



CLAYPAKY CD3003 Sharpy X Frame FD Moving Head Fixture Instruction Manual

[Home](#) » [CLAYPAKY](#) » CLAYPAKY CD3003 Sharpy X Frame FD Moving Head Fixture Instruction Manual 



SHARPY X FRAME
SHARPY X FRAME FD
CD3003

<https://muzcentre.ru/>



Congratulations on choosing a Claypaky product!

We thank you for your custom.

Please note that this product, as all the others in the rich Claypaky range, has been designed and made with total quality to ensure excellent performance and best meet your expectations and requirements.

Contents

- 1 SAFETY INFORMATION**
- 2 UNPACKING AND PREPARATION**
- 3 INSTALLATION AND START-UP**
- 4 MAINTENANCE**
- 5 DIMENSIONS**
- 6 CAUSE AND SOLUTION OF PROBLEMS**
- 7 Documents / Resources**
 - 7.1 References**
- 8 Related Posts**

SAFETY INFORMATION

SAFETY INFORMATION

IMPORTANT: Claypaky recommends you carefully read and keep the safety information on this product, also available in digital format at the following link: www.claypaky.com

Ref: FIS027 – Safety Information Sharpy X Frame / FD

UNPACKING AND PREPARATION

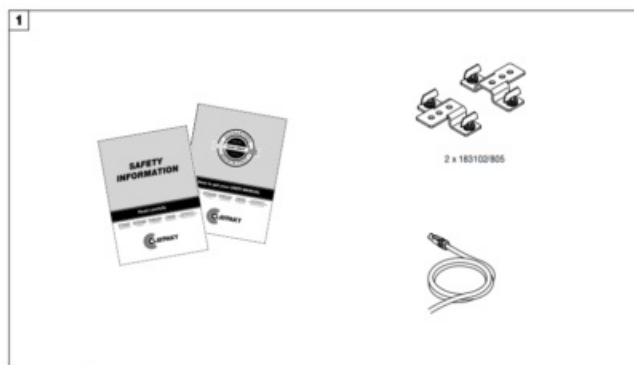

Packing contents - Fig. 1

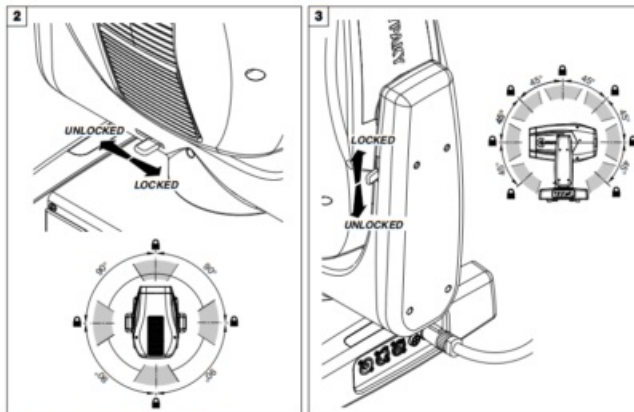

PAN Mechanism Lock and Release (every 90°) - Fig. 2

TILT Mechanism Lock and Release (every 45°) - Fig. 3

INSTALLATION AND START-UP

3.1 Installing the fixture

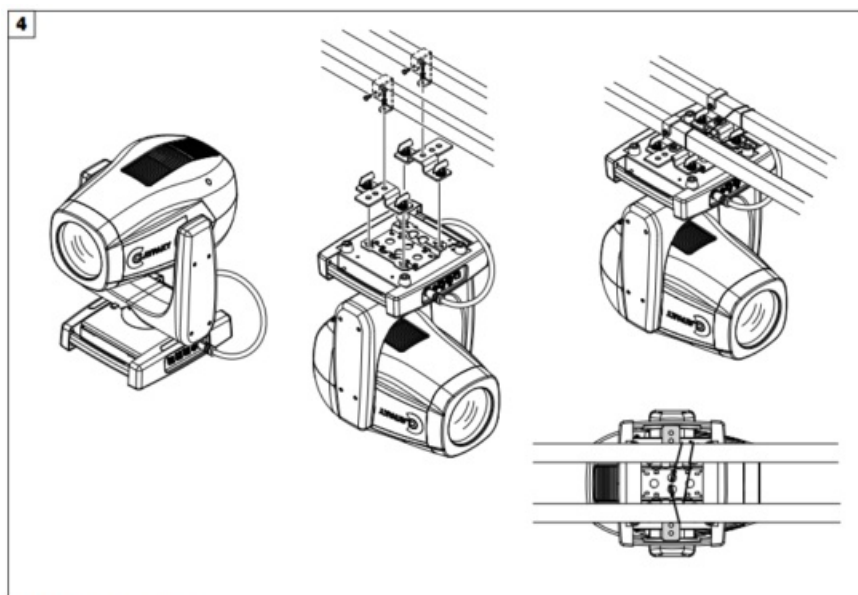

Installing the projector - Fig. 4

The projector can be installed on the floor resting on special rubber feet, on a truss or on the ceiling or wall.

WARNING: with the exception of when the projector is positioned on the floor, the safety cable must be fitted. (Cod. 105041/003 available on request).

This must be securely fixed to the support structure of the projector and then connected to the fixing point at the centre of the base.

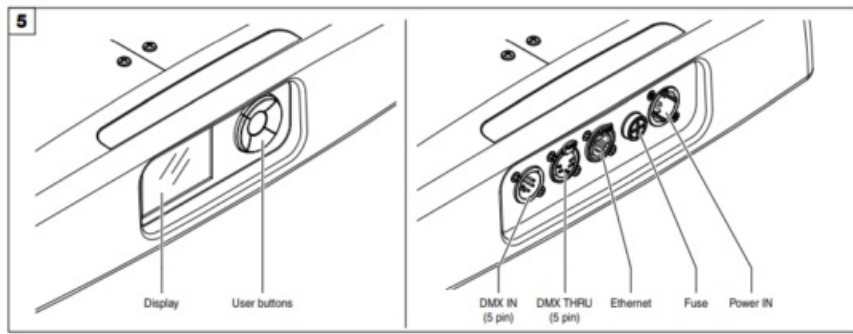

Control panel - Fig. 5

3.2 Connecting to mains supply

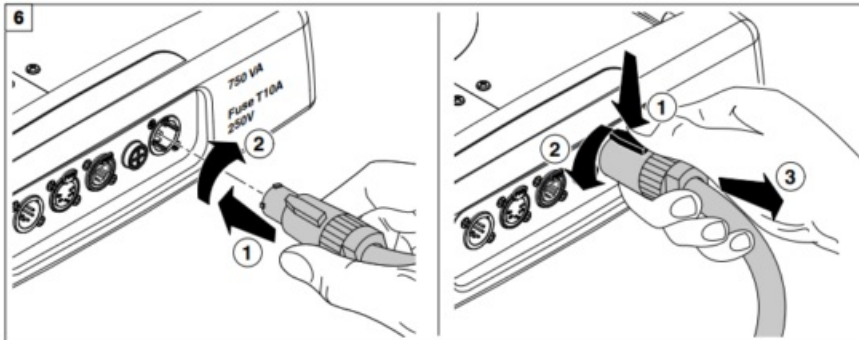

Connecting and disconnecting power cable - Fig. 6

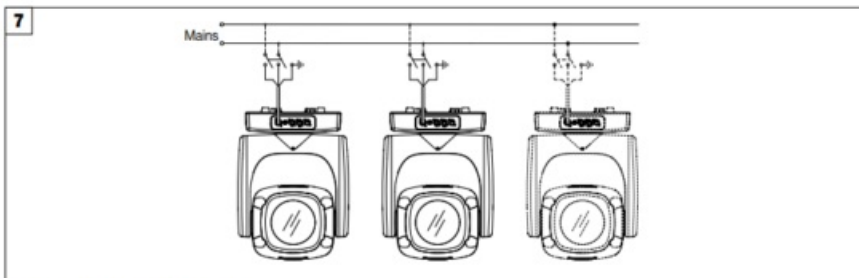

Connecting to the mains supply - Fig. 7

3.3 Connecting the control signal line: DMX / Art-Net

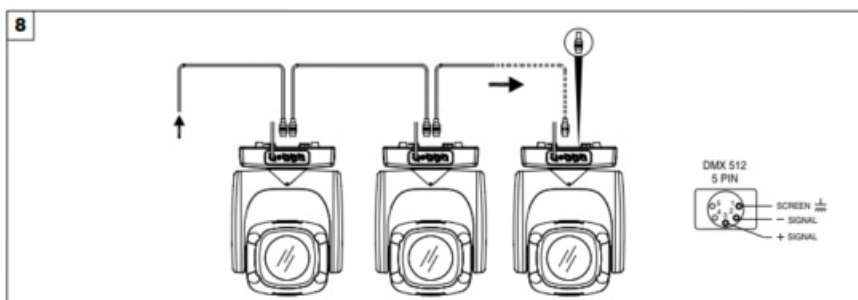

Connecting to the control signal line (DMX) - Fig. 8

Connecting to the control signal line (DMX) – Fig. 8

Use a cable conforming to specifications EIA RS-485: 2-pole twisted, shielded, 120Ohm characteristic impedance, 22-24 AWG, low capacity. Do not use microphone cable or other cable with characteristics differing from those specified. The end connections must be made using XLR type 5 pin male/female connectors. A terminating plug must be inserted into the last projector with a resistance of 120Ohm (minimum 1/4 W) between terminals 2 and 3.

IMPORTANT: The wires must not make contact with each other or with the metal casing of the connectors. The casing itself must be connected to the shield braid and to pin 1 of the connectors.

3.4 Switching on the fixture and basic SetUp

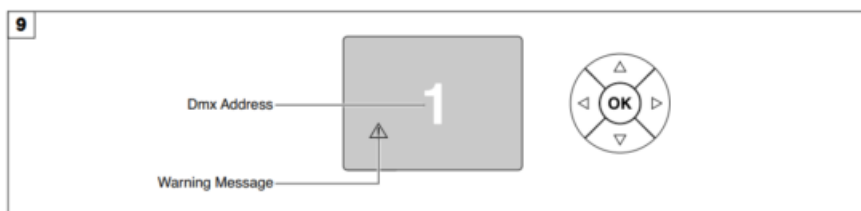

Switching on the projector - Fig. 9

Switch-on the fixture. The projector starts resetting the effects. At the same time, the following information scrolls on the display:





On conclusion of resetting in case of absence of the dmx signal, Pan and Tilt move to the “Home” position (Pan 128 bit – Tilt 128 bit). The control panel (Fig. 8) has a display and buttons for the complete programming and management of the projector menu. The display can be in one of two conditions: rest status and setting status. When it is in the rest status, the display shows the projector’s DMX address.

During menu setting status, after a wait time (about 30 seconds) without any key having been pressed, the display automatically returns to rest status.

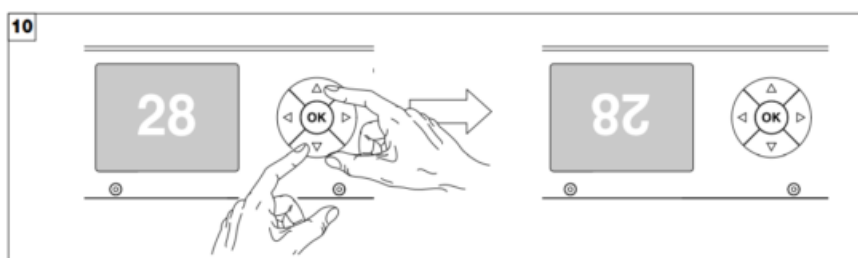
It should be noted that when this condition occurs, any possible value that has been modified but not yet confirmed with the  key will be cancelled.



Reversal of the display - Fig. 10







To activate this function, press UP  and DOWN  keys simultaneously while the display is in the rest mode. This status will be memorised and maintained even for the next time it will be switched on. To return to the initial state, repeat the operation all over again.

Setting the projector starting address

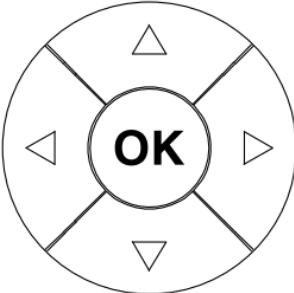





On each projector, the starting address must be set for the control signal (addresses from 1 to 512).

The address can also be set with the projector switched off.

Functions of the buttons – Using the menu

	 Confirms the displayed value, or activates the displayed function, or enters the successive menu.
	 DOWN Decreases the value displayed (with auto-repetitions) or passes to the next item in the menu.
	 UP Increases the value displayed (with auto-repetitions) or passes to the previous item in a menu.
	 LEFT Return to the top level
	 RIGHT Enters the successive menu.

USING THE MENU:

1. Press LEFT  once – “Main Menu” appears on the display.
2. Use the UP  and DOWN  keys to select the menu to be used:
 - Setup (Setup Menu): To set the setting options.
 - Option (Option Menu): To set the operating options
 - Informations (Informations Menu): To read the counters, software version and other information.
 - Manual Control (Manual control Menu): To trigger the test and manual control functions.
 - Test (Test Menu): To check the proper functioning of effects
 - Advanced (Advanced Menu): Access to the “Advanced menu” is recommended for a trained technical personnel.
3. Press  to display the first item in the selected menu.
4. Use the UP  and DOWN  keys to select the MENU items.

Setting addresses and options with the projector disconnected

The projector's DMX address, as well as other possible operating options, can also be set when the appliance is disconnected from the electricity supply. All that is needed is to press RIGHT  to momentarily activate the display and thus access the settings. Once the required operations have been carried out, the display will switch off again after a wait time of 30 seconds.

MAINTENANCE

4.1 Opening the covers

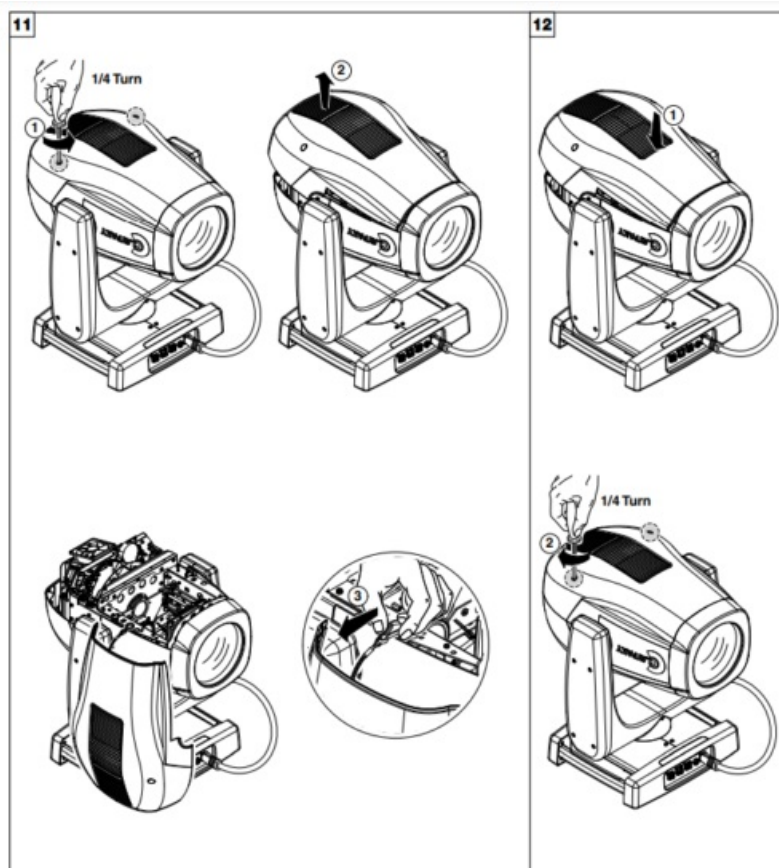

PREPARATION section.

Opening the head covers – Fig. 11.

Closing the head covers – Fig. 12.

4.2 Periodical cleaning

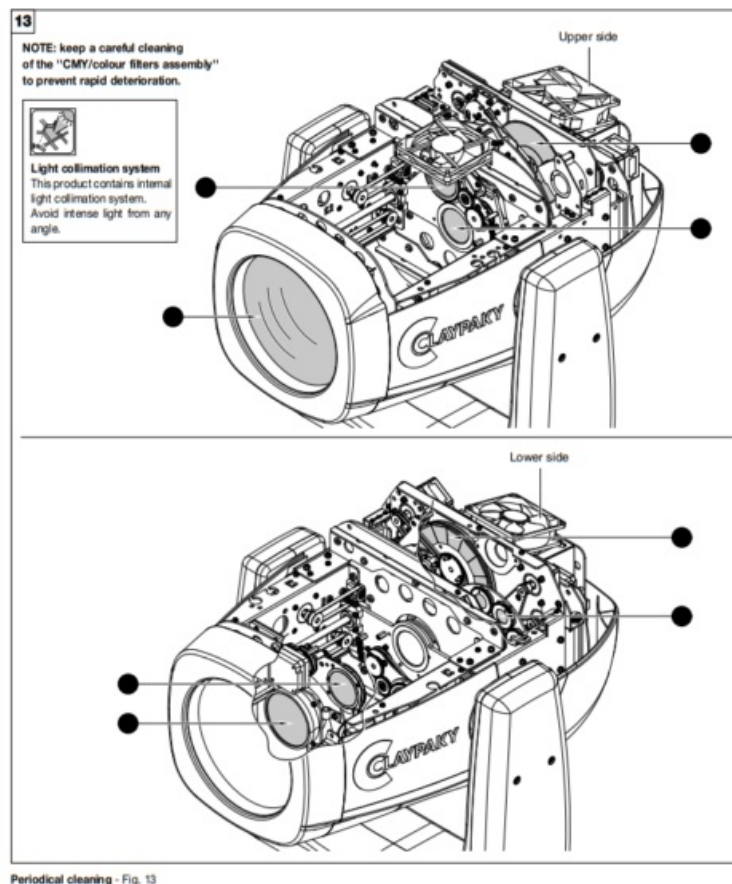

To ensure optimal operation and performance for a long time it is essential to periodically clean the parts subject to dust and grease deposits. The frequency with which the following operations are to be carried out depends on various factors, such as the amount of the effects and the quality of the working environment (air humidity, presence of dust, salinity, etc.).

Use a soft cloth dampened with any detergent liquid for cleaning glass to remove the dirt from the reflectors, from the lenses and filters. It is recommended that the projector undergoes an annual service by a qualified technician for special maintenance involving at least the following operations:

- General cleaning of internal parts.
- Restoring lubrication of all parts subject to friction, using lubricants specifically supplied by Claypaky.
- General visual check of the internal components, cabling, mechanical parts, etc.
- Electrical, photometric and functional checks; eventual repairs.

4.3 Effects module removal

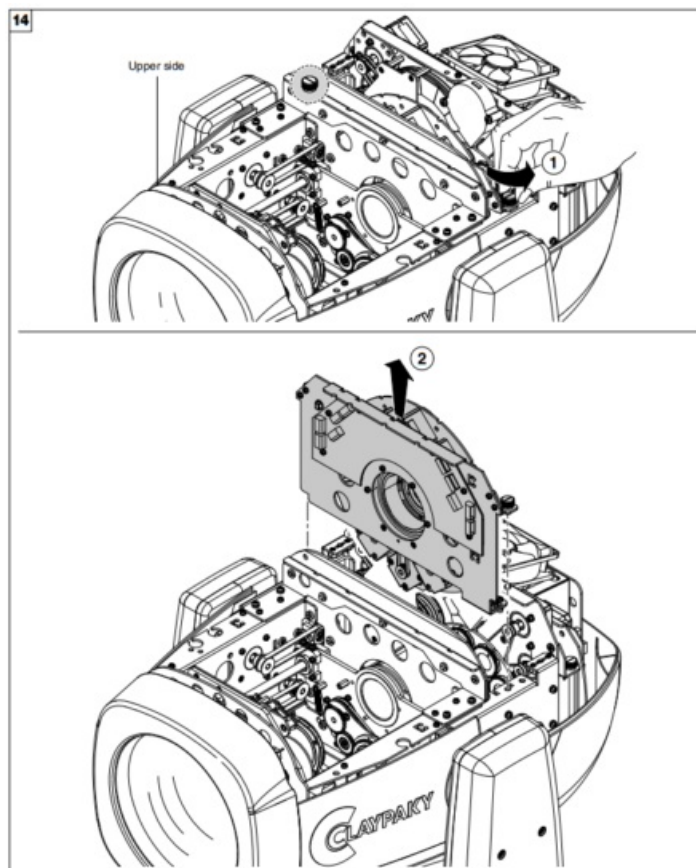

Extraction of the effect modules – Fig. 14.

IMPORTANT: Grasp the modules using the support structure and not the details which could get damaged.
 Insertion of the effect modules: Repeat the operations indicated in Fig. 14, 15 and 16 in reverse order.

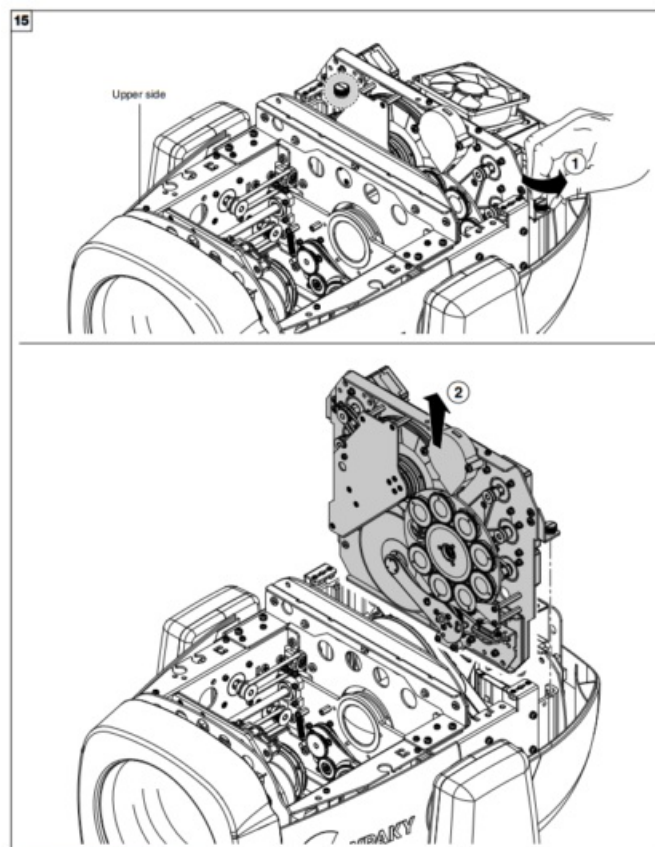

Extraction of the effect modules - Fig. 15.

IMPORTANT: Grasp the modules using the support structure and not the details which could get damaged.
 Insertion of the effect modules: Repeat the operations indicated in Fig. 14, 15 and 16 in reverse order.

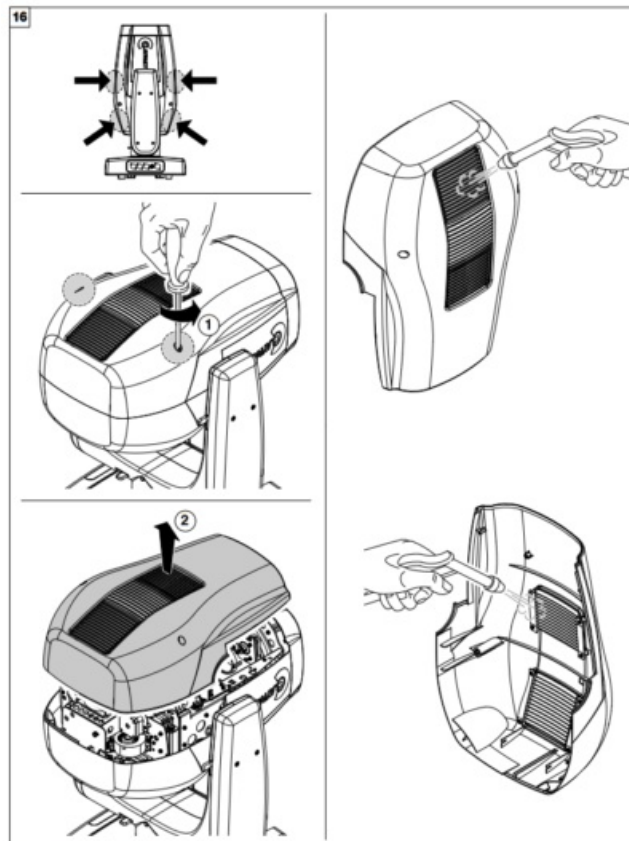

Clearing of the grids - Fig 16.

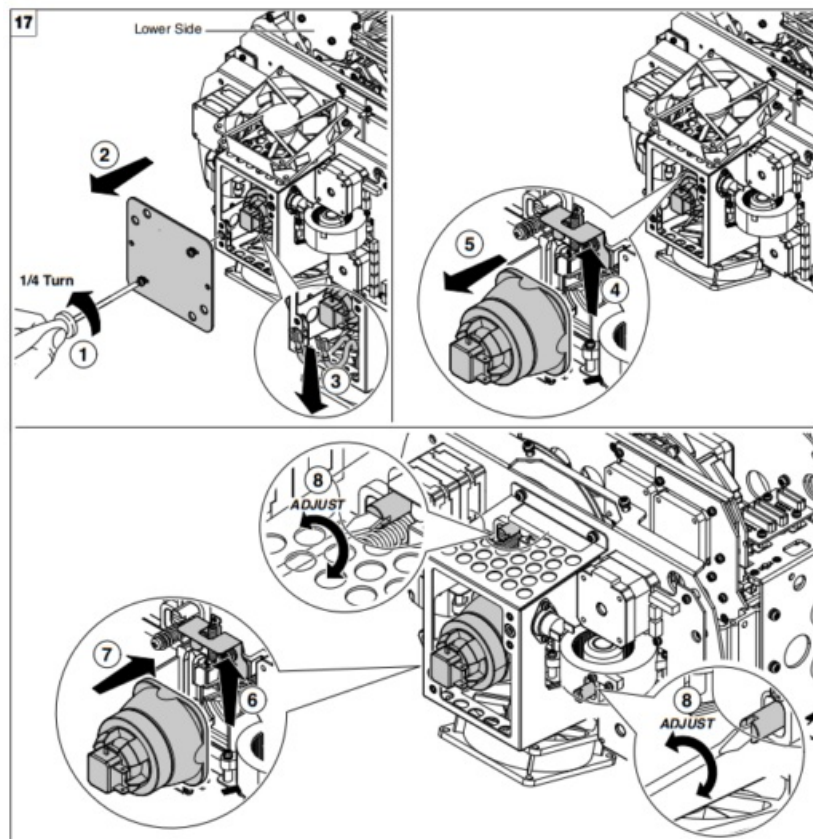

Lamp change - Fig 17.

Take the new lamp out of its package and insert in the fitting.

WARNING: do not touch the lamp's envelope with bare hands. Should this happen, clean the bulb with a cloth soaked in alcohol and dry it with a clean, dry cloth.

Lamp regulation

To centre the lamp, turn the adjusting screw as shown in the figure.

WARNING: The lamp must be adjusted with the projector switched off. After adjusting, close the effects covers,

switch on the projector and check that the adjustment has been correctly made. If necessary, switch off the projector, remove the effects covers and repeat lamp adjustment.

REMARK:

- Lifetime of the lamp will be influenced by the switching cycle.
- After a successful starting, attempt to keep the lamp burning for at least 15 minutes in order to complete the chemical cycle of the lamp to secure the lifetime.
- After switching-off the lamp wait at least 2 minutes before switching-on it again.

4.4 – Rotating gobos

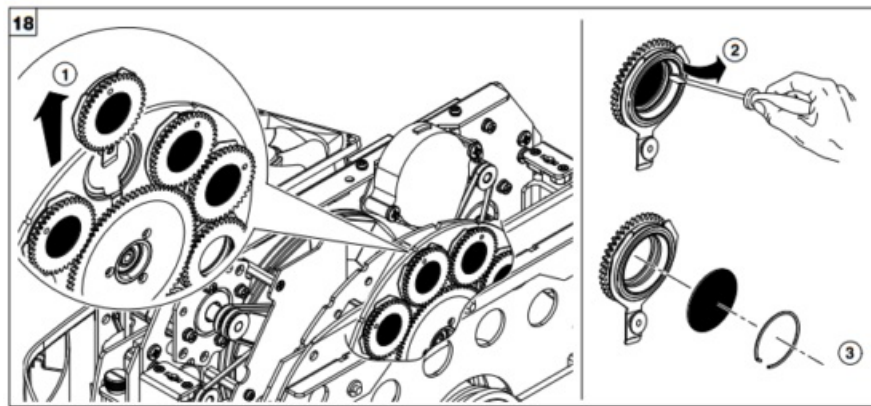

Bearing group replacement - Fig. 18

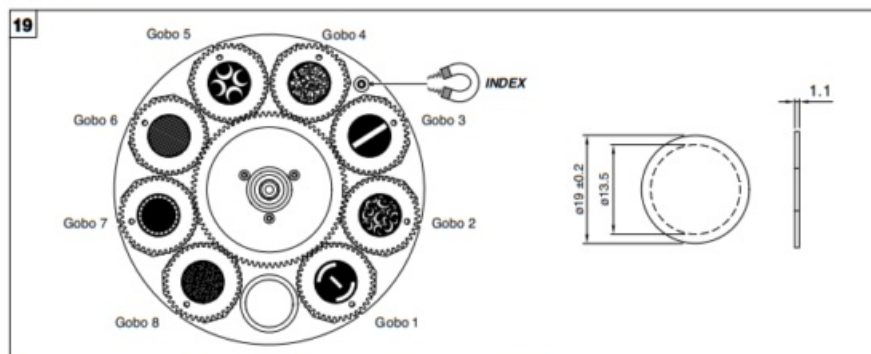

Replacing rotating gobos (\varnothing 19 mm – max 13.5 mm image – thickness 1.1 mm) - Fig. 19

- The rotating gobo wheel only use dichroic glass gobos (it is not possible to use metal gobos);
- For more information contact Claypaky;

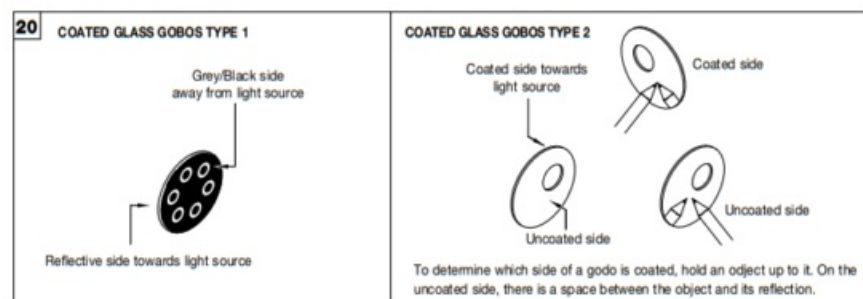

Gobo orientation - Fig. 20

The pictures shown the correct gobos orientation.

4.5 – Battery removal



This product contains a rechargeable battery. To preserve the environment, please dispose the battery at the end of its life according to the regulation in force.

DIMENSIONS

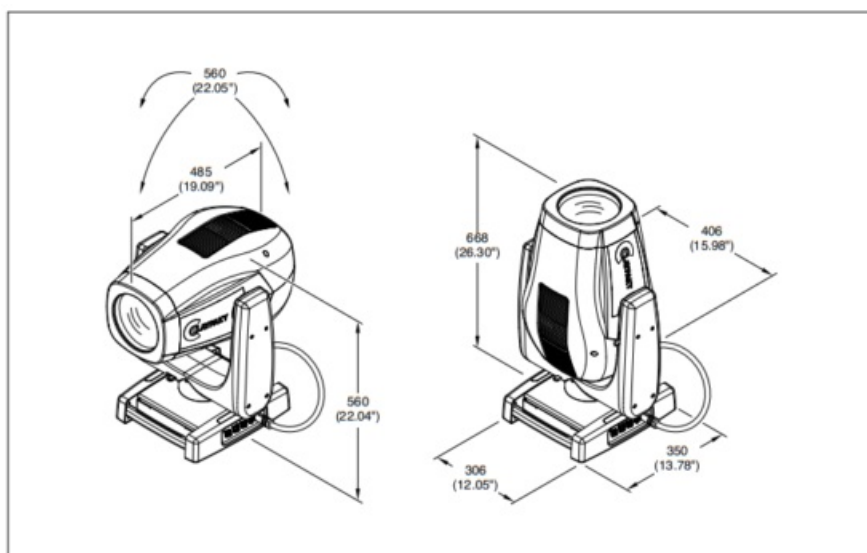

CAUSE AND SOLUTION OF PROBLEMS

THE PROJECTOR WILL NOT SWITCH ON			PROBLEMS
ELECTRONICS NON-OPERATIONAL			
DEFECTIVE PROJECTION			
REDUCED LUMINOSITY			
POSSIBLE CAUSES			CHECKS AND REMEDIES
●		No mains supply.	Check the power supply voltage.
●	●	Light source exhausted or defective.	Call an authorised technician.
●		Signal transmission cable faulty or disconnected.	Replace the cables.
●		Incorrect addressing.	Check addresses (see instructions).
●		Fault in the electronic circuits.	Call an authorised technician.
●	●	Lenses broken	Call an authorised technician.
●	● ●	Dust or grease deposited.	Clean (see instructions).

www.claypaky.com – Service support & Helpdesk: <https://e-assist.tech>

Documents / Resources

 <p>SHARPY X FRAME SHARPY X FRAME FD</p> <p>CLAYPAKY</p> <p>CD3003</p> <p>CD3003 Sharpy X Frame FD Moving Head Fixture, Sharpy X Frame FD Moving Head Fixture, FD Moving Head Fixture, Moving Head Fixture, Head Fixture, Fixture</p>	<p>CLAYPAKY CD3003 Sharpy X Frame FD Moving Head Fixture [pdf] Instruction Manual CD3003, CD3003 Sharpy X Frame FD Moving Head Fixture, Sharpy X Frame FD Moving Head Fixture, FD Moving Head Fixture, Moving Head Fixture, Head Fixture, Fixture</p>
--	---

References

- [Claypaky | Professional Lighting](#)
- [Claypaky - home](#)
- [Профессиональная акустика — Активные акустические системы.](#)
- [User Manual](#)

[Manuals+](#), [Privacy Policy](#)

This website is an independent publication and is neither affiliated with nor endorsed by any of the trademark owners. The "Bluetooth®" word mark and logos are registered trademarks owned by Bluetooth SIG, Inc. The "Wi-Fi®" word mark and logos are registered trademarks owned by the Wi-Fi Alliance. Any use of these marks on this website does not imply any affiliation with or endorsement.