



CLAS OM 9367 Silent Block Extractor Instruction Manual

[Home](#) » [CLAS](#) » CLAS OM 9367 Silent Block Extractor Instruction Manual 

CLAS OM 9367 Silent Block Extractor Instruction Manual

OM 9367

**EXTRACTEUR DE SILENT BLOC
FIAT PANDA/500 ET FORD KA**

**SILENT BLOCK EXTRACTOR
FIAT PANDA/500 AND FORD KA**



WARNING

Before returning this product for any reason (installation problem, instructions for use, breakdown, manufacturing problem...), please contact us.

Contact : You can reach us by mail sav@clas.com or by phone +33(0)4 79 72 69 18 or go directly to our website clas.com

If you have changed your mind regarding your purchase, please return this product before you attempt to install it.

SILENT BLOCK EXTRACTOR FIAT PANDA/500 AND FORD KA

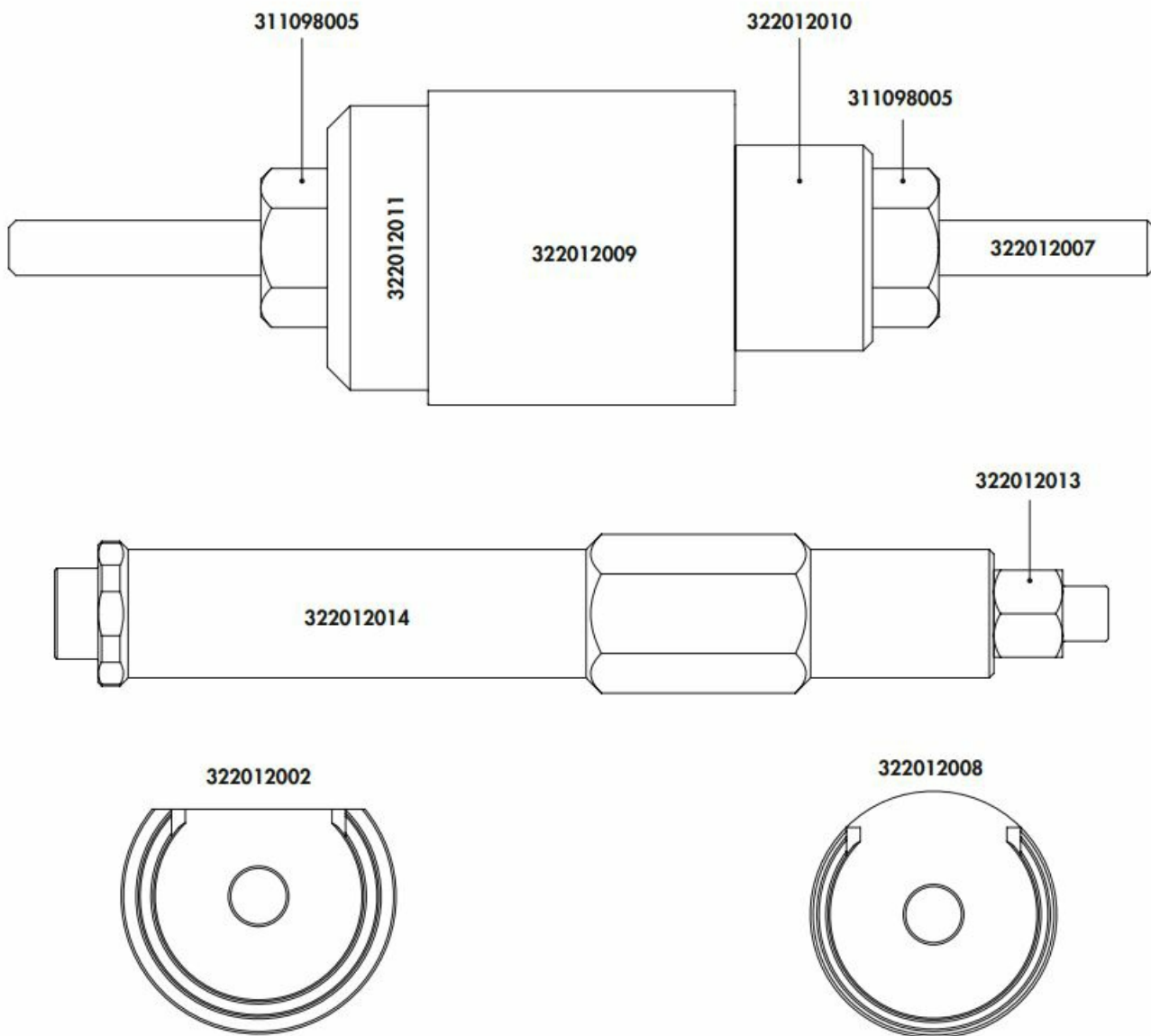

Components

322012011	WASHER WITH BEARING (INSERTION)	
322012009	REMOVAL BUSH	
311098005	NUTS M 12 (N°. 2)	
322012007	SCREW M12	
322012002	INSERTION WASHER	
322012008	REMOVAL WASHER	
322012013 + 322012014	REMOVAL TOOL	
322012010	REMOVAL BUSH WITH BEARING	

Contents

1 INTRODUCTION

2 HOW TO USE

3 Documents / Resources

3.1 References

INTRODUCTION

It is compulsory to read this instruction manual before starting any kind of action.

The proper operation and full compliance of this product's performance is guaranteed only if all the instructions provided in this manual are closely adhered to.

We guarantee that this product complies with the technical specifications described in this manual. The manufacturer shall not be held responsible for any improper uses other than those described herein.

Use protective work gloves, protective footwear, hard hat and safety goggles.



⚠ Misuse:

- This product should only be used as described in this documentation; any other use is considered improper.
- The manufacturer accepts no responsibility for any damage caused by the incorrect or unreasonable use of the equipment.
- Moreover, misuse shall also void the warranty.

Take care of your tools:

- Be sure to store your tools in a clean state.
- Place the tools inside their original package.

Silentblock Ø	Brand	Model
Ø 45 mm	Fiat	Panda (4x4 - Cross - Methane), Panda Classic from 2003 to 2013 with independent left and right arms
Ø 45 mm	Fiat	Ford Ka, Fiat 500
Ø 54 mm	Ford	Ka
Ø 54 mm	Opel	Adam

HOW TO USE

REMOVING / INSERTING SILENTBLOCKS OF fiat 500 / ford ka:

Support with mounted silentblock:

Unscrew nut and remove screw: then pull down 6 support to remove silentblock (fig. 1).



Removal:

- Mark silentblock position BEFORE removal (fig. 2-3).
- Mount tools 322012011 (ref. A), 322012009 (ref. B), 311098005 (ref. C), 322012007 (ref. D), 322012008 (ref. E) as shown in picture (fig. 4).
- Screw nuts with 30 mm wrenches until silentblock is fully removed (fig. 5-6).



Insertion :

- To insert silentblock, put it into position checking previously made marks, and position washer 322012002 (ref.

F) to accommodate silentblock at support output; use tools: 322012011 (ref. A), 311098005 (ref. C), 322012007 (ref. D), 322012002 (ref. F) (fig. 7).

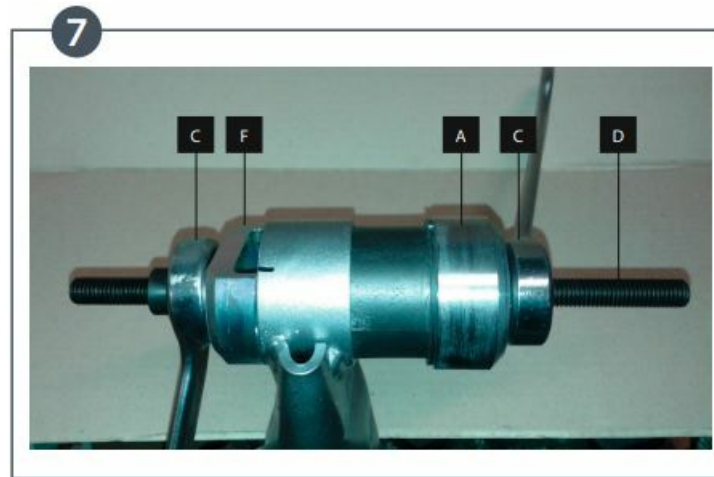

- Keep screwing with both 30 mm wrenches until silentblock is fully inserted (fig. 8-9).

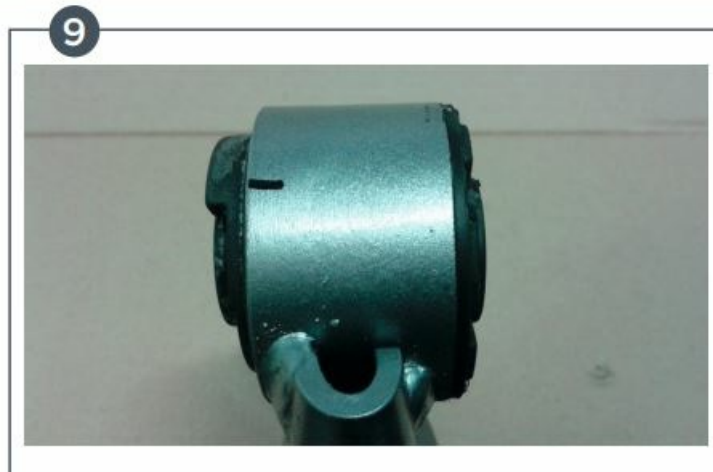
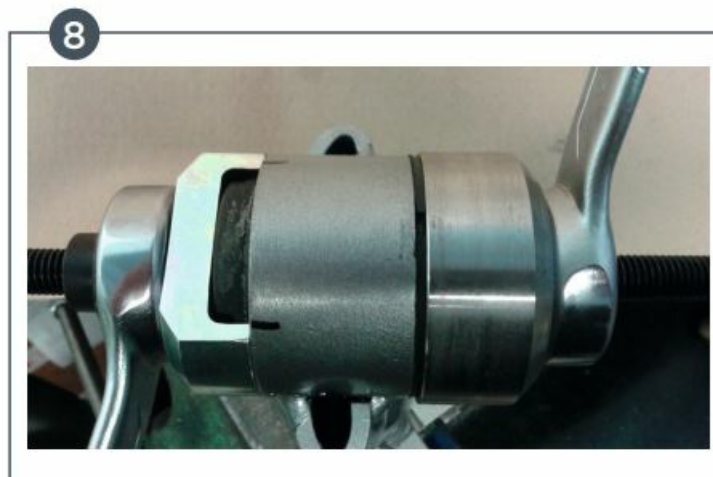

⚠ **ATTENTION** : Apply grease to screw around nut rotation area, and also oil silentblock seat before insertion.

REMOVING / INSERTING SILENTBLOCKS OF PANDA (4X4, CROSS, NATURAL GAS):

Removal:

Insert tool 322012013 + 322012014 (ref. H+G) between silentblocks to remove: position washer 322012002 on one side (ref. F) and use bush with bearing 322012010 (ref. E) on the other side. Remove silentblock on the right-hand; and **REVERSING POSITION** remove silentblock on the left-hand. Use 19 mm and 30 mm wrenches (grease screw 322012013 (ref. H) before use) (fig. 10).



- Bushing (ref. F), on which M16 screw works, must be positioned correctly. Specifically, when the surface of bushing (ref. F) is in contact with the car's "axle" part, it should never be oblique and must bear correctly on the plane. It is important that the M16 screw and the entire tool are in axis during the operation.
- During the job, always use the tool from point X and not from the M16 screw.

⚠ If you use the tool from the M16 screw it will not work as it should and could get damaged.

Insertion:

Fit silentblock onto screw and place it with head on washer with bearing 322012011 (ref. A); get screw onto other side of support and position milled washer 322012002 (ref. F); screw nut M12, checking that everything is aligned before screwing (fig. 11).

Oil silentblock (and, before, seat) and use two 30 mm wrenches to rotate nuts. Keep screwing until silentblock is fully inserted.

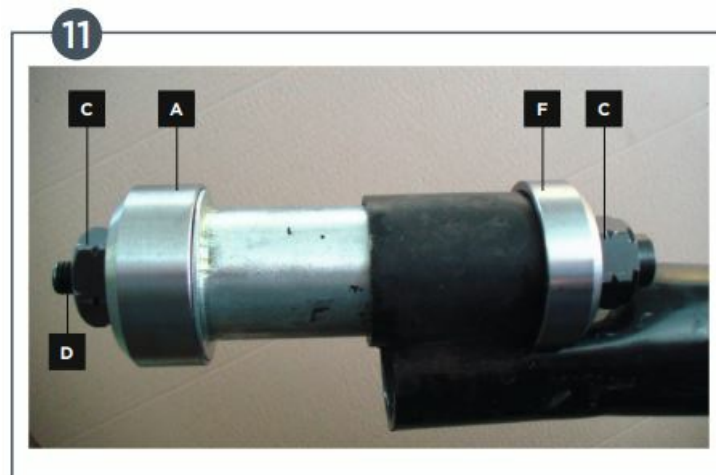

⚠ ATTENTION: Please use threads lubricating paste.



CLAS Equipements ZA de la CROUZA
73800 CHIGNIN FRANCE
Tél. +33 (0)4 79 72 62 22
Fax. +33 (0)4 79 72 52 86

OM 9367

EXTRACTEUR DE SILENT BLOC FIAT PANDA/500 ET FORD KA

If you need components or parts, please contact the reseller. In case of problems, please contact your authorized technician.

Documents / Resources

	<p>CLAS OM 9367 Silent Block Extractor [pdf] Instruction Manual</p> <p>OM 9367 Silent Block Extractor, OM 9367, Silent Block Extractor, Block Extractor, Extractor</p>
---	--

References

-  [Accueil](#) | [CLAS©](#) | [Equipements & outillage](#) | [Garage solutions](#)