

clare™
CLR-C1-RCDW2
ClareOne
Recessed Door
Sensor



CLARE CLR-C1-RCDW2 ClareOne Recessed Door Sensor Installation Guide

[Home](#) » [CLARE](#) » CLARE CLR-C1-RCDW2 ClareOne Recessed Door Sensor Installation Guide 

Contents

- [1 CLARE CLR-C1-RCDW2 ClareOne Recessed Door Sensor](#)
- [2 Product Information](#)
- [3 Product Usage Instructions](#)
- [4 Install your Recessed Door/Window Sensor](#)
 - [4.1 Warranty and Legal Notices](#)
- [5 FCC Compliance Statement](#)
- [6 FAQ](#)
- [7 Documents / Resources](#)
 - [7.1 References](#)
- [8 Related Posts](#)



CLARE CLR-C1-RCDW2 ClareOne Recessed Door Sensor



Product Information

Specifications

- **Product Name:** ClareOne Recessed Door Sensor
- **Model:** CLR-C1-RCDW2
- **Version:** 240828-0100
- **Frequency:** 433MHz

Product Usage Instructions

Step 1: Prepare the Main Sensor

1. Remove the Pull Tab to install the sensor.
2. Remove the clear battery insulator by pulling it away from the Main Sensor.

Step 2: Add Recessed Door/Window Sensor to Your Panel

Power up the sensor and add it to your panel following the manufacturer's instructions.

Step 3: Change Battery

1. Turn the lid of the sensor casing to access the hardware.
2. Pull out the hardware from the plastic casing to change the battery.

Step 4: Install Your Recessed Door/Window Sensor

1. Drill a hole in the door/window frame for the Main Sensor.
2. Insert the Main Sensor into the hole and secure it with screws.
3. Add white glue (PVA) inside the hole for the Magnetic Sensor and gently tap it into place with a rubber hammer.

Ensure there is a gap between the two parts of the sensor ranging from 1mm to 5mm. Adjust if necessary.

Recessed Door/Window Sensor

- The Recessed Door/Window Sensor Invisibly installed, it sits within a door/window and its frame to provide all the information needed by the 433MHz system for security, safety, and ambiance.
- The recessed Door/Window Sensor is comprised of two parts: the larger Main Sensor and the smaller Magnetic Sensor.
- The larger Main Sensor

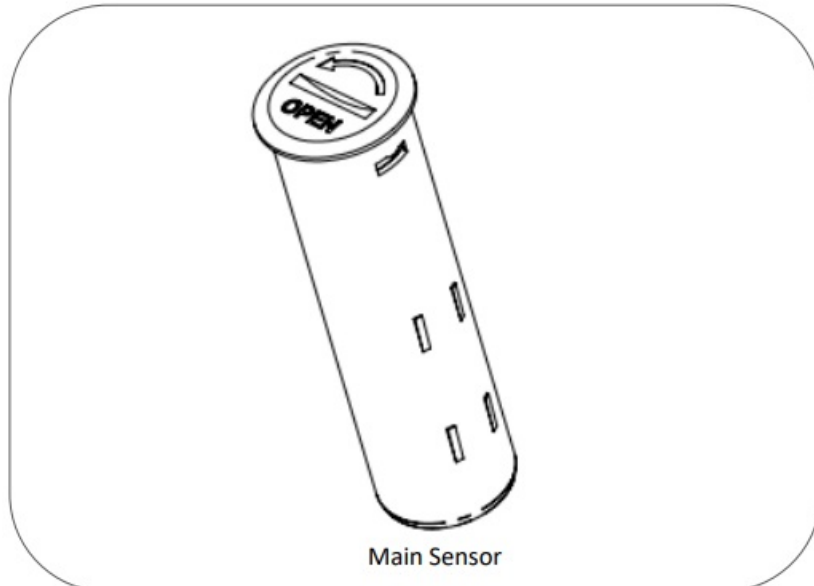

- The Magnetic Sensor

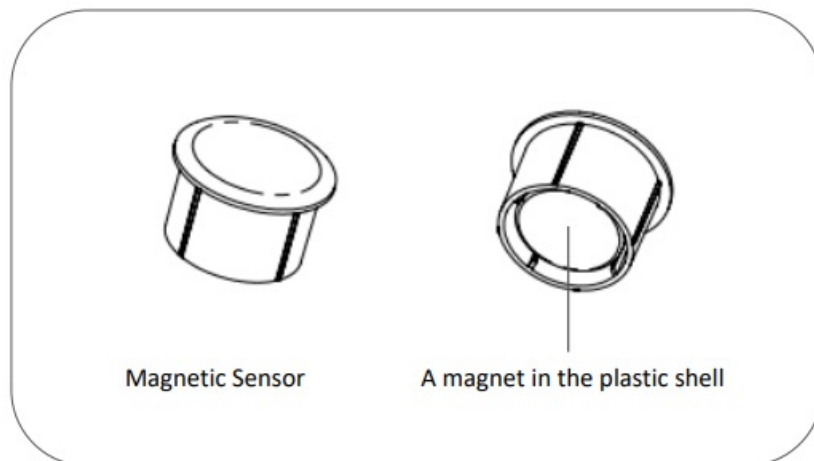

The installation of your Recessed Door/Window Sensor has two key steps:

1. Install both parts of the recessed door/window sensor.
2. Connect the recessed door/window sensor to the panel.

Prepare the Main Sensor

1. Remove the Pull Tab to install the sensor.
2. Remove the clear battery insulator by pulling it away from the Main Sensor.

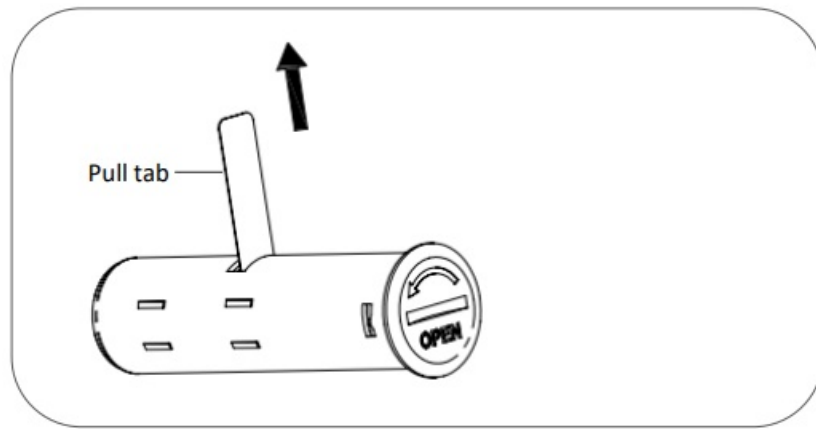

Add Recessed Door/Window Sensor to your panel.

Getting your Recessed Door/Window Sensor up and running is as simple as powering it up, and adding it to the panel.

Change battery

Please follow the below process.

1. Turn the lid of the sensor casing to pull out the hardware from the plastic casing.

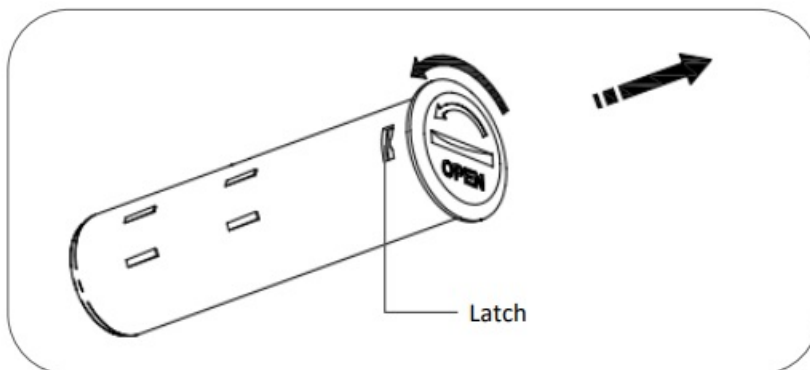

2. Pulling out the hardware from the plastic casing to change the battery.

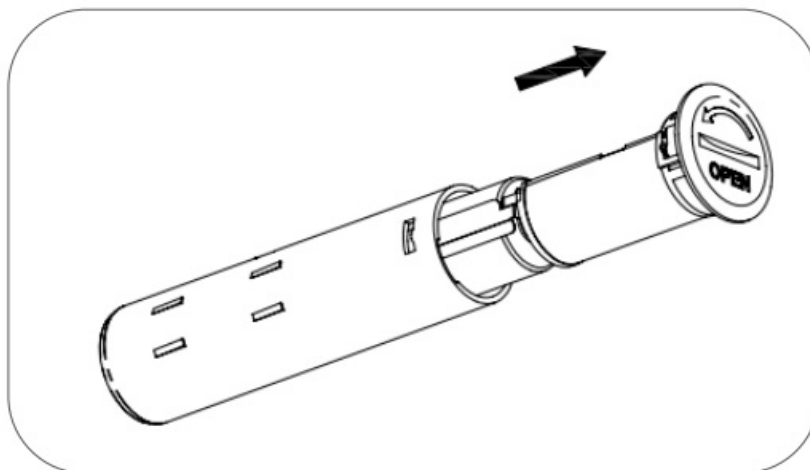

Install your Recessed Door/Window Sensor

With Main Sensor powered and activated, it is now time to inlay it within your selected door/window frame. Before beginning, it is important to select a suitable position for your Recessed Door/Window Sensor. For optimal performance, your sensor should be:

1. Either installed at the top of a door/window or the side of a door/window.

2. Positioned away from metal that could interfere with its magnetic functionality or wireless functions. This includes your door's plate, handle, or lock mechanism.
3. Installed in a suitable location to ensure a clear (between 1mm and 5mm) separation when the door/window is closed.
4. Positioned exactly above or beside the position in which the Magnetic Sensor will be inlaid.

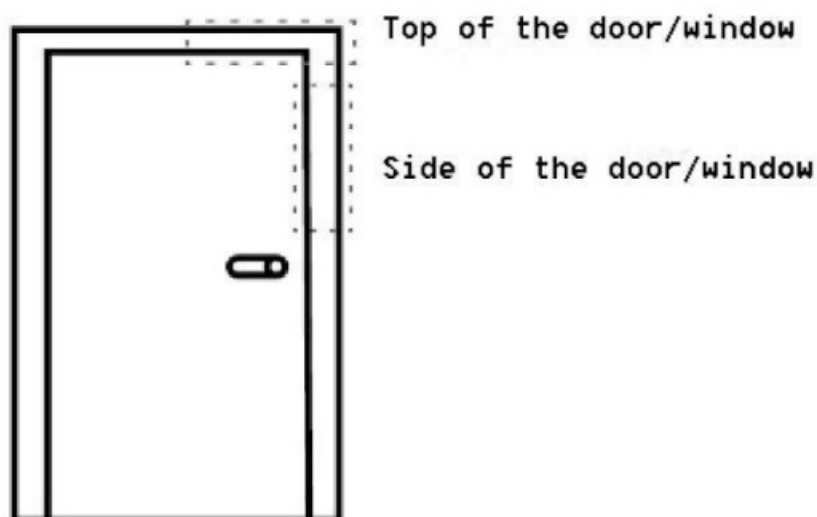

The rectangular areas highlighted above are optimal installation positions.

Step 1 – Drill the for Sensor main body.

Prepare the space for the Main Sensor by drilling a hole into your door/window frame using a 20mm/0,75 inch wide drill bit (you can use a slightly larger drill bit if needed). The hole should be 65mm/2.56 inches deep. Although 19mm/0,75 inch is stated for the drill bit size, it is advised that the drill bit should be larger to allow

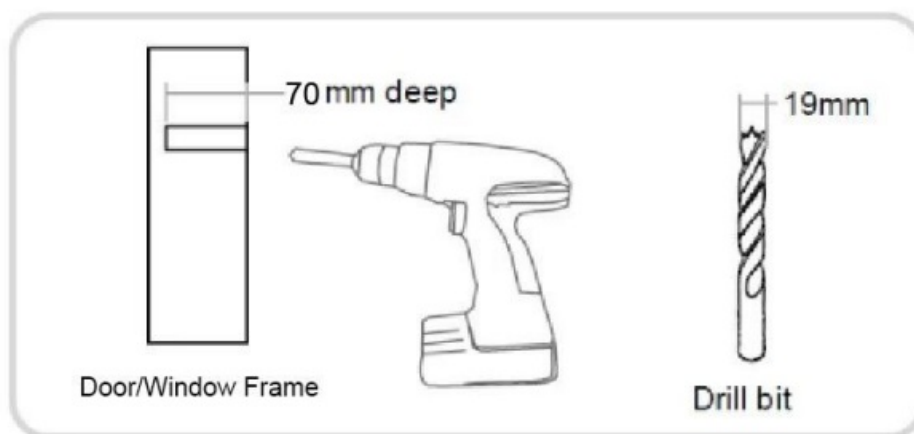

Step 2 – Drill for Magnet piece.

Drill a corresponding hole in your door/window. The hole should be 15mm deep. As stated, the position of this hole should align exactly with the hole you just created in the door/window frame. Again, use a 19mm wide drill bit. Unlike the main unit, a 19mm drill bit should be used.

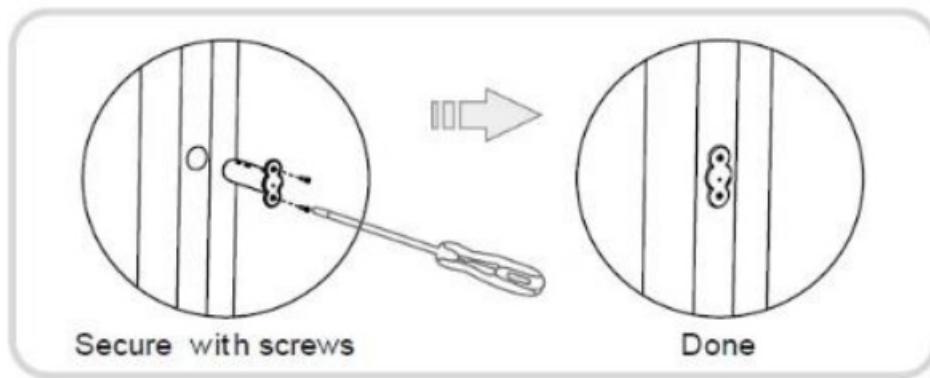

With your door/window and door/window frame prepared and the drill holes created, it's now time to mount both parts of your Recessed Door/Window Sensor.

Step 3

Insert the Main Sensor into the hole you created in the door/window frame then secure it using two screws.

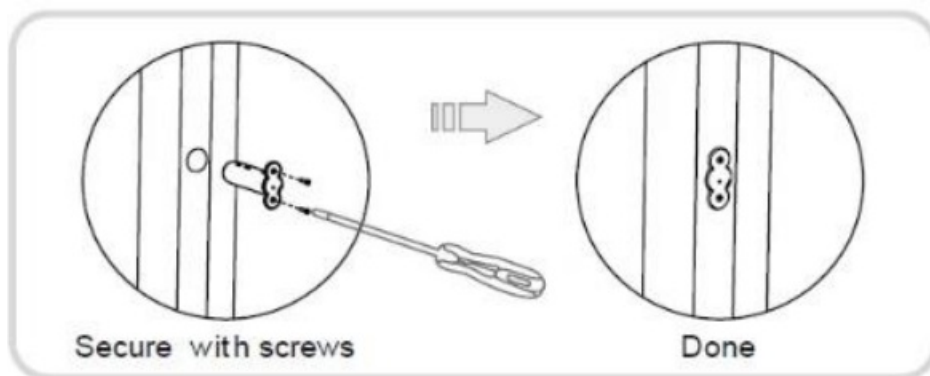

Step 4

Place a small amount of white glue (PVA) inside the hole you created for Magnetic Sensor. Then, place the sensor over and into the hole. Next, insert it by tapping gently on it with a rubber hammer.

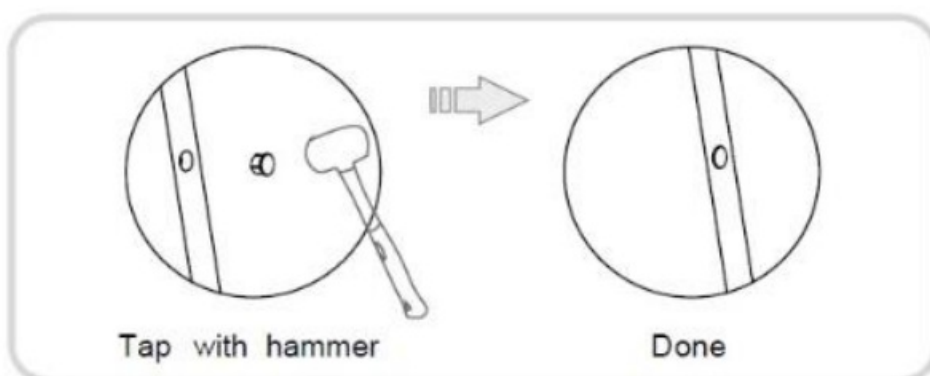

Step 5

The gap between the two parts of your sensor must be no less than 1mm and no more than 5mm. If your gap is different, re-affix the Main Sensor by altering its hole.

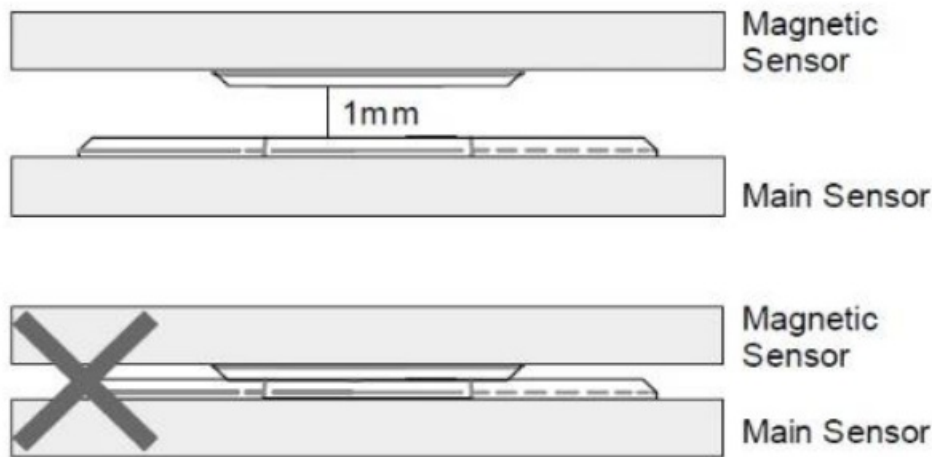

War ranty and Legal Notices

Find details of the product's Limited Warranty at snapone.com/legal/ or request a paper copy from Customer Service at 866.424.4489. Find other legal resources, such as regulatory notices and patent and safety information, at snapone.com/legal/.

Copyright ©2024, Snap One, LLC. All rights reserved. Snap One and its respective logos are registered trademarks or trademarks of Snap One, LLC (formerly known as Wirepath Home Systems, LLC), in the United States and/or other countries. Clare is also a trademark of Snap One, LLC. Other names and brands may be claimed as the property of their respective owners. Snap One does not claim that the information contained herein covers all installation scenarios and contingencies, or product use risks. Information within this specification is subject to change without notice. All specifications are subject to change without notice.

FCC Compliance Statement

This device complies with Part 15 of the FCC Rules. Operation is subject to the following two conditions:

1. this device may not cause harmful interference, and
2. this device must accept any interference received, including interference that may cause undesired operation.

Note: This equipment has been tested and found to comply with the limits for a Class B digital device, under Part 15 of the FCC Rules.

These limits are designed to provide reasonable protection against harmful interference in a residential installation. This equipment generates, uses, and can radiate radio frequency energy and, if not installed and used by the instructions, may cause harmful interference to radio communications.

However, there is no guarantee that interference will not occur in a particular installation.

If this equipment does cause harmful interference to radio or television reception, which can be determined by turning the equipment off and on, the user is encouraged to try to correct the interference by one or more of the following measures:

- Reorient or relocate the receiving antenna.
- Increase the separation between the equipment and the receiver.
- Connect the equipment to an outlet on a circuit different from that to which the receiver is connected.
- Consult the dealer or an experienced radio/TV technician for help.

Warning: changes or modifications not expressly approved by the party responsible for compliance could void the

user's authority to operate the equipment. This equipment complies with FCC radiation exposure limits set forth for an uncontrolled environment. This transmitter must not be co-located or operating in conjunction with any other antenna or transmitter.

ISED Compliance Statements

This device contains license-exempt transmitter(s)/receiver(s) that comply with Innovation, Science, and Economic Development Canada's license-exempt RSS(s). Operation is subject to the following two conditions:

1. This device may not cause interference.
2. This device must accept any interference, including interference that may cause undesired operation of the device.

This equipment complies with IC RSS-102 radiation exposure limits set forth for an uncontrolled environment.

ISED Radiation Exposure Statement

This equipment complies with IC RSS-102 radiation exposure limits set forth for an uncontrolled environment. This transmitter must not be co-located or operating in conjunction with any other antenna or transmitter.

FAQ

Q: What should I do if my Recessed Door/Window Sensor is not connecting to the panel?

A: Make sure the sensor is powered on and within range of the panel. Try re-adding the sensor to the panel following the pairing instructions in the manual.

Q: How often should I change the battery in the sensor?

A: It is recommended to change the battery in the sensor as soon as you notice a decrease in performance or receive low battery notifications on your panel.

Documents / Resources

 <p>clare CLR-C1-RCDW2 ClareOne Recessed Door Sensor Install Guide</p>	clare CLR-C1-RCDW2 ClareOne Recessed Door Sensor [pdf] Installation Guide CLR-C1-RCDW2, CLR-C1-RCDW2 ClareOne Recessed Door Sensor, ClareOne Recessed Door Sensor, Recessed Door Sensor, Door Sensor, Sensor
---	---

References

- [Snap One](#)
- [Policies](#)
- [User Manual](#)

[Manuals+](#), [Privacy Policy](#)

This website is an independent publication and is neither affiliated with nor endorsed by any of the trademark owners. The "Bluetooth®" word mark and logos are registered trademarks owned by Bluetooth SIG, Inc. The "Wi-Fi®" word mark and logos are registered trademarks owned by the Wi-Fi Alliance. Any use of these marks on this website does not imply any affiliation with or endorsement.