



claber Modulo 9V Control Module Instruction Manual

[Home](#) » [claber](#) » claber Modulo 9V Control Module Instruction Manual 

claber Modulo 9V Control Module



Contents

- 1 TECHNICAL DATA
- 2 GENERAL INFORMATION
- 3 DESCRIPTION
- 4 BATTERY REPLACEMENT
- 5 INSTALLATION
- 6 CONDITIONS OF GUARANTEE
- 7 Declaration of Conformity
- 8 KEY
- 9 SETTINGS MODE
- 10 SETTINGS SEQUENCE
 - 10.1 TIME PAGE
 - 10.2 TIME SETTING
 - 10.3 Holding the button pressed down, the time will progress faster
 - 10.4 PROGRAMMING PAGES
 - 10.5 WEEKLY PR
 - 10.6 DISABILITARE GIORNI
- 11 MANUAL
- 12 Documents / Resources
 - 12.1 References
- 13 Related Posts

TECHNICAL DATA

Power supply	1x 6RL61 9 VOLT alkaline
Average life of the battery	1 anno – year
Degree of protection	IP 68
Operating temp	5 – 70 °C
Plastic materials	>ABS< – >PC< >POM< – >TPE<

GENERAL INFORMATION



**NO ANIMAL
INTERACTIONS**



**NOT SUITABLE
FOR CHILDREN**

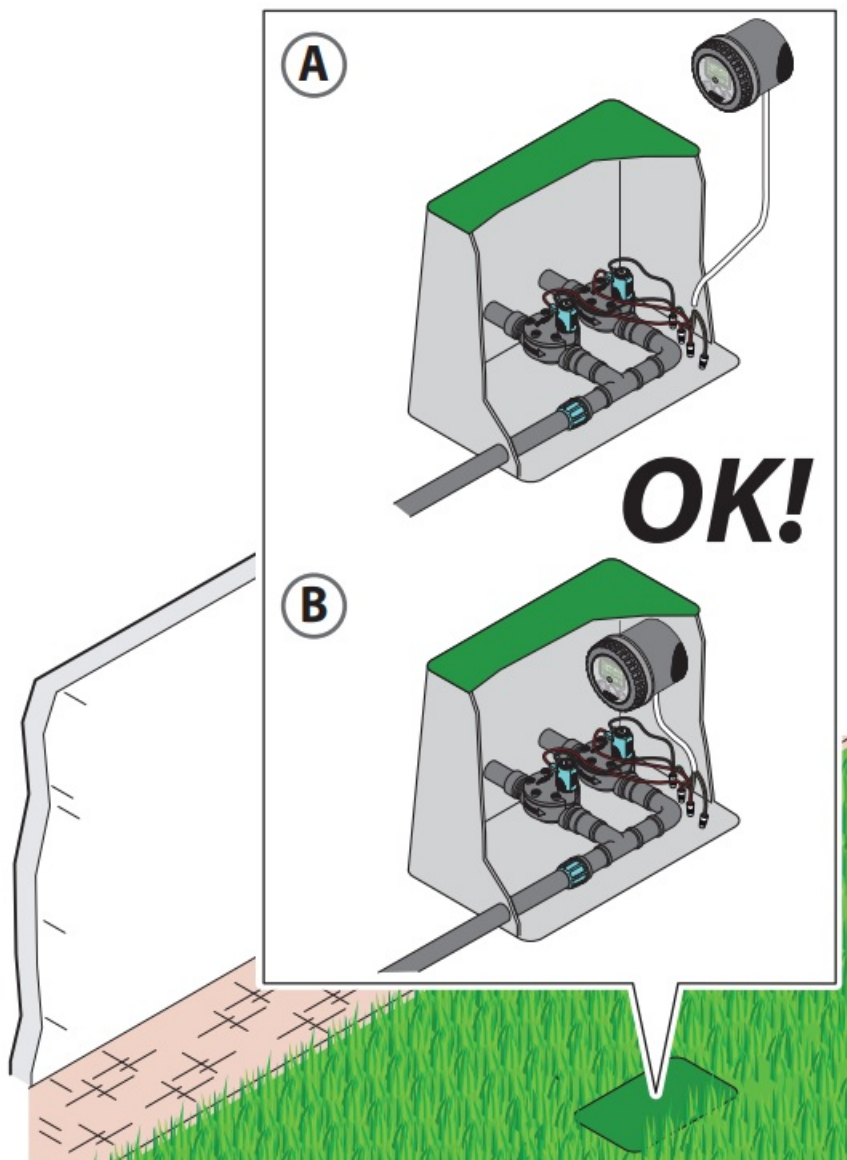

The control unit, with the cover fully and correctly screwed on, is entirely watertight and will function even when permanently under water, up to a depth of one meter (protection rating IP68).
Can be installed inside and outside of valve boxes.

DESCRIPTION

1. Connection cables
2. Body
3. Forward button
4. Enter button
5. Back button
6. Cover lid
7. Liquid Crystal Display
8. Battery housing

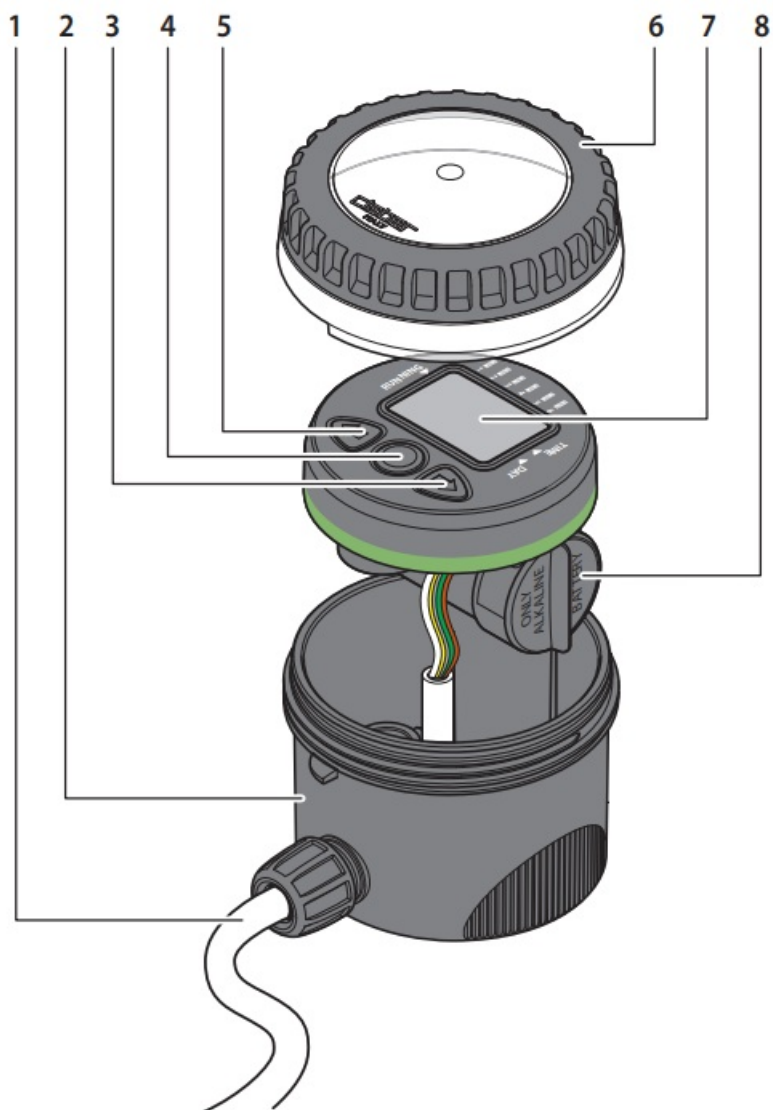

Make the system of a suitable size for the water availability (l/min)

BATTERY REPLACEMENT

Replace the battery as indicated in the procedure to the side. When connecting the battery, ensure that polarity is respected. Only use new and unused, branded 6LR61 9V alkaline batteries (not rechargeable), with an expiry date exceeding one year.

To make the product watertight (protection rating IP68), screw the transparent cover on fully and accurately, with the seal correctly in place.

1

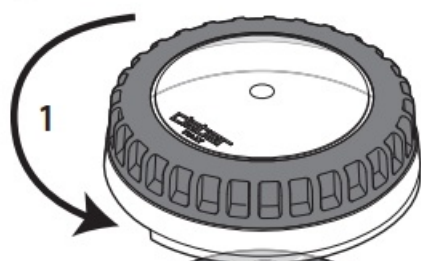

3

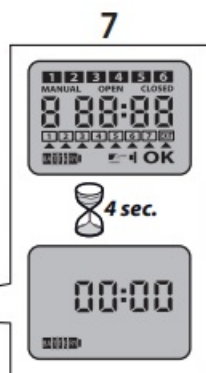

BATTERY NOT INCLUDED

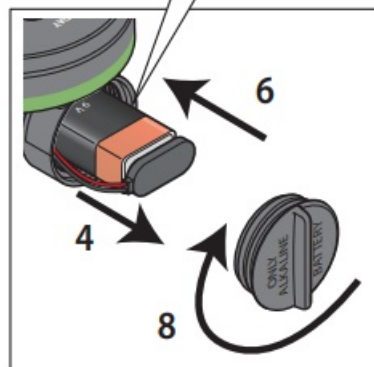

2

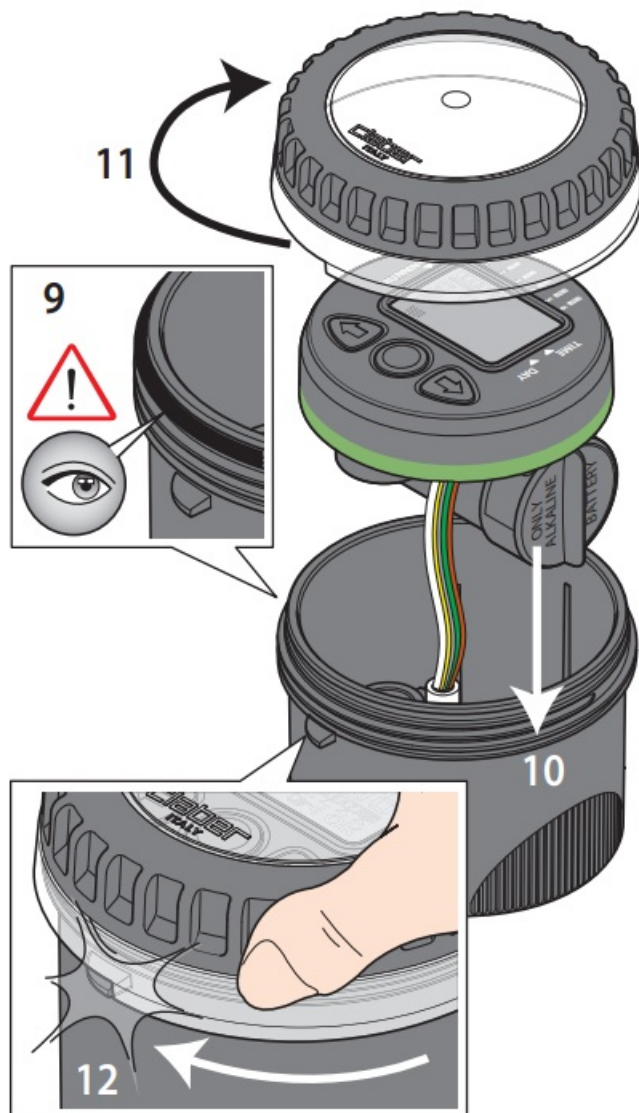

BATTERY	BATTE	BAT	BAT

INSTALLATION

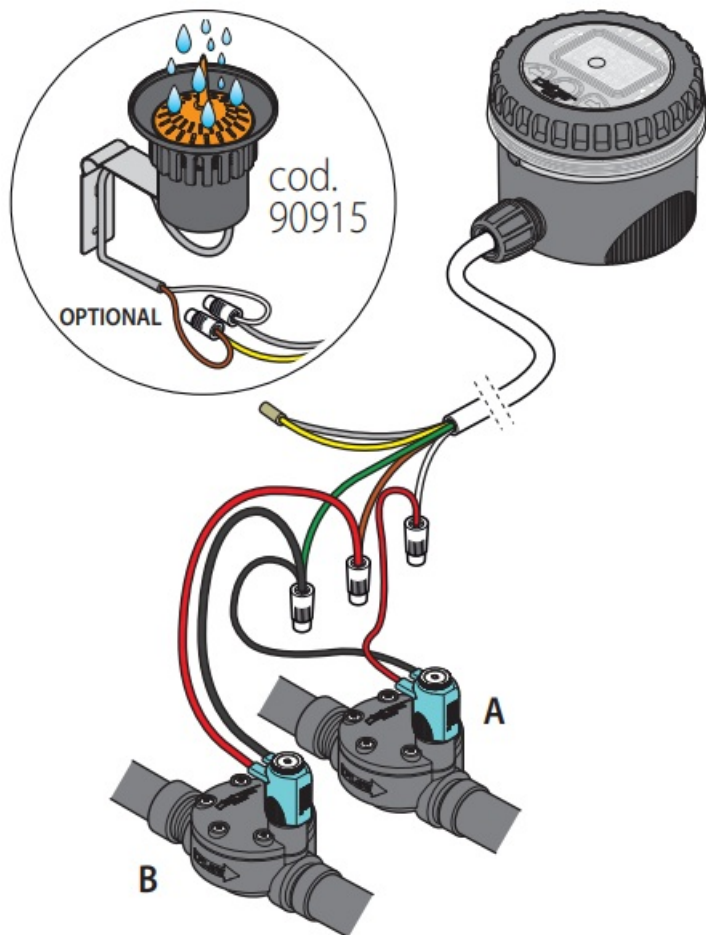

The control unit can control up to two solenoid valves with 9V biostable solenoid. Connect the green wire to the negative pole (black wire) of each solenoid valve (common). Connect the white wire to the positive pole (red wire) of the solenoid valve A. Connect the brown wire to the positive pole (red wire) of the solenoid valve B. To connect the Rain Sensor, cut the yellow and grey wires and connect as shown.

WARNING

Read this instruction manual carefully and keep it handy for future reference. This device has been designed and manufactured exclusively for the setting of watering time by adults with experience and knowledge.

Any use other than that described in this manual is considered improper: the manufacturer acknowledges no liability for damages arising from improper use, which will also void the warranty.

Do not power the water timer with sources other than those specified.

It is good policy – when the water timer is used for the first time – to make certain that the programmes run correctly.

Do not use the water timer with chemicals or liquids other than water.

DISPOSAL



The symbol in question applied to the product or the packaging indicates that the product must not be considered as normal domestic waste, but must be taken to a special centre for the collection and recycling of waste electrical and electronic equipment. Take care to dispose of this product in the proper way; this will help to avoid the negative consequences that could arise from unsorted collection or dumping. For more detailed information on the recycling of this product, contact the municipal authority, the local refuse collection service or

the dealer from whom the item was purchased.

CONDITIONS OF GUARANTEE

This device is guaranteed for 3 years from the date of purchase as indicated by the invoice, bill or till receipt issued at the time of the transaction, which must be kept. Claber guarantees that the product is free of material or manufacturing defects. Within two years from the date of delivery to the consumer, Claber shall repair or replace any parts of this product found to be defective.

The warranty is void in the event of:

- Lack of proof of purchase (invoice, receipt or cash register receipt);
- Use or maintenance different from what is specified;
- Disassembly or tampering by unauthorised personnel;
- Faulty installation of the product;
- Damages from atmospheric agents or contact with chemical agents;

Claber accepts no liability for products that it has not manufactured, even if used in combination with its own products.

The costs and the risks associated with shipment are met entirely by the owner. Assistance is provided by Claber authorized service centres.

Declaration of Conformity



Assuming full responsibility, we declare that the product

90821 – Modulo 9V

complies with the applicable European and British directives, as per the Declarations of Conformity accessible via the following link:



<http://www.claber.com/conformity/>

Fiume Veneto, 11/2022
Il Presidente Claber S.P.A.
Ing. Gian Luigi Spadotto

Handwritten signature

KEY

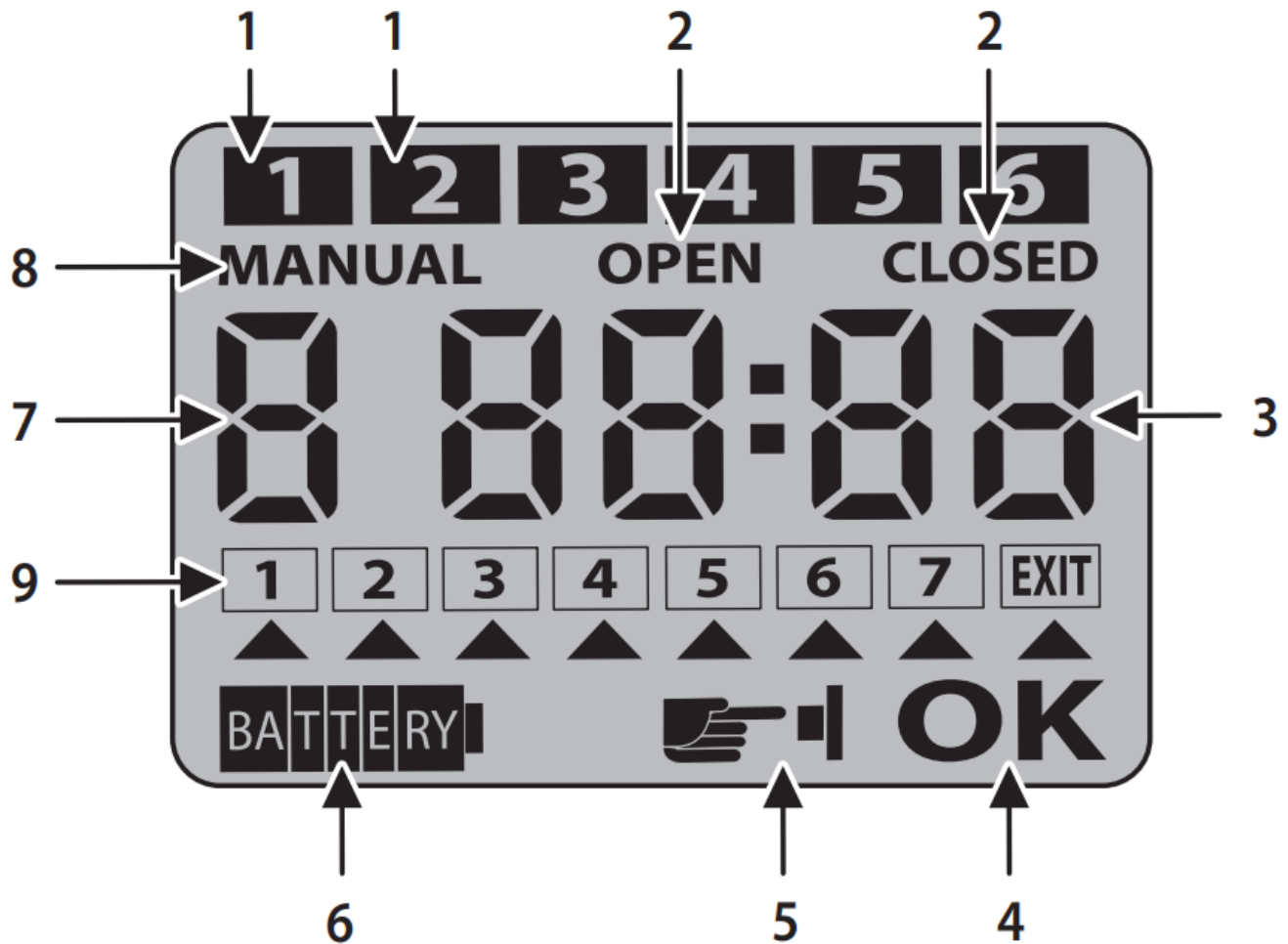

1. LAMPEGGIANTE: programme in fanzine (irrigation in cursor)
2. OPEN=aperta, CLOSED=chiusa
3. Indicates the hour or the start
4. Indicates change settings
5. Indicates the request to press a button
6. Indicates the battery level
7. Indicates the programme that we are working on
8. Manual watering page
9. Days of the week: number 1 corresponds to the day of first programming (e.g. Thursday = 1). The current day (e.g. Saturday = 3) is shown on the display. See the example table below

first programming day

GIOVEDÌ THURSDAY	VENERDÌ FRIDAY	SABATO SATURDAY	DOMENICA SUNDAY	LUNEDÌ MONDAY	MARTEDÌ TUESDAY	MERCOLEDÌ WEDNESDAY	GIOVEDÌ THURSDAY	VENERDÌ FRIDAY	SABATO SATURDAY
1	2	3	4	5	6	7			
	1		3	4	5	6	7		
			2	3	4	5	6	7	
			1	2	3	4	5	6	7

today is

1. Thursday
2. Friday
3. Saturday
4. Sunday
5. Monday
6. Tuesday
7. Wednesday

SETTINGS MODE

- Access the editing of the displayed setting

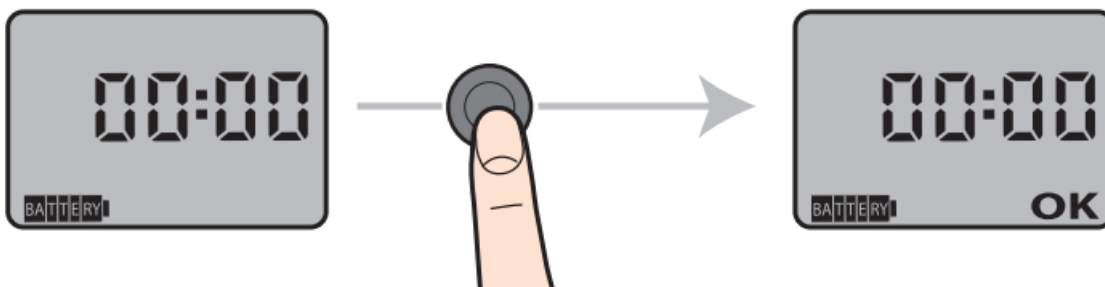

- When you see the message “OK”, press one of the two arrows to modify the parameters

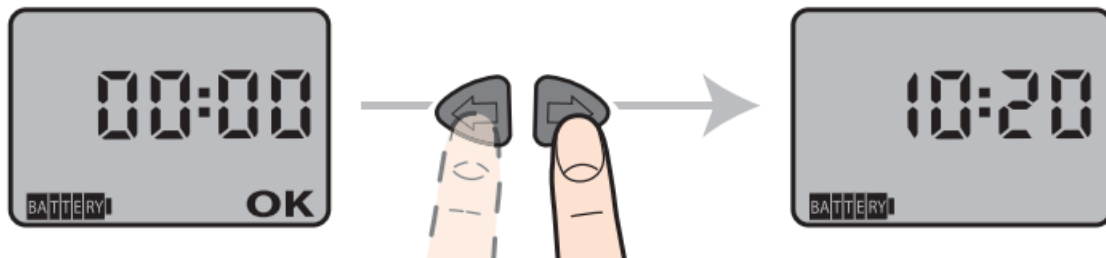

- Once you have reached the desired value, press ENTER to confirm the chosen parameter.

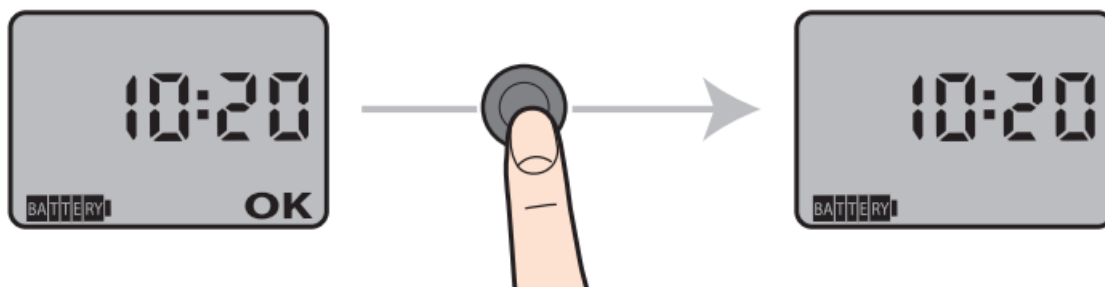

SETTINGS SEQUENCE

TIME PAGE



TIME SETTING



Holding the button pressed down, the time will progress faster



PROGRAMMING PAGES

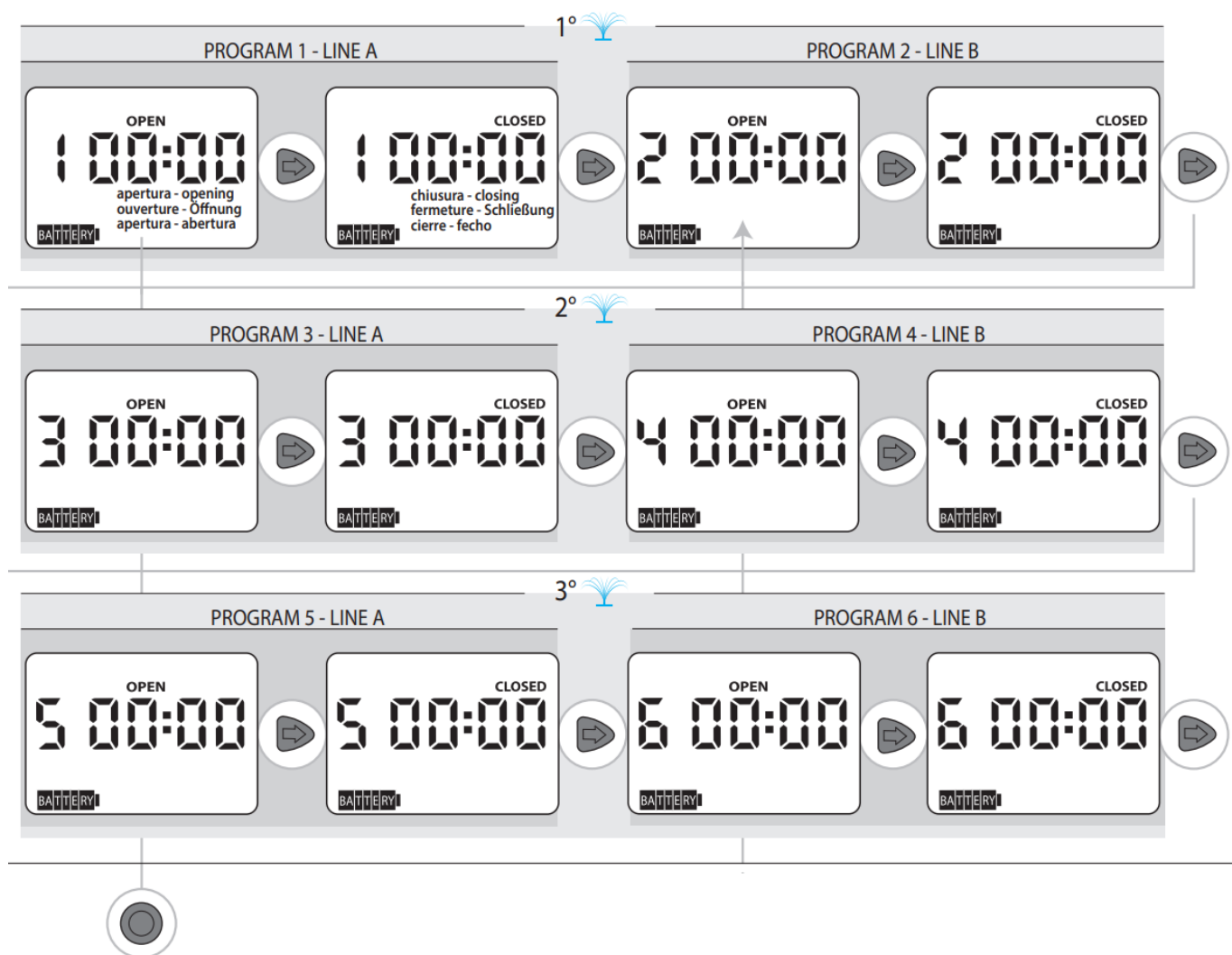

SETTING THE OPENING/CLOSING TIME

All programmes are set in the same way. The programmes must be set in sequence in time order within the same 24 hour period (e.g. 20:00 Í 21:00 pm OK Í 19:00 pm NO). The timer automatically advances by 1 minute with respect to the last set time, both when OPEN and CLOSED.

WEEKLY PR

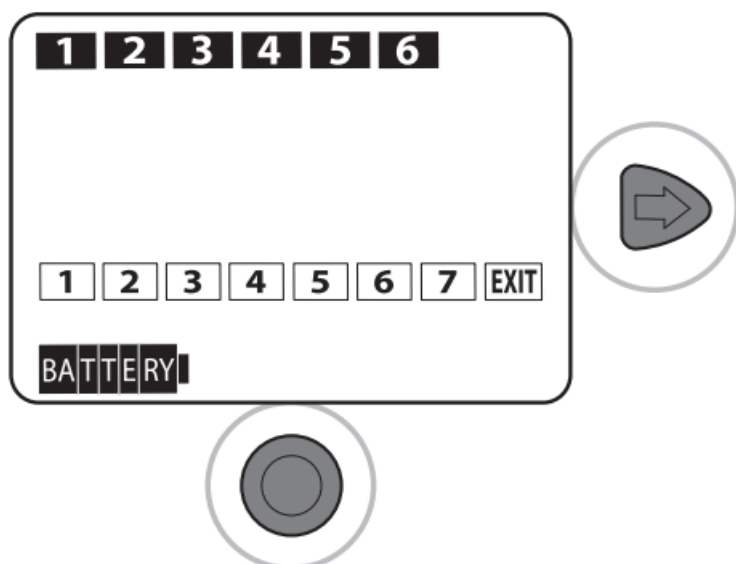

DISABILITARE GIORNI

Press one of the arrows and position the cursor under the day you want to enable/disable. Press ENTER. To exit, position the cursor on EXIT and press ENTER. The days set apply to both lines.

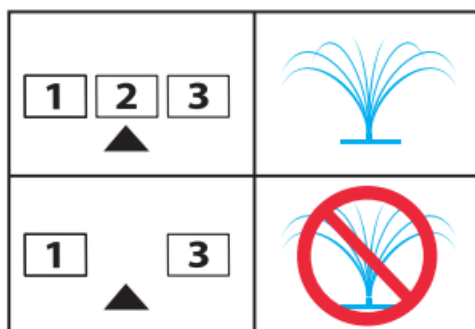
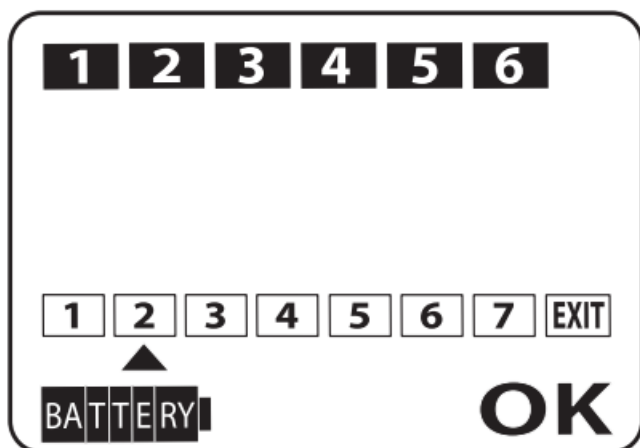
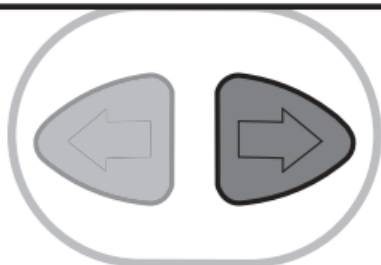
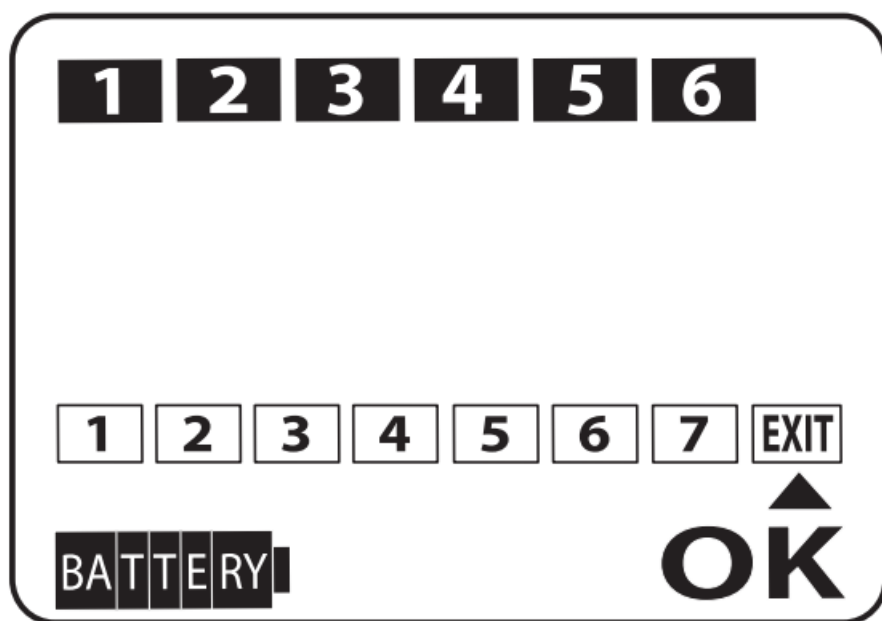

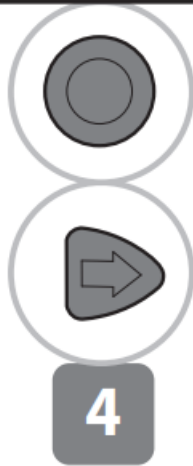
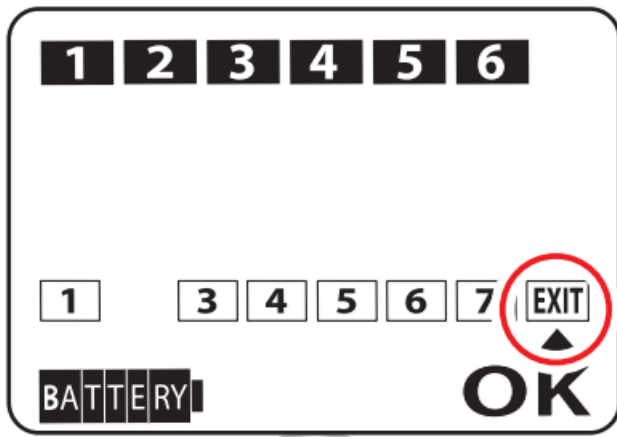

MANUAL

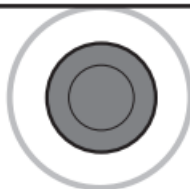
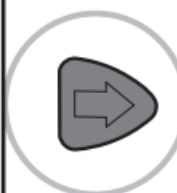
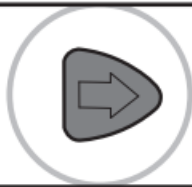
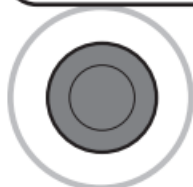
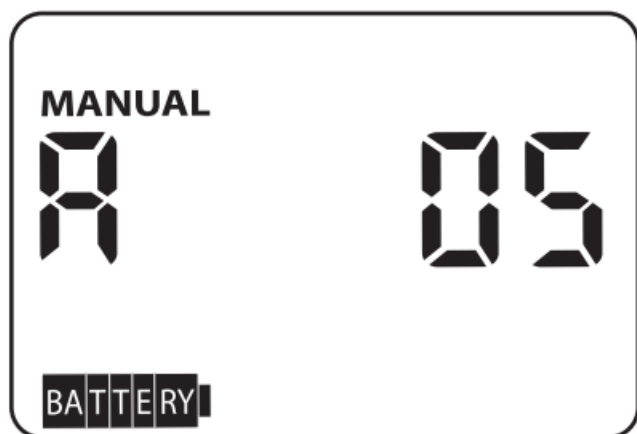

The watering duration cannot be changed



Press the left arrow to start irrigation

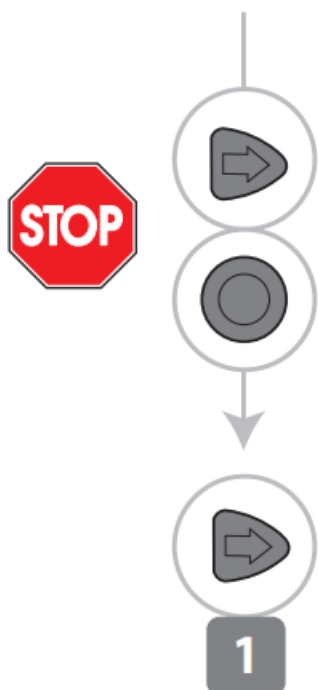

Press the right arrow to stop the cycle early



Watering does not start.

Check that the irrigation days set are active on the weekly page.

I want to delete a programme.

To delete a programme, switch to CLOSED mode, press ENTER, then press the two arrows together.

I want to fully reset the timer.

To fully reset the timer, press and hold the two arrow buttons together for at least 10 seconds, until 00:00 shows on the display.

Follow us on



www.claber.com

**Represented by: Authorised Rep Compliance Ltd., ARC House, Thurnham,
Lancaster, LA2 0DT, UK.**



CLABER SPA – Via Pontebbana, 22 – 33080 Fiume Veneto PN – Italy

Tel. +39 0434 958836 – Fax +39 0434 957193

info@claber.com – www.claber.com





[claber Modulo 9V Control Module](#) [pdf] Instruction Manual
Modulo 9V, Control Module, Modulo 9V Control Module, Module, 90821, 13395

References

-  [Impianti irrigazione giardino: interrata, a goccia, fuori terra](#)
-  claber.com/conformity/

Manuals+,