



CLABEL CT220B Label Maker User Manual

[Home](#) » [clabel](#) » CLABEL CT220B Label Maker User Manual 



User Manual



CT220B Label Printer

Please read this user manual guide carefully before operating the product.

Contents

- 1 Packing List
- 2 Appearance Component
- 3 Function Description
- 4 Description Of Indicator Lights
- 5 Paper Roll Loading
- 6 Mobile Phone Printing Instruction
- 7 Computer Printing Instruction
- 8 Trouble Shooting
- 9 Specification
- 10 Documents / Resources
 - 10.1 References

Packing List

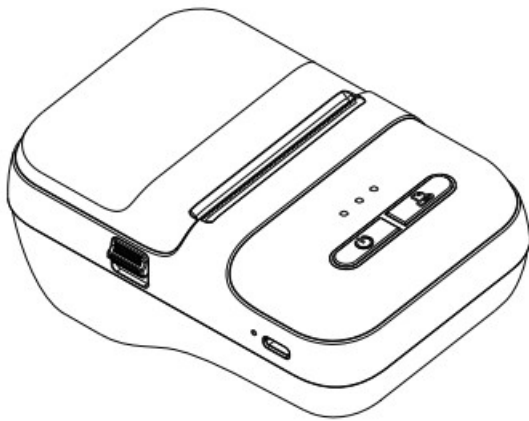

1* Printer

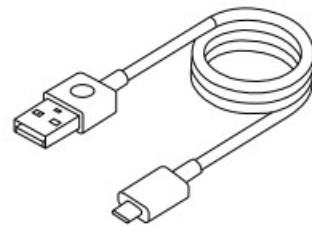

1* USB Cable

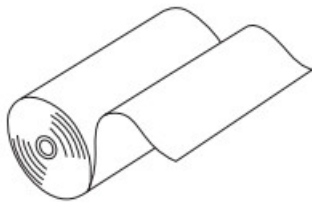

1* 40x30mm
white Labels





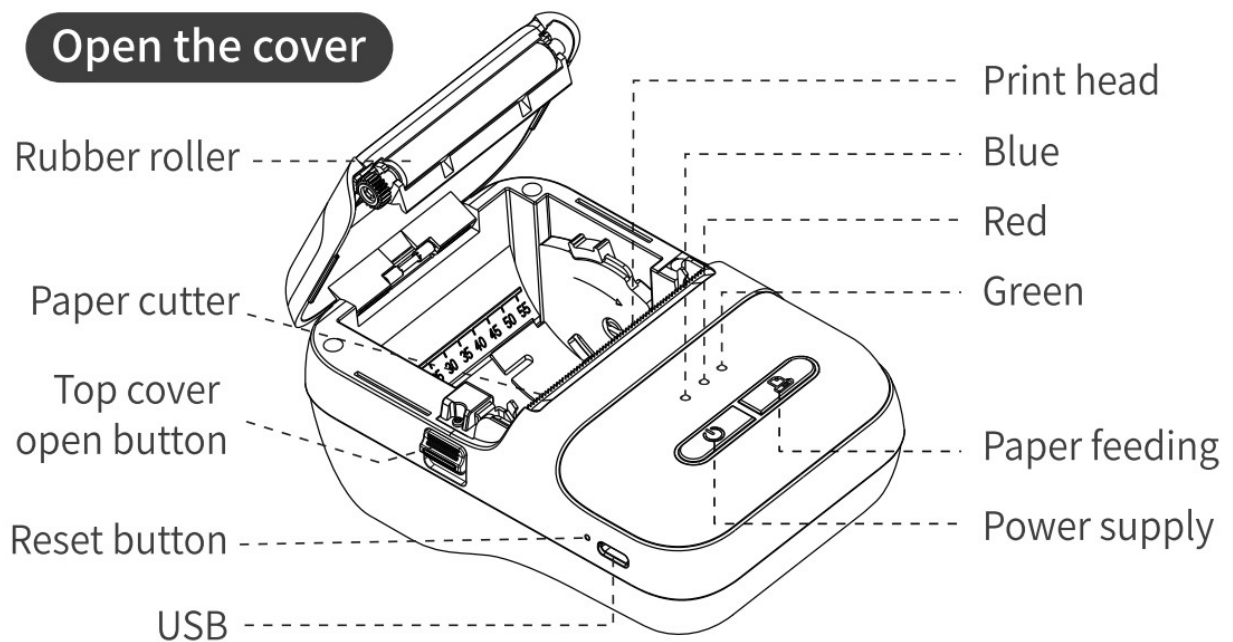

Installation Guide

Appearance Component







Function Description

Label mode

| Diagram | Button | Operating | Features |
|---|-------------------|------------------------------|--|
|  | Power switch | Press and hold for 2 seconds | Power ON/Off |
| | | Double-click | Print self-test page |
|  | Paper feed button | Click | Advance a piece of paper |
| | | Click | Pause/continue printing |
| | | Press and hold | Test (printing self-test pages for positioning accuracy) |
|   | | Press both buttons together | Switch to Label mode/Receipt mode |

Bill mode

| Diagram | Button | Operating | Features |
|---|-------------------|------------------------------|-----------------------------------|
|  | Power switch | Press and hold for 2 seconds | Power ON/Off |
| | | Double-click | Print self-test page |
|  | Paper feed button | Click | Advance paper by 10 mm |
| | | Double-Click | Advance paper until release |
|   | | Press both buttons together | Switch to Label mode/Receipt mode |

Description Of Indicator Lights

| Indicator light color | Indication status | Status description |
|-----------------------|-------------------|-----------------------|
| Blue | Slow flash | Bluetooth unconnected |
| | Normally ON | Bluetooth connected |
| | Flashing | Overheat/Low battery |
| Red | Normally ON | Charging |
| Green | Normally ON | Fully charged |

Paper Roll Loading

1. The paper should load to the left. The thermal side for printing should face down. (fig.1)
2. There's a blue spool holder bracket that should be snug against the paper. Push forward to lock the paper before printing, and push back to unlock (fig.2)
3. Pull out part of the paper roll and close the top cover, make sure both sides of the cover are closed. (Note: Face the serrations and tear the label paper down) fig.3)
4. Press and hold the power button for 25 to turn on the printer. (fig.4)

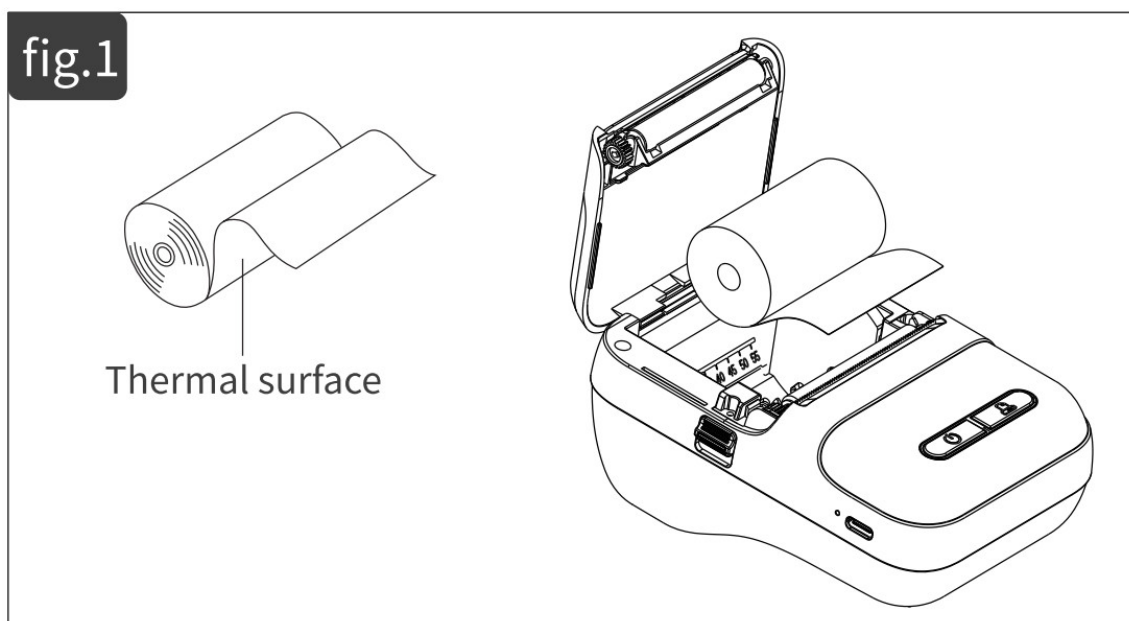

fig.2

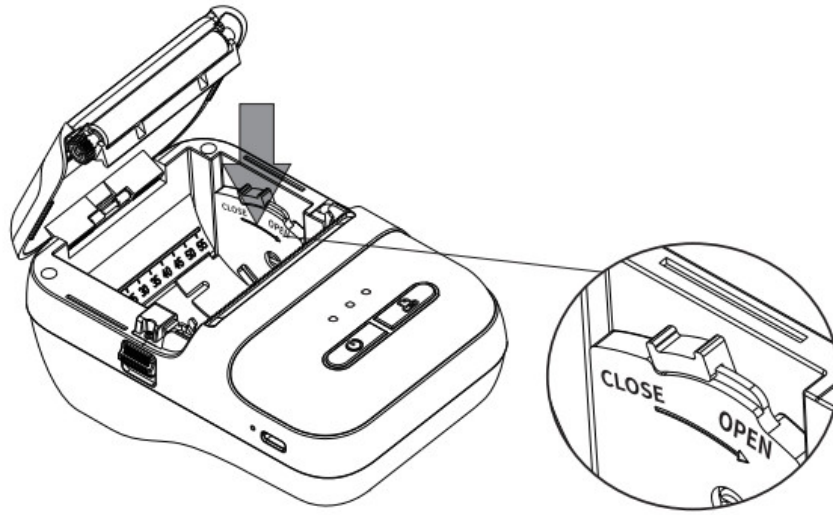

fig.3

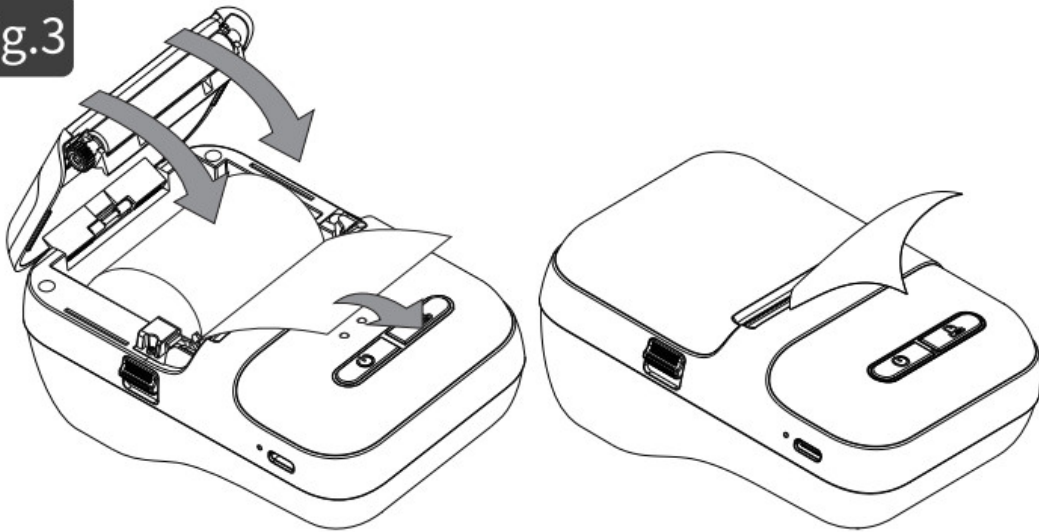
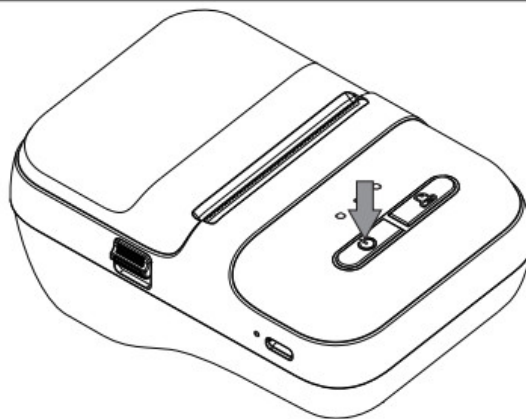

fig.4



Mobile Phone Printing Instruction

- Scan the QR code below with a mobile phone to download “Clabel trade”.
- Please follow the software instructions below to operate the software,



Clabel trade



Available on the
App Store



GET IT ON
Google Play

Download label editing app
"Clabel trade" from Google
Play Store or Apple APP Store
and install it.

! Mobile phone printing ONLY for Bluetooth version.

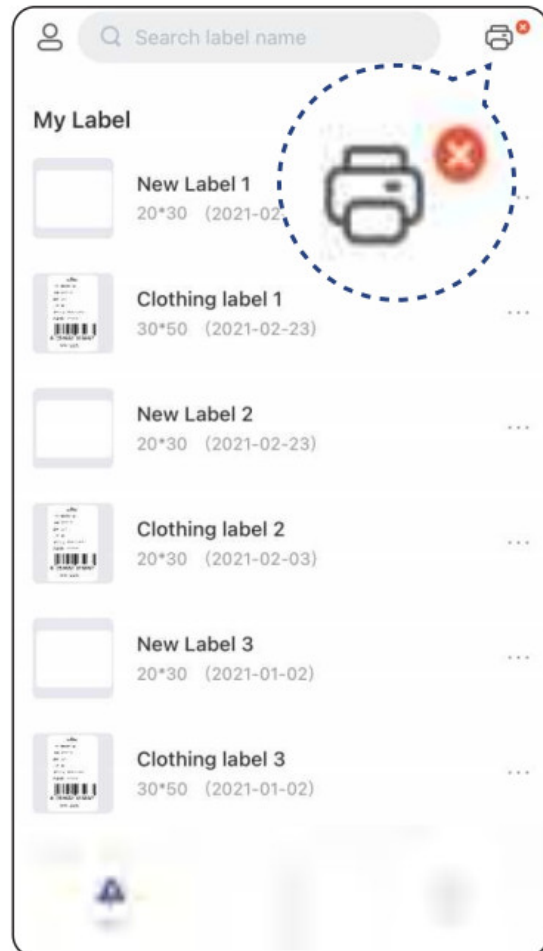

1. Enter the mobile phone system settings and set Bluetooth to on.
2. Enter the clabel trade editing software and click the "Connect" button.

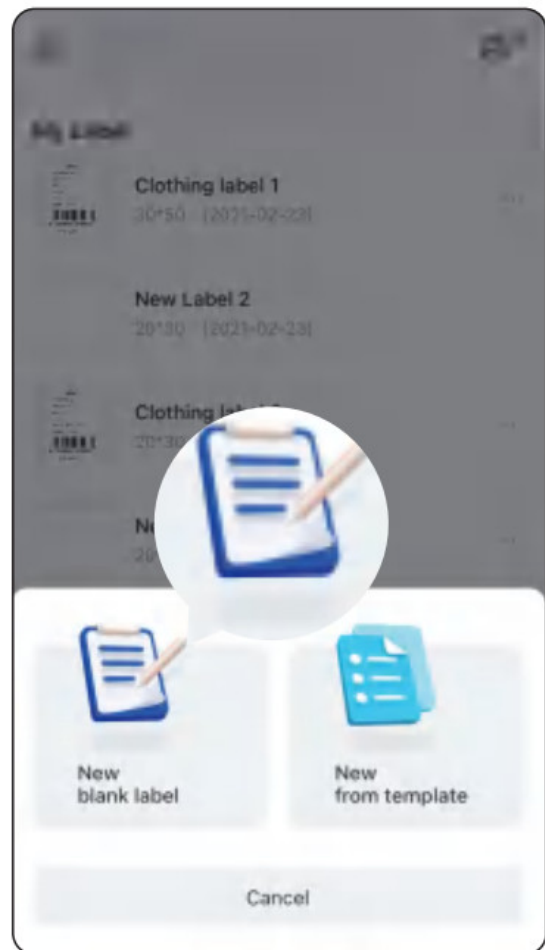

-
- New blank label**
- Label Name New template 1 >
- Label Width − 40 +
- Label Height − 10 +
-
- More settings** Click to expand ^
- Non-multiple rows of tags remain
- Number of labels +
- Add Background
- New**

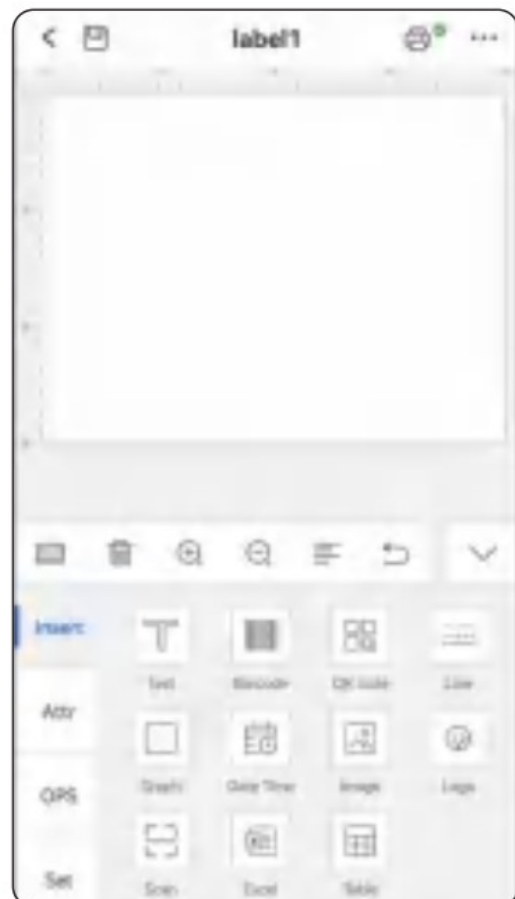

5. Enter label name, width, height click New after.
6. Editing funtion:

Text, Barcode, QR code, Line, Graph, Date ime, Image, Logo,Scan, Excel, Table.

Set:

Label name, Label sizewithheight, Label ows.

Attr:

Date type,Barcode types, Zoom way, Fontsize.

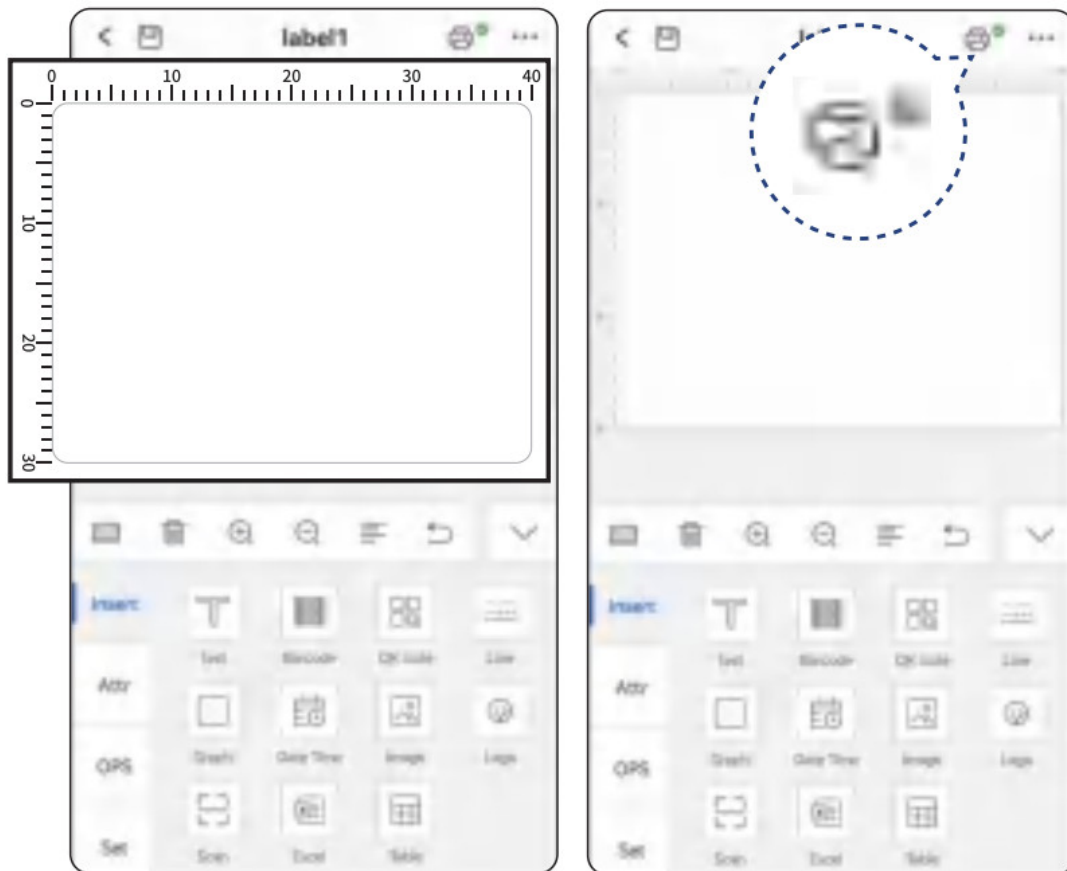

7. The area with size is the label content editing area.

8. Add the print content, and then click [icon] in the upper right corner.

Computer Printing Instruction



Windows

Visit website: <https://ga.ctaiot.com> to download “Clabel trade” and driver.



Download the driver from the above url read the instructions on driver installation/software installation on the website.

Windows Installation

1. Install the software and driver.

◆ step1

Click to open the downloaded “Clabel trade” installation package.(fig.1)

◆ step2

Clickinstallimmediately” fig.2)

◆ step3

Click o open the downloaded print driver package. (fig:3)

◆ step4

Click the printer to the computervia USB. Click o the USB printer ‘and follow the prompts o proceed to the next steps.(fig.4)



2. Open the downloaded clabel trade editing software.

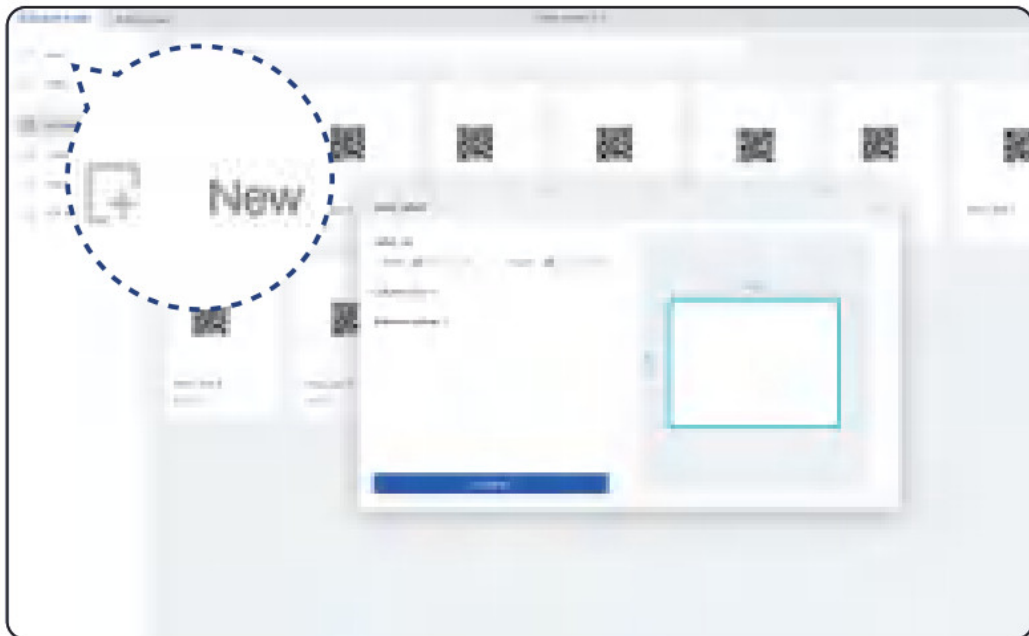

3. Click new, enter the label width and label height, and then click OK.

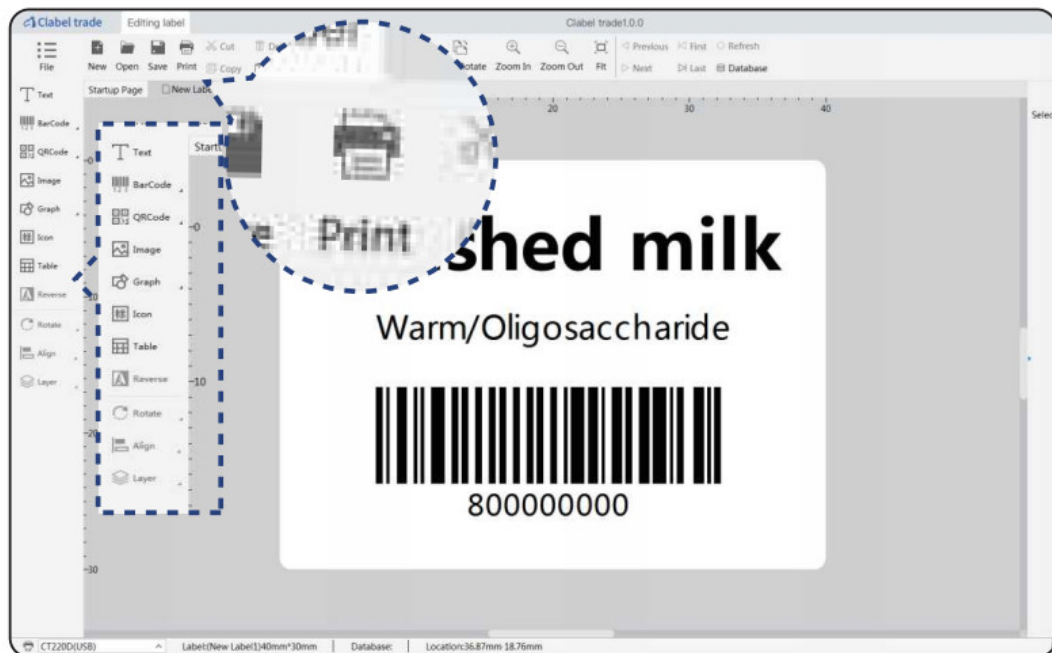

4. Add the prmled content to the editing area and click Print.

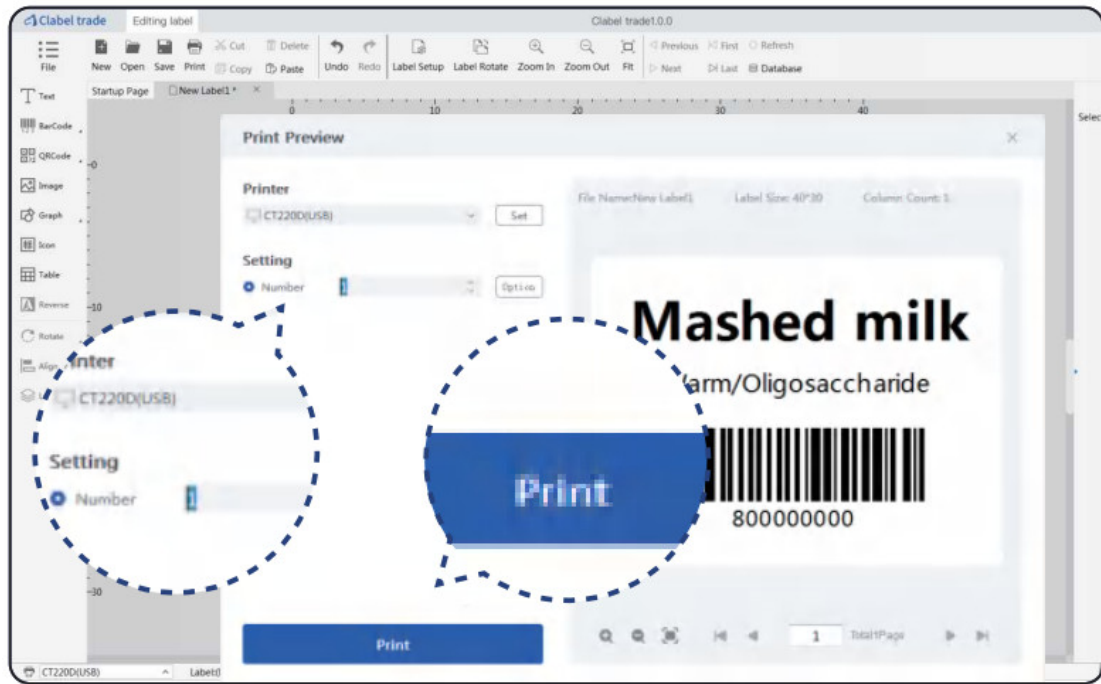

5. Select the driver, enter the print quantity, and click Print to finish printing.

Trouble Shooting

| Symptom | Cause | Correction |
|--------------------------------------|---|---|
| Bluetooth failed to connect | <ul style="list-style-type: none"> – Low version of mobile Phone. – The Bluetooth permission is not enabled. | <ul style="list-style-type: none"> – Machine only suitable for Android 6.0 or above. – Please turn on the permission for the Bluetooth and location in your smartphone. |
| Print is not centered, offset | <ul style="list-style-type: none"> – The label size is not selected correctly. – Software operation is improper. – Clearance mismatch. – Paper holder is not locked to the left. | <ul style="list-style-type: none"> – Please select the corresponding label size before printing. – It can be adjusted through the adjustment button on the APR – Click the paper feed button on the printer, and locate the paper gap. – Go to our product page to watch the video. |
| Machine does not work on computer | <ul style="list-style-type: none"> – The model is not chosen correctly. | <ul style="list-style-type: none"> – Check the printer preview page for the correct model of printer selected, the correct model will be shown with the machine model “CT220B”. |
| The print is not clear and pixelated | <ul style="list-style-type: none"> -Printing appears broken needle. -Font is not clear. | <ul style="list-style-type: none"> -Print the self-check page and check if the black line on the self-check page is normal ~Select other font in the app, and adjust the font size and bolded font. -Please adjust the print density to make the print more clearly. Choose the print content >Print>Print settings>Print density. |
| Printed content is all garbled | <ul style="list-style-type: none"> – The print mode is not adjusted properly. | <ul style="list-style-type: none"> -Check whether the printer mode is print mode, if not, switch to print mode (press and hold the power button and paper feeding button at the same time for three seconds, the printer will print a self-test page to confirm the mode) |

FCC Warning Statement

Changes or modifications not expressly approved by the party responsible for compliance could void the user's authority to operate the equipment.

NOTE: This equipment has been tested and found to comply with the limits for Class B digital device, pursuant to Part 15 of the FCC Rules. These limits are designed to provide reasonable protection against harmful interference in a residential installation. This equipment generates uses and can radiate radio frequency energy and, if not installed and used in accordance with the instructions, may cause harmful interference to radio communications. However, there is no guarantee that interference will not occur in a particular installation. If this equipment does

cause harmful interference to radio or television reception, which can be determined by turning the equipment off and on, the user is encouraged to try to correct the interference by one or more of the following measures:

- Reorient or relocate the receiving antenna.
- Increase the separation between the equipment and receiver.
- Connect the equipment into an outlet on a circuit different from that to which the receiver is connected.
- Consult the dealer or an experienced radio/TV technician for help. NOTE: This device and its antenna(s) must not be co-located or operation in conjunction with any other antenna or transmitter

RF Exposure Statement

To maintain compliance with FCC’s RF Exposure guidelines, This equipment should be installed and operated with minimum distance of 20cm the radiator your body. This device and its antennas) must not be co-located or operation in conjunction with any other antenna or transitter

Specification

| | |
|----------------------------|---|
| Print technology | Thermal printing |
| Print resolution | 203dpi |
| Media type | Continuous paper, gap paper |
| Print speed | 50mm/s |
| Label width | 20-58mm |
| Battery capacity | 2000 mAh |
| Interface | USB,Bluetooth |
| Power input | Output,DC 5V=2A |
| Machine size | 128mm*84mm*61mm |
| Machine weight | 290g |
| Barcode | CODE128,CODE39,CODE93,EAN8, EAN13,EAN128, UPC-A,UPC-E,ITF14 |
| QR code | QR CODE |
| Supported operation system | Andiod 6,iOs10, Windows XP, and Above |

Shenzhen Dudian Technology Co., Ltd
11th Floor, Building 3, COFCO Business Park, Dabao Road,
District 67, Xin'an Street, Bao'an District, Shenzhen



Documents / Resources

| | |
|---|---|
|  | CLABEL CT220B Label Maker [pdf] User Manual CT220B Label Maker, CT220B, Label Maker, Maker |
|---|---|

References

- [User Manual](#)

Manuals+.