



CISCO Table Microphone Pro Installation Guide

[Home](#) » [Cisco](#) » CISCO Table Microphone Pro Installation Guide 

Contents

- [1 CISCO Table Microphone Pro](#)
- [2 Installation Guide](#)
- [3 Microphone placement and orientation](#)
- [4 FCC](#)
- [5 Installation Guide](#)
- [6 Documents / Resources](#)
 - [6.1 References](#)
- [7 Related Posts](#)



CISCO Table Microphone Pro



Installation Guide

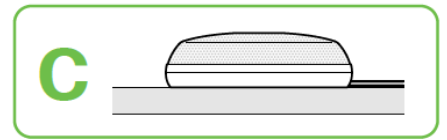
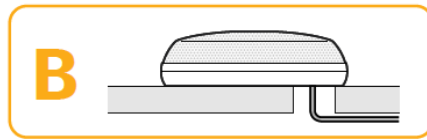
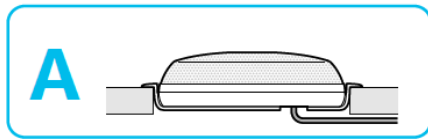

- <https://www.cisco.com/go/offices> | 78-101799-01B0
- Cisco Systems Inc., Corporate Headquarters, 170 West Tasman Dr., San Jose, CA 95134, USA.
- © 2023 Cisco Systems, Inc. All rights reserved.

Microphone placement and orientation

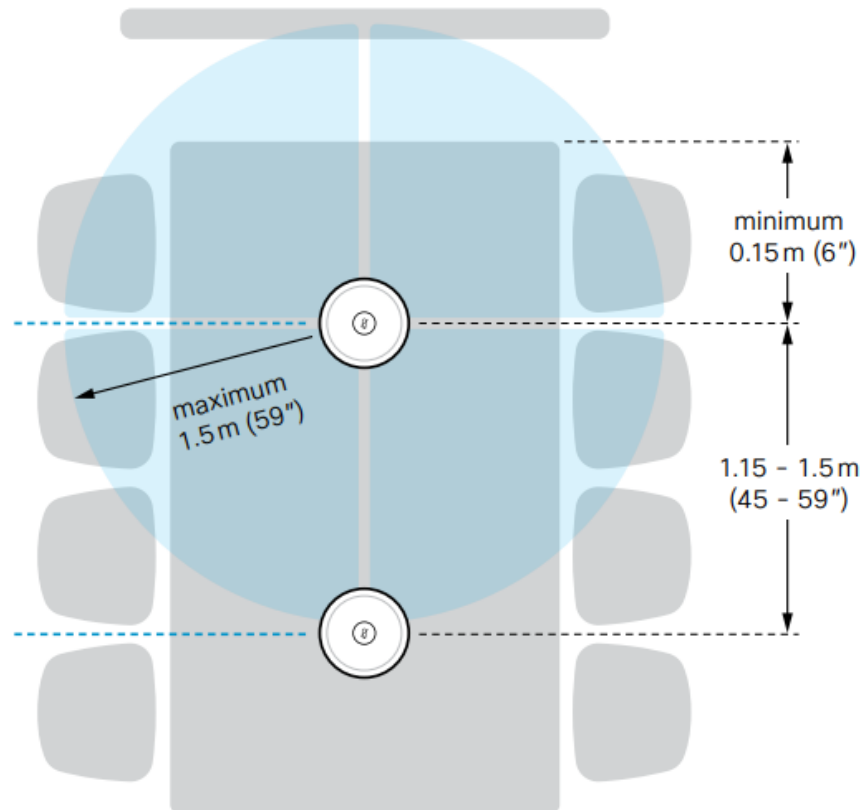

- Place microphones between people; not directly in front of a person.

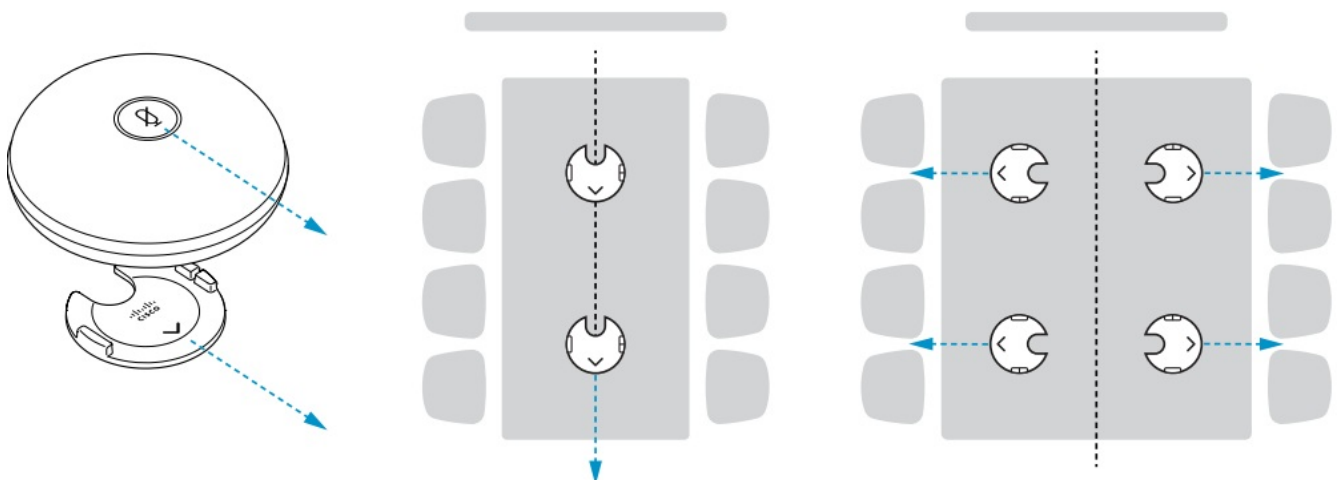

- For microphones placed along the table centerline, the arrow should point away from the screen. If not placed along the centerline, the arrow should point toward the sides where people are sitting.

Removing the cable cover

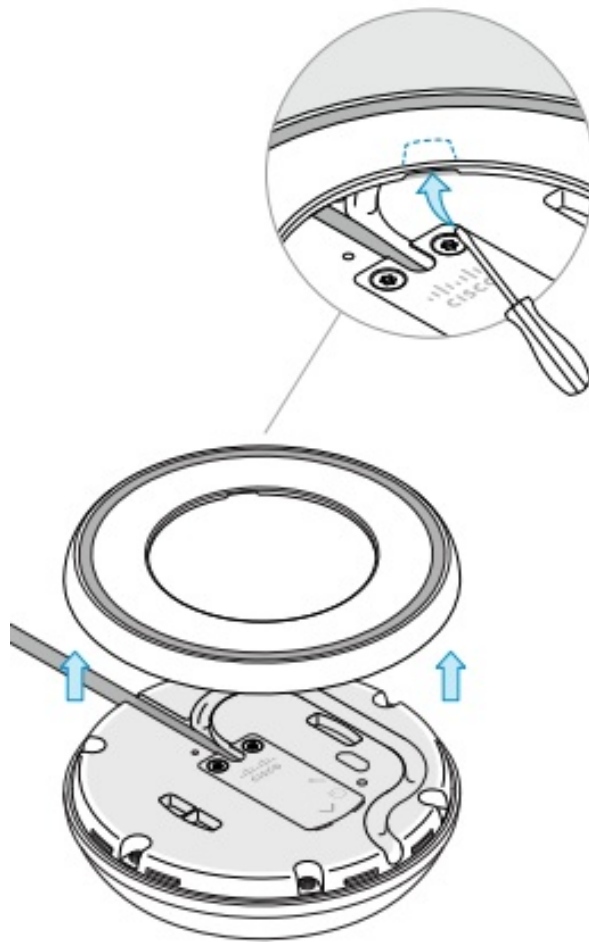

FCC

This device complies with Part 15 of the FCC Rules. Operation is subject to the following two conditions:

1. This device may not cause harmful interference, and
2. This device must accept any interference received, including interference that may cause undesired operation.

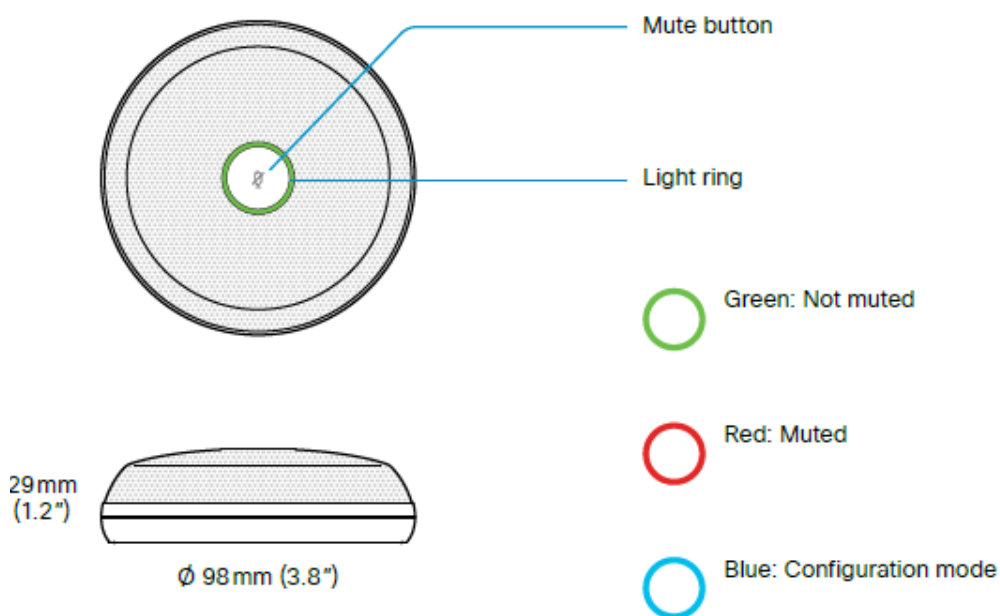

Installation Guide

A

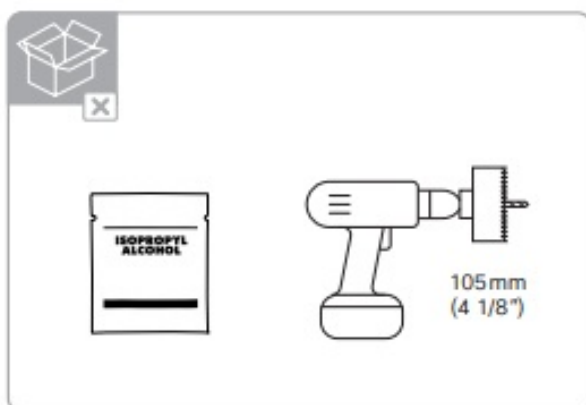
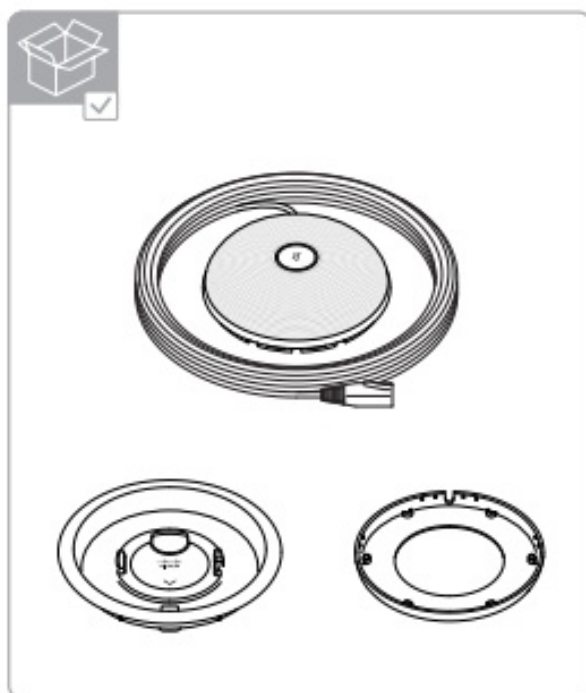
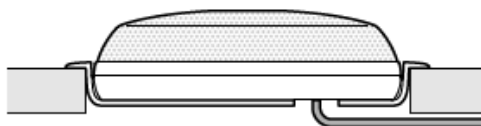

- Step 1

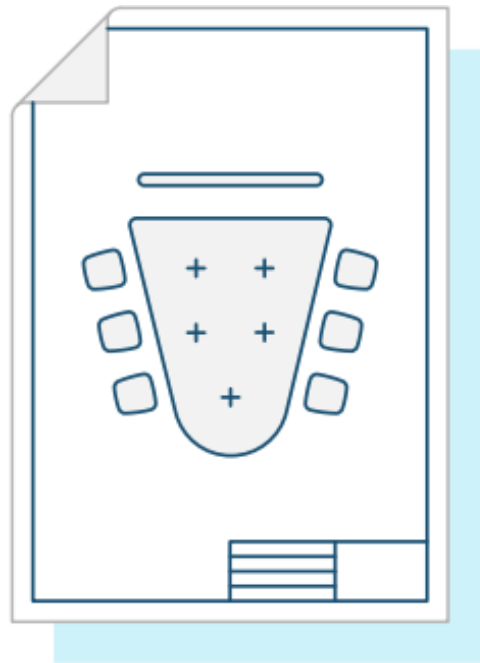

Plan where to place the microphones before you begin. Read about [Microphone placement and orientation](#) in the frame above.

- **Step 2**

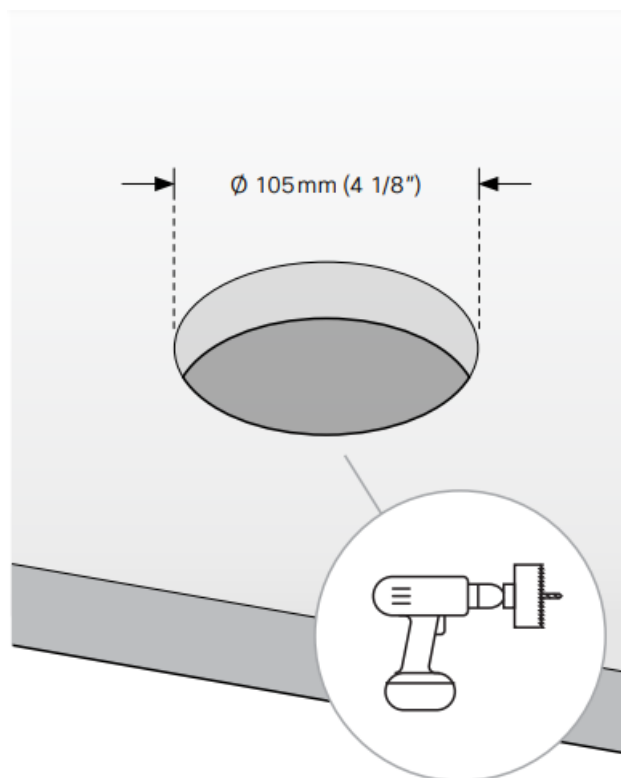

- **Step 3**

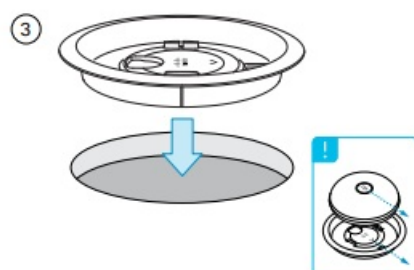

- Step 4

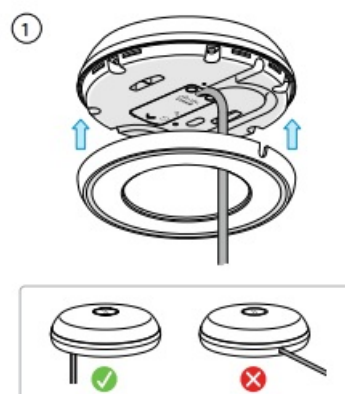

- Step 5

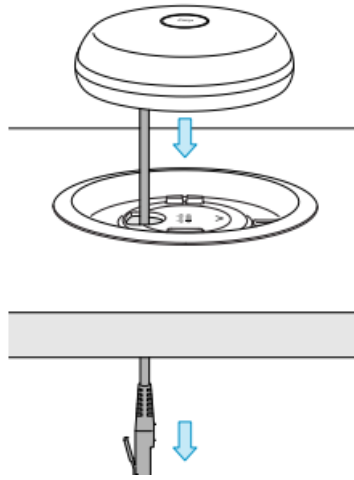

- **Step 6**

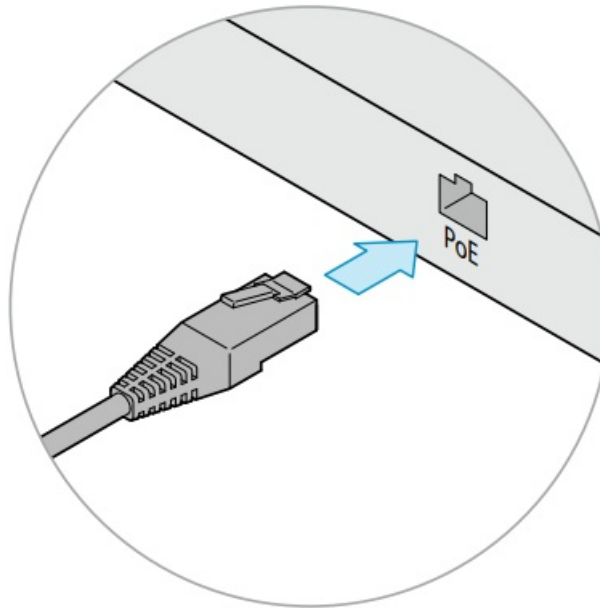

- Either connect the microphone to a PoE port on the Cisco collaboration device, or to a PoE port on a switch that is connected to the Cisco collaboration device



www.cisco.com/go/table-micro-installation

- Find more information on how to use the Table Microphone Pro with a Cisco device on this site

B

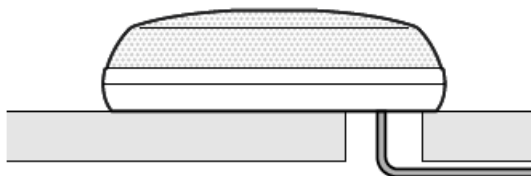

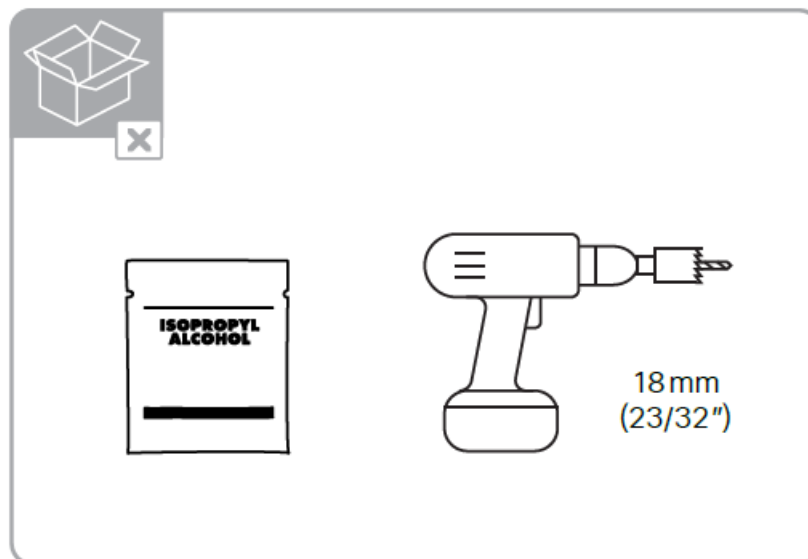
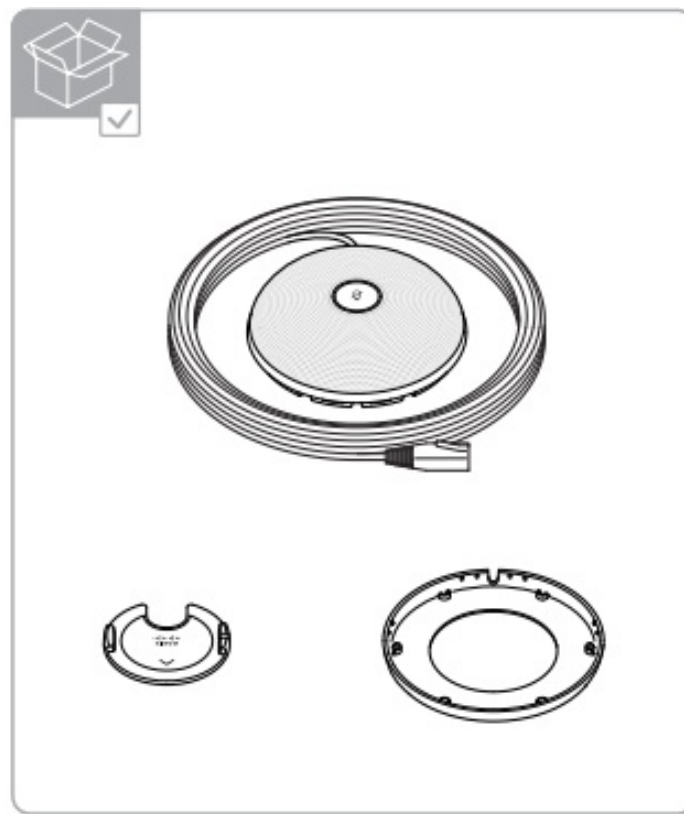

- Step 1

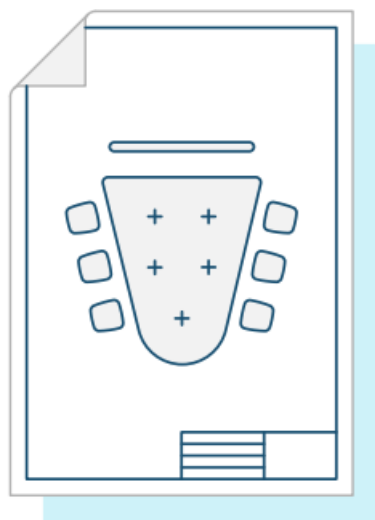

- Plan where to place the microphones before you begin. Read about Microphone placement and

orientation on the other side of the sheet

- **Step 2**

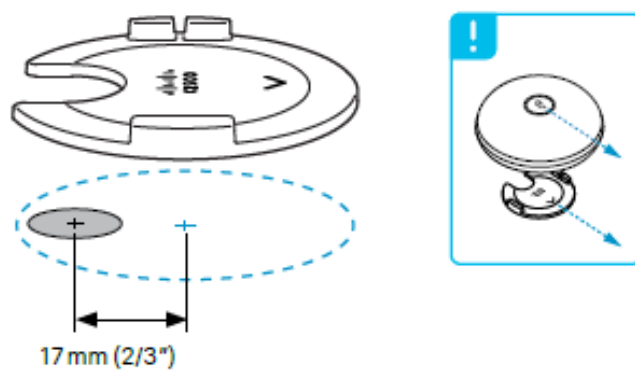
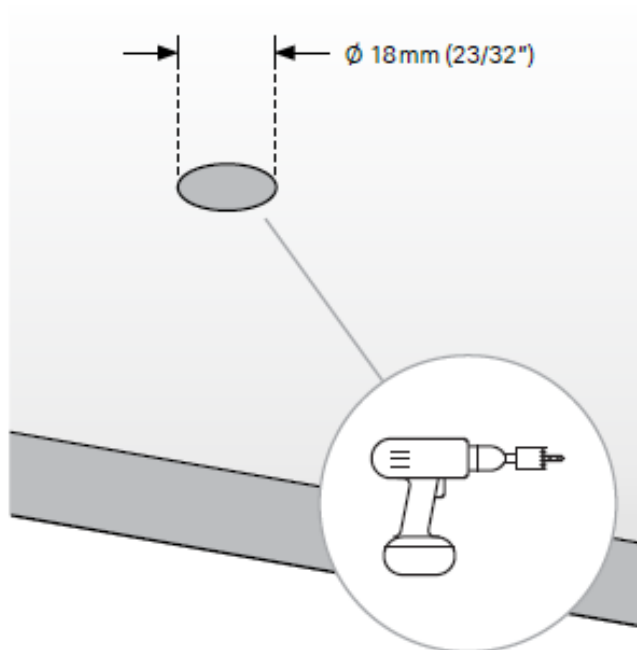

- **Step 3**



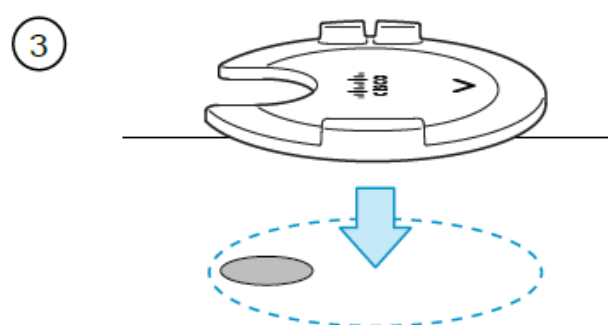
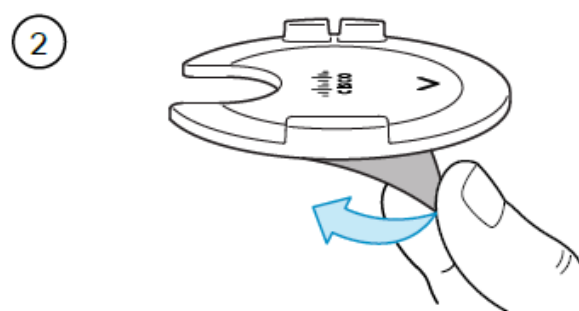

• Step 4

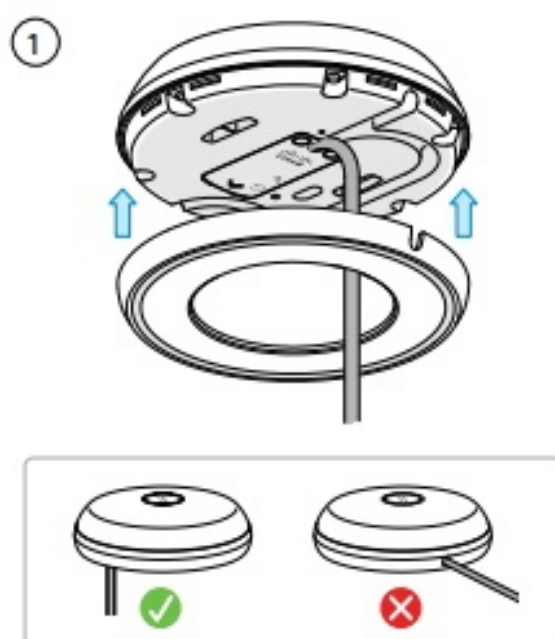

5

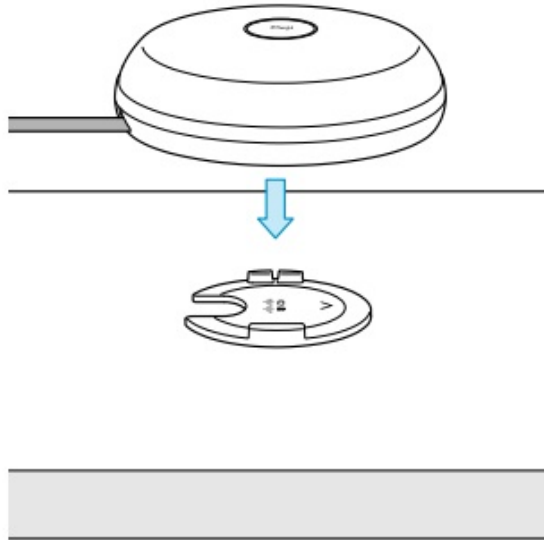

6

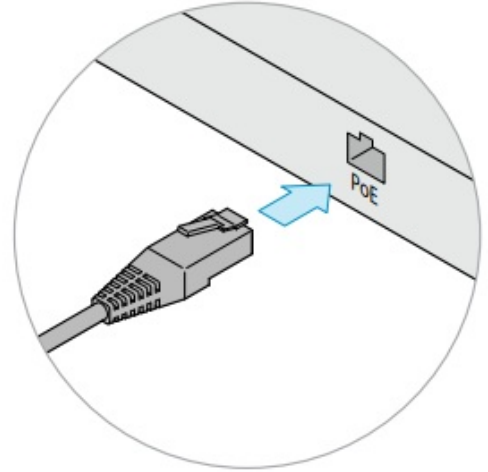

Either connect the microphone to a PoE port on the Cisco collaboration device, or to a PoE port on a switch that is connected to the Cisco collaboration device



- www.cisco.com/go/table-micro-installation
- Find more information on how to use the
- Table Microphone Pro with a Cisco device on this site.

C

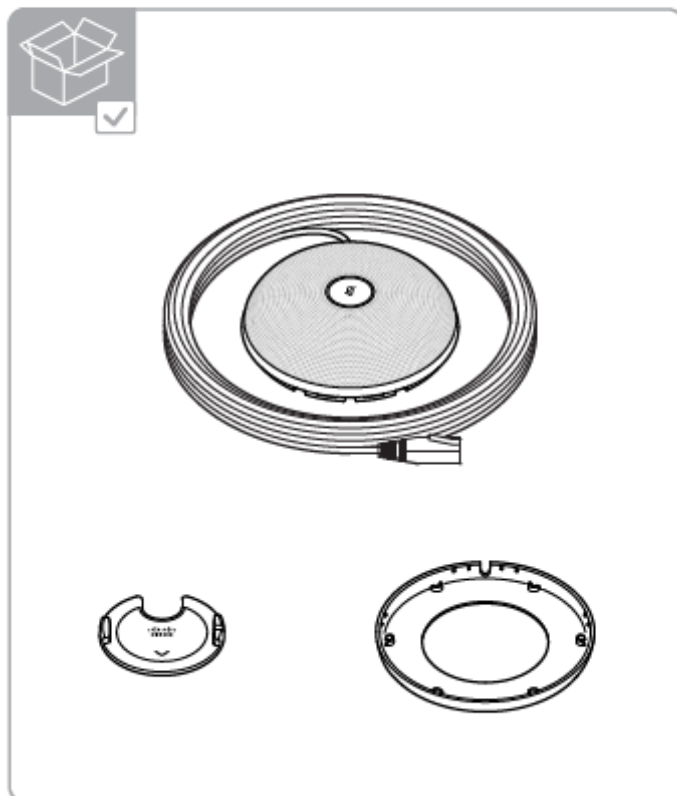
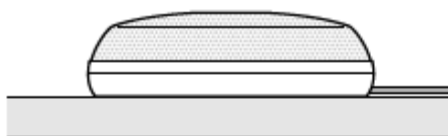

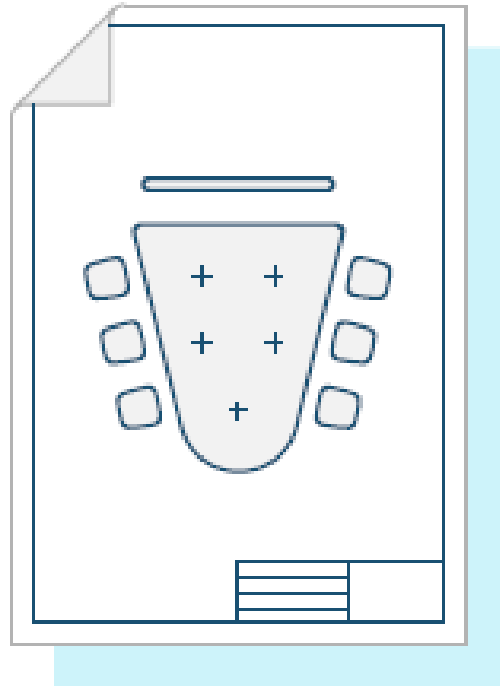

Plan where to place the microphones before you begin. Read about Microphone placement and orientation on the other side of the sheet

2



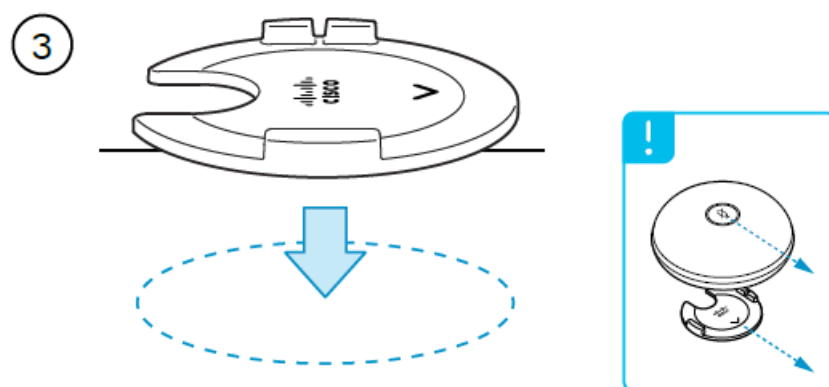
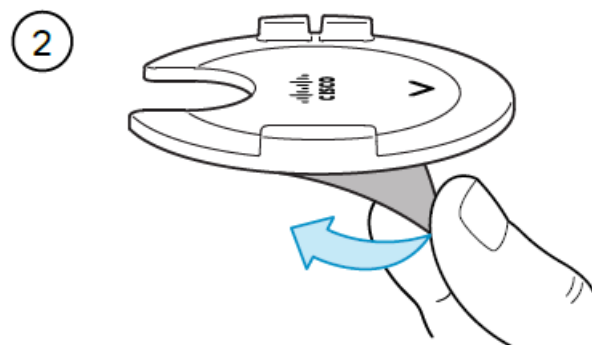

step 3

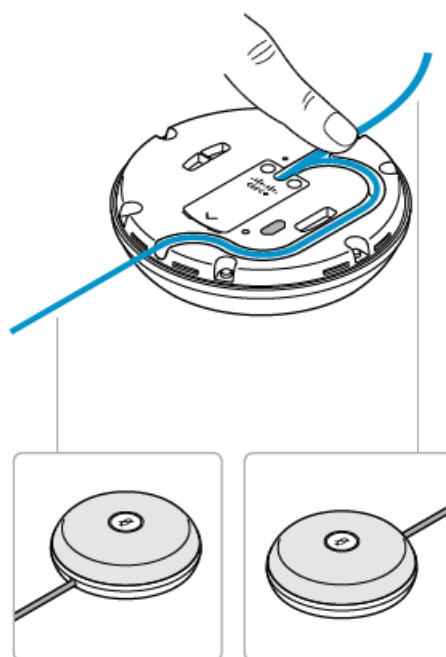

4

①

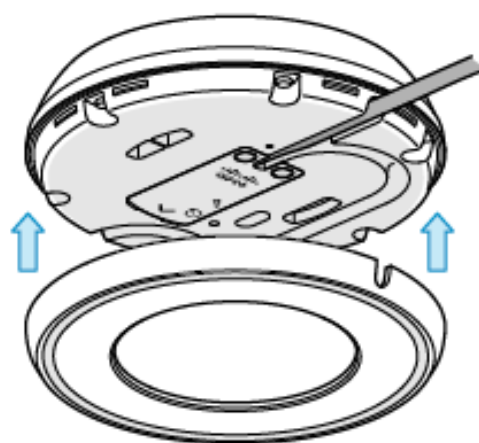

5

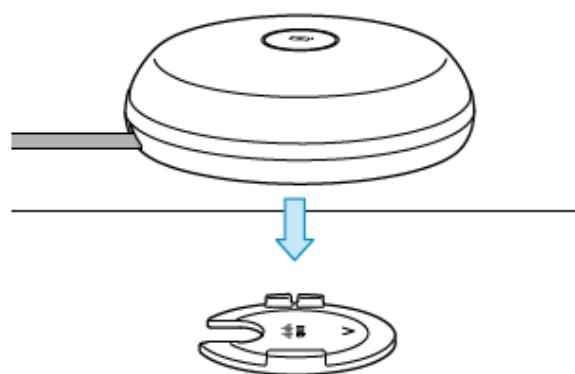

6

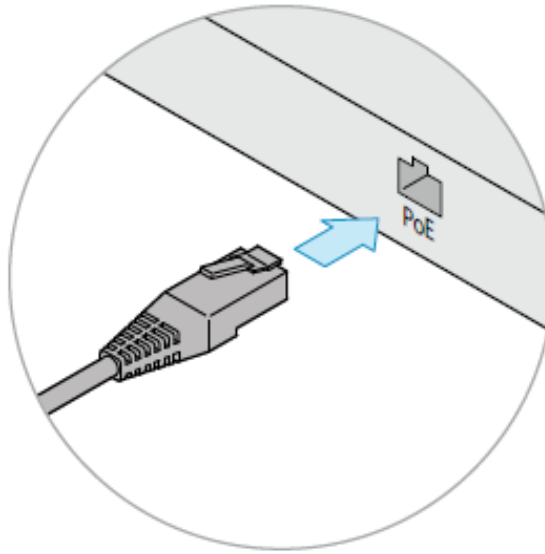

Either connect the microphone to a PoE port on the Cisco collaboration device, or to a PoE port on a switch that is connected to the Cisco collaboration device



- www.cisco.com/go/table-micro-installation
- Find more information on how to use the
- Table Microphone Pro with a Cisco device on this site.

Documents / Resources



[CISCO Table Microphone Pro](#) [pdf] Installation Guide
Table Microphone Pro, Table, Microphone Pro, Pro

References

- [Cisco Room Series - Install and Upgrade Guides - Cisco](#)
- [User Manual](#)