



## Circutor TD4 Current Transformer User Manual

[Home](#) » [Circutor](#) » Circutor TD4 Current Transformer User Manual 

# Circutor

TD4 Current Transformer  
User Manual



TD4  
TRANSFORMADOR DE CORRIENTE

# CURRENT TRANSFORMER

**Note:** Device images are for illustrative purposes only and may differ from the actual device.

## Contents

- 1 TD4 Current Transformer
- 2 DESCRIPTION
- 3 INSTALLATION
- 4 CONNECTION
- 5 Technical features
- 6 Technical service
- 7 Documents / Resources
  - 7.1 References
- 8 Related Posts

## TD4 Current Transformer

This manual is a TD4 installation guide. For further information, please download the full manual from the CIRCUTOR web site: [www.circutor.com](http://www.circutor.com)

### IMPORTANT!



The device must be disconnected from its power supply sources (power supply and measurement) before undertaking any installation, repair or handling operations on the unit's connections. Contact the after-sales service if you suspect that there is an operational fault in the device. The device has been designed for easy replacement in case of malfunction.



The manufacturer of the device is not responsible for any damage resulting from failure by the user or installer to heed the warnings and/or recommendations set out in this manual, nor for damage resulting from the use of non-original products or accessories or those made by other manufacturers.

## DESCRIPTION

The TD4 is a current transformer, which allows current measurement in electrical installations from 40 to 200 A.

## INSTALLATION

The TD4 must be installed on an electric panel or enclosure.

TD4 is designed for wall-mounting or DIN-rail assembly with an accessory for installation.

### IMPORTANT!



Take into account that when the device is connected, the terminals may be hazardous to the touch, and opening the covers or removing elements may provide access to parts that are dangerous to the touch. Do not use the device until it is fully installed



Do not expose the TD4 to aggressive or explosive environment.



For measurements on non-insulated conductors, use the appropriate, required personal protective equipment.

## CONNECTION

TD4 is a bar type current transformer, the wire which current must be measured must pass through the opening of

the transformer. Bridge the S1 and S2 secondary currents using one of the double terminals to prevent damage during installation.

The conductive cable coming from the connection must be inserted into the transformer on the P1 side and emerge on the P2 side towards the load of the installation to be measured.

Once the primary voltage is connected, wire the transformer's secondary voltage (S1 and S2) to the measuring device and disconnect the jumper installed previously.

If no device is connected to the secondary voltage, leave the jumper in place to avoid damaging the installation.

## Technical features



### Electrical features

Type	Barra pasante / Bar
Primary current	40 ... 200 A
Secondary current (In)	.../5A
Thermal short-circuit current (Ith)	60 In
Dynamic current (Idyn)	2.5 Ith
Frequency	50 – 60 Hz
Maximum operating voltage	0.72 kV ~
Insulation voltage	3 kV
Class	0.5, 1, 3
Accuracy limit	1.2 In
Continuous overload	1.2 In
Precision power	0.5 ... 7.5 VA

### Environmental features

Operating temperature	– 5 °C ... 40 °C
Storage temperature	– 40 °C ... 85 °C
Relative humidity(non-condensing)	15 ... 95 %
Maximum altitude	2000 m
Thermal class	B (130°)
Protection degree	Bornes / Terminals: IP20
Safety factor	FS 5

### Mechanical features

Terminals			
S1, S2	4 mm 2	$\leq 0.6 \text{ Nm}$	Pozidriv Z1
Max. conductor diameter	21 mm		
Dimensions	50 x 80 x 48 mm		
Weight	255 g.		
Enclosure	UL94 Plástico V0 autoextinguible UL94 Self-extinguishing V0 plastic		

### Standard

UNE-EN 61869-1, UNE-EN 61869-2

### Dimensions

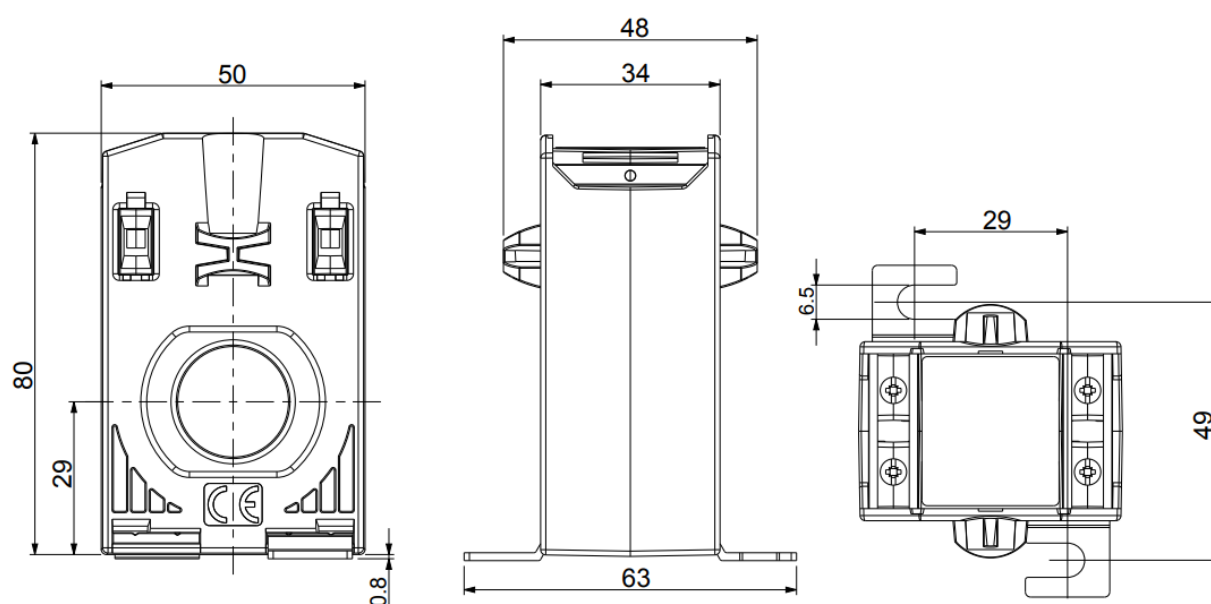

### Connections

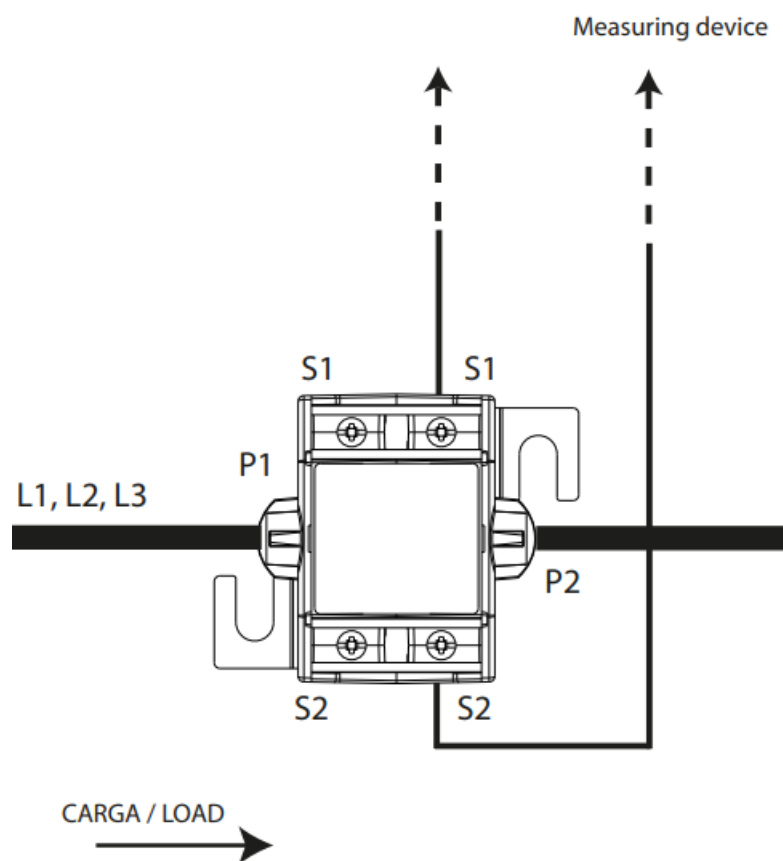

#### Terminal connections designations

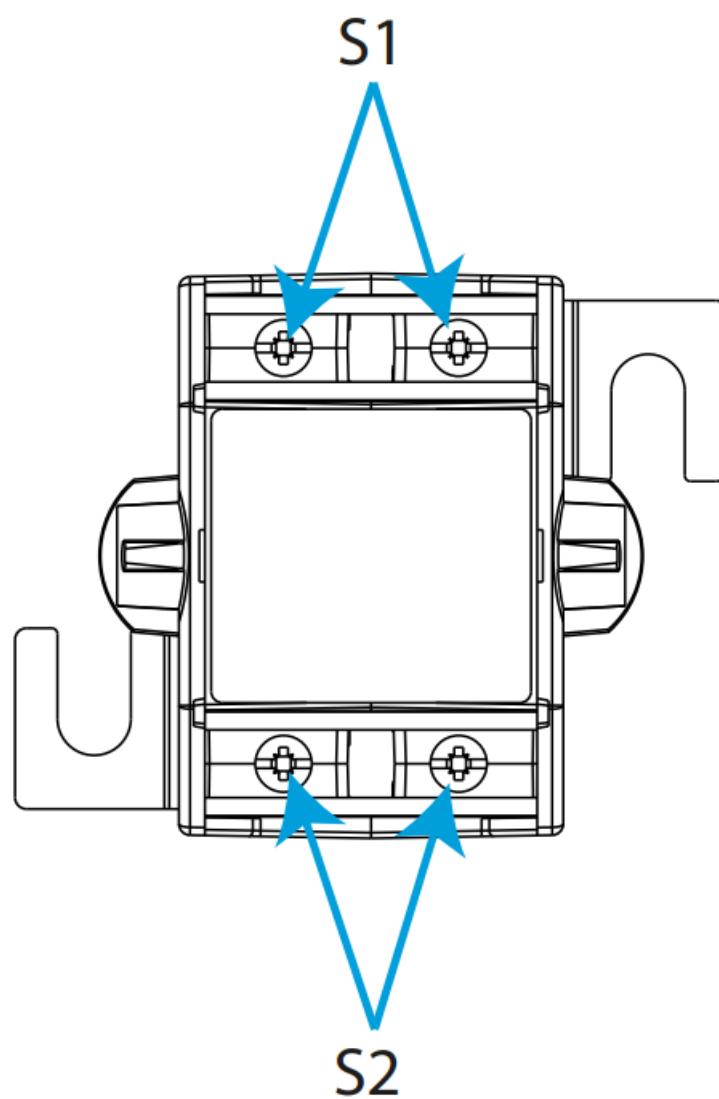

S1	Secondary of the transformer.
S2	Secondary of the transformer.

### Rated current

I (A)	CL 1	CL 3	I (A)	CL 0.5	CL 1	CL 3
40/5	–	1.25 VA	100/5	1.50 VA	2.50 VA	5.00 VA
50/5	1.00 VA	1.50 VA	125/5	2.50 VA	3.75 VA	5.00 VA
60/5	1.25 VA	2.50 VA	150/5	3.75 VA	5.00 VA	5.00 VA
75/5	1.50 VA	3.75 VA	200/5	5.00 VA	7.50 VA	7.50 VA

### Technical service

# Circutor

CIRCUTOR SAT: 902 449 459 (SPAIN) / (+34) 937 452 919 (out of Spain)

Vial Sant Jordi, s/n

08232 – Viladecavalls (Barcelona)

Tel: (+34) 937 452 900 – Fax: (+34) 937 452 914

e-mail : [sat@circutor.com](mailto:sat@circutor.com)

M281A01-44-22A

### Documents / Resources

	<p><a href="#">Circutor TD4 Current Transformer</a> [pdf] User Manual</p> <p>TD4 Current Transformer, TD4, TD4 Transformer, Current Transformer, Transformer</p>
---	--

### References

-  [Productos y soluciones integrales para la eficiencia energética eléctrica](#)