



CINCOM CM-080A-BU Compression Leg Massager Operating Instructions

[Home](#) » [CINCOM](#) » CINCOM CM-080A-BU Compression Leg Massager Operating Instructions 

Contents

- [1 CINCOM CM-080A-BU Compression Leg Massager](#)
- [2 Safety Precautions](#)
- [3 TROUBLESHOOTING FAQ'S](#)
- [4 PRODUCT DESCRIPTION](#)
- [5 OPERATING INSTRUCTIONS](#)
- [6 MAINTENANCE](#)
- [7 TROUBLESHOOTING](#)
- [8 SPECIFICATIONS](#)
- [9 PACKAGE INCLUDES](#)
- [10 FREQUENTLY ASKED QUESTIONS](#)
- [11 VIDEO – PRODUCT OVERVIEW](#)
- [12 References](#)
- [13 Related Posts](#)



CINCOM CM-080A-BU Compression Leg Massager



Thanks for purchasing our product Please read the instructions carefully before use and keep it well for further reference.

Safety Precautions

Warnings

1. Those with any of the following conditions or persons who are receiving medical treatment should consult the doctor before using the product:
 1. Using pacemaker or other medical devices which are susceptible to electrical interference;
 2. Suffering from malignant tumors;
 3. Suffering from cardiac diseases;
 4. Having serious peripheral neuropathy dysfunction or sensory disturbance caused by diabetes;
 5. Being unsuitable to do the massage because of traumas on the body;
2. Keep it out of the reach of infants, children, and people without the ability to use it independently.
3. Don't use another power adapter but the original one.
4. Don't scratch, damage, process, excessively band, pull or twist the power cord of power adapter. Otherwise, it may cause fire or electric shock.
5. It is not allowed to use when the power adapter dysfunctions or the plug is loose.
6. Don't plug or unplug the power adapter with wet hands.
7. Don't put the controller In the quilt or use the machine In high temperature condition.
8. It is forbidden to remodel, disassemble or repair the product without permission.



Cautions

1. Stop using it immediately if you feel unwell. Don't use it again before consulting the doctor.
2. Don't use It In the bathroom or other humid places.
3. Unplug the power adapter from the socket before you clean and maintain It
4. Unplug the power adapter when you are not using il
5. Don't walk around when you are using this item or wearing the wraps.

TROUBLESHOOTING FAQ'S

How does this product massage?

- There are 3 air chambers in each wrap, they will be inflated and deflated to simulate kneading and stroking of tissues like human hands. It can relax our muscles, increase circulation and relieve pain.

How many massage modes, and what's the difference?

- There are 3 massage modes.
 - **Mode1:** Sequence Mode Foot & Lower Calf chamber compress and then release → Upper Calf & Thigh chamber compress and then release. There will be a brief rest period and then the cycle will begin again. This will repeat until the session time runs out.

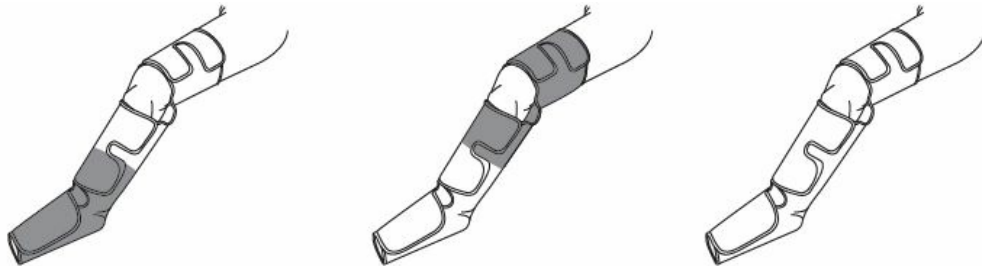

- **Mode 2:** Circulation Mode
Foot & Lower Calf chamber compress and hold pressure → Upper Calf & Thigh chamber compress and hold pressure → all 4 chambers release at the same time. There will be a brief rest period and then the cycle will begin again. This will repeat until the session time runs out.

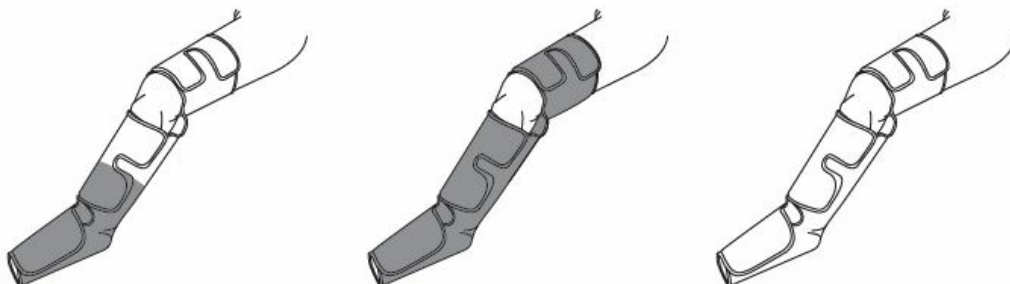

- **Mode 3:** Combination Mode
 - Mode 1 and mode 2 runs alternately in this mode until the session time runs out.

What should I do if I feel the massage strength is too light or too tight?

- There are 3 levels of massage strength selectable via the controller, please select the intensity which is fit for you. You can also adjust the strength by changing the tightness of Velcro on the wraps.

How long should I use it?

- It is recommended to use it once or twice a day, no more than 30 minutes at a time. But you can use it longer if you feel too tired and want it massage longer to work on the soreness.

Why does not it work when I press the power button?

- Please ensure both 2 air hoses are inserted into the controller, otherwise, it will not work.

Why does the controller get hot?

- As we suggested, you can use it 20 minutes per time normally. If it keeps working too long, the controller will get hot, it's a normal phenomenon.

Why does the controller make sound?

- The sound comes from the working air pump in the controller, providing air continuously to the airbags in the wraps, it's normal phenomenon.

What should I do if I feel the temperature is too hot?

- Please use the lower temperature or turn it off. We suggest you wear trousers if necessary.

What should I do if I have thicker legs?

- For bigger legs, please use the extensions included to expand the size of wraps.

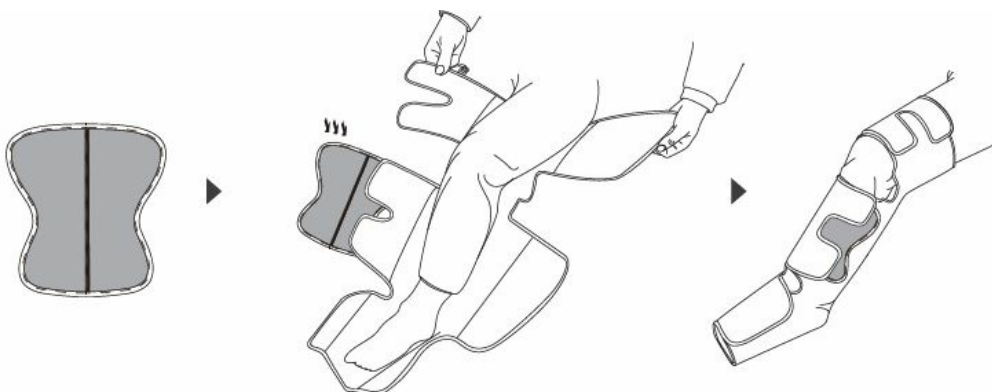

PRODUCT DESCRIPTION

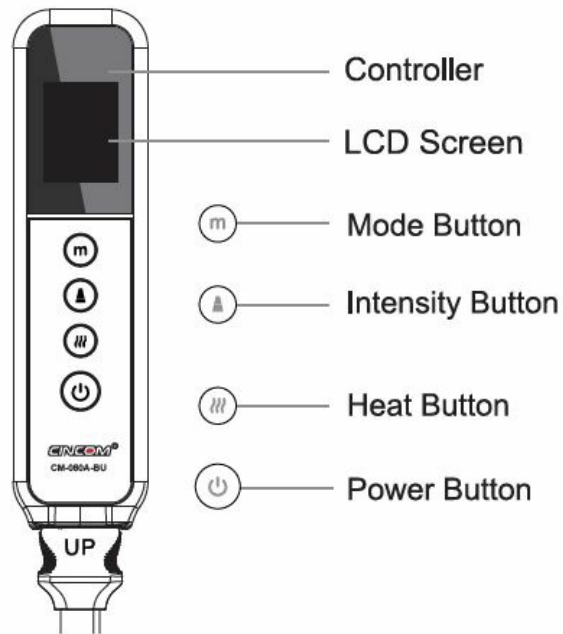

Display Screen display current setting.

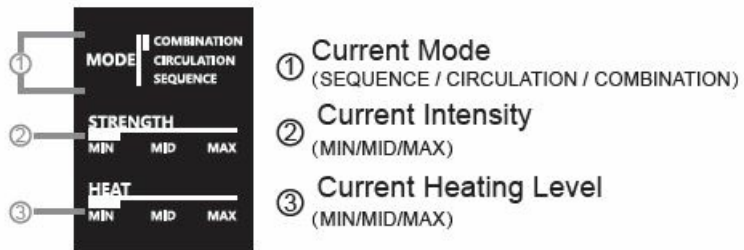

Air Hoses Connect Port

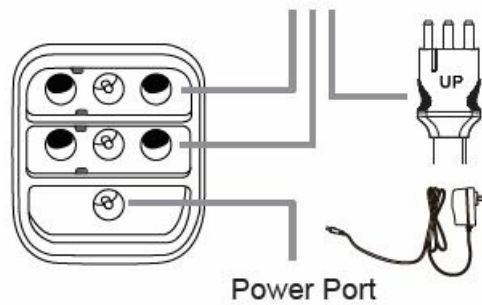

Massage Sleeve

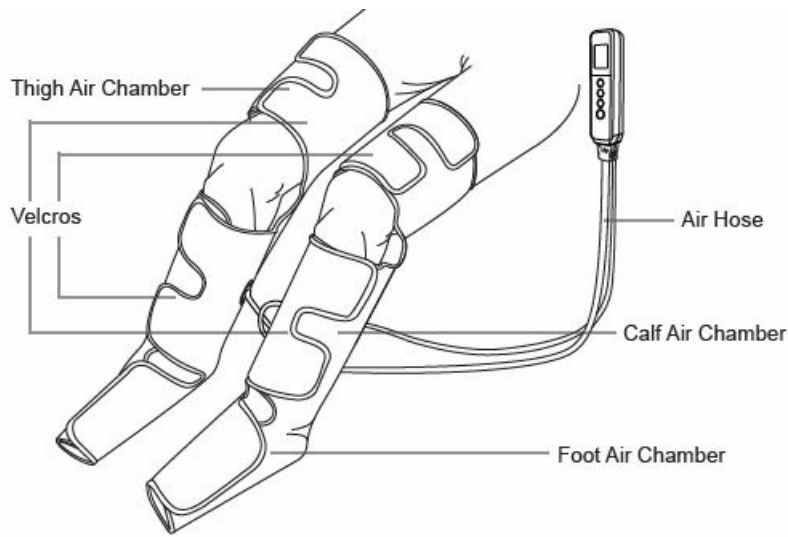

OPERATING INSTRUCTIONS



Please read safety precautions carefully before using the product. In order to get better massage, please use it according to the instruction

1. Check the tags for Left / Right Leg and the central line, then wear the wraps properly.



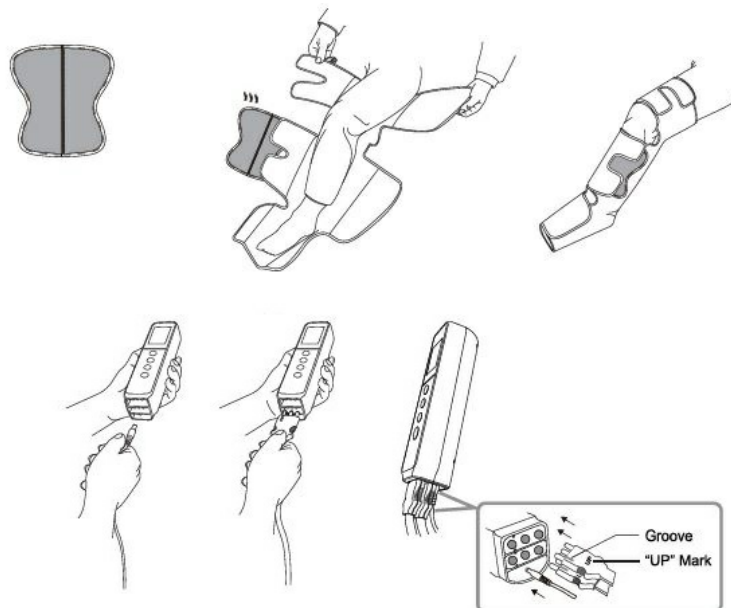

2. Fix the velcros, adjust the position and tightness, don't wrap too tight. Use the extensions for bigger calves, and cut the stitches for bigger feet.(see details in FAQs A9)
3. Insert BOTH two air hoses into the controller correctly and completely, then connect well the adapter to the outlet and controller.

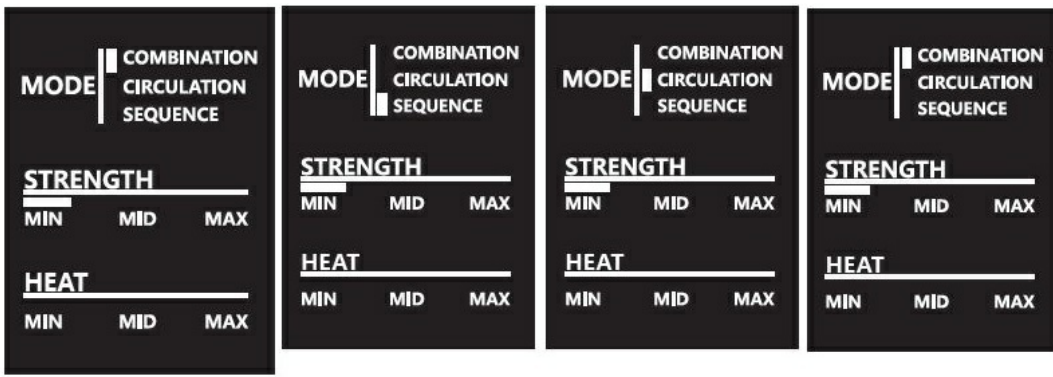

4. Press the Power button  to start. It will begin with Mode 1 / Min air pressure intensity / Heat off by default.
5. Press Mode button  to change the massage mode. 3 modes available, see the difference in FAQs A2.



6. Press Intensity button  to adjust air pressure intensity. 3 intensities available.
 - We suggest you start with the minimum level, gradually increase after you get used to it.
7. Press Heat button  to turn on the heat function, 3 levels available. The Heat can be turned on/off anytime.

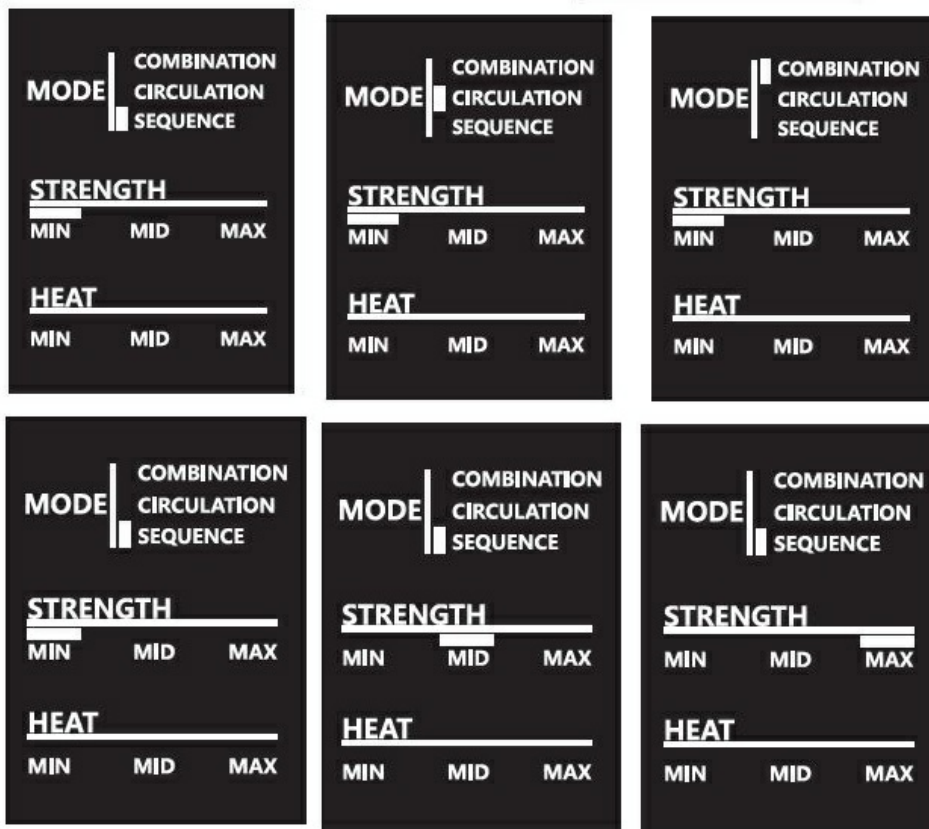

Note: The device will automatically shut off after 20 mins operation, if you wanna enjoy more or end the massage earlier, press the Power button to turn It on/ off.

Notes After Use

- unplug the power adapter from the socket

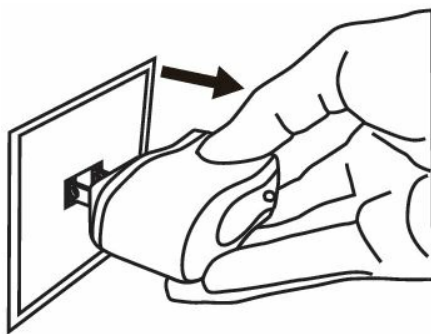

- Pull out the power adapter and air hoses from the bottom of the controller.
- Take off the wraps, fold them into the storage bag or box.

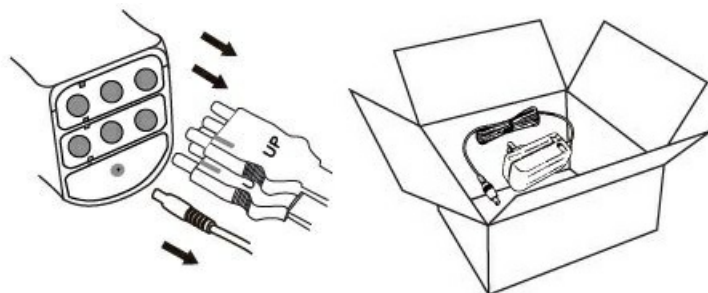

MAINTENANCE

Make sure to cut off the power before you clean the device

1. If dirty, please wipe with a soft cloth moistened by soap solution.
2. Don't use gasoline, alcohol, diluent, and other irritating liquid to wipe the machine, in case it causes malfunction or the components are damaged or discolored.
3. Do not hold the device under running water, do not submerge it in water or other liquids.
4. Don't allow foreign matter to enter the hoses.
5. Toothpicks can be used to remove the hair or chippings attached to the Velcros.
6. Don't disassemble the machine by yourself.

STORAGE

- Keep it out of the reach of children.
- Don't place it in high temperature and humidity conditions.
- Avoid direct sunlight
- Avoid needles puncturing the airbags.
- Don't place heavy stuff on it

DISPOSAL

- Please adhere to the local regulations when you dispose of the waste

TROUBLESHOOTING

Problems	Possible Causes	Solutions
Doesn't work and screen is off	<ol style="list-style-type: none"> 1.Power is not turned on. 2.Adapter is not securely connected. 3.Faulty wall outlet. 	<ol style="list-style-type: none"> 1.Press the power button to turn the control unit on. 2.Make sure the power adapter is connected well to the control unit and the wall outlet. 3.Check if the wall outlet works.
The screen is on but the sleeves doesn't work	<ol style="list-style-type: none"> 1.Only connect one of the sleeves with the air hose. 2.Air hoses are not securely connected. 3.The sleeves have been damaged. 	<ol style="list-style-type: none"> 1.It works only when 2 sleeves are connected to the air hose. 2. Please check if the air hoses are inserted correctly and completely to the control unit and the junction box (pay attention to the 'UP' mark). 3.Check if the sleeves have an air leak, if there is, please contact our customer service at service@cincomhealth.com
Break off during operation or stop pumping	<ol style="list-style-type: none"> 1. Air hoses are not securely connected. 2.The power adapter falls off. 3.The treatment session time is up. 	<ol style="list-style-type: none"> 1.Please check if the air hoses are inserted correctly and completely to the control unit and the junction box(pay attention to the 'UP' mark). 2.Make sure the power adapter is connected well to the control unit and the wall outlet. 3. The device will shut off automatically after 20 mins operation, press the power button to restart it if needed;

SPECIFICATIONS

Product name	Air Compression Leg Massager With Heat
Model NO.	CM-080A-BU
Rated Voltage	AC 100~240V 50/60Hz , DC12V/3A
Rated Power	36W
Weight	2.2kg / 4.8 lbs
Pressure Intensity	3 intensities: Min、 Mid、 Max
Compression Mode	3 Modes ; Sequence、 Circulation、 Combination
Timer	20 Minutes Auto Off
Heating Levels	Min、 Mid、 Max
Heating Temperature	Test at ambient temperature 25°C , High≤43°C; Low≤37°C Test at ambient temperature 40°C , High≤50°C; Low≤45°C
Operating Conditions	Temperature: +5°C to 40°C ; Humidity : 5% to 90% non-condensing; Atmospheric Pressure : 75 kPa to 106 kPa
Storage Conditions	Temperature: -20°C to 55°C ; Humidity : 5% to 90% non-condensing; Atmospheric Pressure : 75 kPa to 106 kPa; Keep dry and avoid direct sunlight.

PACKAGE INCLUDES

- Massage Warps (with air hose)
- Handheld Controller
- User Manual

- Extensions
- Power Adapter/ DC12V3A
- Portable Storage Bag

WARRANTY

CINCOM has made every effort to ensure your product is as strong and durable as possible. However, it is still possible that some mishaps could happen and we take full responsibility. If the air compression, the battery or the programs start to malfunction, please contact us at service@cincomhealth.com.

Note: Please include the order number along with the problems you meet in the mail, videos & pictures are welcomed for better and faster service.

FREQUENTLY ASKED QUESTIONS

What is the intended use of the CINCOM CM-080A-BU Compression Leg Massager?

The massager is intended for use on the thigh.

What is the power source of the CINCOM CM-080A-BU Leg Massager?

The power source is corded electric.

What material is used for the CINCOM CM-080A-BU Leg Massager?

The material used is Nylon.

How much does the CINCOM CM-080A-BU Leg Massager weigh?

The item weight is 5.2 pounds.

What is the brand of the CINCOM CM-080A-BU Compression Leg Massager?

The brand is CINCOM.

What is the model number of the CINCOM CM-080A-BU Leg Massager?

The model number is CM-080A-BU.

What type of heating function does the CINCOM CM-080A-BU Leg Massager have?

It has a full leg heating function offering a 360° wraparound heated compression experience.

What areas of the leg does the CINCOM CM-080A-BU Massager cover with air compression?

The air compression covers the foot, calf, and thigh with 15 massage strokes.

How many modes and intensities are available on the CINCOM CM-080A-BU Leg Massager?

There are 3 modes, 3 intensities, and 3 heat levels available.

What are the three modes of the CINCOM CM-080A-BU Compression Leg Massager?

The modes are SEQUENCE, CIRCULATION, and COMBINATION.

What is the unique three-way heating design in the CINCOM CM-080A-BU Leg Massager?

It offers optionally closed heating for feet, calves, and thighs.

Is the wrap of the CINCOM CM-080A-BU Leg Massager adjustable?

Yes, the wrap is adjustable, and it comes with 2 free extensions.

What is the maximum size the leg massager can accommodate with the extensions?

The leg massager can accommodate up to 36.5 inches for the thighs and 28.5 inches for the calves.

How is the controller of the CINCOM CM-080A-BU Leg Massager upgraded?

The controller has a clear font for easier reading, a modern look, and provides comprehensive control over the product.

Who can benefit from using the CINCOM CM-080A-BU Compression Leg Massager?

It is suitable for post-operative restorers, long-term bed-bound individuals, sedentary workers, and athletes. It can be used at home or in the office.

VIDEO – PRODUCT OVERVIEW

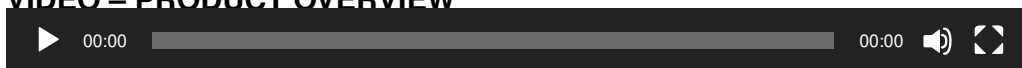

[Download the PDF link to CINCOM CM-080A-BU Compression Leg Massager Operating Instructions](#)
[Compression-Leg-Massager-Operating-Instructions.mp4](#)

References

- [User Manual](#)

[Manuals+](#), [Privacy Policy](#)