

CHWARES CH006 Wireless Chime

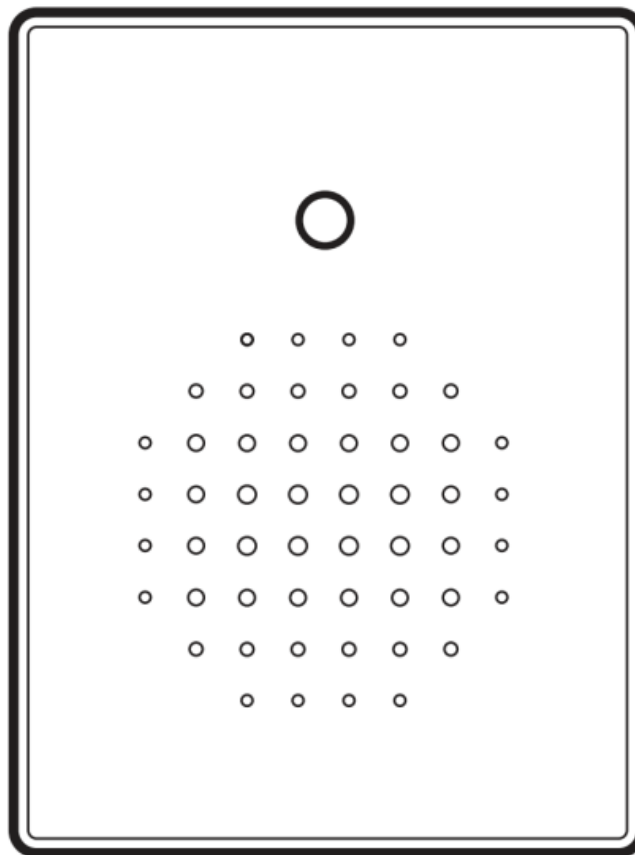

IMPORTANT SAFETY INSTRUCTIONS AND INSTALLATION GUIDE

READ BEFORE INSTALLATION.

SAVE THESE INSTRUCTIONS.

Contents [[hide](#)]

[1 Safety Information](#)

[2 Limited Warranty](#)

[3 Pre-Installation](#)

[4 Description](#)

[5 Setup](#)

[6 Documents / Resources](#)

[6.1 References](#)

Safety Information

SAVE THESE INSTRUCTIONS

IMPORTANT SAFEGUARDS:

ALWAYS FOLLOW BASIC SAFETY PRECAUTIONS WHEN USING ELECTRICAL PRODUCTS, ESPECIALLY WHEN CHILDREN ARE PRESENT.

 **CAUTION:** Please read all information carefully before

 **CAUTION:** Intended for indoor use. ONLY FOR DRY LOCATIONS.

 **CAUTION:** This product is NOT a toy.

Limited Warranty

FCC STATEMENT

This device complies with part 15 of the FCC Rules. Operation is subject to the following two conditions: (1) This device may not cause harmful interference, and (2) this device must accept any interference received, including interference that may cause undesired operation. Note: This equipment has been tested and found to comply with the limits for a Class B digital device, pursuant to part 15 of the FCC Rules. These limits are designed to provide reasonable protection against harmful interference in a residential installation. This equipment generates, uses and can radiate radio frequency energy and, if not installed and used in accordance with the instructions, may cause harmful interference to radio communications. However, there is no guarantee that interference will not occur in a particular installation. If this equipment does cause harmful interference to radio or television reception, which can be determined by turning the equipment off and on, the

user is encouraged to try to correct the interference by one or more of the following measures: Reorient or relocate the receiving antenna. Increase the separation between the equipment and receiver. Connect the equipment into an outlet on a circuit different from that to which the receiver is connected. Consult the dealer or an experienced radio/TV technician for help. Any changes or modifications not expressly approved by the manufacturer could void the user’s authority to operate the equipment.

Warning: Changes or modifications to this unit not expressly approved by the party responsible for compliance could void the user’s authority to operate the equipment.

Pre-Installation

HARDWARE INCLUDED

 **NOTE:** Hardware not shown to actual size.

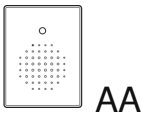

Part	Description	Quantity
AA	Wireless Chime	1

Description

ITEM	DESCRIPTION
Status Light	Once plugged into power the indicator will blink twice then turn off.
Volume/Mute Pairing/Reset	<p>Press and hold the volume button for 6 seconds or until the light indicator blinks rapidly. It will be in pairing mode for 15 seconds, during this time press the doorbell button on the front of the camera. Press the button again to hear it ring.</p> <p>Press the volume button to toggle between high, medium, low, and mute sound settings.</p>

Ring Tone Selection	Cycle through 20 different tones.
USB-A Input Power Plug	5VDC, Max. 1A

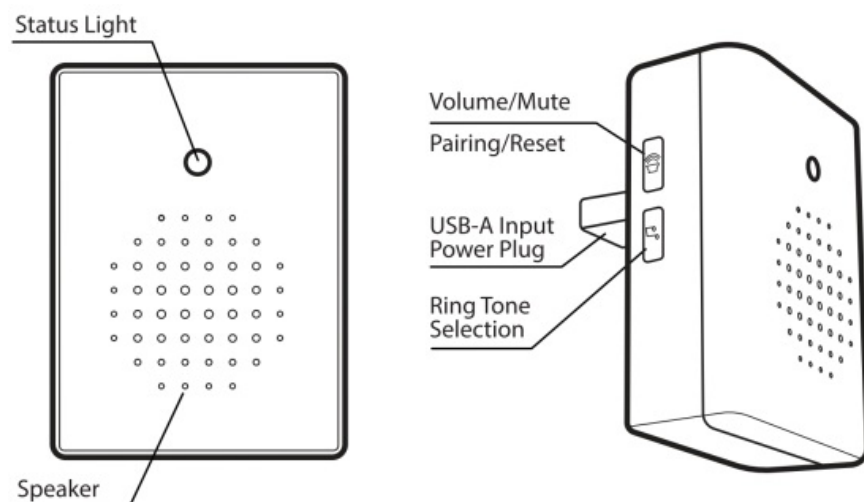

Setup

1. Supply Power

Supply power to your Wireless Chime (AA) with the USB power adapter near the Smart Doorbell. You can relocate it after pairing the device.

 **NOTE:** The USB power adapter is not included.

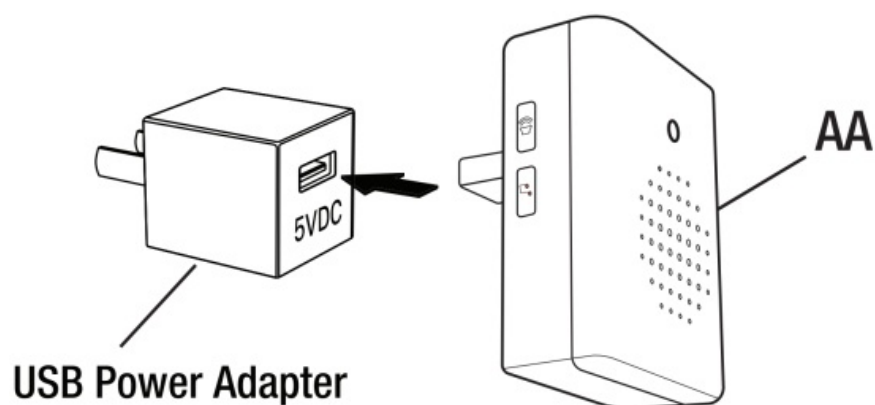

2. Confirm Status Light

Wait for the Status Light to blink twice then turn off.

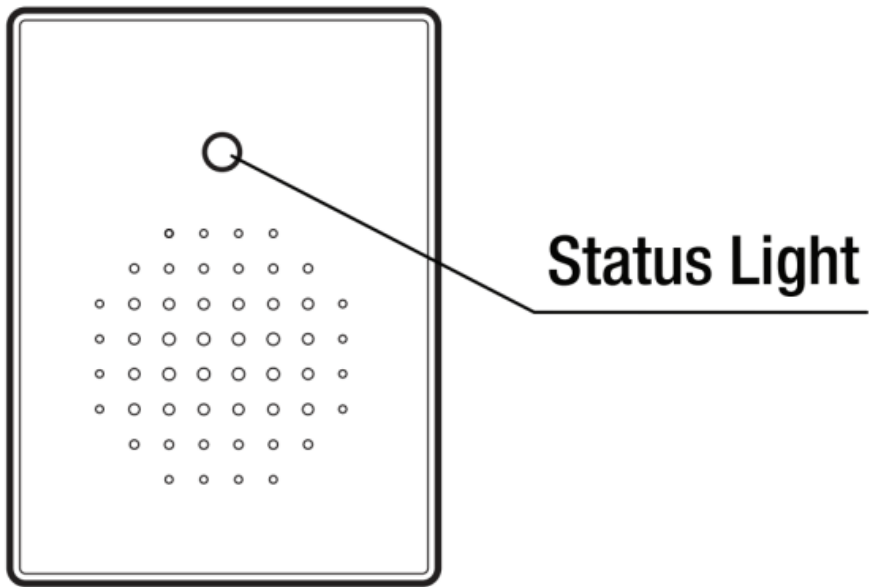

3. Pair with Smart Doorbell

Press and hold the volume button until the light indicator blinks quickly, then release the button and press the doorbell button on the front of the camera.

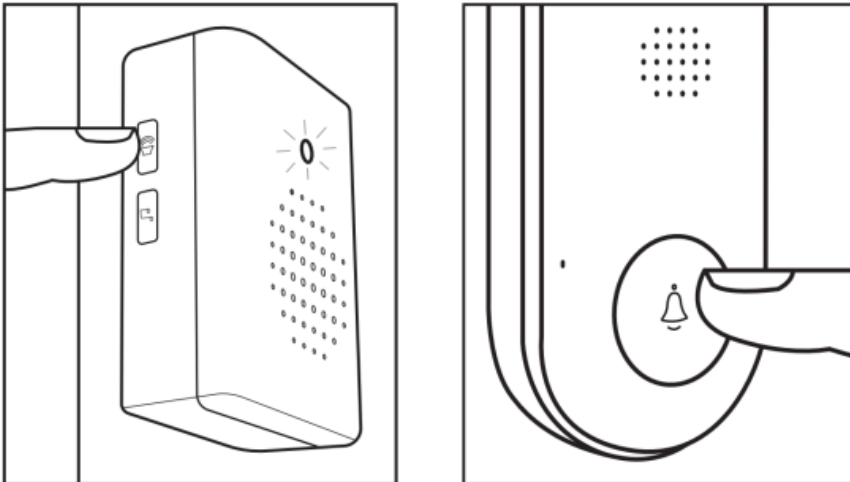

4. Complete Setup

Press it again to make sure it rings. You are now paired.

 **NOTE:** Tapping on the Ring Tone Selection button cycles through all 20 tones. It will play by default once you have stopped cycling.

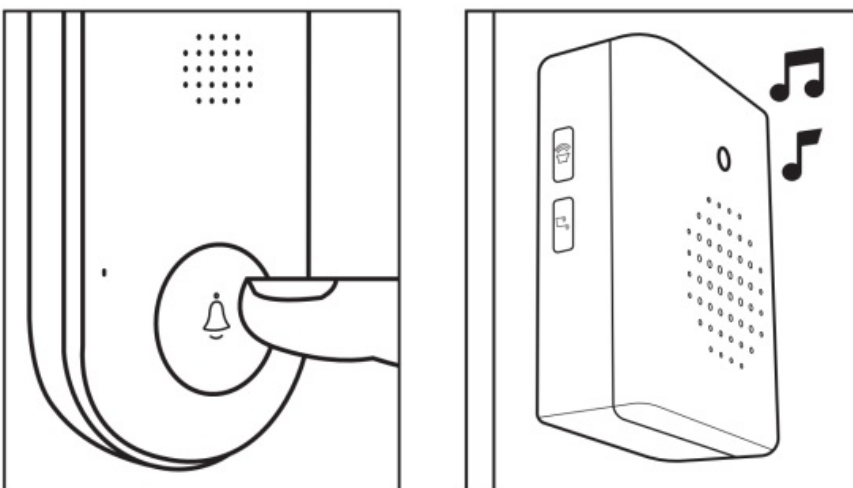

Documents / Resources

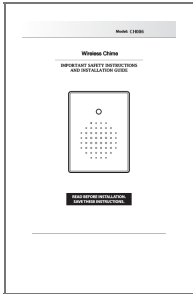

[CHWARES CH006 Wireless Chime \[pdf\]](#) User Manual

CH006, 2AQ7B-CH006, 2AQ7BCH006, CH006 Wireless Chime, CH006, Wireless Chime, Chime

References

- [User Manual](#)

2AQ7B-CH006, 2AQ7BCH006, CH006, CH006 Wireless Chime, Chime, CHWARES, Wireless

CHWARES Chime

—Previous Post

[CHWARES LJC-101 Cat Nursery Night Lights User Manual](#)

Leave a comment

Your email address will not be published. Required fields are marked *

Comment *

Name

Email

Website

☐ Save my name, email, and website in this browser for the next time I comment.

Post Comment

Search:

e.g. whirlpool wrf535swhz

Search

[Manuals+](#) | [Upload](#) | [Deep Search](#) | [Privacy Policy](#) | [@manuals.plus](#) | [YouTube](#)

This website is an independent publication and is neither affiliated with nor endorsed by any of the trademark owners. The "Bluetooth®" word mark and logos are registered trademarks owned by Bluetooth SIG, Inc. The "Wi-Fi®" word mark and logos are registered trademarks owned by the Wi-Fi Alliance. Any use of these marks on this website does not imply any affiliation with or endorsement.