

[Skip to content](#)

Manuals+

User Manuals Simplified.



CHUANGO DWC-102 Window Contact User Manual

[Home](#) » [CHUANGO](#) » CHUANGO DWC-102 Window
Contact User Manual

CHUANGO[®]

DWC-102

**Door/Window Contact
MULTILINGUAL
USER MANUAL**

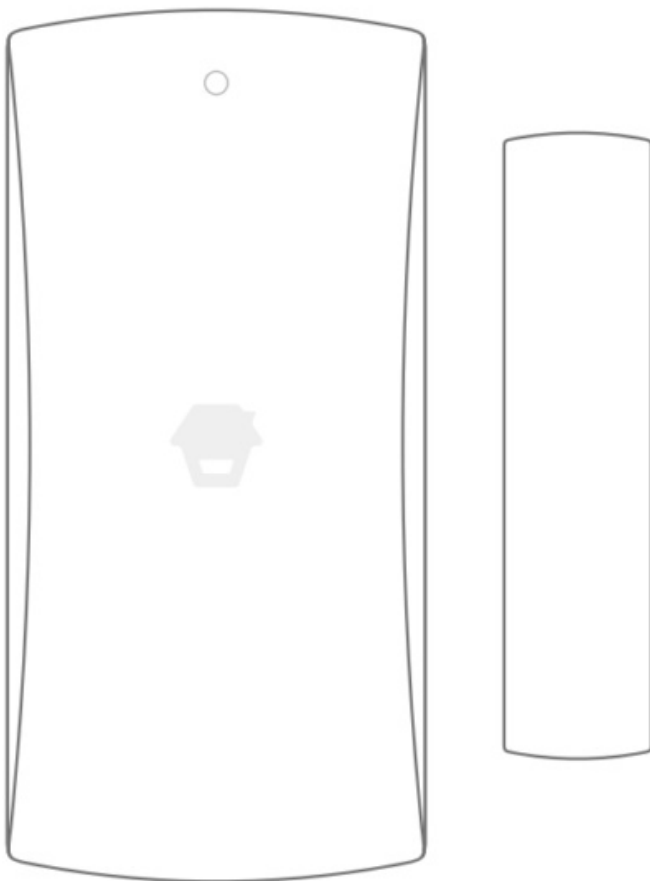

Contents [hide](#)

[1 Introduction](#)

[2 Overview](#)

[3 PCB Layout](#)

[4 Installation](#)

[5 Connect the Door/Window Contact](#)

[6 Specifications](#)

[7 Documents / Resources](#)

[8 Related Posts](#)

Introduction

The contact contains a transmitter and a magnet, which can be mounted on a door, window, or any object that can be opened or closed. When the transmitter and magnet are separated, the contact will send a signal to the control panel and the latter will trigger an alarm. The tamper switch ensures that sabotage attempting to disassemble the contact will trigger an alarm.

Overview

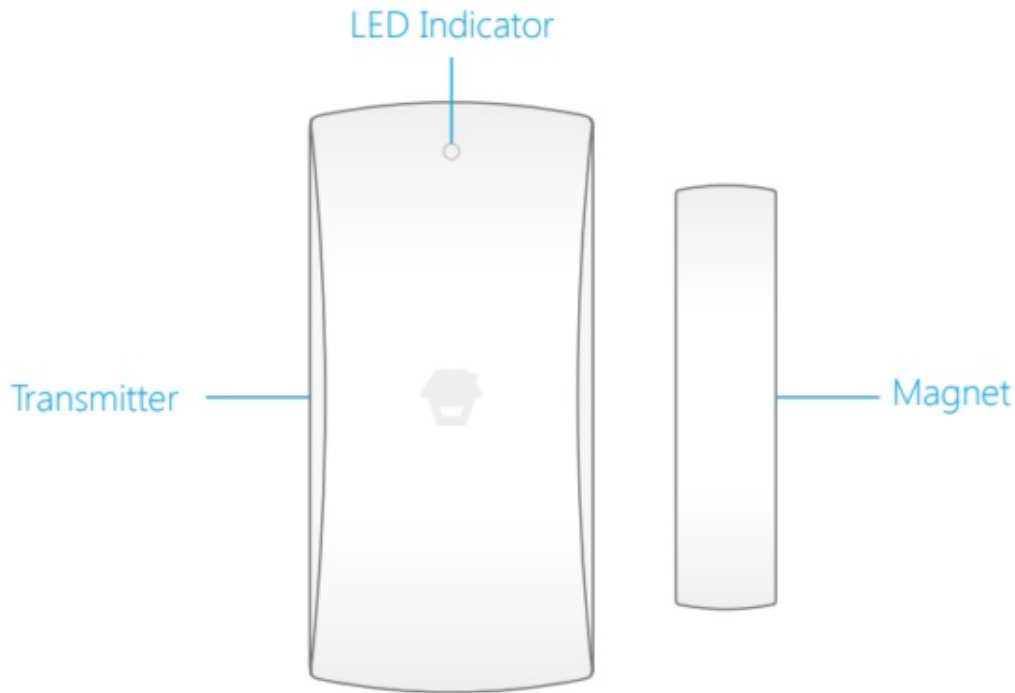

LED Indication

Flash once: Intruder is detected.

Flash once per 3 seconds after triggered: Low battery. Replace the battery as soon as possible.

PCB Layout

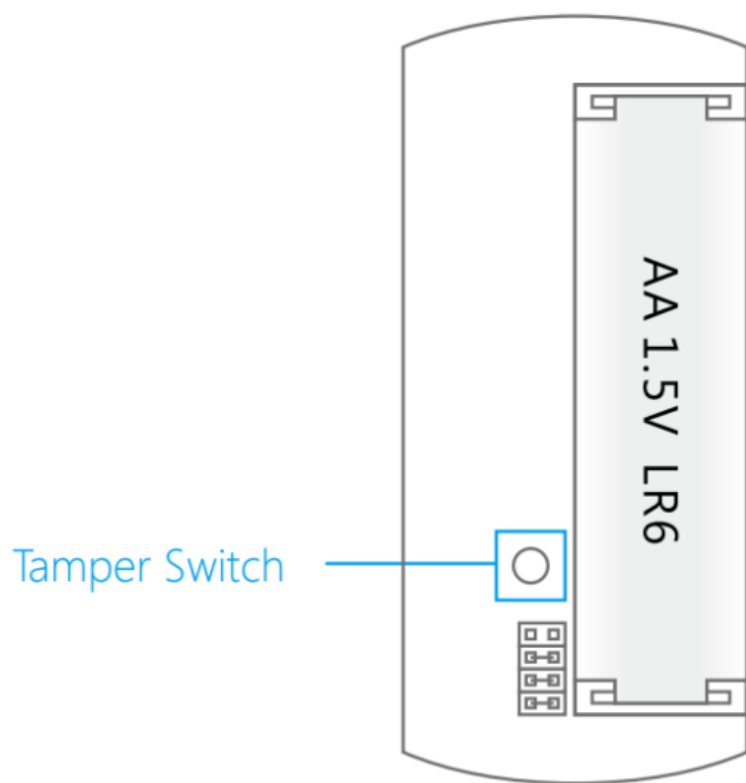

Note: When the tamper switch is pressed, the system will alarm immediately.

Installation

After confirming that the door/window contact works properly, the installation steps can proceed as follow:
Secure the transmitter and magnet in the desired locations (like a door or window which can be opened and closed) with double-sided tapes.

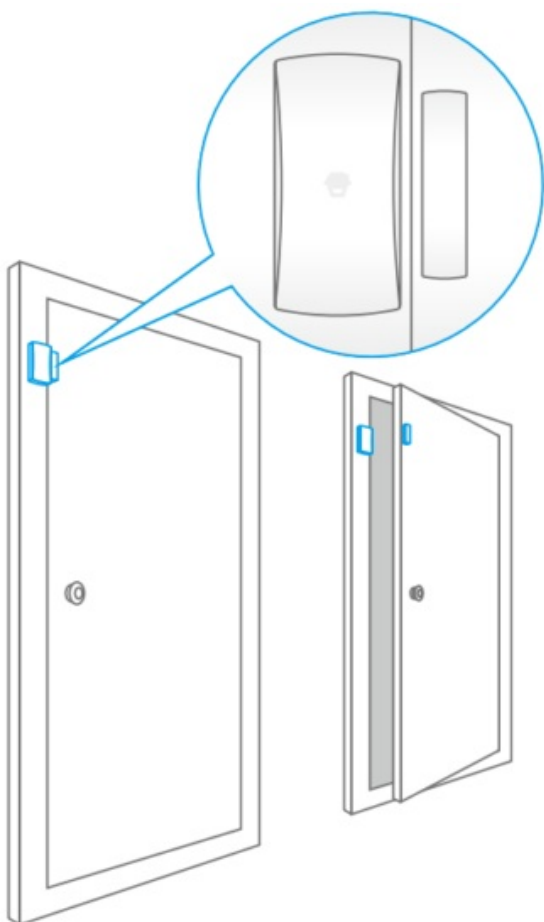

Note: if this product is installed on a metal door, place spacers under the transmitter and magnet. This product is not suitable for shutter doors, please purchase a shutter door sensor for your use.

Connect the Door/Window Contact

Connecting the door/window contact is to build a wireless connection between the door/window contact and the control panel.

1. Make sure the triangle mark is close to each other and within the range of 1cm.
2. The Control panel enters into the connecting state (For details, please refer to the relative user manual).
3. Separate the transmitter and magnet with a space of more than 2 cm, and the control panel beeps once, indicating successful connection.

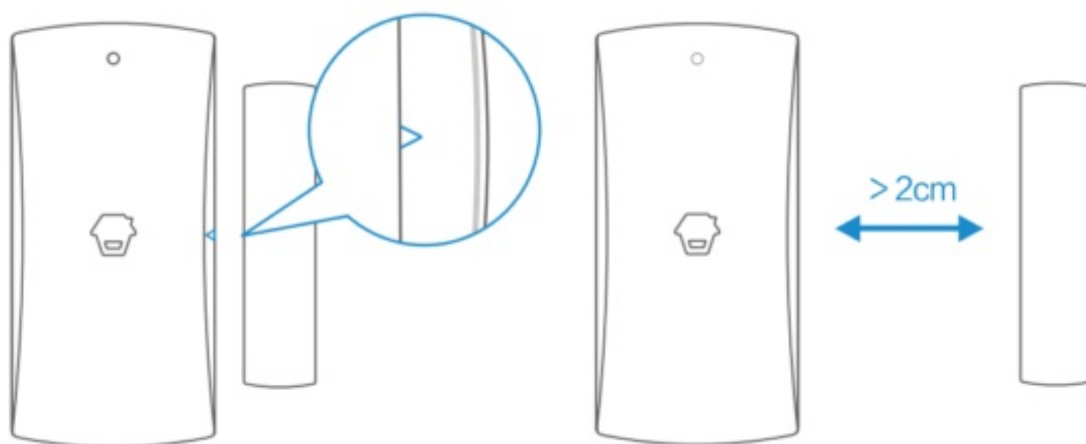

Note: If the control panel beeps twice when the above operation is done, it means the contact has been connected before.

Specifications

Power Supply: DC 1.5V LR6 Battery x 1

Standby Current: < 56 μ A

Alarm Current: < 82 mA

Transmitting Distance: < 80 m (Open area/no interference)

Radio Frequency: 315MHz or 433.92MHz (\pm 75MHz)

Housing Material: ABS plastic

ERP(dBm).MAX: -12.06

Operation Condition:

Temperature: 0 $^{\circ}$ C~+50 $^{\circ}$ C

Relative Humidity: < 90% (non-condensing)

Transmitter Dimensions: 71 x 34 x 17.55 mm

Magnet Dimensions: 51 x 12 x 13.5 mm



Printed in China

Ver: DWC-102-UM-ML-V1.0

© Chuango. All Rights Reserved.

Documents / Resources



[CHUANGO DWC-102 Window Contact](#) [pdf] User Manual
DWC-102 Window Contact, DWC-102, Window Contact

[Manuals+](#),

- [home](#)
- [privacy](#)