



CHUANGO DML-100 Multipurpose Sensor User Manual

[Home](#) » [CHUANGO](#) » CHUANGO DML-100 Multipurpose Sensor User Manual 

Contents

- [1 CHUANGO DML-100 Multipurpose Sensor](#)
- [2 Product Introduction](#)
- [3 Product Overview](#)
- [4 Network Setup](#)
- [5 Installation](#)
- [6 Mount the Sensor](#)
- [7 Specifications](#)
- [8 Documents / Resources](#)
 - [8.1 References](#)
- [9 Related Posts](#)

CHUANGO®

CHUANGO DML-100 Multipurpose Sensor



Product Introduction

This multipurpose sensor can be used by connecting to AC power or wirelessly by built-in battery (after it is fully charged). There are two preset working modes: Away Mode and Home Mode. Easily switch the modes or set schedules to switch on the app.

Please charge it 7-8 hours before use.

In Away Mode, once the sensor detects human movement, the built-in siren sounds, the LEDs flash, and an app push notification will be sent to you.

In Home Mode, when the sensor detects human movement and the surrounding brightness is dark or slightly dark, the LEDs will automatically turn on as a night light.

Ambient light sensing function is default on. If it is toggled off, the LEDs will turn on anytime when motion is detected.

In Away and Home Mode, you can choose to set temperature, humidity and ambient light detecting range, get notified when values exceeding the preset value.

In Away Mode, turn on smoke alarm sound detection function, you'll be notified when your home's smoke alarm goes off.

- Connect to Wi-Fi directly, no hub needed.
- Set schedules to switch between modes.

Product Overview

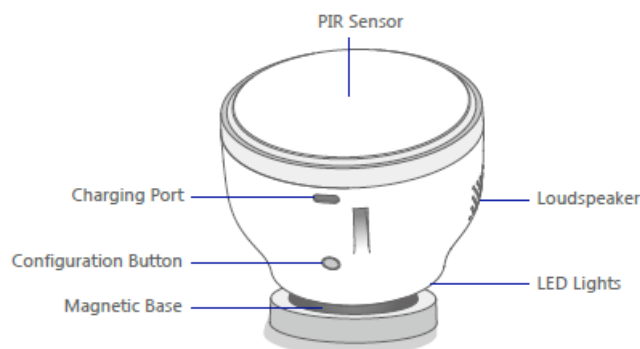

Power On the Sensor

Press and hold the configuration button for 3 seconds to turn the sensor on/off.

Download DreamCatcher Life App



After the device is powered on, add it via Bluetooth or via Wi-Fi AP mode.

Network Setup

Bluetooth: Select Bluetooth toggle to turn it on, it will automatically search for the device. Tap to add it to your home Wi-Fi network.



Wi-Fi AP mode: Tap Add Device or “+” in the upper right corner, then select DML-100 under “Security” .



Press and hold the Configuration Button for 3 seconds to power on the device, wait for the device to complete a 40-seconds self-test until the indicator light gradient flashes.

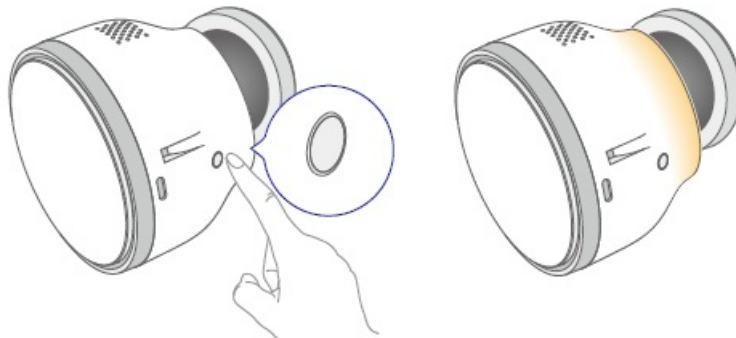

Short press the Configuration Button 3 times, the device will enter the WiFi configuration state. The breathing light goes off to indicate the configuration is successful.

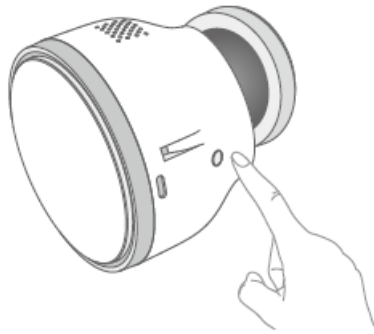

Operation	Light Status	Meaning	Prompt Tone
Press and hold the configuration button for 3 seconds	On	Sensor is powered on	Power on tone
Press and hold the configuration button for 3 seconds	Off	Sensor is powered off	Power off tone
/	Flash on and off for 40 seconds	Device self-test	/
Press the configuration button 3 times	Gradient flashing	Device is under configuration state	Beep once
/	Gradient flashing off	Successfully connected to the network	Beep twice
Press the configuration button 5 times	On for 1 second then gradient flashes (configuration mode)	Device reset	Long beep once

Note: Deleting the sensor on the APP while it's online will also reset it.

Installation

There are two ways to install the sensor: mount it on the wall or place it on desktop.

On Desktop

Put the sensor on a flat surface with the provided desktop bracket.

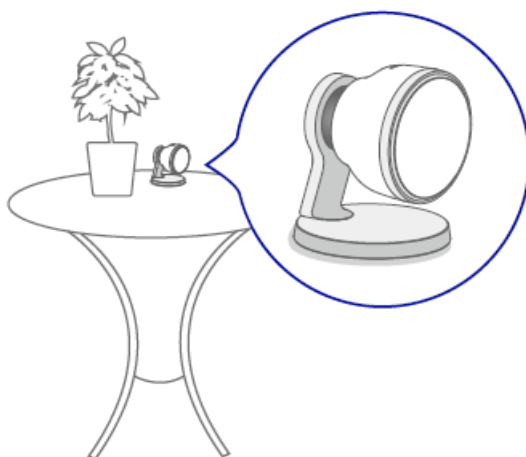

Wall Mount

To get optimal detection coverage, check the following factors before mounting:

- Determine the area of detection and ensure there is no obstructed field of view.
- Determine the height and adjust angle.
- Avoid direct sources of heat or sunshine, swinging objects like curtains.

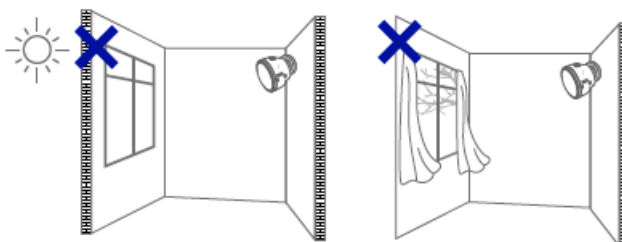

Pet-Immune Function

The motion sensor should be mounted 2-2.2m above the floor and adjust the detecting angle according to your need. When the sensor is installed parallel to the wall, pet under 25kg will not trigger alarm.

Note: when the sensor is put on desktop. The pet-immune function could not work as it intends.

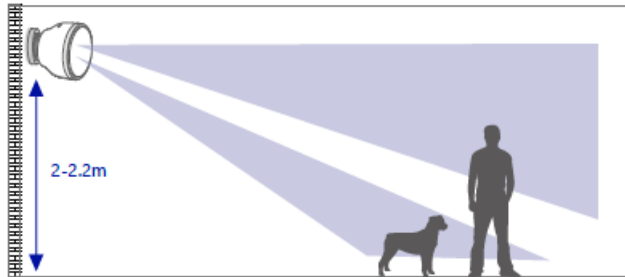
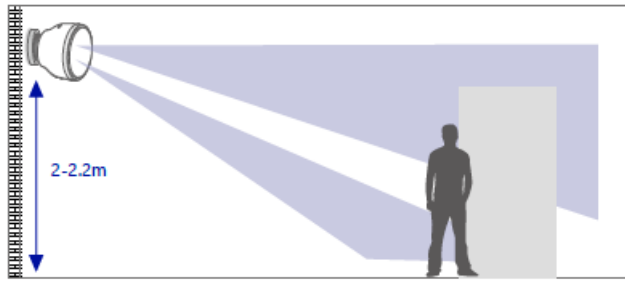

Sensitivity

The sensitivity can be adjusted on the app. The default setting is medium sensitivity.

Mount the Sensor

Use the 3M Double-side Adhesive Tape

Remove the adhesive tape film, and stick one side on the back of the magnetic base, the other side on the wall. Snap the sensor on the base.

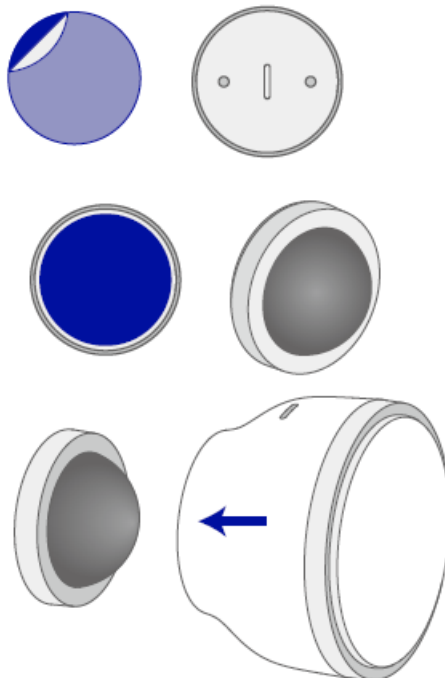

Use the Provided Screws

Place the base against the wall and use a pencil to mark the desired location for mounting.

Drill holes at each marking. Insert anchors into the holes if needed, and fix the base onto the wall with the provided screws.

Snap the sensor back onto the base.

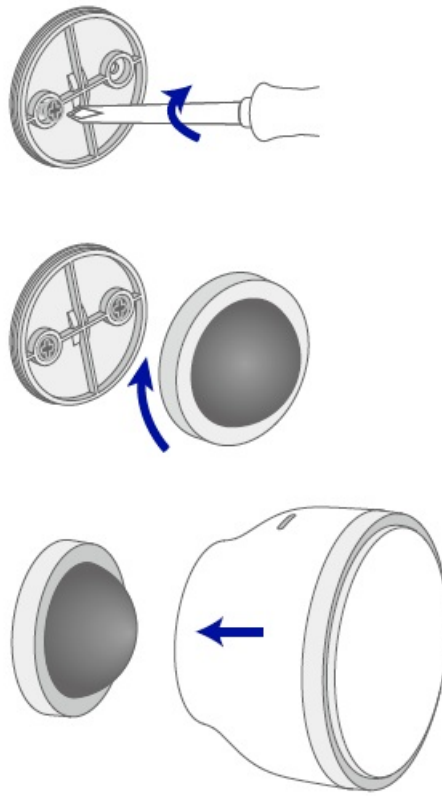

Specifications

- Model: DML-100
- Power Supply: DC 5V (18650 rechargeable battery)
- Standby Time: around 60* days

Under the circumstances of stable network, estimated by 8 nightlight triggers per day and 2 alarm triggers per month. If the network is unstable or the signal is poor, the standby time will be shortened.

- Wireless: Wi-Fi 2.4G
- Detection Scope: 5-10 meters
- Detection Angle: 95°max.
- Pet Immunity: <25kg
- Casing Material: PC+ABS
- Operating Temperature: 0°C to 50°C
- Operating Humidity: 0-90% RH
- Sensor Dimensions (L x W x H): 85 x 85 x 84.5 mm
- Bracket Dimensions (L x W x H): 98.5x 98.5 x 101.5 mm

CE Declaration of Conformity

Hereby, Chuango AIoT GmbH declares that the radio equipment type DML-100 is in compliance with Directive 2014/53/EU. The full text of the EU declaration of conformity is available at the following internet address:

INFORMATION FOR THE USERS At the end of its life, the device has to be separated from the other waste. Consign the device and all its components together to a center of electronical and electrotechnical waste recycling center, designated by your local authorities.

2006/66/EC and its amendment 2013/56/EU (battery directive): This product contains a battery that cannot be disposed of as unsorted municipal waste in the European Union. See the product documentation for specific battery information. The battery is marked with this symbol, which may include lettering to indicate cadmium (Cd), lead (Pb), or mercury (Hg). For proper recycling, return the battery to your supplier or to a designated collection point. For more information see: www.recyclethis.info.

Documents / Resources

	CHUANGO DML-100 Multipurpose Sensor [pdf] User Manual DML-100 Multipurpose Sensor, DML-100, Multipurpose Sensor, Sensor
---	--

References

-  [HOME](#)
-  [Chuango B2B | Wireless DIY smart home security systems](#)
-  [HOME](#)