

# CHENXUAN CX001 Temperature and Humidity Sensor User Manual

[Home](#) » [CHENXUAN](#) » CHENXUAN CX001 Temperature and Humidity Sensor User Manual 

CHENXUAN CX001 Temperature and Humidity Sensor

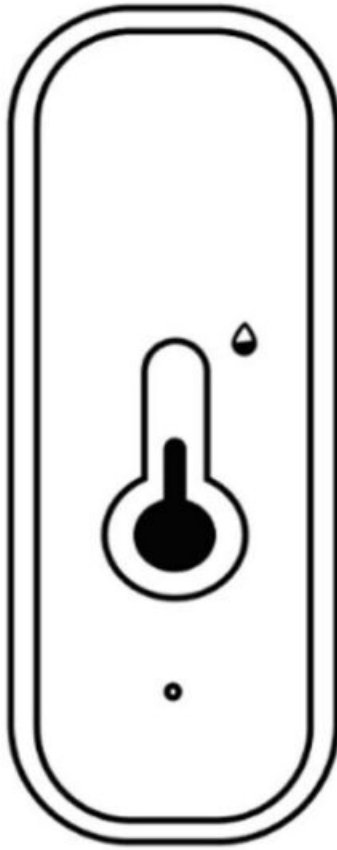

★ Please read this manual carefully before use this sensor

## Contents

- [1 Specification](#)
- [2 How to use](#)
- [3 Checklist before using the sensor](#)
- [4 How to set up](#)
- [5 Functions](#)
- [6 FCC STATEMENT](#)
- [7 FCC Radiation Exposure Statement](#)
- [8 Documents / Resources](#)
  - [8.1 References](#)

## Specification

**Size:** 70\*24\*19mm

**Battery:** LRO3-1.5V/ AAA\*2

**Wireless Type:** WiFi (2.4GHz)

**Measure Range:** -20 °C~60°C 0%-100%RH

**Measure Accuracy:** ±1 °C ±5%RH

**Power Consumption:** <30uA

**Low Power and Low Voltage:** <2.2V

**Working Mode:** APP notification push

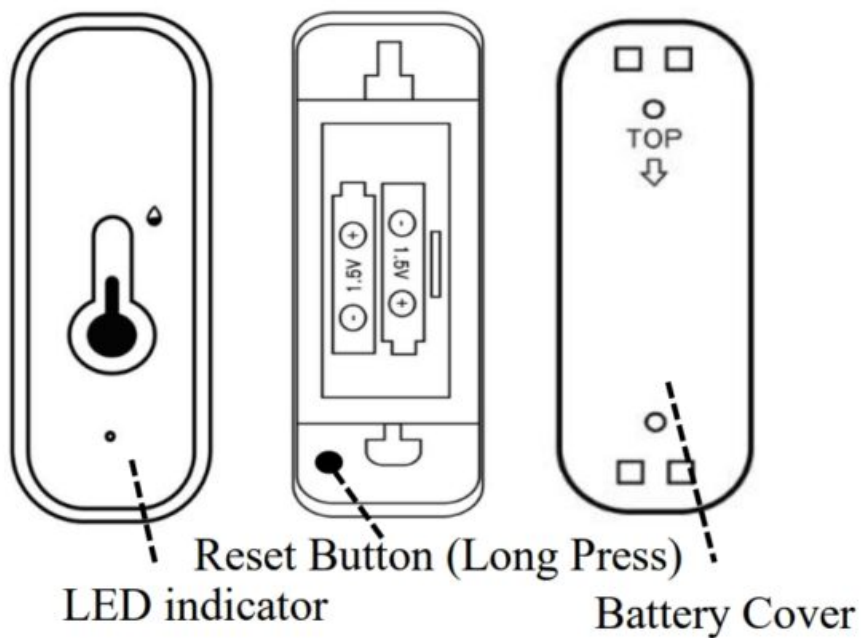

## How to use

Slide to open the back cover of battery compartment, take out the insulation sheet.

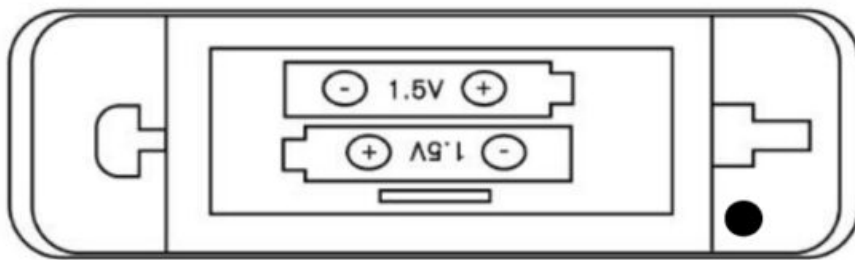

Note: When batteries are run out, please choose Alkaline battery instead of Carbon zinc battery.

## Checklist before using the sensor

- a. Your phone has connected to a 2.4GHz Wi-Fi network.
- b. Your phone must be Android 4.4+ or iOS 8.0+.
- c. Your Wi-Fi router is MAC-open.
- d. The numbers of devices connected to Wi-Fi router DON'T reach the limit.

## How to set up

1. First scan QR code below, or Search “**CozyLife**” APP in Google Play Store or APP Store.



2. Register the APP with email address, or use a trial account to use it, then login in.

**Note:** If device is not in factory mode, please long press Reset Button for 3-4 seconds until the LED blinks slowly.

3. In popped window, key in your Wi-Fi router password. Wait a while and the set-up progress is done.

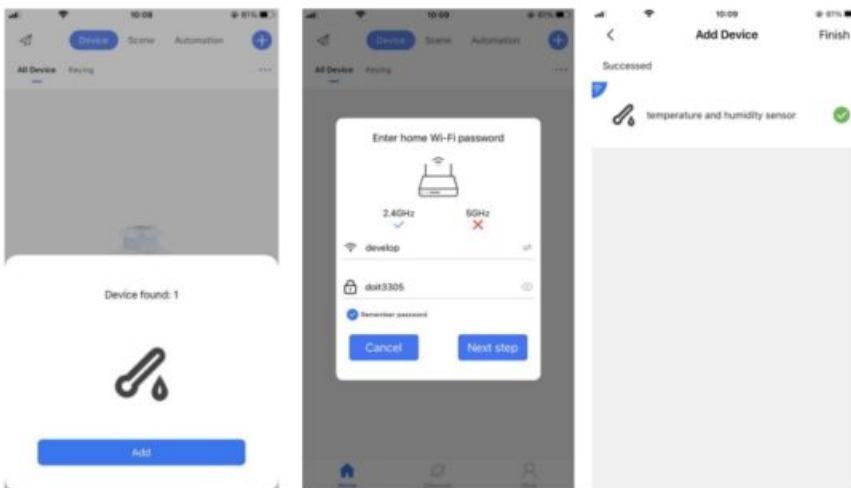

## Functions

1. Accurate Measurement

About 30 minutes after Wi-Fi configuration, the temperature and humidity is closer to the actual ambient environment, so the readings are more accurate. And please keep the sensor away from any heat sources.

2. **Intelligent Linkage**

When the ambient environment change, you can execute intelligent linkage.

For example, when the room temperature surpass 35°C, the air-conditioner will turn on automatically, or when the humidity is lower than 20% RH, the humidifier will spray.

3. **Temp & Humidity Alert**

You can preset the range of temperature and humidity in the configuration, when the temperature and humidity reaches the range, it will push alert message via app.

4. **Temperature Unit Selections in APP**

You can choose °C or °F as temperature unit through app.

5. **Third-party Voice Control**

Device works with Alexa, Google assistant.

## FCC STATEMENT

1. This device complies with Part 15 of the FCC Rules. Operation is subject to the following two conditions:
  1. This device may not cause harmful interference, and
  2. This device must accept any interference received, including interference that may cause undesired operation.
2. Changes or modifications not expressly approved by the party responsible for compliance could void the user's authority to operate the equipment.

This equipment has been tested and found to comply with the limits for a Class B digital device, pursuant to part 15 of the FCC Rules.

These limits are designed to provide reasonable protection against harmful interference in a residential installation.

This equipment generates, uses and can radiate radio frequency energy and, if not installed and used in accordance with the instructions, may cause harmful interference to radio communications. However, there is no guarantee that interference will not occur in a particular installation. If this equipment does cause harmful interference to radio or television reception, which can be determined by turning the equipment off and on, the user is encouraged to try to correct the interference by one or more of the following measures:

- Reorient or relocate the receiving antenna.
- Increase the separation between the equipment and receiver.
- Connect the equipment into an outlet on a circuit different from that to which the receiver is connected.
- Consult the dealer or an experienced radio/ TV technician for help.

## FCC Radiation Exposure Statement

This equipment complies with FCC radiation exposure limits set forth for an uncontrolled environment. In order to avoid the possibility of exceeding the FCC radio frequency exposure limits, Human proximity to the antenna shall not be less than 20cm (8 inches) during normal operation.



## Documents / Resources

 <p>Temperature &amp; Humidity Sensor User Manual FCC ID: J8KCP-CX001 Model: CX001</p> <p>* Please read the manual carefully before use.</p>	<p><a href="#">CHENXUAN CX001 Temperature and Humidity Sensor</a> [pdf] User Manual CX001, CX001 Temperature and Humidity Sensor, Temperature and Humidity Sensor, Humidity Sensor, Sensor</p>
---	--

## References

- [User Manual](#)

## **Manuals+. Privacy Policy**

This website is an independent publication and is neither affiliated with nor endorsed by any of the trademark owners. The "Bluetooth®" word mark and logos are registered trademarks owned by Bluetooth SIG, Inc. The "Wi-Fi®" word mark and logos are registered trademarks owned by the Wi-Fi Alliance. Any use of these marks on this website does not imply any affiliation with or endorsement.