

CHEFMAN RJ38-SQPF-45TDB TurboFry Touch Dual Fryer User Guide

[Home](#) » [Chefman](#) » CHEFMAN RJ38-SQPF-45TDB TurboFry Touch Dual Fryer User Guide 

Contents

- [1 chefman RJ38-SQPF-45TDB TurboFry Touch Dual Fryer](#)
- [2 Feature](#)
- [3 Control Panel](#)
- [4 BEFORE FIRST USE](#)
- [5 CLEANING AND MAINTENANCE](#)
- [6 HOW TO COOK IN THE AIR FRYER](#)
- [7 HOW TO PROGRAM THE AIR FRYER](#)
- [8 Documents / Resources](#)
- [9 Related Posts](#)



chefman RJ38-SQPF-45TDB TurboFry Touch Dual Fryer

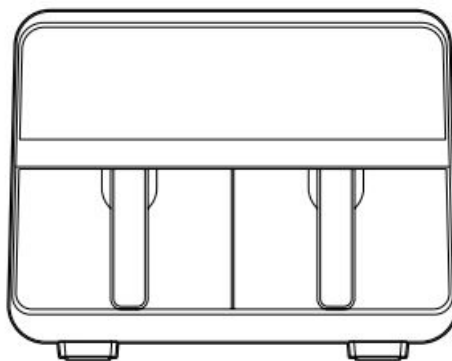

Feature

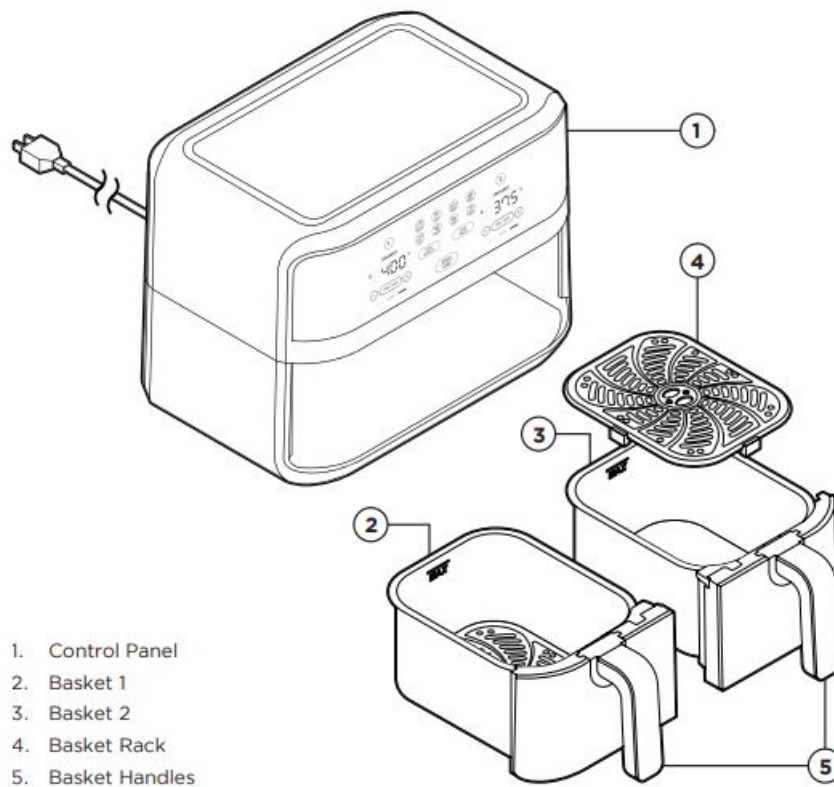

Control Panel

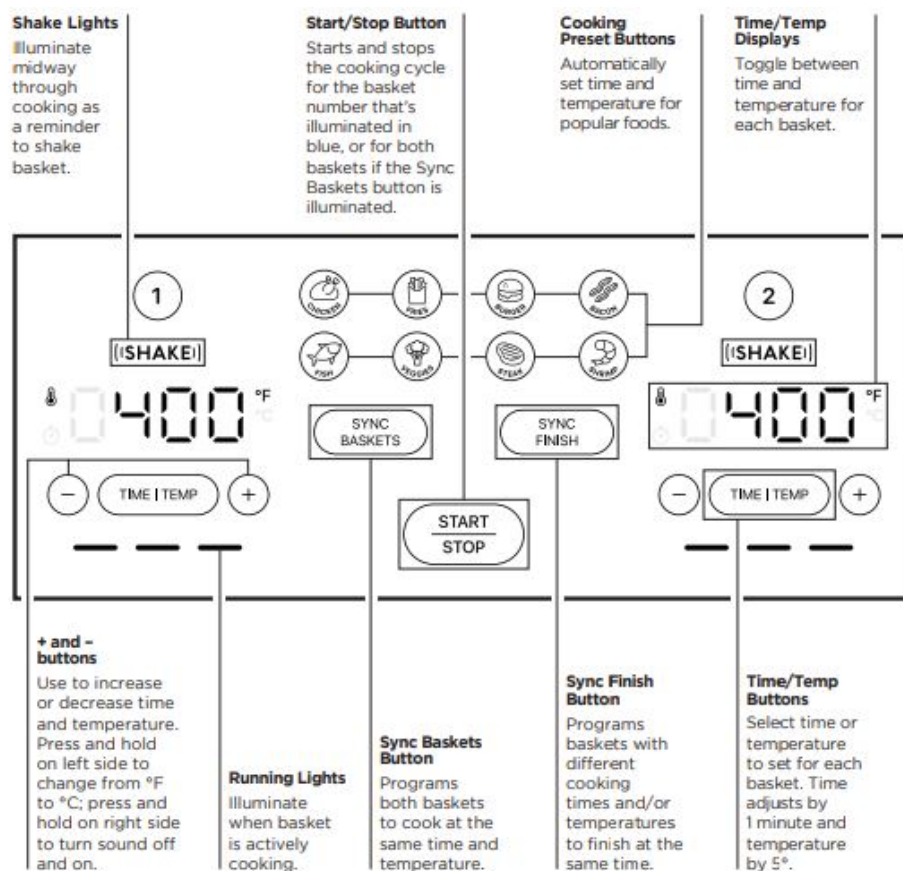

- **Shake Lights**
Illuminate midway through cooking as to shake basket.
- **Start/Stop Button**
Starts and stops the cooking cycle for the basket number that's illuminated in blue, or for both baskets if the

Sync Baskets button is illuminated.

- **Cooking Preset Buttons**

Automatically set time and temperature for popular foods.

- **Time/Temp Displays**

Toggle between time and temperature for each basket.

- **+ and – buttons**

Use to increase or decrease time and temperature. Press and hold on left side to change from °F to °C; press and hold on right side to turn sound off and on.

- **Running Lights**

Illuminate when basket is actively cooking.

- **Sync Baskets Button**

Programs both baskets to cook at the same time and temperature.

- **Sync Finish Button**

Programs baskets with different cooking times and/or temperatures to finish at the same time.

- **Time/Temp Buttons**

Select time or temperature to set for each basket. Time adjusts by 1 minute and temperature by 5°.

BEFORE FIRST USE

1. Remove all packaging materials, such as plastic bags and foam inserts. Ensure that all parts and accessories are accounted for.
2. Read and remove any stickers on the unit except for the rating label on the bottom, which should remain on the unit.
3. Wipe down the interior and exterior with a damp cloth. Wash the baskets and racks with warm, soapy water. Dry thoroughly.

CLEANING AND MAINTENANCE

1. Unplug the unit and let cool completely before cleaning. (For faster cooling, take hot baskets out of the unit.)
2. To remove the cooled racks from the baskets, pinch the center grip bar on the rack, and pull the rack straight up and out of the basket. **WARNING:** Do not lift the rack out of the basket when hot, or injury can occur.
3. Wash the baskets and racks with warm, soapy water, rinse, and dry well with a towel for best results. Baskets and racks are also top-rack dishwasher-safe.
4. Wipe down the outside and the inside of the unit with a damp cloth as needed. Do not put the unit in the dishwasher or submerge in water or any other liquid.
5. Do not use abrasive cleansers on baskets, racks, or the exterior and interior of the appliance, or you could damage the finishes.

HOW TO COOK IN THE AIR FRYER

STEP 1

Set the unit on a hard, flat surface and plug in. Lower the racks into the baskets, or just one rack if cooking in one basket. Press on the rack(s) to ensure they are secure and level.

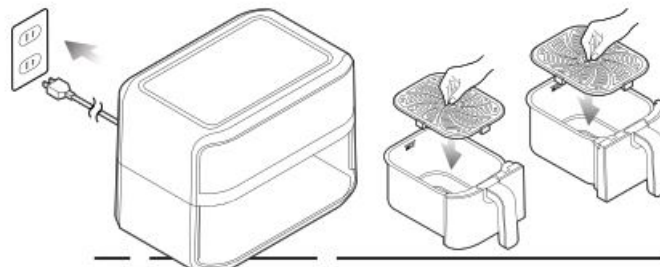

STEP 2

Put food on the rack(s). Do not fill the basket(s) past the Max line.

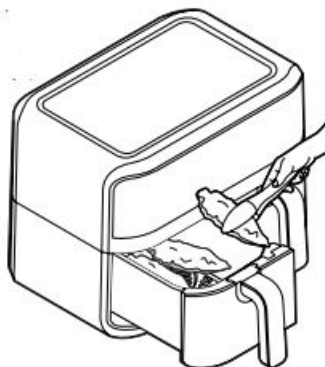

STEP 3

Slide the basket(s) into the air fryer.

NOTE: If cooking in one basket, the other does not need to be in place.

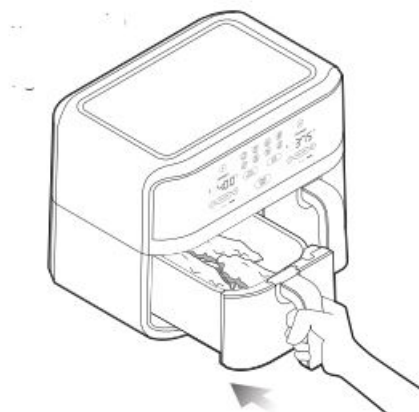

STEP 4

Set the time and temperature, independently or in sync as desired (see chart at right). Press Start.

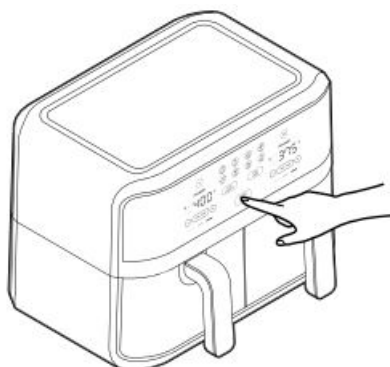

STEP 5

During cooking, the Shake light will turn on for active baskets (not necessarily simultaneously), and the air fryer will beep as a reminder to shake (or flip) food as necessary. If your food does not need to be shaken, simply ignore the warning.



STEP 6

When the timer is done, the air fryer will turn off automatically. Remove the basket, check food for doneness, then carefully transfer food to plates or a platter and serve.

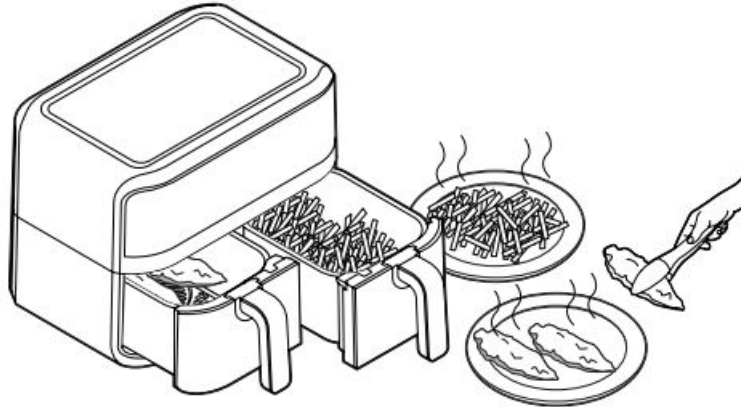

HOW TO PROGRAM THE AIR FRYER

To cook in one basket	To cook in two baskets with Sync Baskets	To cook in two baskets with Sync Finish	
Set temperature for basket 1. Press Time/Temp on left until temperature displays, then press + or - to set. OR press a preset icon.	Set temperature for basket 1. Press Time/Temp on left until temperature displays, then press + or - to set. OR press a preset icon.	Set temperature for basket 1. Press Time/Temp on left until temperature displays, then press + or - to set. OR press a preset icon.	
Set time for basket 1. If not using preset, press Time/Temp button until time displays, then press + or - to set time.	Set time for basket 1. If not using preset, press Time/Temp button until time displays, then press + or - to set time.	Set time for basket 1. If not using preset, press Time/Temp button until time displays, then press + or - to set time.	
		Press the button.	
	Press Sync Baskets.		
		Set time and temperature for basket 2 as you did for basket 1 above.	
		Press Sync Finish.	
Press Start.	Press Start.	Press Start.	



[CHEFMAN RJ38-SQPF-45TDB TurboFry Touch Dual Fryer](#) [pdf] User Guide
RJ38-SQPF-45TDB, TurboFry Touch Dual Fryer