

Cheerdots CHP02 CheerTok Smart Device User Manual

[Home](#) » [Cheerdots](#) » **Cheerdots CHP02 CheerTok Smart Device User Manual** 

Contents

- [1 Cheerdots CHP02 CheerTok Smart Device](#)
- [2 Basic Operations](#)
- [3 Turn ON/OFF](#)
- [4 Connection](#)
- [5 Working on Android](#)
- [6 Working on iPhone/iPad](#)
- [7 Working on Win/Mac](#)
- [8 Recording/Playing](#)
- [9 Product parameters](#)
- [10 FCC Statment](#)
- [11 Documents / Resources](#)
- [12 Related Posts](#)



Cheerdots CHP02 CheerTok Smart Device



Basic Operations

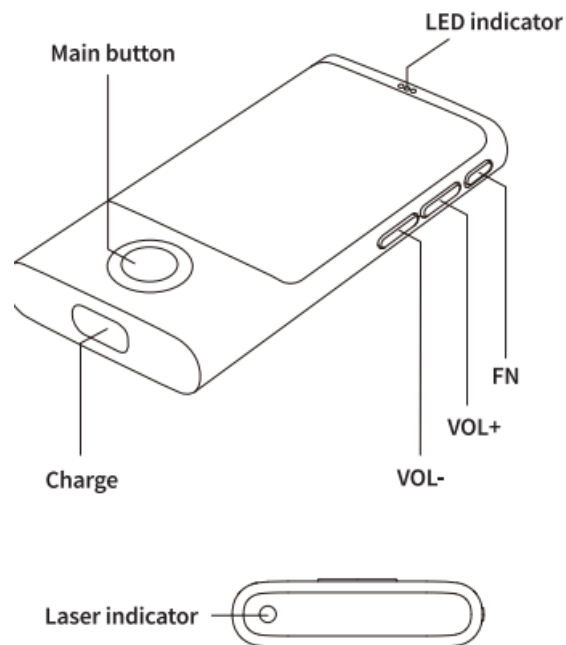

Turn ON/OFF

Turn On:

Long press Fn button until the blue light blinks, then “CheerTok” can be found by host.

Trun Off:

Long press Fn button, the green light will turns on, press and hold the button till green light turns off.

Quick Shutdown:

Press the main button and Fn button at the same time.





Connection

Connect to MacOS

Open “System Preferences” , choose “Bluetooth”  turn on bluetooth and search, you will see “CheerTok” in

searching bar, click to connect with your CheerTok.

Connect to Windows

Click "Start" icon , then open "Settings" , select "Devices" , turn on the Bluetooth switch , then click "Add Bluetooth or other devices" , choose "Bluetooth", then you can search and connect with "CheerTok" on the "Add a device" page.

Connect to iPad/iPhone

Open "Settings" @-> "Bluetooth" t-> Search for devices to connect with "CheerTok". If the mouse cursor is not shown on the screen, you can turn on the cursor following below steps: "Settings"-> "Accessibility" -> "Touch" -> "AssistiveTouch", then mouse cursor will be displayed on the screen. Mouse cursor can still be shown normally when you turn off "Assistive Touch" after that.

Connect to Android

Open "Settings" 

Working on Android

1. Main Button

Quick Click: Go Back Double Click: Home Page Long press: Laser On

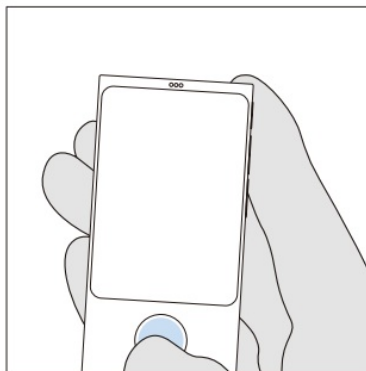

2. One Finger Touch

Keep press the trackpad: Drag Slide side: Scroll Up/Down Slide top: Scroll Left/Right Slide bottom: Sliding Tiktok Progress Bar

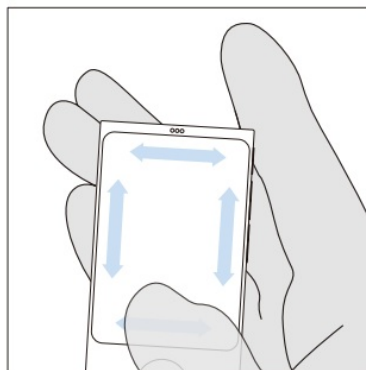

3. Two Fingers

Pinch with 2 fingers: Zoom In/Out

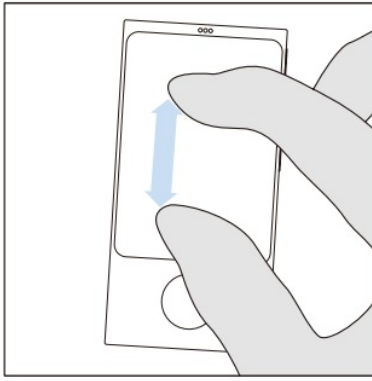

4. Quick screenshot

Press main button&VOL- at the same time. For some phone brands, need to press home button&VOL+.

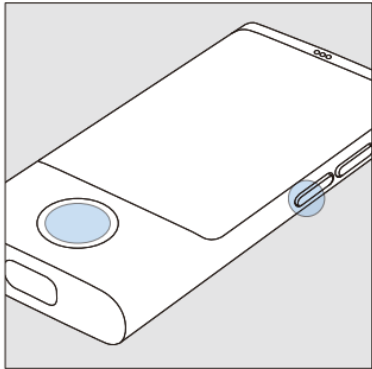

Working on iPhone/iPad

1. Main Button

Quick Click: Home Page Double Click: Show Multitasks Long press: Laser On

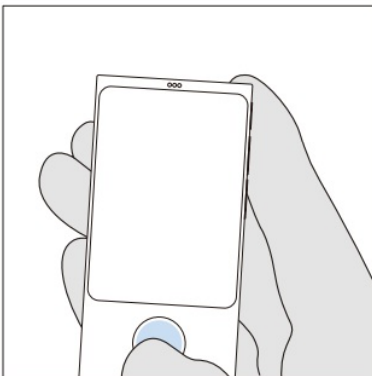

2. One Finger Touch

Long press drag mode: Drag Slide side: Scroll Up/Down Slide top: Scroll Left/Right Slide bottom: Scroll Left/Right

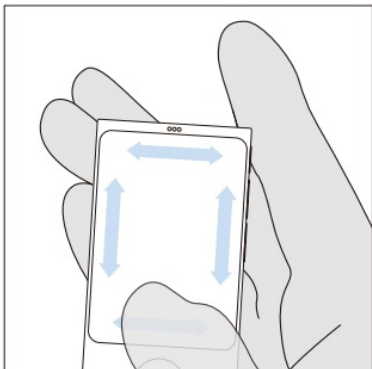

3. Two Fingers

Pinch with 2 fingers: Zoom In/Out

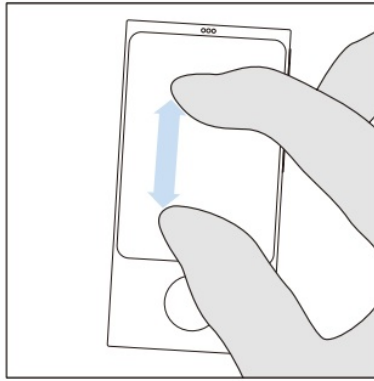

4. **Quick screenshot**

Press main button&VOL+ together for no physical Home button iPhone/iPad; For those with a physical home button, press main button&VOL-.

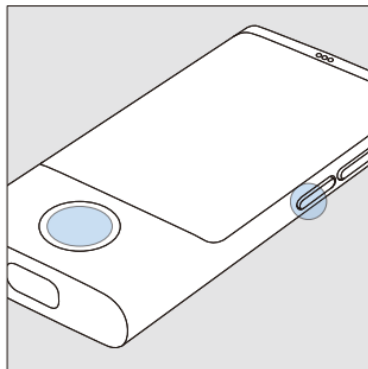

Working on Win/Mac

1. Main Button

Long press: Laser On

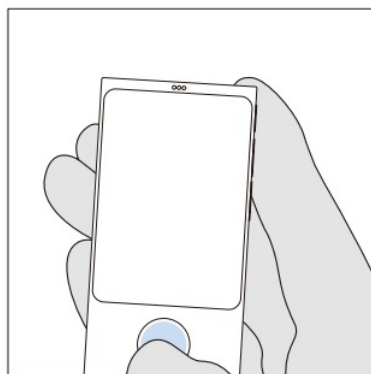

2. **One Finger Touch**

long press drag mode: Drag Slide side: Scroll Up/Down Slide top: Switch Page

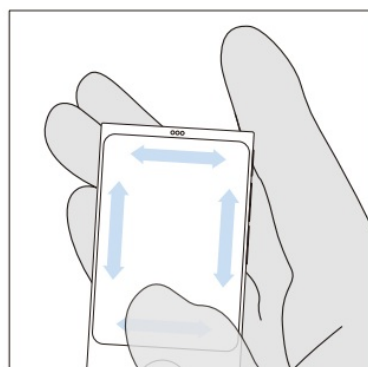

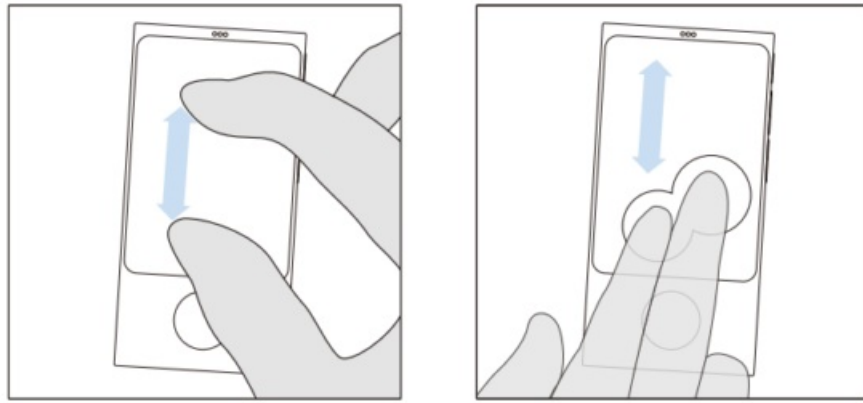

3. Two Fingers

Slide Up/Down with 2 fingers: Scroll Up/Down Pinch with 2 fingers: Zoom In/Out Tap with 2 fingers: Right click menu

Recording/Playing

1. Start recording

Long press Fn button until green light

2. Recording gestures

Touch, buttons, screenshots, etc.

3. Stop recording

Tap Fn key, the green light is off

4. Playing

Single playback (Tap Fn key, the green light flashes quickly) Loop playing (double click Fn key, the green light blinks slowly)

5. End playing

Tap Fn key, the green light goes off

Note

Device operating temperature range is -10° C ~40° C (14 ° F~104 ° F) Recharging the CheerTok every 3 months is recommended, which will maximize the battery life span.

Warning

Strong laser beam will do harm to eyes.

- Do not look directly at the laser beam when laser turned on.
- Do not point to other people's eyes.

Product parameters

Project	Specification
Product name	CheerTok
Product model	CHP02
Weight	40 g
Laser Power	1 mW
Input Voltage	5V
Battery Life	20+ Days
Battery Capacity	200 mAh
Charging Duration	1.5 Hour
Dimensions	76×38×10 mm
Compatibility	Mac(2013 or later), Win8/10(with BLE), iPadOS 13 or above, Android 5 or above
Bluetooth Version	Bluetooth 5.0
Opertating Environment	-10°C ~ 40°C (14°F ~104°F)

FCC Statment

This equipment has been tested and found to comply with the limits for a Class B digital device, pursuant to part 15 of the FCC Rules. These limits are designed to provide reasonable protection against harmful interference in a residential installation. This equipment generates, uses and can radiate radio frequency energy and, if not installed and used in accordance with the instructions, may cause harmful interference to radio communications. However, there is no guarantee that interference will not occur in a particular installation. If this equipment does cause harmful interference to radio or television reception, which can be determined by turning the equipment off and on, the user is encouraged to try to correct the interference by one or more of the following measures:

- Reorient or relocate the receiving antenna.
- Increase the separation between the equipment and receiver.
- Connect the equipment into an outlet on a circuit different from that to which the receiver is connected.
- Consult the dealer or an experienced radio/TV technician for help.

Caution: Any changes or modifications to this device not explicitly approved by manufacturer could void your authority to operate this equipment.

This device complies with part 15 of the FCC Rules. Operation is subject to the following two conditions:

1. This device may not cause harmful interference, and
2. this device must accept any interference received, including interference that may cause undesired operation.

The device has been evaluated to meet general RF exposure requirement.

Documents / Resources



CheerTok
User Manual

[Cheerdots CHP02 CheerTok Smart Device](#) [pdf] User Manual
CHP02, 2AYBG-CHP02, 2AYBGCHP02, CHP02 CheerTok Smart Device, CheerTok Smart Device