



CHASING BLUE iSUP Stand Up Paddle Board Instruction Manual

[Home](#) » [CHASING BLUE](#) » CHASING BLUE iSUP Stand Up Paddle Board Instruction Manual 

CHASING BLUE iSUP Stand Up Paddle Board Instruction Manual



Thank you for purchasing the Chasing Blue SUP Board!

We hope you have a great day on the water. If you like our boards or enjoy SUP, don't forget to share it with us!

Chasing Blue

Scan the QR code and follow our official Instagram for more information, upcoming events, and giveaways!



Meanwhile, keep in mind that **SAFETY FIRST!**



Please read this manual carefully before starting your journey

This manual contains general safety warnings, instructions and maintenance suggestions to better prepare you for the upcoming adventure! Follow the instructions to avoid injuries and fatalities.

Please keep this manual for future.

When giving / selling the board to others, make sure to also include this manual.

Contents

- 1 WARNINGS AND PRECAUTIONS**
- 2 PRODUCT & ACCESSORIES**
- 3 INFLATION**
- 4 DEFLATION & PACKING:**
- 5 WARRANTY**
- 6 Documents / Resources**
 - 6.1 References**
- 7 Related Posts**

WARNINGS AND PRECAUTIONS



Before you start:

- We recommend the SUP starters to wear a safety vest. In some region, the wearing of a safety vest is mandatory. Please check the local regulations and familiarize yourself with the local surroundings before use.
- Check the weather before you start and pay special attention to the following factors: Wind, wave, and tide. Do not use this item on windy days or on high waves. Do not use when the wind is blowing offshore or when the waves are moving offshore. It is possible that you got carried away (literally)!
- This item is suitable for swimmers only.
- This item is not for children under 14 years old. Teenagers should use this item under the supervision of adults.

- Before you start, check your board and the accessories carefully. Do not use the board when it's leaking air.
- Do not modify the board. Doing so will void the warranty of the board.
- Do not use this item when you are under the influence of alcohol, drugs, or medications.

When Using:

- Don't overrate your strength. Save your strength to make sure you have enough power to make it back to the shore effortlessly.
- When carrying the board, pay attention to the people around you.
- When using on water, pay attention to other watercrafts and surrounding people.
- When paddling, make sure that the weight on the board is always evenly distributed.
- It is recommended to paddle with partner(s).
- Do not smoke around your board.
- Do not operate sharp or pointy items around your board.
- Do not carry the board on vehicles when it is inflated.
- Use the leash to keep the board close to you and don't keep your board unattended. When falling from the board or leaving it on the water, the water may carry the board away so fast that it is impossible to retrieve.
- When the paddle is accidentally lost, stay on the board. It is still easier to paddle back with hand than to swim back.
- Foot Position: Stand in the middle of the board when paddling. On flat water, stand with your feet about shoulder width apart and face forward. When surfing on wavy water, take more of a surfer's stance with the dominant foot facing forward. Your feet should not be glued to the board; instead, you should be used to moving your feet around on the board. The sooner that you do this the more comfortable you will feel about doing turns and riding waves.

PRODUCT & ACCESSORIES

Please check the completion and condition of the accessories before using. If any item is found missing or defect, please contact us for replacement.

Features & Components

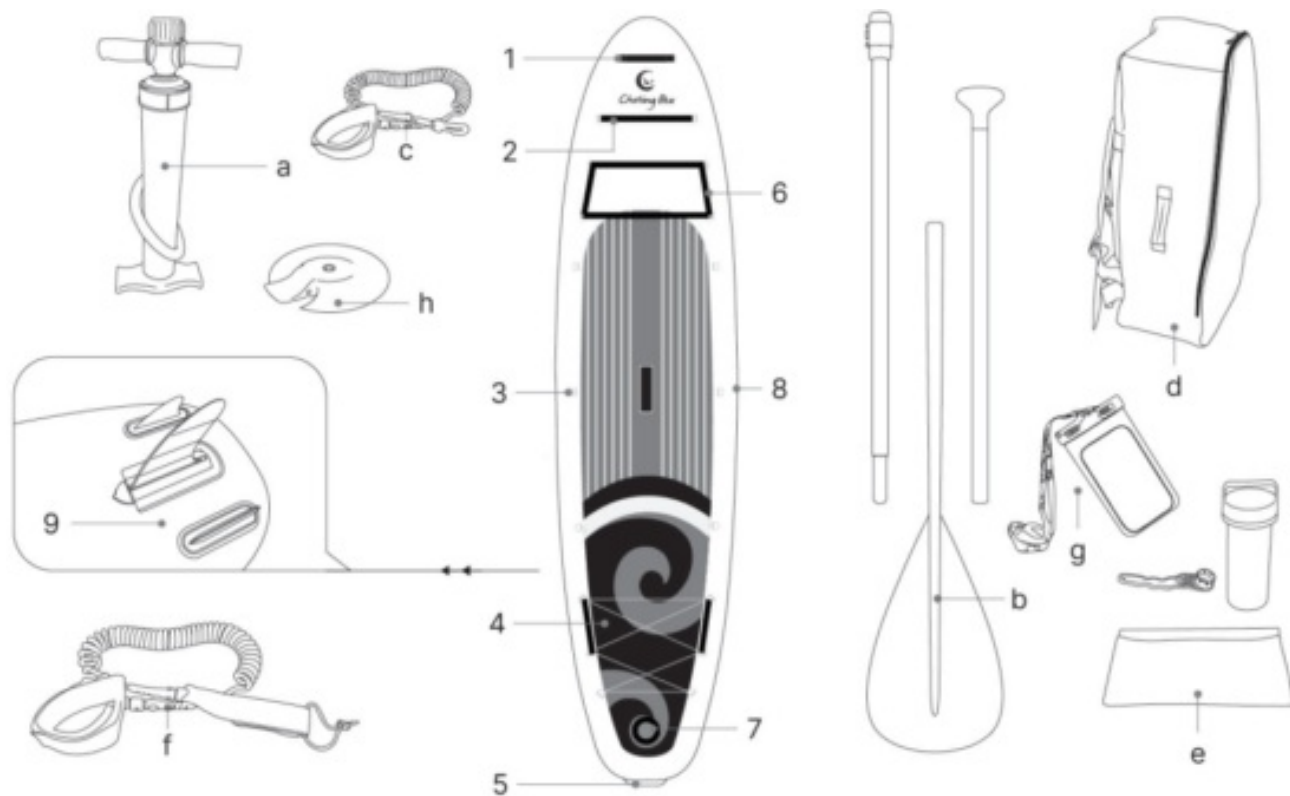

1. Foam Core Carry Handle
2. Extra Wide & Flat Bungee Carrying System
3. Multi-function Stainless Steel D-Rings
4. 6-Point Bungee Cargo System
5. Foam Core Carry Handle
6. Safety Grab Handle
7. Double Secured Valve
8. Enhanced Rail Tape
9. Touring Fins

- a:** High-pressure Air Pump
b: Stainless Steel Paddle
c: Paddle Leash
d: SUP Luggage Bag
e: Repair Kit
f: Coiled Leash
g.: Waterproof Cellphone Bag
h: Action Camera Mount

The illustration on this manual is for introduction only and does not necessarily represent the actual appearance of the product.

INFLATION

Step 1: Before Inflation

- Choose an open location to carefully unfold your board with the soft EVA pad facing upwards. Keep the board away from sharp or pointy items. Make sure all the components are fully functional. Check your board each

time before using to make sure that there is no leaking points or tears.

Step 2: Inflate Your Board

1. Open the valve cap counterclockwise.



2. Screw the pump hose onto the valve clockwise.



3. Begin to pump steadily. Do not inflate your board too fast. Pump until the gauge reads 10 to 15 psi. (Do not inflate your boards fully when the temperature is high)



4. Open the valve cap counterclockwise



5. If the valve is not closed, push the valve pin to close the valve.



6. Close the valve cap.



Step 3: Install the touring fins

1. Turn the board upside down and slide the fins into the sockets.



2. Secure the fins by inserting the safety lock.



DEFLATION & PACKING:

Deflate Your Board

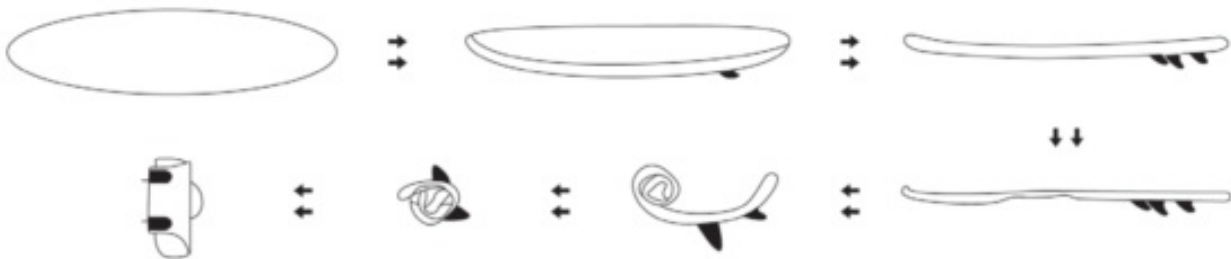

1. Put board on flat ground, then clean and dry it.
2. Press and turn the valve core 1/4 clockwise, the air will be out automatically.
3. Remove the fins.
4. Roll up the board, then squeeze the remaining air from valve core out.
5. Store the board into a backpack.

How to fix a leaking valve?

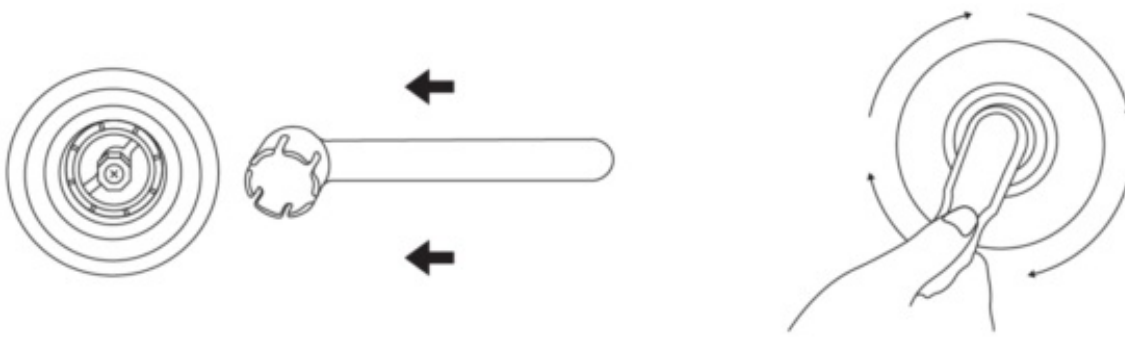

Take out the plastic wrench from the repair kit. Then insert the plastic wrench into the air valve and turn clockwise until it is locked firmly.

WARRANTY

We offer a two-year warranty on our boards and accessories starting from the day of purchase.

Our one-year warranty covers all the defects resulted from faulty material or product found broken when the customer first received it. The limited warranty does not cover any problem caused by natural disasters, damage due to the mishandle of the product, or any alternation by the customer on the structure of the board.

For customer service, please contact us via the following Email address or by visiting our website:

Customer Service Email: care@chasingblue.com

<http://www.chasingblue.com/>

Copyright Chasing Blue

Outdoor master (HK) Trading Limited
Room 517, New City Center, 2 Lei Yue Mun Road, Kwun Tong, Kowloon, HK

Documents / Resources

 <p>CHASING BLUE</p> <p>EN STAND UP PADDLEBOARD User Manual</p> <p>FR STAND UP PADDLEBOARD Remarque</p> <p>PT PLANCHAS DE STAND UP PADDLE Manual do usuário</p>	<p>CHASING BLUE iSUP Stand Up Paddle Board [pdf] Instruction Manual</p> <p>iSUP, Stand Up Paddle Board, iSUP Stand Up Paddle Board</p>
--	--

References

- [Chasing Blue](#)

