

Charniol B09WYPXDCS Smart Bedside Table USB Three Color Light



# Charniol B09WYPXDCS Smart Bedside Table USB Three Color Light Instruction Manual

[Home](#) » [Charniol](#) » Charniol B09WYPXDCS Smart Bedside Table USB Three Color Light Instruction Manual 

### Contents

- 1 Charniol B09WYPXDCS Smart Bedside Table USB Three Color Light
- 2 Product Information
- 3 Product Usage Instructions
- 4 Instructions for use
- 5 Documents / Resources
  - 5.1 References

# Charniol

## Charniol B09WYPXDCS Smart Bedside Table USB Three Color Light



### Product Information

**Specifications:**

- Fingerprint Lock
- Power Source: 3XAAA alkaline batteries
- Emergency Power Supply: Rechargeable battery or phone charger

**Product Usage Instructions**

Fingerprint Entry:

**Cautions:**

1. Make sure to add your fingerprint before use. The default factory setting allows any finger to unlock.
2. To ensure proper functioning, add a minimum of 3 fingerprints.

**Delete Fingerprint (Restore Factory Settings):**

1. Place the registered fingerprint on the sensor until the light turns green, then press and hold. The light turns green again, continue holding.
2. The green light will be on, followed by the red light flashing. Remove your finger when the red light flashes.
3. The green light will stay on for 2 seconds, indicating all fingerprints are deleted.

**Locked:**

Push up the drawer or close the cabinet door for automatic locking.

**Unlocking:**

1. Place any enrolled fingerprint on the sensor.
2. The green light will indicate successful unlocking.
3. Pull open the door.

**Electronic Key:**

1. Insert the electronic key.
2. Place any finger on the sensor to delete all fingerprints.
3. Pull out the electronic key, place any finger on the sensor to unlock the door.

**Low Power Warning:**

If the battery is low, a series of light signals will indicate insufficient power. Replace the battery immediately after unlocking.

**Emergency Power Supply:**

When the battery is low, connect a rechargeable battery or phone charger for external power supply. Replace the battery immediately after unlocking.

**Frequently Asked Questions (FAQ)**

**Q:** What type of batteries should be used with the fingerprint lock?

**A:** Use 3XAAA alkaline batteries; do not use carbon batteries for optimal performance.

## Instructions for use

### The method of fingerprint entry

1. Put your finger on the sensor, the green light comes on, the latch retracts, continue to press and hold the green light comes on again, the latch sticks out, keep it pressed, the green light comes on, and then remove the finger.
2. Blue light is on, put your finger on it green light is on, take your finger away.
3. Put the finger on and remove it after the green light repeat until the green light comes on for 2 seconds (fingerprint registration is successful).
4. Blue light is on to add more new fingerprints.

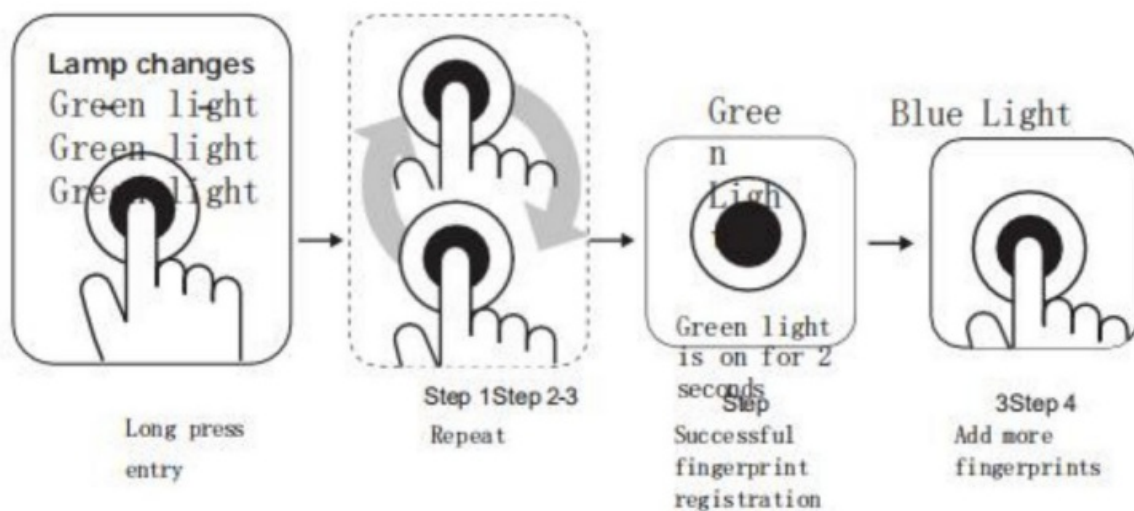

### Cautions

1. Make sure to add your fingerprint before use. The default factory setting is that any finger can be unlocked
2. To keep the lock working well, add no less than 3 fingerprints.

### Delete fingerprint (restore factory settings)

1. Put the registered fingerprint on the sensor, light green, press and hold, light green again, keep pressing 2 ) Green light is on and then red light is flashing, then take away the finger. 2 ) Green light for 2 seconds, all fingerprints are deleted.

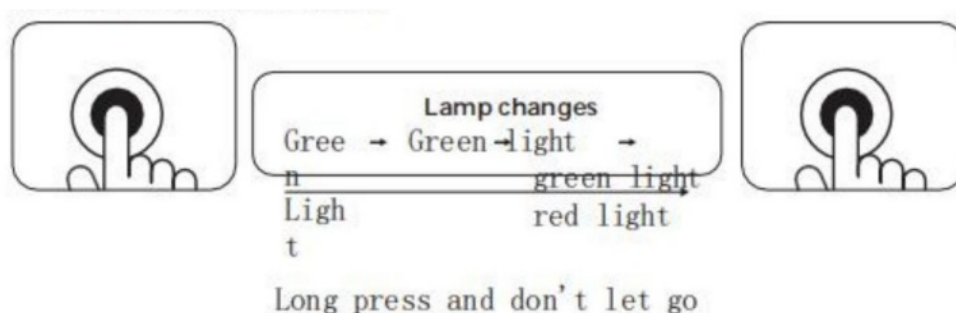

**Locked**

Push up the drawer or close the cabinet door and lock automatically

**Unlocking**

1. Place any enrolled fingerprints on the sensor.
2. The green light is on and the unlock is successful.
3. Pull open the door.

**Electronic key**

1. Insert the electronic key.
2. Place any finger on the sensor, the green light comes on and all fingerprints are deleted.
3. Pull out the electronic key, put any finger on the sensor, the green light comes on, the lock opens, and pull open the drawer or cabinet door.

**Low power warning**

If the battery is low, the green light flashes once when opening the lock, then the red light flashes three times (indicating insufficient power) then the green light comes on and unlocks. Replace the battery immediately after opening the door.

**Note:** Use 3XAAA alkaline batteries, not use carbon batteries.

**Emergency power supply**

When the battery is low, connect a rechargeable battery or phone charger for external power supply. Replace the battery immediately after unlocking

