



Channel Vision A4603 4-input 6-zone Matrix AV Controller Manual Instructions

[Home](#) » [Support](#) » Channel Vision A4603 4-input 6-zone Matrix AV Controller Manual Instructions 

Contents

- 1 Channel Vision A4603 4-input 6-zone Matrix AV Controller
- 2 FREQUENTLY ASKED QUESTIONS

CHANNEL VISION

Channel Vision A4603 4-input 6-zone Matrix AV Controller



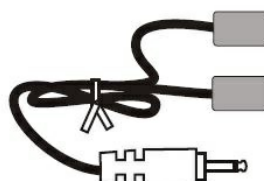
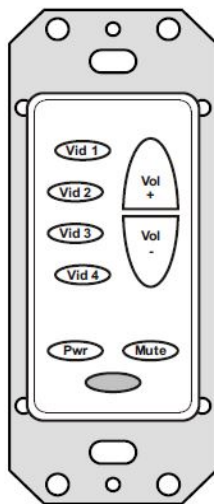



CAUTION
RISK OF ELECTRIC SHOCK
DO NOT OPEN

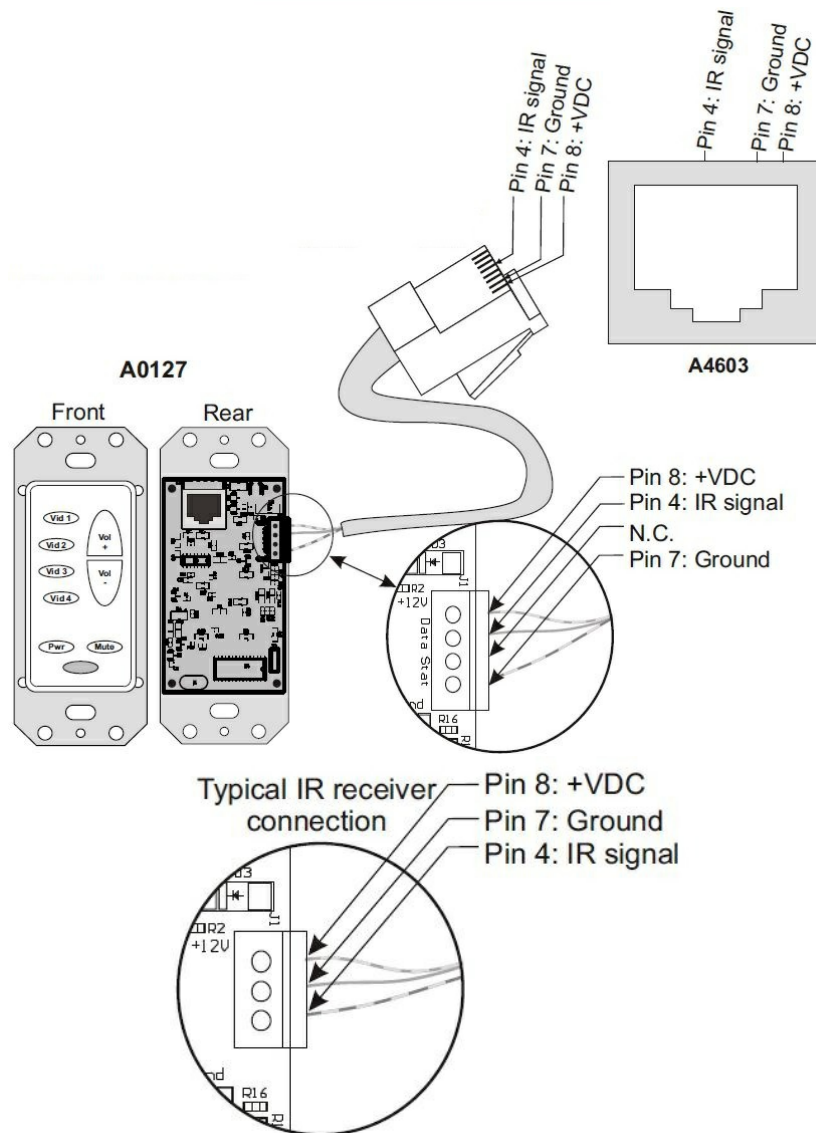

A4603 Rear Panel

Each zone is controlled through the A0127 keypad which connects to the RJ45 jacks on the rear panel. See page 4 for connection details

Connect serial data controller to the Serial port (Hex codes on pages 8-11)

Power switch

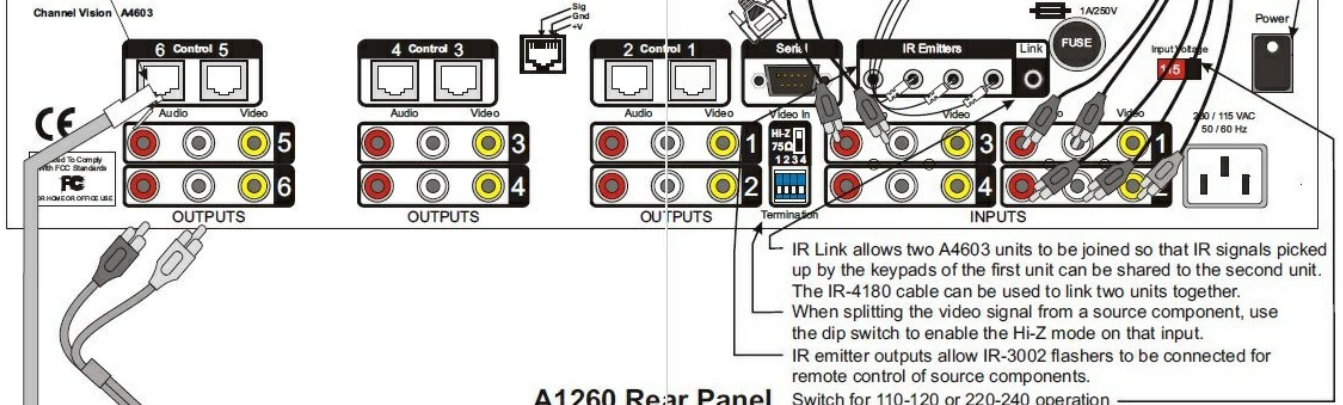

A1260 Rear Panel

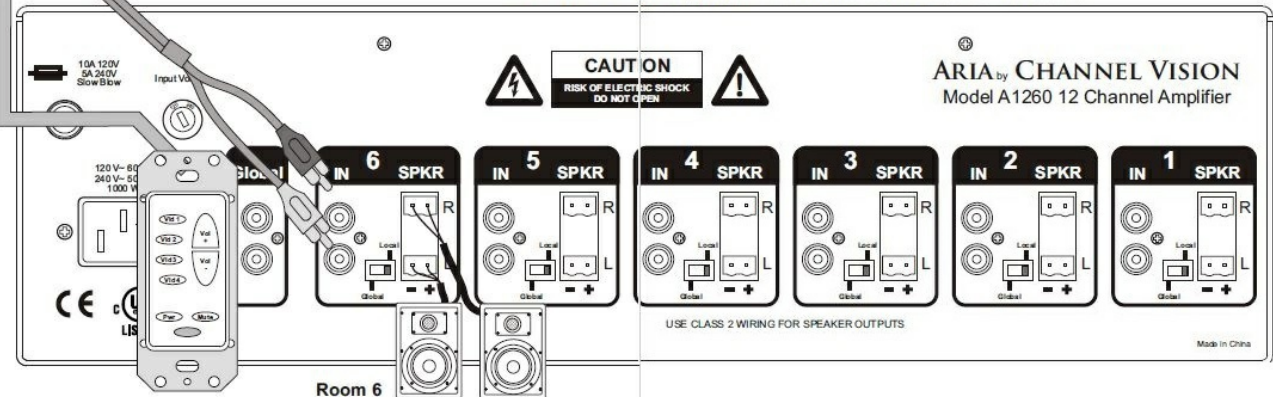

A4603 RS-232 Pins
DB-9P, Female

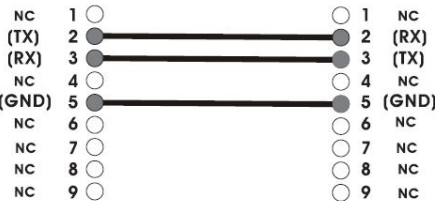
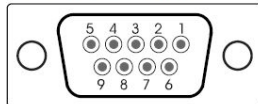

PC RS-232 Pins
DB-9P, Male

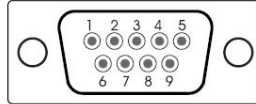

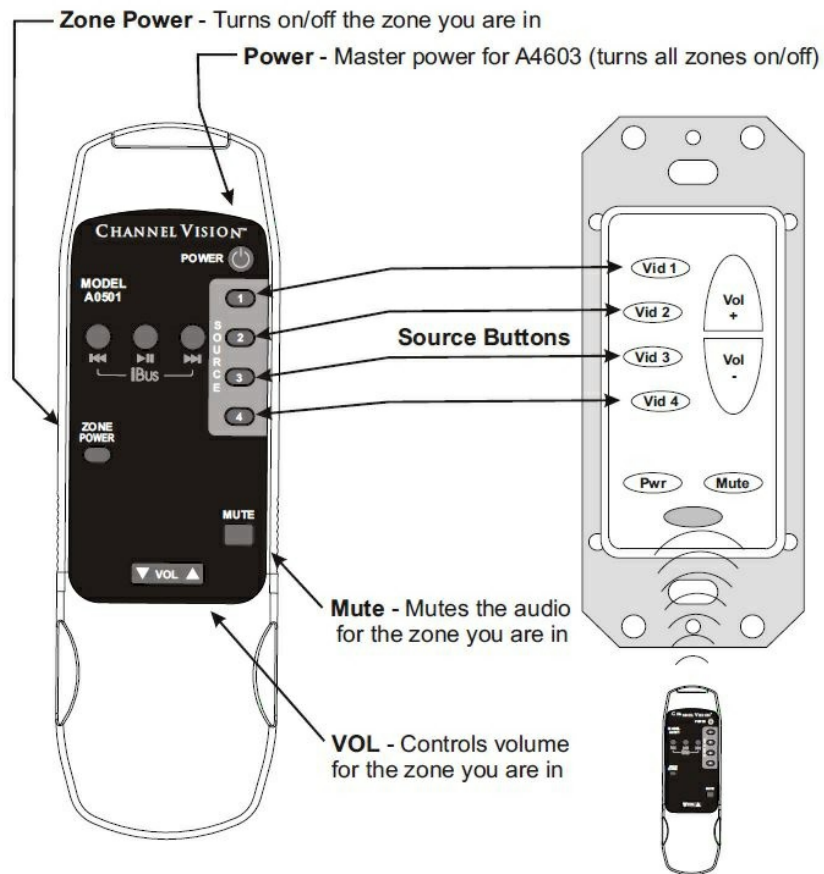

FREQUENTLY ASKED QUESTIONS

Download the PDF Link: [Channel Vision A4603 4-input 6-zone Matrix AV Controller Manual Instructions](#)