



Chandasung Tech S10 True Wireless Earbuds User Manual

[Home](#) » [Chandasung Tech](#) » Chandasung Tech S10 True Wireless Earbuds User Manual 

Contents

- [1 Chandasung Tech S10 True Wireless Earbuds](#)
- [2 PACKING LIST](#)
- [3 PRODUCT OVERVIEW](#)
- [4 Earbuds Charging](#)
- [5 Charging Case Charging](#)
- [6 Power On/off](#)
- [7 Specifications](#)
- [8 Bluetooth Connection](#)
- [9 Factory Restore Setting](#)
- [10 Multi-function Operations](#)
- [11 How To Sync Volume On Android?](#)
- [12 FCC](#)
- [13 Documents / Resources](#)
- [14 Related Posts](#)

Chandasung Tech

Chandasung Tech S10 True Wireless Earbuds



Customer Service

Email: amz@boloxa.ltd

WhatsApp: (+86) 1392 3490 475

Web: (www.boloxa.ltd)

PACKING LIST



Charging Case *1

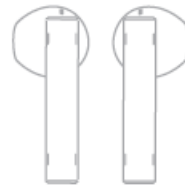

Earbuds *1 Pair



Type-C Charging
Cable *1



User Manual *1

PRODUCT OVERVIEW

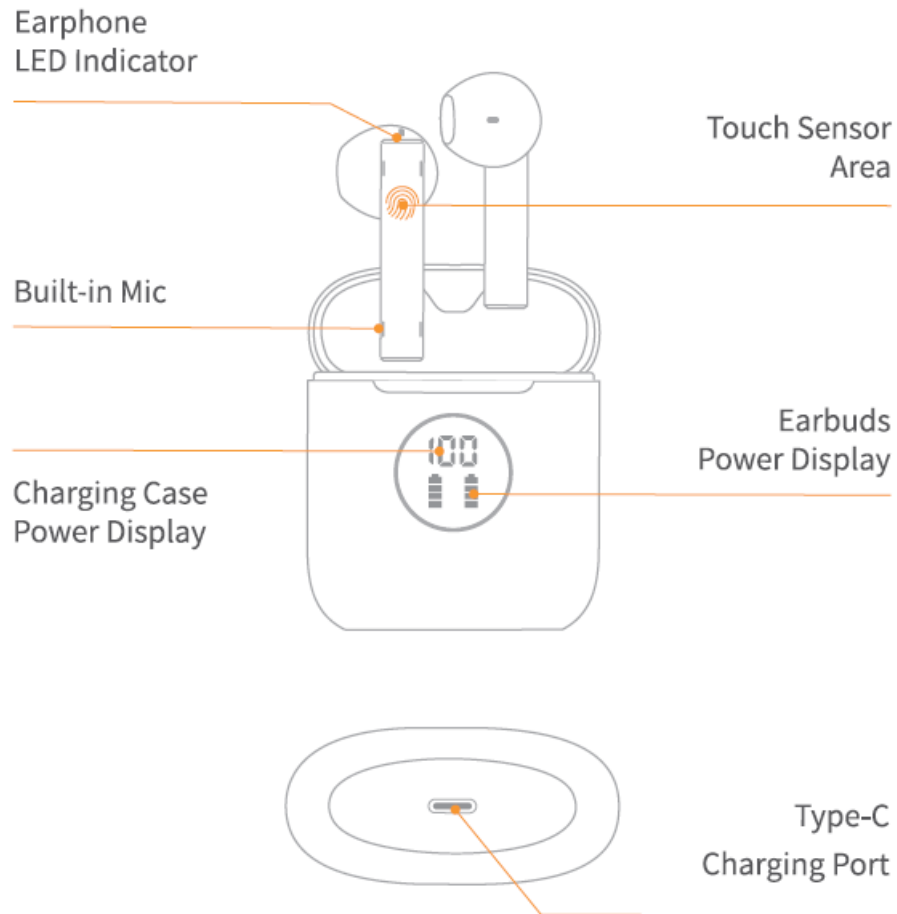

Earbuds Charging

To Charge Earbuds

Put the earbuds back into the box and close the lid to charge the earbuds.

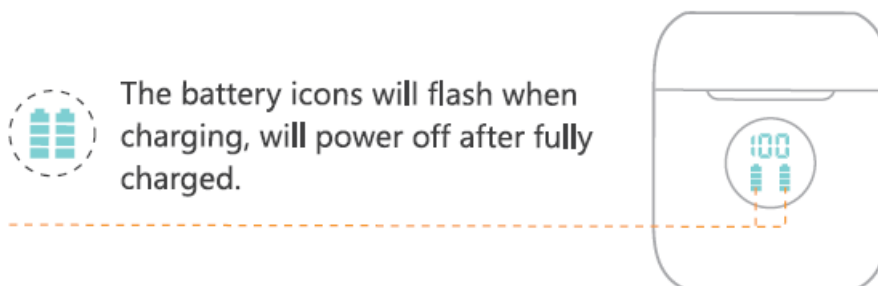

Low Battery Alarm

When the battery is less than 109% (and the voltage is lower than 3.4V), a prompt voice “Battery level low” will be advised. The white light flashes 1 time in 5 secs.

(Prompts voice once every 5 minutes), then the earbuds will power off normally.

Charging Case Charging

Type-C Cable Charging

(There is a Type-C charging cable in the small black paper box inside the packing box.)

Please Use the provided Type-C cable with a 5V/1A adapter (not included) to charge the charging case.

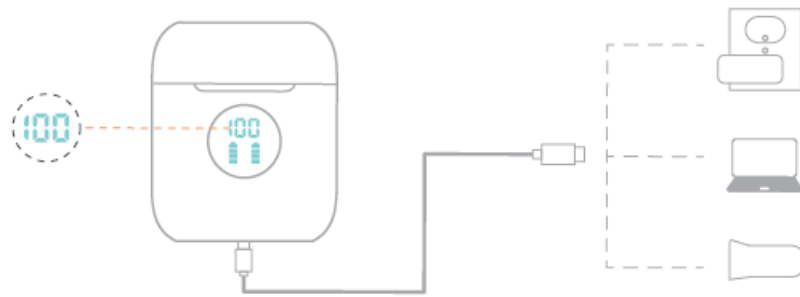

During charging, the charging case power display will show the battery in real time. The number will be display as 100 when fully charged.

Tips:

If the earbuds don't charge or even can't tun on, that may because there is oxidized layer or something else on the charging connector or charging pin.

You can solve this problem by cleaning the magnet connector on the earbuds and charging pin on the charging case with alcohol wipes

Power On/off

Auto Power On

The earbuds power on automatically when you open the lid of the charging case.

Auto Power Off

Put the earbuds back into charging case and close the lid, theywill disconnect& power off automatically.

Manually Power On

If the earbud is out of the charging case and power off, then press&hold it for 3s, it will power on

Manually Power Off

Disconnect the Bluetooth with your device, press & hold either earbud for 5s, both earbuds will power off at the same time.

Note: If the earphones are not connected to any device over 5 minutes, they will power off automatically.

Specifications

Earbud (each)

- **Model Name:** S10
- **Bluetooth Version:** V5.3
- **Battery Capacity:** 40mAh
- **Size:** 39.9*16.9*17.8mm
- **Charging Time:** 2H
- **Support:** AVRCP/HFP/HSP/A2DP
- **Bluetooth Range:** 33feet (without obstacle)



Charging Case

- **Size:** 47.9*22.5*57mm
- **Charging Port:** Type-C
- **Batter Capacity:** 400mAh
- **Charging Time:** 2H



Bluetooth Connection

Prior to first use (or not in use for long time), please charge both earbuds and charging case fully.

First Time Pairing

Step 1-Open the lid of charging case, two earbuds will automatically power on and enter pairing mode. (At this time, the indicator light of both earbuds will turn white and flash fast)

Step 2-Activate Bluetooth setting on your phone, search and connect "S10".

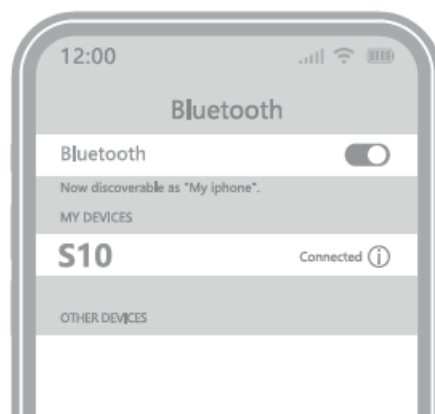

Note: If the earbuds are not connected to your device over 5 minutes, the earbuds will power off automatically.

For Second Time Use

If the headphones have already connected with your device, and the Bluetooth setting of this device is on, in the second time using, when you open the charging case, they will automatically connect to your device.

Pair with Other Device

S10 True Headphones Bluetooth has memory function, it usually auto connects with the last paired device. Thus, if you want to pair them with other device, you should disconnect "S10" from the last paired device, AND forget the pairing record on the last device. Then try to connect it to a new device, it should work properly.

Mono Mode (Only Left/Right Earbud is being Used)

You can use one earbud alone, leave the other earbud in the charging case.

When in Dual mode, put one earbud into the charging case.

Or only take one earbud out of the charging case, then search & connect "S10" on your device.

Factory Restore Setting

When should I do reset?

When only one side play music.

When you can't find "s10" on the device.

When both earbuds fail to pair with each other or occur connection related issues.

How to reset?

1. Delete the Bluetooth settings on your phone and forget about "S10" in the menu.
2. Take out the two head phones from the charging case, press and hold either earbud for 5 secs, it will flash the white light and then power off.
3. Press&hold both earbuds 8 secs simultaneously, then put the earbuds back into the charging case and close the lid. (Both earbuds will flash fast with white light on a long time, then flash slowly three times and keep it on for 3 secs)
4. Now open the charging case and turn on the Bluetooth on your device, search and connect "S10", they should work properly.

Note: If it still doesn't work, please repeat the steps to try again.

Multi-function Operations

For Call

- **Answer Call:** Quick Double-Tap
- **End Call:** Quick Double-Tap
- **Reject Call:** Long Press 2s

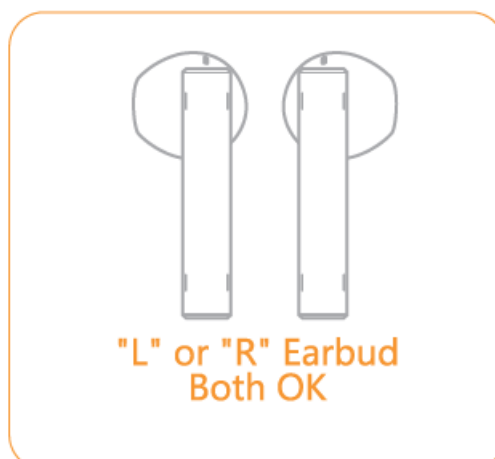

Voice Assistance

Activate Siri or other voice

assistants: Quick Triple-Tap

(Must in non-music mode or standby mode)



For Music

[Functions on "R Earbud"]

Play/Pause: Quick Double-Tap

Next Track: Quick Triple-Tap

Volume+ Long Press & Hold

(In single mode, "R" Earbud only support next song and Volume +)



"R" Earbud

[Functions on "L Earbud"]

Play/Pause: Quick Double-Tap

Previous Track: Quick Triple-Tap

Volume- Long Press & Hold

(“In single mode, “L” Earbud only support Previous song and volume -)

Note: Prompt sound “Du” will be produced when the volume reach minimum or maximum level.



"L" Earbud

How To Sync Volume On Android?

To protect users from potential hearing damage, Android's limit on max volume is quite low for Bluetooth audio devices.

If you feel the volume is too low, please access developer options and enable absolute volume, so you'll be able to max the E volume at your own volition and to the full capabilities of your Bluetooth earphones.

(Scan this QR code to watch a video to learn UVA more details.)



Find Build Number Firstly

- **Android 4.1 and lower:** the Developer options screen is available by default.
- **Android 4.2 and higher:** the Developer options in Android phones are hidden, you must enable this screen through Build Number.
- **Android 7.1 and lower:** Settings > About Phone > Build Number
- **Android 8.0.0 and Android 8.1.0:** Settings> System >About Phone> Build Number
- **Android 9 and higher:** Settings>About Phone >Build Number

Enable Developer Options

Locate the Build number and tap it about 7 times in succession to enable Developer options. You may also have to tap in your PIN for verification. Once developer options are activated, you will see a message that reads "You are now a developer"

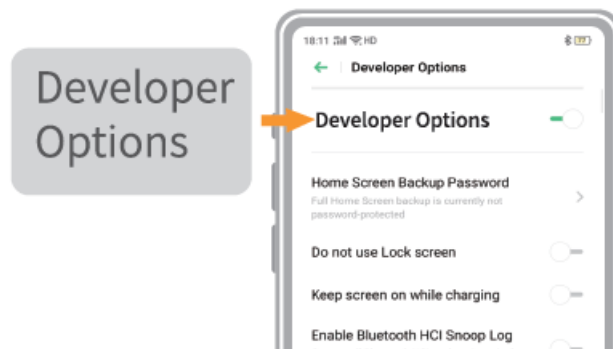

(figure 1)

Enable Absolute Volume

Scroll down until you reach the Networking section. Once there, enable (toggle ON) the absolute volume options as figure 2.



(figure 2)

Note: These options in the figure 2 maybe different from the evice you’re using. Typically, the choices depend on the type and model of the device you are working with.

FCC

NOTE :This equipment has been tested and found to comply with the limits for a Class B digital device, pursuant to part 15 of the FCC Rules. These limits are designed to provide reasonable protection against harmful interference in a residential installation. This equipment generates uses and can radiate radio frequency energy and, if not installed and used in accordance with the instructions, may cause harmful interference to radio communications. However, there is no guarantee that interference will not occur in a particular installation. If this equipment does cause harmful interference to radio or television reception, which can be determined by turning the equipment off and on, the user is encouraged to try to correct the interference by one or more of the following measures:

- Reorient or relocate the receiving antenna.
- Increase the separation between the equipment and receiver.
- Connect the equipment into an outlet on a circuit different from that to which the receiver is connected.
- Consult the dealer or an experienced radio/TV technician for help.

Changes or modifications not expressly approved by the party responsible for compliance could void the user’s authority to operate the equipment.

FCC ID: 2AQK8-S10

Documents / Resources

	Chandasung Tech S10 True Wireless Earbuds [pdf] User Manual S10, 2AQK8-S10, 2AQK8S10, S10 True Wireless Earbuds, S10, True Wireless Earbuds, Wirele ss Earbuds, Earbuds
---	---