



# CHAMPION 201049 4500W Open Frame Inverter Generator User Guide

[Home](#) » [Champion](#) » CHAMPION 201049 4500W Open Frame Inverter Generator User Guide 

## **CHAMPION** GLOBAL POWER EQUIPMENT 201049 4500W Open Frame Inverter Generator User Guide



### Contents

- [1 Set Up / Montaje](#)
- [2 Start-Up](#)
- [3 Documents / Resources](#)
- [4 Related Posts](#)





## Set Up / Montaje

**Open shipping carton.**  Assembly > Unboxing

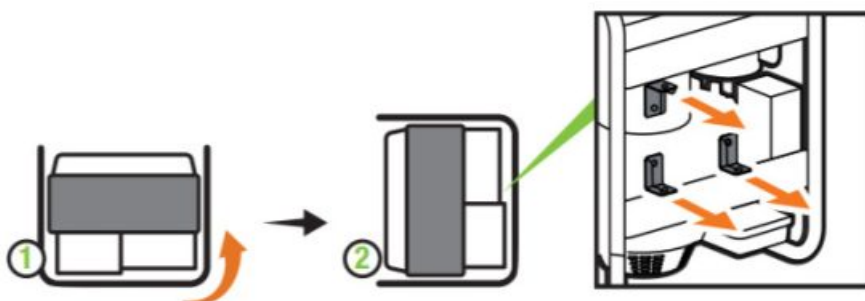

**Remove brackets.**  Assembly > Remove Shipping Support Brackets.



**Add oil.**  Assembly > Add Engine Oil.  
Recommended: 10W-30, up to 18.6 fl. oz. (550 ml) DO NOT overfill.

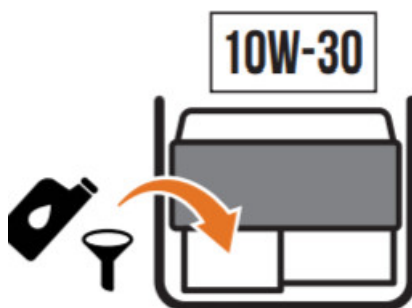

**MAKE SURE SHIPPING BRACKETS ARE REMOVED BEFORE ADDING OIL.**

**Move the generator outdoors.**

Move generator to an open, outdoor area.  
Point exhaust away. Never run a generator in enclosed areas (e.g., not in house or garage).



Keep all objects at least 5 feet (1.5 m) from the generator. Heat from the muffler and exhaust gas can ignite combustible materials.



## Start-Up

**Add fuel.**  Assembly > Add Fuel

**DO NOT** use E15 or E85.



**DO NOT** plug in any electrical devices.



**NEVER** START OR STOP THE GENERATOR WITH ELECTRICAL DEVICES CONNECTED OR TURNED ON!

Turn the **EZ Start dial** to the “CHOKE” position.



Pull the **recoil** to start the engine.



Turn the **EZ Start dial** to the “ON” position.



**Plugin.**  Operation > Connecting Electrical Loads.



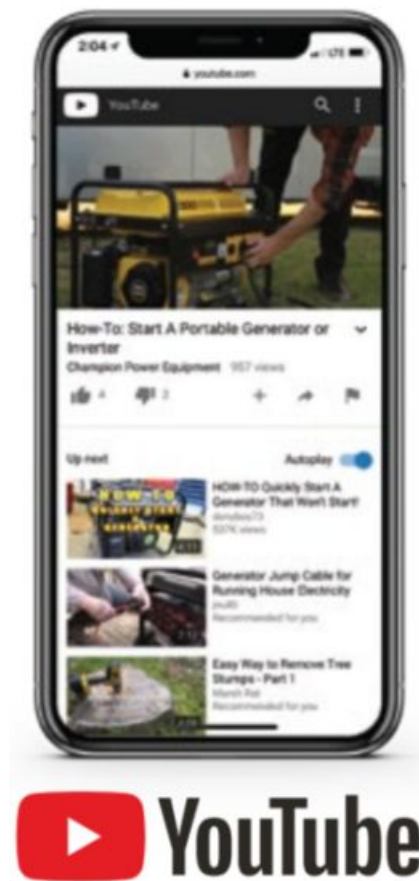

Visit our YouTube channel to watch our how-to videos and subscribe to view our latest videos on our Champion Power Equipment products!



#### **WARNING:**

Read the ENTIRE operator's manual to become familiar with the features of the product before operating. Failure to operate the product correctly can result in damage to the product, personal property and cause serious injury or even death.

NEED ASSISTANCE OR HAVE A QUESTION?  
GIVE US A CALL.



**1-877-338-0999**

[CHAMPIONPOWEREQUIPMENT.COM](http://CHAMPIONPOWEREQUIPMENT.COM)

## **Documents / Resources**

	<p><a href="#">CHAMPION 201049 4500W Open Frame Inverter Generator</a> [pdf] User Guide 201049, 4500W Open Frame Inverter Generator</p>
---	---