



Chacon Connected Shutter Switch DiO Connect User Manual

[Home](#) » [CHACON](#) » Chacon Connected Shutter Switch DiO Connect User Manual 

Contents



- [1 Chacon Connected Shutter Switch DiO Connect](#)
- [2 WHAT'S IN THE BOX](#)
 - [2.1 Video tutorial](#)
- [3 Install the shutter switch](#)
- [4 Linking the switch with a control Dio 1.0](#)
- [5 Add the switch to the application](#)
- [6 Reset the switch](#)
- [7 Use](#)
- [8 Problem-solving](#)
- [9 Technical specifications](#)
- [10 Supplementing your installation](#)
- [11 Documents / Resources](#)
 - [11.1 References](#)
- [12 Related Posts](#)



Chacon Connected Shutter Switch DiO Connect

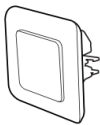

WHAT'S IN THE BOX

			
	1x Rev-Shutter	2x	1x manual

WiFi Shutter Switch & 433MHz

Video tutorial

We have produced a series of video tutorials to make it easier to understand and install our solutions. You can see them on our [Youtube.com/c/dio-connected-home](https://www.youtube.com/c/dio-connected-home) channel, under Playlists.

Install the shutter switch

This product must be installed in accordance with the installation rules and preferably by a qualified electrician. Incorrect installation and / or incorrect use may cause risk of electric shock or fire.

Cut the power supply before any intervention.

Connect the switch Fig.1

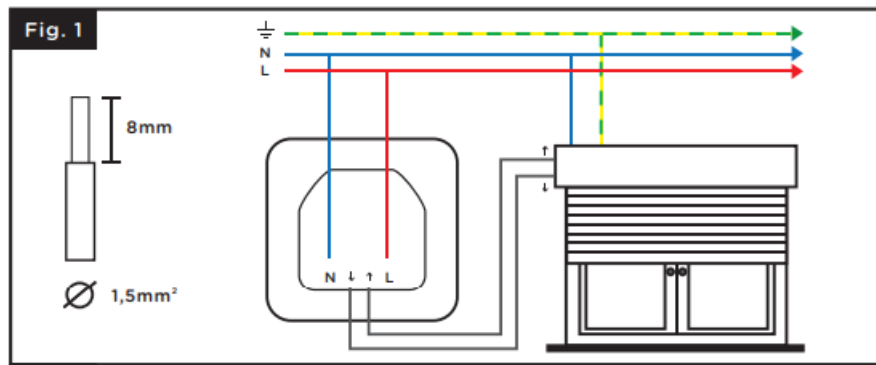

- Remove your mechanical switch.
- Strip around 8mm cables to have a good contact surface.

Attach the switch to the wall Fig.2

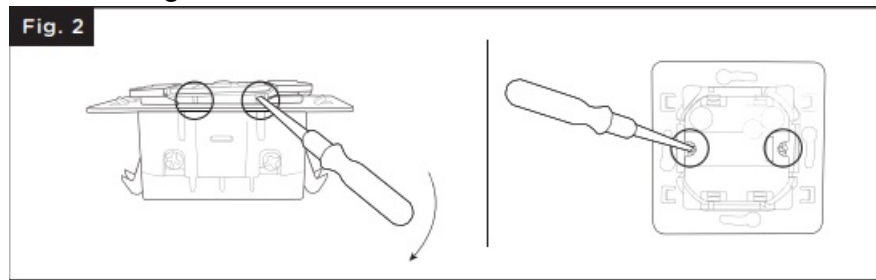

- using the provided claws
- To access the claws, remove the front module with a small flat screwdriver by pushing inwards at the 2 lower notches. Remove the claws from their location and tighten the 2 screws to secure the switch.
- using 2 screws not supplied
- Attach the switch to your flush mount box using 2 screws not included.

Linking the switch with a control Dio 1.0

Fig.3

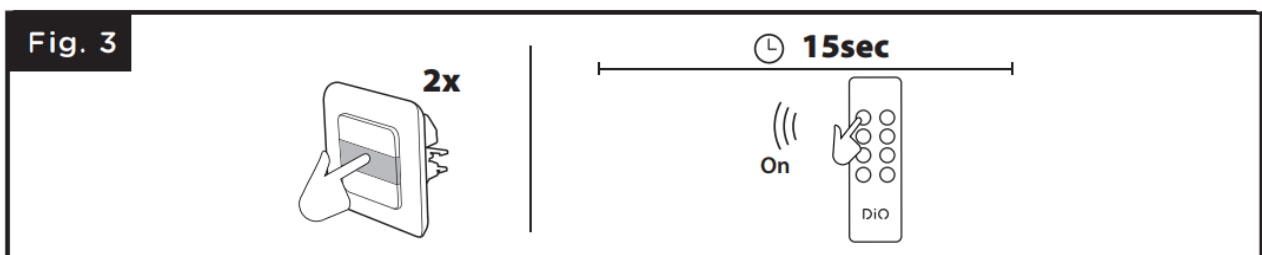

- **This product is compatible with all dio 1.0 devices:** remote control, switches, and wireless detectors.

1. Press the central button twice quickly, the LED starts to flash slowly in light green.
2. Within 15 seconds, press the 'ON' button on the remote control, the switch LED flashes light green quickly to confirm the association.

- **Warning:** If you do not press the 'ON' button on your control within 15 seconds, the switch will exit learning mode; you must start from point 1 for the association.

The switch can be linked up to 6 different DiO commands. If the memory is full, you will not be able to install a

7th command, see paragraph 2.1 to delete an ordered

Deleting the link with the DiO control device

If you want to delete a control device from the switch :

- Press the central button of the switch twice quickly, the LED will start to flash slowly in light green.
- Press the 'OFF' button of the DiO control to be deleted, and the LED flashes light green rapidly to confirm the deletion.

To delete all registered DiO control devices :

- Press during 7 seconds the pairing button of the switch, until the LED indicator turns purple, then release.

Add the switch to the application

Create your DiO One account Fig.4

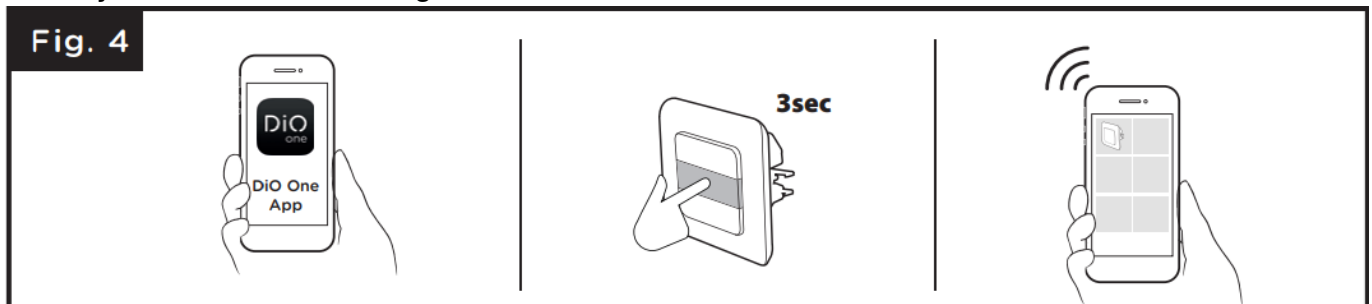

- Download the free DiO One app from the iOS App Store or Google Play for Android.
- Create an account by following the instructions on the app.
- Also compatible with the “my Chacon” app.

Connect the switch into the Wi-Fi network

- In the application, select “My devices”, click “+” and then “ Install the Connect Wi-Fi device”.
- Select the “DiO Connect shutter switch”.
- Power up the DiO switch and press the switch central button during 3 seconds, the LED indicator flashes quickly red.
- Within 3 minutes, click “Install the Connect Wi-Fi device” in the app.
- Follow the installation wizard in the application.

Warning: In case the Wi-Fi network or password is changed, press the pairing button 3 seconds and in the app press long in the device icon. Then follow the instruction in the application to update the Wi-Fi.

Disable Wi-Fi from the switch

- Press 3 secs on the central button, release, and click twice to disable the switch Wi-Fi.
- When Wi-Fi is off, the switch's LED will appear purple. Press again for 3 seconds, release and double-click to turn on the Wi-Fi and to control your shutter with your smartphone

Note: The timer created through your smartphone will still be active.

Switch light status

- Steady red: switch is not connected to the Wi-Fi network
- Flashing blue: switch is connected to the Wi-Fi
- Steady blue: switch is connected into the Cloud, turns to white after few seconds
- Steady white: switch on (it can be switch off through the app – discreet mode)
- Steady purple: Wi-Fi disabled
- Flashing green: update download

Connect with your vocal assistant

- Activate the “One 4 All” service or skill in your voice assistant.
- Enter your DiO One account information.
- Your devices will automatically appear in your assistant’s application.
- You can also use Siri on your iPhone to open or close your shutter. To create a Siri shortcut, simply go to the “Settings” menu and “Siri Shortcuts” in the DiO One app.

Reset the switch

- Press during 12 seconds the pairing button of the switch, until the LED flashes light blue, then release. The LED will blink red twice to confirm the reset.

Use

- **With the remote control / DiO switch :**
- Press the “ON” (“OFF”) button on your DiO control to open (close) the electric shutter. Press a second time corresponding to the first press to stop the shutter

On the switch :

- Up/down the shutter by pressing the corresponding button once.
- Press the central button once to stop. With your smartphone, via DiO One:
- Open/close from anywhere
- **Create a programmable timer:** set it to the nearest minute with a precise opening (for example 30%), select the day (s) of the week, single or repeated timer.
- **Create a countdown:** the shutter closes automatically after the allotted time.
- **Presence simulation:** select the duration of absence and the switch-on periods, the switch will open and close randomly to protect your home.

Problem-solving

- The shutter does not open with a DiO control or detector:
- Check that your switch is properly connected to the electric current.
- Check the polarity and/or the exhaustion of the batteries in your order. Check that the stops of your shutter are correctly adjusted.
- Check that the memory of your switch is not full, the switch may be linked to maximum 6 DiO commands (remote control, switch and / or detector), see paragraph 2.1 to place an order.
- Make sure you are using a command using the DiO 1.0 protocol.
- The switch does not appear on the app interface:

Check the light state of the switch:

- **Red LED:** check the status of the Wi-Fi router.
- **Flashing blue LED:** check internet access.
- Ensure that the Wi-Fi and Internet connection is functional and that the network is within range of the switch.
- Make sure the Wi-Fi is on a 2.4GHz band (does not work in 5GHz).
- During configuration, your smartphone must be on the same Wi-Fi network as the switch.
- The switch can only be added to an account. A single DiO One account can be used by all members of the same household.
- **Important:** A minimum distance of 1-2 m is necessary between two DiO receivers (module, plug, and/or bulb). The range between the switch and the DiO device may be reduced by the thickness of the walls or an existing wireless environment.

Technical specifications

- **Protocol:** 433,92 MHz by DiO
- **Wi-Fi frequency:** 2,4GHz
- **EIRP:** max. 0,7 mW
- **Transmission range with DiO devices:** 50m (in free field)
- Max. 6 associated DiO transmitters
- **Operating temperature:** 0 à 35°C
- **Power supply:** 220 – 240 V – 50Hz
- **Max.:** 2 X 600W
- **Dimensions :** 85 x 85 x 37 mm
- Indoor use (IP20). Do not use in a damp environment Alternating current

Supplementing your installation

Supplement your installation with DiO solutions to control your heating, lighting, roller shutters, or garden, or use video surveillance to keep an eye on what is happening at home. Easy, high-quality, scalable, and economical... learn about all of the DiO Connected Home solutions at www.chacon.com

- **Recycling**

Don't throw batteries or out of order products with the household waste (garbage). The dangerous substances that they are likely to include may harm health or the environment. Make your retailer take back these products





or use the selective collect of garbage proposed by your city.

- Hereby, Chacon declares that the radio equipment type Rev-Shutter is in compliance with Directive 2014/53/EU. The full text of the EU declaration of conformity is available at the following internet address:
<https://www.chacon.com/conformity>
- Support www.chacon.com/support V1.1 220207

Documents / Resources

	<p>Chacon Connected Shutter Switch DiO Connect [pdf] User Manual Connected Shutter Switch DiO Connect, Shutter Switch DiO Connect, Switch DiO Connect, DiO Connect, Connect</p>
---	---

References

-  [Shop for Chacon and Dio products](#)
-  [Contact us](#)
-  [Info-tri | Ministères Écologie Énergie Territoires](#)
-  [Downloads](#)