

Contents [[hide](#)]

- [1 centsys D6 SMART Origin Sensor and Marker](#)
- [2 Product Information](#)
- [3 SMART ORIGIN SENSOR AND MARKER QUICK GUIDE](#)
- [4 Connecting the Origin Sensor](#)
- [5 Mounting the Origin Marker](#)
- [6 FAQ](#)
- [7 Documents / Resources](#)
 - [7.1 References](#)

centsys

centsys D6 SMART Origin Sensor and Marker



Product Information

Specifications

- Model: SMART ORIGIN SENSOR AND MARKER
- Standard: ISO 9001:2015
- Doc Number: 1401.D.01.0008_2
- SAP Code: DOC1401D0108

SMART ORIGIN SENSOR AND MARKER QUICK GUIDE



Connecting the Origin Sensor

Place the Origin Sensor into its dedicated slot found just above the Pinion on the Lower Battery Tray.

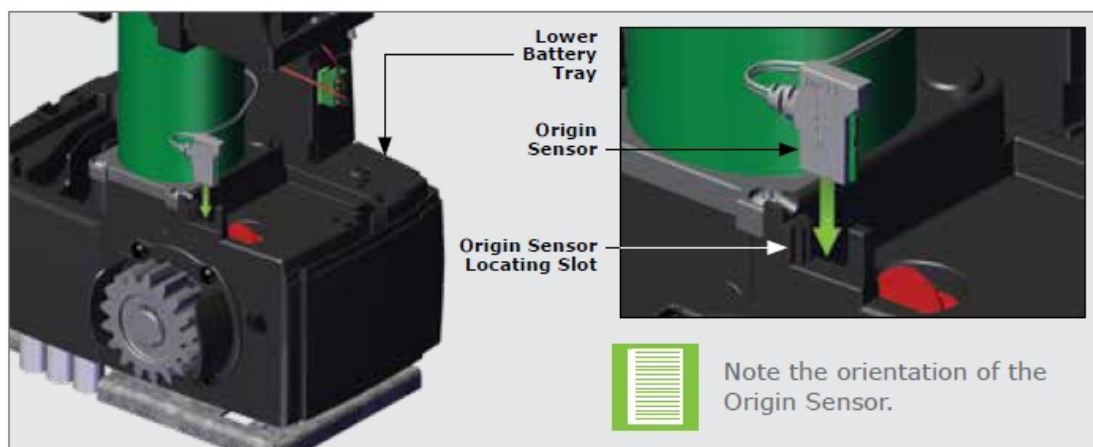

FIGURE 1

Route the Harness around the electric motor to the front of the SMART Gate Motor, and through the cable retainers found in front of the Control Card.

Connect the Harness to the white “Origin” Terminal found on the Control Card.

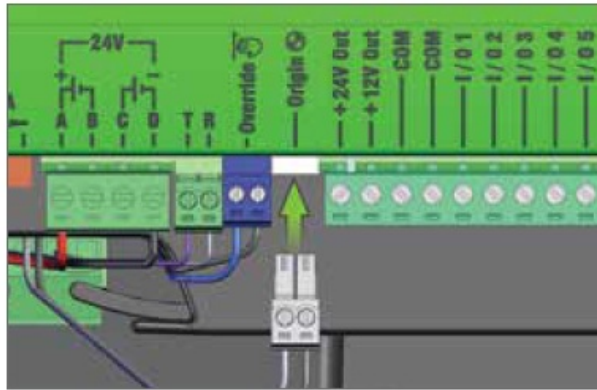

FIGURE 2

Mounting the Origin Marker

Firstly, close the gate completely.

Mount the Origin Marker to the rack a minimum of 500mm from the Origin Sensor. Refer to Figure 3.

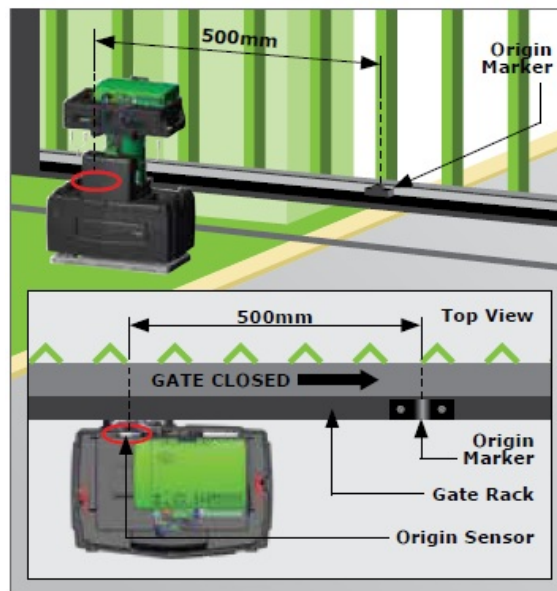

FIGURE 3

It is possible to make the distance between the Marker and the Sensor much greater than 500mm. However, if using the pedestrian opening facility, although the position of the Marker will not affect the width of the pedestrian opening, it is preferable to have the Marker mounted inside of the pedestrian opening point. This ensures that the system remains synchronised / calibrated.

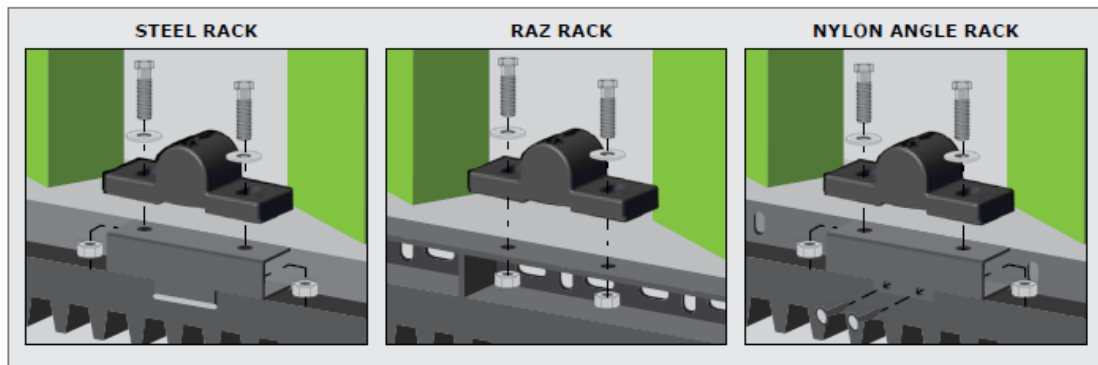

FIGURE 4

Note the orientation of the Origin Marker in Figures 4 and 5.

- Manually slide the gate open until the Origin Marker is in line with the Origin Sensor.
- Ensure the distance between the face of the Marker and front face of the Sensor is between 10 and 20mm.
- Adjust distance by sliding the Origin Marker along the slotted mounting holes until the specified distance is achieved.

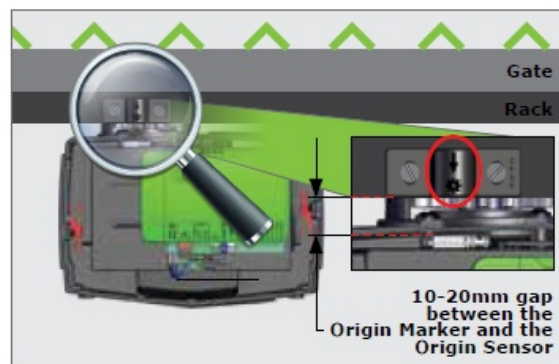

FIGURE 5

- In order to set up the Origin functionality, run the Limits setup in the MyCentsys Pro application.

Doc number: 1401.D.01.0008_2 SAP Code: DOC1401D0108

FAQ

- **Q: How can I calibrate the system if the gate does not close properly?**

A: If you are experiencing issues with gate closure, ensure that the Origin Marker and Sensor are properly aligned and within the specified distance range of 10-20mm. You may need to adjust the mounting position of the Origin Marker to achieve proper calibration.

Documents / Resources

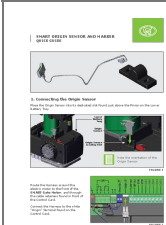

[centsys D6 SMART Origin Sensor and Marker \[pdf\]](#) User Guide
D6 SMART, D3 SMART, D6 SMART Origin Sensor and Marker, D6 SMART, Origin Sensor and Marker, Sensor and Marker, Marker

References

- [User Manual](#)

CENTSYS

CENTSYS, D3 SMART, D6 SMART, D6 SMART Origin Sensor and Marker, Marker, Origin Sensor and Marker, Sensor and Marker

—Previous Post

CENTSYS D-SERIES Smart Accessories Owner’s Manual

Leave a comment

Your email address will not be published. Required fields are marked *

Comment *

Name

Email

Website

☐ Save my name, email, and website in this browser for the next time I comment.

[Post Comment](#)

Search:

[Search](#)

[Manuals+](#) | [Upload](#) | [Deep Search](#) | [Privacy Policy](#) | [@manuals.plus](#) | [YouTube](#)

This website is an independent publication and is neither affiliated with nor endorsed by any of the trademark owners. The "Bluetooth®" word mark and logos are registered trademarks owned by Bluetooth SIG, Inc. The "Wi-Fi®" word mark and logos are registered trademarks owned by the Wi-Fi Alliance. Any use of these marks on this website does not imply any affiliation with or endorsement.