



CENTEGIX CrisisAlert Intercom Device Installation Guide

[Home](#) » [CENTEGIX](#) » CENTEGIX CrisisAlert Intercom Device Installation Guide 

Contents

- [1 CENTEGIX CrisisAlert Intercom Device](#)
- [2 Product Information](#)
- [3 Product Usage Instructions](#)
- [4 Parts List](#)
- [5 Intercom Setup Instructions](#)
- [6 FCC Statement](#)
- [7 Documents / Resources](#)
- [8 Related Posts](#)



CENTEGIX CrisisAlert Intercom Device



Product Information

The CrisisAlert™ Intercom is a communication device designed for emergency situations. It allows for instant communication between individuals in different areas or rooms. The intercom system includes the following components:

- Intercom Device x 1
- Power Supply (Micro USB) x 1
- 3.5mm Audio Cable x 1
- Ethernet Cable x 1
- USB Audio Connector x 1 (Not Pictured)

Product Usage Instructions

1. **Install Power Supply:** Connect the provided power supply to the mini USB port on the back of the gateway. Ensure that the power supply is 5v DC and between 2 amp and 3.5 amps.
2. **Install Ethernet Cable:** Connect the provided ethernet cable to the ethernet port on the back of the gateway.
3. **Install USB Audio Connection:** Connect the provided USB audio connector to the corresponding port on the back of the gateway.
4. **Wire Relay (optional):** If your intercom system does not have an auto-sensing audio input or always-on input, you may need to wire a relay. Consult the intercom provider to verify if integration is required. Follow the instructions provided by the intercom provider to connect the relay.
 - **Normally Closed:** Connect the green and white wires to your Intercom using the crimp connectors.
 - **Normally Open:** Connect the red and white wires to your Intercom using the crimp connectors.
 - **NOTE:** Do not connect more than 24v DC via the relay.
5. **Power on and Install Device:** Connect the ethernet cable to your existing switch. Plug the intercom device into a power outlet and turn it on. The screen should turn on, and within 2-5 minutes, the IP information will be displayed, indicating that the intercom is connected and ready. If this does not happen, contact your Onboarding Specialist for assistance.

FCC Statement

RF Exposure Information: This equipment complies with FCC radiation exposure limits. To ensure safety, install and operate the intercom system with a minimum distance of 20cm between the radiator and your body.

Parts List



Please ensure the following are all included in your box. If not, reach out to your Onboarding Specialist so they can assist you with the missing equipment.

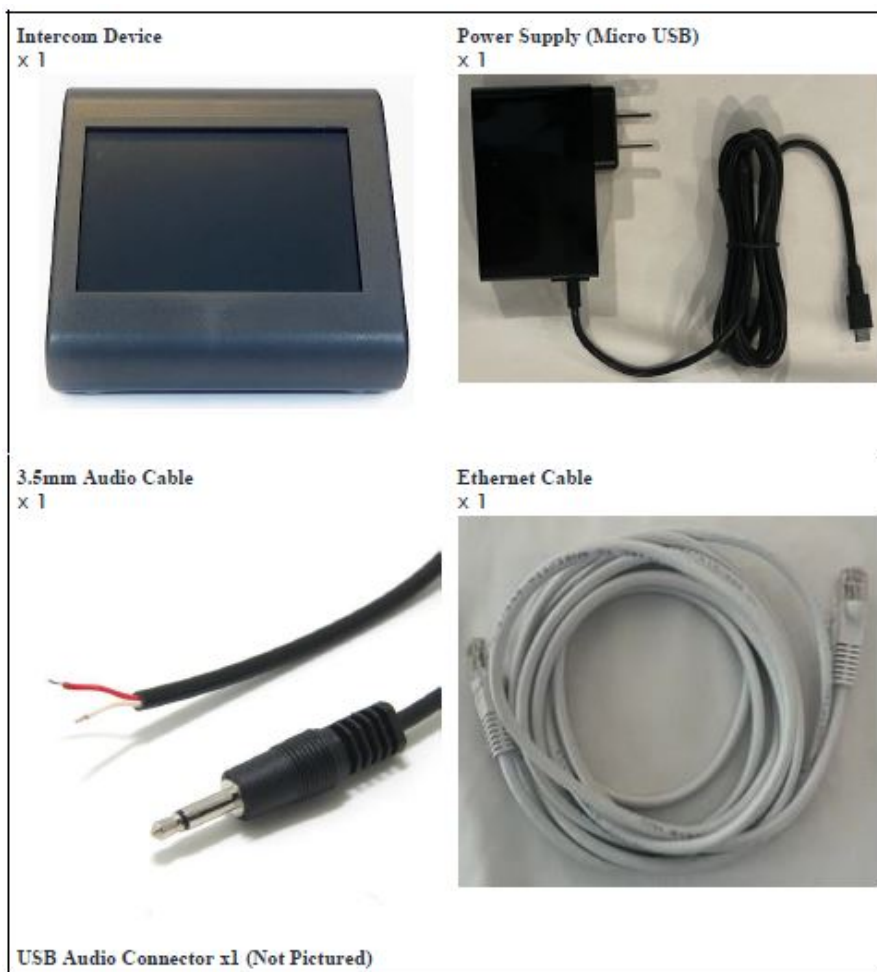

Intercom Setup Instructions

1. Install Power Supply

- Connect the provided power supply to the mini usb port on the back of the gateway.

- Ensure that the power supply is 5v DC and between 2 amp and 3.5 amps

2. Install Ethernet Cable

- Connect the provided ethernet cable to the ethernet port on the back of the gateway.

3. Install USB Audio Connection

- Connect the provided ethernet cable to the ethernet port on the back of the gateway.

4. Wire Relay (optional)

- If the intercom system does not have an auto sensing audio input/always on input, you will need to connect to the relay, which is located in the Integration Device.
- There are two types of connections:
 - Normally Closed – Connect the green and white wires to your Intercom with the crimp connectors.
 - Normally Open – Connect the red and white wires to your Intercom with the crimp connectors.
- **NOTE:** Contact the intercom provider to verify whether the intercom system is set up to complete integration. If not, an intercom technician will need to update the intercom system to integrate with the Device. DO NOT CONNECT MORE THAN 24v DC VIA RELAY.

5. Power on and Install Device

- Connect the ethernet cable to your existing switch.
- Plug the intercom device into a power outlet and power on the intercom.
- The screen should turn on and within 2-5 minutes the IP information will be displayed indicating that the intercom is connected and ready. If not, please reach out to your Onboarding Specialist for assistance.

FCC Statement

- This equipment has been tested and found to comply with the limits for a Class B digital device, pursuant to part 15 of the FCC Rules.
- These limits are designed to provide reasonable protection against harmful interference in a residential installation.
- This equipment generates, uses and can radiate radio frequency energy and, if not installed and used in accordance with the instructions, may cause harmful interference to radio communications. However, there is no guarantee that interference will not occur in a particular installation.
- If this equipment does cause harmful interference to radio or television reception, which can be determined by turning the equipment off and on, the user is encouraged to try to correct the interference by one or more of the following measures:
 - Reorient or relocate the receiving antenna.
 - Increase the separation between the equipment and receiver.
 - Connect the equipment into an outlet on a circuit different from that to which the receiver is connected.
 - Consult the dealer or an experienced radio/TV technician for help.

Caution: Any changes or modifications to this device not explicitly approved by manufacturer could void your authority to operate this equipment.

This device complies with part 15 of the FCC Rules. Operation is subject to the following two conditions:

1. This device may not cause harmful interference
2. this device must accept any interference received, including interference that may cause undesired operation.

RF Exposure Information

This equipment complies with FCC radiation exposure limits set forth for an uncontrolled environment. This equipment should be installed and operated with minimum distance 20cm between the radiator and your body.

Documents / Resources

	<p>CENTEGIX CrisisAlert Intercom Device [pdf] Installation Guide 2ATQ2-CEINT01, 2ATQ2CEINT01, ceint01, CrisisAlert, CrisisAlert Intercom Device, Intercom Device, Device</p>
---	--