

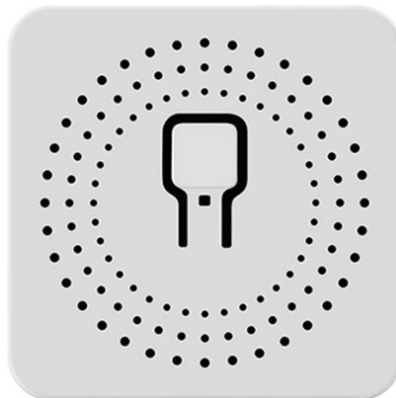

centechia 16A/10A WiFi Smart Switch User Manual

[Home](#) » [centechia](#) » centechia 16A/10A WiFi Smart Switch User Manual

centechia 16A/10A WiFi Smart Switch User Manual



Contents [[hide](#)]

- [1 Product introduction](#)
- [2 Specifications](#)
- [3 Installation instructions](#)
- [4 How to connect the device to Wi-Fi](#)
- [5 FCC WARNING](#)
- [6 Documents / Resources](#)
- [7 Related Posts](#)

Product introduction

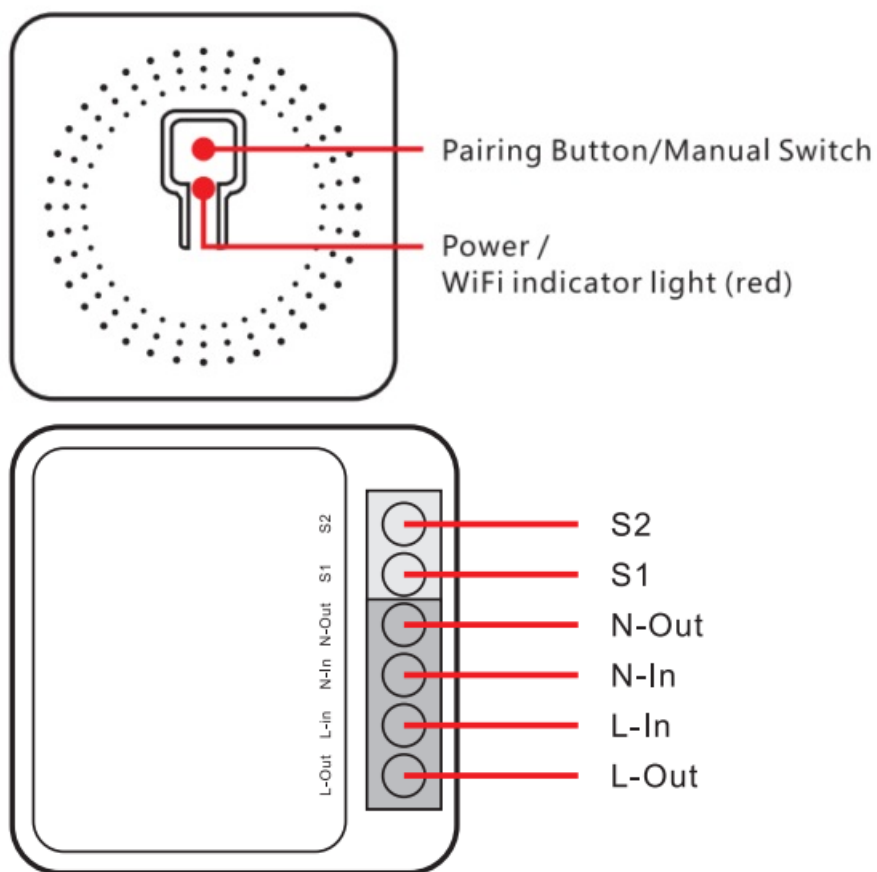

⚠ The device weight is less than 1 kg. The installation height of less than 2 m is recommended.

Specifications

Name	WIFI Smart Switch
Input	AC 100-240V 50/60Hz
Output	AC 100-240V 50/60Hz
Operating Systems	Android 5.0 & iOS 10) or higher
Frequency Standard	WiFi(802.11 b/ /n 2.4GHz)
Current	≤16A
Material	PC
Dimension	41*41*20mm

Installation instructions

1. Power off

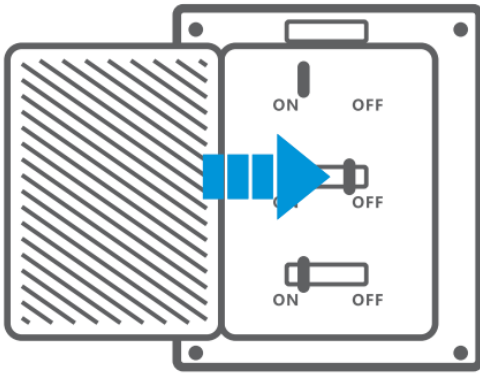

⚠ To avoid electric shocks, please consult the dealer or a qualified professional for help when installing and repairing.

2. Wiring instruction

⚠ Make sure correct wiring before powering the device on.

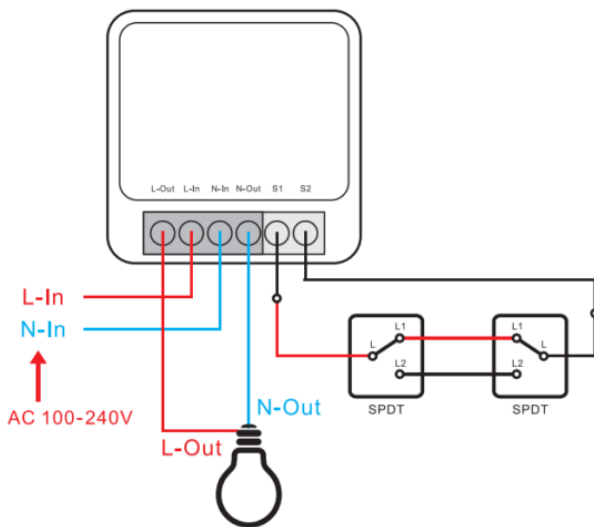

⚠ S1/S2 can connect with the rocker light switch or doesn't connect. To ensure safety, do not connect the neutral wire and live wire to it.

How to connect the device to Wi-Fi

1. First of all:

- Power on the smart switch and make sure that the phone is connected to the Wi-Fi network in the 2.4GHz frequency band; turn on the phone's Bluetooth.
- Make sure that the device, mobile phone, and router are close to each other.
- Download and open the App: Search for "Smart Life" in the App Store or scan the QR code below to download and install the App. For the first download and use, please click the "Create New Account" button to register;
If you already have an account, click the "Log in with an existing account" button.



2. Reset the smart switch:

Press and hold the button on the smart switch for more than 5 seconds until the LED indicator on it flashes quickly.

3. Add Device to App

Open the “Smart Life” App, click the “+” in the upper right corner to enter the device addition page, and then select “Auto Scan” (please turn on the Bluetooth function of the phone before performing this operation) to start searching for nearby devices to be added. After discovering the device to be added, the icon and name of the device will appear on the APP page or a prompt page will pop up, then please follow the APP prompts to add the device.

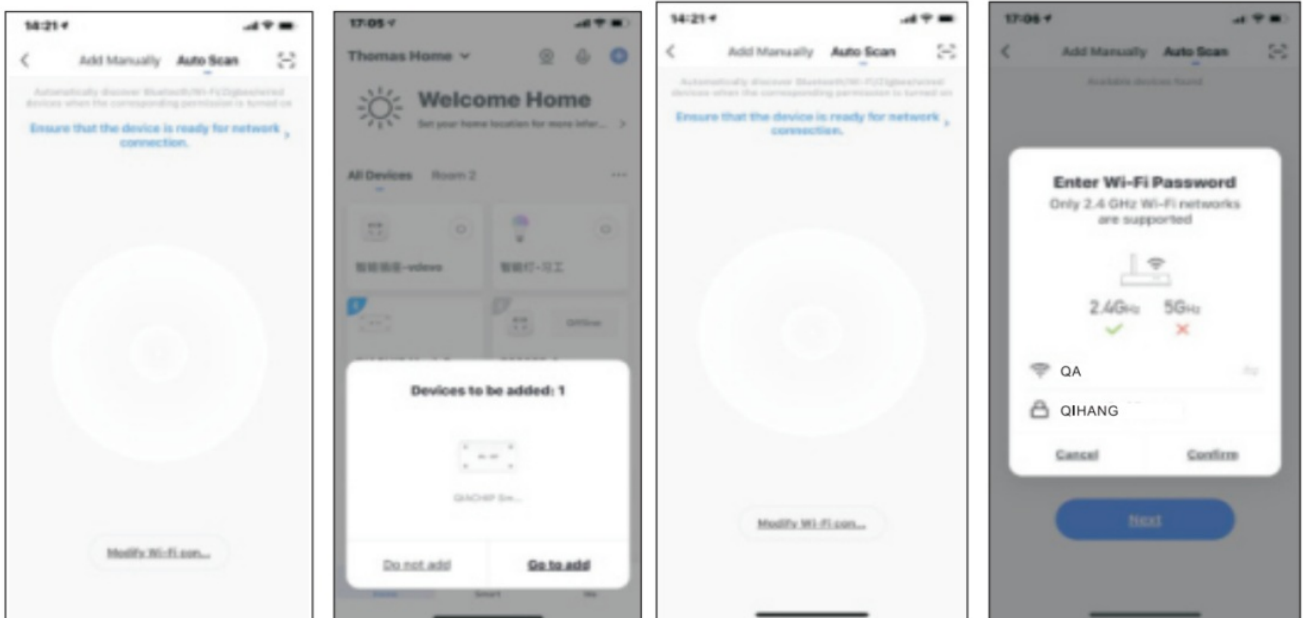

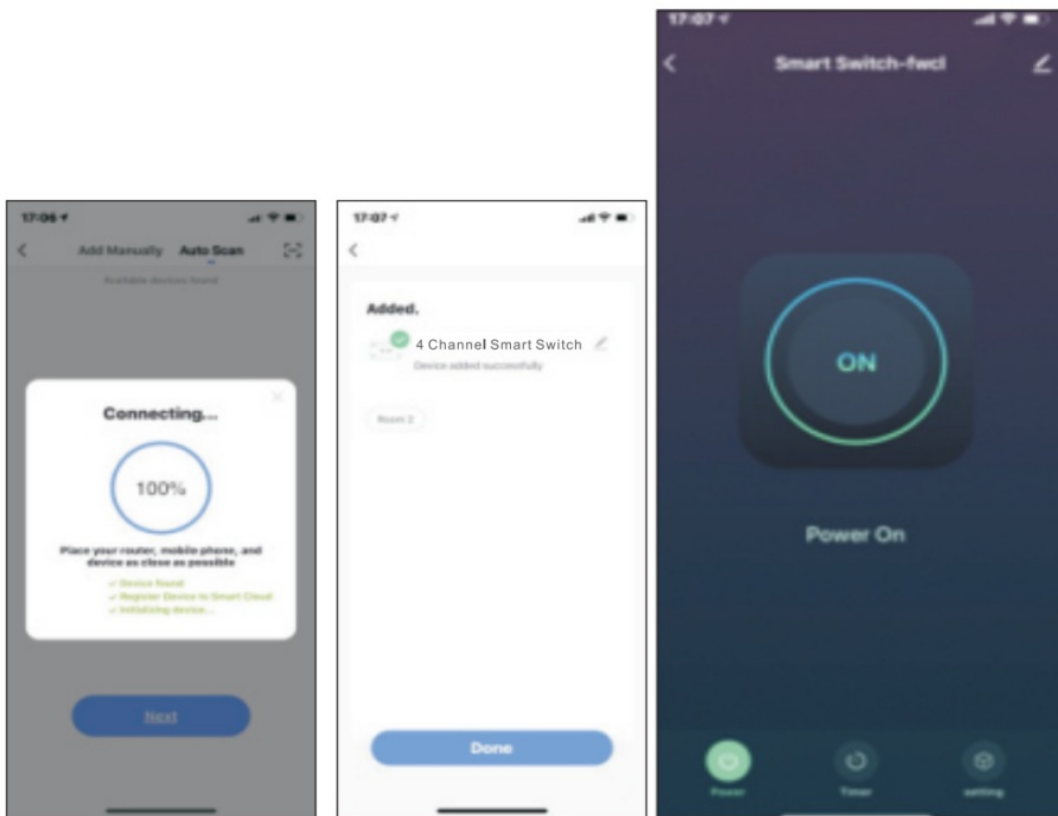

After the smart switch is successfully connected to Wi-Fi, you can see the newly added device on the home page of the Smart Life App.

How to connect to third-party applications such as Alexa and Google Assistant

When using a third-party smart speaker to connect, you first need to download the third-party APP and register an account, such as Amazon Alexa; then add the device in the “Smart Life APP”, open the device control page, click the upper right corner (see the picture below), and then Jump to the device information page, where you can change the name of the device, and you can see the details of the third-party controlled APP supported by the device, select the APP you need to connect, such as Alexa, click the icon to enter the binding interface, and then press the page prompts the operation. (see the figure below)

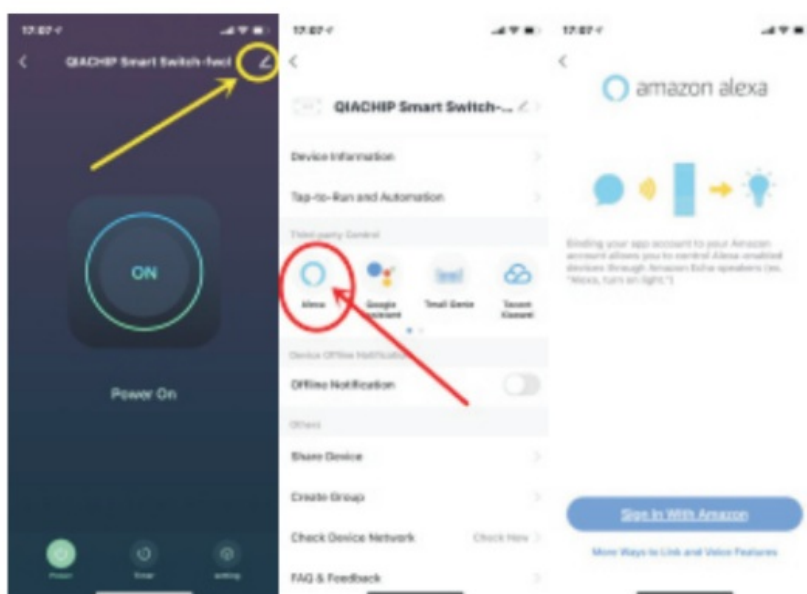

FCC WARNING

This device complies with part 15 of the FCC Rules. Operation is subject to the following two conditions:

1. this device may not cause harmful interference, and
2. this device must accept any interference received, including interference that may cause undesired operation.

Any changes or modifications not expressly approved by the party responsible for compliance could void the user's authority to operate the equipment.

NOTE: This equipment has been tested and found to comply with the limits for a Class B digital device, pursuant to Part 15 of the FCC Rules. These limits are designed to provide reasonable protection against harmful interference in a residential installation. This equipment generates, uses and can radiate radio frequency energy and, if not installed and used in accordance with the instructions, may cause harmful interference to radio communications.

However, there is no guarantee that interference will not occur in a particular installation.

If this equipment does cause harmful interference to radio or television reception, which can be determined by turning the equipment off and on, the user is encouraged to try to correct the interference by one or more of the following measures:

- Reorient or relocate the receiving antenna.
- Increase the separation between the equipment and receiver.
- Connect the equipment into an outlet on a circuit different from that to which the receiver is connected.
- Consult the dealer or an experienced radio/TV technician for help.

To maintain compliance with FCC's RF Exposure guidelines, This equipment should be installed and operated with minimum distance between 20cm the radiator your body: Use only the supplied antenna.

Documents / Resources

	<p>centechia 16A/10A WiFi Smart Switch [pdf] User Manual KR2301, 2AYLT-KR2301, 2AYLTKR2301, 16A, 10A, WiFi Smart Switch, 16A WiFi Smart Switch, 10A WiFi Smart Switch</p>
---	---