



cellularline REACT Bluetooth Mono Headphones with Charging Dock User Guide

[Home](#) » [cellularline](#) » cellularline REACT Bluetooth Mono Headphones with Charging Dock User Guide 



REACT Bluetooth Mono Headphones with Charging Dock User Guide

Contents

- [1 REACT](#)
- [2 Documents / Resources](#)
 - [2.1 References](#)
- [3 Related Posts](#)

REACT

BLUETOOTH MONO HEADPHONES WITH CHARGING DOCK

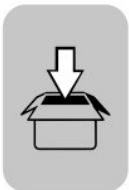

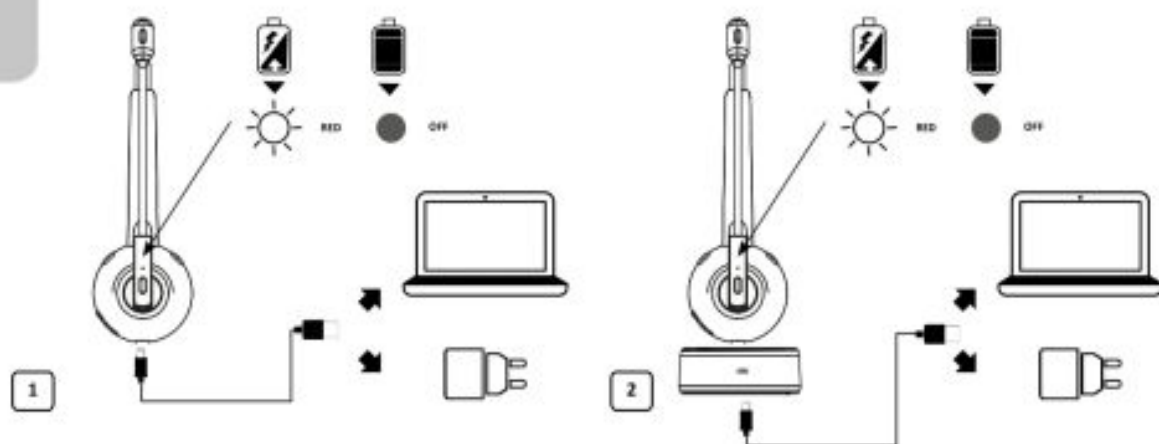

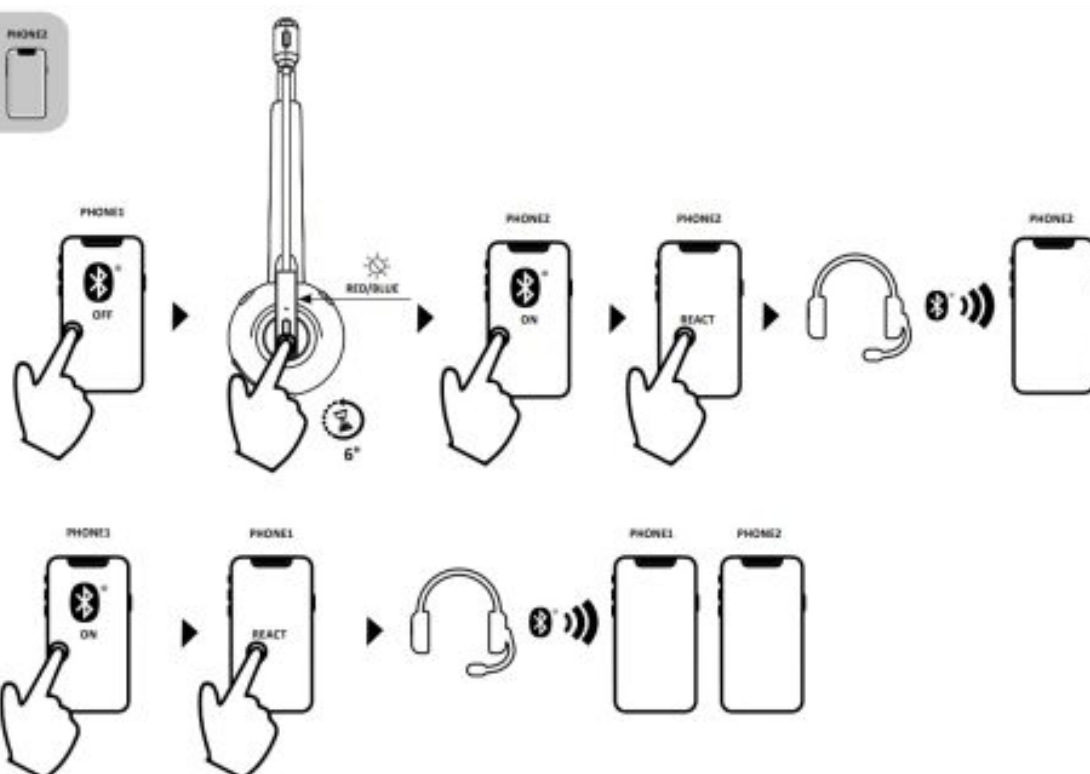
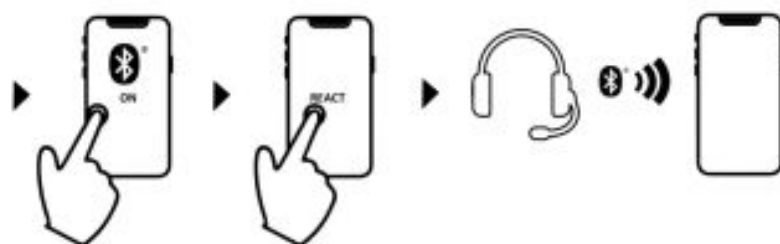
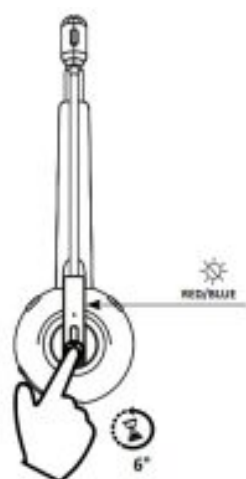

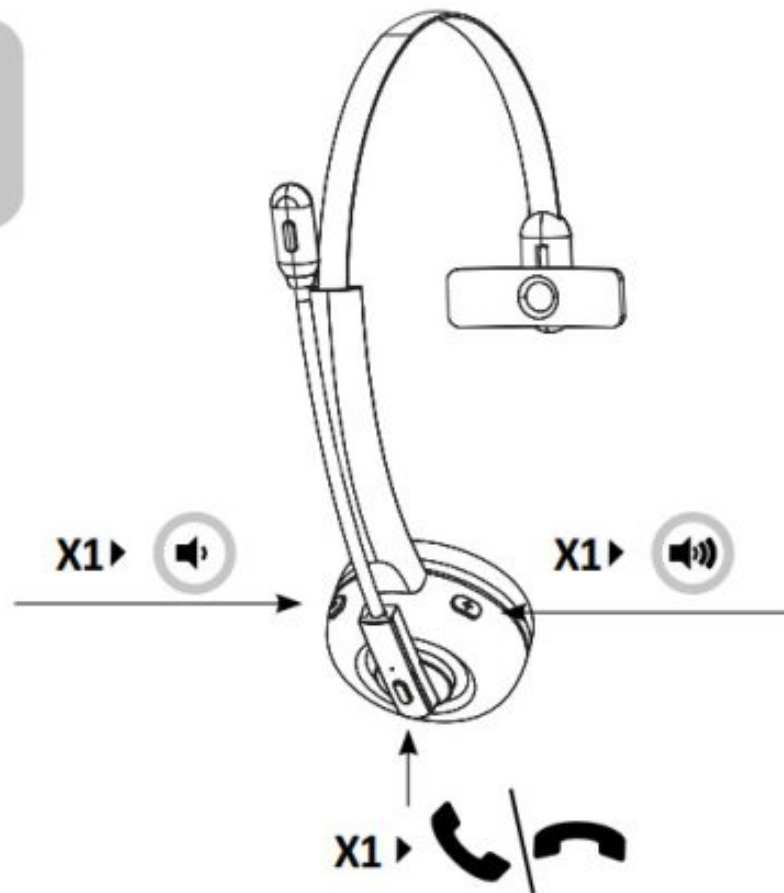

Headset technical specifications:

Headset technical specifications:

Bluetooth: v5

Supported profiles: Headset – Handsfree – A2DP – AVRCP

Capacity: 10mt

Bluetooth Frequency Range: 2.402~2.480GHz

Battery Voltage: 3.7V

Battery Capacity: 400mAh

MicroUSB port Voltage (V): 5V

MicroUSB port current (A): 500mA

ERP: 4dBm

Stand-by Time: Around 800 hours

Talk Time: Around 35 hours

Play Time: Around 35 hours

Charge Time: Around 1 hour

Charging Case Charge Time: around 1.5h

Weight: 66 g



Using the device may, in some cases, interfere with the correct functioning of medical devices (e.g. pacemakers). Prolonged exposure to high volume and prolonged use may cause permanent damage to hearing.

Do not use the device in places where being unable to hear external noises could prove dangerous (e.g. railway crossings, train platforms)

If used when driving, comply with the regulations in force in the relevant country.

Children should be supervised when using the device and all accessories and packaging should be kept out of their reach.

Do not expose the device for prolonged periods to dampness, dust, soot, steam, direct sunlight, and excessively high or low temperatures, which could result in it malfunctioning Use only suitable chargers for charging Regularly

charge the product (at least once every 3 months).



Cellularline S.p.A. declares that these Bluetooth headphones comply with Directive 2014/53/EU. The full text of the EU Declaration of conformity is available at the following Internet address:

<https://www.cellularline.com/altec-declaration-of-conformity> Cellularline S.p.A. also declares that these Bluetooth headphones comply with Directive 2011/65/EU updated from 2015/863/EU.



INFORMATION ON THE STATUTORY WARRANTY

Our products are covered by a statutory warranty against conformity defects in accordance with applicable national consumer protection laws.

For more information, please see the following page www.cellularline.com/_/warranty



INSTRUCTIONS FOR THE DISPOSAL OF DEVICES FOR DOMESTIC USE (Applicable in countries in the European Union and those with separate waste collection systems)

This mark on the product or documentation indicates that this product must not be disposed of with other household waste at the end of its life. To avoid any damage to health or the environment due to improper disposal of waste, the user must separate this product from other types of waste and recycle it in a responsible manner to promote the sustainable re-use of the material resources.

Domestic users should contact the dealer where they purchased the product or the local government office for all information regarding separate waste collection and recycling for this type of product. Corporate users should contact the supplier and verify the terms and conditions in the purchase contract. This product must not be disposed of along with other commercial waste.

This product has a battery that cannot be replaced by the user. Do not attempt to open the device to remove the battery as this could cause malfunctions and seriously damage the product. When disposing of the product, please contact the local waste disposal authority to remove the battery. The battery inside the device was designed to be able to be used during the entire life cycle of the product.

For more information, visit the website <http://www.cellularline.com>

Cellularline S.p.a
Via Lambrakis 1/A, 42122 Reggio Emilia, Italy
www.cellularline.com

Documents / Resources

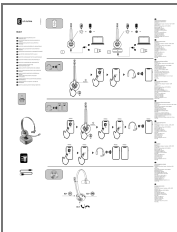

[cellularline REACT Bluetooth Mono Headphones with Charging Dock](#) [pdf] User Guide
REACT, Bluetooth Mono Headphones with Charging Dock, REACT Bluetooth Mono Headphone
s with Charging Dock, BTHEADBREACT

References

- [CellularLine Site WW | Homepage](#)
- [CellularLine Site WW | Homepage](#)
- [CellularLine Site IT | Homepage](#)
- [CellularLine Site IT | Homepage](#)