



Cell2 Omni View Dual L-Bracket 9 LED Corner Warning Lighthouse Instruction Manual

[Home](#) » [Cell2](#) » Cell2 Omni View Dual L-Bracket 9 LED Corner Warning Lighthouse Instruction Manual 

Contents

- [1 Cell2 Omni View Dual L-Bracket 9 LED Corner Warning Lighthouse](#)
- [2 Wiring](#)
- [3 Operation](#)
- [4 Installation](#)
- [5 Approved Mounting Position](#)
- [6 Documents / Resources](#)
- [7 Related Posts](#)



Cell2 Omni View Dual L-Bracket 9 LED Corner Warning Lighthouse



Wiring

To Chassis Ground:..... **BLACK**

To+VDC for Warning Mode ❶ (fuse @ 3A):..... **RED**

Default Flash Pattern - FP#1 Double [2Hz]

To+VDC for Warning Mode ❷ (fuse @ 3A):..... **WHITE**

Default Flash Pattern - FP#18 Steady Scene (Cruise Mode)

For Warning Mode ❶ Low Power Operation: **RED+WHITE**

NOTE: For ECE R65 Class 1 models, low power operation is disabled by default.

For Synchronization and Flash Pattern:.... **YELLOW**

Connect **YELLOW** wires of all lightheads together for synchronization.

(All lightheads should be set to the same Flash Pattern)

NOTE: When arranging lightheads to comply with ECE R65 CAT "HT" or "T", all units must be synchronized.

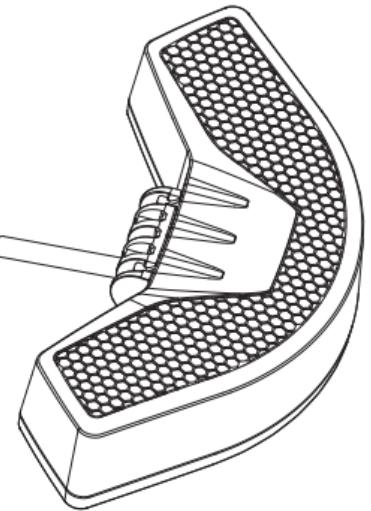

Operation

For Flash Pattern Selection:

Each warning mode may select and save one flash pattern. While activating a warning mode, momentarily apply YELLOW wire to +VDC:

- Once to the next pattern.
- Quick three times to the default flash pattern (FP#1 or FP#18).

Flash Pattern								
1	Double	[2Hz]	7	Single	[SAE/CA13]	13	Giga	
2	Single	[2Hz]	8	Double	[SAE]	14	Ultra	[SAE]
3	Triple	[2Hz]	9	Triple	[SAE]	15	Single-Quad	
4	Quad	[2Hz]	10	Quad	[SAE]	16	Single H/L	
5	Random		11	Quint	[SAE]	17	Single-Triple-Quint	
6	Steady EF*		12	Mega		18	Steady Scene (Cruise Mode)	

* For use with external flash controller.

For Low Power Operation / Disabling Low Power Operation:

While Warning Mode is activated, apply WHITE wire to +VDC for Low Power Operation.

To disable Low Power Operation, momentarily apply YELLOW wire to +VDC once to force High Power Operation and permanently disable Low Power Operation. Re-activate Low Power Operation by momentarily apply YELLOW wire to +VDC again.

NOTE: When arranging lightheads to comply with ECE R65 Class 1, disable Low Power Operation or make RED and WHITE wire in mutually exclusive switching.

For Simultaneous or Alternating Synchronization:

1. Power up the unit by applying +VDC to RED or (WHITE) and YELLOW wires simultaneously to enter SETTING

MODE; the lighthouse will display its current Group in short flashes:

- Single flash = Group 1 • Double flash = Group 2
2. Remove YELLOW wire from +VDC then momentarily apply to +VDC again for less than 3 seconds to change to the desired Group:
 - Lighthouses of the same Group will flash together.
 - Lighthouses of two different Groups will flash alternately.
 3. Save and exit SETTING MODE by disconnecting all power.

NOTE: All warning modes share the same Group setting.

Reset Factory Default Settings:

1. Power up the unit by applying +VDC to RED and YELLOW wires simultaneously to enter SETTING MODE.
2. Remove YELLOW wire from +VDC then apply to +VDC again for more than 5 seconds. The lighthouse will display fast short flashes to indicate restoring successfully.

Installation

L-bracket mount

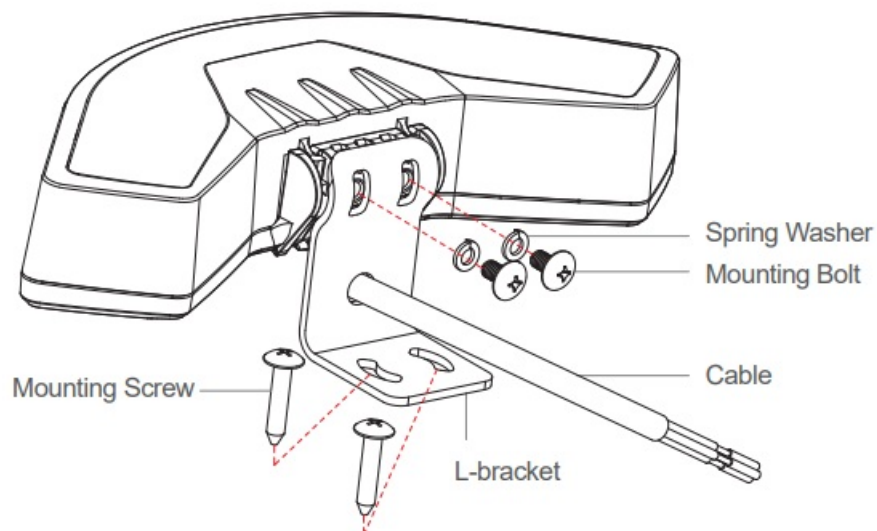

1. Locate a suitable mounting location and secure the L- bracket onto the surface with provided screws.
2. Feed the cable through the wiring hole and route it towards the control panel or switches.
3. Level the lighthouse by adjusting ± 20 degree for optimum warning effect.
4. Secure the lighthouse onto the L-bracket. [Set driver torque value at 5.5~6.5 kgf-cm (4.77~5.64 lbf-in)]

Adjustable Angle

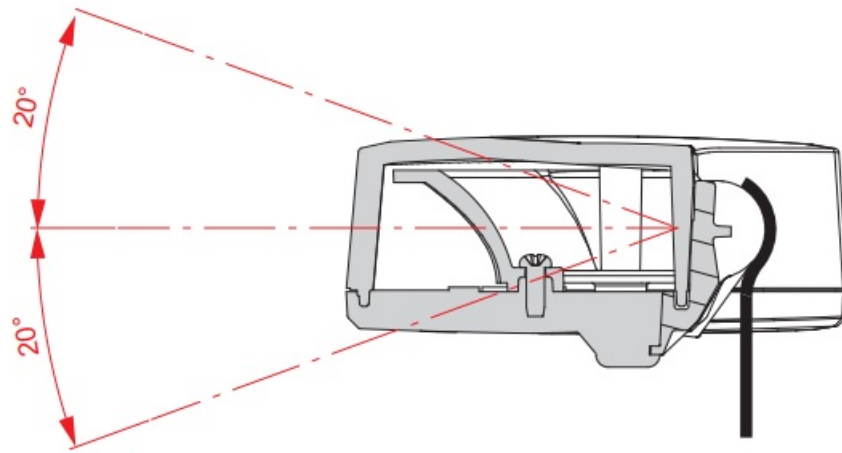

Approved Mounting Position

This 9-LED corner lighthouse may be set up in pair to meet ECE R65 CAT. HT or in four to meet CAT. T Follow the graphs carefully to fulfill the approval requirement.

Category 'HT' – 270° Warning Coverage

(One Pair of Units at the Front or Rear of Vehicle)

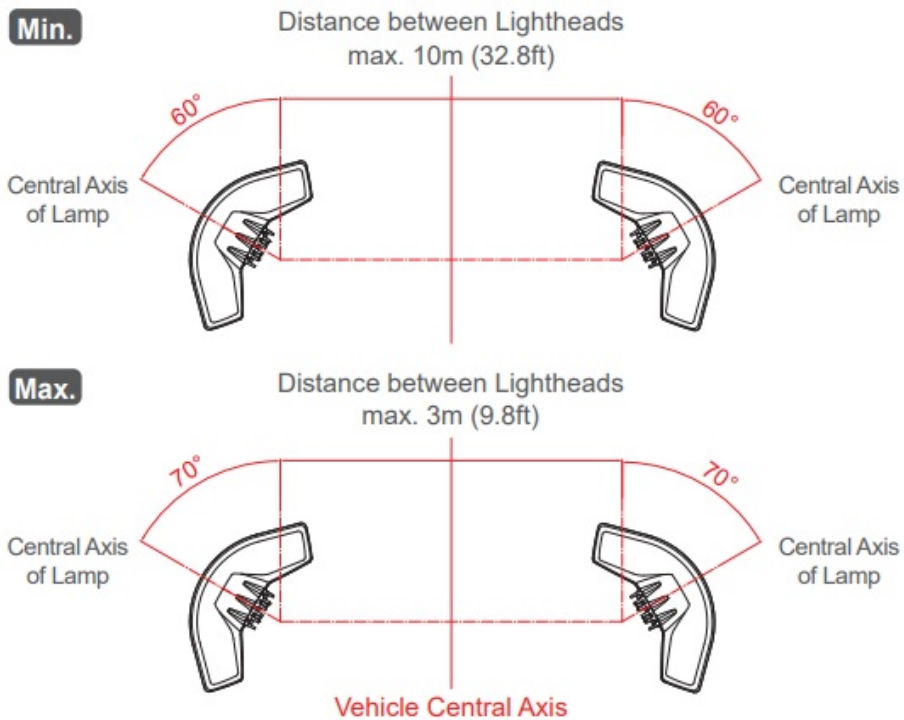

NOTE: When arranging lighthouses with ECE R65 Class 1 approval, disable Low Power Operation or make RED and WHITE wire in mutually exclusive switching.

Category 'T' – 360° Warning Coverage

(Four Units Mounted on the Vehicle)

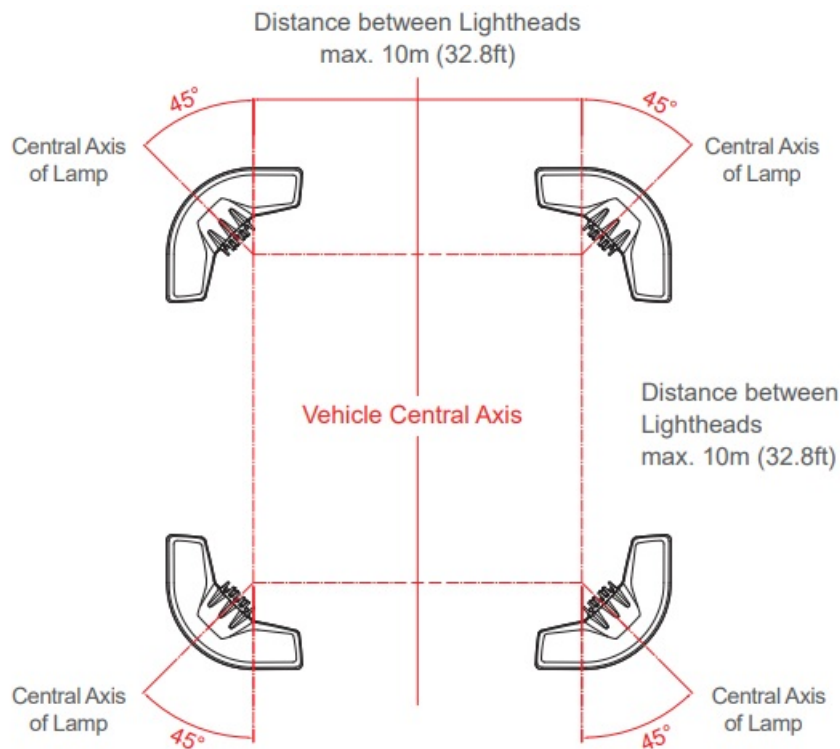

NOTE: When arranging lighthoods with ECE R65 Class 1 approval, disable Low Power Operation or make RED and WHITE wire in mutually exclusive switching.

IMPORTANT

As long as the efficiency of the special warning lamp is to be secured all around the vehicle, it is the obligation of the installer to maintain detection of the failure of a part of a special warning system on the vehicle.

Documents / Resources

	<p>Cell2 Omni View Dual L-Bracket 9 LED Corner Warning Lighthouse [pdf] Instruction Manual Omni View Dual L-Bracket 9 LED Corner Warning Lighthouse, Omni View, Dual L-Bracket 9 LED Corner Warning Lighthouse, L-Bracket 9 LED Corner Warning Lighthouse, 9 LED Corner Warning Lighthouse, Corner Warning Lighthouse, Warning Lighthouse, Lighthouse</p>
--	--