

celexon™
32424_102 Expert
Electrically Height
Adjustable Display
Trolley



celexon 32424_102 Expert Electrically Height Adjustable Display Trolley Instruction Manual

[Home](#) » [celexon](#) » celexon 32424_102 Expert Electrically Height Adjustable Display Trolley Instruction Manual 

Contents

- 1 [celexon 32424_102 Expert Electrically Height Adjustable Display Trolley](#)
- 2 [DISCLAIMER](#)
- 3 [BATTERY INSTRUCTIONS](#)
- 4 [TECHNICAL DATA](#)
- 5 [IN THE BOX](#)
- 6 [DIMENSIONS OSLO](#)
- 7 [INSTALLATION NOTES](#)
- 8 [INFORMATION ON EU CONFORMITY](#)
- 9 [Frequently Asked Questions](#)
- 10 [Documents / Resources](#)
 - 10.1 [References](#)
- 11 [Related Posts](#)

celexon™

celexon 32424_102 Expert Electrically Height Adjustable Display Trolley



Thank you for purchasing this product. For optimum performance and safety, please read these instructions carefully before connecting or operating this product. Please retain these instructions for future use.

WARNINGS

These operating instructions are intended to familiarise you with the operation of this product. Keep this manual in a safe place so that you can refer to it at any time.

- Before installation, please refer to the enclosed data sheet for further safety and use instructions.
- Do not begin installation until you have read and understood the complete operating instructions.
- Carry out the installation with another person to ensure safe installation.
- Remove the product from its packaging and remove all packaging material. Make sure that no packaging material is on or in the product. If you notice any damage to the packaging, also check whether there is any damage to the product. If you notice any external damage to the unit or any unexpected or unusual functioning, the product must not be used any longer. Contact the dealer immediately, from whom you purchased the product or celexon directly (Web: www.celexon.co.uk, Mail: info@celexon.co.uk) for further information.
- To ensure trouble-free operation, the product must only be used indoors, it is NOT suitable for outdoor use.
- The use of the product and accessories is forbidden to children under 16 years of age.
- Ensure that no children play with the appliance or are in the vicinity without supervision. Ensure that the product is not installed in locations where there is a permanent presence of people.
- Converting or modifying the product compromises product safety.
- Caution: Risk of injury! Never open the product without authorisation. Never carry out repairs yourself!
- Do not use the product near gas or water appliances or in a dusty environment.
- Handle the product with care. It can be damaged by knocks, blows or falling from even a small height.
- Keep the product away from moisture and heat.
- Never immerse the product in water or other liquids.
- Use the product only in its intended manner. Any use for any other purpose may damage the product or its surroundings.
- Tighten the screws, but do not overtighten them. Overtightening (e.g. by using a cordless screwdriver) can

cause damage and impair the secure hold of the product.

- If necessary, obtain suitable mounting material for your mounting surface. Make sure that the surface has sufficient load-bearing capacity to securely and safely mount the product and other components securely and permanently.
- After mounting the product and other components, check that they are sufficiently strong and safe to operate.
- Suspended loads must be checked for strength and load-bearing capacity at least twice a year.
- Do not load the product with more weight than permitted. Pay attention to the maximum permissible carrying weight.
- Make sure that the product is not loaded asymmetrically, especially after the product has been adjusted.
- All supply lines and cables must not be subjected to any additional load and must be laid in such a way that they are not damaged or crushed.
- Failure to comply with the above instructions may result in personal injury and damage to the product or equipment connected to it. Incorrect installation or use may also invalidate the warranty.
- If you are unsure about the use of the product, please contact your specialist personnel, your dealer or celexon directly (Web: www.celexon.co.uk, Mail: info@celexon.co.uk).
- Technical changes and errors excepted.

The manufacturer accepts no responsibility for damage to property or personal injury, if the bracket is used outside the recommended specifications, or in the event of improper installation.

DISCLAIMER

The information in this document is subject to change without notice by the manufacturer. Changes will be added to subsequent versions of this manual. The manufacturer does not guarantee or warranty for the correctness of the information in this document.

BATTERY INSTRUCTIONS

- Always observe the correct polarity and insert the batteries according to the indicated symbols (+ and -).
- Do not use mixed batteries, i.e. do not mix different types such as alkaline and zinc-carbon batteries or old and new batteries together.
- Avoid short circuits by ensuring that batteries do not come into contact with each other or with conductive materials such as metal.
- Never throw batteries into a fire or expose them to extreme temperatures as they could explode.
- Do not open or disassemble batteries by force, as they may contain hazardous chemical substances.
- If batteries leak, avoid contact with the skin, eyes or clothing and clean affected areas thoroughly with water.
- Keep batteries out of the reach of children to prevent them from being swallowed.
- Dispose of batteries in an environmentally friendly manner and in accordance with legal regulations, never in household waste.
- Do not use damaged or leaking batteries, as these can release hazardous chemicals.

TECHNICAL DATA

- Suitable for display sizes:
Oslo: 55" to 90"

Oslo Max: 80" to 110"

- Suitable for VESA standard:

Oslo: 200×200 – 900×600

Oslo Max: 200×200 – 1200×600

- Max. weight capacity: 90 kg
- Height adjustment: 25 cm
- Battery for remote control: CR2032

IN THE BOX



1x left strut (A)



1x right strut (B)



4x roller base (C)



1x motor element (D)

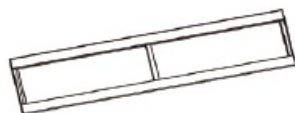

1x cross strut (E)



1x shelf (F)



1x left VESA mount (G)



1x right VESA mount (H)

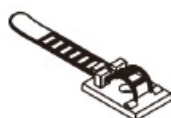

2X cable management (I)



1x remote control (J)

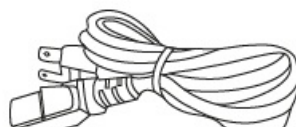

1x Power cable (K)



4x M10x15 mm (A1)



4x M8x25 mm (B1)



4x M6x25 mm (C1)



4x M5x25 mm (D1)



4x 16xØ6.2x1.5 mm (E1)



4x Ø8.2x10 mm (F1)



8x M8x60 mm (A2)



16x M6x10.5 mm (B2)



8x Ø8.2xØ16x1.2 mm (C2)



10x M5x10 mm (D2)



1x Left-hand anti-unhook guard (E2)



1x Right-hand anti-unhook guard (F2)



1x 5 mm hexagon spanner (G2)



1x mounting brace for camera shelf (L)



1x camera shelf (M)



1x M5x10 mm (O)

DIMENSIONS OSLO

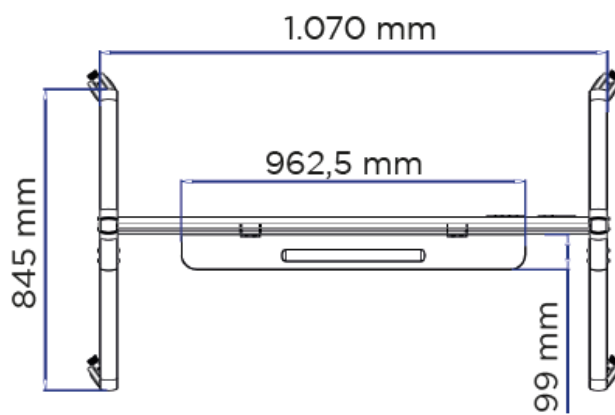
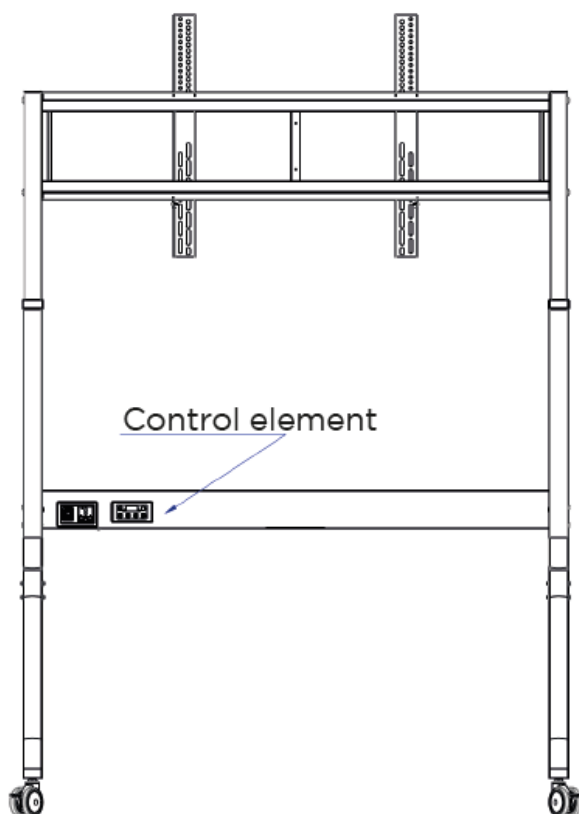
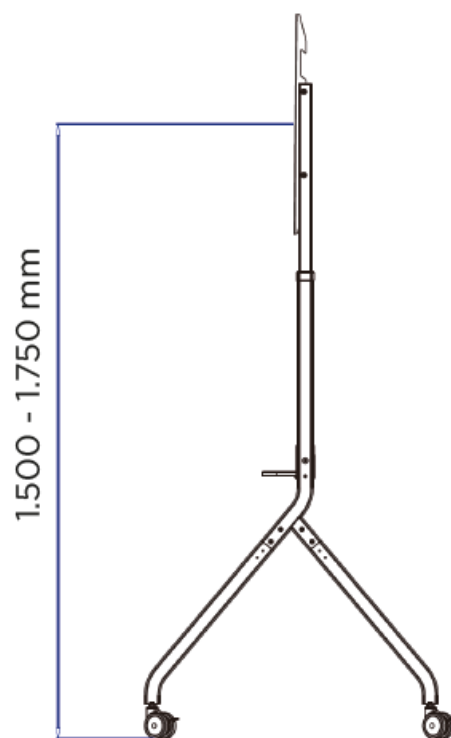
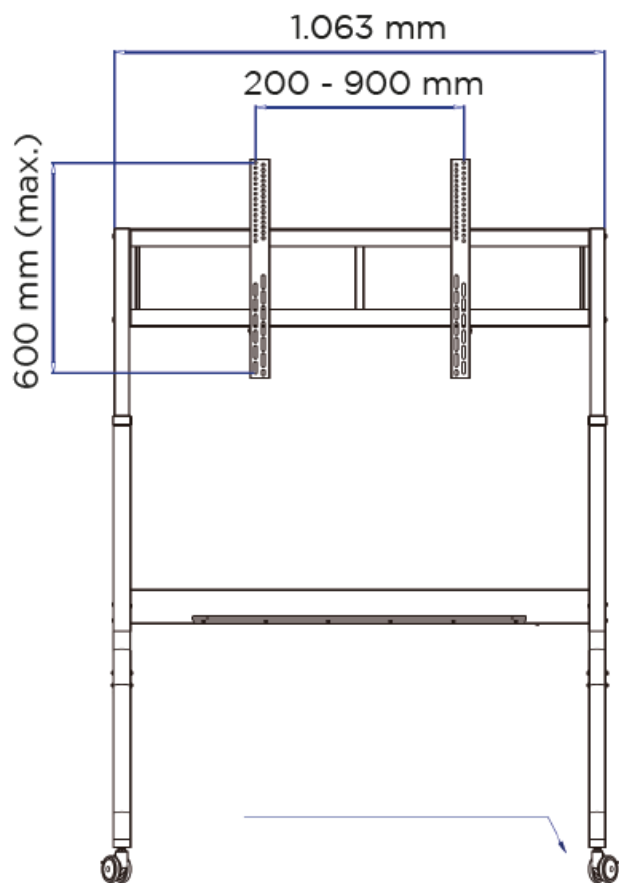

DIMENSIONS OSLO MAX

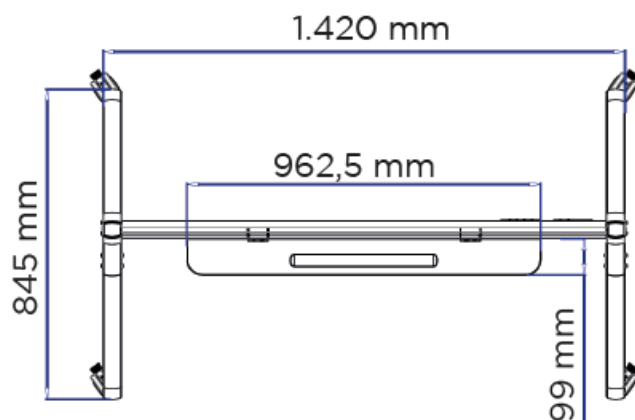
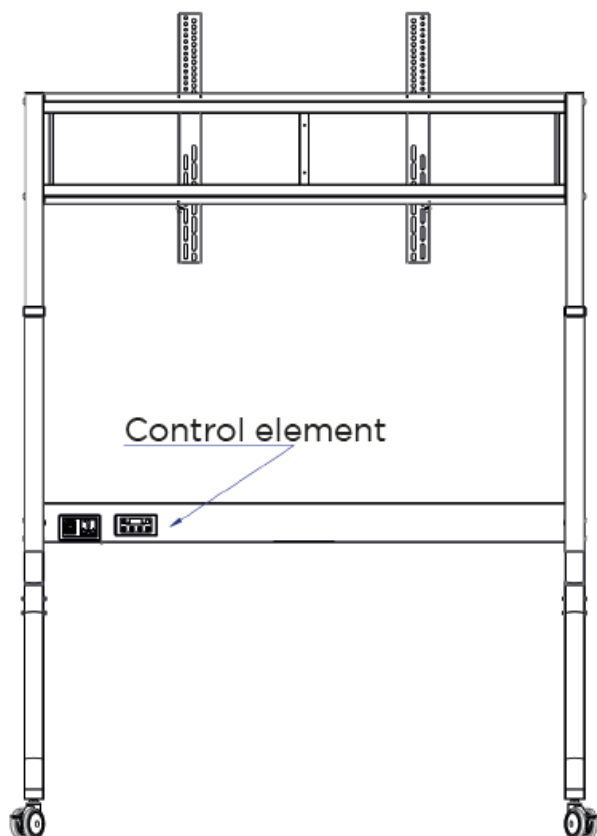
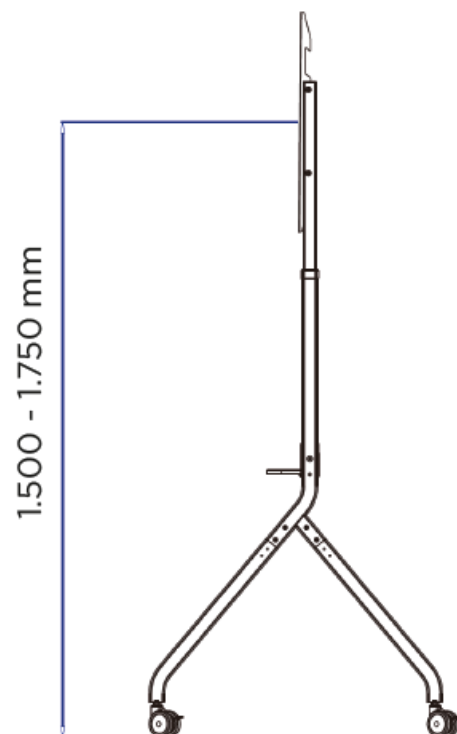
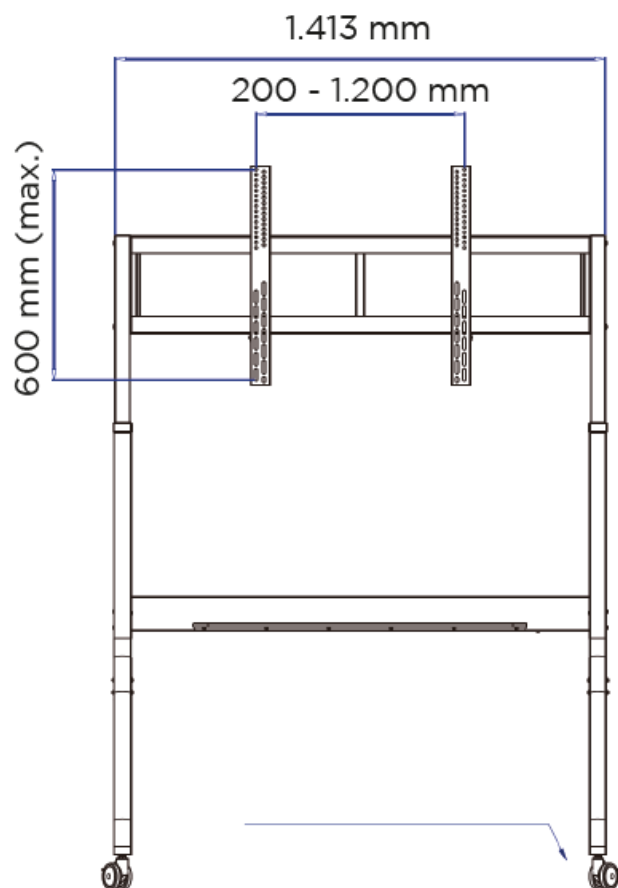

INSTALLATION NOTES

]During assembly, ensure that the display and the associated accessories do not come into contact with the ceiling, door frames or similar obstacles when raising the display stand. This could lead to injuries or damage to the products. Note: Ensure that the display used, including accessories, does not exceed the maximum load capacity of 90 kg.

STEP 1 | ASSEMBLING THE CHASSIS

Apply the brake on the four castor feet to prevent the display stand from rolling away unintentionally. During assembly, make sure that the curvature of the castor feet is facing outwards, as shown in Figure 2. Use the screws B2 to attach the castor feet C to the struts A and B. Tighten the screws firmly but do not overtighten them to avoid damage.

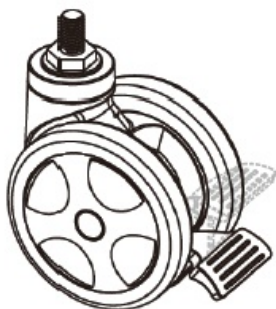

Fig. 1

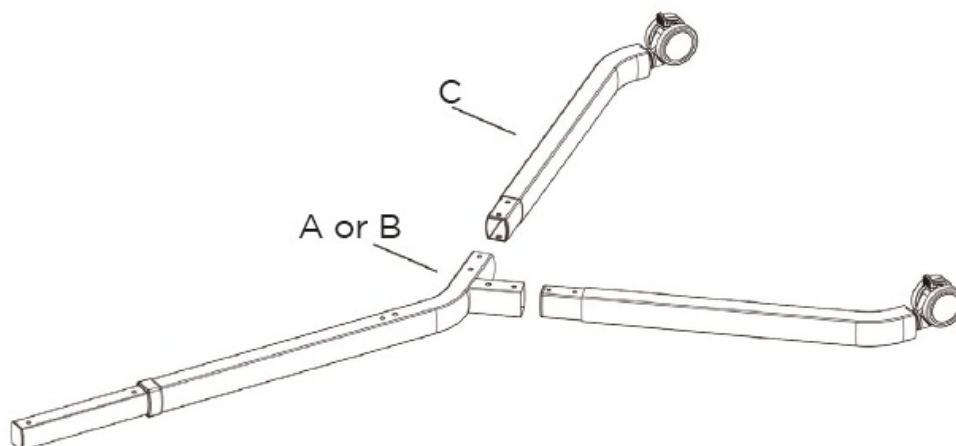

Fig. 2

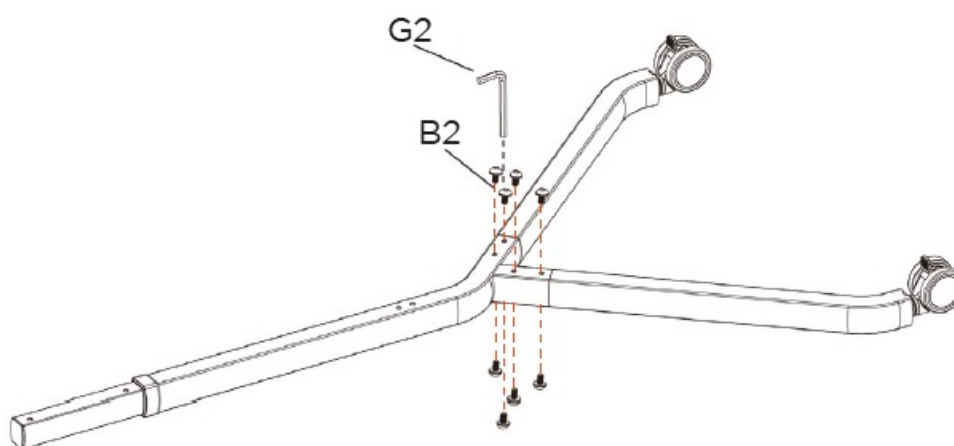

Fig. 3

- Make sure that both columns are the same height. If one of the columns is higher, carefully push it down until it reaches the same height as the other.

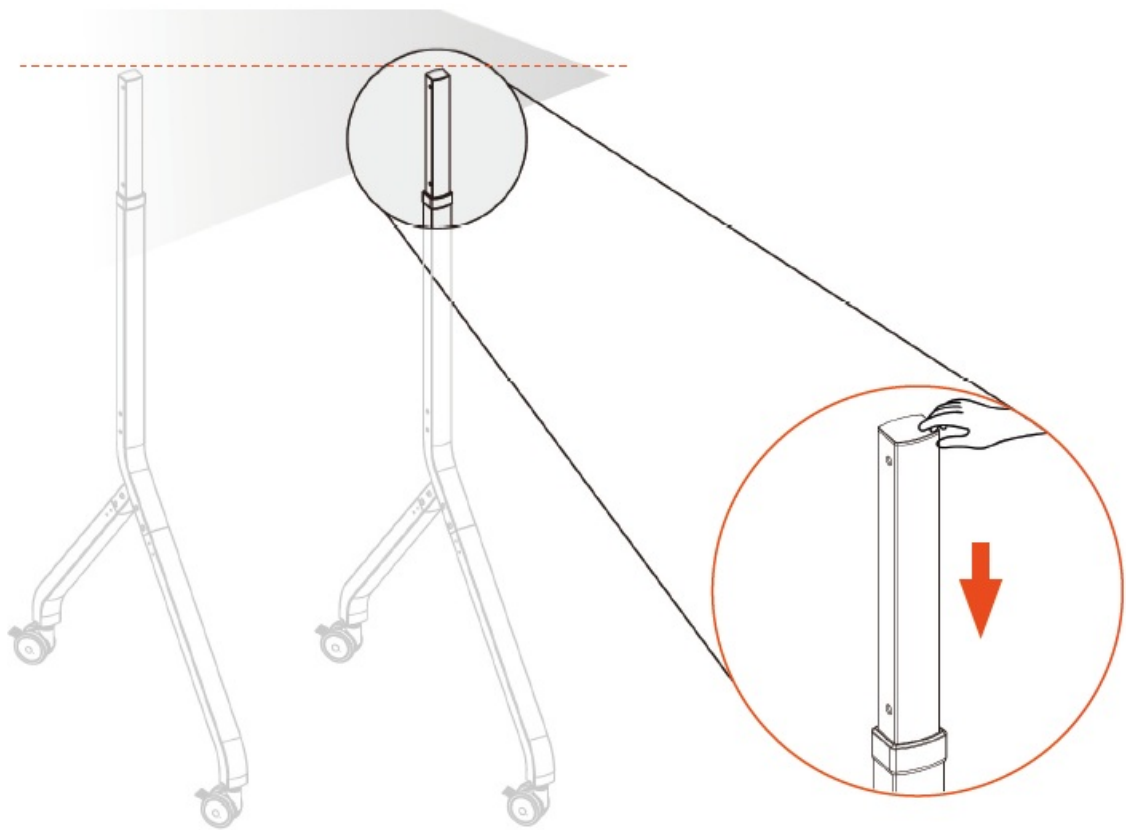

Fig. 4

- Screw the shelf F to the motor element D using the screws D2.
- Tighten the screws firmly but do not overtighten them to avoid damage.

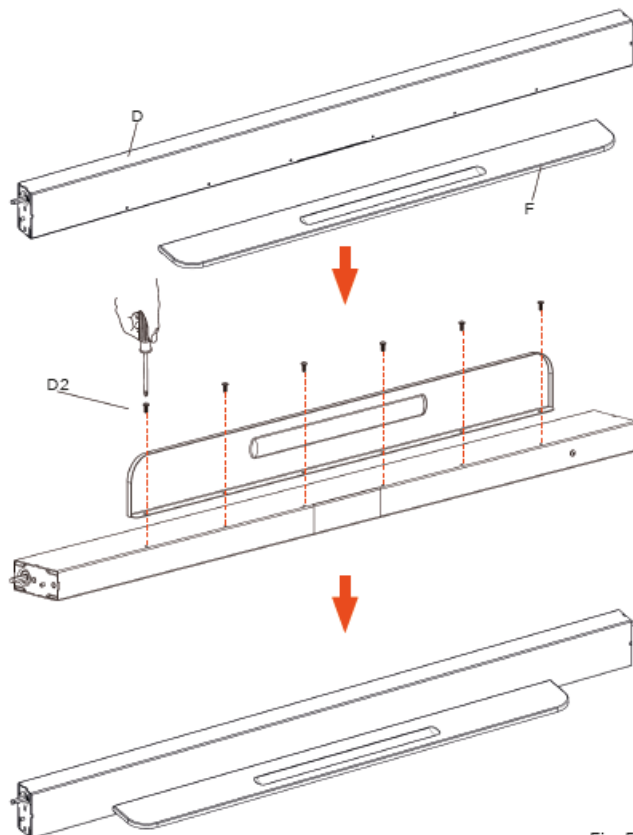

Fig. 5

- Fit the motor element to the roller feet. Make sure that the sides with the additional holes point inwards so that the motor can engage in the threads provided. This step should be carried out by at least two persons.
- Fasten the motor element to the roller feet from the outside using screws A2 and washers C2 to the roller feet. Tighten the screws firmly but do not over-tighten them to avoid damage.

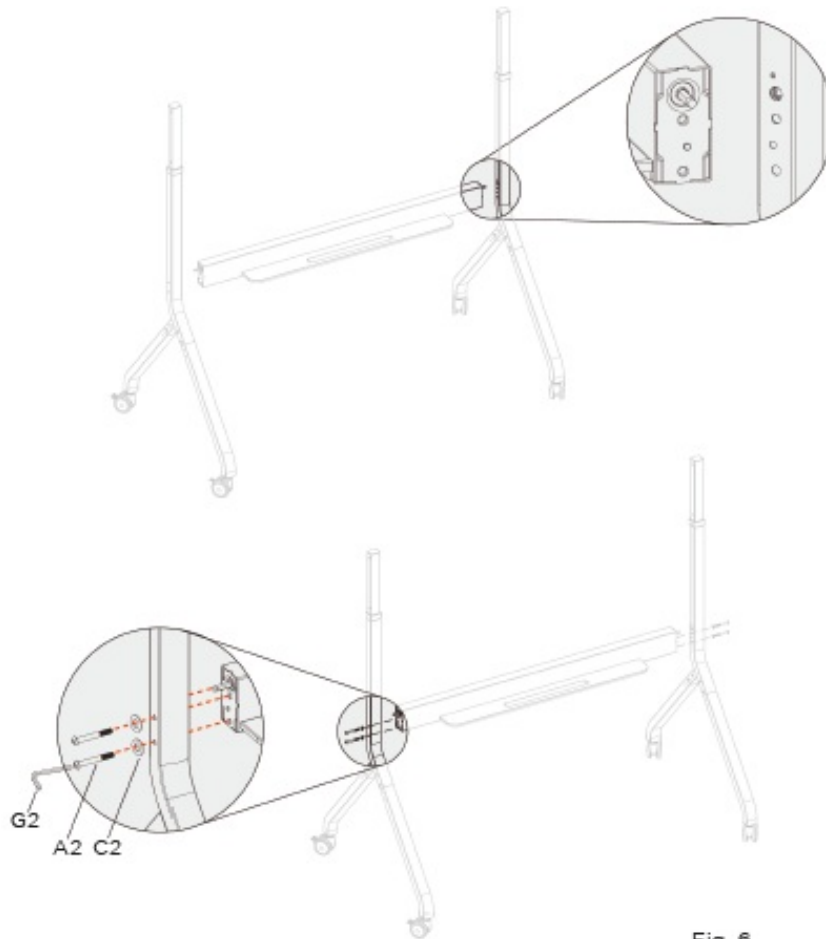

Fig. 6

STEP 2 | MOUNTING DISPLAY ASSEMBLY

Align the cross strut for mounting the display holder so that the marking points forwards towards the shelf (see Fig. 7). Fasten the cross strut to the roller feet using the A2 screws and C2 washers. Tighten the screws firmly but do not overtighten them, to avoid damage.

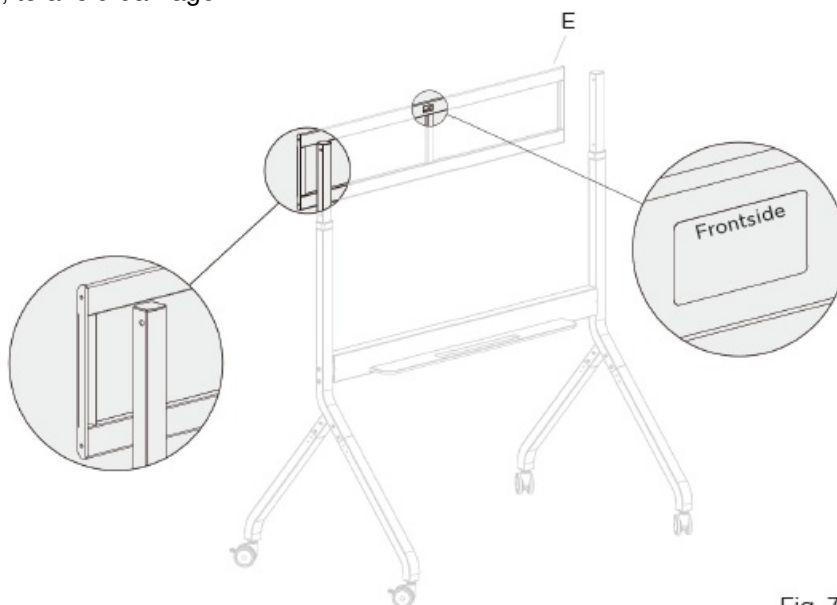

Fig. 7

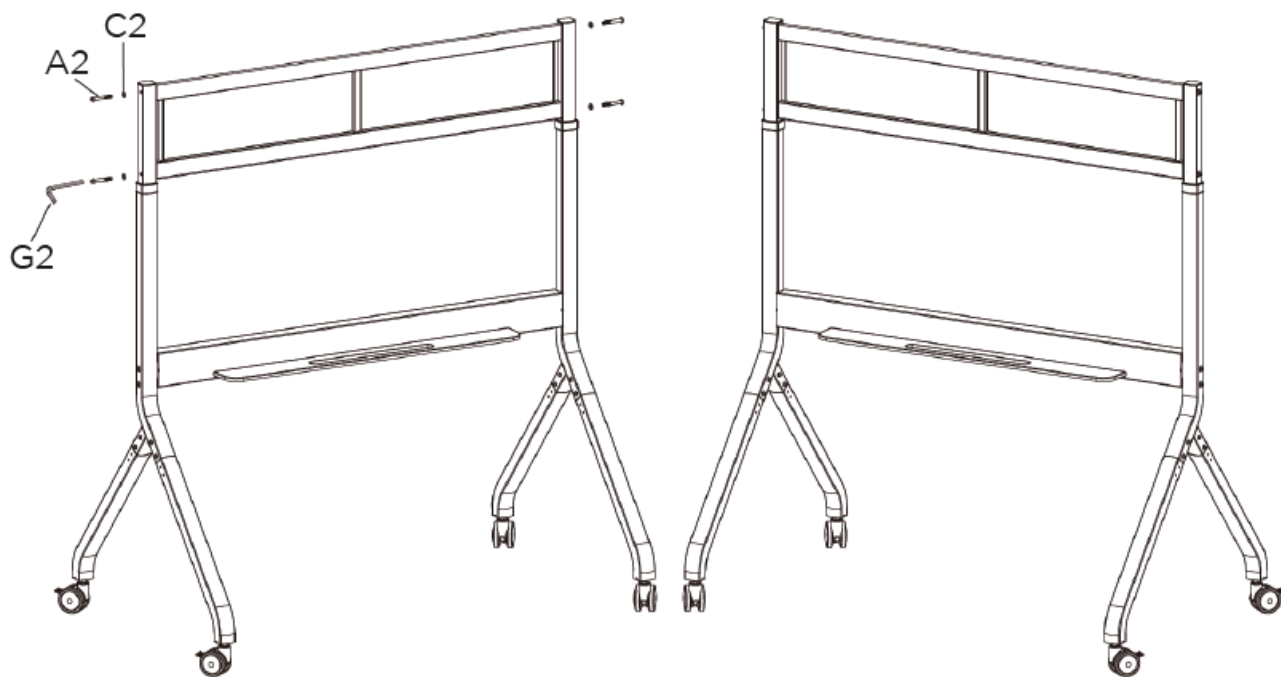



Fig. 8

STEP 3 | OPERATION

Attention: Before attaching the display, initialise the display stand, after you have connected it to the power supply.

To do this, press the reset button  on the rear control panel and hold it down until '1750' appears on the display. The display stand is then ready to be loaded and used normally.

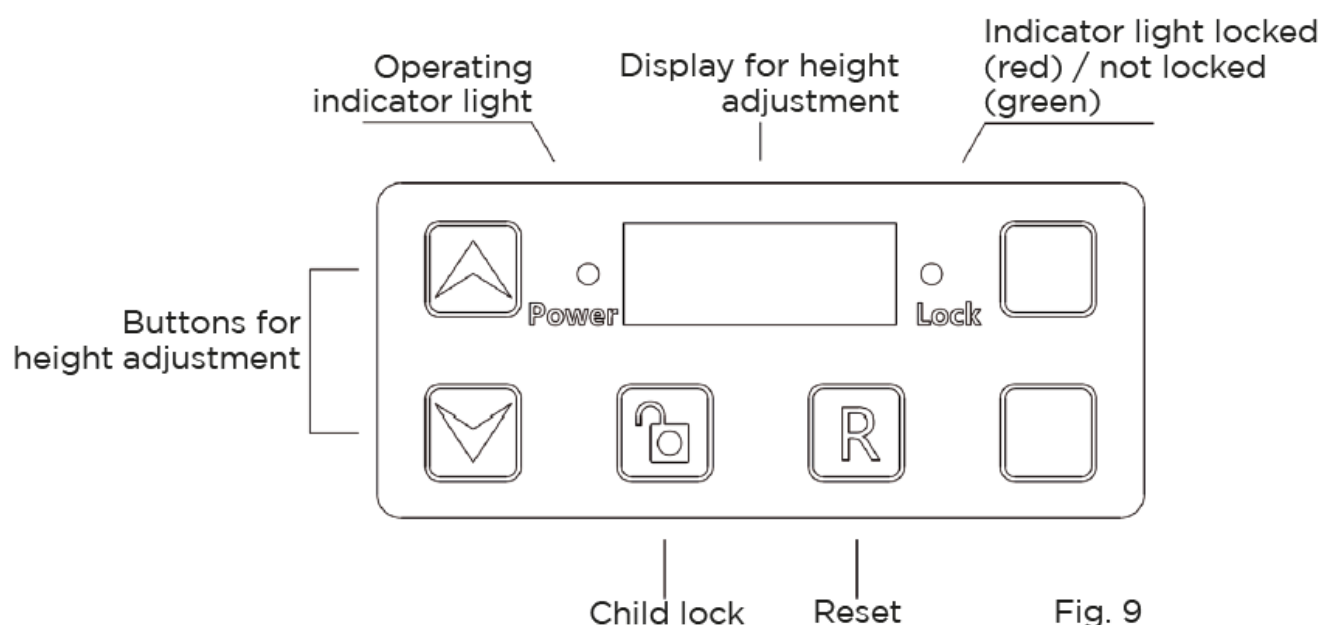





Fig. 9

Initialisation setting:

Press and hold the reset button . The height adjustment display flashes '—'. The initialisation process has started. Press and hold the reset button until '1750' appears in the display. At this point, the display stand is at its highest position. Initialisation is now complete.

Childproof setting:

- Press and hold the childproof lock button . The indicator light lights up red and the control unit is locked.
- Press and hold the childproof lock button again . The indicator light lights up green and the control unit is unlocked again.

To go up:

- Press and hold the up button the button . The display rises at a constant speed. Release to end the process.

To go down:

- Press and hold the down button . The display lowers at a constant speed. Release the button to end the process.

STEP 4 | MOUNTING THE DISPLAY

- Mount the two VESA brackets G and H on the display. Only use screws in accordance with the manufacturer's instructions for your display.
- Make sure that the screws are not screwed too far into the display otherwise the display may be damaged.

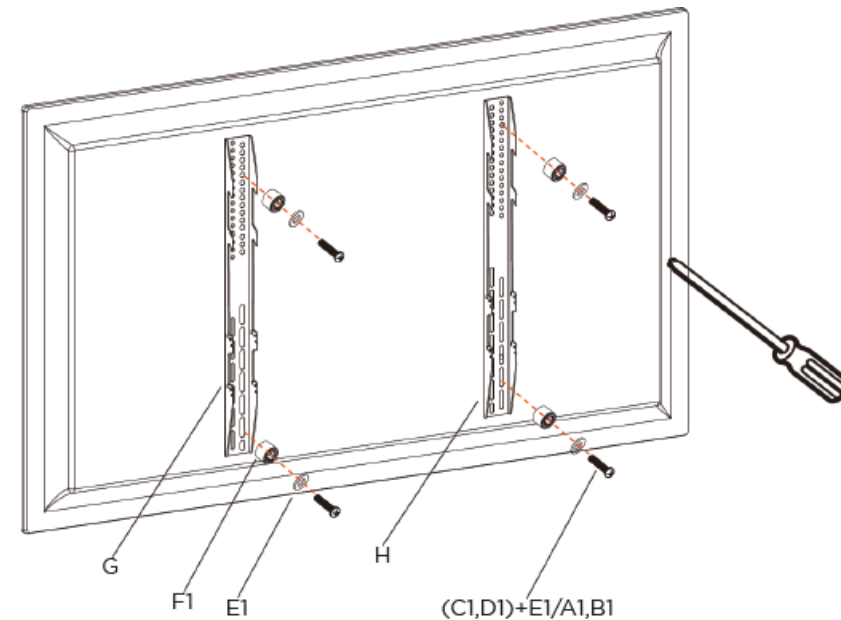

Fig. 10

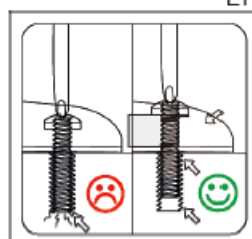
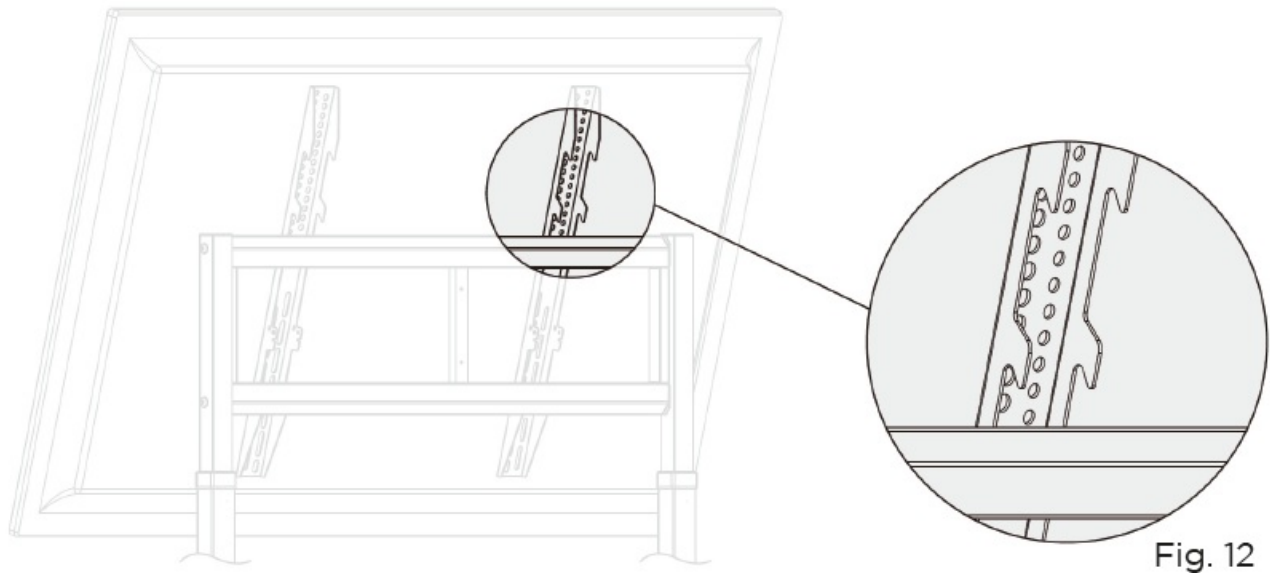

Fig. 11

STEP 4 | MOUNTING THE DISPLAY

- To prevent the display from colliding with the shelf, adjust the bracket to the correct height before hanging the display. Make sure that the display stand is in the lowest position. The VESA brackets have two recesses that can be used to mount the bracket at different heights on the display stand. Hang the display on the display stand with two people.



- Fig. 12 Ensure that the display is centred on the cross strut. To fix the display and pre-vent unintentional unhinging, fit the unhinging protection E2 and F2 with the screws D2 on both sides.

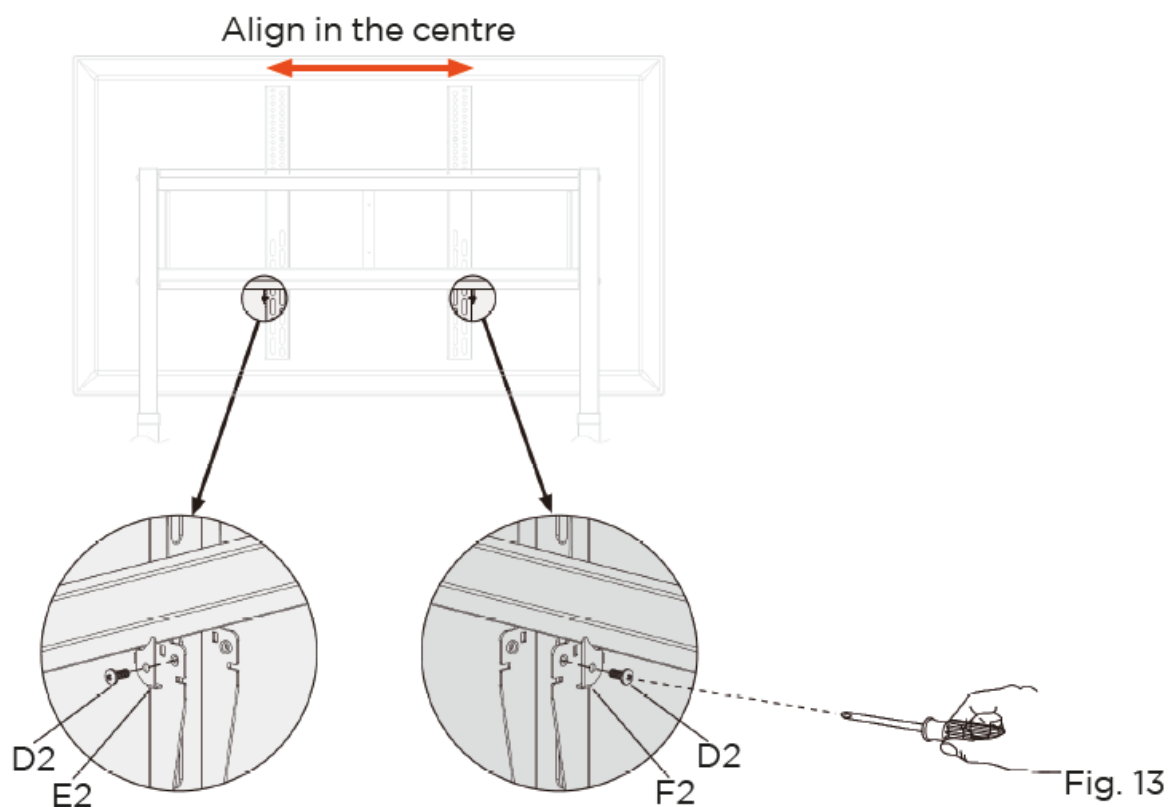

STEP 5 | WIRING

- Make sure that there are no people or objects in the area of travel when the display stand is in use. Attach the two brackets I for the cable management to the castor base and route the outgoing cables through these brackets.



Fig. 14



Fig. 15

STEP 6 | REMOTE CONTROL

- Replacing the battery in the remote control:
- Loosen the screw on the back of the battery cover. Remove the cover. Replace the battery, ensuring that the polarity is correct. Place the cover back on the battery compartment. Screw the cover back on.

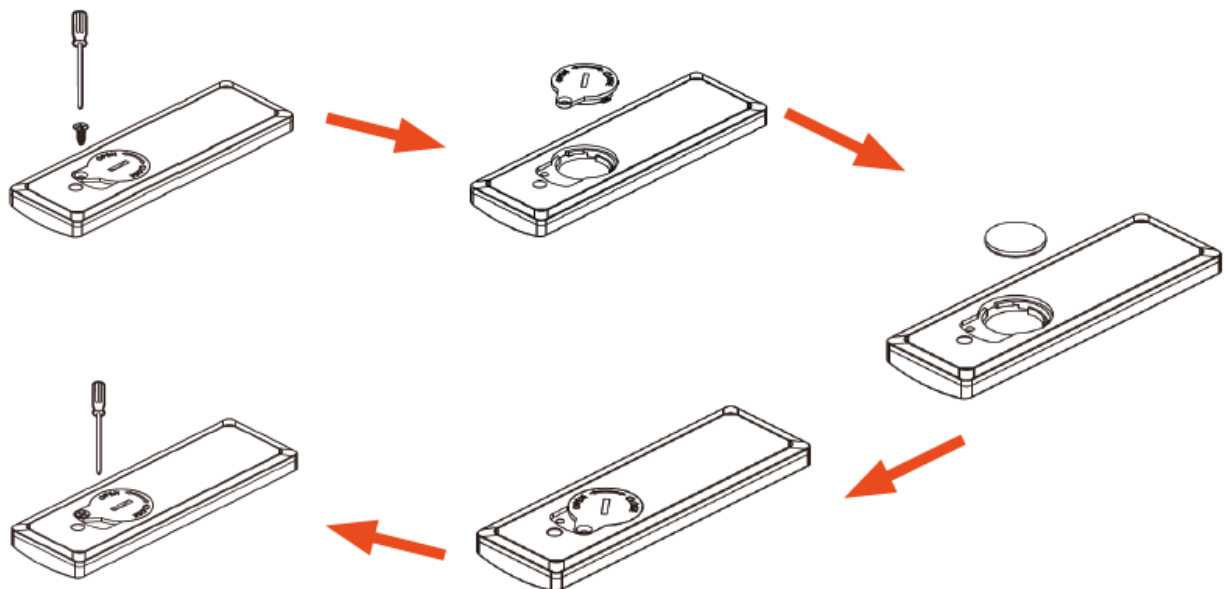
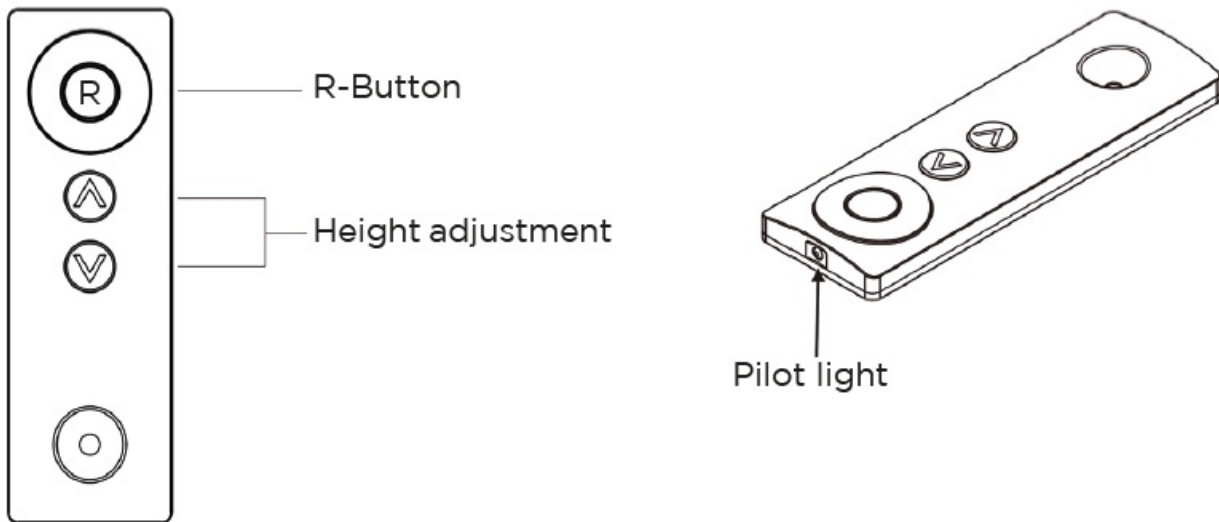

Fig. 16

Pairing the remote control:

- Make sure that the display stand is not connected to the power supply. Press and hold the 'R' button on the remote control until the indicator light lights up. Continue to hold down the 'R' button while connecting the display stand to the power supply. Release the button as soon as the indicator light on the remote control goes

out.



STEP 7 | MOUNTING OPTIONAL CAMERA SHELF

- You have the option of mounting the supplied camera shelf on the display stand.
- To do this, attach the camera shelf M to the mounting strut L using the screw O.

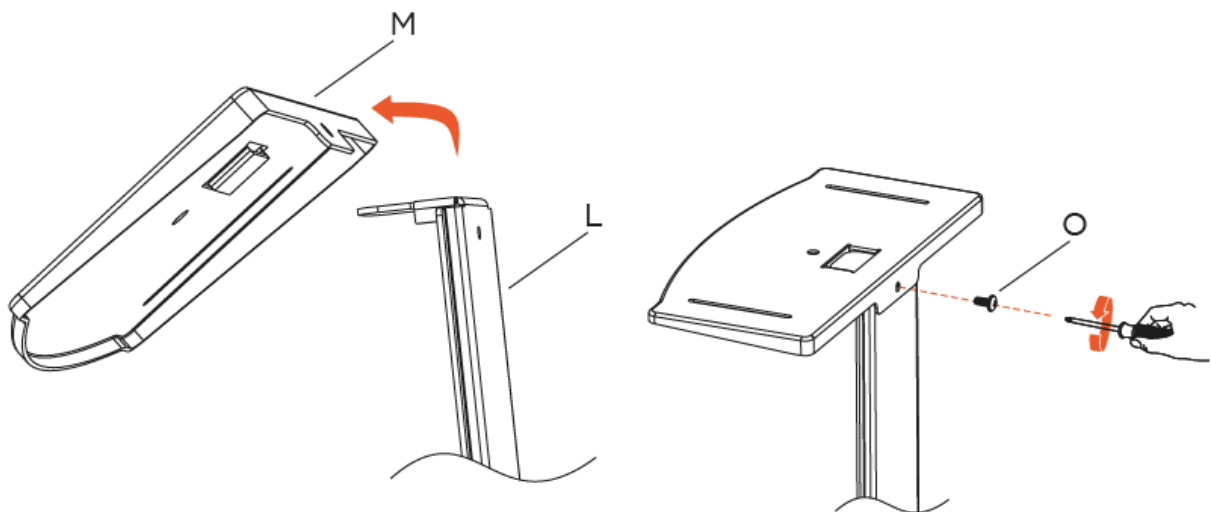

Fig. 17

- Attach the entire camera shelf to the back of the display stand using screws D2, as shown in Figure 18.
- Tighten the screws firmly but do not overtighten them to avoid damage.

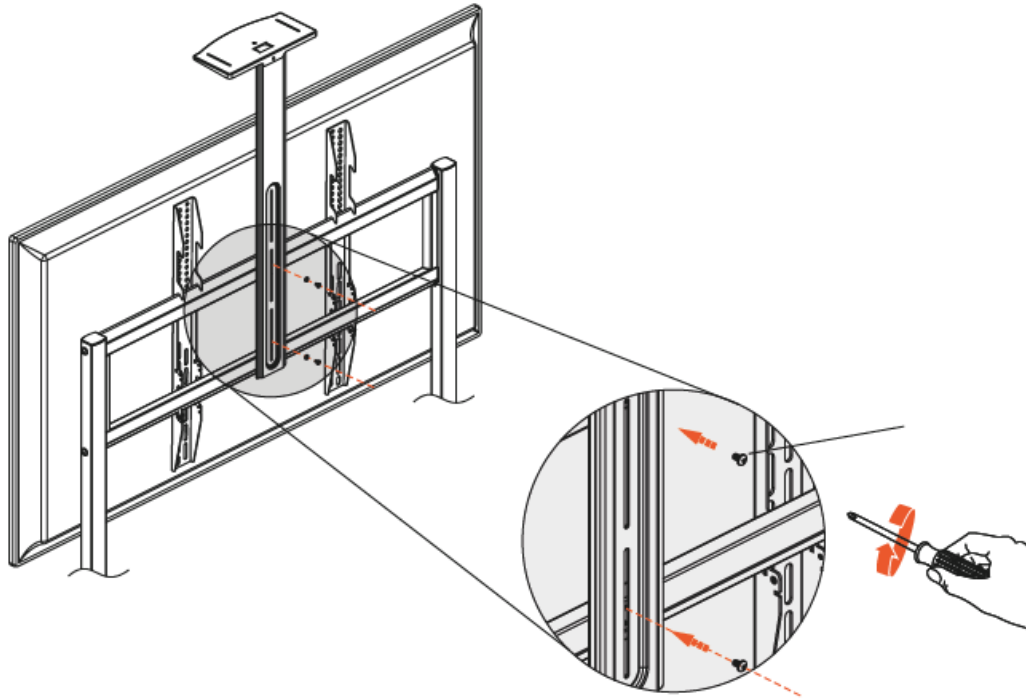

Fig. 18

INFORMATION ON EU CONFORMITY

- Manufacturer: celexon Europe GmbH
- Address: Gutenbergstraße 2, 48282 Emsdetten, DE
- Product name: celexon Expert electrically height-adjustable display trolley Oslo / Oslo Max

Hereby celexon Europe GmbH declares that the celexon Expert electrically height-adjustable display trolley Oslo / Oslo Max complies with the directive 2014/53/ EU. The EU declaration of conformity can be downloaded from the following address: www.celexon.de/zertifikate



The symbol indicates the separate collection of electrical and electronic devices in EU countries. Please do not throw the device into household waste. Find out about the return system applicable in your country and contact your local authority or your local waste and pollutant collection point if you have any questions about the disposal process.

INFORMATION ON UK CONFORMITY

- Manufacturer: celexon Europe GmbH
- Address: Gutenbergstraße 2, 48282 Emsdetten, DE
- Product name: celexon Expert electrically height-adjustable display trolley Oslo / Oslo Max

Hereby celexon Europe GmbH declares that the radio equipment type celexon Expert electrically height-adjustable display trolley Oslo / Oslo Max complies with the Radio Equipment Regulations 2017. The UK

declaration of conformity can be downloaded from the following address: www.celexon.de/zertifikate



The symbol indicates the separate collection of electrical and electronic devices in EU countries. Please do not throw the device into household waste. Find out about the return system applicable in your country and contact your local authority or your local waste and pollutant collection point if you have any questions about the disposal process.

Frequently Asked Questions

- **Q: What is the maximum load capacity of the product?**

A: The maximum load capacity of the display trolley is 90 kg.

- **Q: What battery type does the product use?**

A: The product uses a CR2032 battery.

- **Q: What are the height ranges for Oslo and Oslo Max?**

A: The height range for Oslo is 200 – 900 mm, and for Oslo Max is 200 – 1200 mm.

Documents / Resources

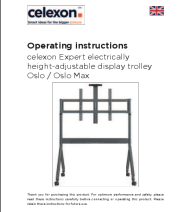
	<p>celexon 32424_102 Expert Electrically Height Adjustable Display Trolley [pdf] Instruction Manual</p> <p>32424_102, 32424_102 Expert Electrically Height Adjustable Display Trolley, 32424_102, Expert Electrically Height Adjustable Display Trolley, Electrically Height Adjustable Display Trolley, Height Adjustable Display Trolley, Adjustable Display Trolley, Display Trolley, Trolley</p>
---	--

References

-  [celexon | Smart Ideas for the bigger picture](#)
- [User Manual](#)

[Manuals+](#), [Privacy Policy](#)

This website is an independent publication and is neither affiliated with nor endorsed by any of the trademark owners. The "Bluetooth®" word mark and logos are registered trademarks owned by Bluetooth SIG, Inc. The "Wi-Fi®" word mark and logos are registered trademarks owned by the Wi-Fi Alliance. Any use of these marks on this website does not imply any affiliation with or endorsement.