



cecotec Super Automatic Coffee Machine Instruction Manual

[Home](#) » [cecotec](#) » cecotec Super Automatic Coffee Machine Instruction Manual 

cecotec

CREMMAET MACCHIA BLACK
CREMMAET MACCHIA BLACK ROSE
CREMMAET MACCHIA WHITE
CREMMAET MACCHIA WHITE ROSE
Super-automatic coffee machine



Cumbia
Instruction manual

Contents

- 1 SAFETY INSTRUCTIONS
- 2 PARTS AND COMPONENTS
- 3 BEFORE USE
- 4 OPERATION
- 5 CLEANING AND MAINTENANCE
- 6 TROUBLESHOOTING
- 7 TECHNICAL SPECIFICATIONS
- 8 DISPOSAL OF OLD ELECTRICAL AND ELECTRONIC APPLIANCES
- 9 TECHNICAL SUPPORT AND WARRANTY
- 10 COPYRIGHT
- 11 Documents / Resources
 - 11.1 References
- 12 Related Posts

SAFETY INSTRUCTIONS

Read these instructions thoroughly before using the device.
Keep this instruction manual for future reference or new users.

- The appliance can be used by persons with reduced physical, sensory, or mental capabilities or lack of experience and knowledge if they have been given supervision or instruction concerning use of the appliance in a safe way and understand the hazards involved.
- The device is not intended to be used by children. Keep the appliance and its power cable out of the reach of children.
- Cleaning and maintenance tasks should not be carried out by children.
- Children must not play with the device.
- Check the power cable regularly for visible damage. If the power cable is damaged, it must be replaced by the Technical Support Service of Cecotec or similar qualified personnel to avoid risks.
- This device is designed for domestic use only and is not intended for bars, restaurants, farmhouses, hotels, motels, and offices.
- Do not immerse the cable, plug, or any other part of the appliance in water or any other liquid or expose electrical connections to water. Make sure your hands are dry before handling the plug or switching on the appliance.
- WARNING: the filling opening must not be opened during operation.
- WARNING: take precautions to avoid spillage of liquids on the cable.
- WARNING: incorrect or improper use can be dangerous for the user and damage the appliance. Use the appliance only for the purposes described in this manual. The surface of the heating element is subject to residual heat after use.
- Always disconnect the appliance from the power supply if it is left unattended and before assembly, disassembly, or cleaning.
- It is your responsibility to make sure every user is informed about the warnings and precautions stated in this instruction manual. Do not use the appliance for any use other than the one specified in this manual.
- Make sure that the mains voltage matches the voltage stated on the rating label of the appliance and that the wall outlet is earthed.
- Disconnect the appliance from the mains in any of the following circumstances:

- Before filling up the water tank.
- Before removing or installing any of the appliance's parts.
- Before cleaning or maintenance.
- When the appliance is not working properly.
- After using the appliance.
- Empty the water tank when the appliance is not going to be used for some time.
- Make sure the appliance has cooled down completely before removing or installing parts and before cleaning it.
- Always use cold water. The use of hot water or other liquids may damage the appliance.
- Use the grinder to grind only coffee beans.
- Do not use caramelised or frozen coffee beans. This appliance can only be used with natural coffee beans.
- Never leave the appliance unattended when it is connected to a mains power supply.
- Do not let the cable protrude over the edge of the table or worktop or come into contact with hot surfaces or sharp edges.
- Place the appliance on a flat, stable surface. Do not use or place the appliance on a hot or damp surface.
- Do not use the appliance if the drip tray is not properly positioned.
- Do not use the appliance if any of its parts are damaged or if the appliance is not working properly.
- **WARNING:** this product has undergone a quality control previous to its commercialisation with the aim of ensuring its correct functioning. After the quality control testing, the appliance is cleaned thoroughly, therefore, although it is unlikely to occur, there could be rests of water or coffee drops inside it.

PARTS AND COMPONENTS

Fig. 1

1. Grind setting knob
2. Coffee bean tank cover
3. Control panel
4. Coffee spout
5. Drip tray grid
6. Drip tray
7. Cleaning brush
8. Inner drip tray
9. Panel
10. Coffee waste tank
11. Brewing unit
12. Water tank

Fig. 2

1. Power icon
2. Warning for lack of coffee indicator light
3. Warning for lack of water indicator light
4. Warning for grinder cleaning indicator light

5. Warning indicator light
6. Warning for full waste tank indicator light
7. Coffee bean emptying icon
8. Single Espresso icon
9. Double Espresso icon
10. Americano icon
11. Manual cleaning icon

NOTE:

the graphics in this manual are schematic representations and may not exactly match the device.

BEFORE USE

- This appliance is packaged in a way as to protect it during transport. Take the device out of its box and remove all packaging materials. You can keep the original box and other packaging elements in a safe place. This will help you prevent damage to the device when transporting it in the future. In case the original packaging is disposed of, make sure all packaging materials are recycled accordingly.
- Make sure all parts and components are included and in good conditions. If there is any piece missing or in bad conditions, contact the official Cecotec Technical Support Service immediately.

Box content

- Cremmaet Macchia superautomatic coffee machine (in any of its designs)
- Instruction manual

OPERATION

To prepare the coffee machine before the first use, follow the instructions below:

1. Water tank

Fill the water tank with distilled water up until the Max mark and place it back in the machine.

Make sure it is in the correct position.

2. Grind setting knob

- Turn the grind setting knob to the left.
- Turn the grind setting knob clockwise.

NOTE: when using the machine for the first time, set the grind setting to a level higher than 8.

The adjustable grinding levels range from 1 (finest) to 15 (coarsest). The number of the arrow on the grind level icon corresponds to the selected grind level.

WARNING: it is suggested not to adjust several levels at the same time to avoid causing damage. Never adjust the grinding level when the grinder is not in operation, as this could damage the grinder.

3. Adjust the coffee spout to the desired height

The height of the coffee spout can be adjusted between 85 and 115 mm, depending on the cup to be used, so you will have to adjust it. All you have to do is raise or lower it by exerting a little force.

4. Coffee machine

- Open the panel and check that the brewing unit is properly installed in its position.

– Check if the arrow on the brewing unit is aligned with the arrow on the upper bracket. If you hear a click when removing and reassembling it, this indicates that the brewing unit is correctly assembled.

NOTE: the warning indicator light will light up and remain steady if the brewing unit is not installed in the correct position.

– Close the panel and check that the panel and the machine body are in the same horizontal plane.

NOTE: the warning indicator light will flash if the panel is not properly closed.

5. Inner drip tray and waste tank

Open the panel and check if the drip tray and the waste tank are installed in place.

NOTE: the inner drip tray is not correctly installed in position if the warning indicator light is flashing. The machine will not operate if there are any foreign objects in the front part of the waste tank.

6. Drip tray grid

– Place the drip tray grid in the drip tray. The drip tray grid must be installed properly so that a coffee cup can be placed on it.

– Put the drip tray into the appliance.

NOTE: the drip tray collects the water from the spout during each rinsing and self-cleaning as well as any coffee that may spill during preparation. Empty and clean the drip tray daily.

7. Coffee bean tank

Fill the coffee bean tank with the appropriate amount of fresh beans, maximum 200 g, then close the coffee bean tank cover.

WARNING: if the grinding blade has previously been removed, make sure that it is correctly installed when it is replaced before filling the coffee bean tank. Otherwise, you will have to empty it because it will be difficult to install.

Coffee machine operation

This is a multifunctional coffee machine, it has the functions “Single Espresso”, “Double Espresso”, “Americano”, “Manual Cleaning” and “Coffee Bean Emptying”, as you can see on the control panel.

SPECIAL NOTE: the product will automatically perform cleaning to prepare for operation each time it is started.

NOTE: coffee will come out drop by drop at the beginning (2-3 seconds after starting) and at the end (6-8 seconds before the end), this is normal operation.

Switching on and preheating

- Connect the machine to the mains and press the power switch at the back of the machine.
- Press and hold the power switch for at least 0.3 seconds. The corresponding indicator light will flash, and the machine will enter the self-test state.
- Place a cup under the coffee spout.
- The manual cleaning indicator will remain illuminated, and the power switch indicator light will flash; then, the machine will enter the preheating function and the automatic cleaning state.
- When preheating is complete, the Single Espresso, Double Espresso, Americano and Manual cleaning indicator lights will remain illuminated, and the machine will then enter standby mode. It is now ready for use.

Preparing a cup of espresso coffee

- Place a cup under the coffee spout.
- Press and hold down the Single Espresso icon for at least 2 seconds; the machine will start to prepare a cup of

espresso. The single espresso indicator light will light up steadily during the preparation process.

- When the espresso preparation is finished, the machine automatically enters standby mode.

NOTE: you can press the espresso icon during coffee preparation to cancel the process.

Preparing a double cup of espresso coffee

- Place a cup under the coffee spout.
- Press and hold down the Double Espresso icon for at least 2 seconds; the machine will start to prepare a double cup of espresso. The double espresso indicator light will light up steadily during the preparation process.

NOTE: double espresso is achieved by preparing two single espresso cycles continuously, so you should not remove the cup during the preparation process.

- When the double espresso preparation is finished, the machine automatically enters standby mode.

NOTE: you can press the double espresso icon during coffee preparation to cancel the process.

Preparing an Americano

- Place a cup under the coffee spout.
- Press and hold the Americano icon for at least 2 seconds; the machine will start brewing Americano. The Americano coffee indicator light will remain illuminated during the Americano coffee preparation process.
- Once the Americano coffee has been prepared, the machine will automatically enter standby mode.

NOTE: you can press the Americano icon during coffee preparation to cancel the process.

Manual cleaning

- Place a cup under the coffee spout.
- Press and hold the Manual Cleaning icon for at least 2 seconds; the machine will start the manual cleaning function.
- When cleaning is complete, the machine will automatically enter standby mode.

NOTE: you can press the manual cleaning icon during cleaning to cancel the process.

Coffee bean emptying

NOTE: this function is used to empty the coffee beans from the coffee bean tank. Use this function carefully to avoid waste.

- Press and hold the coffee bean emptying icon for at least 2 seconds; the machine will start the coffee bean emptying function. During this process the indicator light for the emptying function will remain on while all other indicator lights will remain off.
- Remove the waste tank and empty it of debris.
- Once the process is complete, the machine will automatically enter standby mode.

NOTE: you can press the coffee bean emptying icon during cleaning to cancel the process.

NOTE: the emptying function lasts 15 seconds. Please, repeat the above operation if there are too many coffee

beans left in the tank.

Energy saving mode

- Press and hold the power icon for at least 2 seconds in standby mode. The machine will enter standby mode. At this point, all indicator lights will turn off and all functions will be disabled.
- To exit the standby mode, press and hold the power icon for at least 8 seconds. The machine then performs a self-test, preheating and self-cleaning, and finally enters standby mode.
- The machine will enter standby mode if no operation is performed for 28 minutes. All indicator lights will turn off and all functions will be disabled during standby mode.

Adjusting the amount of coffee

After coffee starts being dispensed, press, and hold the icon of the coffee type you have selected for 2 seconds; then, the buzzer will beep, and the corresponding coffee indicator light will flash. Finally, the machine will enter the setting for the amount of coffee dispensed.

As soon as the coffee in the cup reaches the desired level, release the coffee type icon so that the machine stops operating. The set amount of coffee will be saved. The amount of coffee dispensed according to the type of coffee is:

1. Single espresso: 30-100 ml
2. Double espresso: (30-100 ml) *2
3. Americano: 220-180 ml

Reset function

Press and hold the single and the double Espresso icons for two seconds. Then, all settings will go back to factory default settings.

CLEANING AND MAINTENANCE

WARNING: make sure to unplug the coffee machine and allow it to cool down completely before cleaning it. To prevent electric shocks, do not immerse the cord, plug or main body in water or any other liquid. Unplug the device after every use.

- Wipe the outer surface of the product with a soft, damp cloth to remove stains, but avoid using abrasive cleaning tools, which will scratch the product. Do not use cleaners containing alcohol or solvents.
- Water droplets may accumulate in the area above the drip tray grid or on the worktop during preparation. To control dripping, wipe the area with a clean, dry cloth after each use of the product.
- The water tank, drip tray, drip tray grid, inner drip tray, waste tank and panel are not dishwasher safe.
- The water in the grid and drip tray, as well as the coffee grounds in the inner drip tray and the waste tank, must be emptied and cleaned thoroughly.
- Clean the parts according to the description and operation below.

Non-removable parts	Non-removable parts	How to clean them
Powder-dispensing channel	Check it once a week.	<p>Method 1:</p> <ol style="list-style-type: none"> 1. Press and hold down the icons coffee bean emptying and single espresso for 2 seconds, their corresponding indicator lights will flash. 2. After opening the panel of the coffee machine (the appliance remains in the safety protection mode), the inside of the machine can be cleaned. 3. Open the panel and loosen the ground coffee in the powderdispensing channel with a toothpick, then close the panel. 4. Press and hold down the icons coffee bean emptying and single espresso for 3 seconds, their corresponding indicator lights will turn off and the panel will close. <p>Method 2:</p> <p>If there are only a few coffee beans left in the tank, press, and hold the coffee bean emptying icon for at least one second to keep the machine running until the ground coffee blocked in the powder-dispensing channel is emptied, after which the machine will return to normal operation.</p> <p>NOTE: if the ground coffee becomes finer during use, check the powderdispensing channel for any dust blockage. It should be cleaned once a week.</p>
Brewing base	Check it once a week.	Clean the coffee residue around the brewing base with a brush.
Brewing system bracket	Check it once a week.	<ol style="list-style-type: none"> 1. When the appliance is on, hold and press the manual cleaning icon and double Espresso icon for 1 second. 2. After opening the panel of the coffee machine (the appliance remains in the safety protection mode), the inside of the machine can be cleaned. 3. When cleaning is complete, close the panel. 4. Hold and press the manual cleaning icon and double Espresso icon for 1 second to exit the cleaning function.

Cleaning the waste tank

- Open the panel.
- Remove the waste tank.
- Empty the coffee grounds into the waste tank.
- Rinse the waste tank under the tap.
- Install the waste tank into the appliance.
- When cleaning is complete, close the panel.

Cleaning the brewing unit

- Open the panel.
- Remove the brewing unit.
- Rinse the brewing unit under the tap.
- Install the brewing unit into the appliance.

- When cleaning is complete, close the panel.

Cleaning the water tank

- Remove the water tank from the machine.
- Rinse the water tank under the tap.

Cleaning the drip tray

- Remove the drip tray.
- Add some cleaning solution and rinse the drip tray under the tap.
- After cleaning, reinstall the drip tray.

Cleaning the grinder

- Turn the grind setting knob to the left.
- Remove the internal grinding wheel counterclockwise.
- Clean it with the cleaning brush and empty the ground coffee at the gap.
- Clean the grinding chamber with the cleaning brush.
- Install the grinding wheel and return the grind setting knob to its correct position.
- Turn the grind setting knob.
- Let the grinder continue to run to remove the remaining powder in the grinding chamber (repeat steps 3 and 4 if some powder remains).
- Turn the grind setting knob counterclockwise.
- Install the internal grinding wheel clockwise.
- Install the grind setting knob clockwise; then the cleaning is complete.

Cleaning the brewing system bracket

- When the appliance is on, hold and press the manual cleaning icon and double Espresso icon for 1 second.
- After opening the panel of the coffee machine (the appliance remains in the safety protection mode), the inside of the machine can be cleaned.
- When cleaning is complete, close the panel.
- Hold and press the manual cleaning icon and double Espresso icon for 1 second to exit the cleaning function.

Cleaning the powder-dispensing channel

Method 1:

1. Press and hold down the icons coffee bean emptying and single espresso for 2 seconds, their corresponding indicator lights will flash, and the panel will be open.
2. Open the panel and loosen the ground coffee in the powder-dispensing channel with a toothpick, then close the panel when you have dispensed the ground coffee.
3. Press and hold down the icons coffee bean emptying and single espresso; press them again at the same time

for at least 1 second. Their corresponding indicator lights will turn off and the panel will close.

Method 2:

If there are only a few coffee beans left in the tank, press and hold the coffee bean emptying icon for at least one second to keep the machine running until the ground coffee blocked in the powder-dispensing channel is emptied, after which the machine will return to normal operation.

Descaling

- The machine must be descaled when the Americano and double Espresso indicator lights flash at the same time.
- Fill the water tank with water and a descaling solution up to the MAX level indicated on the water tank (the scale of water and descaler is 4:1, the detail refers to the instructions of the descaler). You can also use a “household descaler”, i.e., citric acid (100 parts water to 3 parts citric acid).
- Place a container on the drip tray grid.
- Press and hold down the Americano and double Espresso icons for 1 second; the machine will enter the descaling process.
- The descaling process lasts 10 minutes approximately. The eight (8) operating light indicators will slowly flash from left to right.
- Once the descaling process is finished, the hot water and manual cleaning light indicators will stop flashing.

NOTE: the number of brewing cycles is reset to zero and restarts counting after descaling is complete. The descaling warning will occur when the machine has reached 500 coffee cycles.

TROUBLESHOOTING

Problem	Cause	Solution
The warning for lack of water indicator light flashes	Water tank is out of water.	1. Fill up the water tank. 2. If this does not solve the problem, contact the official Cecotec Technical Support Service.
The warning indicator light flashes	The grind setting knob, panel and inner drip tray are not correctly installed in their place.	1. Install the grind setting knob, panel, and drip tray correctly. 2. If this does not solve the problem, contact the official Cecotec Technical Support Service.
The warning indicator light remains lit	The brewing unit or the inner drip tray are not correctly installed in their place.	1. Install the brewing unit or the inner drip tray correctly. 2. If this does not solve the problem, contact the official Cecotec Technical Support Service.
Warning for lack of coffee indicator light remains lit	Coffee beans are missing in the coffee bean tank.	Fill the tank with coffee beans and then start the machine to prepare coffee.
The warning for full waste tank indicator light remains lit	It is necessary to empty the waste tank.	1. Remove the waste tank and the inner drip tray to clean them. After 2 seconds, the full waste tank indicator light will turn off. 2. If this does not solve the problem, contact the official Cecotec Technical Support Service.

The warning for grinder cleaning indicator light remains lit	The brewing unit must be cleaned.	<ol style="list-style-type: none"> 1. Remove the brewing unit to clean it. After 2 seconds, the brewing unit cleaning indicator light will turn off. 2. If this does not solve the problem, contact the official Cecotec Technical Support Service.
The single Espresso and the warning indicator lights flash at the same time	The grinding motor is not working properly.	<ol style="list-style-type: none"> 1. Restart the coffee machine. 2. If this does not solve the problem, contact the official Cecotec Technical Support Service.
The warning for lack of coffee and the warning indicator lights flash at the same time	It means that the appliance has grinded beans, and the time does not correspond to the time set by the software. The grinding system will then be forcibly switched off.	<ol style="list-style-type: none"> 1. Leave the appliance switched off for 5 minutes. 2. If this does not solve the problem, contact the official Cecotec Technical Support Service.
The manual cleaning and the warning indicator lights flash at the same time	The flow meter has no signal, and the water supply is abnormal.	<ol style="list-style-type: none"> 1. Fill up the water tank. 2. If this does not solve the problem, contact the official Cecotec Technical Support Service.
The manual cleaning, single Espresso, and warning indicator lights flash at the same time	The coffee machine does not work properly.	<ol style="list-style-type: none"> 1. Restart the coffee machine. 2. If this does not solve the problem, contact the official Cecotec Technical Support Service.
The crema is not rich	The ground coffee is too coarse.	Turn the grind setting knob clockwise to select the right adjustment.
	The type of coffee beans used is not correct.	Use the right coffee beans to prepare espresso coffee. Consider the quality of the grain as well as its roasting.
The coffee comes out slowly or drop by drop	The ground coffee is too fine.	Turn the grind setting knob counterclockwise to select the right adjustment.
Coffee does not come out of the coffee spout	The coffee spout is blocked.	Clean the coffee spout with a toothpick.
The coffee machine cannot be switched on	The power cord is not properly plugged.	Plug the power cable into the outlet.
The brewing unit cannot be removed	The coffee machine has not been switched off correctly.	Turn the machine off and then on again to restart the machine. If this does not solve the problem, contact the official Cecotec Technical Support Service.
	The brewing unit is blocked.	If this does not solve the problem, contact the official Cecotec Technical Support Service.
Both the waste tank indicator light and the machine's cleaning indicator light light up	You must empty the waste tank and clean the machine when the machine is switched off.	<p>Always empty the waste tank and clean the brewing unit when it is switched off.</p> <p>Reinstall them after waiting at least 3 seconds.</p>

The waste tank is not full, but the appliance prompts you to empty it or to clean the brewing unit	The counter does not reset after emptying the waste tank or cleaning the machine.	After emptying the waste tank, always wait about 3 seconds for the counter to reset. Always empty the waste tank and clean the coffee machine when it is switched off. The counter will not be reset if the waste tank is emptied, or the brewing unit is cleaned when the machine is switched off.
The coffee machine can grind coffee beans, but no coffee comes out	Please check that heavily roasted coffee beans do not have oil on the surface. The coffee powder dispensing channel will be blocked if the coffee beans are wet or there is too much oil on the surface.	<ol style="list-style-type: none"> 1. Press and hold down the icons coffee bean emptying and single espresso for 2 seconds, their corresponding indicator lights will flash, and the panel will be open. 2. Open the panel and loosen the ground coffee in the powderdispensing channel with a toothpick, then close the panel when you have dispensed the ground coffee. 3. Press and hold down the icons coffee bean emptying and single espresso for 3 seconds, their corresponding indicator lights will turn off and the panel will close.
The coffee machine makes a lot of noise	It is normal for the coffee machine to make noise during operation.	If the machine starts to make any other noise, lubricate the brewing system, and contact the after-sales service.

TECHNICAL SPECIFICATIONS

Product reference: 01599/01716/01717/01718

Product: Cremmaet Macchia Black Superautomatic Coffee Machine, Cremmaet Macchia Black

Rose Superautomatic Coffee Machine, Cremmaet Macchia White Superautomatic Coffee

Machine, Cremmaet Macchia White Rose Superautomatic Coffee Machine

Voltage: 220-240 V

Frequency: 50 Hz

Power: 1350 W

Grinder power: 150 W

Technical specifications may change without prior notification to improve product quality.

Made in China | Designed in Spain

DISPOSAL OF OLD ELECTRICAL AND ELECTRONIC APPLIANCES



This symbol indicates that, according to the applicable regulations, the product and/or batteries must be disposed of separately from household waste. When this product reaches the end of its shelf life, you should dispose of the cells/batteries/accumulators and take them to a collection point designated by the local authorities. Consumers must contact their local authorities or retailer for information concerning the correct disposal of old appliances and/or their batteries.

Compliance with the above guidelines will help protecting the environment.

TECHNICAL SUPPORT AND WARRANTY

Cecotec shall be liable to the end user or consumer for any lack of conformity that exists at the time of delivery of the product under the terms, conditions, and deadlines established by the applicable regulations.

It is recommended that repairs be carried out by qualified personnel.

If at any moment you detect any problem with your product or have any doubt, do not hesitate to contact the official Cecotec Technical Support Service at +34 963 210 728.

COPYRIGHT

The intellectual property rights over the texts in this manual belong to CECOTEC INNOVACIONES, S.L. All rights reserved. The contents of this publication may not, in whole or in part, be reproduced, stored in a retrieval system, transmitted, or distributed by any means (electronic, mechanical, photocopying, recording or similar) without the prior authorization of CECOTEC INNOVACIONES, S.L.

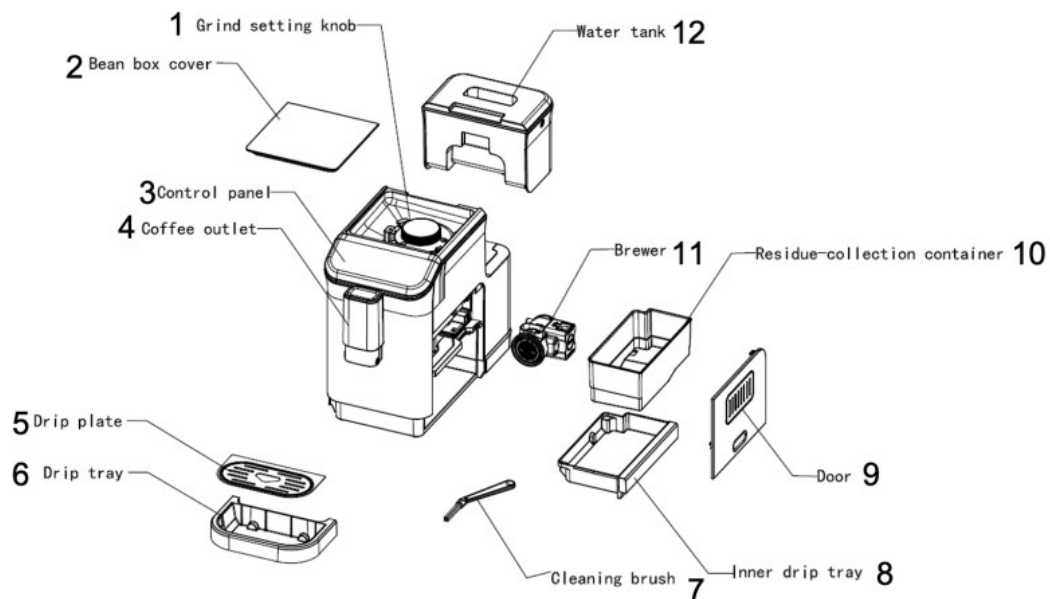

Fig. / Img. / Rys. / Obr. 1

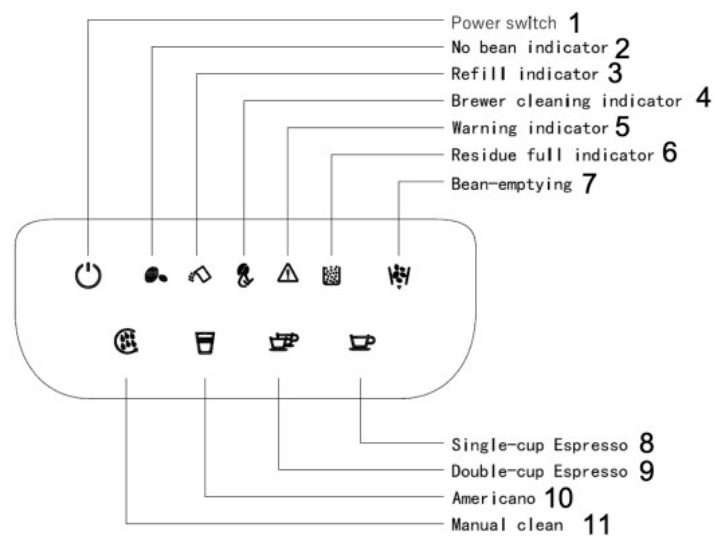



Fig. / Img. / Rys. / Obr. 2

cecotec

www.cecotec.es

Cecotec Innovaciones S.L.

Documents / Resources

	<p>cecotec Super Automatic Coffee Machine [pdf] Instruction Manual Super Automatic Coffee Machine, Automatic Coffee Machine, Coffee Machine, Machine</p>
---	--

References

- [User Manual](#)