



cecotec 870 Robot Window Cleaner Instruction Manual

[Home](#) » [cecotec](#) » cecotec 870 Robot Window Cleaner Instruction Manual 

Contents

- 1 cecotec 870 Robot Window Cleaner
- 2 SAFETY INSTRUCTIONS
- 3 BATTERY INSTRUCTIONS
- 4 PARTS AND COMPONENTS
- 5 BEFORE USE
- 6 Box contents
- 7 OPERATION
- 8 CLEANING AND MAINTENANCE
- 9 TROUBLESHOOTING
- 10 SMARTPHONE APP
- 11 TECHNICAL SPECIFICATIONS
- 12 DISPOSAL OF OLD ELECTRICAL AND ELECTRONIC APPLIANCES
- 13 TECHNICAL SUPPORT AND WARRANTY
- 14 COPYRIGHT
- 15 DECLARATION OF CONFORMITY
- 16 Documents / Resources
 - 16.1 References
- 17 Related Posts



cecotec 870 Robot Window Cleaner



SAFETY INSTRUCTIONS

Read these instructions thoroughly before using the product. Keep this instruction manual for future reference or new users.

- Make sure that the mains voltage matches the voltage stated on the rating label of the device and that the wall outlet is grounded.
- This appliance is intended for domestic use only. Do not use it for industrial or commercial purposes.
- Check the power cord regularly for visible damage. If the cord is damaged, it must be replaced by the official Technical Support Service of Cecotec to avoid any type of danger.
- The device may only be assembled, disassembled, and repaired by qualified personnel.
- Do not touch the cable, the power socket, or the charger when your hands are wet.
- Keep the appliance away from clothing, curtains, and similar materials. Keep hair, fingers, and other body parts away from the appliance's openings.
- Do not sit on or place sharp or heavy objects on top of the appliance or its cord.
- Do not use the appliance near heat sources, flammable substances, wet surfaces on which it may fall or where water may be spilled, or allow it to come into contact with water or other liquids.
- Do not use the charger if it has a broken cord or plug or if it is not working properly. In case of fault or malfunction, contact the official Technical Support Service of Cecotec.
- The device can only be operated with the battery and charger provided. The use of other components or accessories may result in fire, electric shock, damage to the appliance, or risk thereof.
- Do not expose the device to excessive moisture or rain and keep it away from liquids.
- Do not expose the device to direct sunlight, strong light, or strong magnetic fields.
- Ensure enough ventilation around the adapter when using the appliance. Do not cover the power adapter with objects that could reduce cooling.
- To avoid risks, do not disassemble, short-circuit, incinerate, or heat up the battery above 60 °C.

- Make sure the appliance is unplugged from the mains and switched off after use and before cleaning or maintenance. To disconnect it, do not pull on the power cord. Instead, pull on the adapter.
- Do not twist, bend, strain, or damage the power cord. Do not place any heavy or sharpened objects on the cord, as this could cause a fire or electrical shock.
- Do not leave the appliance unattended when it is plugged to a power outlet or in operation.
- Do not use the appliance if it has been dropped, if it shows visible signs of damage, or if it is leaking.
- Keep the appliance out of the reach of children when it is running or cooling down.
- Do not use the appliance on frameless windows.
- Do not use the appliance on broken glass or windows. The reflective glass or coating may get slightly scratched due to soiling of the glass when using the device.
- This appliance can be used by children aged 8 and above, and persons with reduced physical, sensory, or mental capabilities or lack of experience and knowledge, as long as they have been given supervision or instruction concerning the use of the appliance in a safe way and understand the hazards involved. Children must not play with the appliance.
- Supervise children to make sure they do not play with the appliance. Close supervision is necessary if the appliance is used by or near children.
- It is recommended not to use the device on glass less than 3 mm thick.
- **PLEASE NOTE:** Do not operate the appliance without securing it to a sturdy, solid surface in your home with the safety rope. After and before every use, you must check the safety rope is not damaged. Make sure that it is securely fastened and at a suitable height to break the fall of the device in case it is dropped.

BATTERY INSTRUCTIONS

- This device includes a built-in lithium-ion battery, the removal of which must be carried out by a qualified professional.
- Do not burn or expose the battery to high temperatures, as it may explode.
- Both batteries and cells can leak under extreme conditions. Should they leak, do not touch the liquid. If the liquid gets into contact with skin, wash immediately with soap and water. If the liquid gets into the eyes, wash them immediately with clean water for a minimum of 10 minutes and seek medical attention. Wear gloves when handling the battery and dispose of it immediately in accordance with local regulations.
- Avoid contact between the battery and small metallic objects such as paper clips, coins, keys, nails, or screws.
- Never modify the charger in any way.
- The battery must be removed for safe disposal.
- Keep batteries out of the reach of children when there is a risk of ingestion.
- Battery ingestion can cause burns, soft tissue perforation, and death. It can cause severe burns within two hours of the ingestion.
- In case of battery ingestion please seek medical help immediately.
- **WARNING:** To recharge the battery, use only the power supply unit provided with the appliance, reference WT120-2403750-T.
- Non-rechargeable batteries should not be recharged.
- The battery supply terminals must not be short-circuited.
- Battery must be inserted in the correct position. When replacing batteries, note the correct polarity (+/-).

PARTS AND COMPONENTS

Fig. 1

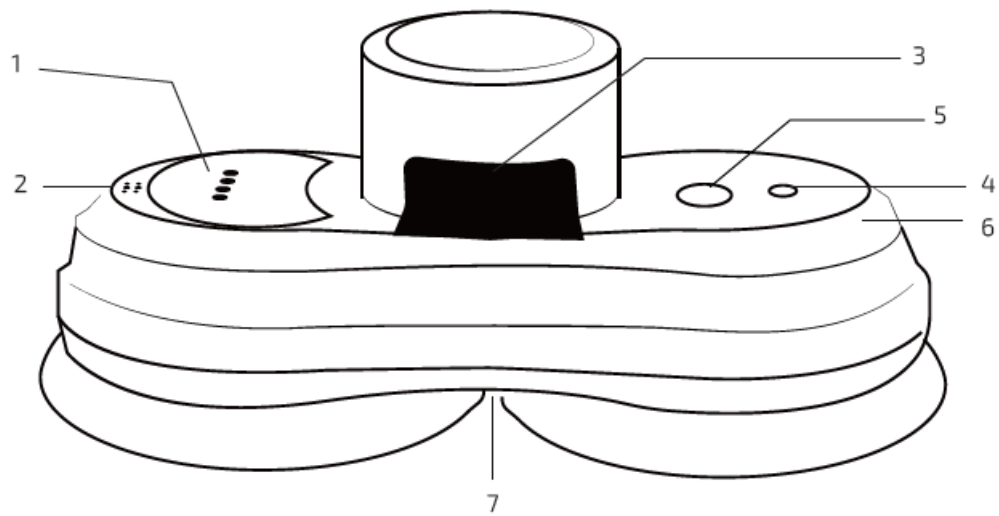

1. Light indicators

- **Blinking red:** Error
- **Blue ON:** Operating
- **Green ON:** Fully charged
- **Red ON:** Charging
- **White ON:** Connected to the power supply

2. Buzzer

3. Air vent

4. Power jack

5. Power button

6. Hooking hole

7. Bottom light indicator

- **Blinking red:** Error
- **Red ON:** Correct operation

Fig. 2

Remote control

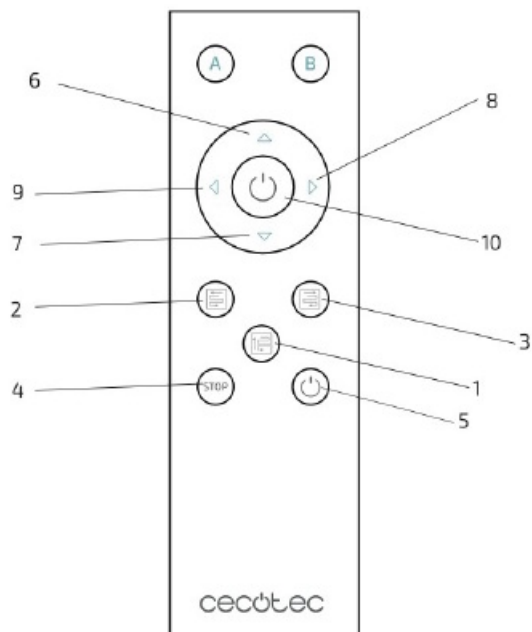

1. Automatic up and down
2. Automatic left and down
3. Automatic right and down
4. Stop cleaning
5. Pause cleaning
6. Manual up
7. Manual down
8. Manual right
9. Manual left
10. Start cleaning

Buttons A and B are not functional.

NOTE:

The graphics in this manual are schematic representations and may not exactly match the product.

BEFORE USE

- This appliance is packaged in a way as to protect it during transport. Take the device out of its box and remove all packaging materials. You can keep the original box and other packaging elements in a safe place. This will help you prevent product damage when transporting it in the future. In case the original packaging is disposed of, make sure all packaging materials are recycled accordingly.
- Make sure all parts and components are included and in good conditions. If there is any piece missing or in bad conditions, contact the official Technical Support Service of Cecotec immediately.

Box contents

- Conga WinDroid 870 Connected window cleaning robot
- Power adapter and power cord
- Remote control

- Safety rope
- 12 cleaning cloths made of microfiber
- Instruction manual
- App manual

1. Check if the safety rope is broken or the knot is loose. Fasten the safety rope and tie to indoor fixture before operating the device.
2. Make sure the battery is fully charged (green light indicator on).
3. turn the robot on before putting it onto the glass. Once on the glass, make sure it remains stuck before letting it go.
4. Remove anything on the glass.

Warning

Before using the remote control, remove the insulation spacer at the bottom back side of the remote control. To remove or change the batteries, just slide the battery cover downwards.

Warning

It is advisable to monitor the window cleaning robot's operation to ensure it is working properly. If you want to clean peculiar surfaces and don't know if the window cleaning robot will work properly, be extra vigilant and take precautions. Remember that the safety rope must be always used.

The Conga WinDroid 870 Connected is designed to clean all types of windows, shop windows, and standard vertical, flat surfaces. However, for safety reasons, it is recommended not to use the window cleaning robot under the following circumstances:

- On rimless glass.
- On curved glass, whether concave or convex.
- In glass less than 3 mm thick.
- On glass panes that have a joint (silicone or rubber) between the frame and the glass with the following characteristics: if the joint has an angle (α) of less than 45° and its distance at the edge (l_b) is greater than 5 mm. The window cleaning robot may lose suction and fall. If your window joints fit these characteristics, do not use the window cleaning robot.

OPERATION

Important

The window cleaning robot must be always plugged to a mains socket during operation.

Connection Fig. 3

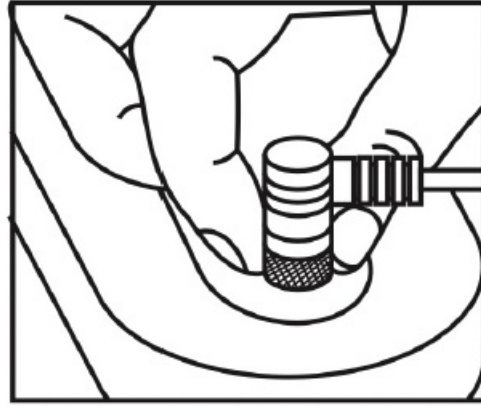
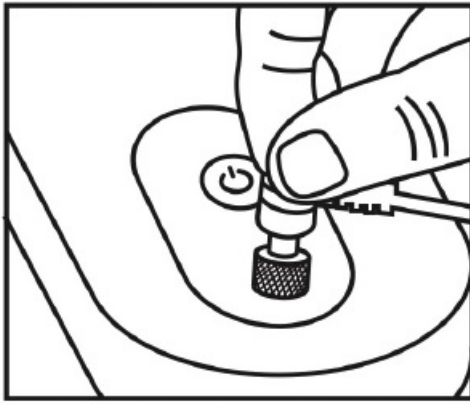

- Connect the power cord to the power supply and then to the robot.
- Tighten the power connector as shown in figure 3.

Power button

- Press and hold the power button for 2 seconds to turn the window cleaning robot on and off.
- While in operation, press the power button to pause or start cleaning.

How to place the Conga WinDroid robot on the glass/window

- Switch on the window cleaning robot and make sure the fan starts up.
- Place the window cleaning robot on the glass or window. Keep it 10 cm away from the window frame.
- Make sure the window cleaning robot remains firmly attached to the glass before releasing it.

How to remove the Conga WinDroid robot from the glass/window

- Once finished cleaning, hold the safety rope with one hand and detach the window cleaning robot from the glass with the other.
- Press the power button to turn off the window cleaning robot once placed on a safe surface.

Note:

Secure the window cleaning robot firmly during this process.

UPS (Uninterrupted Power System) function

- The safety system activates for 30 minutes when the power supply is cut off, this way preventing the window cleaning robot from immediately falling to the floor.
- The window cleaning robot will automatically stop working and the red-light indicator will blink.
- Remove the robot from the glass as soon as possible. You can pull carefully from the safety rope to detach it.

Table cleaning mode

Place the robot on the table and select manual cleaning mode. Then, use the buttons to move the robot and clean the table manually as desired.

Changing the cleaning cloth Fig. 4

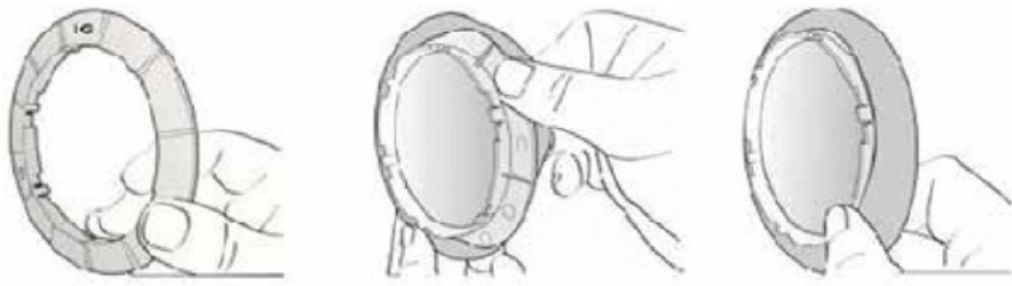

- Assemble the cleaning cloth onto the ring.
- Assemble the ring onto the cleaning wheel and ensure the 6 slots on the ring are well fixed together to prevent leakage.

Note:

The window cleaning robot can carry out dry and wet cleaning. For wet cleaning, spray some specific window cleaning agent on the window.

CLEANING AND MAINTENANCE

- Use a soft, damp cloth to clean the outside surface of the window cleaning robot.
- The cleaning cloths are washable and reusable.
- Do not immerse the window cleaning robot in water or place it under the tap.

TROUBLESHOOTING

SMARTPHONE APP

This window cleaning robot has a smartphone app which is connected to the robot through Bluetooth and allows total control over the cleaning process.

Note:

- iOS System requires iOS 7.0 or above versions.
 - Android System requires Android 4.3 or above versions.
 - Bluetooth 4.3 or above version required.
1. Plug the window cleaning robot to a power outlet and press the power button for 2 seconds to switch in on. As soon as the robot is turned on, your Smartphone will be able to detect it.
 2. Turn on your Smartphone's Bluetooth.
 3. Search for the "Windroid 870 Connected" application, download it, and open it on your mobile phone.
 4. Click on "Bluetooth Search" and connect the window cleaning robot to your mobile phone.
 5. Enjoy full control of your Conga WinDroid robot.

TECHNICAL SPECIFICATIONS

- **Product:** Conga WinDroid 870 Connected
- **Product reference:** 05455

- **Rated voltage and frequency:** 100-240 V AC 50/60 Hz
- **Power:** 80 W
- **Charger output:** 24 V , 3.75 A
- **Ion-Lithium battery:** 14,8 V , 600 mAh

Technical specifications may change without prior notification to improve product quality. Made in China | Designed in Spain

DISPOSAL OF OLD ELECTRICAL AND ELECTRONIC APPLIANCES

This symbol indicates that, according to the applicable regulations, the product and/or battery must be disposed of separately from household waste. When this product reaches the end of its shelf life, you should dispose of the batteries/accumulators and take them to a collection point designated by the local authorities.

Consumers must contact their local authorities or retailer for detailed information concerning the correct disposal of old electrical and electronic appliances and/or their batteries.

Compliance with the above guidelines will help protecting the environment.

TECHNICAL SUPPORT AND WARRANTY

Cecotec shall be liable to the end user or consumer for any lack of conformity that exists at the time of delivery of the product under the terms, conditions, and deadlines established by the applicable regulations. It is recommended that repairs be carried out by qualified personnel.

If at any moment you detect any problem with your product or have any doubt, do not hesitate to contact Cecotec official Technical Support Service at +34 963 210 728.

COPYRIGHT

The intellectual property rights over the texts in this manual belong to CECOTEC INNOVACIONES, S.L. All rights reserved. The contents of this publication may not, in whole or in part, be reproduced, stored in a retrieval system, transmitted or distributed by any means (electronic, mechanical, photocopying, recording or similar) without the prior authorization of CECOTEC INNOVACIONES, S.L.

DECLARATION OF CONFORMITY

Cecotec Innovations hereby declares that this robot, model 05455 Conga Windroid 870 connected is in conformity with the Radio Equipment Directive 2014/53/EU.

The complete text of the EU declaration of conformity is available in the following Internet address:

www.cecotec.es

www.cecotec.es

Cecotec Innovaciones S.L.

C/ de la Pinadeta s/n, 46930

Quart de Poblet, Valencia (Spain)

EA02220602



[cecotec 870 Robot Window Cleaner](#) [pdf] Instruction Manual
870 Robot Window Cleaner, 870, Robot Window Cleaner, Window Cleaner, Cleaner

References

- [Cecotec Tienda Oficial | Envío Gratis | Mejor Precio](#)
- [Cecotec Tienda Oficial | Envío Gratis | Mejor Precio](#)