



# CDVI K3 DESFire EV2 High-Security Keypad and Card Reader Installation Guide

[Home](#) » [CDVI](#) » [CDVI K3 DESFire EV2 High-Security Keypad and Card Reader Installation Guide](#) 

## CDVI K3 DESFire EV2 High-Security Keypad and Card Reader Installation Guide CDVI K3 DESFire EV2 High-Security Keypad and Card Reader Installation Guide

### Contents

- [1 INTRODUCTION](#)
- [2 FEATURES](#)
- [3 MOUNTING](#)
- [4 WIRING DIAGRAM](#)
- [5 LED STATUS INDICATORS](#)
- [6 Documents / Resources](#)
  - [6.1 References](#)
- [7 Related Posts](#)

## INTRODUCTION

### K3

#### **DESFire EV2® High-Security Keypad and card reader**

Radio equipment for access control applications.

CDVI's KRYPTO K3 card reader/keypad makes high security easy! KRYPTO K3 Mifare® DESFire® EV2® readers combined with CDVI EV2 credentials work right out of the box. No fastidious and complicated programming required!

Factory-programmed, industry-unique secure CDVI protocol and encryption keys ensure end-to-end encryption between the card, reader/keypad and A22K door controller.

## FEATURES

- Bi-technology, keypad and reader
- Easy to use & FULLY secure CDVI protocol using authentication with diversified keys.
- Reads 13.56 MHz Mifare® Classic and DESFire EV2 credentials
- OSDP-2 compatible
- Bluetooth
- Up to 4 in. (10cm) read range
- Power requirements: 12VDC
- Current consumption : 200mA

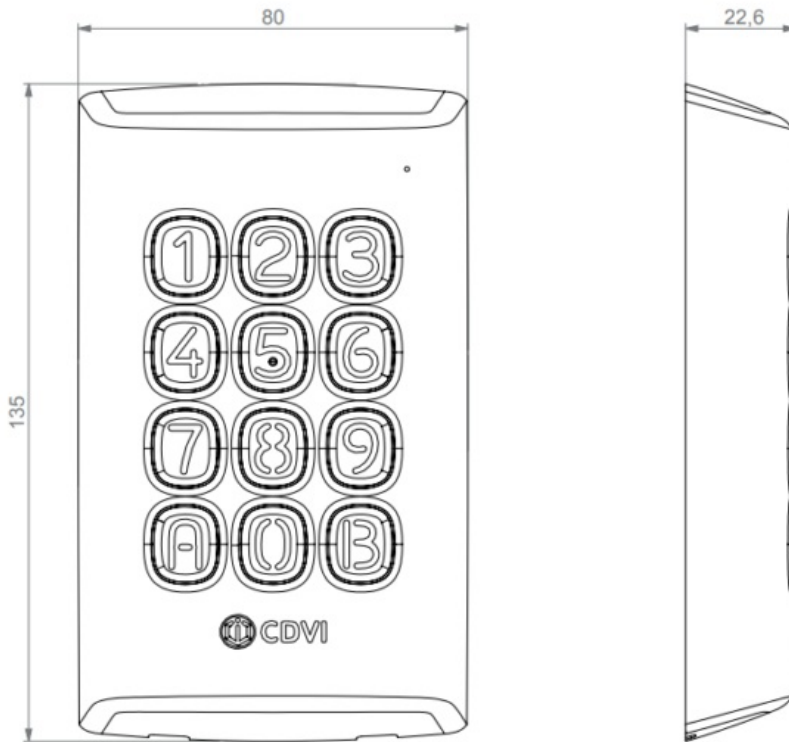

## MOUNTING

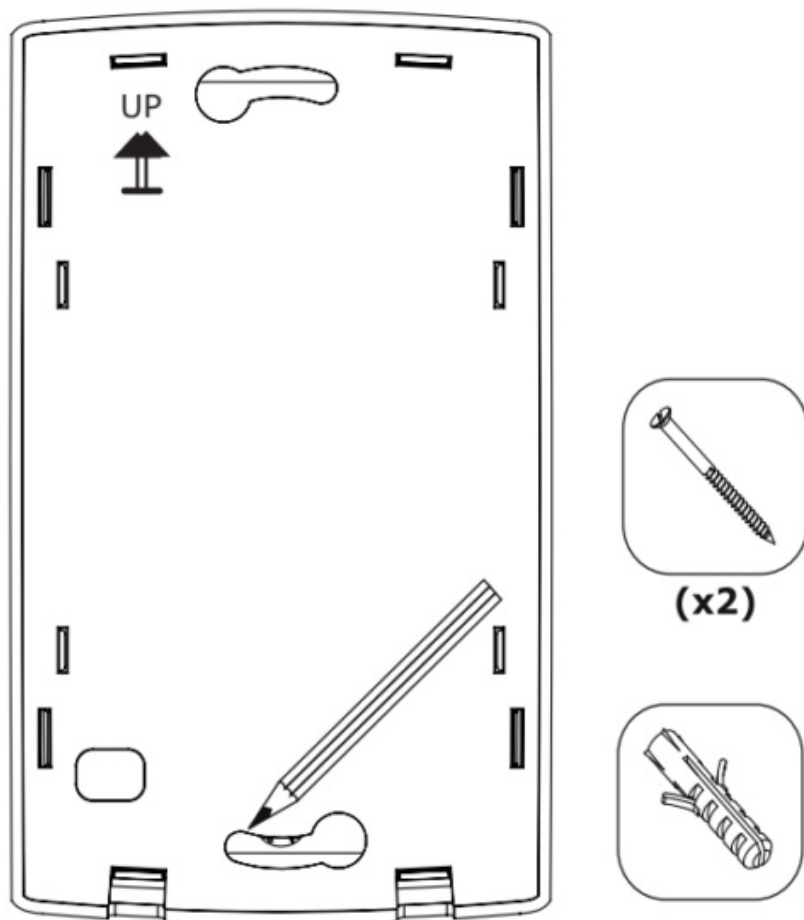

## WIRING DIAGRAM

### K3 READER

#### EXIT READER OPTION (RS485 ONLY):

Each A22K controller supports the Input/Output reader, 2 readers per door. Connect the 2 readers in parallel (as shown below).

### CAUTION

The dipswitch must be at the bottom near the motherboard: Set the position of the switch before powering the player, or unplug and plug the player if you change the dip switch to the exit mode.

The 2 players must be separated by a distance of 20 cm to avoid any interference.

It is recommended to use CAT5e/6 cable

Distance between the reader and the controller up to 1220m (AWG 22 cable) \

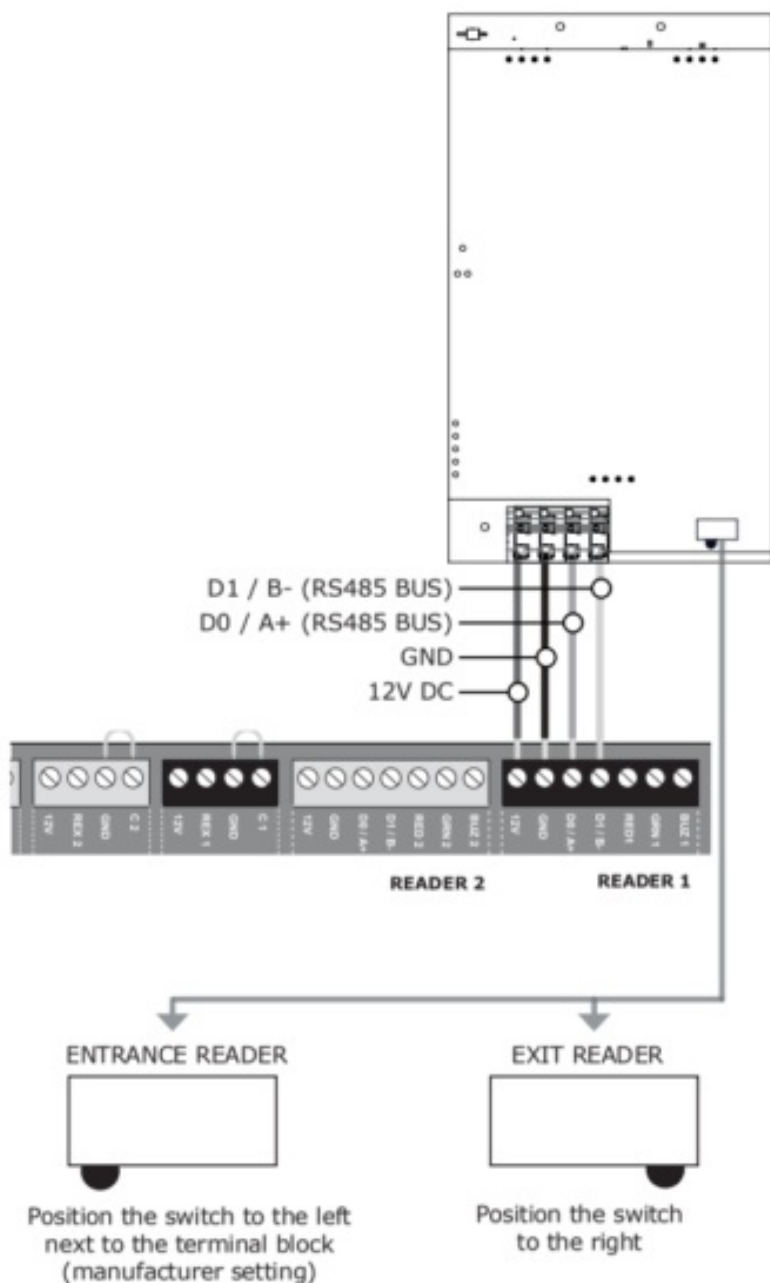

## LED STATUS INDICATORS

Here are the LED status when connected to an A22K ATRIUM controller :

LED State	Buzzer	Description
Steady blue	—	Standby (door se- cure)

Green 5 sec.	Chirp beep	Access granted
Red blinks	Steady beep for 3 sec.	Access denied
Flashing blue	–	Reader compromised (lost its encryption key)
Blinks green every 3 sec.	–	Door unlock schedule
Flashing Red	Steady beep	Door forced alarm
Flashing Red	Beep every 2 sec.	Door open too long pre-alarm
Flashing Red rapidly	Fast beep	Door open too long alarm

Note:

Door output timings such as; unlock time (access granted), door open too long pre-alarm and door open too long alarm, can be modified in the ATRIUM software “Door Properties” window.

**CDVI SAS**

31 avenue du Général Leclerc 93500 PANTIN 01 48 91 01 02



## Documents / Resources

	<p><a href="#">CDVI K3 DESFire EV2 High-Security Keypad and Card Reader</a> [pdf] Installation Guide K3, DESFire EV2 High-Security Keypad and Card Reader</p>
---	---

## References

- [CDVI | Security to Access](#)