

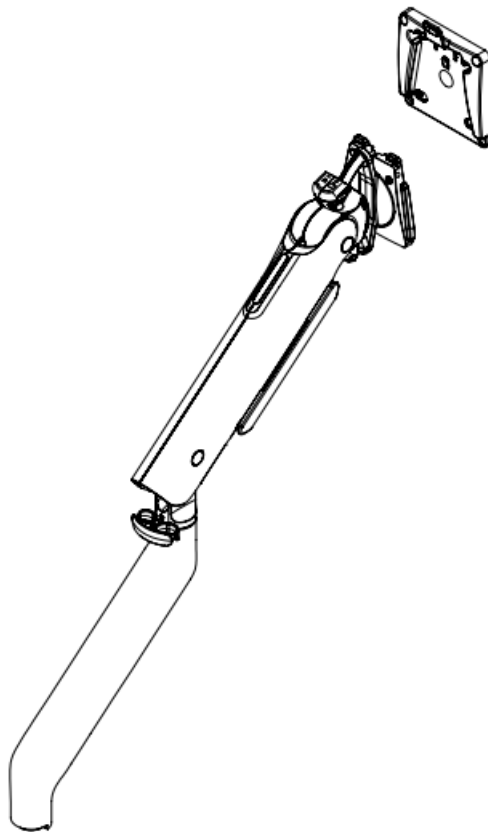

## CBS FLX Flo X Monitor Arm User Guide

[Home](#) » [CBS](#) » CBS FLX Flo X Monitor Arm User Guide 

### CBS FLX Flo X Monitor Arm



## Contents

### 1 FLOXMONITOR ARM FLX/018/010

- 1.1 COMPONENT LIST
- 1.2 OTHER KITS REQUIRED
- 1.3 FIT DESK FIXING TO WORKSURFACE
- 1.4 FIT MONITOR ARM TO CLAMP
- 1.5 ATTACH VESA PLATE TO MONITOR
- 1.6 OPTIONAL STEP DUAL SPRING CONFIGURATION
- 1.7 MOUNT MONITOR TO ARM
- 1.8 ADJUST ARM TO SUIT WEIGHT OF MONITOR
- 1.9 OPTIONAL STEP VESA FRICTION ADJUSTMENT (if required)
- 1.10 OPTIONAL STEP TILT HEAD FRICTION ADJUSTMENT (if required)
- 1.11 INSTALL CABLES
- 1.12 OPTIONAL STEP SECURITY SCREW
- 1.13 TO REMOVE MONITOR
- 1.14 OPTIONAL STEP DUAL SPRING CONFIGURATION

### 2 FLO X SPLIT CLAMP FLX/018/AS01

- 2.1 PARTS INCLUDED
- 2.2 CONFIGURE CLAMP BRACKET
- 2.3 INSTALL CLAMP SCREW AND CLAMP PAD
- 2.4 FIT CLAMP TO DESK
- 2.5 TIGHTEN CLAMP SCREW
- 2.6 CONFIGURE 180° STOP (if required)
- 2.7 FIT CLAMP COVER AND BUSH
- 2.8 ALTERNATIVE INSTALLATION METHODS FOR RESTRICTED GAP AT REAR OF WORK SURFACE

### 3 Documents / Resources

#### 3.1 References

### 4 Related Posts

## FLOXMONITOR ARM FLX/018/010

### COMPONENT LIST

- FLO X Arm

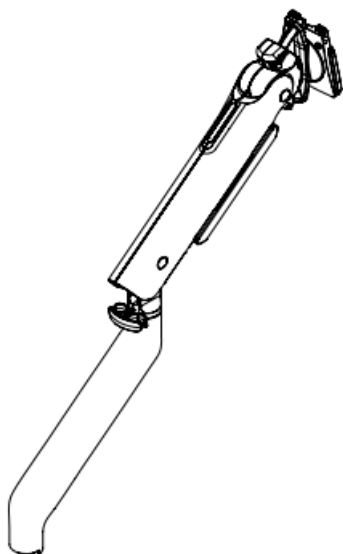

- VESA Plate x 1

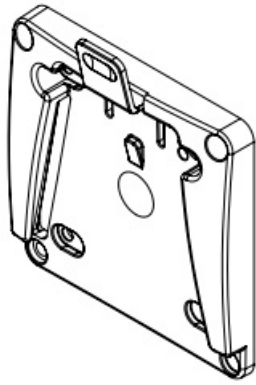

- M4x12mm VES A Screws x 4  
M4x10mm V ESA Screws x4  
Optional Security Screw x1

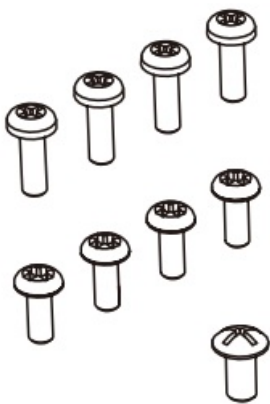

- 2.5mm Allen Key x 1  
3mm Allen Key x 1  
5mm Allen Key x1

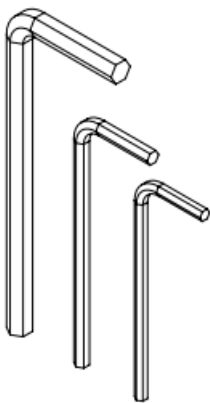

## OTHER KITS REQUIRED

- Flo X Split Clamp FLX/018/AS01

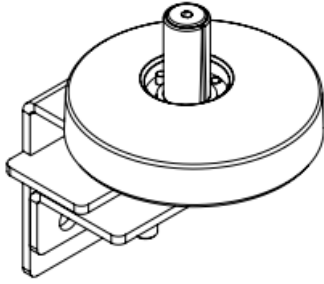

**OR**

- Flo X Top Mount Clamp FLX/ 018/C07

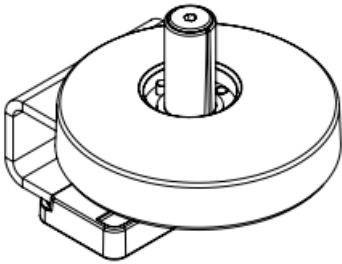

Prefer red Clamping Method

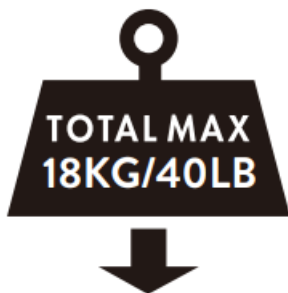

[www.colebrookbossonsaunders.com](http://www.colebrookbossonsaunders.com)

## **FIT DESK FIXING TO WORKSURFACE**

Follow instructions provided with chosen desk finxing

### **FLO X SPLIT CLAMP**

FLX/018/AS01

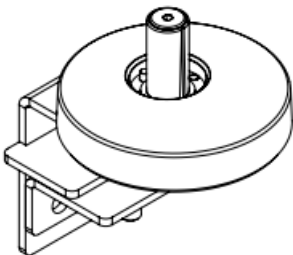

### **FLO X TOP MOUNT CLAMP**

FLX/0 18/C07

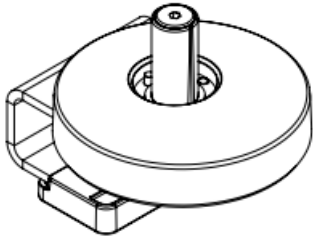

## **FIT MONITOR ARM TO CLAMP**

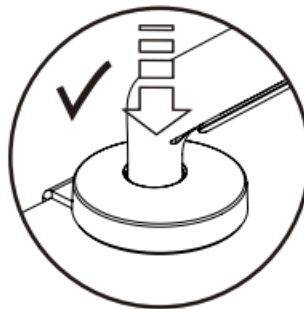
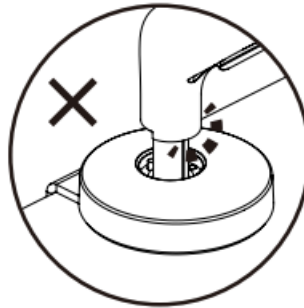
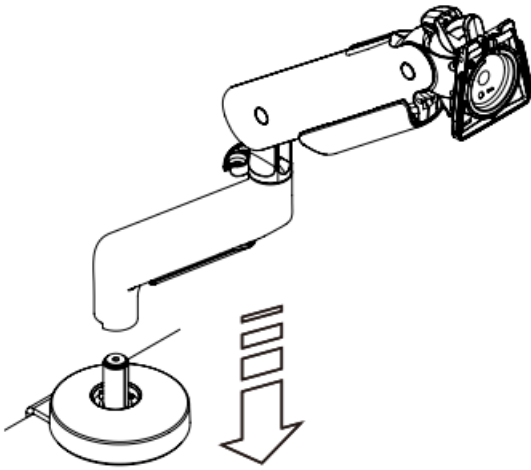

### **NOTE**

Ensure that plastic bush is in place

### **IMPORTANT**

Ensure that arm is pushed fully down onto clamp

## **ATTACH VESA PLATE TO MONITOR**

Use screws supplied

Be sure to select correct length

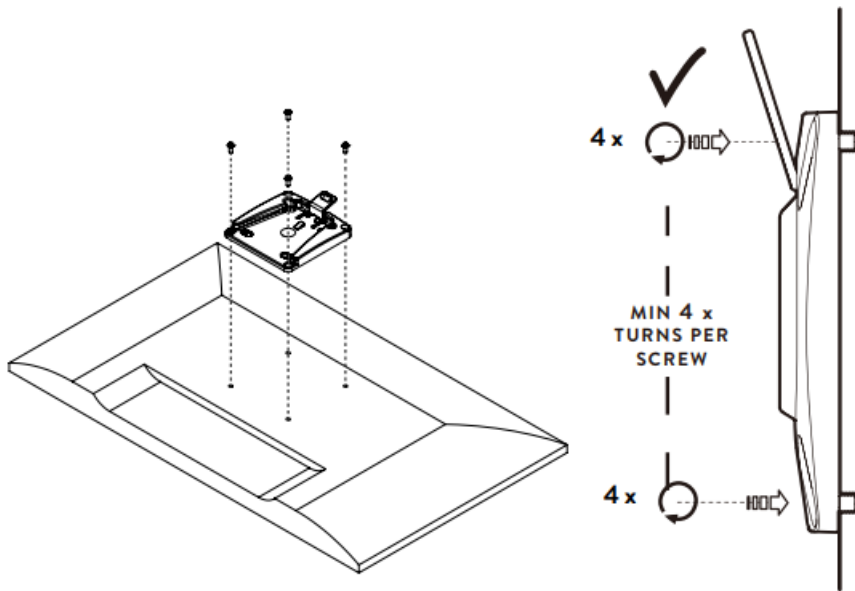

Screws over-inserted

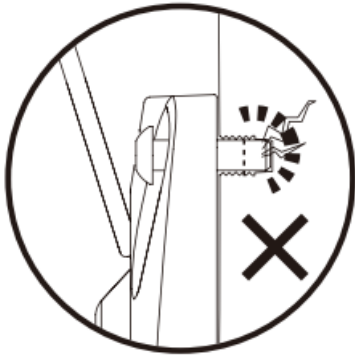

Screws under-inserted

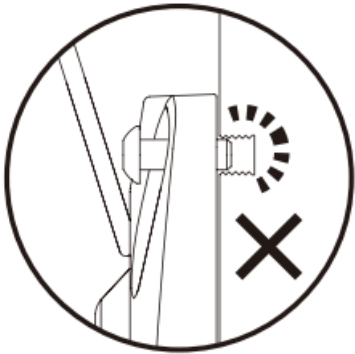

## IMPORTANT

It is the responsibility of the installer to ensure all mounting screws are properly engaged with a minimum of 4 x 360° turns into the display.

Under or over insertion may cause damage to the equipment or injury to personnel.



## OPTIONAL STEP DUAL SPRING CONFIGURATION

If the monitor to be mounted weighs less than 9kg (20lb), you may need to configure the Flo X Dual Spring mechanism to suit the lower weight range.

Factory set dual spring configuration is suitable. Go to step 5

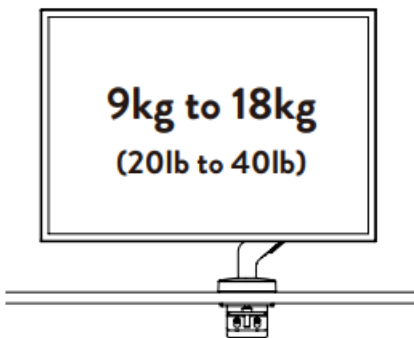

Dual spring mechanism will need to be reconfigured to lower weight range. See step 12

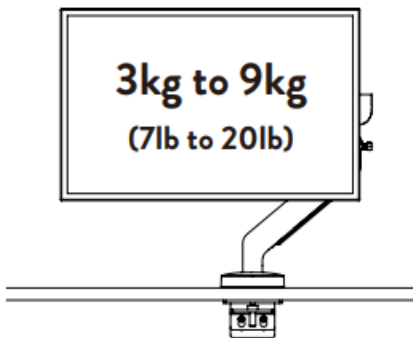

## MOUNT MONITOR TO ARM

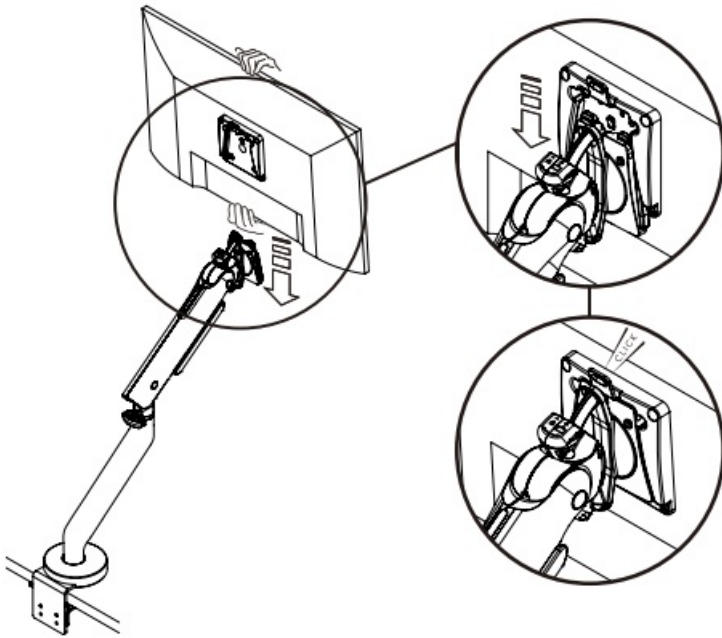

#### NOTE

See Optional Step 10 for Security Screw installation

### ADJUST ARM TO SUIT WEIGHT OF MONITOR

Turn adjuster screw until monitor 'floats' in all height positions

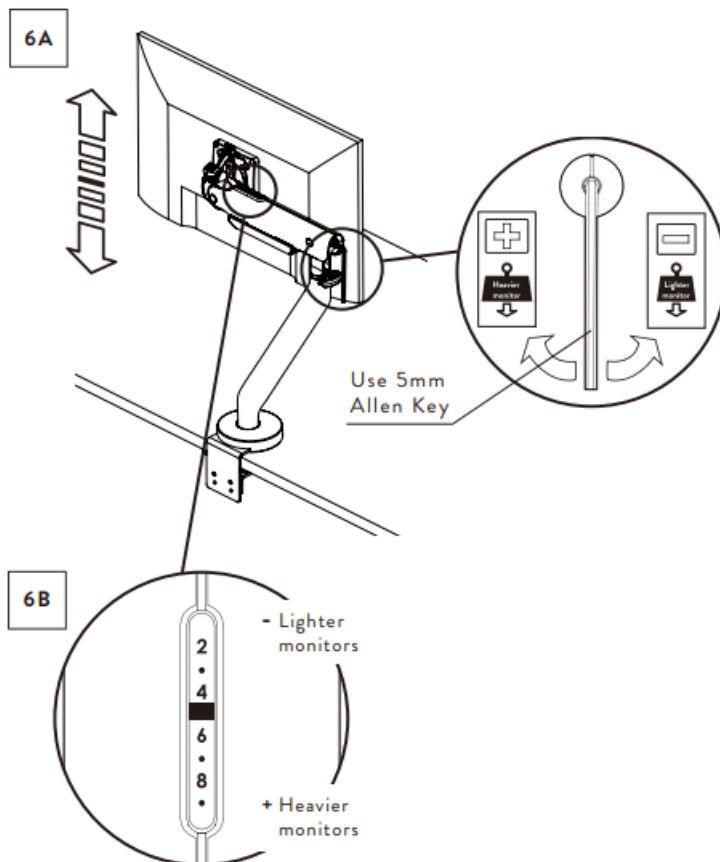

The arm setting indicator allows for quick installation of multiple arms

You can quickly 'dial' into the same setting, then if necessary, fine tune the adjustment to balance the monitor



## OPTIONAL STEP VESA FRICTION ADJUSTMENT (if required)

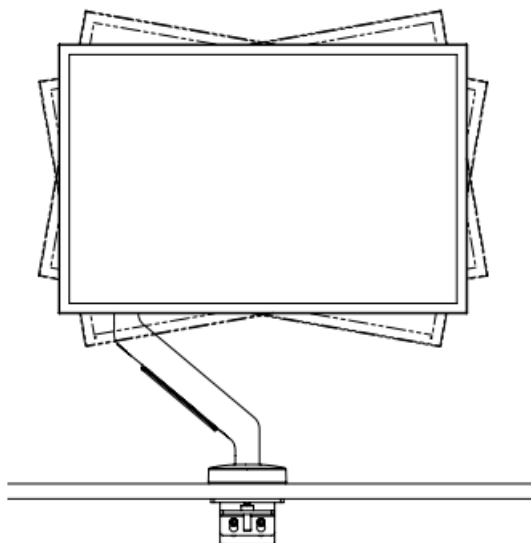

### IMPORTANT

Portrait-to – landscape monitor rotation is factory- set for optimum performance, however if the monitor droops sideways, rotation friction can be adjusted as described below.

Adjust the friction just enough to avoid unwanted rotation

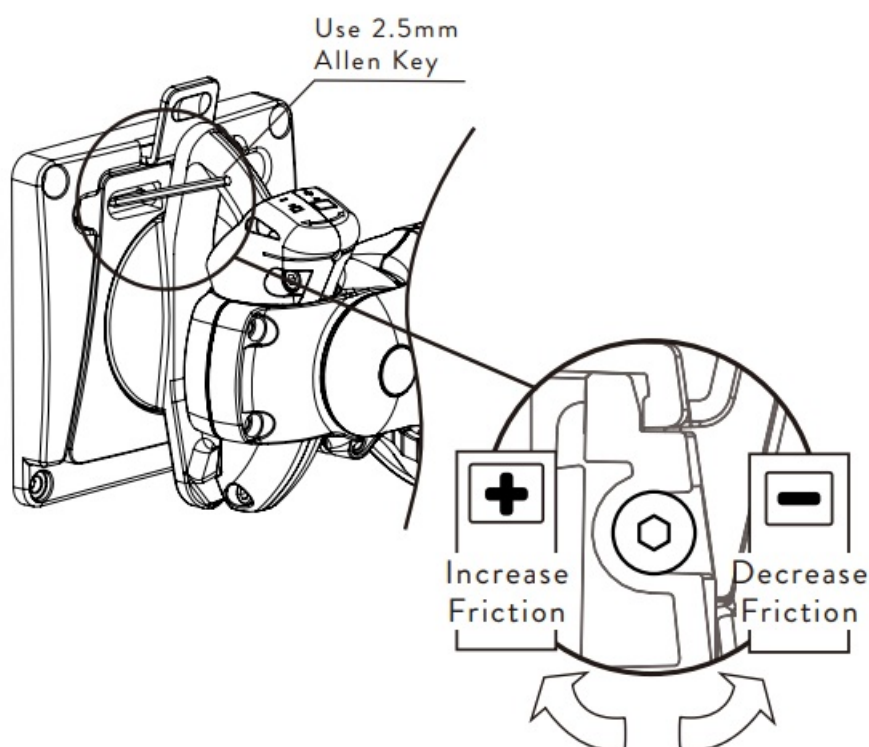

## OPTIONAL STEP TILT HEAD FRICTION ADJUSTMENT (if required)

### IMPORTANT

Monitor tilt should balance with factory settings. If monitor droops, adjust friction using adjuster screw beneath tilt joint.

Note the position of the silver disc, indicating how much friction is applied to the monitor tilt.

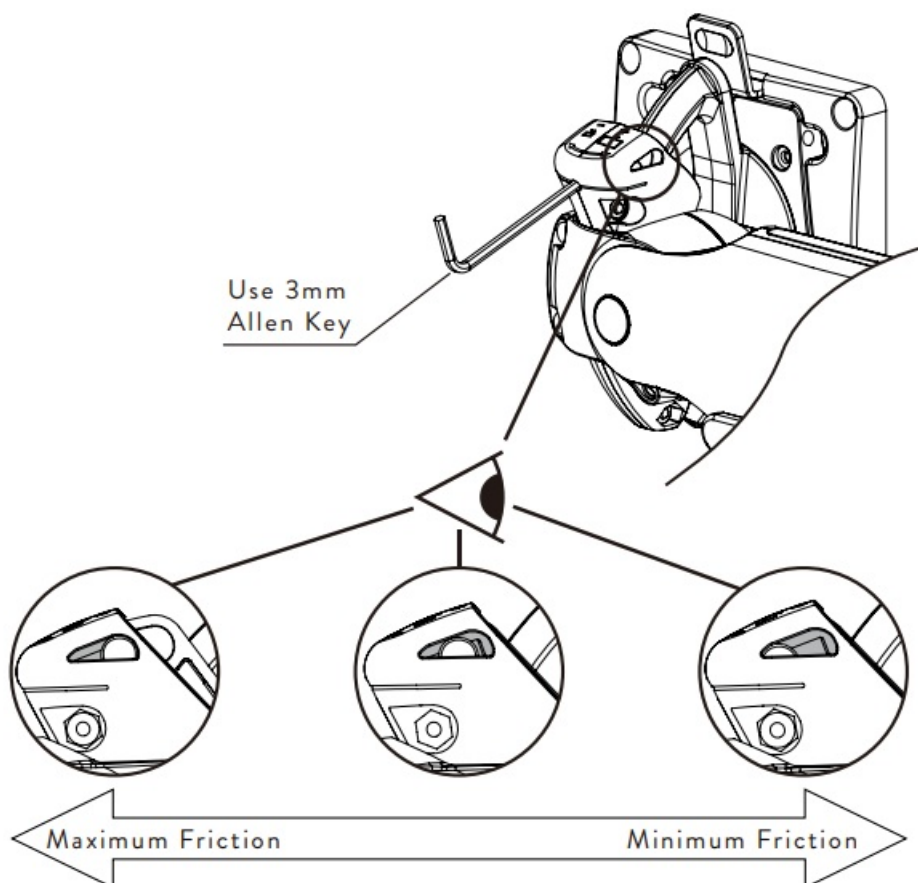

Adjust the tilt friction just enough to avoid unwanted monitor droop.

For heavy monitors turn the alien key to the left (in direction of the arrow).

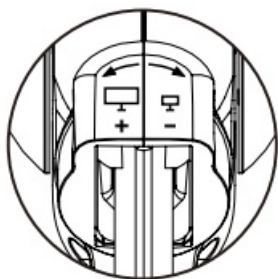

For lighter monitors turn the alien key to the right ( in direction of the arrow).

Note that drawing shows the top of the tilt head as viewed over the top of the monitor from the front of the desk.

## INSTALL CABLES

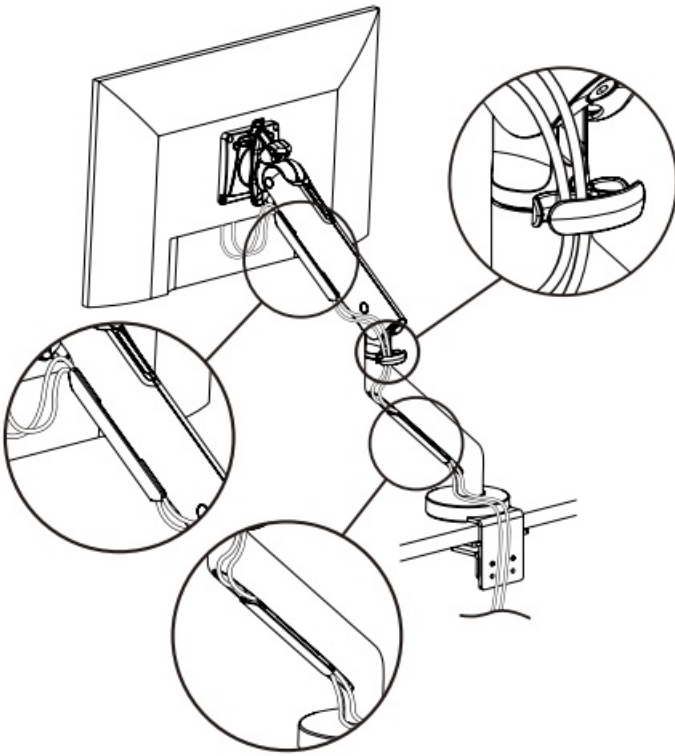

### **IMPORTANT**

Ensure that you allow enough free cable for easy monitor movement in all directions

### **OPTIONAL STEP SECURITY SCREW**

Security screw locks monitor to arm

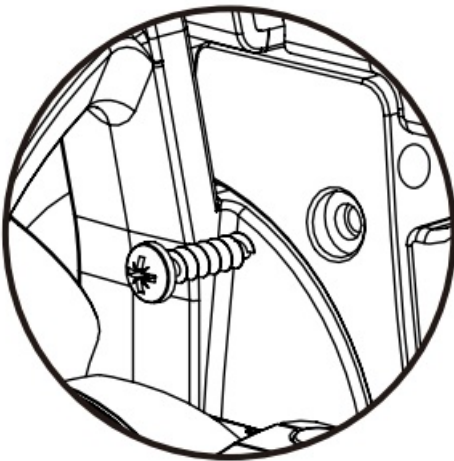

### **TO REMOVE MONITOR**

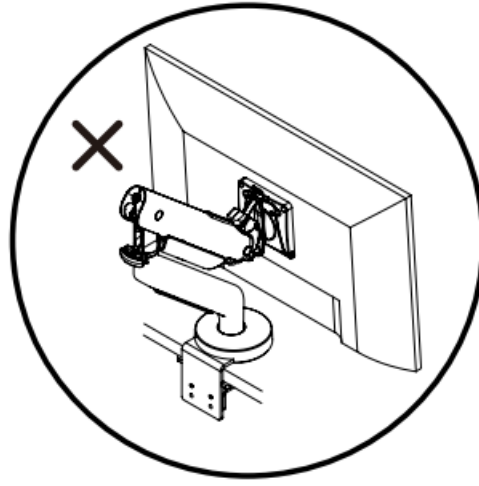
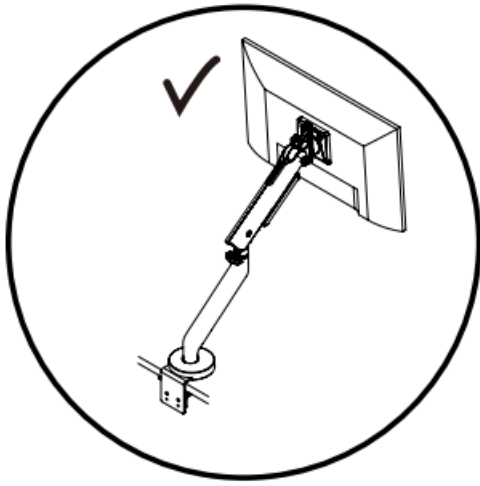

### IMPORTANT

Raise arm to uppermost position before removing monitor otherwise it may spring up when unloaded.

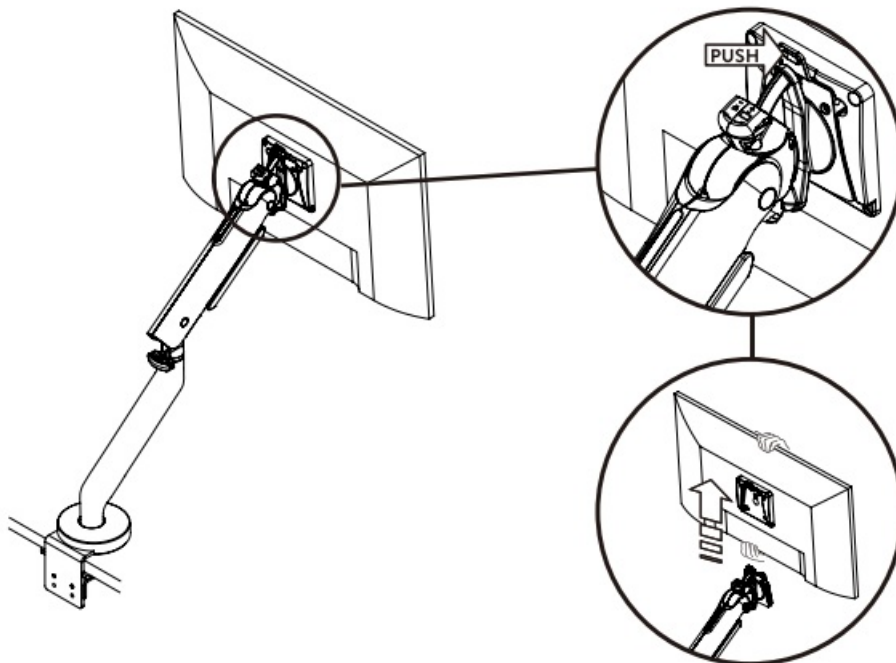

### OPTIONAL STEP DUAL SPRING CONFIGURATION

If the monitor to be mounted weighs less than 9kg (2016) you may need to reconfigure the dual spring mechanism to the lower weight range.

An extra long T-Bar Allen Key is required to perform this adjustment – see guidance drawing below. This tool is not supplied with Flo X.

If you do not have a suitable tool, we can supply one.

Please contact your account manager or dealer to request a tool.

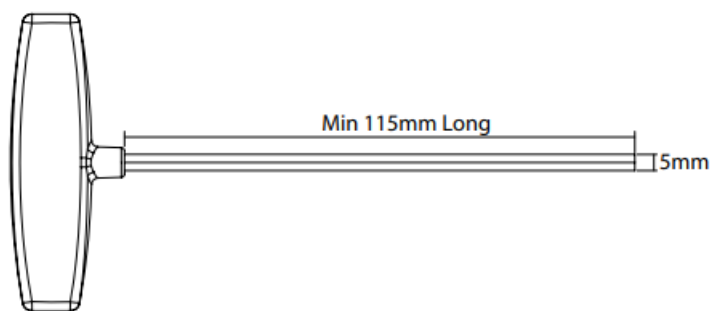

Hold the arm in its lowest position to help with mechanism adjustment.  
 (You may find this easier by installing the monitor first.)

12 a

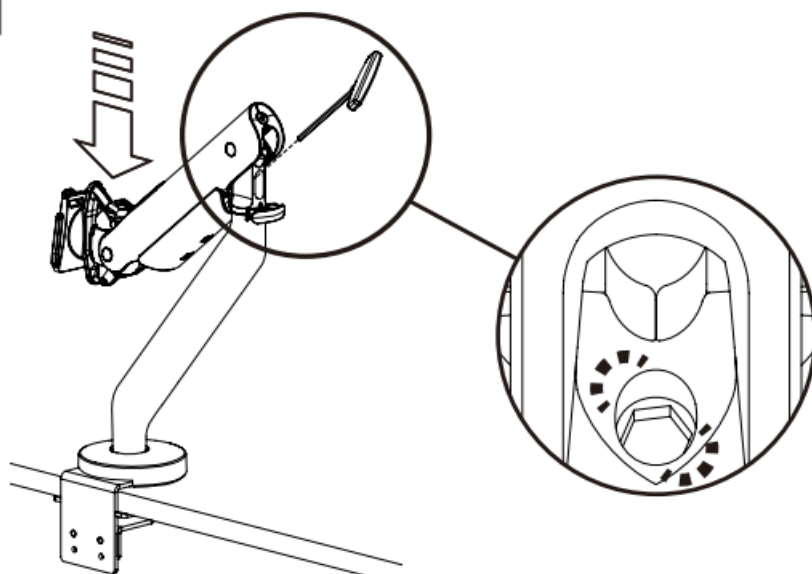

Be sure to insert the Allen Key in the hex detail of the lower hole.

Use the 5mm Allen Key to adjust the mechanism. This will disengage one of the Flo X dual springs and will reduce the weight support range.

12 b

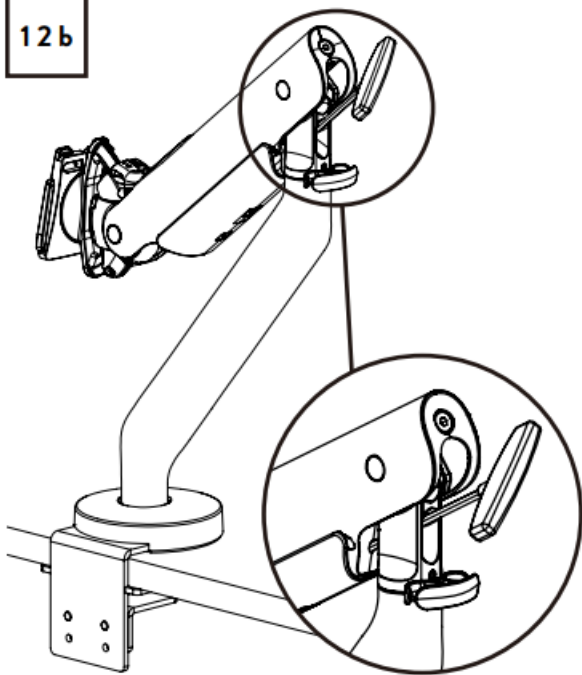

### IMPORTANT

Turn the screw anti-clockwise to the **,end of its travel and fully tighten** to disengage one of the Flo X dual springs.

The spring is fully disengaged when the plastic wedge on the underside of the arm (shown in grey left) is drawn fully forwards and level with the arm body.

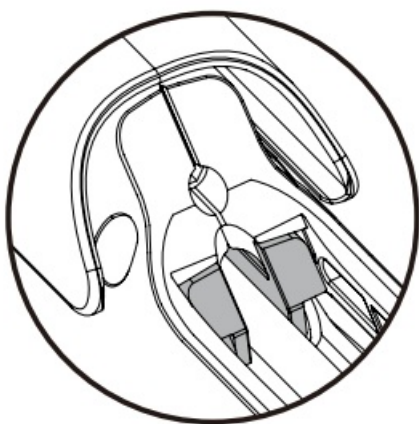

### TO RETURN TO FACTORY SET DUAL SPRING:

If Flo X Dual Spring mechanism has already been configured to low weight range, it can be returned to high load range by repeating the above process , except turning the adjuster screw clockwise until the mechanism reaches the end of its travel.

FLX- 018 – 0 10 – IN ST-A -SEPT 2022



Please consider leaving these instructions with the product if further installation may be required by others

### WARNING

- Ensure desk/work surface/wall/partition is suitable to take the weight of the arm/sand monitors.

- Do not use this product for any purpose other than that for which it was designed.
- Supported weight must not exceed 18kg (4016) per arm.
- Hold the monitor tightly when making adjustments.
- Care should be taken to avoid trapping fingers.
- Do not dismantle or remodel the arms.
- Do not attach the monitor before assembling arm .
- Some monitors have recesses and may require spacers or a 75mm VESA plate.
- The screws supplied for the installation of the arm are supplied in good faith and with the intention that they will be used with the correct monitor, namely a monitor with VESA mounting holes. Please therefore check before attempting installation that you have the appropriate equipment on which to carry out the installation. CBS cannot be held liable for any damage caused to your equipment resulting from a failure to make this check. Please also carefully read the installation instructions to ensure correct fixing.

## **MAINTENANCE AND INSPECTION**

- Ensure all screws are tightened and occasionally adjust if needed.
- Clean with a damp cloth, NO solvent.

## **DISCLAIMER**

As part of Colebrook Bosson Saunders ongoing product improvement programme, the design of products may change without prior notice and details may vary from those illustrated.

## **FLO X SPLIT CLAMP FLX/018/AS01**

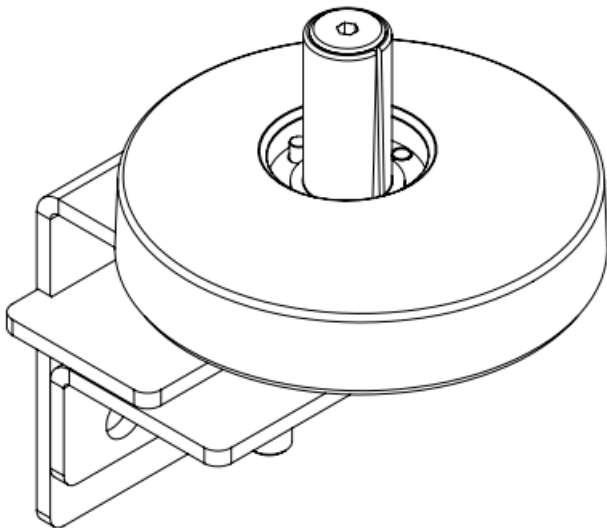

## **PARTS INCLUDED**

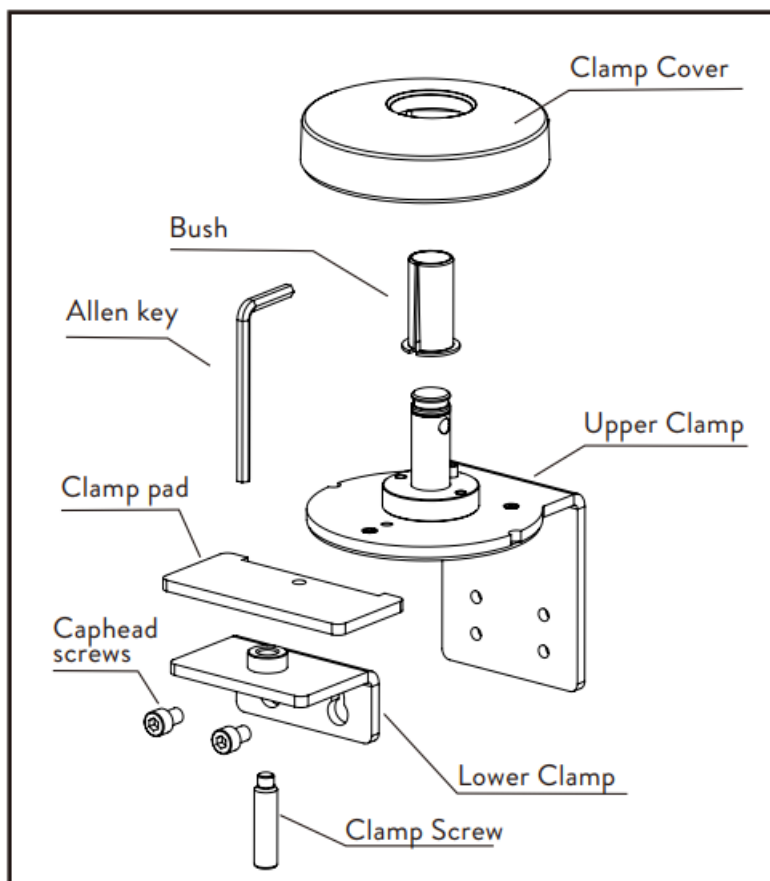

## CONFIGURE CLAMP BRACKET

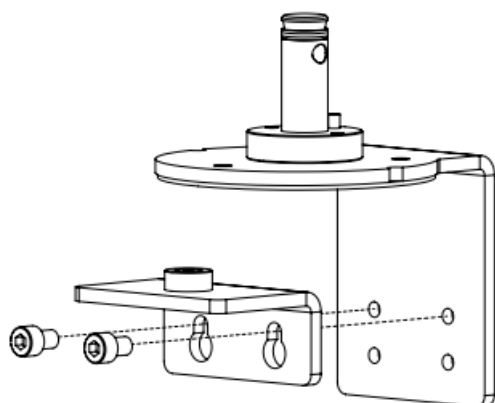

If required change the clamp plate setting by removing the screws and adjusting to correct setting

### Desk Thickness Range



Setting 1: 9mm - 25mm (3/8" - 1")  
Setting 2: 20mm - 45mm (3/4" - 1 3/4")

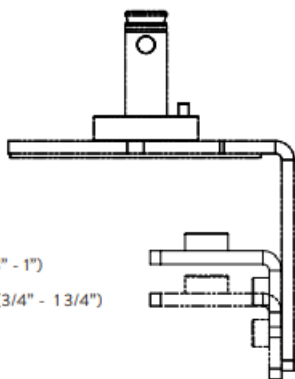

## INSTALL CLAMP SCREW AND CLAMP PAD

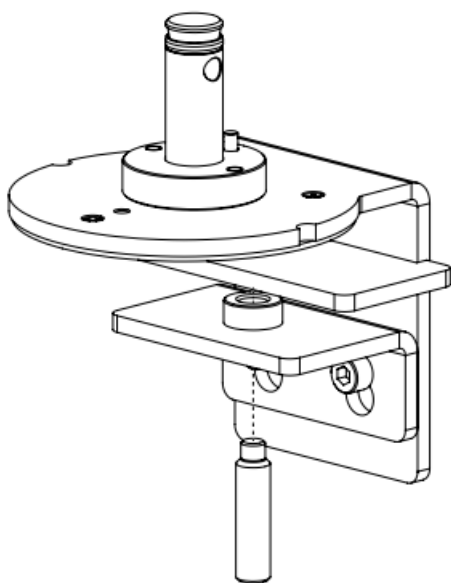

## FIT CLAMP TO DESK

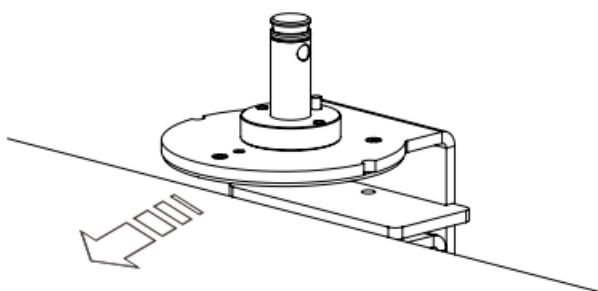

## TIGHTEN CLAMP SCREW

Use Allen Key provided with clamp

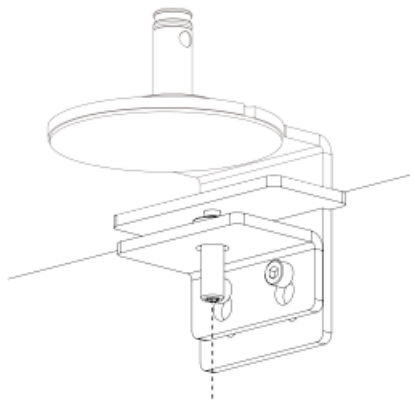

## IMPORTANT NOTE

Ensure screw is tightened

## CONFIGURE 180° STOP (if required)

**A** 180° STOP ENGAGED

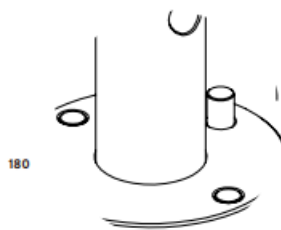

**B** 360° ROTATION

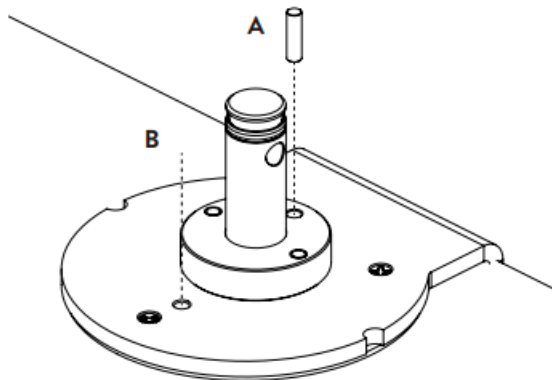
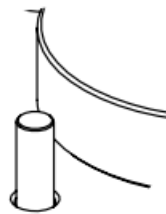

## FIT CLAMP COVER AND BUSH

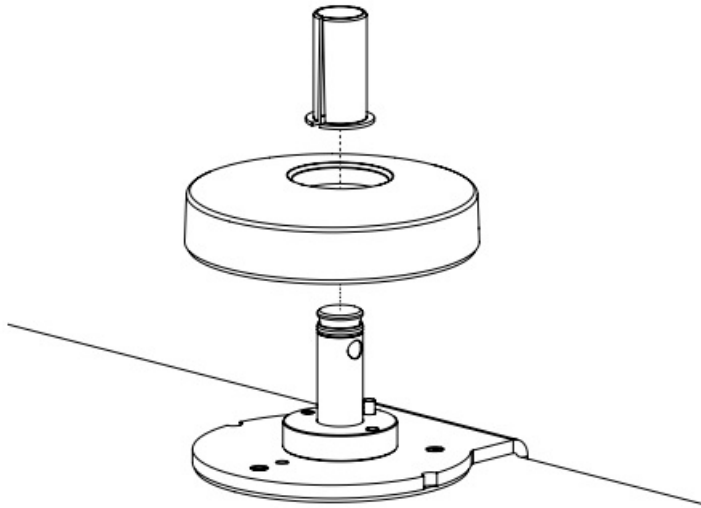

## ALTERNATIVE INSTALLATION METHODS FOR RESTRICTED GAP AT REAR OF WORK SURFACE

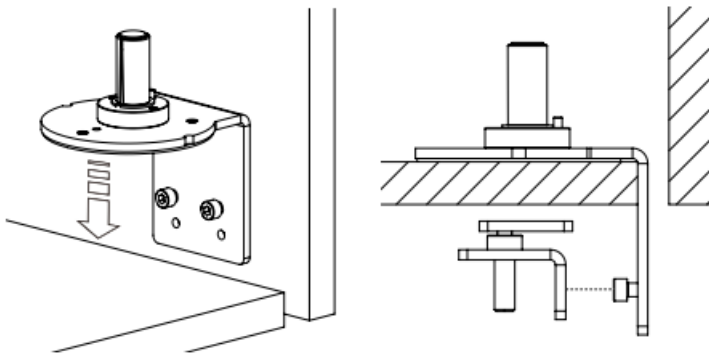

- Do not use this product for any purpose other than that for which it was designed
- Ensure desk/worksurface is suitable to take the weight of the arm/sand monitors
- Supported weight must not exceed the maximum load per arm
- Take care when installing as fingers could become trapped
- Ensure all screws are tightened and occasionally adjust if needed
- Ensure arm is pushed fully down onto the clamp before installing the monitor(s)
- Clean with a damp cloth, NO solvents
- The use of power tools, lever bars or excessive force during the installation, or re-configuration of the product will invalidate your guarantee
- Failure to observe the recommendations in the use, and configuration of these products may affect your guarantee
- As a part of Colebrook Bosson Saunders ongoing product improvement programme the design of products may change without prior notice and details may vary from those illustrated

## PATENTS

Colebrook Bosson Saunders hold a number of patents and other intellectual property rights covering our products and processes.

You can find patent information on our website at:

[www.colebrookbossonsaunders.com/patents](http://www.colebrookbossonsaunders.com/patents)



## Documents / Resources

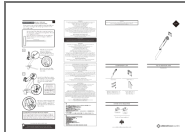

### [CBS FLX Flo X Monitor Arm](#) [pdf] User Guide

FLX Flo X Monitor Arm, FLX, Flo X Monitor Arm, X Monitor Arm, Monitor Arm

## References

- [🌐 Hamptons Real Estate & Homes for Sale | Saunders & Associates| Shelter Island Real Estate](#)  
[Hamptons Real Estate | Saunders & Associates | Shelter Island Real Estate](#)
- [User Manual](#)