

CAT SHIELD PROTECTED 2012-2017 Prius Generation V Installation Guide

[Home](#) » [CAT SHIELD PROTECTED](#) » CAT SHIELD PROTECTED 2012-2017 Prius Generation V Installation Guide

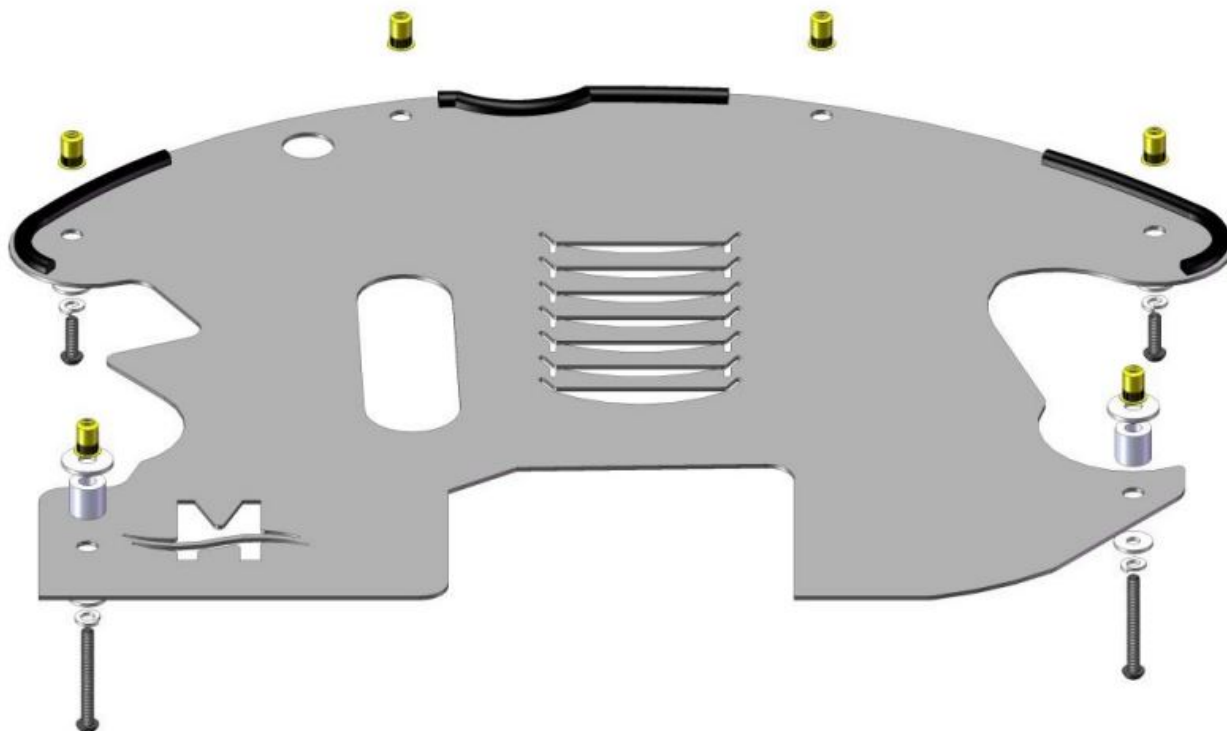

*CAT SHIELD PROTECTED 2012-2017 Prius Generation
V Installation Guide*



Prius Generation V (2012-2017) Installation Guide

Thank you for purchasing the best Prius catalytic converter theft deterrence device on the market. Please read the following instructions to ensure the most accurate and secure fit for your Cat Shield. Professional installation is highly recommended and knowledge of using rivet nuts plus a rivet nut tool is necessary. Please check out www.catshield.com for installation videos.

Contents

[1 Necessary Tools:](#)

[2 Included with your Cat Shield:](#)

[3 Documents / Resources](#)

[3.1 References](#)

[4 Related Posts](#)

Necessary Tools:

- Drill
- 25/64" drill bit (no pilot bit)

- Rivet nut tool with M6 mandrel/head
- 1/4" bit driver
- 10mm socket
- Marking pen
- Panel fastener removal tool or flat head screw driver
- Protective eyewear
- Center punch tool (optional)

Included with your Cat Shield:

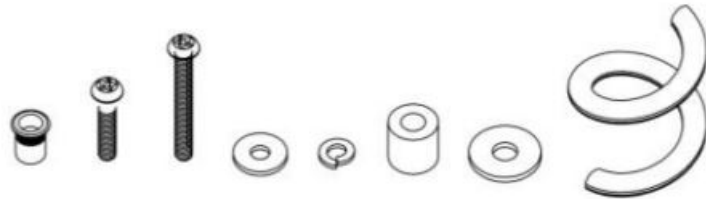

- 1 Cat Shield
- 7 rivet nuts (1 extra)
- 4 tamper-proof screws (short)
- 2 tamper-proof screws (longer)
- 6 fender washers M6
- 2 fender washers M8
- 6 lock washers
- 2 aluminum spacers
- 1 tamper-proof bit
- 3 rubber dampeners

Step 1: Remove heatshield. Remove the 4 panel fasteners using a fastener removal tool or a flat head screw driver. (Refer to Image #1)

Step 2: Remove O2 sensor bracket. Using a 10mm socket, remove the bolt holding the O2 sensor and move the bracket out of the way. (Refer to Image #2)

Step 3: Enlarge 4 panel holes. Using a step drill bit or the drill bit, enlarge the 4 holes. *CAUTION the furthest hole toward the driver side must be carefully drilled. The fuel and brake line are close to this hole and aggressive drilling could damage those lines. (Refer to Image #2)

Step 4: Install rivet nuts. Using a rivet nut tool, install the 4 rivet nuts to the recently drilled out holes. *Please watch an instructional video if you have never used a rivet nut tool before.

Step 5: Mark 2 holes for drilling. Temporarily place the Cat Shield onto the vehicle using the 1 pre-existing stud (refer to Image #1 for location) as a guide and use the 1 new M8 flange nut provided to loosely tighten in place. Hand-tighten the 4 tamper-proof screws onto the rivet nuts and mark the 2 remaining holes that are located along each side of the Cat Shield. *(Optional) Use a center punch tool at each of these markings for easier drilling.

Step 6: Drill 2 holes for the rivet nut. Remove the nut, 4 tamper resistant screws and Cat Shield. Using the drill bit (with no pilot bit) drill the 2 holes that were recently marked which should be on the vehicle's frame rails.

Step 7: Reinstall O2 sensor bracket. Reinstall O2 sensor bracket (10mm socket).

Step 8: Install Cat Shield. *Prior to install, place 3 rubber stripping along the front of the Cat Shield as pictured in the top image. Stripping will help reduce noise and vibration. Place the Cat Shield back up to the vehicle. First loosely tighten the front four screws using the hardware in the following order: fender washer, lock washer, then tamper-proof screw.

Step 9: Install rear tamper-proof screws and aluminum spacers. Use the 2 longer tamper-proof screws and hardware, fasten the rest of the shield to the vehicle. First place the aluminum spacer then the larger fender washer in between the hole/rivet nut and Cat Shield. Then use the fender washer, lock washer, and longer tamper-proof screw to secure the rear end of the shield. The spacer will ensure your shield remains as flat as possible and significantly reduce noise and vibration.



Front (x4) screw installation

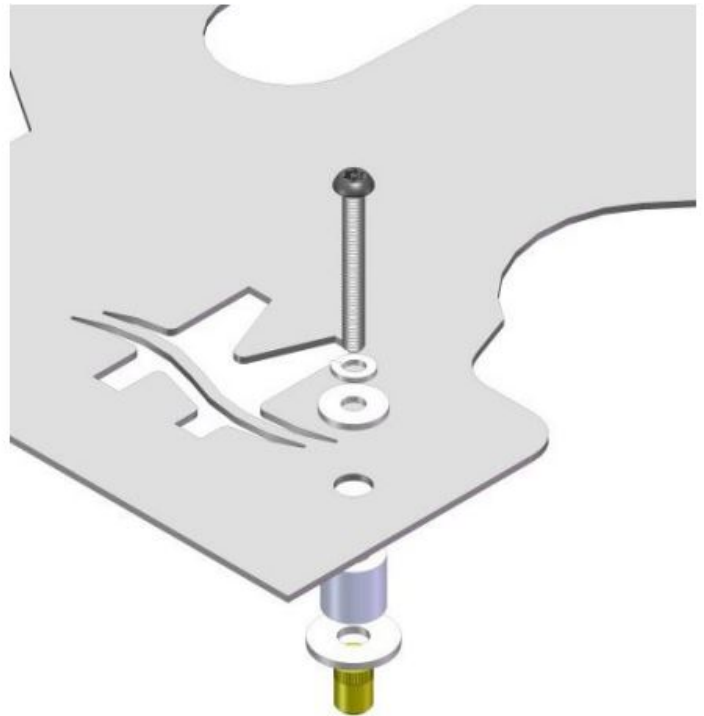

Rear (x2) screw installation

Step 10: Complete installation. Use the provided tamper-proof bit and 1/4" bit driver to tighten the tamper-proof screws. Check each screw to ensure the shield is completely secured to the vehicle.

Step 11: Apply Cat Shield sticker (optional). Place the sticker on the vehicle to warn thieves this vehicle is protected by Cat Shield! Recommended placement: Rear liftgate window.



Image #1

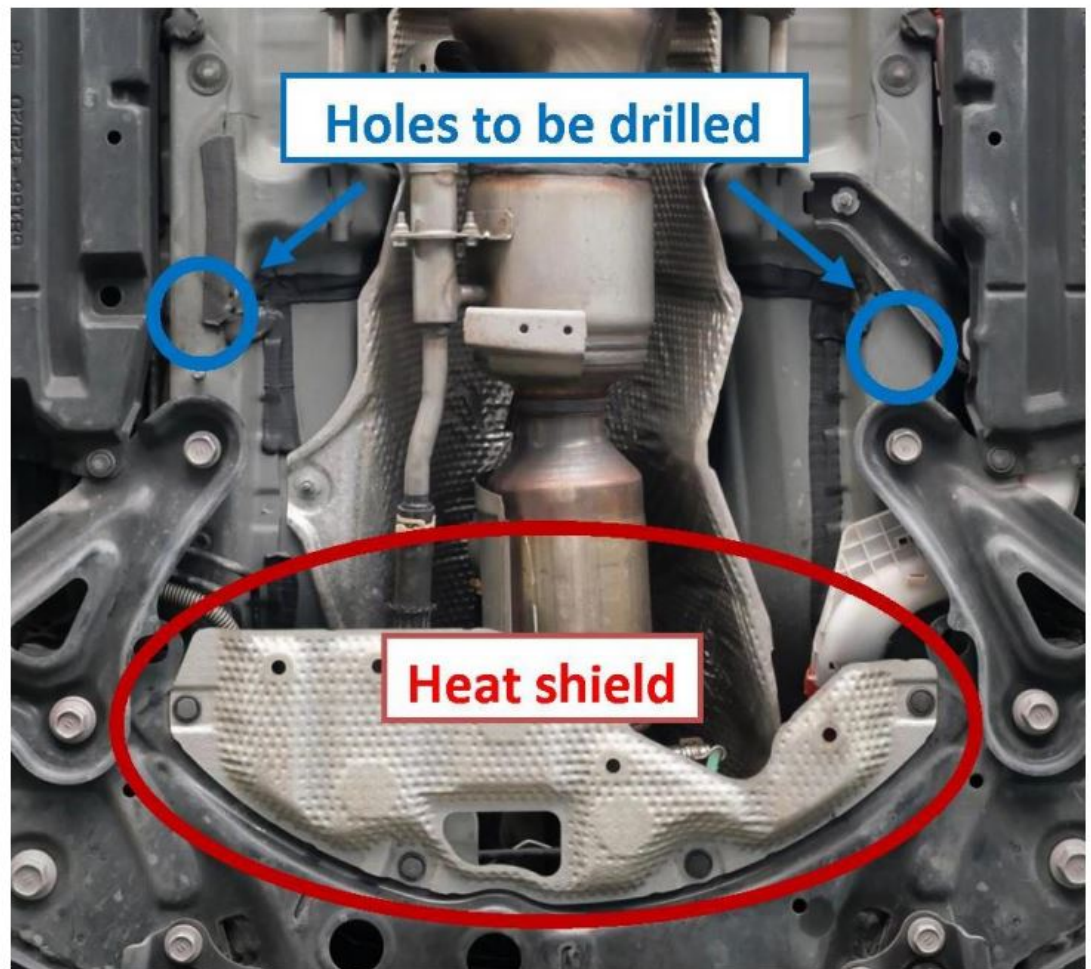
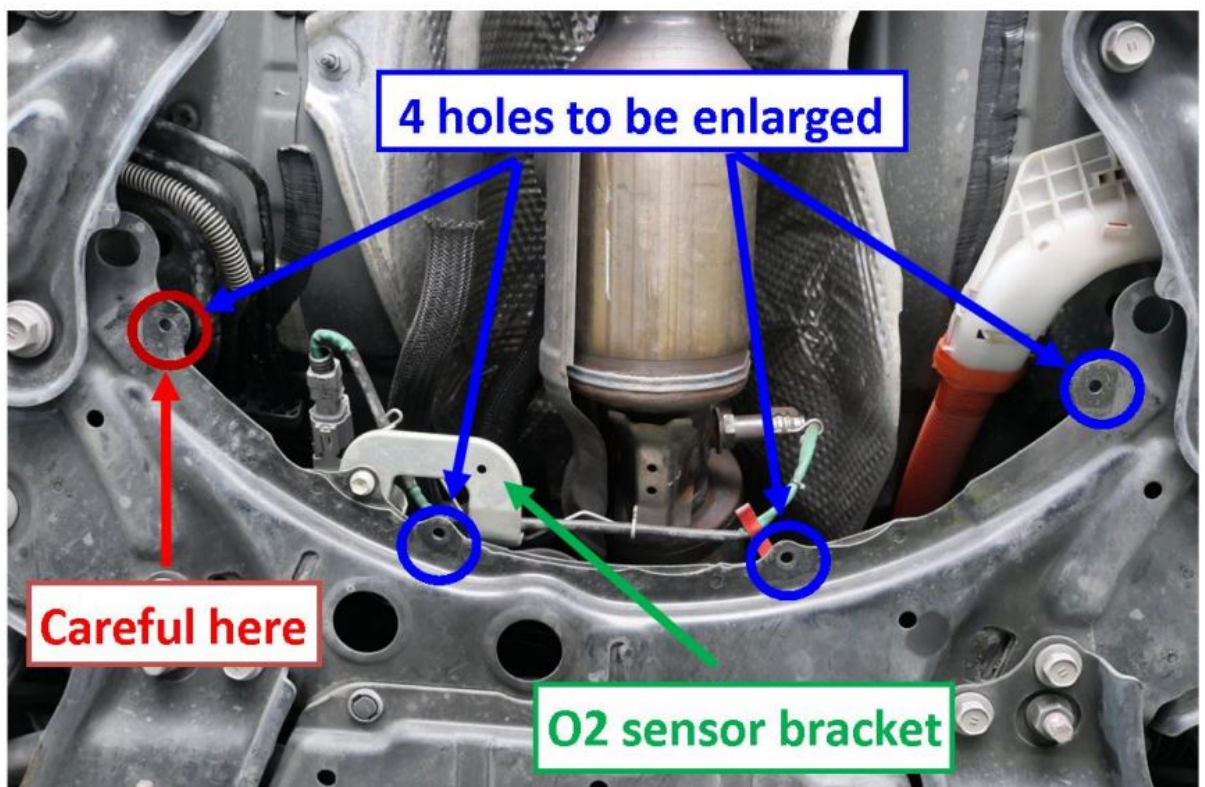
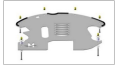

Image #2





CAT SHIELD PROTECTED

Read this manual carefully before installing the Cat Shield. It contains important information about the product and its use. It also contains safety instructions and a list of the parts and materials required for installation.

Contents:

- 1. Introduction
- 2. Safety Instructions
- 3. Installation Instructions
- 4. Troubleshooting
- 5. Contact Information

[CAT SHIELD PROTECTED 2012-2017 Prius Generation V](#) [pdf] Installation Guide

2012-2017 Prius Generation V, 2012-2017, Prius Generation V, Generation V

References

- [Catalytic Converter Protection | Cat Shield™ by Miller CAT](#)