



Cassida C200 Coin Counter & Roller User Manual

[Home](#) » [Cassida](#) » Cassida C200 Coin Counter & Roller User Manual 

Contents

- [1 Cassida C200 Coin Counter & Roller](#)
- [2 INTRODUCTION](#)
- [3 Specifications](#)
- [4 GETTING STARTED](#)
- [5 MAINTENANCE AND TROUBLESHOOTING](#)
- [6 FREQUENTLY ASKED QUESTIONS](#)
- [7 VIDEO – PRODUCT OVERVIEW](#)
- [8 Related Posts](#)



Cassida C200 Coin Counter & Roller



This manual contains important information on safety measures and operational features. Please read it carefully before operating your coin sorter and keep it for future reference.

INTRODUCTION

About the Cassida C200

Thank you for choosing the Cassida C200 coin sorter. We hope you enjoy using it.

The Cassida C200 coin counter/sorter/wrapper is a multi-functional coin processing machine that incorporates all the features of a professional coin counter/sorter/wrapper at a very affordable price. Its large hopper is capable of holding 2,000 coins and the coin trays can each accumulate up to 900 coins at a time. Displaying the subtotal for each denomination and the total value makes the Cassida C200 an easy all-in-one tool for any coin-handling needs. The Cassida C200's lightweight, compact, and stylish design will easily fit into your business environment.

Box contents

- Cassida C200 Automatic Coin Counter/Sorter/Wrapper
- User manual
- Cleaning cloth
- Coin tubes

Front and rear views

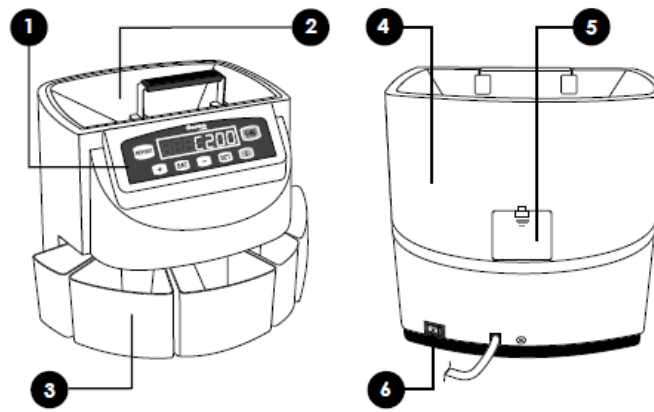

1. Control panel
2. Coin hopper
3. Coin trays
4. Plastic housing
5. Rear access panel
6. Power switch

- Holds coins that need to be counted.
- Each tray holds a specific denomination of counted and sorted coins.
- When removed, provides access to the counting mechanism for cleaning and repair purposes.
- Provides easy access to the interior mechanism to remove foreign objects and coins.
- Turns the machine on and off.

Control panel



Name	Function
START/STOP	Starts or stops the operation of the machine
C	Clears the display and resets the count
SET	Shows batch quantities set for each denomination
BAT	Select preset batch quantities (0, 10, 20, 25, 50, 80, 100, 120, 150, 200, 300, 400, 500)
– (Minus)	Decreases batch quantity by a value of 1 Also used to clear all batch quantities when pressed for 2-3 seconds
+ (Plus)	Increases batch quantity by a value of 1 Switches between value reporting and quantity reporting Also used to set batch quantities for coin rolls when pressed for 3-4 seconds
REPORT	Shows the value (or quantity) of coins counted for each denomination

Specifications

Hopper capacity	Up to 2,000 coins (varies for each currency)				
Coin tray capacities	US del	Canadian countries	Other Denomination	model	mo
	\$2	n/a	125	variable	
	\$1	130	130	(denominations	
	25¢	350	190	and capacities vary by country)	
	10¢	900	350		
	5¢	450	200		
	1¢	300	300		
Batch range	0-500 coins				
Control panel display	7 digit LED				
Dimensions	284mm (w) x 260mm (h) x 275mm (d) 11.18" (w) x 10.24" (h) x 10.83" (d)				
Weight	3.95 kg (8.7 lbs)				
Counting speed	up to 300 coins/minute				
Input power	110 VAC / 60 Hz or 220 VAC / 50Hz (refer to the input power label on the rear of this unit)				
Power consumption	45 watts maximum				
Ambient temperature	0°C – 40°C (32°F – 104°F)				
Ambient humidity	30 to 80%				

Important safety notes

Basic safety precautions should be observed when using this unit, including the following:

- Do not use this unit in areas where it may be exposed to water or any other liquids.
- Only use the power cord supplied by the machine. Plug the power cord into a properly grounded wall outlet. Do not remove the ground pin from the power cord. Failure to properly ground the machine can result in severe

injury or fire.

- Make certain the unit is installed on a flat surface. Do not operate the machine in areas with high temperature, humidity or smoke as these conditions may prevent proper operation.
- Do not start the unit when the rear access panel is open. Ensure no coins are in the hopper when the machine is first turned on.
- When not using the unit for an extended period of time, disconnect the power cord from the wall outlet.
- Unplug the unit from the wall outlet before cleaning. Use a damp cloth or specifically designed maintenance accessories such as the Cassida air duster or soft bristle brush.
- To avoid the risk of electrical shock, do not disassemble this unit. Disassembly will expose you to dangerous voltages and other safety risks. Incorrect reassembly can cause electrical shock when the appliance is subsequently used.
- Take the unit to a qualified technician when service or repair is required. Do not try to replace any parts yourself.

GETTING STARTED

Powering up

IMPORTANT: Before turning on the Cassida C200, make certain no coins are present in the coin hopper. This will cause an “EA” error when the C200 self-test is performed. To clear the “EA” error, press the “START/STOP” button, then empty any coins present in the coin trays.

Turn on the power switch located on the rear of the unit. The machine will conduct a self-check. The main display will show “0” when the test has successfully completed.

Counting

The C200 always operates in a batching mode. To enable simple counting, all batch quantities need to be set to zero. To set batch quantities to zero, press and hold the “-” button for approximately three seconds until “C” is displayed on the left of the LED display.

- Before loading the hopper, make sure there are no uncounted coins remaining in it from the previous count.
- To count coins, place them into the hopper and press the “START/STOP” button.
- The C200 will start counting and will automatically sort all coins into the appropriate coin trays.
- The machine will automatically stop when all coins in the hopper are counted, or if the batch quantity for any coin denomination is reached.
- To stop the machine, press the “START/STOP” button.
- To resume counting, press the “START/STOP” button.
- When a coin tray becomes full, stop the machine and empty the tray to ensure correct machine operation. Stopping the machine will not alter or reset the count. You can continue counting by pressing the “START/STOP” button.
- As it counts, the Cassida C200 will automatically display the total value of counted coins on the screen.
- To view the value of coins counted for each denomination press the “REPORT” button. The denomination will appear on the left and the value of coins counted on the right part of the screen. To display the number of coins counted, press the “+” button.

While in the REPORT mode, pressing the “+” button will switch the display between the value of coins counted

or a number of coins counted. The C200 will remember the last setting chosen for the report display.

- To reset the coin count before starting a new batch, press the “C” button.

Adding

The C200 operates in ADD mode by default. In ADD mode, the coin count is added to the count from previous batches. To start a new count, press the “C” button. This will reset the coin count to zero.

Setting Batch Quantities

You may batch the desired quantity of each coin denomination. Each denomination can be assigned a batch quantity.

Setting batch quantities for coin rolls

Press and hold the “+” button for approximately three seconds until “L” is shown in the display. This automatically programs each coin denomination for bank coin roll amounts as follows:

- \$2 25 (Canadian model only)
- \$1 25
- 25¢ 40
- 10¢ 50
- 5¢ 40
- 1¢ 50

Setting other batch quantities

- Press “Set” until the desired denomination appears on the left part of the screen.
- To assign a batch quantity for this denomination press the “BAT” button until a desired batch quantity appears on the display
- (0, 10, 20, 25, 50, 80, 100, 120, 150, 200, 300, 400, 500). Fine adjustments to batch quantity can be made by pressing the “-” or “+” button.
- Repeat this procedure to set the desired batch quantities for other coin denominations.

The C200 will stop when a desired batch quantity is completed for any of the denominations. The denomination will be displayed on the left and the total count for that denomination will be displayed on the right side of the screen.

NOTE: When operating in batch mode, the C200 will keep a running total for each denomination coin. For example, after four batches of 50 pennies have been dispensed, the C200 will stop and display:

- IC 200 (quantity reporting)
or
- IC 2.00 (value reporting)

To resume counting, press the “START/STOP” button. Pressing the “C” button will reset the count and the machine will start batching from zero. The batch quantities you choose will be stored in the C200’s internal

memory and will not be reset when the machine is turned off.

Clearing batch quantities

You may clear all batch quantities by pressing and holding the “-” button for approximately three seconds. The C200 will then beep and display a “C” message on the control panel, indicating all batch quantities have been reset to zero.

Using the coin tube attachments

The C200 coin tube attachments allow you to sort coins directly into preformed paper bank roll wrappers.

To use the coin tube attachments, perform the following steps:

1. Remove the coin tray(s) for the denomination coins that will be using coin tubes.
2. Insert the appropriate pre-formed paper wrapper in the coin tubes with the crimped end down. Ensure the top of the paper wrapper is below the top lip of the coin tube as shown in Figure 1.

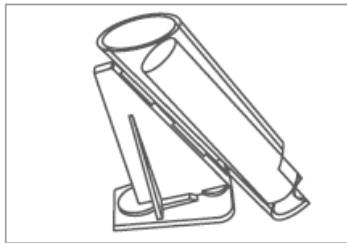

Figure 1: Coin roll inserted into coin tube

3. Attach the coin tubes to the C200 by gently sliding each tube into the proper slot in the base of the machine as shown in Figures 2 and 3.

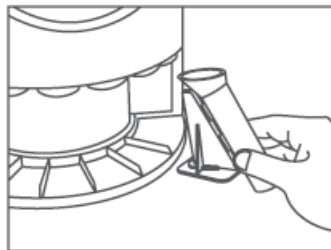

Figure 2 - Installing coin tube

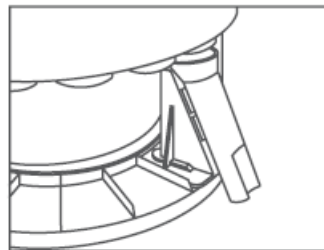

Figure 3 - Coin tube in proper position

Coin tube locations for each country vary. Use coin denomination labels to help you place the coin tubes. Coin tubes should be placed exactly underneath the coin denomination label.

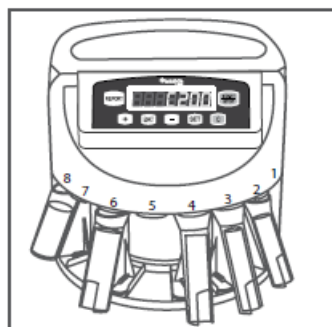

Figure 4 - US model

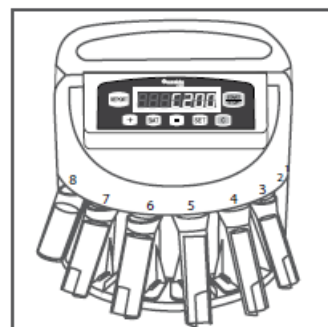

Figure 5 - Canadian model

4. Set coin roll batch quantities (see section 2.4) for each coin denomination by pressing and holding the “+” button for approximately three seconds until “L” is shown in the display. This programs each coin denomination for standard bank coin roll sizes.

US Model: **Canadian Model:** Other Countries

\$2 25 Varies

\$1 25
25¢ 40
10¢ 50
5¢ 40
1¢ 50

5. Load coins into the coin hopper and press the “START/STOP” button. The C200 will automatically dispense the correct number of coins into each coin tube.
6. When the number of dispensed coins equals the batch quantity for any denomination, the C200 will stop and display a message on the control panel. For example, after the first batch of 50 pennies has been counted, the front panel will display:
 - 1c 50 (quantity reporting)
 - or
 - 1c 0.50 (value reporting)

NOTE: When operating in batch mode, the C200 will keep a running total for each denomination coin. For example, after four batches of 50 pennies have been dispensed, the C200 will stop and display:

 - 1c 200 (quantity reporting)
 - or
 - 1c 2.00 (value reporting)
7. Remove the full coin tube from the C200 and slide out the paper wrapper containing the coins. Crimp the open end of the wrapper. Insert an empty wrapper in the coin tube and reinstall the coin tube.
8. Press the “START/STOP” button to continue batching.

MAINTENANCE AND TROUBLESHOOTING

Maintenance

Most operational problems can be avoided with regular care and preventive maintenance. Taking regular care of your coin sorter will significantly increase its lifetime and help you avoid costly repairs.

IMPORTANT: You should always turn the machine off and disconnect the power cord before cleaning the machine.

To get the best results out of your machine, the following maintenance is recommended on a regular basis:

- Clean all external parts of the machine with a Cassida air duster or a soft cloth. Do not use solvents, as they may damage the C200.
- Clean all the sensors using the procedure described below:
 1. Remove the three housing screws and carefully lift up the housing.
 2. Clean all sensors and other dusty parts using a Cassida air duster followed by a CleanPro swab. See Figure 6 for sensor locations.
 3. Replace the housing. The housing must be properly lined up with the AC power cord at the back of the machine. Do not force the housing into place, as this could damage the coin feed mechanism built into the housing.

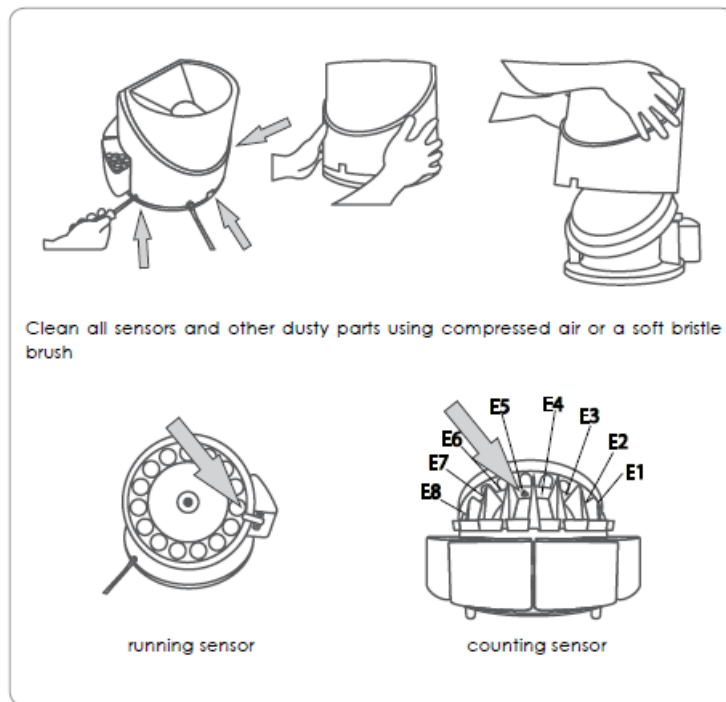

Figure 6 - Sensor locations

TROUBLESHOOTING

Error message display

Error code	Cause	Corrective action
<i>E 1 – E8</i>	A counting sensor may have collected dust or is obscured by a foreign object.	<p>Clean the counting sensor using a Cassida air duster and CleanPro swab (see section 3.1).</p> <p>Inspect coin outlet openings for possible foreign material that may be present (rubber bands, paper, etc.)</p>
<i>E9</i>	The running sensor does not detect the rotation of the coin platter.	<p>Clean the running sensor (see section 3.1).</p> <p>Inspect the interior of the machine for possible foreign material that may be preventing the coin platter from rotating.</p> <p>If the error persists, contact Cassida Technical Support (see section 3.3).</p>
<i>EA</i>	<ol style="list-style-type: none"> Coins are present in the hopper when the machine is turned on. Defective coin sensor. 	<ol style="list-style-type: none"> Press the “START/STOP” button to clear the error. Empty any coins in coin trays back into the hopper. Contact Cassida Technical Support (section 3.3).

Warranty

Warranty Registration

To activate your warranty in the US or Canada, please register your product online by visiting www.cassidausa.com/register.html. In other countries, go to www.cassidaglobal.com/register.html. For warranty information, please visit www.cassidausa.com/support.html. In most cases, the malfunction of the machine can be resolved by cleaning the unit. Please refer to section 3.1 for guidelines.

Contact information

Technical Support Contact Information:

- **Email:** technicalsupport@cassidausa.com
- **Tel:** (888) 800-0303
- www.cassidausa.com or in other countries, go to www.cassidaglobal.com

FREQUENTLY ASKED QUESTIONS

What is the Cassida C200 Coin Counter & Roller?

The Cassida C200 is a compact and reliable coin counter and roller designed for businesses and organizations that deal with large volumes of coins.

How fast can the C200 count coins?

The Cassida C200 can count and sort up to 300 coins per minute, offering efficient and rapid coin processing.

What types of coins can the C200 handle?

The Cassida C200 can handle most U.S. coins, including pennies, nickels, dimes, quarters, and dollar coins.

Is the C200 suitable for businesses with various currencies?

The Cassida C200 is primarily designed for U.S. coins and may not be suitable for handling other currencies without appropriate adjustments.

Can the C200 count tokens or foreign coins?

The Cassida C200 is optimized for U.S. coins and may not accurately count tokens or foreign coins with different specifications.

Does the C200 provide accurate coin counting?

Yes, the Cassida C200 ensures accurate counting with advanced sensors and technology, minimizing errors

in coin sorting.

Is the C200 easy to operate?

Yes, the Cassida C200 features a user-friendly interface, making it easy to operate even for users with minimal experience.

Can the C200 batch coins for wrapping?

Yes, the Cassida C200 allows users to batch coins into customizable amounts, facilitating easy coin wrapping and storage.

What is the hopper capacity of the C200?

The Cassida C200 has a hopper capacity of up to 2000 coins, reducing the frequency of manual coin loading during counting.

Is the C200 portable and compact?

Yes, the Cassida C200 is compact and lightweight, making it portable and suitable for businesses with limited space.

Does the C200 require any maintenance?

The Cassida C200 is designed for low maintenance, but regular cleaning and occasional calibration are recommended to ensure optimal performance.

Is technical support available for the C200?

Yes, Cassida offers technical support and customer assistance for the C200, including setup, troubleshooting, and maintenance guidance.

Can the C200 detect counterfeit coins?

No, the Cassida C200 is designed for counting and sorting genuine coins and does not have counterfeit detection features.

Is the C200 suitable for retail businesses?

Yes, the Cassida C200 is commonly used in retail businesses, banks, and other organizations dealing with coins on a regular basis.

What is the warranty for the Cassida C200 Coin Counter & Roller?

The warranty typically range from 1 year to 2 years.

VIDEO – PRODUCT OVERVIEW



[Download the PDF link Cassida 680023 in Cassida 8200 Cruise Control Roller-User-Manual.mp4](#)



[Manuals+](#)