

CASIO WSD-F20X BAND Smart Watch



CASIO WSD-F20X BAND Smart Watch User Guide

[Home](#) » [Casio](#) » CASIO WSD-F20X BAND Smart Watch User Guide 

Contents

- [1 CASIO WSD-F20X BAND Smart Watch](#)
- [2 INSTALLATION AND USING INSTRUCTION](#)
- [3 Instructions Overview](#)
- [4 FAQ](#)
- [5 Documents / Resources](#)
 - [5.1 References](#)
- [6 Related Posts](#)

CASIO®

CASIO WSD-F20X BAND Smart Watch



INSTALLATION AND USING INSTRUCTION



A / B

1

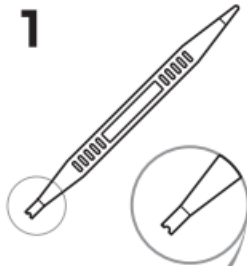

2

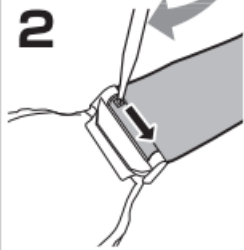

3

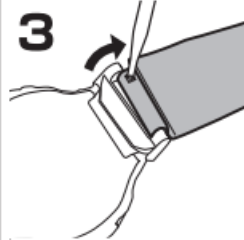

4

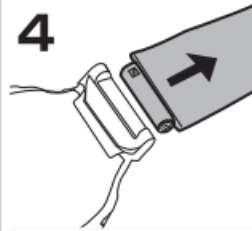

A / B

1

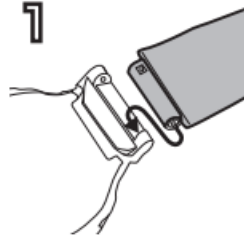

2

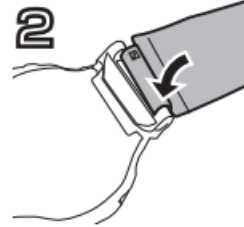

3

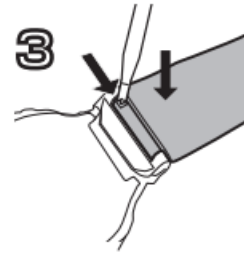

4

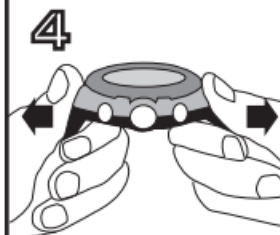

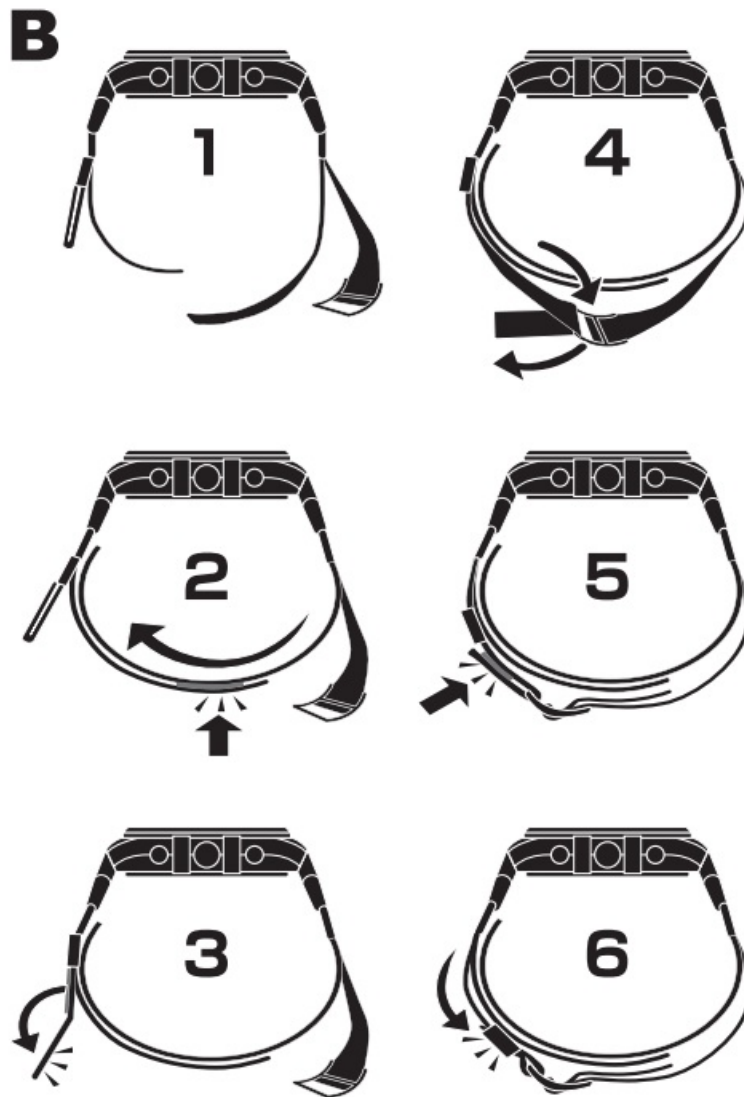

Instructions Overview

The images provide a step-by-step guide for adjusting a watch strap.

Adjusting the Watch Strap Length

Illustrations A and B depict the process of adjusting the length of the watch strap.

Diagram A: Shows the watch with an arrow pointing toward the pin that needs to be removed to adjust the strap.

Steps for Diagram A:

1. Use a tool to push the pin out.
2. Remove the pin completely with your fingers.
3. Separate the watch strap at the removed pin section.
4. Reattach by aligning and inserting the pin into the desired hole.

Diagram B: Demonstrates how to wrap the strap around the wrist and secure it in place.

Steps for Diagram B:

1. Position the watch on the wrist.

2. Pull the strap tight around the wrist.
3. Secure the strap by pressing it downwards.
4. Adjust until the strap fits comfortably.
5. Ensure the strap is securely fastened.
6. Double-check for a proper fit.

FAQ

- **Where can I find the manual for my watch?**
 - Manuals for various watches can be found at [Manual-Hub.com](https://www.manual-hub.com).
 - **What tool do I need to adjust the watch strap?**
 - A small tool, such as a pin pusher or a similar device, is required to remove the pins from the watch strap for adjustment.
 - **How can I ensure the watch strap fits comfortably?**
 - After making adjustments, wrap the strap around your wrist and secure it. Adjust the tightness and secure the strap to ensure a comfortable fit.
 - **What should I do if the strap doesn't fit after adjustment?**
 - If the strap doesn't fit comfortably after adjustment, you may need to remove or add links to the strap. Refer to the specific sections in the manual for further instructions.
-

Documents / Resources

	CASIO WSD-F20X BAND Smart Watch [pdf] User Guide WSD-F20X BAND Smart Watch, WSD-F20X BAND, Smart Watch, Watch
---	--

References

-  [Manual-Hub.com - Free PDF manuals!](https://www.manual-hub.com)
- [User Manual](#)

[Manuals+.](#) [Privacy Policy](#)

This website is an independent publication and is neither affiliated with nor endorsed by any of the trademark owners. The "Bluetooth®" word mark and logos are registered trademarks owned by Bluetooth SIG, Inc. The "Wi-Fi®" word mark and logos are registered trademarks owned by the Wi-Fi Alliance. Any use of these marks on this website does not imply any affiliation with or endorsement.