



CarryBright Remote Control Front and Rear LED Direction Indicator User Manual

[Home](#) » [CarryBright](#) » CarryBright Remote Control Front and Rear LED Direction Indicator User Manual 

Contents

- [1 CarryBright Remote Control Front and Rear LED Direction Indicator](#)
- [2 Package List](#)
- [3 Product Overview](#)
- [4 Basic Operation](#)
- [5 SWITCH MODE](#)
- [6 Specification](#)
- [7 Warranty](#)
 - [7.1 FCC Statement](#)
- [8 Documents / Resources](#)
 - [8.1 References](#)
- [9 Related Posts](#)

CarryBright

CarryBright Remote Control Front and Rear LED Direction Indicator



Package List

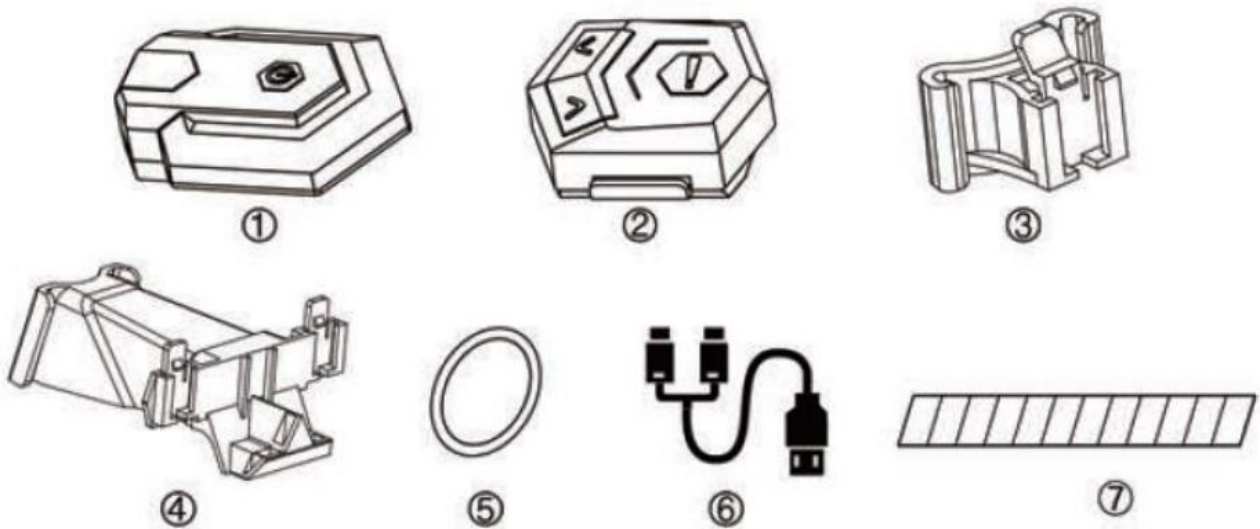

1. direction indicator X 4
2. Remote controller X 1
3. Small mounting bracket X 4
4. Rear seat mounting bracket X 1
5. Silicon band X 6
6. 1 split 4 charge USB cable X 1
7. Friction pad sticker X 12

Notice Before Use

- It's recommended to use 5A/2A adapter to charge.

- The charging or working hours may be slightly varied for different usage duration and interval.
- Please make sure the bracket is firmly fixed and undamaged.
- Please charge the controller if the LED on the controller doesn't work or all lights flash when press any button.
- Please take out the battery before disposing the product. Dispose of used batteries in accordance with local regulations.

Product Overview

Remote Control

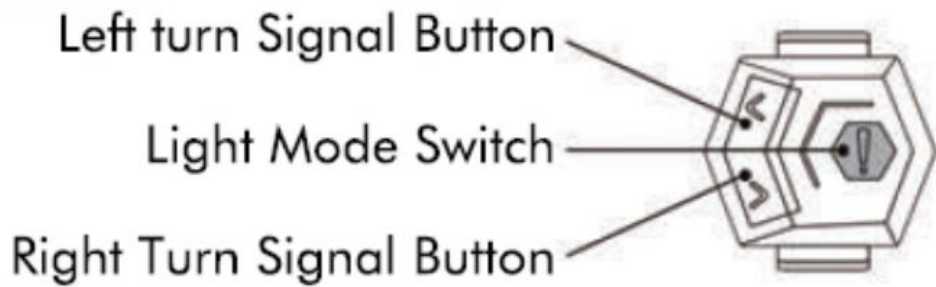

LED Direction Indicator

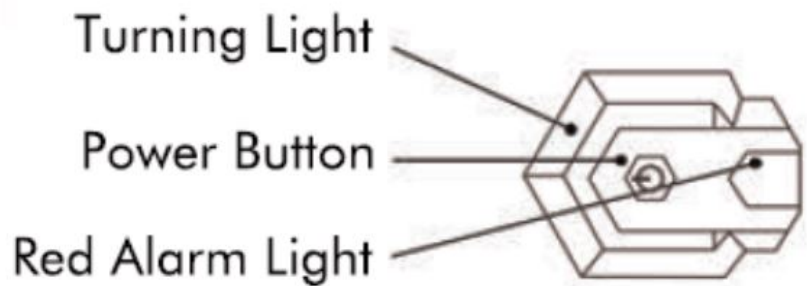

Basic Operation

INSTALLATION

1. Stick the friction sticker to the corresponding area of the mounting bracket.

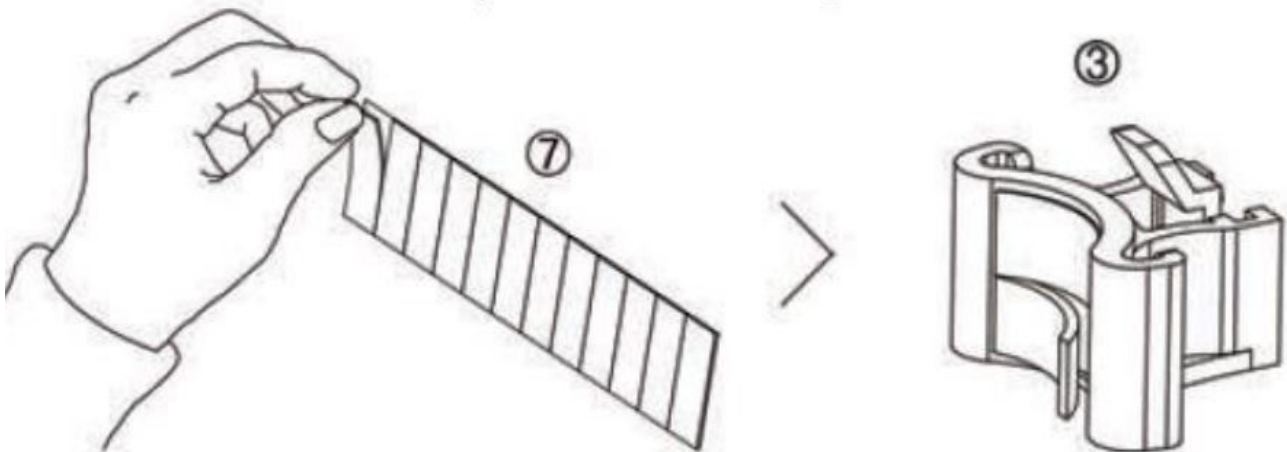

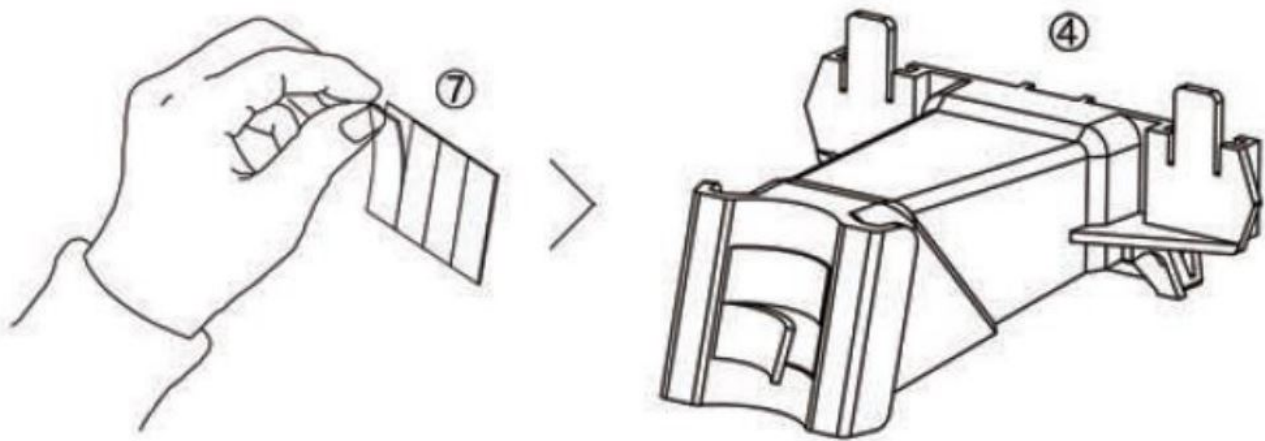

2. Lock the indicators on the bar bracket or seat tube bracket depends on your needs.

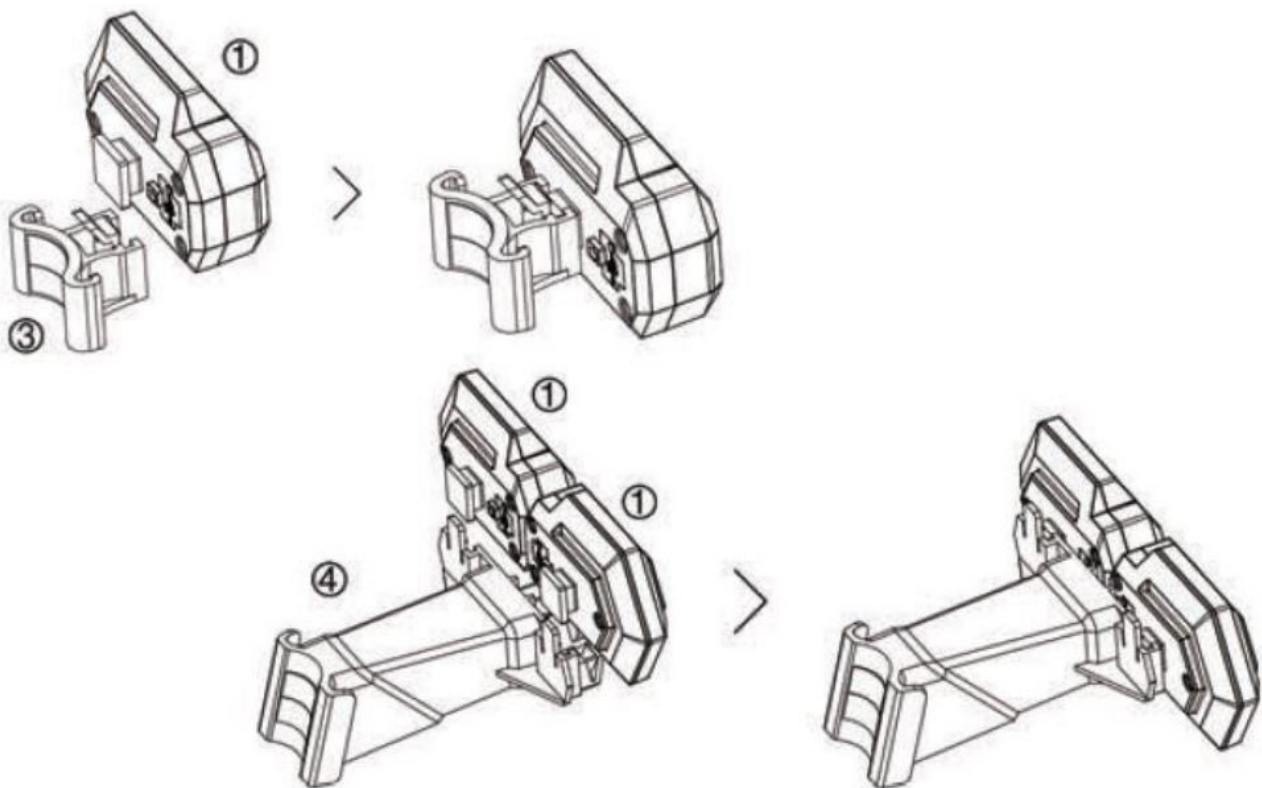

1. a Fasten the mounting bracket on the tube with the silicon ring.

3. Fasten the remote controller on the handlebar with the silicon ring.

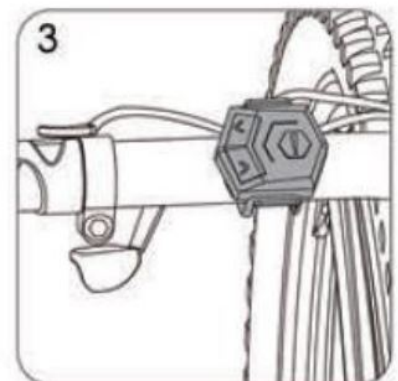
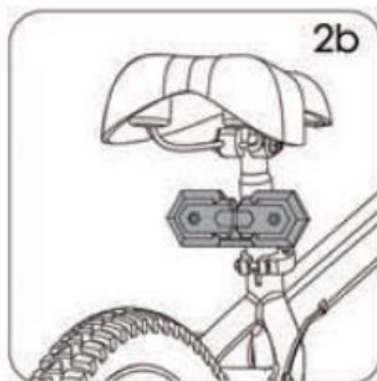
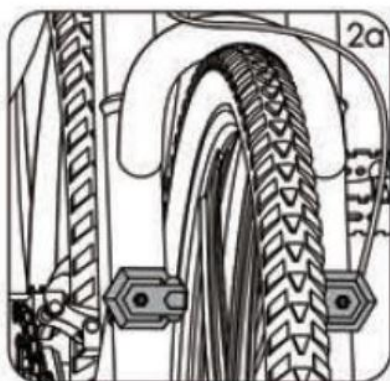

CHARGE

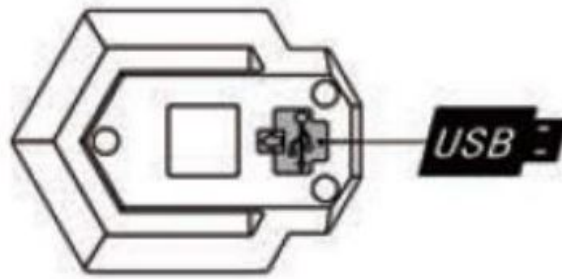

Please fully charge the LED Direction Indicator before use.

- Connect the indicator to power source with the USB charging cable;
- Charging time: 2 hours
- During charging: Red light is ON
- Fully charged: Green light is ON

SWITCH MODE

Switch mode on remote controller:

- Click Mode Switch button to switch mode of the indicator
- Mode①: Small red light keeps flashing(for night caution);
- Mode②: Red light and yellow turn light keep flashing (Warning);
- Mode③: All lights turn OFF;
- Turn signal can only be activated in MODE ① OR ③.
- Please switch to MODE ③ after use for battery-saving by the Mode Switch button (Remote) or Power button (LED Direction Indicator).

Switch button on LED Direction Indicator:

- Click switch button on LED Direction Indicator to switch modes.
- 1st press: LED Direction Indicator flash in 2HZ
- 2nd press: LED Direction Indicator OFF

Press and hold the switch on the LED Direction Indicator for 3s to enter paring mode (to pair the Remote and a new LED Direction Indicator when you lost one). Normal use you don't need the enter paring mode.

TURNING SIGNAL

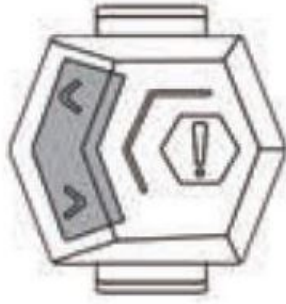

Left Turn: Press left button () to flash left turn signal for 30s; Left Turn: Press right button () to flash right turn signal for 30s; Press corresponding turn button again to cancel the turn signal while signal is activated. Turn signal can only be activated in MODE ① OR ③.

Specification

Turn signal LED

- Light source: COB LED
- Waterproof Level: IP65
- Working hours: Continuous flash 4 hours
- Battery: 230 mAh lithium battery
- Working Temperature: -10°C to 40°C
- Brightness: 75 Lumens

Remote Control

- Light source: LED
- Waterproof Level: IP65
- Working hours: Standby 200 days
- Battery: 180 mAh lithium battery
- Working Distance: Within 10 meters from Turn Signal LED

Warranty

Warranty

- The LED Direction Indicator comes with 12 months warranty from the beginning of shipment.
- If you have any question or concerns about the product, please drop us an email at carrybriht@carrybright.com.
- All contact will be answered within 24 hours.

FCC Statement

This equipment has been tested and found to comply with the limits for a Class B digital device, pursuant to part 15 of the FCC Rules. These limits are designed to provide reasonable protection against harmful interference in a residential installation. This equipment generates, uses and can radiate radio frequency energy and, if not

installed and used in accordance with the instructions, may cause harmful interference to radio communications. However, there is no guarantee that interference will not occur in a particular installation. If this equipment does cause harmful interference to radio or television reception, which can be determined by turning the equipment off and on, the user is encouraged to try to correct the interference by one or more of the following measures:

- Reorient or relocate the receiving antenna.
- Increase the separation between the equipment and receiver.
- Connect the equipment into an outlet on a circuit different from that to which the receiver is connected.
- Consult the dealer or an experienced radio/TV technician for help.

RF Exposure Information

The device has been evaluated to meet general RF exposure requirements. The device can be used in portable exposure conditions without restriction.

Documents / Resources

	CarryBright Remote Control Front and Rear LED Direction Indicator [pdf] User Manual CBRCTL01, 2A5VHCBRCTL01, Remote Control Front and Rear LED Direction Indicator, Remote Control Front and Rear LED Light, LED Direction Indicator
---	--

References

- [Carrybright-Carrybright](#)
- [Carrybright-Carrybright](#)