



## carmanah MX Series Push Button Kit Installation Guide

[Home](#) » [carmanah](#) » carmanah MX Series Push Button Kit Installation Guide 



MX Series  
PUSH BUTTON KIT INSTALL GUIDE  
LEVEL 4

### Contents

- [1 MX Series Push Button Kit](#)
- [2 Documents / Resources](#)
  - [2.1 References](#)

## MX Series Push Button Kit



**Mount with Integrated Sign Frame**

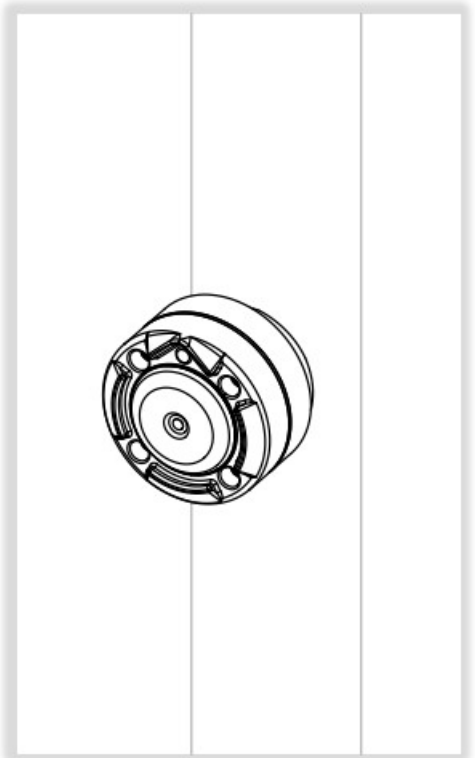

**Compact Pole Mount**

**NOTE**

ADA regulations specify that the button should be 42" from the ground.

**NOTE**

Push button can be connected in either polarity.

**NOTE**

Two or fewer parallel-connected buttons recommended per module trigger input.

1. Prepare pole and install button base per button manufacturer's instructions.
2. Ensure cable entry hole is deburred and button base sits flush against pole.
3. Fish cable through pole and button base and slip gasket over cable.

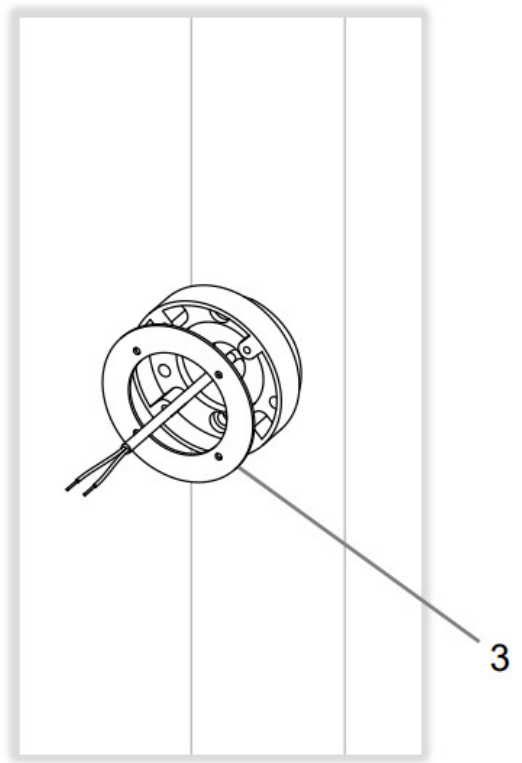
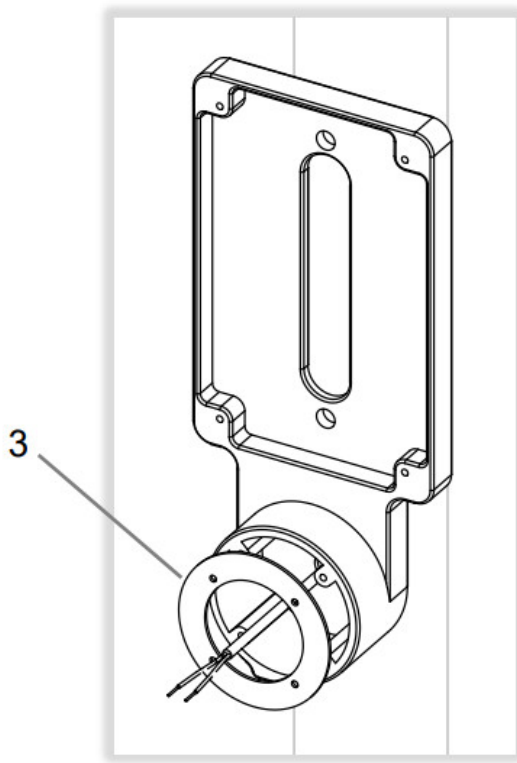

4. Connect one wire to each button terminal (button is not polarized).
5. Install button with its supplied hardware, ensuring gasket is in place and cable forms a drip loop inside pole.

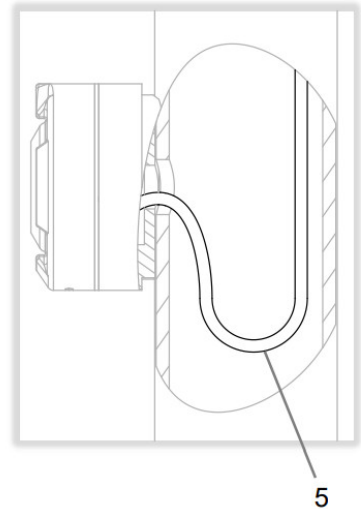
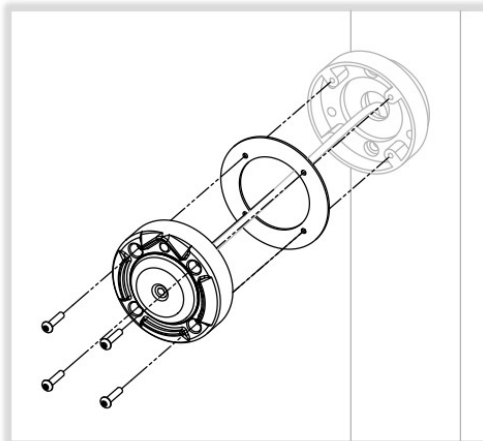
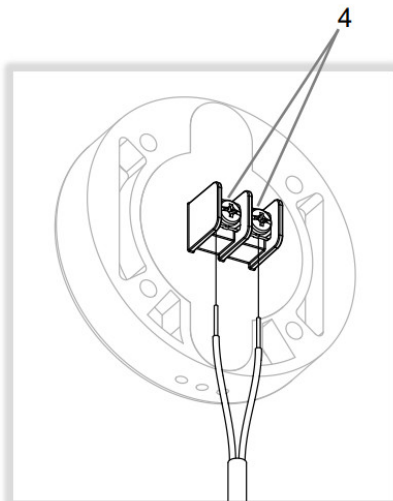

6. Connect other end of cable to trigger input terminals A and B of any power or flasher module.
7. Secure cable with cable tie following power or flasher module instructions.

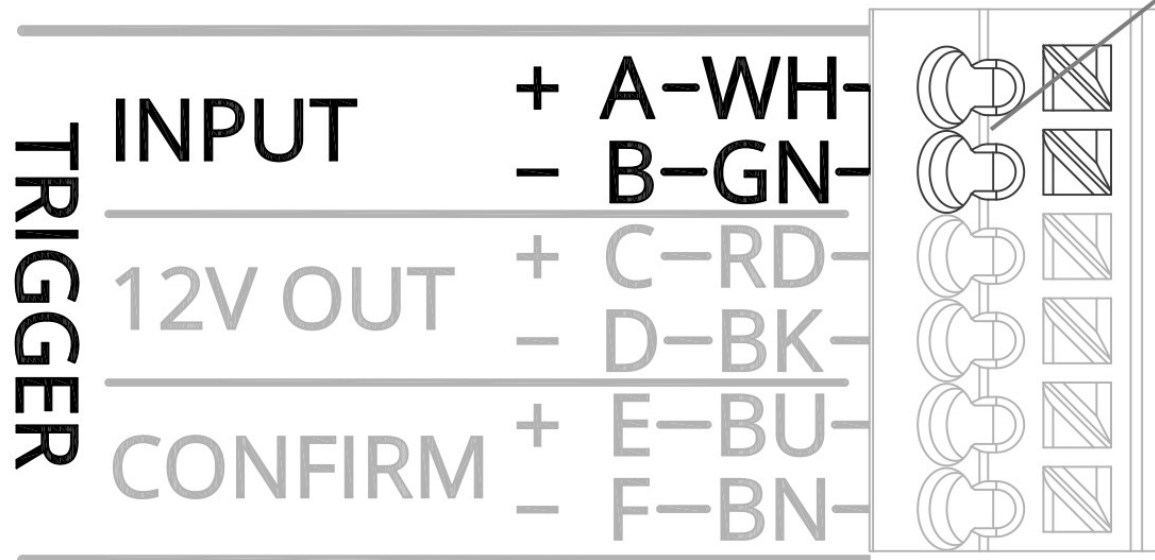

**NOTE:** READ ALL INCLUDED INSTALL GUIDES BEFORE SYSTEM INSTALLATION



**carmanah**<sup>®</sup>  
MX Series

**Carmanah Technologies Corp.**

250 Bay St, Victoria, BC V9A 3K5, Canada

1.250.380.0052

[customersupport@carmanah.com](mailto:customersupport@carmanah.com)

[carmanah.com](http://carmanah.com)

## Documents / Resources

	<p><a href="#">carmanah MX Series Push Button Kit</a> [pdf] Installation Guide MX Series Push Button Kit, MX Series, Push Button Kit, Button Kit</p>
--	--

## References

- [Systems for Traffic Beacons and Signs | Solar LED Beacons | Carmanah](#)
- [Systems for Traffic Beacons and Signs | Solar LED Beacons | Carmanah](#)