

# Carlson 6002 Foldable Secure Crate Instruction Manual

[Home](#) » [Carlson](#) » Carlson 6002 Foldable Secure Crate Instruction Manual 

## Contents

- [1 Carlson 6002 Foldable Secure Crate](#)
- [2 Before Assembly](#)
- [3 BEFORE USING PRODUCT](#)
- [4 CARE AND MAINTENANCE](#)
- [5 Assembling Your Crate](#)
- [6 Operating the Door](#)
- [7 WARRANTY](#)
- [8 Documents / Resources](#)
  - [8.1 References](#)
- [9 Related Posts](#)



**Carlson 6002 Foldable Secure Crate**

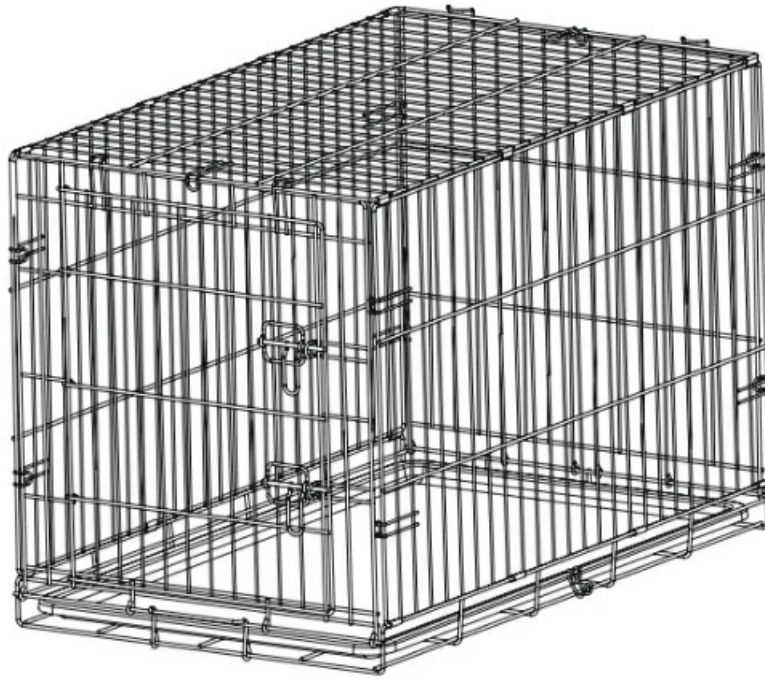

READ ALL INSTRUCTIONS BEFORE ASSEMBLY AND USE OF PRODUCT. KEEP INSTRUCTIONS FOR FUTURE USE

### **Before Assembly**

**A**

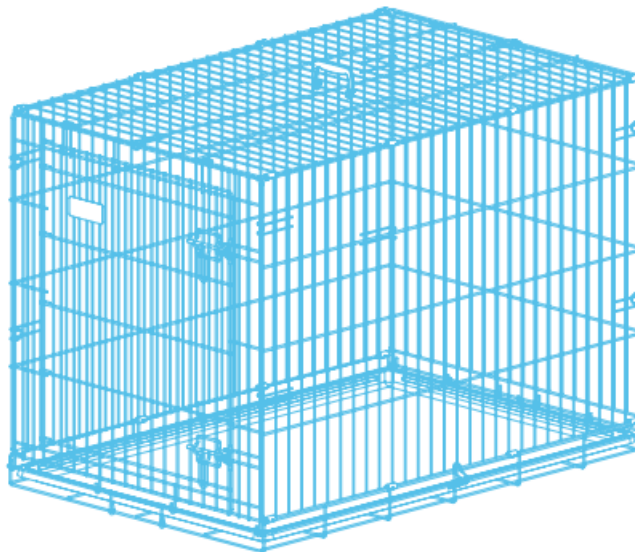

**PLEASE CHECK TO MAKE SURE YOU HAVE THE FOLLOWING PARTS:**

- Crate (1)

### **BEFORE USING PRODUCT**

Read and follow all instructions carefully to ensure that your crate is properly assembled. Improper assembly could result in the crate becoming unsafe. Please keep these instructions for your reference.

### **CARE AND MAINTENANCE**

Periodically check the pen for signs of damage, wear, or missing components. Do not use if any part is missing, worn or damaged Do not use abrasive cleaners or bleach. Clean with warm water and a mild detergent. Do not machine wash.

## Assembling Your Crate

1. Set the crate on the ground with the tray on the bottom. Unhook the latch from the side of the crate.

### STEP 1

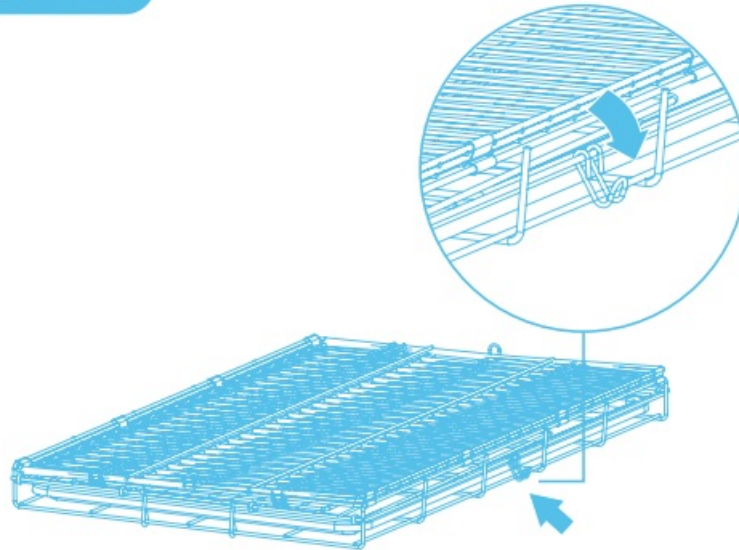

2. Unfold the panels, like turning the page of a book. Then pull upwards from the middle of the crate panels.

### STEP 2

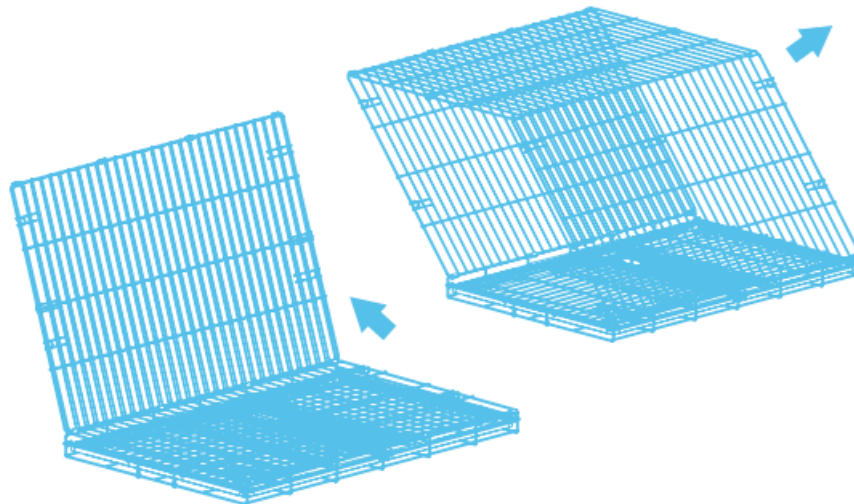

3. Hold the top panel up, reach inside the crate and pull the door panel forward until it snaps into the 7 hooks located around the edges of the crate.

### STEP 3

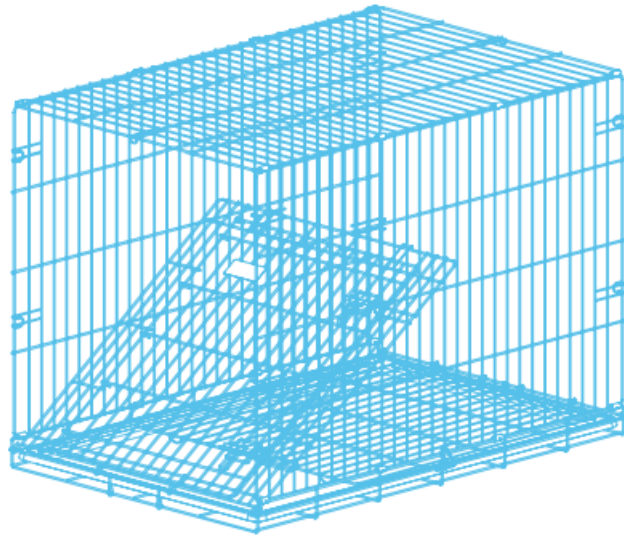

**NOTE:** A forceful pull will allow the hooks to snap into place.

4. Repeat Step 3 on the other side of the crate. Attach handle to center top crate panel, as shown illustrated.

### STEP 4

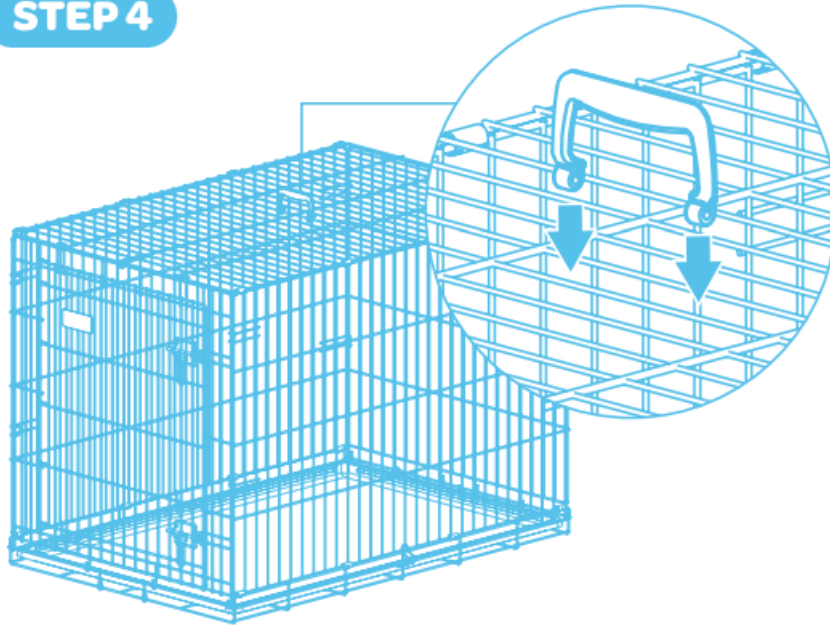

**NOTE:** For cleaning purposes, the bottom tray is removable. Do NOT carry pet in crate with handle.

### Operating the Door

1. To open, lift up the locking handle and slide to the left to release from the crate frame. If your crate has more than one locking handle repeat step for all locking handles to open the door.

**NOTE:** Crate size extra small and small include one latch on front door.

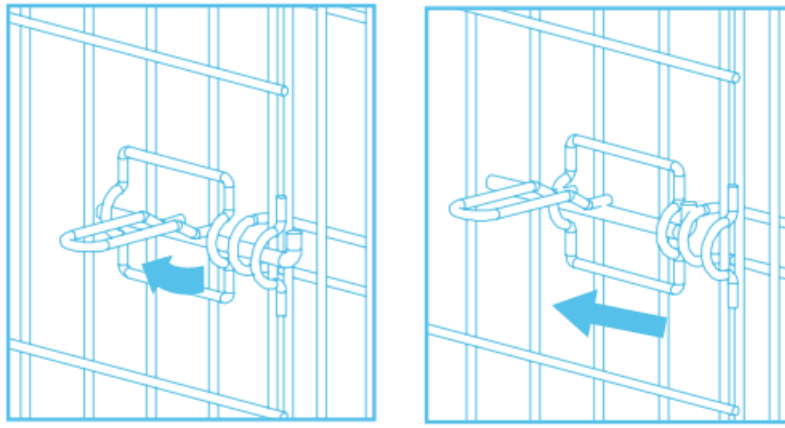

2. To close, lift up and slide the locking handle to the left and shut the door. Slide the locking handle to the right and push down to secure the locking handle to the crate frame. If your crate has more than one locking handle repeat step for all locking handles to open the door.

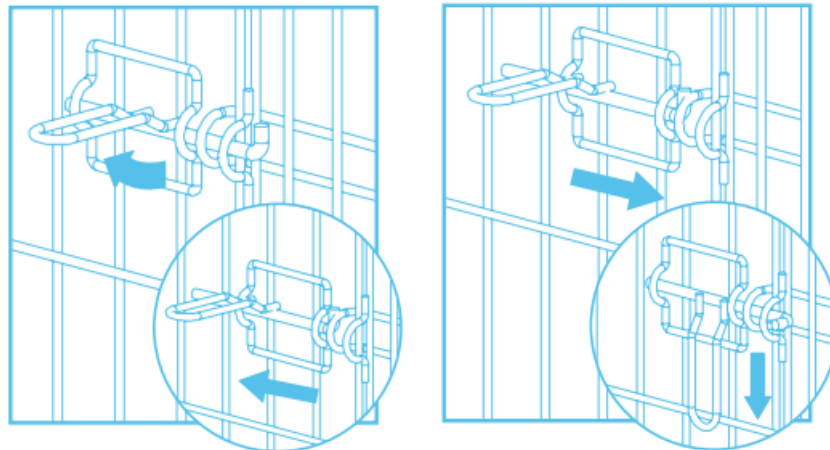

### Disassembling your crate

1. Unhook the 7 hooks located around the edges of the door panel by pushing the panel into the crate
2. Repeat Step 1 on the other side of the crate.
3. Allow the panels to all collapse flat. Fold the panels, like turning the page of a book.
4. Hook the latch on the side of the crate to lock all the panels together

### WARRANTY

#### 90 DAYS LIMITED WARRANTY

If, during the first 90 days after consumer purchase of the item, under reasonable and non-commercial use and conditions of maintenance, it fails while owned by the original purchaser because of the quality of materials or workmanship of finish and assembly, Carlson Pet Products, Inc. will replace or repair it at Carlson's option. PROOF OF PURCHASE REQUIRED.

#### Carlson Pet Products, Inc.

3200 Corporate Center Drive, Suite 105 /  
Burnsville, MN 55306, USA/ , É.-U. / , EE. UU.

[www.carlsonpetproducts.com](http://www.carlsonpetproducts.com)

952.435.1084

Made in Vietnam/ Fabriqué en Vietnam/ Hecha en Vietnam

---

## Documents / Resources

	<p><a href="#">Carlson 6002 Foldable Secure Crate</a> [pdf] Instruction Manual 6002, 6002 Foldable Secure Crate, Foldable Secure Crate, Secure Crate, Crate</p>
---	---

## References

- [User Manual](#)