

Garlinkit[®]
TBox Plus
Wireless
Carplay



Carlinkit TBox Plus Wireless Carplay User Manual

[Home](#) » [Carlinkit](#) » Carlinkit TBox Plus Wireless Carplay User Manual 

Contents

- [1 Carlinkit TBox Plus Wireless Carplay](#)
- [2 Function Introduction](#)
- [3 Product Specification](#)
- [4 Connection Instruction](#)
- [5 Download APPs](#)
- [6 After-sales Service](#)
- [7 Documents / Resources](#)
 - [7.1 References](#)



Carlinkit TBox Plus Wireless Carplay



Function Introduction

The product expands the open Android system platform through the car USB interface, supports the installation of applications at any time, and realizes more audio-visual entertainment and navigation functions. Besides, it also supports 4G/GPS/Bluetooth/Phone/Mobile Connectivity enables wireless CarPlay and wireless Android Auto.

Product Specification

Version&CPU

1. **Tbox Mini:** Qualcomm's® QCM2290 ARM® Cortex™-A53 Quad-Core 64-bit CPU, up to 2.0GHz 11nm process
2. **Tbox:** Qualcomm's® SDM450 ARM® Cortex™-A53 Octa-Core 64-bit CPU, up to 1.8GHz 14nm process
3. **Tbox Plus:** Qualcomm's® QCM6125, Quad-Core ARM® Cortex™-A73, 2.0GHz + Quad-Core ARM® Cortex™-A53, 1.8GHz 11nm process

- **Operating System:** Android system
- **System Storage:** 2GB(RAM)+32GB(ROM) / 3GB(RAM)+32GB(ROM) / 4GB(RAM)+64GB(ROM) / 6GB(RAM)+128 GB(ROM)
- **Operator Version:** NA(North America) / EAU(Europe, Asia) / CN(China) / No data version
- **Communication Standard:** LTD-FDD / LTE-TDD / WCDMA / GSM / EDGE
- **Global Positioning:** GPS / GLONASS / BeiDou
- **Wireless Network:** 802.11a/b/g/n/ac, 2.4G+5G
- **Bluetooth:** 4.2BLE+5.0BLE
- **Power Input:** 5V  1A

- **Temperature:** -20°C~75°C

Compatible cars and mobile phones

- **Applicable models:** The original car with wired CarPlay
- **iPhone:** Support iPhone 6 and above, for iOS 10 and above
- **Android phone:** Support Android 10.0 and above, some require Android 11.0 and above

SIM/TF Card Slot Instruction

- **SIM Card Slot:** Support 4G Network, real-time traffic Internet access (SIM card is inserted with the metal face down)
- **TF Card Slot:** Expandable up to 256GB (TF card is inserted with the metal face down)

Connection Instruction

- In original car system interface (the specific interface is subject to the actual car model), click “CarPlay” on the screen, then enter to product’s Android system interface.
- Insert the SIM card, click the “phone” icon to add existing contacts, or click the “BT Phone” icon to pair with the mobile phone’s Bluetooth, and the mobile contacts can be synchronized to the car screen.
- Click the “Settings” icon to change languages, customize wallpapers, etc.
- Click the “Home” icon to return to the original car system.

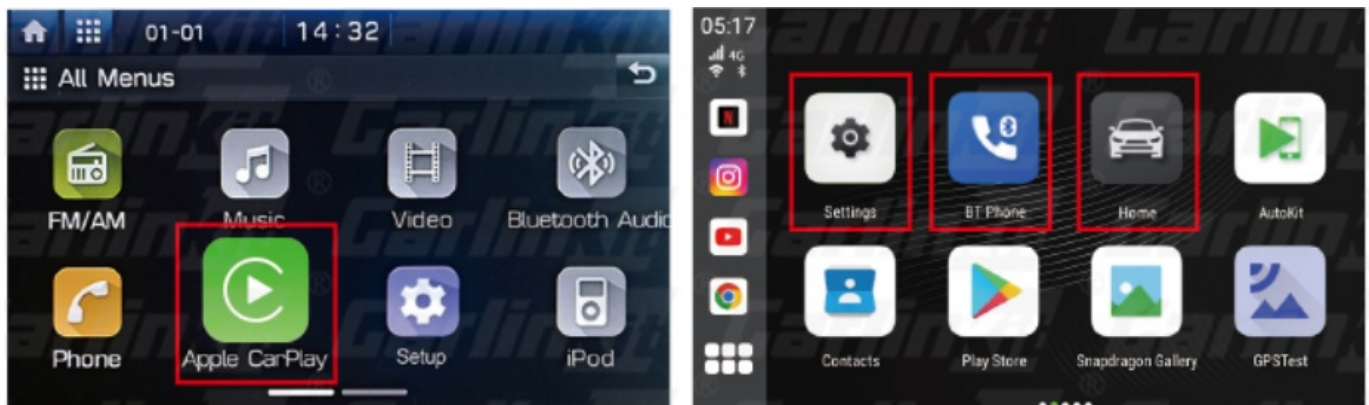

Wireless CarPlay/Android Auto Connection Instructions

1. Click the “AutoKit” icon to enter the connection interface

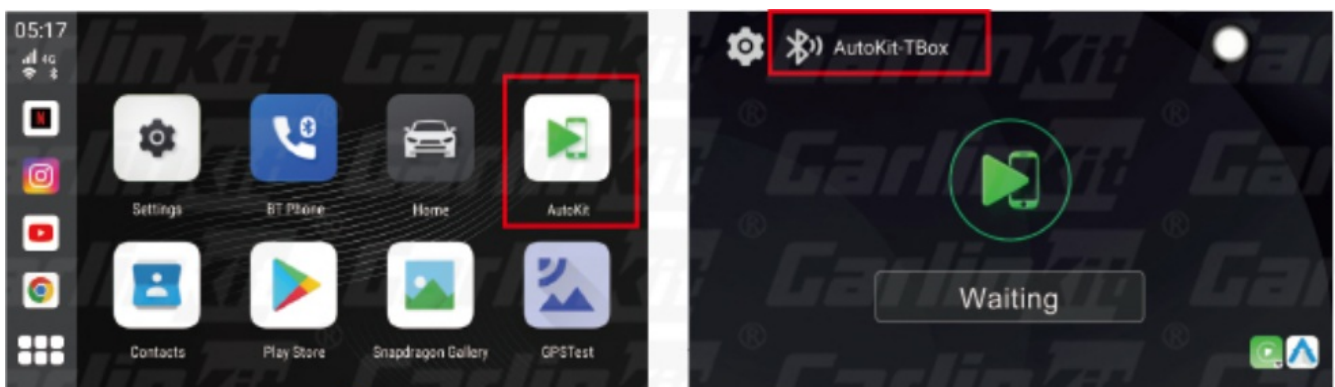

2. Turn on the Bluetooth and WiFi of the iPhone/Android phone
3. Search the bluetooth name displayed on the car screen in the bluetooth list of the mobile phone, and click pairing

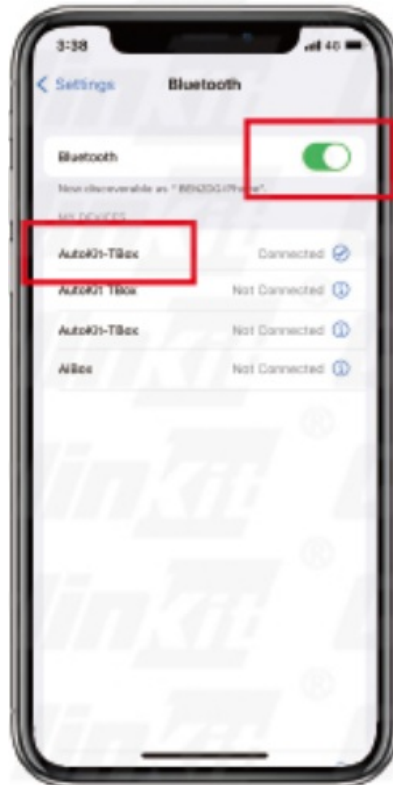

4. Wait for the connection to succeed, and the wireless CarPlay/Android Auto will work

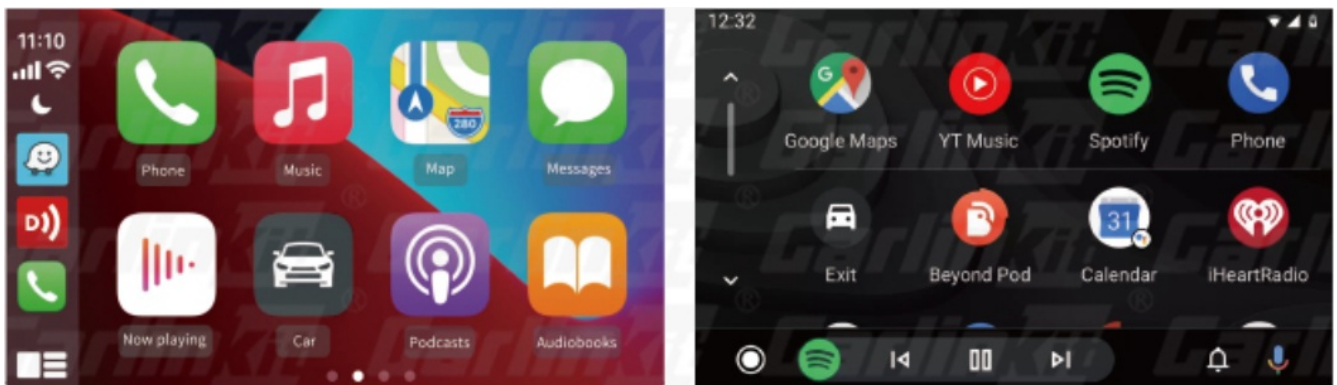

Download APPs

Click the “Play Store”, then can download various apps. It supports third-party map navigation, online music, plenty of awesome videos and online games, which makes your driving life joyful.

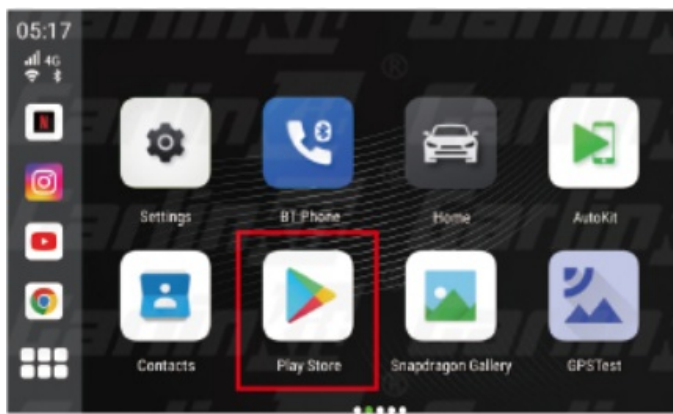

The main interface

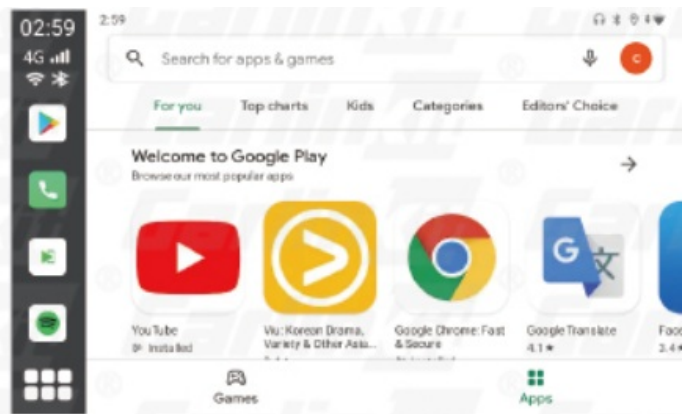

Play Store interface

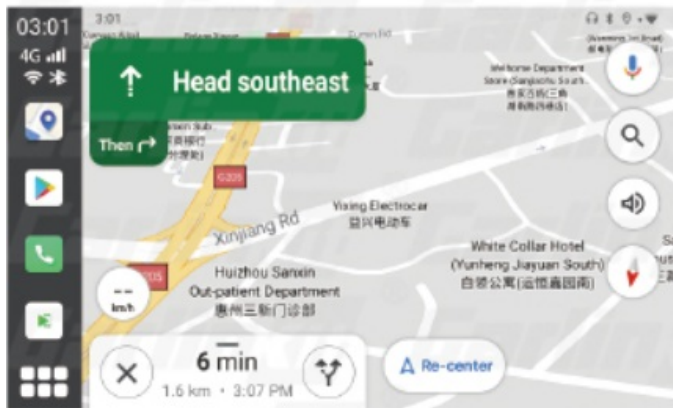

Online map



Online video

- **Q:** What should I do if the SIM card is not recognized when inserted?
 1. **A:** Confirm whether the card insertion method is correct (SIM Card inserted with metal side down, and the notch end is facing inward);
 2. Do not insert or remove the SIM card when the product is turned on. The product must be turned off to remove and insert the SIM card.
- **Q:** The Netflix display needs to be updated.
 - **A:** When it appears that it needs to be updated, please click the “Cancel” button (Don’t update or delete the software preloaded on the product).
- **Q:** The SIM card insertion is recognized, but the internet connection does not work.
 1. **A:** Settings – Network and Internet – APN, manually adjust it;
 2. Insert the SIM card into the Android phone and check the information parameters of the APN in the phone. Then in the product settings network and Internet – APN – right upper corner “+” sign, add APN parameters (add according to the parameters in the mobile phone);
 3. If you need a video tutorial of the operation, please contact the store customer service directly.

After-sales Service

Dear user, thank you for using this product. In order to protect your rights and interests, we will provide you with high-quality after-sales service. You can enjoy one-year warranty service from the date of purchase (for failure caused by the quality issue of the product itself). Please keep this card properly, as the necessary proof of warranty service, the company reserves the right to interpret the after-sales

Warranty Card

Name	Purchase date
Phone number	E-Mail
Address	
Dealer's name(stamped)	
Warranty content	



<https://carlinkitcarplay.com/>

Documents / Resources



[Carlinkit TBox Plus Wireless Carplay](#) [pdf] User Manual
TBox Plus Wireless Carplay, TBox Plus, Wireless Carplay, Carplay

References

- [Carlinkit Wireless CarPlay Adapter - Upgrade to Wireless CarPlay – Carlinkit Carplay Store](#)
- [User Manual](#)

[Manuals+](#), [Privacy Policy](#)

This website is an independent publication and is neither affiliated with nor endorsed by any of the trademark owners. The "Bluetooth®" word mark and logos are registered trademarks owned by Bluetooth SIG, Inc. The "Wi-Fi®" word mark and logos are registered trademarks owned by the Wi-Fi Alliance. Any use of these marks on this website does not imply any affiliation with or endorsement.