

CAR AUDIO-SYSTEMS RL-MFD2 Camera Interface



CARAUDIO-SYSTEMS RL-MFD2 Camera Interface User Manual

[Home](#) » [CARAUDIO-SYSTEMS](#) » CARAUDIO-SYSTEMS RL-MFD2 Camera Interface User Manual 

Contents

- [1 CAR AUDIO-SYSTEMS RL-MFD2 Camera Interface](#)
- [2 Product Usage Instructions](#)
- [3 Before installation](#)
- [4 Connection schema](#)
- [5 Installation](#)
- [6 Specifications](#)
- [7 Technical Support](#)
- [8 Legal Information](#)
- [9 Documents / Resources](#)
 - [9.1 References](#)
- [10 Related Posts](#)

CARAUDIO-SYSTEMS

CAR AUDIO-SYSTEMS RL-MFD2 Camera Interface



Specifications

- **Product Name:** Camera Interface RL-MFD2
- **Compatibility:** Audio-video-input compatible with navigation systems Volkswagen MFD2/RNS2 Skoda Nexus
- **Features:** AV input to connect any AV source to the factory navigation system
- **Version:** 20.09.2017

Product Usage Instructions

Delivery Contents

Take note of the SW-version and HW-version of the interface boxes. Store this manual for support purposes.

Check the Compatibility of the Vehicle and Accessories

- Ensure compatibility with Volkswagen, Seat, and Skoda MFD2/RNS2 or Nexus navigation systems.
- Check limitations on factory TV tuner and factory rear-view camera installations.

Connection Schema

Switch off the ignition and disconnect the vehicle's battery before installation.

Installation

- Plug harness RLC-VN02 into 12-pin Molex of Interface-box RLC-M02.
- Connect 18-pin AMP connectors accordingly.
- If connecting AV-source: Connect red cable to +12V ACC and black cable to ground. Do not connect the green

wire.

- If connecting the rear-view camera: Connect cables as instructed, suggest using a relay to avoid signal noise.
- **Note:** If the 18-pin AMP socket of the head unit is occupied, uninstall any factory rear-view camera or TV tuner before installation.

FAQ

Q: Can I use the product while driving?

- **A:** By law, watching moving pictures while driving is prohibited.
- The product should only be used while standing or to display fixed menus or rear-view camera video when the vehicle is moving.

Q: How can I receive software updates for the interface?

- **A:** We offer free software updates for one year after purchase.
- To receive a free update, send the interface at your own cost.
- Labor costs and other expenses for software updates will not be refunded.

Before installation

- Read the manual before installation. Technical knowledge is necessary for installation.
- The place of installation must be free of moisture and away from heat sources.

Delivery contents

- Take down the SW-version and HW-version of the interface boxes, and store this manual for support purposes.

Interface-box
RLC-M02
HW _____ SW _____



Harness
RLC-VN02

Check the compatibility of the vehicle and accessories

Requirements

- **Vehicle Volkswagen, Seat, and Skoda**
- **Navigation MFD2/RNS2, or Nexus navigation**

Limitations

- **Factory-TV-tuner** Must NOT be installed.
- **Factory-rear-view-** camera Must NOT be installed.
- **Video-source** Interface is initialized to PAL.

Connection schema

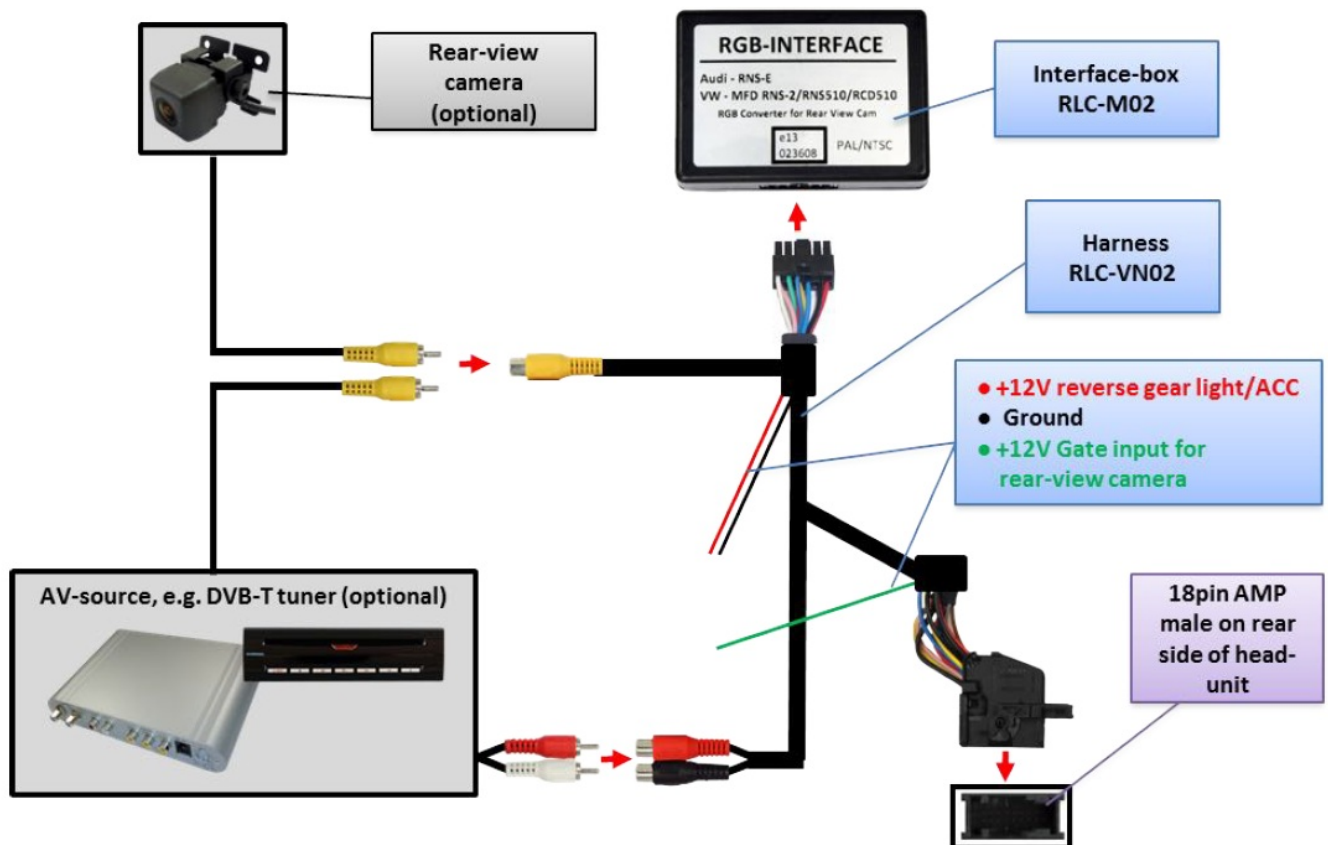

Installation

- Switch off the ignition and disconnect the vehicle's battery! If according to factory rules disconnecting the battery has to be avoided, it is usually sufficient to put the vehicle in sleep mode.
- In case the sleep mode does not show success, disconnect the battery with a resistor lead.
- The place of installation is behind the head unit.

Interconnecting interface box, harness, and head unit

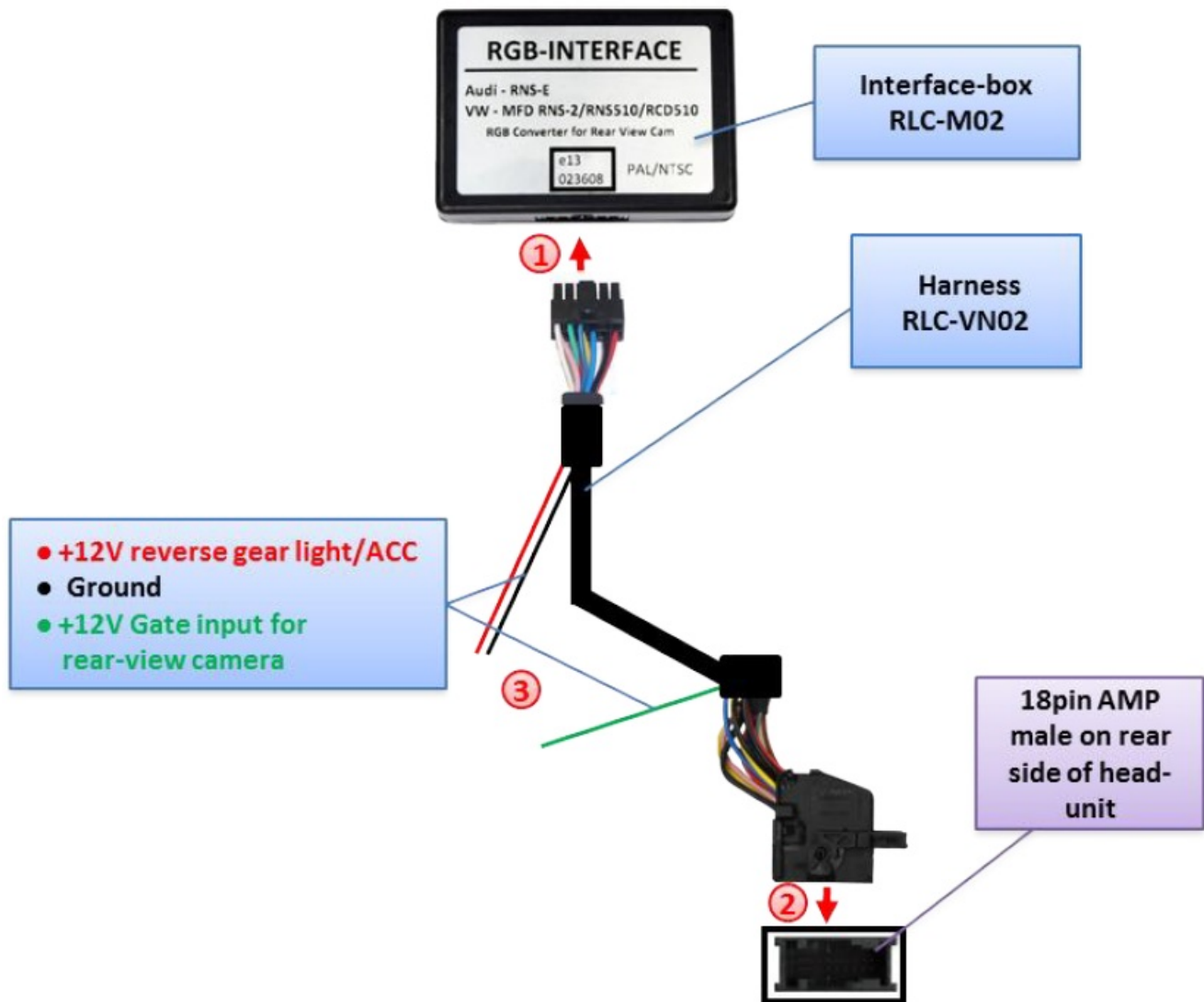

1. Plug harness RLC-VN02 into 12-pin Molex of Interface-box RLC-M02.
2. Plug the female 18-pin AMP connector of RLC-VN02 into the male 18-pin AMP connector of the head unit.
3. **If connecting an AV source:**

- Connect the red cable of harness RLC-VN02 to +12V ACC and the black cable of harness RLC-VN02 to the ground. NOT connect the green wire.

If connecting a rear-view camera:

- Connect the red and green cables of harness RLC-VN02 to +12V reverse gear light (we suggest connecting through relays to avoid signal noise) and the black cable of harness RLC-VN02 to the ground.
- **Note:** If the 18-pin AMP socket of the head unit is already occupied, the vehicle probably has a factory rear-view camera or a factory TV tuner.
- In the case of a factory tuner, it must be uninstalled: disconnect the female 18pin AMP connector of the factory harness and disconnect all wires from the factory TV tuner.
- In case of a factory rear-view camera you have ordered/received the wrong product, call for support.

Connections to AV-source or after-market rear-view camera

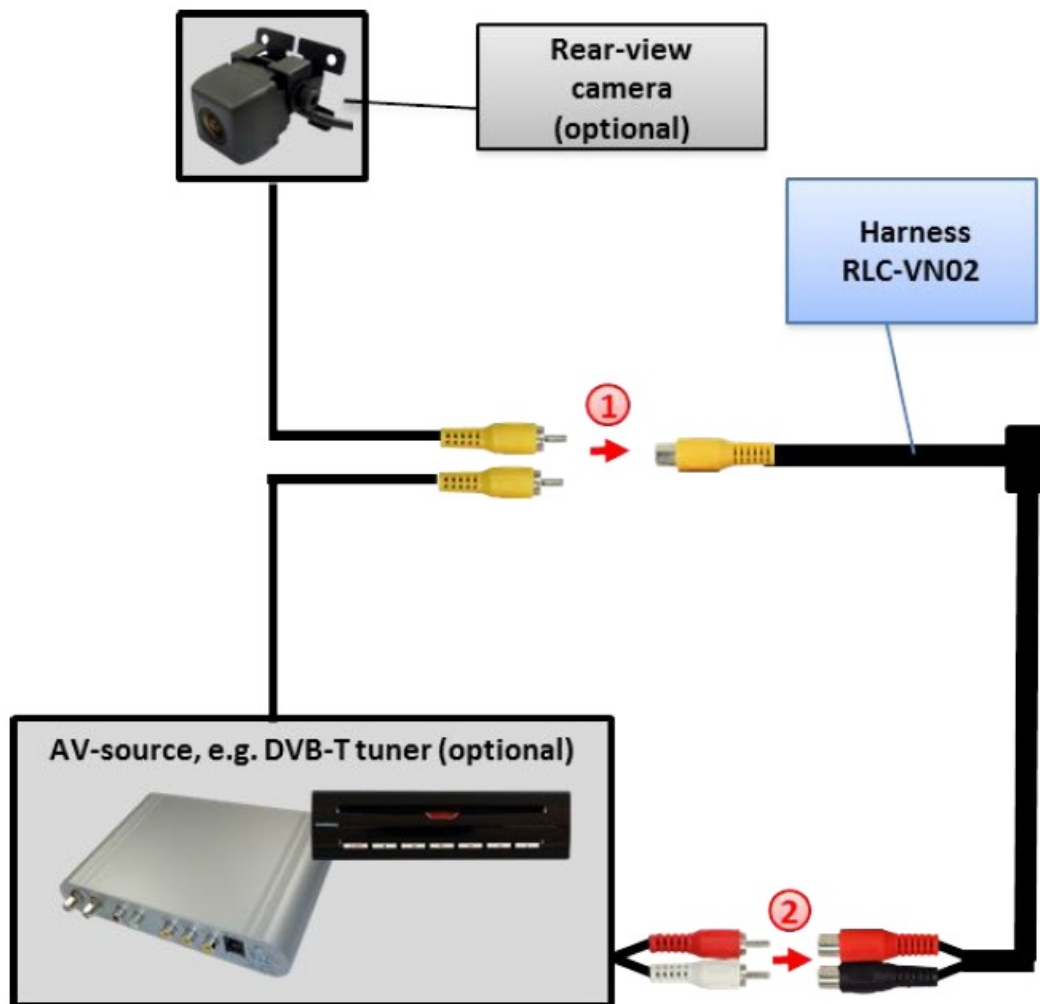

1. Connect the video RCA of the AV-source or the after-market rear-view camera to the female video RCA connector of harness RLC-VN02.
2. If connecting an AV source, connect the audio RCA of the AV source to the female audio RCA connector of harness RLC-VN02.

Note: The interface is initialized to PAL. Remove and isolate pin 15 of the 18-pin female AMP connector of harness RLC-VN02 if you want to connect a NTSC source.

Activation of the interface as a current AV source

CD-version Press AUDIO and select „AV“ (possibly switch the AV-source to „A+V“ before) DVD-version Press CD and select „AUX“

Specifications

- **Operation voltage** 10.5 – 14.8V DC
- **Stand-by power** drain 0mA
- **Operation power** drain 200mA
- **Power consumption** 2.8W ϵ \equiv 12V DC
- **Temperature range** -30°C to +80°C
- **Weight** 53g
- **Measurements (box only)** B x H x T 72 x 23 x 50mm

Technical Support

- Caraudio-Systems Vertriebs GmbH manufacturer/distribution In den Fuchslöchern 3 D-67240 Bobenheim-Roxheim email support@caraudio-systems.de
- **Legal disclaimer:** The mentioned company and trademarks, as well as product names/codes are registered trademarks ® of their corresponding legal owners.

Legal Information

- By law, watching moving pictures while driving is prohibited, the driver must not be distracted.
 - We do not accept any liability for material damage or personal injury resulting, directly or indirectly, from the installation or operation of this product.
 - This product should only be used while standing or to display fixed menus or rear-view-camera video when the vehicle is moving, for example, the MP3 menu for DVD upgrades.
 - Changes/updates of the vehicle's software can cause malfunctions in the interface.
 - We offer free software updates for our interfaces for one year after purchase.
 - To receive a free update, the interface must be sent in at its own cost.
 - Labor costs and other expenses involved with the software updates will not be refunded.
-

Documents / Resources

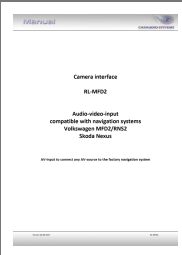
	<p>CARAUDIO-SYSTEMS RL-MFD2 Camera Interface [pdf] User Manual RL-MFD2 Camera Interface, RL-MFD2, Camera Interface, Interface</p>
---	---

References

- [User Manual](#)

Manuals+ Privacy Policy

This website is an independent publication and is neither affiliated with nor endorsed by any of the trademark owners. The "Bluetooth®" word mark and logos are registered trademarks owned by Bluetooth SIG, Inc. The "Wi-Fi®" word mark and logos are registered trademarks owned by the Wi-Fi Alliance. Any use of these marks on this website does not imply any affiliation with or endorsement.