



# CANYON Stylish Multimedia Wireless Keyboard Set SET-W4 User Guide

[Home](#) » [CANYON](#) » CANYON Stylish Multimedia Wireless Keyboard Set SET-W4 User Guide 



Stylish multimedia wireless  
keyboard set  
SET-W4

Quick Guide v 1.4

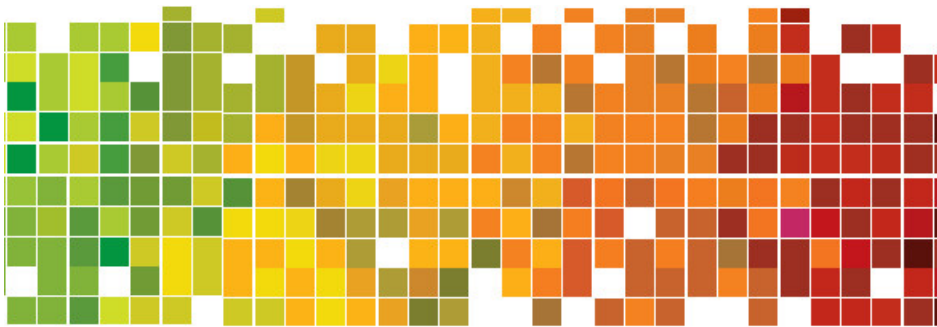

## Package Contents

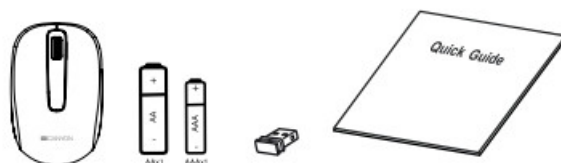

**Pic. 1**

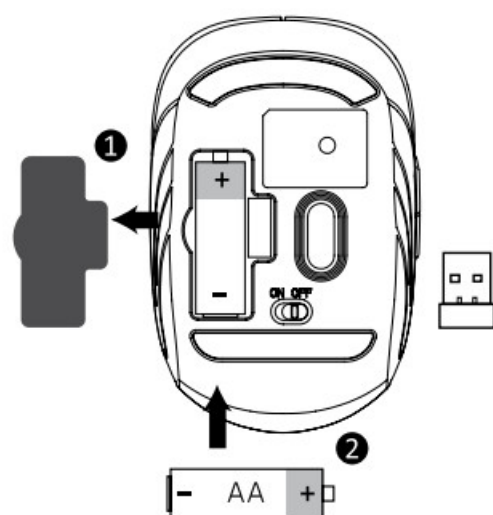

**Pic. 2**

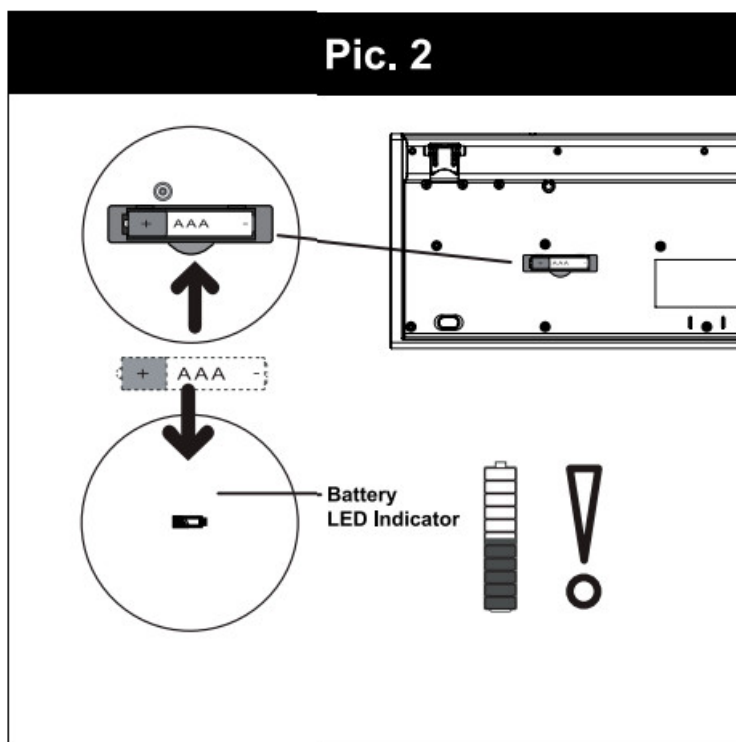

**Pic. 3**

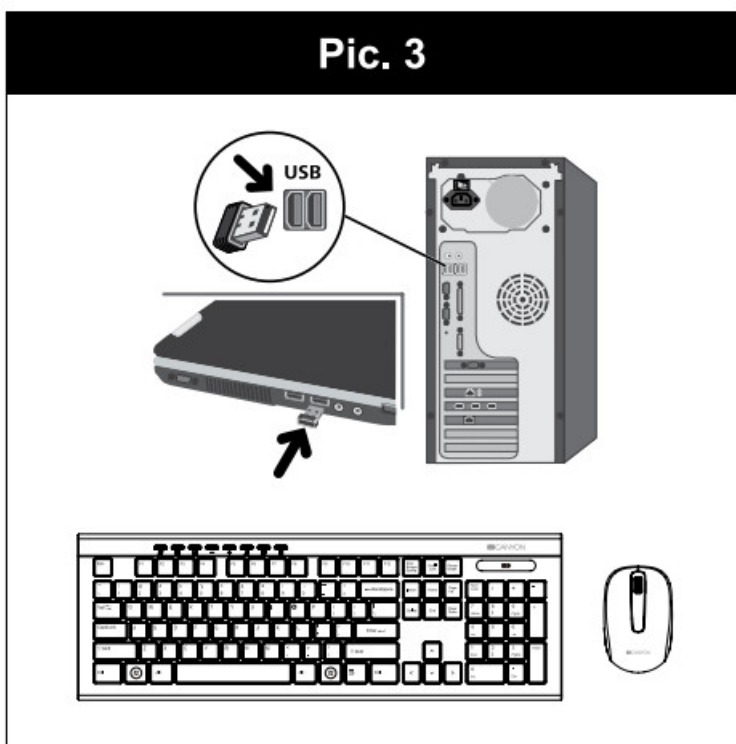

### **Warranty**

For detailed information regarding warranty terms, please refer to: <http://canyon.eu/warranty-terms/>

### **Features:**

#### **KEYBOARD**

**Connectivity:** Wireless 2,4 GHz

**Type of keycaps:** Chocolate Keycap Design, Membrane/Slim

**Number of keys:** 104/105 standard (depends by language) + 8 hot keys

**Compatible:** OS Windows/Mac OS

#### **MOUSE**

**Connectivity:** Wireless 2,4 GHz

**Pointing Device Technology:** Optical

**DPI:** 800/1200/1600 adjustable mouse

**Compatible OS** Windows/Mac OS

**Included Accessories:** one receiver for both devices, batteries

**Number of keys:**3

**User manual.** Wireless multimedia combo

Package contents	Connection
Keyboard Mouse USB receiver Batteries 1 pc – AA type, 1 pc – AAA type User manual	<ol style="list-style-type: none"><li>1. Open the battery compartment. Insert AA battery into the mouse. Led indicator will alert if the battery is low.</li><li>2. Open the battery compare requirement. Insert AAA battery into the keyboard. Led indicator will alert if the battery is low.</li><li>3. Remove the USB receiver. Connect USB receiver to computer, namely free USB port. Driver not required.</li><li>4. The DPI value can be changed by holding the left and right mouse buttons for 3 seconds.</li></ol>

## Contents

### [1 SAFETY](#)

### [INSTRUCTIONS](#)

### [2 Troubleshooting](#)

### [3 WARRANTY](#)

### [4 Documents / Resources](#)

#### [4.1 References](#)

### [5 Related Posts](#)

## SAFETY INSTRUCTIONS



Read carefully and follow all instructions before using this product.

1. Do not expose the mouse to excessive moisture, water or dust. Do not install in rooms with high humidity and dust level.
2. Do not expose the mouse to heat: do not place it close to heating appliances, and do not expose it to direct sun rays.
3. The product shall be connected to the power supply source of the type indicated in the operation manual only.
4. Never spray liquid detergents. Use only dry clothes for device cleaning.

## WARNING

It is forbidden to dismantle the device. Attempt to repair this device is not recommended and leads to cancellation of the warranty.

## Troubleshooting

Problem	Solution
1. The keyboard does not work properly	1. It is possible that one of the keys is “fused”. Keypad faults can be caused by a technological defect in the keyboard, as well as debris or water in the keyboard. It's not recommended to perform self-cleaning of the keyboard.
2. Keyboard doesn't work	1. Low battery power. To test, insert new batteries of the specified type. 2. Absence of signal from the transmitter installed in the USB port of the computer. Check the receiver, connecting it to another USB port. Remove the device from the system and install it again.

If the actions from the above list do not contribute to problem-solving, please contact the support team at Canyon:  
<http://canyon.eu/ask-your-question>

## WARRANTY

The warranty period starts from the day of the product purchase from Canyon authorized Seller. The date of purchase is the date specified on your sales receipt or on the waybill. During the warranty period, repair, replacement or refund for the purchase shall be performed at the discretion of Canyon. In order to obtain warranty service, the goods must be returned to the Seller at the place of purchase together with proof of purchase (receipt or bill of lading). 2 years warranty from the date of purchase by the consumer. The service life is 2 years. Additional information about the use and warranty is available at <https://canyon.eu/warranty-terms/>

**Manufacturer:** Asbisc Enterprises PLC, 43, Kolonakiou Street, Diamond Court 4103 Ayios Athanasios  
<http://canyon.eu>



[www.canyon.eu](http://www.canyon.eu)

## Documents / Resources

	<a href="#">CANYON Stylish Multimedia Wireless Keyboard Set SET-W4</a> [pdf] User Guide CANYON, Stylish, Multimedia, Wireless, Keyboard, SET-W4
--	--

## References

- [Y  \$\text{D}^{\circ}\text{D}^{\circ}\text{N}\text{€}\text{D}^{\circ}\text{D}^{\frac{1}{2}}\text{N}+\text{D} \text{D}^{\frac{3}{4}}\text{D}^{\frac{1}{2}}\text{D}^{\frac{1}{2}}\text{D} \text{NfN}\text{D}\text{»}\text{D}^{\frac{3}{4}}\text{D}^2\text{D} \text{N}\$  - Canyon](#)
- [Y Canyon](#)
- [Y Canyon](#)
- [Y Canyon](#)
- [Y Canyon](#)
- [Y Certificates](#)
- [Y Limited warranty statement - Canyon](#)
- [Y Canyon](#)
- [Y Garantie produse - Canyon](#)
- [Y Canyon](#)
- [Y Canyon](#)
- [Y Podmienky záruky - Canyon](#)
- [Y A KorlÄjtozott JÄ³tÄjllÄjs - Canyon](#)
- [Y Canyon](#)
- [Y certificates](#)
- [Y  \$\text{D}\_i\text{D}\_\mu\text{N}\text{€}\text{N} \text{D} \text{N} \text{D} \text{D}^{\circ}\text{N} \text{D}\$](#)
- [Y Limited warranty statement - Canyon](#)
- [Y Canyon](#)
- [Y Canyon](#)

