

CANOPIA Curtain and Netting Set for Gazebos



CANOPIA Curtain and Netting Set for Gazebos Instruction Manual

[Home](#) » [CANOPIA](#) » CANOPIA Curtain and Netting Set for Gazebos Instruction Manual 

Contents

- [1 CANOPIA Curtain and Netting Set for Gazebos](#)
- [2 Product Information](#)
- [3 Product Usage Instructions](#)
- [4 INFORMATION](#)
- [5 BEFORE ASSEMBLY](#)
- [6 ASSEMBLY](#)
- [7 2 YEAR LIMITED WARRANTY](#)
- [8 Documents / Resources](#)
 - [8.1 References](#)
- [9 Related Posts](#)



CANOPIA Curtain and Netting Set for Gazebos



Product Information

Specifications:

- Compatible with Palram – Canopia's Palermo™ 10×10 / 3×3 | 11×11 / 3.5×3.5 | 12×12 / 3.6×3.6 Milano™ 10×10 / 3×3 Martinique™ 10×12 / 3×3.6
- Includes curtain and netting set for 10'-12' / 3-3.6m gazebos

Product Usage Instructions

Before Assembly:

1. This curtain/netting set includes 4 parts that cover the entire gazebo.
2. Read the instructions carefully before starting assembly.
3. Some steps may require assistance from a second person.

Important Assembly Steps:

When encountering the information icon during assembly, refer to the relevant assembly step for additional comments.

- **Step 1:**

Ensure you have all parts of the curtain/netting set ready.

- **Step 2:**

If part #7829 is not inserted during gazebo assembly, refer back to the Palermo/Milano/Martinique Garden Gazebo Assembly Instructions.

- **Step 3:**

Adjust the curtain/netting to the appropriate size based on the gazebo model.

- **Step 4:**

Optional: Thread a curtain weight chain at the bottom for added stability

FAQ

- **Q: What should I do if I encounter any issues during assembly?**

A: If you face any difficulties during assembly, please contact our customer support at canopia.shop/support for assistance.

HOW TO ASSEMBLE

- CURTAIN & NETTING SET
- FOR 10'-12' / 3-3.6m GAZEBOS
- Compatible with Palram – Canopia's
- Palermo™ 10×10 / 3×3 | 11×11 / 3.5×3.5 | 12×12 / 3.6×3.6 Milano™ 10×10 / 3×3
- Martinique™ 10×12 / 3×3.6

IMPORTANT!

Please read these instructions carefully before starting assembly. Keep these instructions in a safe place for future reference.

www.canopia.com



Curtain Set



Netting Set



HAVE A CONCERN ? WE CAN HELP.

Before returning your purchase:

- **You didn't find what you were looking for?**
 - We can help at canopia.shop/support
- **Still can't find what you are looking for?**
 - Please see next page for local customer care.



UK • IE	FR • BE • IT • NL • PT • ES	WE ARE HERE TO HELP	CR • SL
01302-380775	+33-169-791-094		0599-37-057 info@ms-viscom.com
DE • AT • LUX • LI CH	US		DK
+49-180-522-8778	877-627-8476		<ul style="list-style-type: none"> • 07-575 42 70 • post@nshnordic.com
IL	CA		CH • HU • SK
04-848-6800	905-5646007	canopia.com/contact-us 	<ul style="list-style-type: none"> • 0493-523-523 • servis@garland.cz
AUS	AUS – Greenhouses only		PL
1800-955-855	03-9544-6-999		<ul style="list-style-type: none"> • Infolines: 801-011-929 • 22-349-93-36 • kontakt@ogrodosfera.pl
ZA	NZ		FI
011-397-7771	0800 800 880		<ul style="list-style-type: none"> • Neuvonta: 09-6866720 Tuki • Varaosat: 050-3715350 • www.horisontenterprises.fi • tuki@horisontenterprises.fi
SZ	GLOBAL CONTACT (Rest of World)		CY
062-287-33-77	+972-4-848-6816		0224-971-13 alpaco@alpacodmica.com www.alpacodmica.com

INFORMATION

SAFETY ADVICE

- Dispose of all plastic bags safely – keep them away from children's reach.
- Keep children away from the assembly area.
- When using a stepladder or power tools, make sure that you are following the manufacturer's safety advice.

IMPORTANT RECOMMENDATIONS

- These instructions are compatible with Palram Canopia's
- Palermo 10×10 / 3×3 | 11×11 / 3.5×3.5 | 12×12 / 3.6×3.6 | Milano 10×10 / 3×3 | Martinique 10×12 / 3×3.6.
- Please carry out the steps in the order set out in these instructions.
- Keep these instructions in a safe place for future reference.

BEFORE ASSEMBLY

1. This curtain / netting set includes 4 parts that cover the entire gazebo.
2. Please read these instructions carefully before you start to assemble this product.
3. Some of the steps may require the assistance of a second person.

IMPORTANT ASSEMBLY STEPS

When encountering this information icon during assembly, please refer to the relevant assembly step for important additional comments.

- In order to assemble the curtain / netting you will need to use part #7829. This part is supplied with the gazebo.
- If the part was not inserted while the gazebo was assembled please refer back to the Palermo / Milano / Martinique Garden Gazebo Assembly Instructions.
- (You can download the assembly instructions from our website:(www.canopia.com)
- **Step 3:**
(Palermo 10×10 / 3×3 | Milano 10×10 / 3×3) Adjust the curtain / netting to the appropriate size.
- **Step 4:**
(Martinique 10×12 / 3×3.6) Adjust the curtain / netting to the appropriate size.

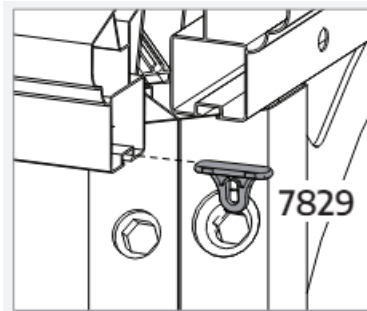

- When closed, the curtain / netting has to be stretched in order to properly maintain them.
- When opened, the curtain / netting should be tied to the poles with the built-in straps.

Optional:

It is possible to thread a curtain weight chain at the bottom.

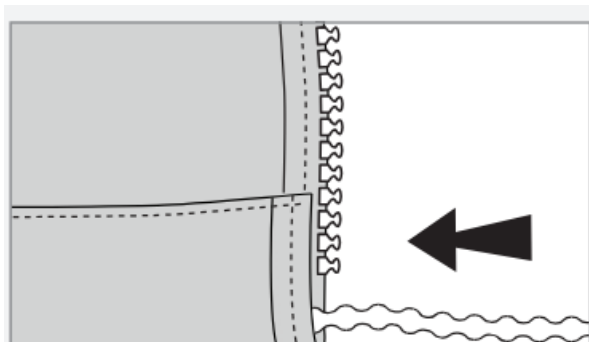

ASSEMBLY

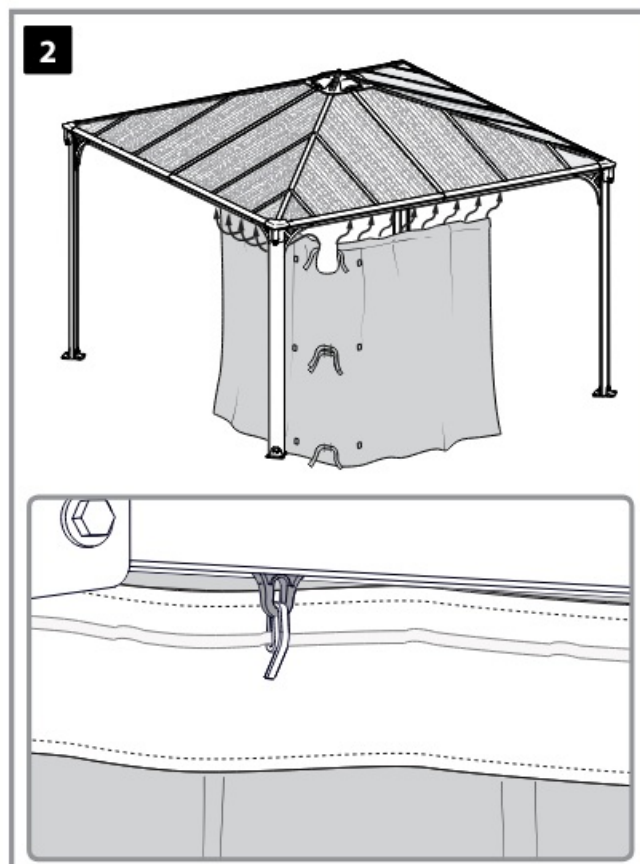
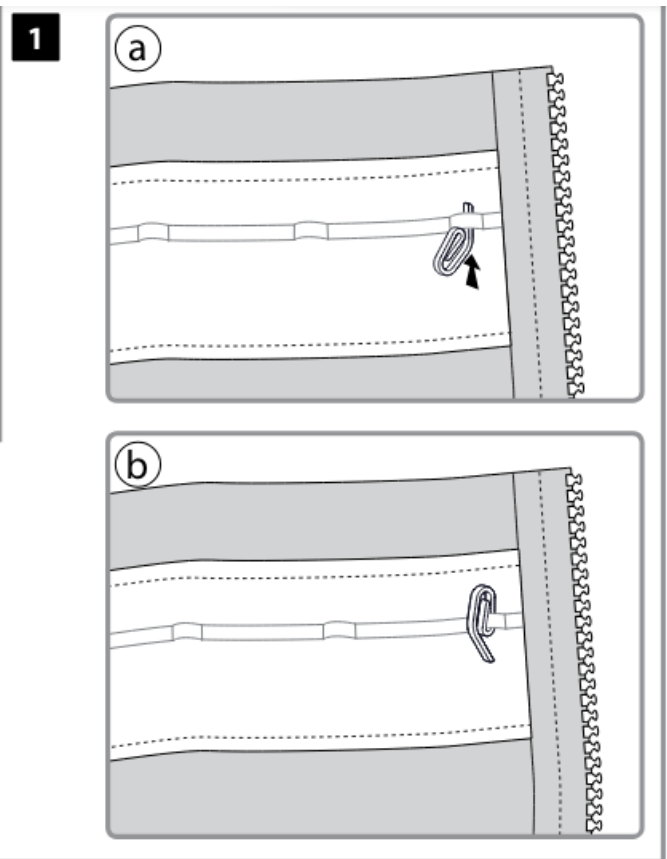
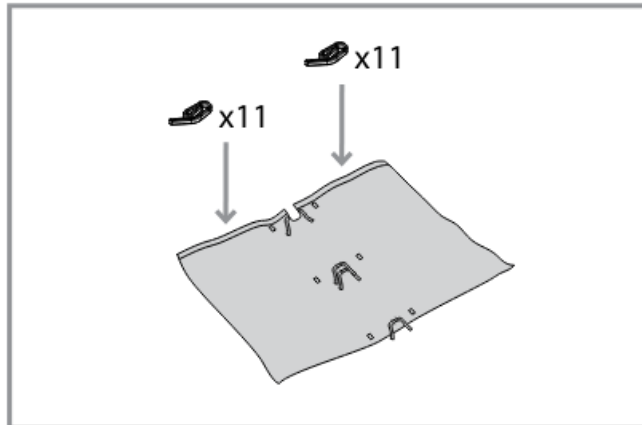
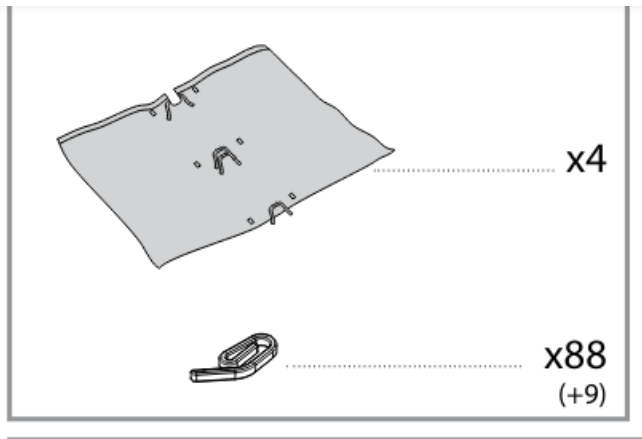

3

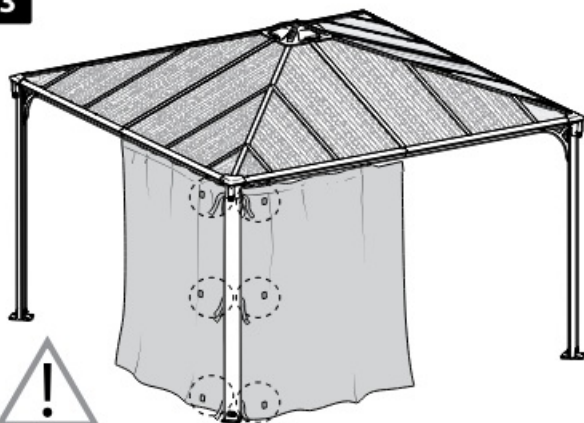

Milano 3000
Palermo 3000

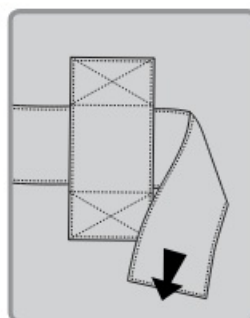
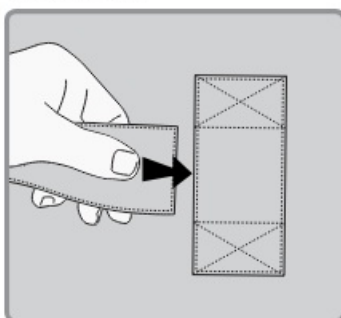

4



Martinique 3600

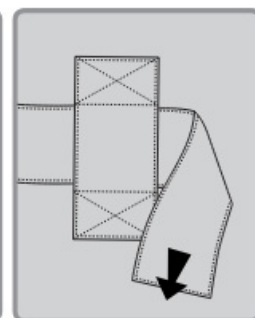
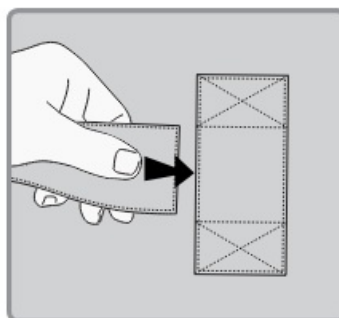

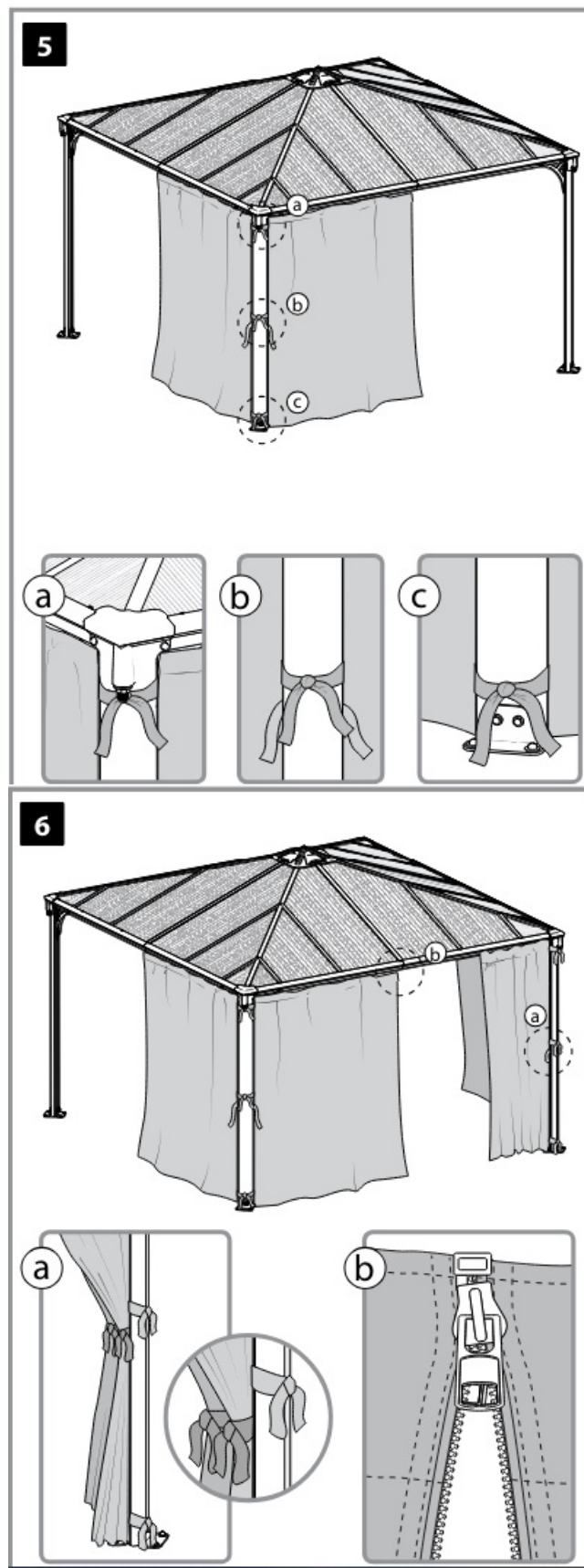

2 YEAR LIMITED WARRANTY

- PALRAM – CANOPIA
- 2 YEAR LIMITED WARRANTY
- Palram Canopia Ltd. (**Company number:** 512106824) whose registered office is at Teradion Industrial Park, M.P Misgav 2017400, Israel ("Canopia") warrants that the product will be free from defects in material or



workmanship for a period of 2 years from the original date of purchase

- This warranty is valid only if the product is installed, handled, cleaned, and maintained in accordance with Canopia's written specifications.
 - **This warranty does not cover defects resulting from normal wear and tear including, but not limited to:** damage caused by use of force, incorrect handling, inappropriate use, negligence, accidents, impact from foreign objects, vandalism, pollutants, alteration, painting, damage resulting from cleaning with incompatible detergents or minor deviations of the product.
 - This warranty does not apply to damage resulting from "acts of Nature", which includes but is not limited to hail, storm, tornado, hurricane, blizzard, flood, or fire.
-

Documents / Resources

	CANOPIA Curtain and Netting Set for Gazebos [pdf] Instruction Manual Curtain and Netting Set for Gazebos, Netting Set for Gazebos, Set for Gazebos, Gazebos
---	--

References

-  [Canopia Australia - Celebrate Outdoor Living](#)
-  [Canopia United Kingdom - Celebrate Outdoor Living](#)
- [User Manual](#)

Manuals+, Privacy Policy

This website is an independent publication and is neither affiliated with nor endorsed by any of the trademark owners. The "Bluetooth®" word mark and logos are registered trademarks owned by Bluetooth SIG, Inc. The "Wi-Fi®" word mark and logos are registered trademarks owned by the Wi-Fi Alliance. Any use of these marks on this website does not imply any affiliation with or endorsement.