



Canon TM Series imagePROGRAF Multi Large Format Printers Installation Guide

[Home](#) » [Canon](#) » Canon TM Series imagePROGRAF Multi Large Format Printers Installation Guide 

Canon

imagePROGRAF
TM-355/TM-350/TM-340
TM-255/TM-250/TM-240

Contents

- 1 TM Series imagePROGRAF Multi Large Format Printers
- 2 Confirming the Installation Space
- 3 Confirming the Accessories
- 4 Removing the Packing Material
- 5 Assembling the Printer Stand
- 6 Installing the Printer
- 7 Connecting to a PC or Smartphone
- 8 Performing Color Calibration
- 9 Safety Precautions
- 10 Handling Cautions
- 11 Ink Tanks
- 12 Documents / Resources
 - 12.1 References

TM Series imagePROGRAF Multi Large Format Printers

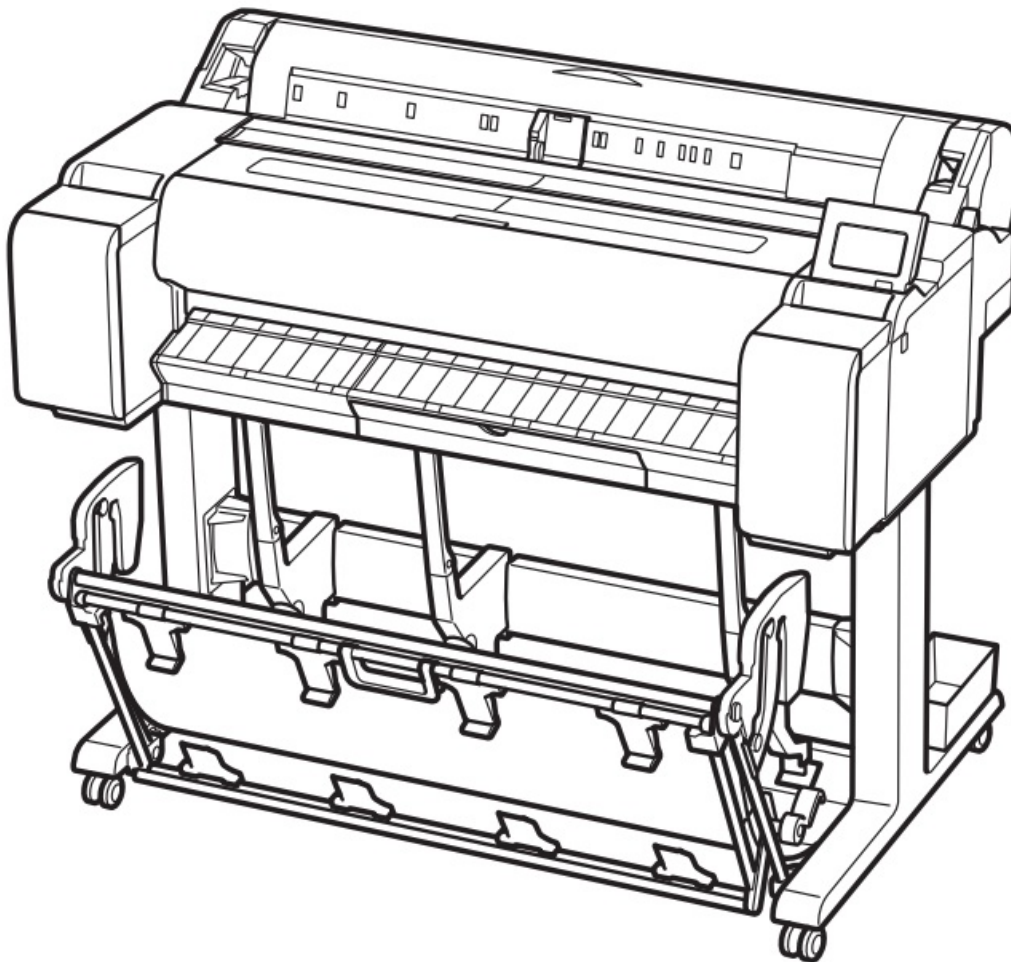

Introductory Information

Read this manual before attempting to operate the printer. Keep this manual for future reference. The illustrations in this manual are using the TM-355 as an example for explanation. Note that your printer may look different from these illustrations in some cases.

- When using an MFP model, refer also to the scanner assembly guide.
- Regardless of whether a scanner is attached, the time needed for setup is roughly 40 minutes.

Confirming the Installation Space

When installing the printer, it is recommended that you secure the following space around the printer.



Important

- The printer stand may not be included with your model.
- The space required in front of the printer differs depending on how the basket supplied with the printer stand is used.

Required space (W x D x H)

When using SD-35: 66.4 x 66.9 x 65.6 inches (1,685 x 1,698 x 1,664 mm)

When using SD-34: 66.4 x 57.8 x 65.6 inches (1,685 x 1,468 x 1,664 mm)

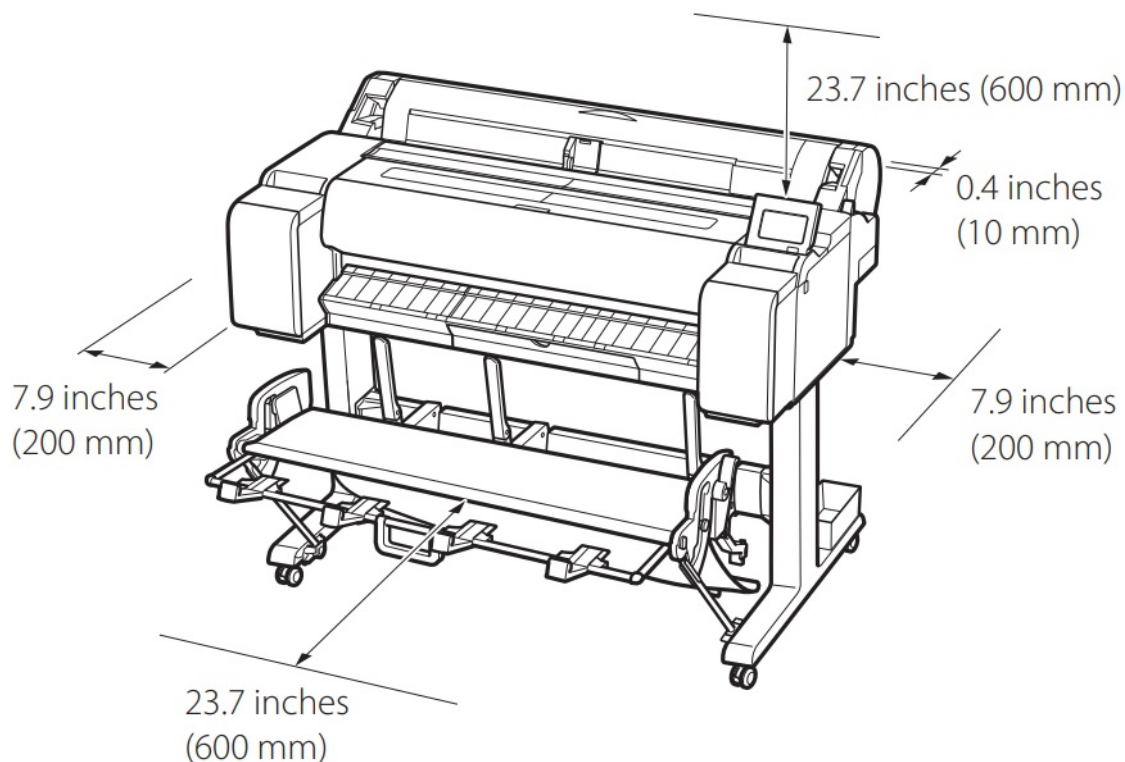

TM-340

Required space (W x D x H)

When using SD-33: 66.4 x 57.8 x 65.6 inches (1,685 x 1,468 x 1,664 mm)

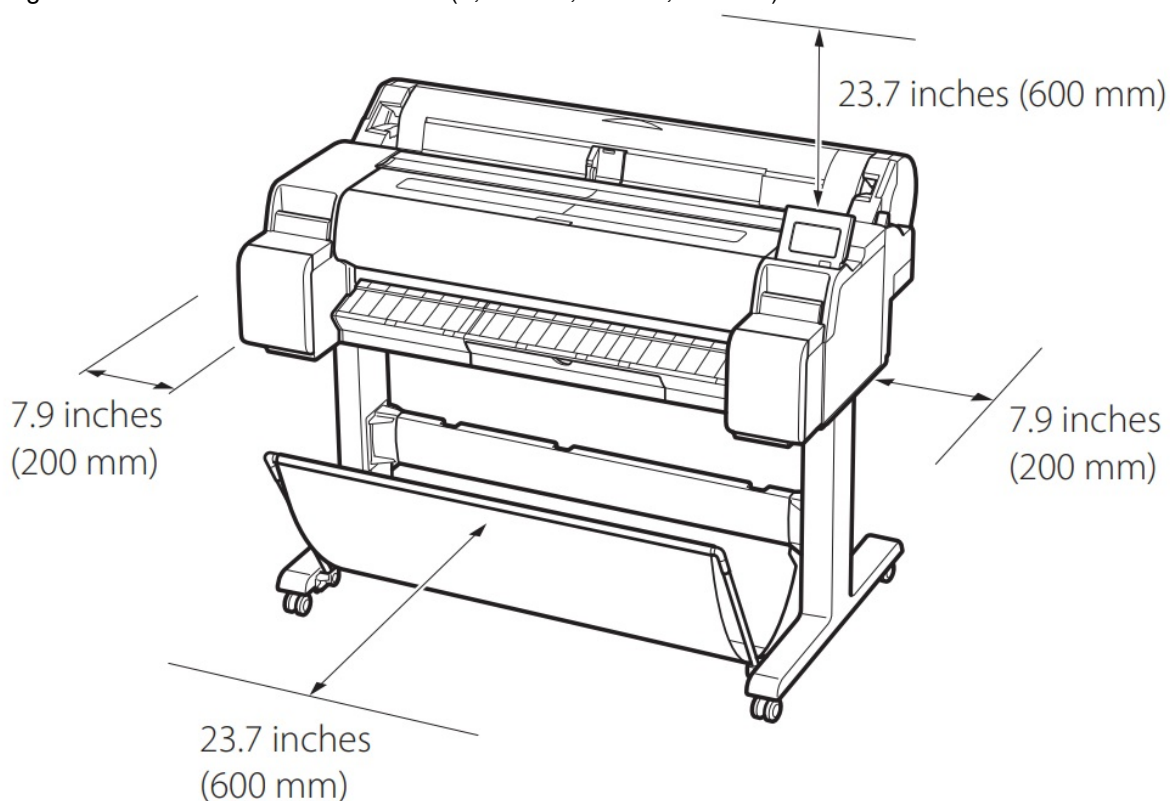

TM-255/TM-250

Required space (W x D x H)

When using SD-26: 54.3 x 66.9 x 65.6 inches (1,378 x 1,698 x 1,664 mm)

When using SD-25: 54.3 x 57.8 x 65.6 inches (1,378 x 1,468 x 1,664 mm)

No stand: 54.3 x 53.5 x 41.1 inches (1,378 x 1,358 x 1,043 mm)

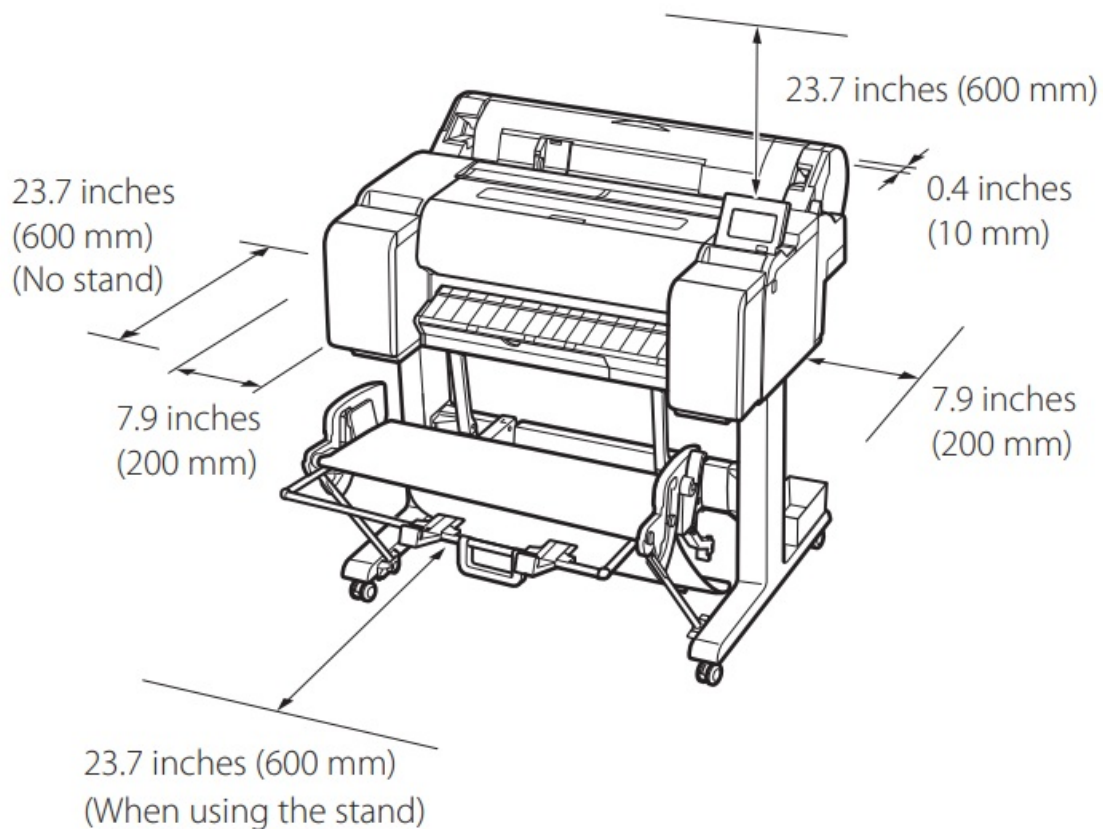

TM-240

Required space (W x D x H)

When using SD-24: 54.3 x 57.8 x 65.6 inches (1,378 x 1,468 x 1,664 mm)

No stand: 54.3 x 53.1 x 41.1 inches (1,378 x 1,348 x 1,043 mm)

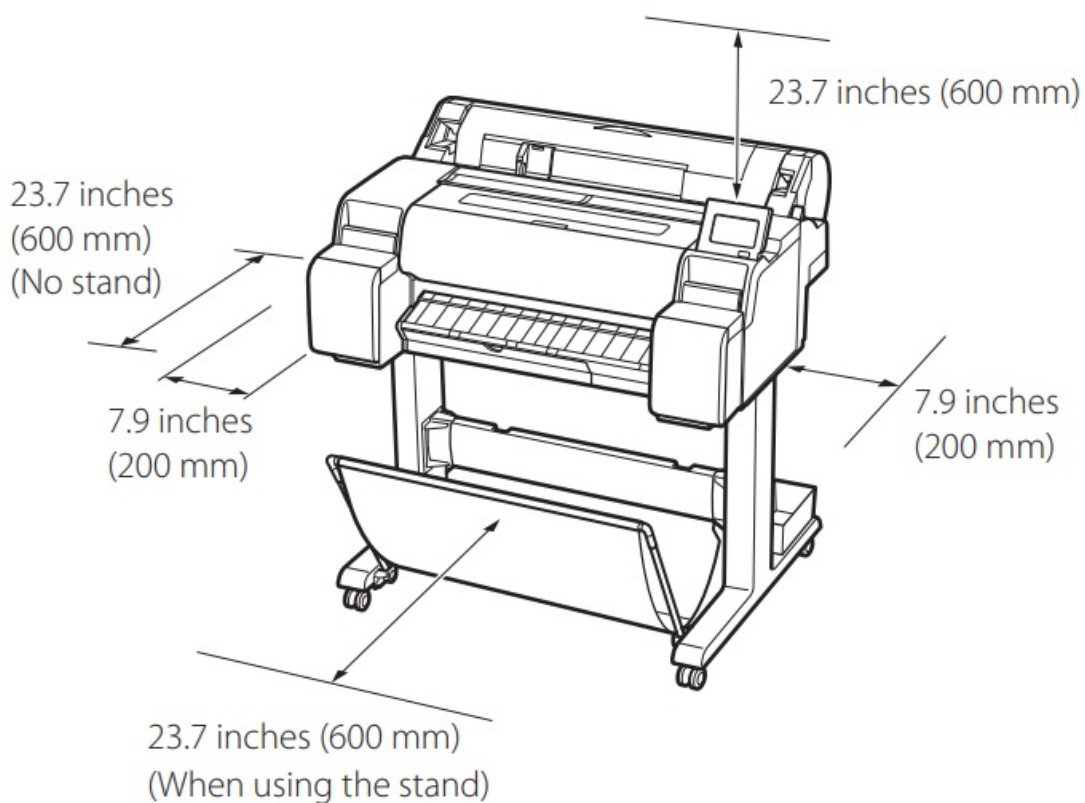

Confirming the Accessories

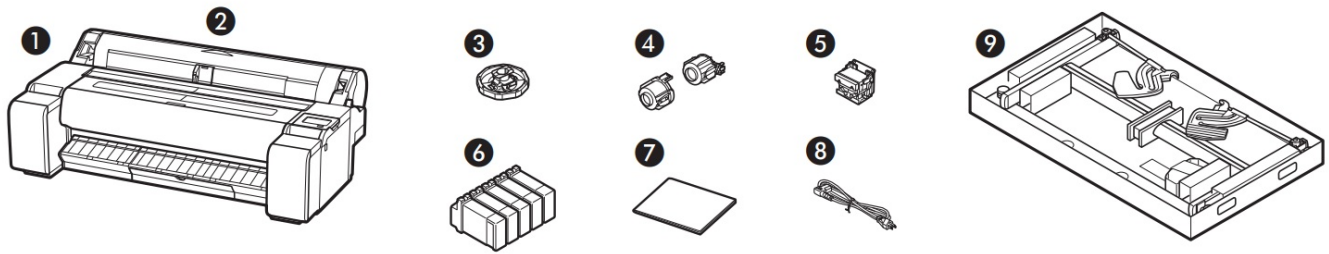

1. Printer
2. Roll holder: Already mounted on printer
3. Holder stopper (*1)
4. 3-inch paper core attachment (R, L) (*2)
5. Print head
6. Starter ink tanks (C, M, Y, MBK, BK) (*3)
7. Installation Guide (this document)
8. Power cord
9. Stand set (*4)

*1 The holder stopper is used when loading roll paper. For details, refer to the Online Manual.

*2 Only included with TM-355, TM-350, TM-255, and TM-250.

*3 The MBK ink tank included with TM-340 and TM-240 cannot be used with models other than the model you purchased.

*4 Stand set

Only included as standard in some regions.

It may be packaged in a separate box depending on the region where you purchased the printer.

Manuals Included with the Printer

Installation Guide (this document)

Describes how to setup the printer.

Printer Stand Setup Guide

Describes how to assemble the stand.

This item might not be included depending on your model.

Online Manual

This manual describes advanced usage of the printer such as paper saving tips, how to print a poster and banner with the supplied software, and print quality adjusting method, in addition to the basic instructions for printing on roll paper or cut sheet. To view the Online Manual, refer to "Displaying the Online Manual" (P.21).

Removing the Packing Material

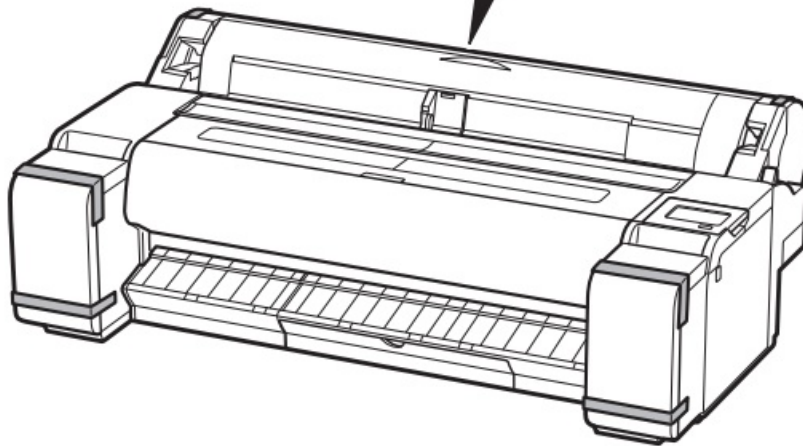
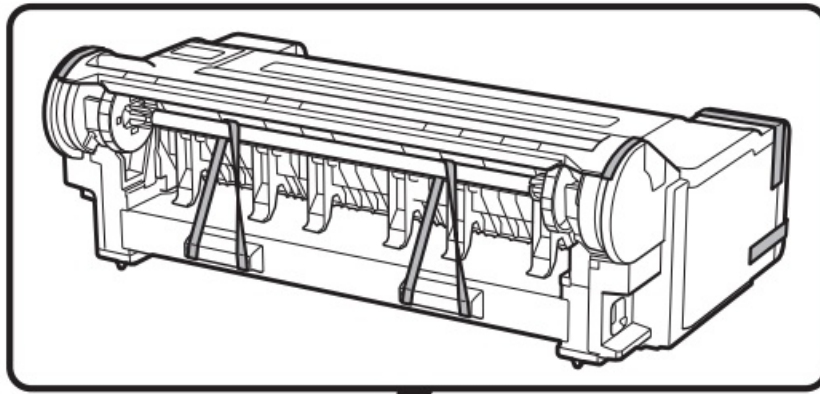

Remove and discard all the packing material, orange tape, and tape affixed to the roll holder.

Assembling the Printer Stand

SD-35/SD-26

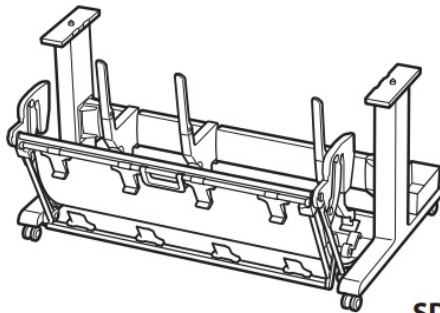

SD-34/SD-25

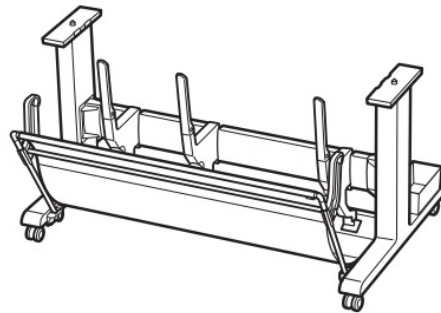

SD-33/SD-24

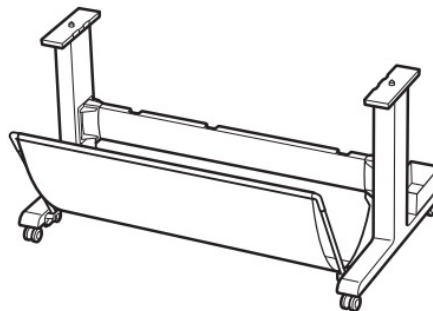

If you will use the printer stand, assemble the stand now by referring to the Printer Stand Setup Guide (separate manual).

Otherwise, proceed to the next step.

Installing the Printer

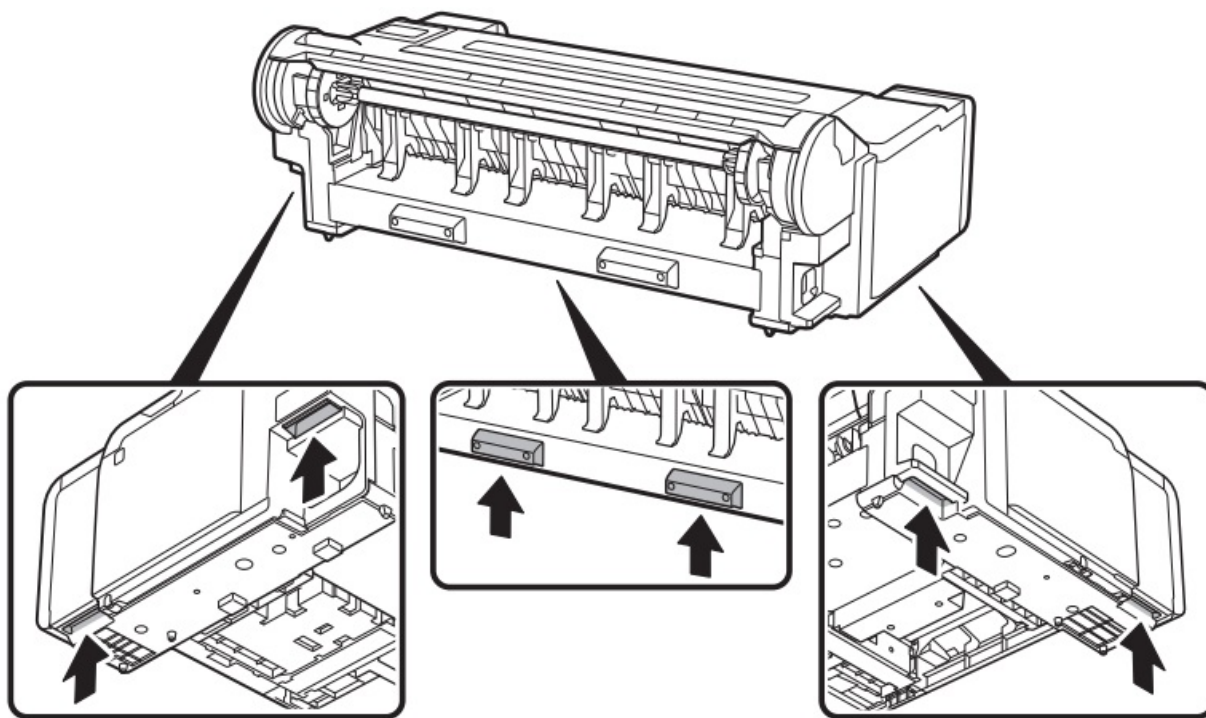

Carrying grips

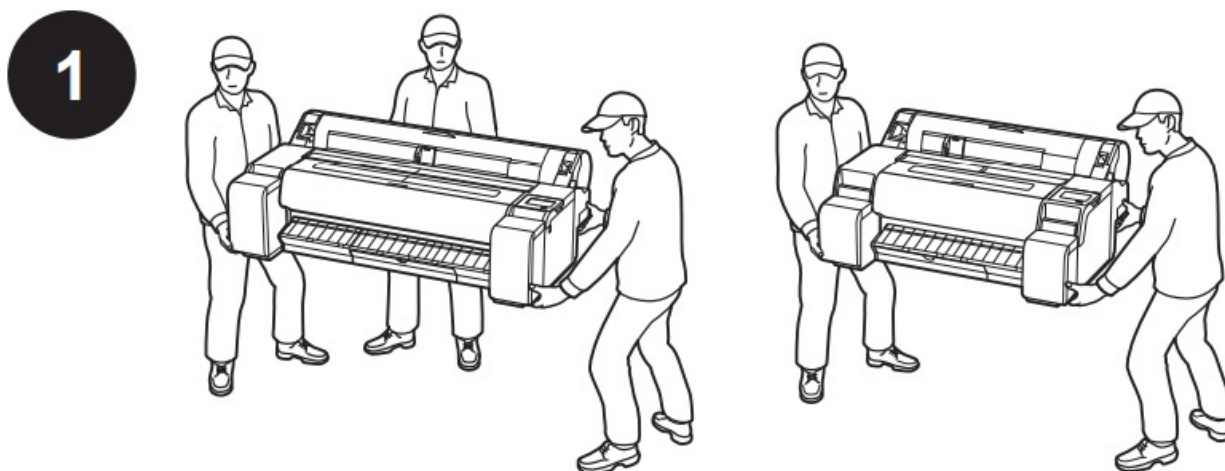

Use the following number of people to move the printer.

- TM-355, TM-350, TM-340, TM-255, TM-250: 3 people or more
- TM-240: 2 people or more

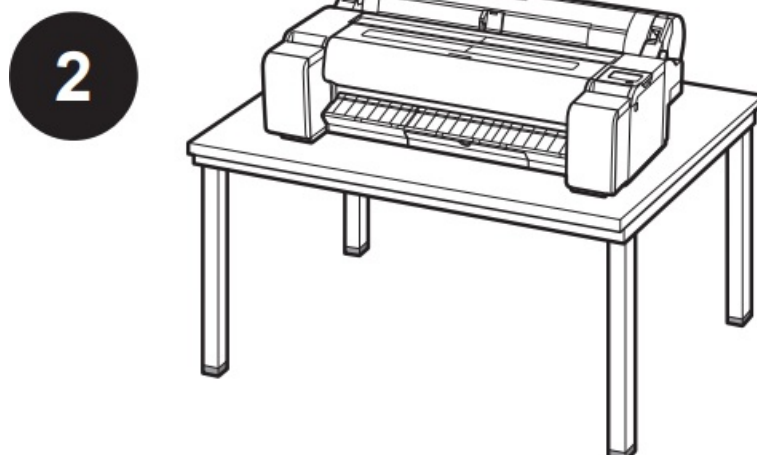

Place the printer on a flat, stable location.

Turning On the Printer



Important

When using an MFP model, the power cable included with the scanner is also used. For details, refer to the scanner assembly guide.

1

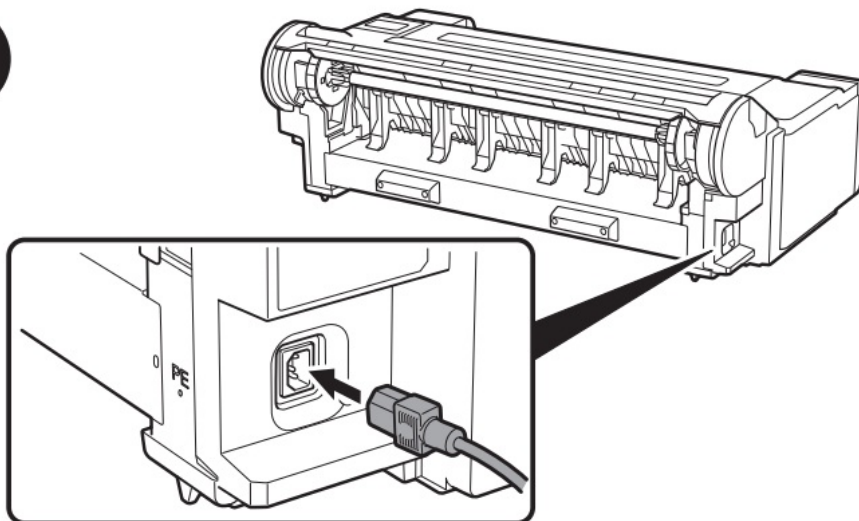

Insert the power cord into the power connector on the side of the printer.

2

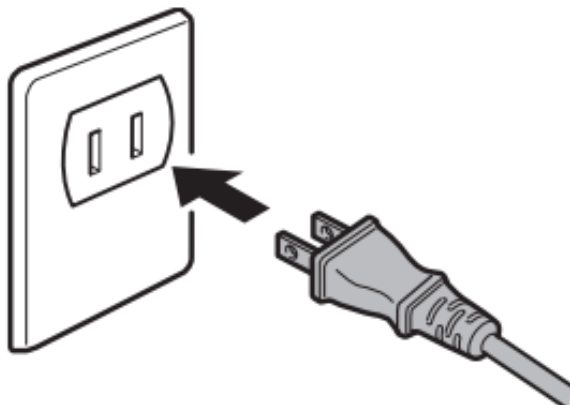

Connect the power cord to the power outlet.

3

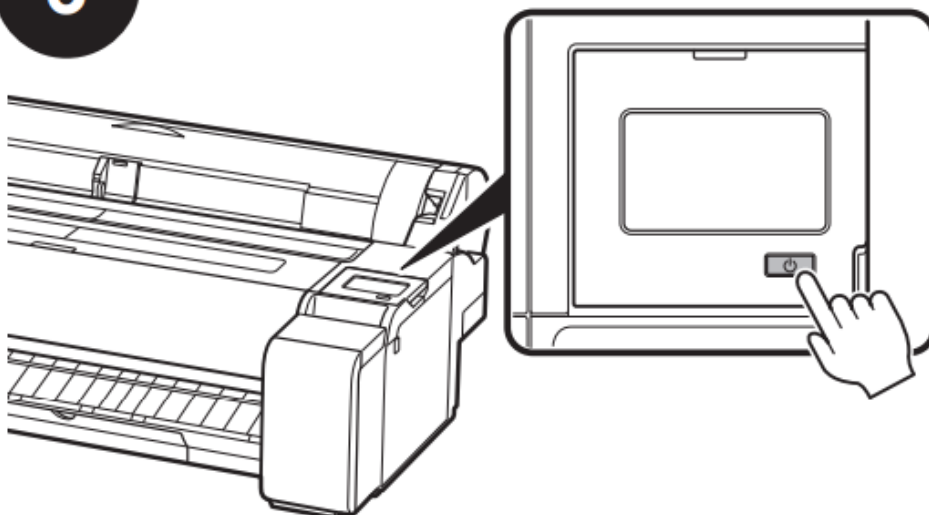

4. Continue setup by following the instructions on the operation panel in the following order.

1. Install ink tanks.
2. Install print head.
3. Select connection method.



Important

When using an MFP model, after selecting the connection method, refer to the scanner assembly guide and attach the scanner.

When the home screen appears on the printer after finishing the procedure above, proceed to “Connecting to a PC or Smartphone” (P.20).

Connecting to a PC or Smartphone

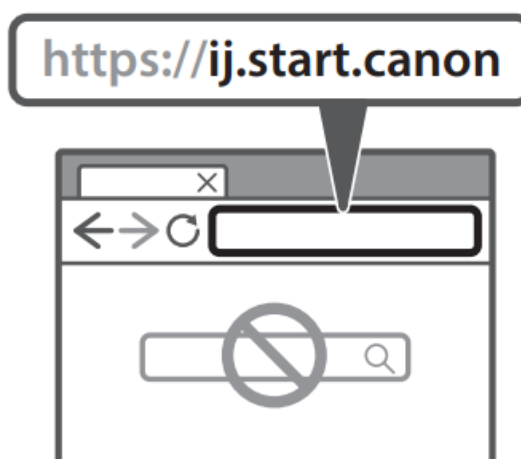

<https://ij.start.canon>

Open your web browser and access the Canon website.



Enter the model name and click Go.

Continue the operations by following the instructions on the screen.

Performing Color Calibration

It is recommended that you perform color calibration after you have finished setting up the printer and software. Color calibration compensates for variations in color tone due to differences between individual printers and changes over time.

Performing color calibration

From the home screen, select  (Setup), Maintenance, Color calibration, and then Auto adjust.

- Color calibration takes around 10 minutes.

- When performing color calibration, use paper that supports color calibration. For details, refer to “Paper Information List” in the Online Manual.
- It is convenient to use the color calibration reminder setting (Calibration guide setting). For details, refer to “Performing Color Calibration” in the Online Manual.

Sending Information To Canon

To provide services related to printer, and to develop and market products and services that better meet customer needs, Canon requests that information such as that below, related to your Canon product, be sent to Canon (if you are using your Canon product in China, to the legally approved research company) through the internet.

Information related to printer/scanner/information devices

- Basic information such as the printer ID number, installation date and time, country settings, etc.
- Usage history such as the type of ink installed, ink usage information, the number of sheets printed, scanning frequency, and maintenance information, etc.
- Paper use information, printing environment/conditions, scan job setting, and questionnaire results
- Basic device information such as the model name, OS version, language, and display setting information, etc.
- Version information and usage history of device driver and application software

* Some of the above information may not be sent depending on your model and/or application software.

* The sent information may be delivered to Canon’s affiliated companies.

* The internet connection fee shall be borne by each customer.

If your Canon product is shared for use, the above information recorded in the shared product will be sent. If you are to agree, please convey this fact to the users who share the product and obtain their agreement as well beforehand.

If you agree to the above, choose [Agree]. Otherwise, choose [Do not agree].

This process will stop information related to your Canon product from being sent through the internet to Canon. If you use services such as PIXMA Cloud Link that require information about your Canon product, you will no longer be able to use these services. Registration with these services may also be canceled as a result of the process. Before you stop information from being sent, please confirm whether you wish to continue using such services.

If you agreed sending information by Application Software or PC, you should also change the settings of them.

Trademarks

QR Code is a trademark of DENSO WAVE INCORPORATED in Japan and in other countries.

Displaying the Online Manual

The Online Manual describes how to use the printer. It can be accessed from the Canon website as shown below.

1. Access the Canon website by either of the following methods.

- Enter the URL.

<https://ij.start.canon/top>

Select the model number of the printer you are using.

- Scan the QR code.



https://rs.cigwgs.net/rd2.cgi?FNC=GSQB_CNT&DEV=TM-355&CTN=CN%2FTop.html

2. Select  Read Online Manual.

- Perform the remaining operations by following the instructions on the screen to display the Online Manual.

Safety Precautions

Follow the items below to use the printer safely. Furthermore, do not perform any actions that are not described in the instruction manual (this document and the Online Manual) of the product. This may cause unexpected accidents such as fire or electrical shock.

Symbols



Warning

Instructions that, if ignored, could result in death, serious personal injury, or property damage caused by incorrect operation of the equipment are provided. These must be observed for safe operation.



Caution

Instructions that, if ignored, could result in personal injury or property damage caused by incorrect operation of the equipment are provided. These must be observed for safe operation.



Warning

Product contains button/coin cell battery

Button/coin cell batteries are hazardous and must be kept out of reach of children at all times, whether new or used. These batteries can cause severe or fatal injuries in 2 hours or less if swallowed or placed inside any part of the body. If it is suspected a button/coin cell battery has been swallowed or placed inside any part of the body, seek medical attention immediately.

For people who are using a cardiac pacemaker

This product generates a low-level magnetic field. If you experience discomfort while working around this product, leave the area and consult a doctor.

Turn off the power immediately in the following circumstances.

If you continue to use the printer in the following cases, it may cause fires or electrical shock. Immediately press the power button to turn off the printer, disconnect the power plug from the outlet, and make a request for repairs.

- If any foreign matter (metal fragments, liquids, etc.) gets inside the printer
- If the printer emits smoke, abnormal odors, or abnormal noises
- If the power cord or any of the cables become hot, corroded, bent, frayed, or damaged

Follow the items below as there is a risk of fire and electrical shock.

- Do not set up the product in any location exposed to alcohol, thinner, or other flammable liquids.
- Do not disassemble or modify the product.
- Use the cables that are included with the printer. Do not use the cables included with the printer with other devices.
- Do not use outside of the designated power supply voltage and frequency.
- Insert the power plug securely and completely into the power outlet.
- Never handle the power plug with wet hands.
- Do not damage, modify, pull, bundle, join, or forcefully bend the power cord or any cables.
- Never place a heavy object on the power cord or any cables.
- Do not insert multiple power plugs into the same outlet.
- Do not connect multiple extension cords.
- If there is lightning nearby, disconnect the power plug from the outlet and do not use the product.
- When cleaning, always disconnect the cables and power plug, and do not use highly flammable sprays or liquids such as alcohol or thinner.

- Once per month, disconnect the power plug and power cord from the outlet, and check that dust has not accumulated, and that there are no abnormalities such as heat generation, rust, bending, chafing, or cracking.

Caution

- Never insert your hand into the printer while it is printing.
- Never touch the electrical contacts of the print head by hand immediately after printing.
- The following symbol is displayed around the movable parts of the printer. Take care to avoid touching them with your hand or inserting your finger. Note that this symbol may not appear on your model.

Moving Parts

Keep body parts away from moving parts.
Keep body parts out of the motion path.

- Always store consumables out of the reach of small children.
- If a child licks or ingests ink accidentally, wash out their mouth or make them drink one or two cups of water, and immediately seek medical attention. If ink accidentally gets in your eyes, immediately rinse with water, and immediately seek medical attention.
- If ink gets on your skin, immediately clean it off with soap and water. If irritation persists, immediately seek medical attention.
- If ink becomes adhered to your clothes or anything you are carrying, you might not be able to wash it out.
- Do not leave in a location that gets hot, such as near a fire, near a heater, or in a vehicle. The container may deform, causing the ink to spill, or the ink quality may become degraded.

Moving the printer

Have the following number of people grasp the carrying grips on the printer. The weight may cause pain such as back pain.

TM-355 (Approx. 110 lb (50 kg))	3 people or more
TM-350 (Approx. 110 lb (50 kg))	3 people or more
TM-255 (Approx. 93 lb (42 kg))	3 people or more
TM-250 (Approx. 93 lb (42 kg))	3 people or more
TM-340 (Approx. 106 lb (48 kg))	3 people or more
TM-240 (Approx. 88 lb (40 kg))	2 people or more

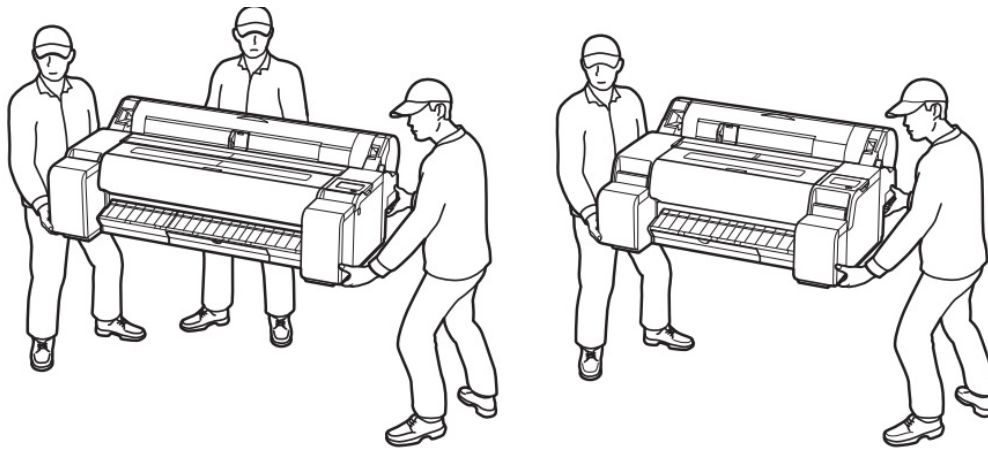

Printer stand

If a stand is included with the printer, please use that stand.

If you are purchasing an optional printer stand, please observe the following caution.

When using a printer stand with the Canon TM-255/TM-250/TM-240 printer, follow the instruction manual to securely attach the printer to the stand. Furthermore, always use the following combinations.

For Canon Printer TM-255, use Canon Printer Stand SD-26/SD-25.

For Canon Printer TM-250, use Canon Printer Stand SD-26/SD-25.

For Canon Printer TM-240, use Canon Printer Stand SD-24.

Using a different combination of printer and stand than shown above, using a printer stand not listed above, or not attaching the printer securely to the printer stand may be unstable and may result in injury.

Handling Cautions

Power supply

- Keep the area around the power outlet clear of items so that you can disconnect the power plugs immediately.
- Always grip the plug to remove the power cord from the power outlet. Pulling on the power cord could damage the cord.
- Never use an extension power cord.
- A power cord shall be connected to a socket-outlet with earthing connection in order to prevent electric shock.

Cautions when requesting repairs, leasing, transferring ownership, and disposing of the printer

- If personal information is registered with the printer or security information such as passwords are set on the printer, that information may remain inside the printer.
- To prevent information leaks, perform the operations specified in the Online Manual before the printer is temporarily out of your hands such as for getting it repaired or leased, or before the printer is transferred to another owner or disposed of.

Other

- Never insert your hand into the printer while it is printing.
- Never place items on top of the printer. In particular, never place small metal objects (paper clips, staples, etc.), liquids, any type of liquid container that contains flammable solvents (alcohol, thinner, etc.) on the printer.
- When using the printer, do not tilt it, stand it on its side, or turn it upside down. There is a risk of the ink spilling.
- When transporting the printer, always perform the steps in “Preparing to Transfer the Printer” in order to protect the internal structure. Refer to the Online Manual for “Preparing to Transfer the Printer”.

- Connect the interface cables correctly. To avoid damage, before connection, make sure that the shape of the cable connector matches the connection point on the printer.
- During printing, turn on the ventilation system in the room.
- To safely use the printer

The printer cannot be directly connected to the communication lines (including public wireless LAN) of electronic telecommunication providers (mobile telecommunication providers, fixed telecommunication providers, or internet providers). When connecting the printer to the internet, always connect via a router or other equipment.

- Firmly grasp the carrying grips (A) on each side of the base and the rear of the printer. Holding the printer at other positions is dangerous, causing injury and damage if the printer is dropped.

•

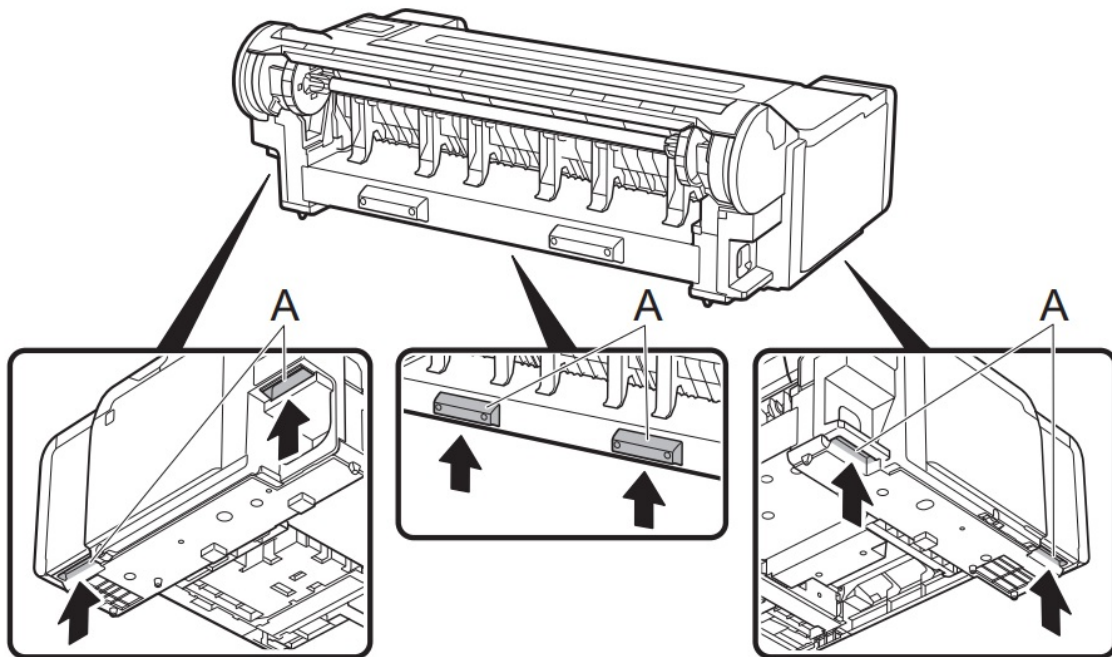

Do not put the printer down or carry the printer with only the center of the printer supported. This may cause damage to the printer.



- When setting the printer down temporarily, make sure to put the printer on a flat, stable surface.

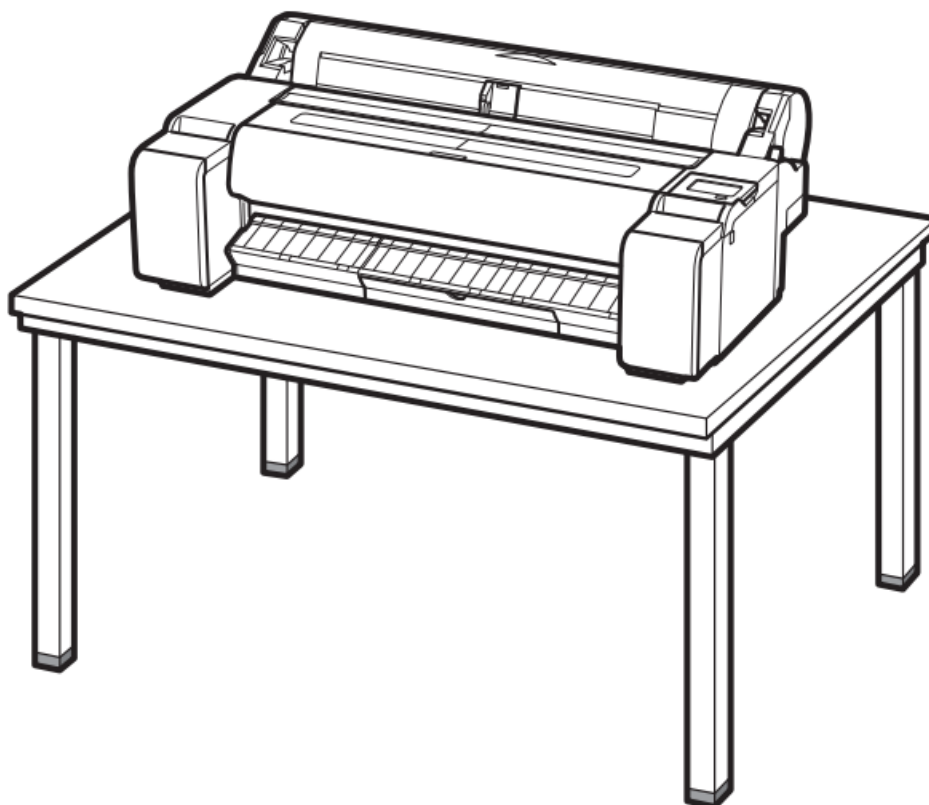

Legal Notices

■ Copyright

Unauthorized reproduction of this user manual in whole or part is prohibited.

■ Legal Notice

- It is illegal to reproduce currency, bills, negotiable securities and other documents prohibited by law.

Reproduction of such items may be subject to criminal prosecution.

- It is illegal to reproduce legal certificates, licenses, travel tickets, and certain public and private documents prohibited from reproduction by law. Reproduction of such items may be subject to criminal prosecution.
- Please note that intellectual property protected by copyright may not be reproduced without the express permission of the copyright holder except for personal or household use under limited circumstances.

Ink Tanks

When purchasing, check the model number.

TM-355/TM-350/TM-255/TM-250

10.1 fl oz (300 ml)

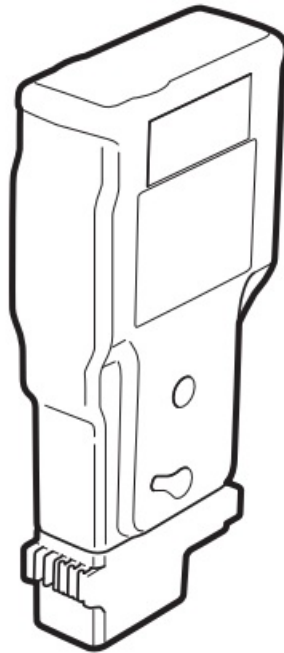

Color	Model Number
Matte Black	PFI-320 MBK
Black	PFI-320 BK
Cyan	PFI-320 C
Magenta	PFI-321 M
Yellow	PFI-320 Y

4.4 fl oz (130 ml)

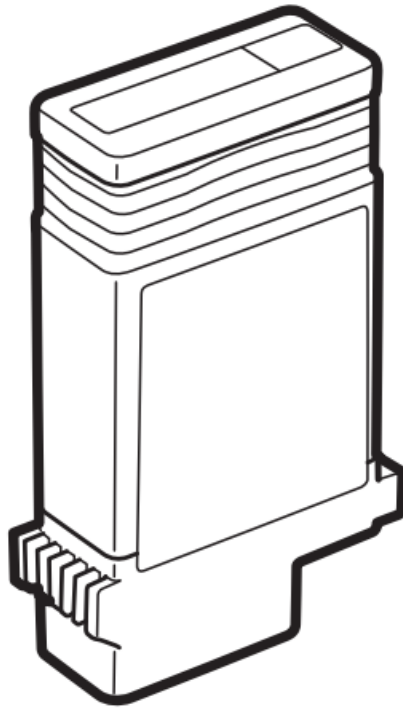

Color	Model Number
Matte Black	PFI-120 MBK
Black	PFI-120 BK
Cyan	PFI-120 C
Magenta	PFI-121 M
Yellow	PFI-120 Y

When purchasing, check the model number.

TM-340/TM-240

1.9 fl oz (55 ml)

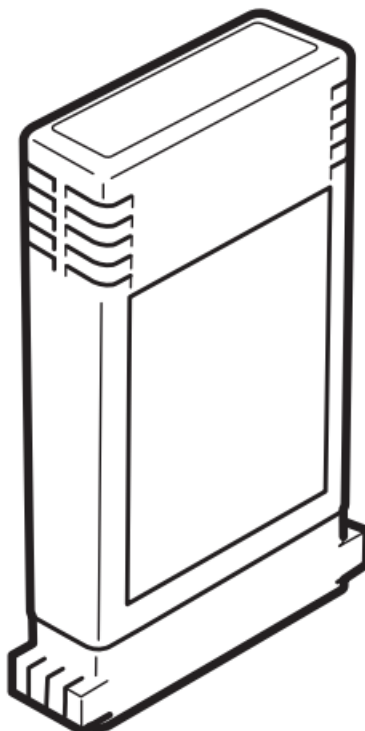

Color	Model Number
Matte Black	PFI-030 MBK
Black	PFI-030 BK
Cyan	PFI-030 C
Magenta	PFI-031 M
Yellow	PFI-030 Y

Canon

© CANON INC.

2023XXXXXXXX

PRINTED IN XXXXXXXX

Documents / Resources

	Canon TM Series imagePROGRAF Multi Large Format Printers [pdf] Installation Guide TM-355, TM Series imagePROGRAF Multi Large Format Printers, imagePROGRAF Multi Large Format Printers, Multi Large Format Printers, Large Format Printers, Format Printers, Printers, TM-350, TM-340, TM-255, TM-250, TM-240
---	--

References

- [Canon : Official Manuals : Welcome!](#)
- [Canon : Manuals : Select Product Name](#)
- [User Manual](#)

Manuals+. [Privacy Policy](#)

This website is an independent publication and is neither affiliated with nor endorsed by any of the trademark owners. The "Bluetooth®" word mark and logos are registered trademarks owned by Bluetooth SIG, Inc. The "Wi-Fi®" word mark and logos are registered trademarks owned by the Wi-Fi Alliance. Any use of these marks on this website does not imply any affiliation with or endorsement.