



# CAMDEN DOOR CONTROLS RX-DB Lazer Point Installation Guide

[Home](#) » [CAMDEN DOOR CONTROLS](#) » CAMDEN DOOR CONTROLS RX-DB Lazer Point Installation Guide 



Lazerpoint™ RX-DB  
Installation Instructions

## Contents

[1 RX-DB Lazer Point](#)

[2 Documents /  
Resources](#)

[2.1 References](#)

[3 Related Posts](#)

**RX-DB Lazer Point**

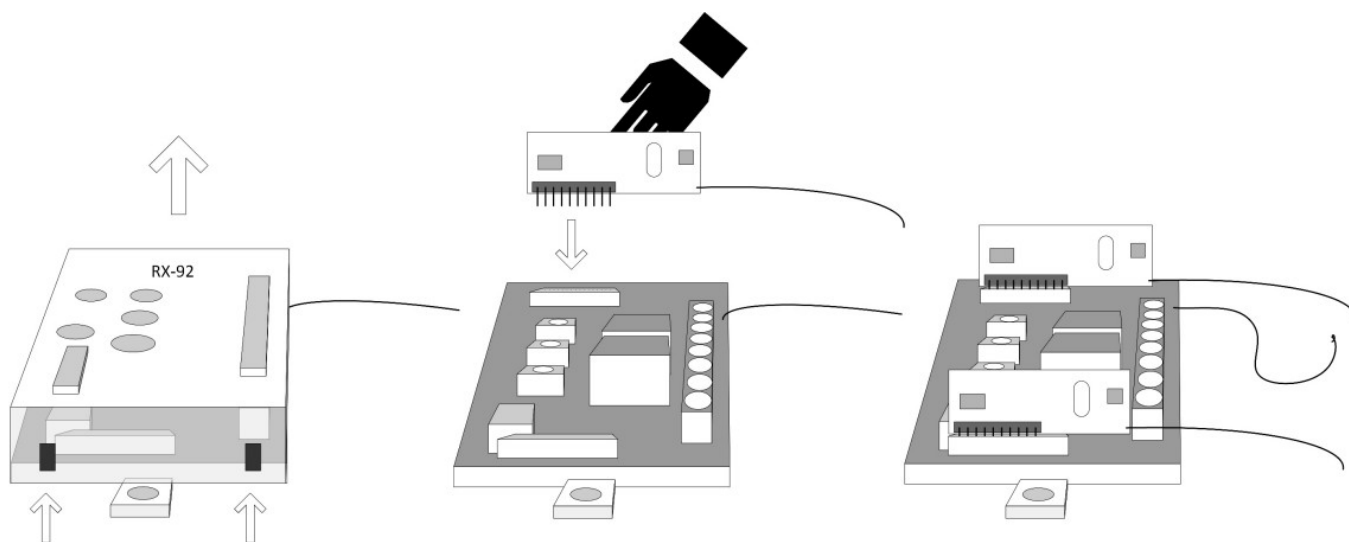

### STEP 1

- Ensure power is turned off, or removed from board
- Carefully press in two tabs on one end of plastic case
- Pry case lid up and off circuit board. Set aside

### STEP 2

- Remove daughterboard from packaging, and carefully insert it into either one of the two headers on main circuit board
- Ensure all 9 pins are properly seated into header, and daughterboard is straight up and down (not bent over)

### STEP3

- Repeat for additional daughterboard, if desired
- Using case lid as a guide carefully route antenna wires to fit into slots on lid
- Re-install lid making sure wires are routed to avoid damage
- lid should snap onto tabs on ends

### CAUTION !

Do not install or remove  
Daughterboard(s) with unit powered.  
Remove power first

Camden Door Controls  
5502 Timberlea Blvd.  
Mississauga, Ontario  
L4W 217

SCALE: NONE

DRAWN BY: DGW

DATE: 03/24/10

REVISED: 16/C

RX-DB Daughterboard Assembly

DRAWING No: DRG-RX-DB

FILENAME: Daughterboard Assembly Diagram  
Ver\_1\_01.vsd



[www.camdencontrols.com](http://www.camdencontrols.com)

Toll Free: 1.877.226.3369

Made in Canada



FS 541752

Certified ISO 9001: 2008

## Documents / Resources



[CAMDEN DOOR CONTROLS RX-DB Lazer Point](#) [pdf] Installation Guide  
01, 40-82B123, RX-DB, RX-DB Lazer Point, Lazer Point, Point

## References

-  [Camden Door Controls is the industry leading manufacturer of door activation and locking products.](#)
-  [Search - Manual-Hub.com](#)