



# Cambium Networks XV2-2 VWi-Fi 6 Access Point User Manual

[Home](#) » [Cambium Networks](#) » Cambium Networks XV2-2 VWi-Fi 6 Access Point User Manual 



## XV2-2 Wi-Fi 6 Access Point



### Contents

- [1 Intended Use](#)
- [2 Installation and operation](#)
- [3 Product safety information](#)
- [4 Important note](#)
- [5 Operation in Canada](#)
- [6 AP Management](#)
- [7 Documents / Resources](#)
  - [7.1 References](#)
- [8 Related Posts](#)

## Intended Use

The Cambium Networks enterprise WiFi products are intended for use in delivering indoor wireless LAN data networks. The XV2-2 is a dual-radio design with internal antennas. The 802.11ax standard is more efficient than previous generations, providing performance enhancements, network segmentation, and improved battery life.



<https://www.cambiumnetworks.com/guides>

<https://learning.cambiumnetworks.com>

<https://support.cambiumnetworks.com>

Cambium Networks Ltd, Unit B2 Linhay Business Park, Eastern Road Ashburton, Devon, TQ13 7UP, United Kingdom

**Model#: REG-XV2-2**

## Installation and operation

Installation and operation of this product is complex, Cambium, therefore, recommends professional installation and management of the system to ensure that operation complies with the regulations of the region where the product is installed. Follow the instructions in this leaflet. Further guidance on installation and operation is available in the product user guide, see web links. The installer must have sufficient skills, knowledge, and experience to perform the installation task and is responsible for:

- Familiarity with current applicable national regulations including radio regulations, electrical installation regulations, and surge protection regulations
  - Installation in accordance with Cambium Networks instructions
  - Confirming that the equipment settings are compliant with national or regional regulations
- Observe the following important instructions during installation. This will set the equipment in compliance with national regulatory regulations:
- Ensure that the XV-Series equipment is fitted with the latest firmware version (System Release 6.x or later). The software is available from the Cambium Support Centre website.
  - During equipment set-up, verify that the correct region code is set (the region code is pre-set in the factory for EU products) and then select the correct country code for the particular country where the product is being deployed. Changes or modifications not expressly approved by Cambium Networks could void the user's authority to operate the equipment and will void the manufacturer's warranty.

## Product safety information

### Observe the following safety rules:

- Always power down and unplug the equipment before servicing. The power supply is the primary disconnect device. There are no serviceable parts inside this equipment.
- Always turn off the power to the XV-Series device before undertaking maintenance activities in front of the antenna.
  - Observe the minimum safe distance limit for XV-Series products provided below.
  - Ensure that equipment is installed in a position avoiding any radiation hazard.
- It is the user's responsibility to install the equipment in accordance with national regulations. It is recommended that installation be contracted to a professional installer.
- Always use the specified XV-Series platform power supply units (PSU) to power the equipment. Failure to use

the specified Cambium-supplied PSU could result in equipment damage and may cause a safety hazard.

- Connecting to a different power source to that specified on the equipment label may result in improper operation, damage to equipment or pose a fire hazard.
- Always install Cambium recommended cables.
  - Use a power cord with an integral safety ground wire intended for connection to a grounded safety outlet
  - Protective bonding must be installed in accordance with local national wiring rules and regulations
- The indoor unit enclosure may be hot to the touch when in operation.
- Please contact your local supplier to get more information about the power supply/adaptor.
- If a Class I PoE adapter or switch is used to provide power, be sure that the power cord is firmly plugged into the socket and confirm the main earth connection.
- This product is intended to be supplied by a UL Listed Power Adapter or DC power source marked “L.P.S” (or “Limited Power Source”), rated 42.5~57Vdc, 0.6A Gigabit Passive PoE injector, 802.3af/at PSE, Tma=60 degree C.
- Interconnecting cables for PoE is intended to be supplied by a UL Listed type CL3P, CL3R or CL3X, marked “SUNLIGHT RESISTANT”, “SUN. RES.”, or “SR.” and “water-resistant” or “W”.

### **Operation in the USA**

This device complies with Part 15 of the FCC Rules. Operation is subject to the following two conditions.

1. This device may not cause harmful interference, and
2. This device must accept any interference received, including interference that may cause undesired operation.

For products available in the USA market, only channels 1 to 11 for the 2.4GHz band can be operated. Selection of other channels is not possible. This device is restricted to indoor use.

### **Important note**

#### **FCC Radiation Exposure Statement:**

This equipment complies with FCC radiation exposure limits set forth for an uncontrolled environment. This equipment should be installed and operated with a minimum distance of 25cm between the radiator and your body. This equipment has been tested and found to comply with the limits for a Class B digital device, pursuant to Part 15 of the FCC Rules. These limits are designed to provide reasonable protection against harmful interference in a residential installation. This equipment generates, uses and can radiate radio frequency energy and, if not installed and used in accordance with the instructions, may cause harmful interference to radio communications.

However, there

is no guarantee that interference will not occur in a particular installation. If this equipment does cause harmful interference to radio or television reception, which can be determined by turning the equipment off and on, the user is encouraged to try to correct the interference by one of the following measures:

- Reorient or relocate the device.
- Increase the separation between the equipment and receiver.
- Connect the equipment into an outlet on a circuit different from that which the receiver is connected.
- Consult the dealer or an experienced radio/TV technician for help.

**FCC Caution:** Any changes or modifications not expressly approved by the party responsible for compliance could void

## Operation in Canada

### ISED statement

This device complies with 'Innovation, Science and Economic Development (ISED) Canada's license-exempt RSS standard(s). Operation is subject to the following two conditions: (1) this device may not cause interference, and (2) this device must accept any interference, including interference that may cause undesired operation of the device.

Operation in the band 5150–5250 MHz is only permitted for indoor use, to reduce the potential for harmful interference to cochannel mobile satellite systems.

### Important note

ISED Radiation Exposure Statement: This equipment complies with IC RSS-102 radiation exposure limits set forth for an uncontrolled environment. This equipment should be installed and operated with a minimum distance 30 cm between the radiator and your body.

### Operation in the EU

Frequency bands, maximum operating power, a safe distance

**In the EU, the 2.4 GHz / 5 GHz dual-band XV-Series products operate in the following frequency bands up to the maximum the power is shown below:**

Operating frequency band	EU standard	Maximum power limit (EIRP)	Permitted usage	Units that support this frequency band
2401 – 2483 MHz	EN 300 328	100 mW / 20 dBm	Available for general usage within all EU nations	All XV series
5150 – 5350 MHz	EN 301 893	200 mW / 23 dBm		
5470 – 5725 MHz	EN 301 893	1 W / 30 dBm		
5725 – 5875 MHz	EN 302 502	4 W / 36 dBm		

For XV-Series products deployed in the EU, the minimum safe distance between the equipment and humans is 20 cm.

### Restrictions and requirements for authorization for use

- This equipment is for Indoor use only.
- The XV-Series products can be configured to operate in unlicensed frequency bands subject to frequency planning within individual countries. Operators / End users must ensure that the equipment is installed and operated in accordance with the regulations applicable to the country of operation.
- Use only with Power Supply L.P.S 42.5-57Vdc/600mA Gigabit Passive PoE injector, 802.3af/at PSE.

### Simplified EU Declaration of Conformity

Hereby, the manufacturer Cambium Networks Ltd, declares that the radio equipment type XV2-2 is in compliance with Directive 2014/53/EU. The full text of the EU declaration of conformity is available at the following internet address:

[http://www.cambiumnetworks.com/eu\\_dofc](http://www.cambiumnetworks.com/eu_dofc)

### Waste Electrical and Electronic Equipment (WEEE) Directive



■ Please do not dispose of Electronic and Electric Equipment or Electronic and Electric Accessories with your household waste. In some countries or regions, collection systems have been set up to handle waste of electrical and electronic equipment. In European Union countries, please contact your local equipment supplier representative or Cambium Networks Support Centre for information about the waste collection system in your country.

## AP Management

Standalone	Access Point can be managed directly from its GUI by selecting the 'Configure' tab on the menu, and setting up a wireless LAN.
On-Premises	Access Point can be onboarded to the cnMaestro network management system.
Cloud	Access Point can be onboarded to either cnMaestro Cloud or XMS-Cloud at <a href="https://cloud.cambiumnetworks.com">https://cloud.cambiumnetworks.com</a> or <a href="https://login.xirrus.com">https://login.xirrus.com</a> respectively.

For management from cloud please ensure the AP has connectivity to the internet. Connectivity can be verified using tools such as ping from the 'Troubleshooting' tab of the Access Point GUI. Connection status can be monitored from the AP dashboard.

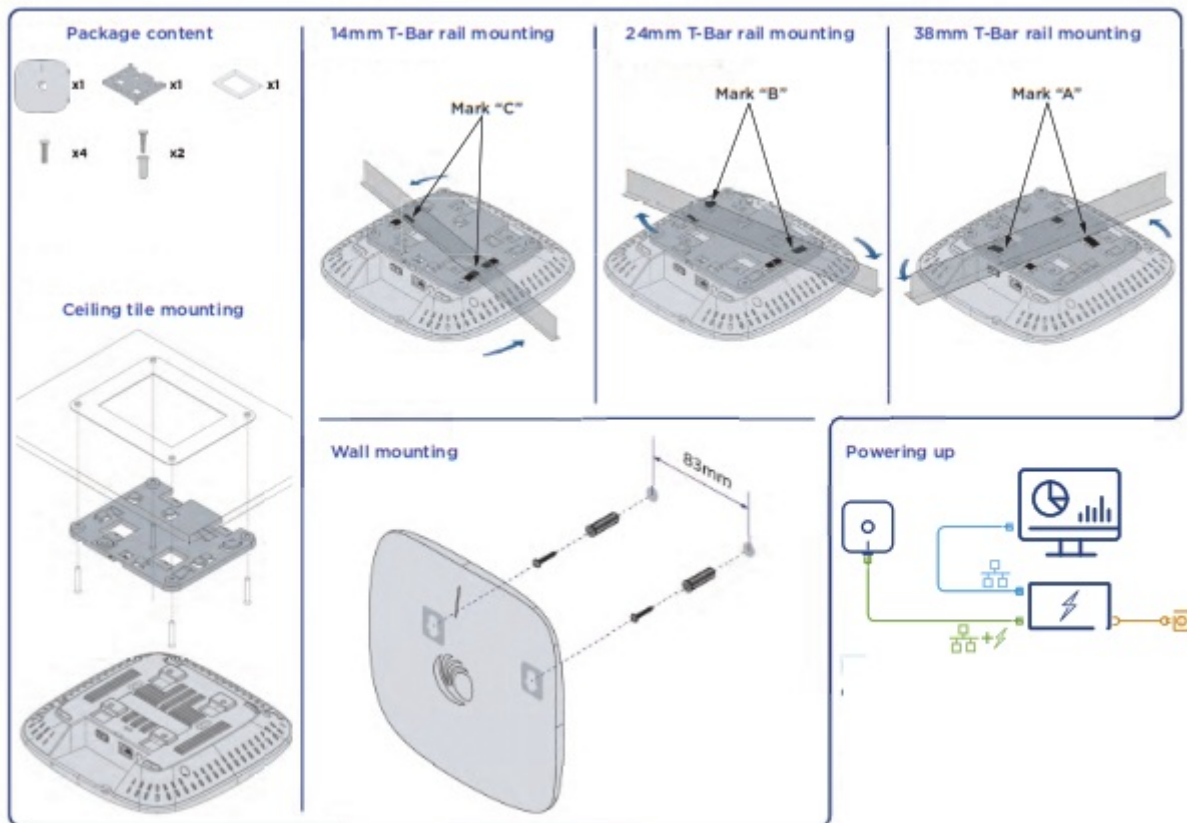

DHCP/192.168.0.1

<http://192.168.0.1>

Managing with XMS-Cloud

Copy the Entitlement ID (EID) received via email, then go to

[support.cambiumnetworks.com](http://support.cambiumnetworks.com) > Licensing, under Entitlements click

Activate Entitlements, and then paste the EID.

Open XMS-Cloud console and add the AP serial number: [login.xirrus.com](https://login.xirrus.com) > Access Point tab > Add/Remove > + ADD APTO ACCOUNT.



admin/admin

Managing with cnMaestro-Cloud

1. To create a Cambium account, go to [support.cambiumnetworks.com](http://support.cambiumnetworks.com) and click Register on the top-right.
2. To create a cnMaestro instance, go to [cloud.cambiumnetworks.com](https://cloud.cambiumnetworks.com) and click Create a Company Account.

3. Open cnMaestro console and add AP serial number: [cloud.cambiumnetworks.com](https://cloud.cambiumnetworks.com) > Claim a device > Enter Serial Number.



<https://support.cambiumnetworks.com>

Connecting what matters



P020650

pmp-2965 000v003

[www.cambiumnetworks.com](https://www.cambiumnetworks.com)

## Documents / Resources

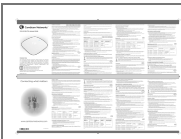

[Cambium Networks XV2-2 VWi-Fi 6 Access Point](#) [pdf] User Manual  
89FT0057, Z8H89FT0057, XV2-2 VWi-Fi 6, Access Point, Point

## References

- [Cambium Networks | Wireless Solutions that Just Work](#)
- [EU Compliance - Cambium Networks](#)
- [cnMaestro™](#)
- [Cambium Networks | Wireless Solutions that Just Work](#)
- [EU Compliance - Cambium Networks](#)
- [cnMaestro™](#)
- [Loading](#)
- [Xirrus Management System - Log In](#)
- [Home / Cambium Networks Support](#)
- [Search our Resources - Case Studies, Brochures and more | Cambium](#)