

**Calypso RM3500WF Smart Water Heater Controller**



# Calypso RM3500WF Smart Water Heater Controller Installation Guide

[Home](#) » [CALYPSO](#) » Calypso RM3500WF Smart Water Heater Controller Installation Guide 

## Contents

- [1 Calypso RM3500WF Smart Water Heater Controller](#)
- [2 Product Information](#)
- [3 YOUR CALYPSO CONTROLLER](#)
- [4 TECHNICAL SPECIFICATIONS](#)
- [5 INSTALL YOUR CONTROLLER ON A WATER HEATER](#)
- [6 INSTALLATION ON A 240 V CIRCUIT](#)
- [7 INSTALLING THE TEMPERATURE PROBE](#)
- [8 INSTALLING THE OPTIONAL](#)
- [9 DISCONNECT YOUR CONTROLLER](#)
- [10 FCC STATEMENT](#)
- [11 Limited Warranty](#)
- [12 Documents / Resources](#)
  - [12.1 References](#)
- [13 Related Posts](#)

# Calypso

**Calypso RM3500WF Smart Water Heater Controller**



## Product Information

### Specifications

- **Operating voltage:** 240 V (60 Hz)
- **Maximum load:** 20.8 A @ 240 Vac
- Single-pole relay
- **Standard UL:** Conforms to ANSI/UL Std. 916
- Certified under CAN/CSA Std. C22.2 No205
- Indoor installation only
- **Protocol:** Wi-Fi
- **Standard:** IEEE 802.11 b/g/n
- **Frequency:** 2.4 GHz

### FAQs

- **Q:** Can I install the Calypso RM3500WF controller myself?
  - **A:** No, the installation must be done by a certified electrician following all electrical codes.
- **Q:** What should I do if the Link Indicator does not light up?
  - **A:** Check your network connection and ensure proper setup following the installation guide.

## Warning

- The installation of this controller must be made by a certified electrician and must be installed in conformity with the national and local electrical codes.
- The smart water heater controller is designed for indoor use only.

## YOUR CALYPSO CONTROLLER

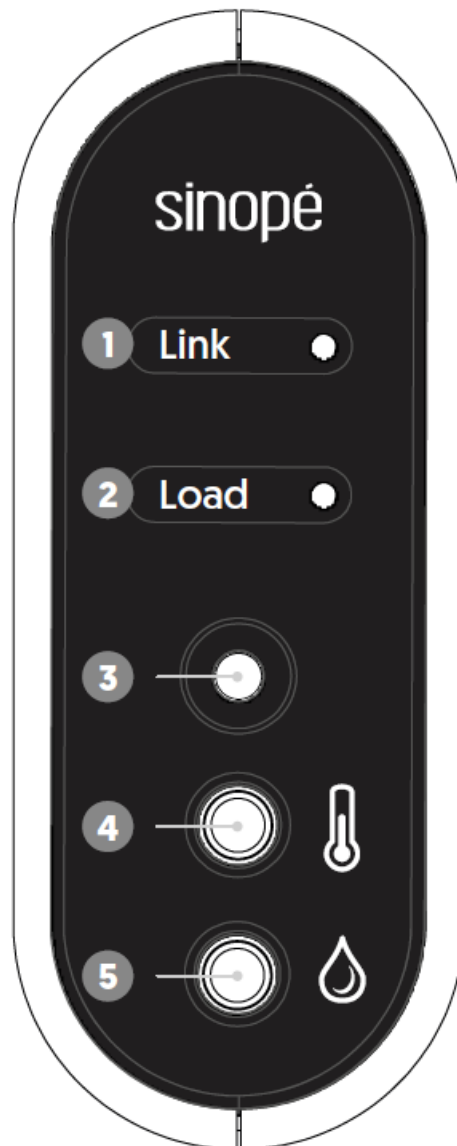

### 1. “Link” Indicator

- The indicator lights up when the controller is connected to the network.

### 2. “Load” Indicator

- The indicator lights up when power is applied to the water heater.

### 3. ON / OFF Button

### 4. Temperature Probe Port

- This temperature sensor guarantees maximum comfort and a minimum temperature threshold during your power utility’s peak management events and your programmed events.\*

### 5. Water Detection Cable Port

- The optional water detection cable detects potential leaks and sends an alert on your mobile.

\* Neviweb account and Éco Sinopé participation required.

## TECHNICAL SPECIFICATIONS

- **Operating voltage:** 240 V (60 Hz)
- **Maximum load:** 20.8 A @ 240 Vac
- Single-pole relay
- **Operating temperature:** 0 °C to 40 °C (32 °F to 104 °F)
- **Storage:** -20 °C to 50 °C (-4 °F to 122 °F)
- **Standard UL:** Conforms to ANSI/UL Std. 916
- Certified under CAN/CSA Std. C22.2 No205
- Indoor installation only
- **Protocol:** Wi-Fi
- **Standard:** IEEE 802.11 b/g/n
- **Frequency:** 2.4 GHz

### Note

- If your water heater has been turned off for several days, it is recommended to wait until the water temperature has reached 55 °C (131 °F) for a minimum of 4 hours and then let the hot water run for a few minutes before using it.

## INSTALL YOUR CONTROLLER ON A WATER HEATER

### Hardware required for installation

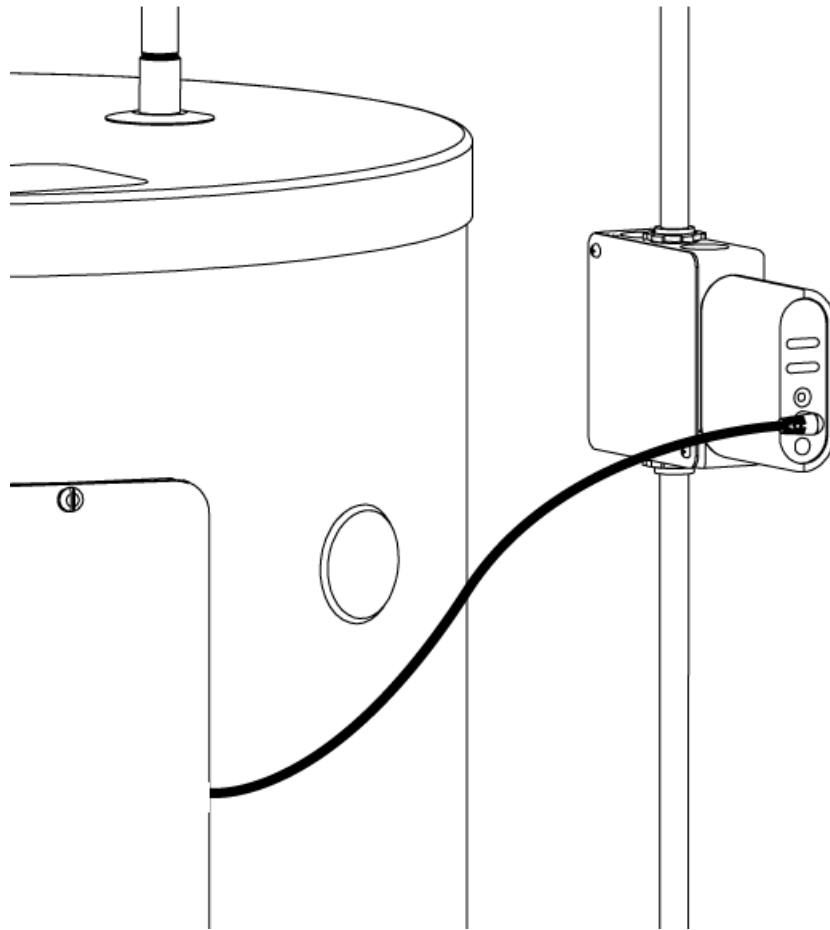

- 1 standard utility electrical wiring box – with conduit knockouts, 4" x 4" x 1-1/2" deep
  - 1 electrical box cover
  - 2 wire clamps
- Turn OFF the water heater circuit at the main electrical panel.
- Insert the water heater wire (load) and the power wire (line) into the electrical box and secure them with wire clamps.
  - Install an electrical box ground wire to the water heater ground screw.

**Learn how the protection mechanism works**



## **INSTALLATION ON A 240 V CIRCUIT**

### **Electrical panel**

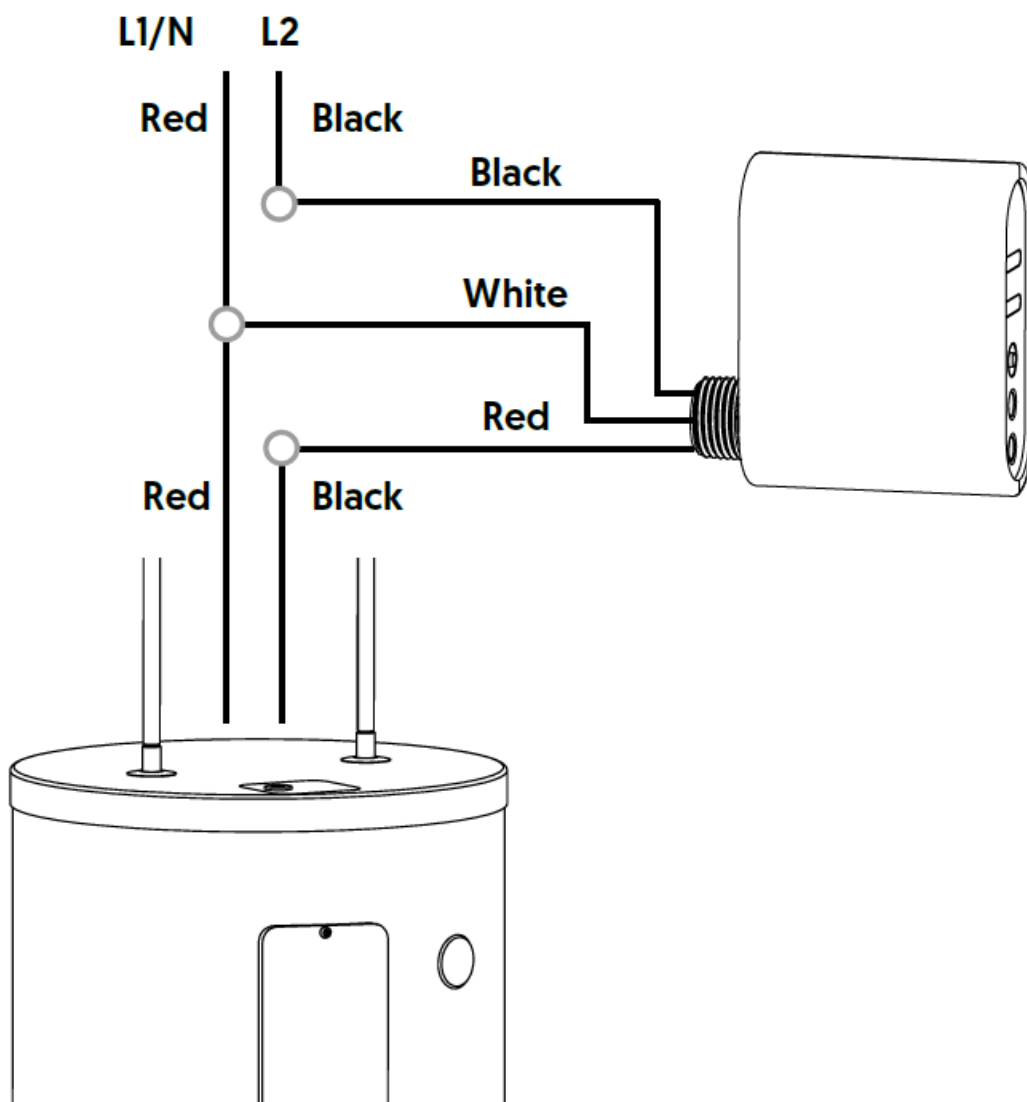

## INSTALLING THE TEMPERATURE PROBE

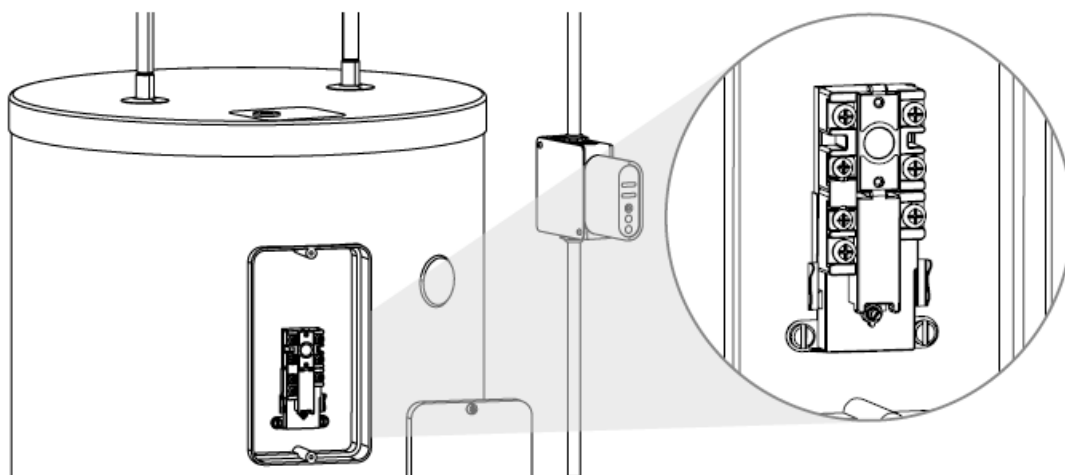

1. Unscrew and remove the door plate located at the top of the water heater.

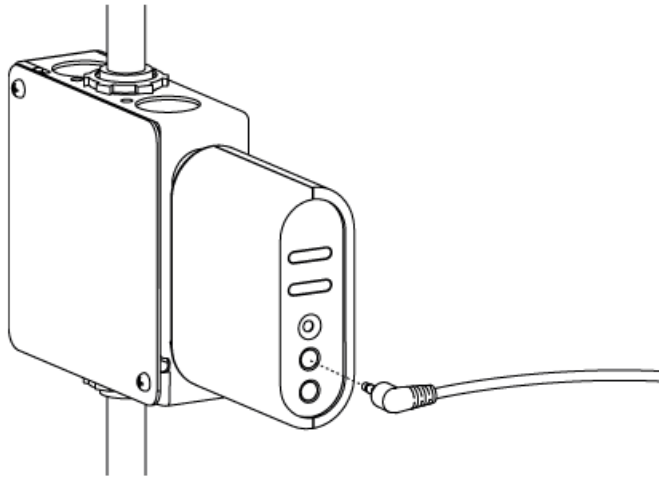

2. Plug the probe into the controller's temperature port.

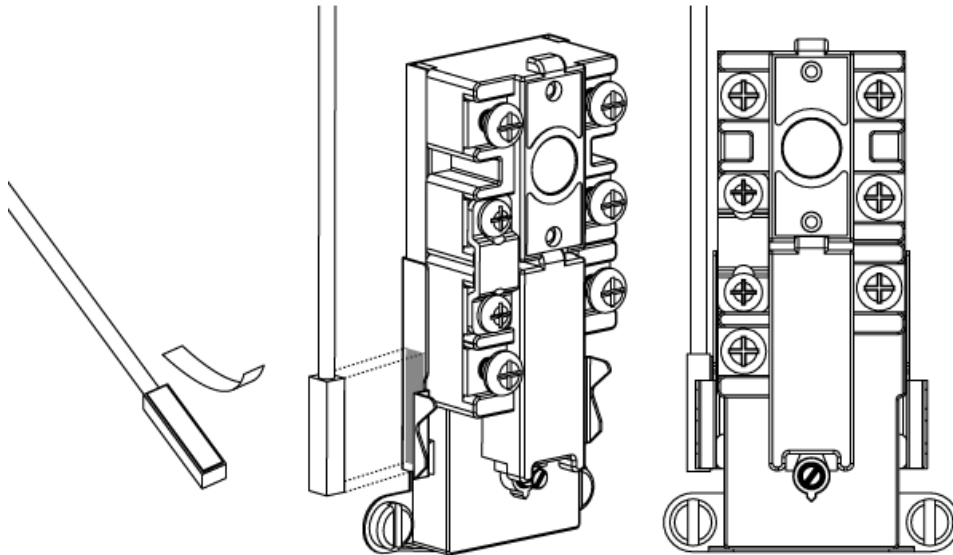

3. Remove the sticker liner from the end of the probe and affix it to either side of the water heater's thermostat, as illustrated. Screw the water heater door plate in place.

- **Note:** Clean the side of the thermostat with isopropyl alcohol before affixing the probe.

4. Make sure to adjust the water heater's temperature between 55°C (131°F) and 60°C (140°F) to use the controller during your power utility's peak management events.
5. Power up the controller
6. Press the ON/OFF button to activate the controller.

## INSTALLING THE OPTIONAL

### INSTALLING THE OPTIONAL AC4200C-02 WATER DETECTION CABLE

You can add a water detection cable to the water heater controller to receive to get alerted when a leak is detected.

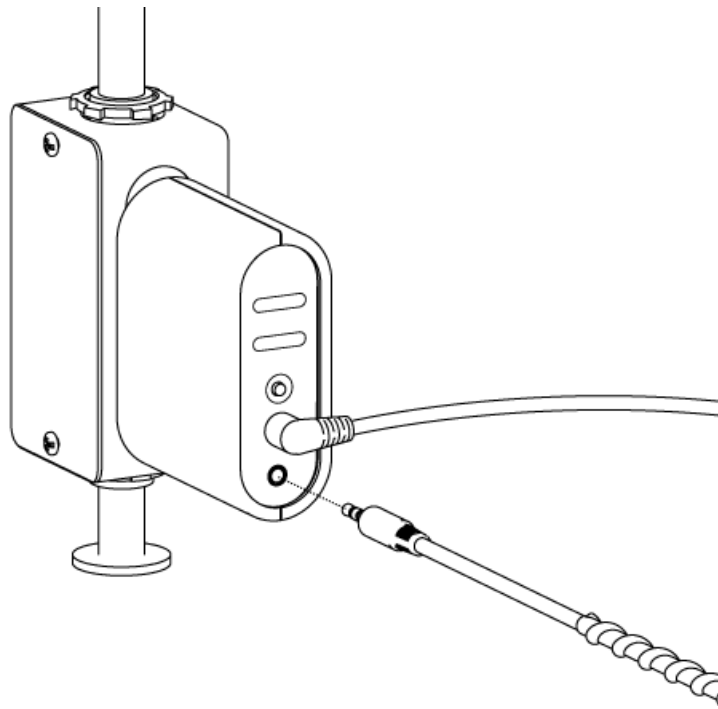

1. Plug the water detection cable into the controller's lower port.
2. Position the water detection cable at the base of the water heater and secure its position with the provided fasteners.

#### **ADD YOUR CONTROLLER TO THE NEVIWEB APP**



### **Get the app**



1. If you do not have an account yet, download the Neviweb app for iOS or Android to create an account and add your device.
2. Tap , then select "Add Device".
3. Follow the steps of the installation wizard.



## DISCONNECT YOUR CONTROLLER

### DISCONNECT YOUR CONTROLLER FROM THE WI-FI ROUTER OR THE NEVIWEB APP

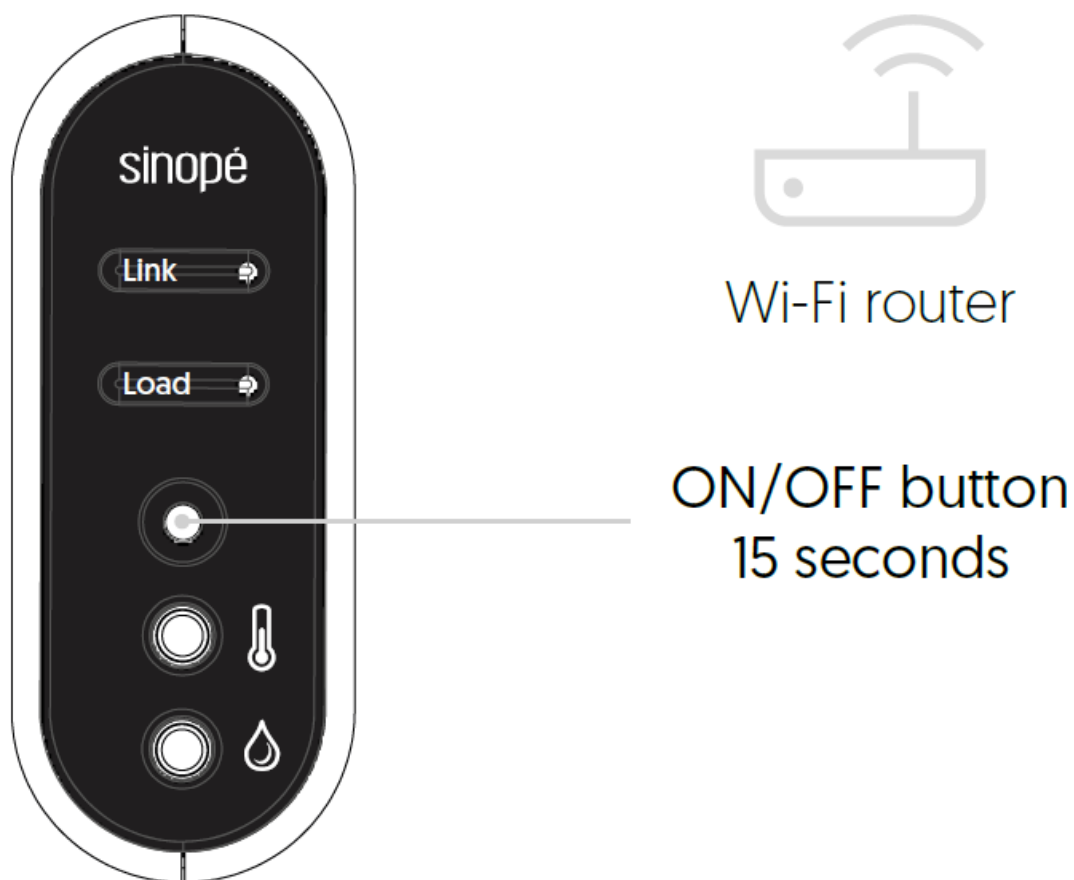

- To disconnect your device from the Wi-Fi router, press the ON/OFF button for 15 seconds.

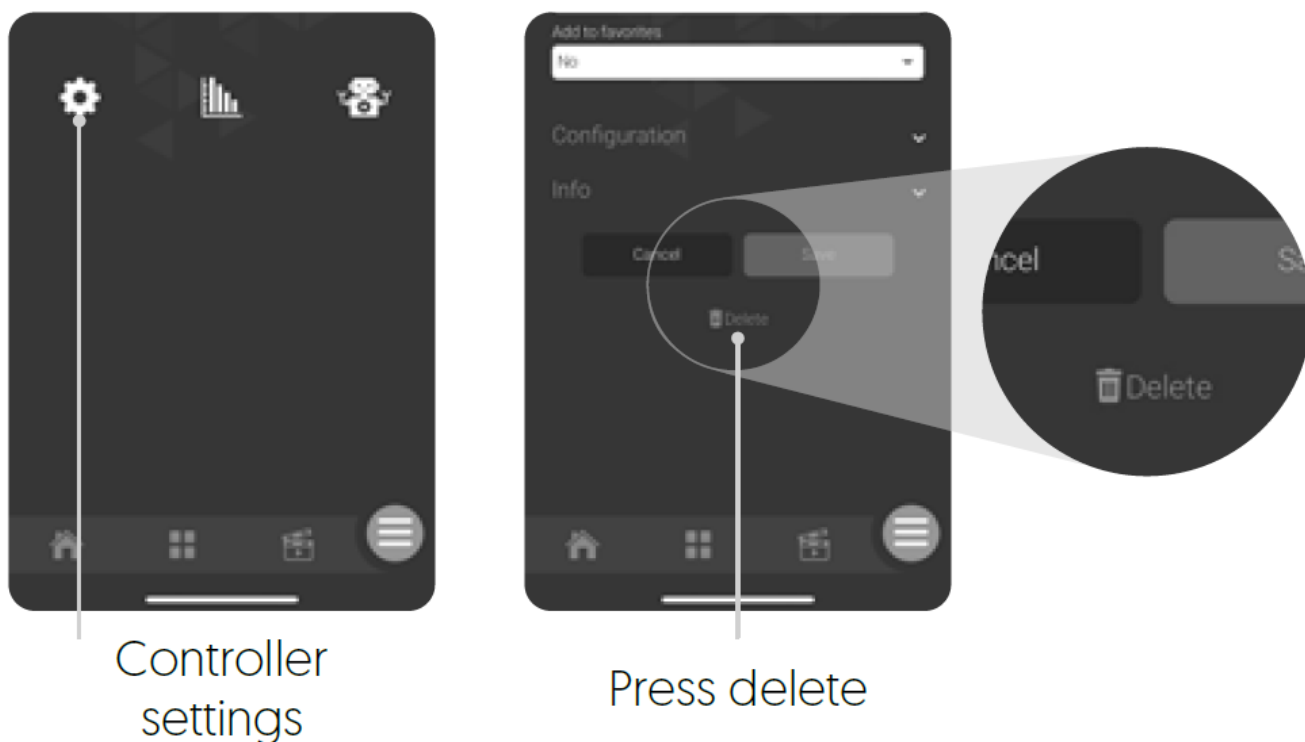

- To remove your controller from Neviweb, press Delete in the controller settings.

## **FCC STATEMENT**

- **Transmitter module:**

- **FCC ID:** 2AC7Z-ESPWROOM32 /
- **IC:** 21098-ESPWROOM32

### **FCC CFR 47 Title 15 Class B**

This device complies with Industry Canada license exempt RSS standard(s). Operation is subject to the following two conditions:

1. this device does not cause interference
2. this device must accept any interference, including interference that may cause undesired operation of the device.

This equipment has been tested and found to comply with the limits for a Class B digital device, pursuant to part 15 of the FCC Rules. These limits are designed to provide reasonable protection against harmful interference in a residential installation. This equipment generates, uses and can radiate radio frequency energy, and if not installed and used in accordance with the instructions, may cause harmful interference to radio communications. However, there is no guarantee that interference will not occur in a particular installation. If this equipment does cause harmful interference to radio or television reception, which can be determined by turning the equipment OFF and ON, the user is encouraged to try to correct the interference by one or more of the following measures:

- Reorient or relocate the receiving antenna.
- Increase the separation between the equipment and receiver.
- Connect the equipment into an outlet on a circuit different from that to which the receiver is connected.
- Consult the dealer or an experienced radio/TV technician for help.

## **Limited Warranty**

### **3-year limited warranty**

SINOPÉ TECHNOLOGIES INC. warrants the components of their products against defects in material and workmanship for a 3 year period from the date of purchase, under normal use and service, when proof of purchase of such is provided to the manufacturer. This warranty does not cover any transportation costs that may be incurred by the consumer. Nor does it cover a product that has been improperly installed, misused or accidentally damaged. The obligation of SINOPÉ TECHNOLOGIES INC., under the terms of this warranty, will be to supply a new unit and this releases the manufacturer from paying the installation costs or other secondary charges linked to replacing the unit or the components.

**For more information, visit our Website: [www.sinopetech.com](http://www.sinopetech.com)**



Controlling this HomeKit-enabled accessory automatically and away from home requires a HomePod, Apple TV, or iPad set up as a home hub. It is recommended that you update to the latest software and operating system.

Use of the Works with Apple badge means that an accessory has been designed to work specifically with the technology identified in the badge and has been certified by the developer to meet Apple performance standards. Apple is not responsible for the operation of this device or its compliance with safety and regulatory standards. HomeKit is a trademark of Apple Inc.

Neviweb® is a registered trademark of Sinopé Technologies Inc. in Canada and the United States.  
Apple and the Apple logo are trademarks of Apple Inc., registered in the U.S. and other countries.  
App Store is a service mark of Apple Inc., registered in the U.S. and other countries.  
Google Play and the Google Play logo are trademarks of Google Inc.  
The Wi-Fi CERTIFIED™ Logo is a certification mark of Wi-Fi Alliance®

---

## Documents / Resources

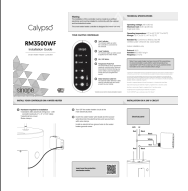
|   |  |
|---|--|
|  | <p><a href="#">Calypso RM3500WF Smart Water Heater Controller</a> [pdf] Installation Guide<br/>RM3500WF Smart Water Heater Controller, RM3500WF, Smart Water Heater Controller, Water Heater Controller, Heater Controller, Controller</p> |
|---|--|

## References

- [User Manual](#)

[Manuals+](#), [Privacy Policy](#)

This website is an independent publication and is neither affiliated with nor endorsed by any of the trademark owners. The "Bluetooth®" word mark and logos are registered trademarks owned by Bluetooth SIG, Inc. The "Wi-Fi®" word mark and logos are registered trademarks owned by the Wi-Fi Alliance. Any use of these marks on this website does not imply any affiliation with or endorsement.