



Contents [[hide](#)]

- [1 CallTou SW11 Series Wireless Watch Calling System](#)
- [2 Product Specifications](#)
- [3 Product Usage Instructions](#)
- [4 Safety Precautions](#)
- [5 How does the system work with a caregiver?](#)
- [6 What is in the Box](#)
- [7 Features](#)
- [8 Learn About Products](#)
- [9 Operational Guidance](#)
- [10 Installation Guide](#)
- [11 Charge the Provided Battery](#)
- [12 Technical Parameters](#)
- [13 Question & Answer](#)
- [14 Documents / Resources](#)
 - [14.1 References](#)



CallTou SW11 Series Wireless Watch Calling System



Product Specifications

- Model: SW11
- Buttons Model: Q-01A/Q-01AB
- Wireless Range: 1000ft/300m
- Waterproof Rating: IP67
- Features: 4 Ringtone Adjustable, Prompt Time & Date, Touch Key

Product Usage Instructions

Safety Precautions:

The product manual contains important safety information. Follow these precautions to ensure safe use:

- Do not place the product near flammable, explosive, or hazardous objects.
- Avoid disassembling the product as it may result in safety hazards.
- Avoid dropping or subjecting the product to strong impacts to prevent failure.
- Use appropriate detergents for cleaning to prevent discoloration or deformation of the product.
- If the product shows any abnormalities like overheating or strange smells, stop using it

immediately.

- Supervise children to prevent them from playing with the product.

How does the system work with caregivers?

The system is designed for elderly care and sends signals to caregivers for bed alarms, fall prevention, hospice care, and home nursing.

Contents:

- Call Button
- Double-Sided Adhesive Tape
- Auxiliary Tool
- Manual
- AC Plug
- Screwdriver
- Charging Cable
- Lanyard

Features:

The SW11 Smart Call Watch Receiver features a waterproof design with a wireless range of 1000ft/300m. It includes a touch key, 4 ringtone options, and adjustable prompt times.

Operational Guidance:

Add Call Buttons/Transmitters:

1. Press and hold the Setup key.
2. Access the Administrator menu.
3. Select "Add Buttons".
4. Edit the transmitter number by pressing the Setup key and entering digits.
5. Press the transmitter button to confirm.

Installation Guide:

Follow the provided manual for step-by-step installation instructions to set up the wireless watch calling system.

Charge the Provided Battery:

Utilize the charging cable and AC plug to charge the provided battery for uninterrupted usage of the product.







Receiver Model: SW11

Buttons Model: Q-01A/Q-01AB

Safety Precautions

The instruction manual contains important information to prevent harm to the user and other people and damage to property, and to ensure safe and correct use of the product. Please thoroughly understand the following contents (displays and graphic symbols)

 **Caution**

	Do not place the product in or near an inflammable, explosive, or hazardous object.
	Do not disassemble the product. Disassembly may result in a risk of safety hazards.
	Do not drop or subject it to strong impact. It will be the cause of the failure.
	Do not use chlorine-based or acidic detergents for cleaning. The main body may become discolored or deformed, or toxic gases may be generated, which may harm your health.
	Do not be mixed with other commercial wastes for disposal.
	If you feel any abnormality such as getting hot or smelling strange, please stop using it immediately. It may cause fire or electric shock.
	Children should be supervised to ensure that they do not play with the appliance.

How does the system work with a caregiver?

Designed for elderly care, it sends a signal to caregivers.



Bed Alarms and Fall Prevention

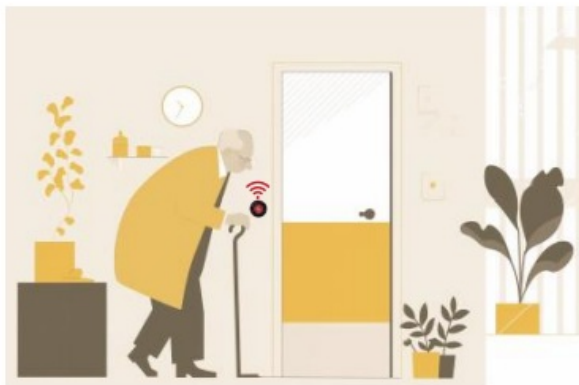

Hospice Care, Home Nursing

What is in the Box



Call Button

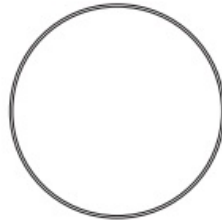

Double Sided
Adhesive Tape



Auxiliary
Tool



Manual



AC Plug



Screwdriver



Smart Call Watch



Charging Cable

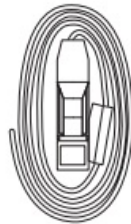

Lanyard

Features

Watch Receiver-SW11



384
Add Button



55 Keyvalue
Define



1000ft/300m
Wireless Range



IP67
Waterproof



4 Ringtone
Prompt Modes



Adjustable Prompt
Times(02-99 times)



Time & Date/
Touch Key

Call Button-Q-01AB



IP55
Waterproof



Easy to Carry



-22°F to 158°F
Working Temperature

Learn About Products

SW11-Watch Receiver

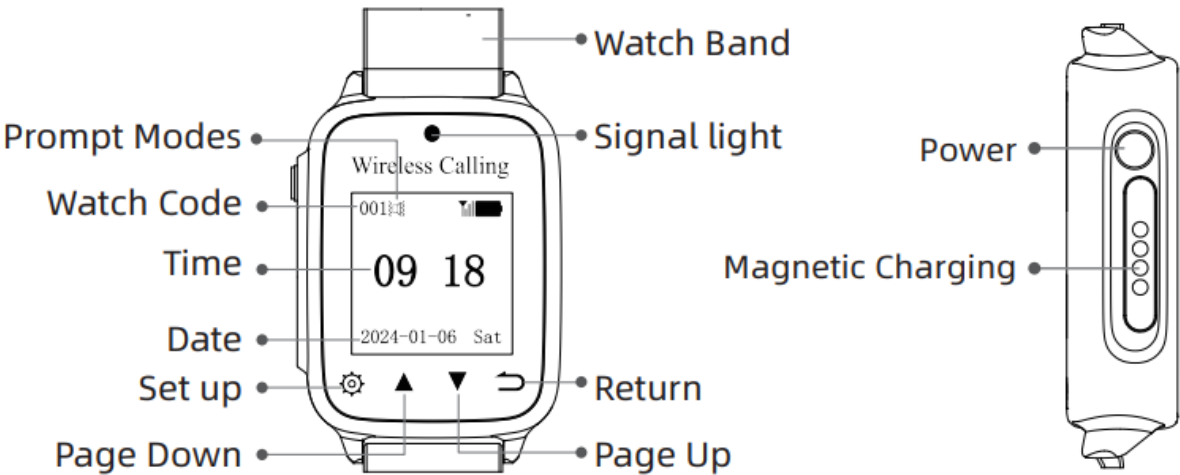

Q-01AB/Q-01A-Call Button

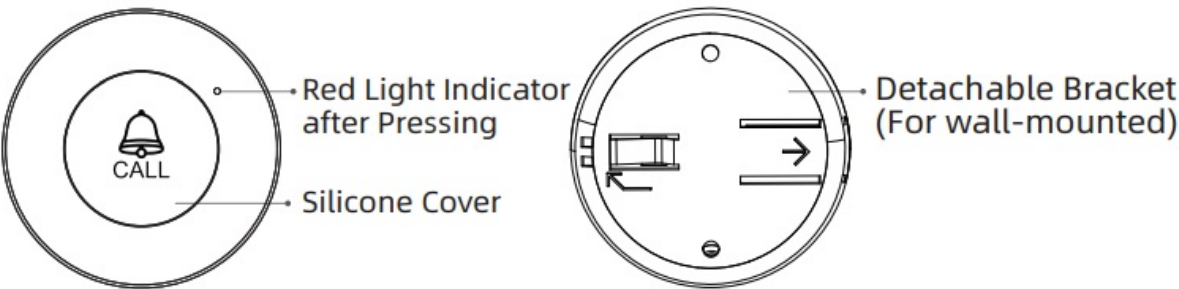

Operator Interfaces

A Calling Interface

Watch pager number

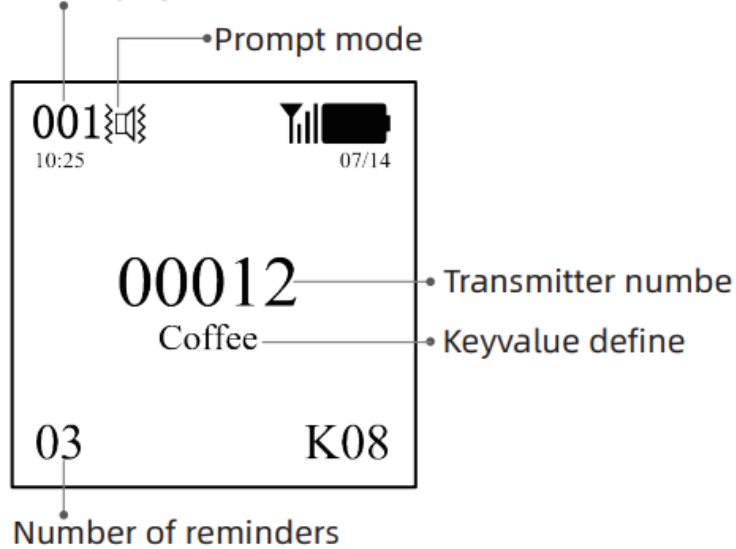

B Add Buttons

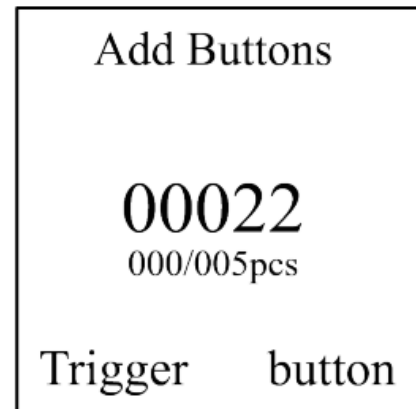

C Keyvalue Define

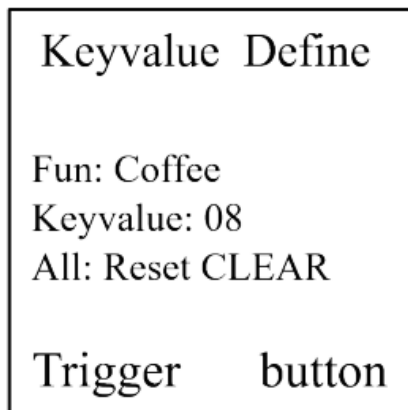

D Del All Buttons

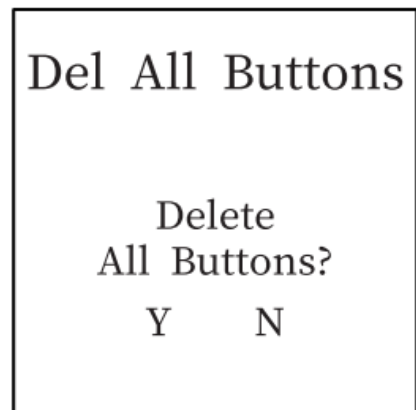

Operational Guidance

1. Add Call Buttons/Transmitters

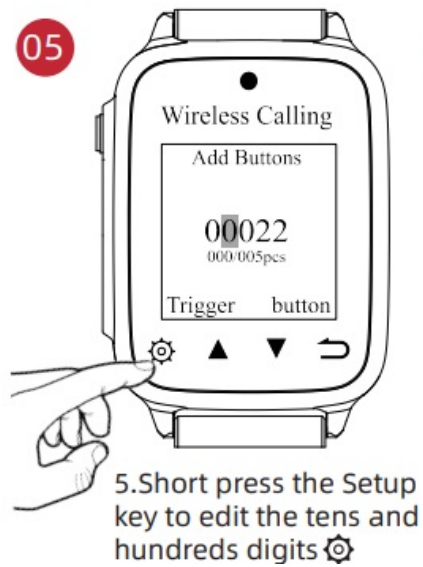
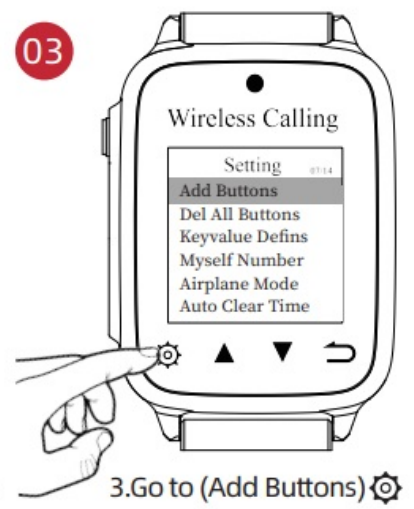
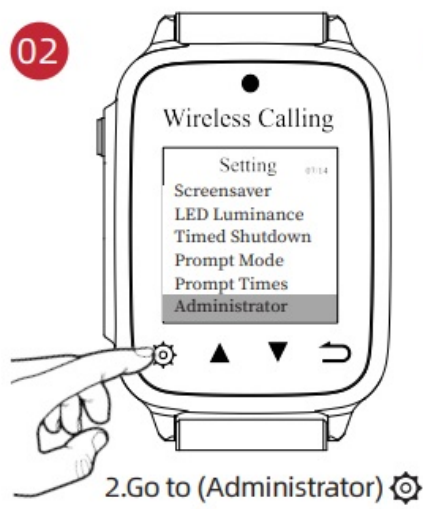

2. Keyvalue Define

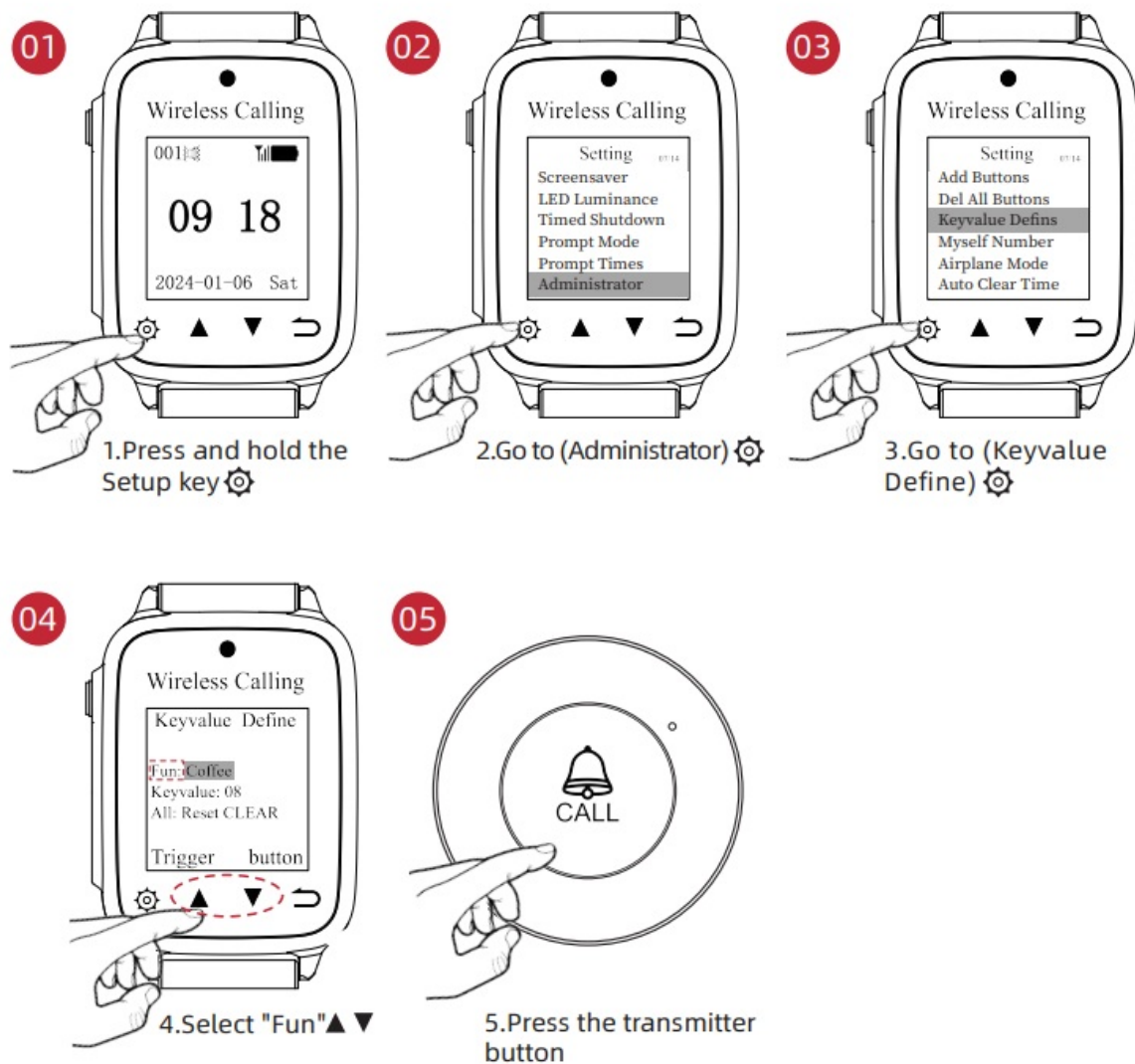

3. Del All Buttons

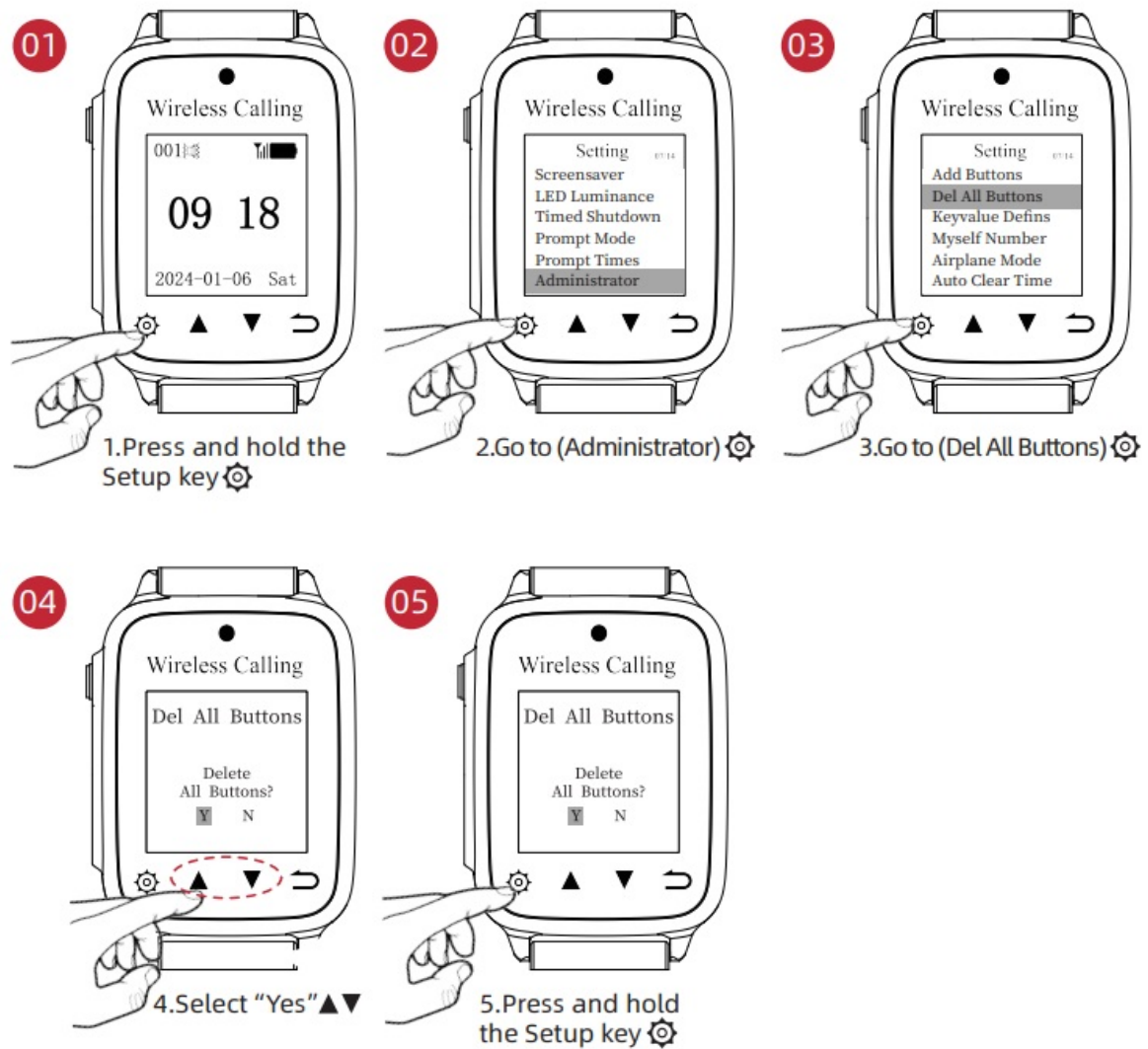

4. Changing the Prompt Mode (Ringtone)/Prompt Times

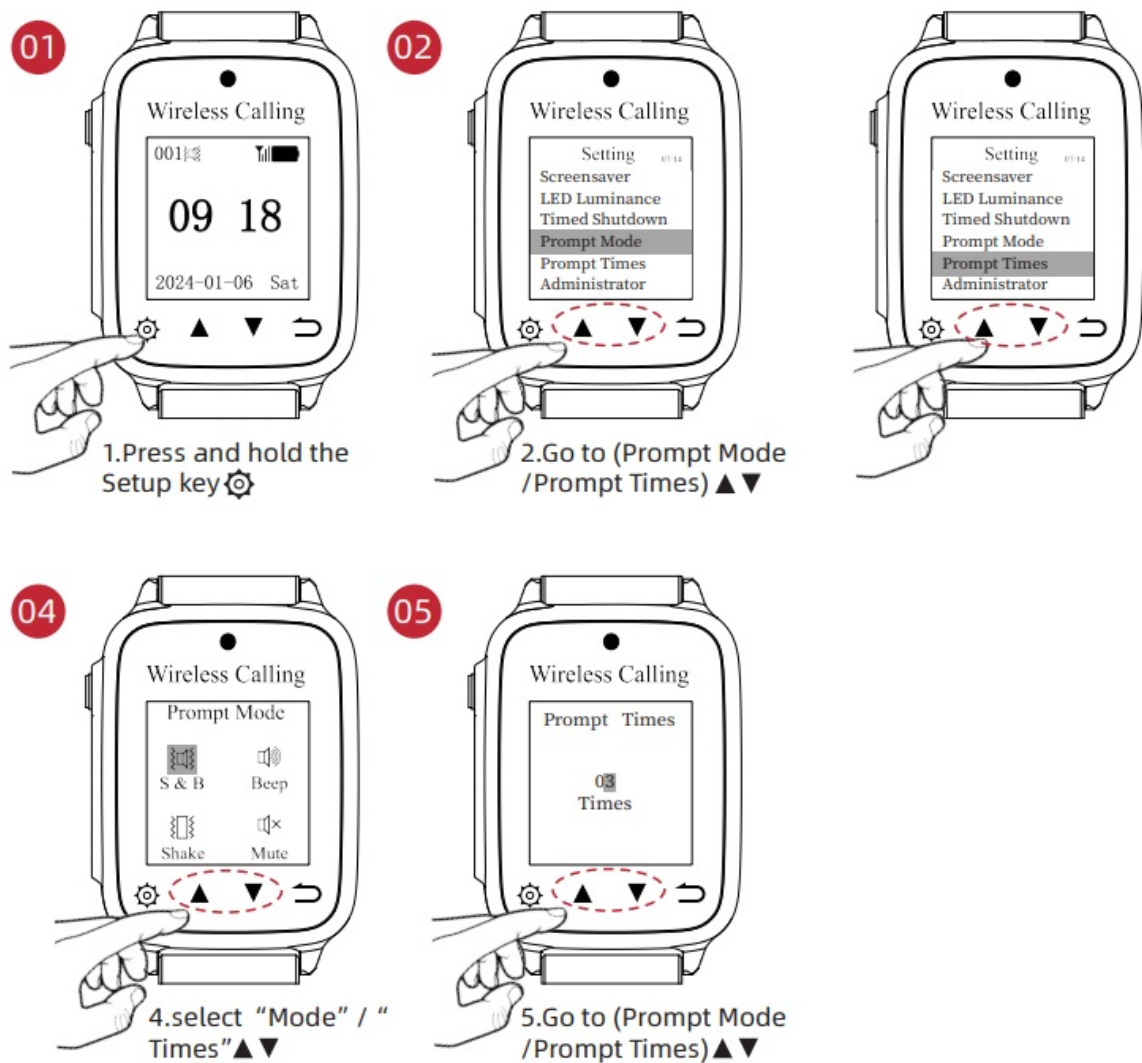

5. Data Sync

This function only applies if you have purchased more than one watch receiver. you can contact us to send you a data cable (a customized cable is required), if you have purchased few watch receivers, just do it manually.

6. Timeout Prompt

Press and hold the Setup key ⚙️ – Go to (Timeout Prompt) ⚙️

7. For more features, please check the video QR code

How to set alarm, change background and font color, alert language, rest time and screen brightness

Video Guide

Model: Q-01A/Q-01AB

FCC ID: 2AWYQ-Q-01A

Power: AAA Battery

SW11 Receiver and Transmitter Operation Video

Please scan the code to view



www.calltou.com

Service01@calltou.com

Installation Guide

1. The transmitter button can be used in two ways

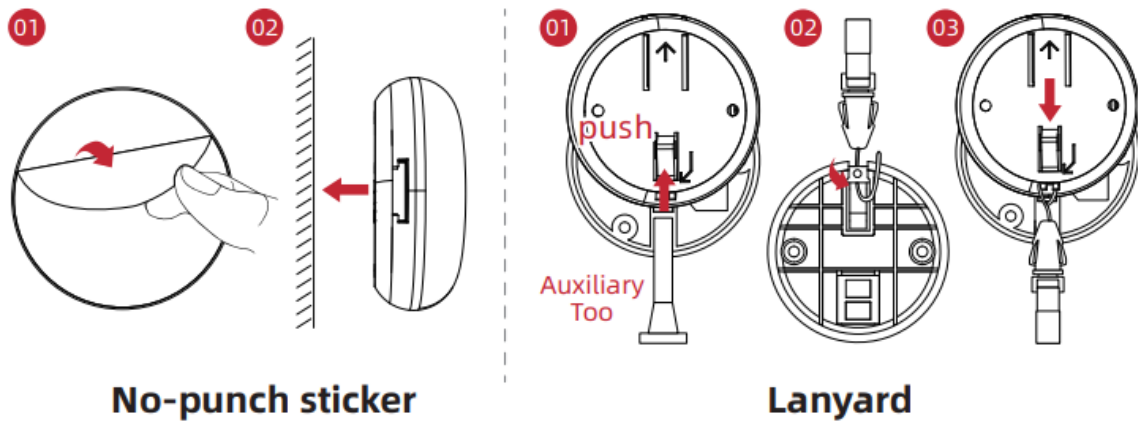

2. Call Button-Replacing Battery

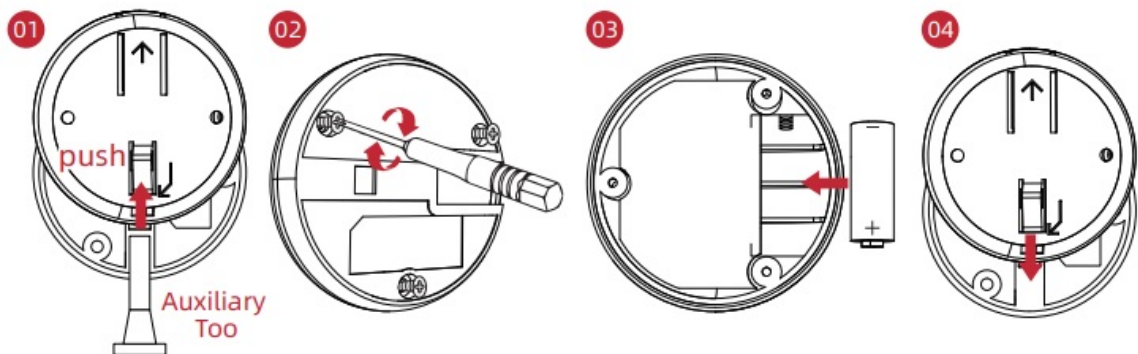

Note: For more detailed instructions, please scan the QR code on page 12 to watch.

Charge the Provided Battery

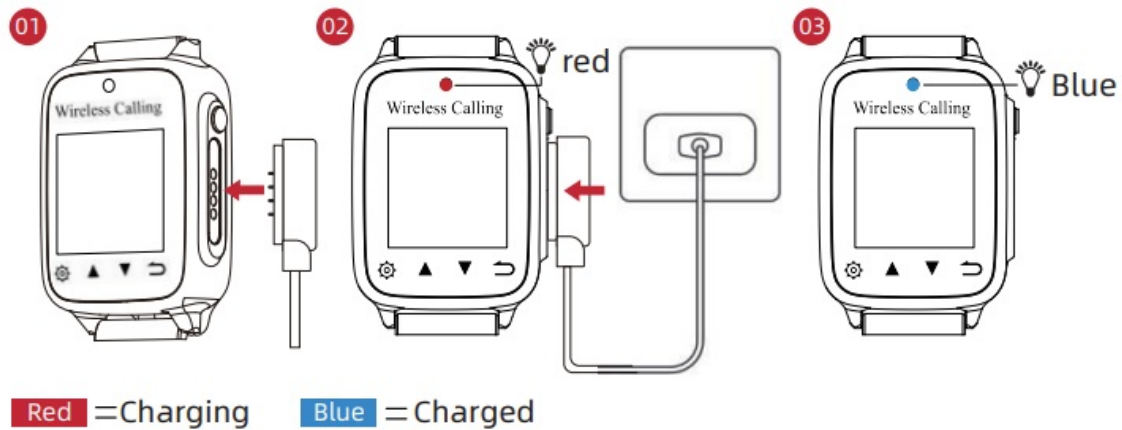

1. First, fully charge the battery by plugging
2. it into a power source using the provided cable.
3. The small light on top will glow blue once fully charged.

Technical Parameters

- Battery capacity 3.7V 450mAh
- Standby current <12mA
- Receiving frequency 433.92MHz
- Receiving sensitivity -113 dBm
- Power supply 5V 1A
- Ambient temperature -200 °C to 55°C

Question & Answer

Q: Do I need to pair the receiver and transmitter myself?

A: The receiver and transmitter are factory-paired and do not need to be paired yourself.

Q: What factors affect the use distance of the pager?

A: Obstacles near the transmitter and receiver can interfere with the signal. Avoid placing them near items like power supplies, TVs, microwaves, or iron doors.

Q: The pager cannot select the menu.

A: Long press the setup button for 5s ,enter the menu page ,short press the setup button to select next menu,

Documents / Resources

	CallTou SW11 Series Wireless Watch Calling System [pdf] Instruction Manual SW11, Q-01A, Q-01AB, SW11 Series Wireless Watch Calling System, SW11 Series, Wireless Watch Calling System, Watch Calling System, Calling System
---	--

References

- [User Manual](#)

CALLTOU
Calling System, CALLTOU, Q-01A, Q-01AB, SW11, SW11 Series, SW11 Series Wireless Watch Calling System, Watch Calling System, Wireless Watch Calling System

Leave a comment

Your email address will not be published. Required fields are marked *

Comment *

Name

Email

Website

☐ Save my name, email, and website in this browser for the next time I comment.

Post Comment

Search:

e.g. whirlpool wrf535swhz

Search

[Manuals+](#) | [Upload](#) | [Deep Search](#) | [Privacy Policy](#) | [@manuals.plus](#) | [YouTube](#)

This website is an independent publication and is neither affiliated with nor endorsed by any of the trademark owners. The "Bluetooth®" word mark and logos are registered trademarks owned by Bluetooth SIG, Inc. The "Wi-Fi®" word mark and logos are registered trademarks owned by the Wi-Fi Alliance. Any use of these marks on this website does not imply any affiliation with or endorsement.