

**CALIMET
CM9-509
1 Button
Remote
Control**



CALIMET CM9-509 1 Button Remote Control Instructions

[Home](#) » [CALIMET](#) » CALIMET CM9-509 1 Button Remote Control Instructions 

Contents

- [1 CALIMET CM9-509 1 Button Remote Control](#)
- [2 Product Usage Instructions](#)
- [3 CM9-509 1 BUTTON REMOTE CONTROL](#)
- [4 FAQs](#)
- [5 Documents / Resources](#)
 - [5.1 References](#)

CALIMET

CALIMET CM9-509 1 Button Remote Control



Product Specifications

- Model: CM9-509 1 Button Remote Control
- Battery: A23 12V
- Compatibility: Homelink Remotes
- Version: V.01.01282025

Product Usage Instructions

Remote Control Battery Replacement

CM9-509 uses an A23 12V battery. To replace the battery:

1. Unscrew the 2 screws on the back of the remote control to separate the front and back cover.
2. Gently open the remote to gain access to the remote circuit board.
3. Replace the battery with a new A23 12V battery.
4. Reassemble the remote control.
5. **Caution:** The built-in remote's antenna is a delicate part, handle it with care.

Program With Homelink Remotes

Most modern cars have a built-in feature called Homelink that lets you open your gate by pressing a button on your car. Calimet gate operators are compatible with Homelink. To set up:

1. Visit www.homelink.com/program/vehicle.
2. Enter your car model to view specific instructions for programming.

For older cars or cars without Homelink, refer to your car's manual for setup instructions.

CM9-509 1 BUTTON REMOTE CONTROL

Program New Remote by Dip Switch (FIGURE A)

1. Located the "DIP SWITCH OFF/ON" switch on the circuit board. Turn it "ON" (FIGURE A – STEP 1).
2. On the left of the ON/OFF Switch, you will find a 1-8 dip switch. Set a random switch combination to created your own code (FIGURE A – STEP 2)
3. Unscrew the back of the remote control to gain access to the control circuit board. Your should see 1- 8 dip switches. Set the same 1-8 dip switch combination as you did on the main circuit board.

NOTICE – Do not share your dip switch code and keep it safe. Anyone have access to your code will have access to your gate system.

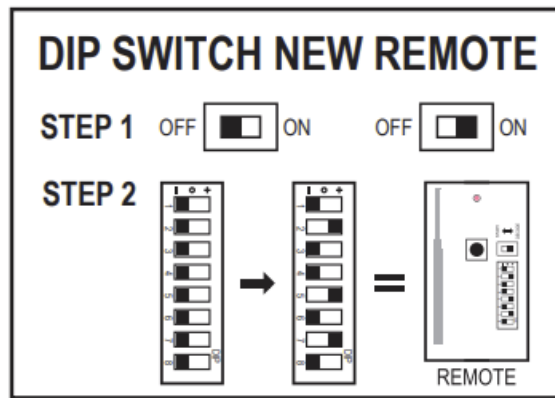

FIGURE A

Remote Control Battery Replacement

- CM9-509 uses an A23 12V battery. To replace the battery, unscrew the 2 screws on the back of the remote control to separate the front and back cover and gain access to the remote circuit board.
- **CAUTION:** The built-in remote's antenna is a very delicate part; please handle it with care.

Program With Homelink Remotes

- Most modern cars have a built-in feature called Homelink that lets you open your gate by pressing a Homelink button on your car. Calimet gate operators are compatible with Homelink. To set up please visit: "www.homelink.com/program/vehicle" and enter your car model to view specific instructions. For order cars or cars with software that isn't Homelink, check your car's manual for setup instructions.

CM9-509 USER MANUAL

- V.01.01282025

FAQs

1. What type of battery does the CM9-509 remote use?

The CM9-509 remote uses an A23 12V battery for operation.

2. How can I program the CM9-509 remote with my car's Homelink system?

To program the CM9-509 remote with your car's Homelink system, visit www.homelink.com/program/vehicle and follow the specific instructions based on your car model.

Documents / Resources

	<p>CALIMET CM9-509 1 Button Remote Control [pdf] Instructions</p> <p>CM9-509 1 Button Remote Control, CM9-509, 1 Button Remote Control, Remote Control, Control</p>
--	---

References

- [User Manual](#)

[Manuals+](#), [Privacy Policy](#)

This website is an independent publication and is neither affiliated with nor endorsed by any of the trademark owners. The "Bluetooth®" word mark and logos are registered trademarks owned by Bluetooth SIG, Inc. The "Wi-Fi®" word mark and logos are registered trademarks owned by the Wi-Fi Alliance. Any use of these marks on this website does not imply any affiliation with or endorsement.