



A7700 Series Panic Exit Device



CAL-ROYAL A7700 Series Panic Exit Device Installation Guide

[Home](#) » [CAL-ROYAL](#) » CAL-ROYAL A7700 Series Panic Exit Device Installation Guide 

Contents

- [1 CAL-ROYAL A7700 Series Panic Exit Device](#)
- [2 Product Usage Instructions](#)
- [3 Frequently Asked Questions](#)
- [4 INSTALLATION INSTRUCTIONS](#)
- [5 Documents / Resources](#)
 - [5.1 References](#)



CAL-ROYAL A7700 Series Panic Exit Device



Specifications

- **Series:** A7700
- **Application:** Panic Exit Device
- **Door Compatibility:** Fits 36" doors, can be cut down to fit doors as narrow as 30" wide; Fits 48" doors, can be cut down to fit doors as narrow as 36" wide
- **Hand Orientation:** Right Hand or Left Hand
- **Impact Rating:** Panic bar set screws must be activated at the top and bottom of the push rail for impact rating

Product Usage Instructions

Prepare Door

- For 2 1/8" bore prep, position the template over the existing hole and mark for two chassis mounting screw holes. Ensure vertical chassis is parallel to the door edge.
- For doors without bore prep, mark vertical and horizontal chassis using provided dimensions and mounting screw holes.

Apply Hardware

- Install lever trim and mortise cylinder according to the provided instructions.

Apply Rail Assembly

- Check the size of the device and cut to length if required.
- Determine the cut-off length by subtracting 1-3/4" from Y and mark the cut-off point on the mounting rail.
- Depress the arm into the rail opening and slide the rail onto the chassis. Level rail and fasten chassis and mounting plate securely.

Apply Cover and Strikes

- Attach the mounting plate to the door with provided round-head screws.
- Attach cover to chassis with provided truss head machine screws.
- Attach the end cap to the mounting plate with cover screws.
- Attach strike to door stop with provided strike screw and lock washer.

Frequently Asked Questions

Q: Can the panic exit device be installed on both right-hand and left-hand doors?

A: Yes, the panic exit device is designed to be installed on both right-hand and left-hand doors. Ensure correct orientation during installation.

Q: How do I achieve the impact rating for the panic exit device?

A: The panic bar set screws must be activated at the top and bottom of the push rail to achieve the impact rating. Follow the installation instructions carefully for proper installation.

INSTALLATION INSTRUCTIONS

BEFORE INSTALLING THE DEVICE, PLEASE CHECK

1. IF DOOR IS FITTED AND HUNG
2. SIZE OF EXIT DEVICE, FUNCTION AND DESIGN ...
 - 36" DOORS, CAN BE CUT TO FIT DOORS DOWN TO 30" WIDE.
 - 48" DOORS, CAN BE CUT TO FIT DOORS DOWN TO 36" WIDE.
 - HAND OF DEVICE AGAINST APPLICATION.

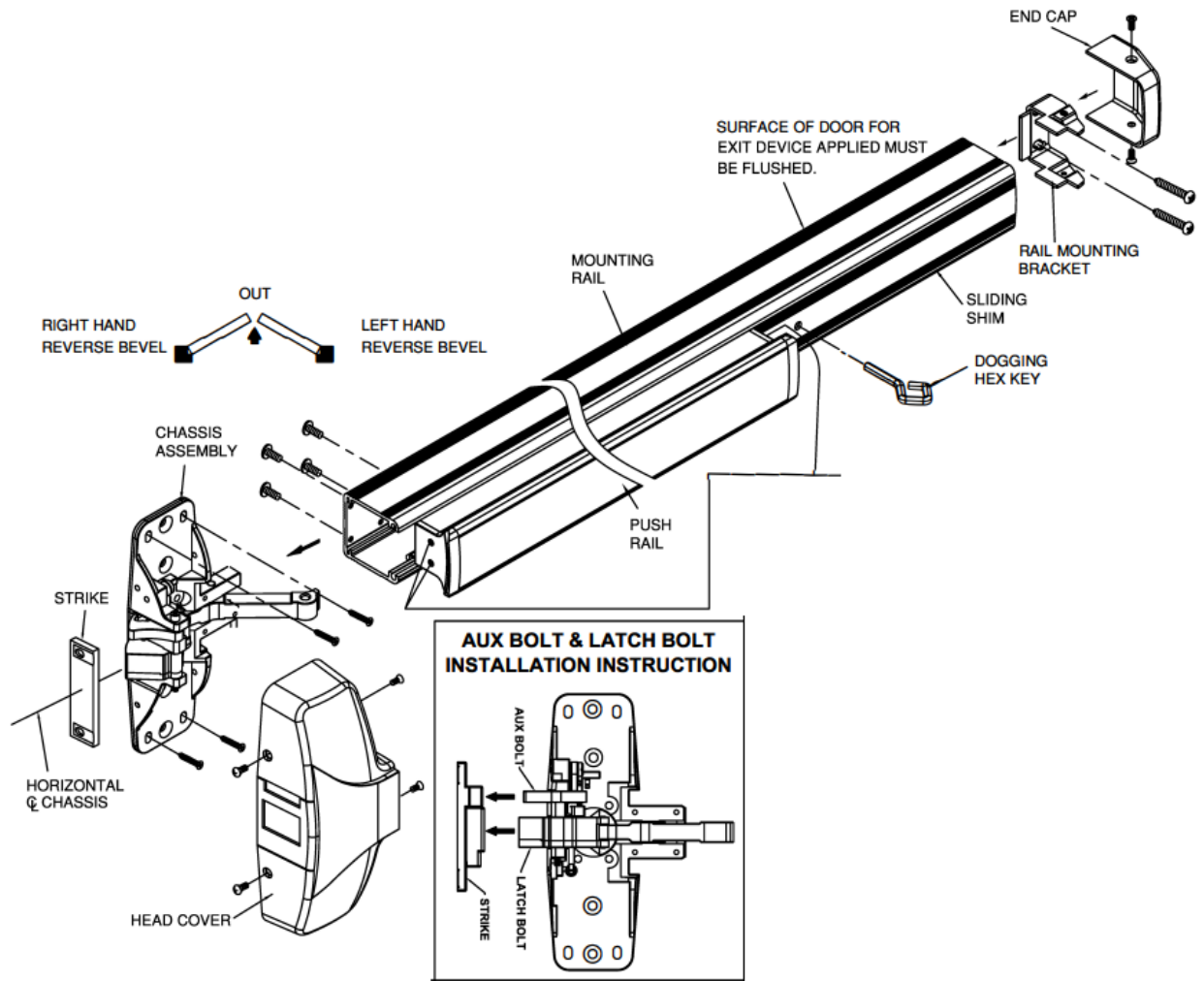

- PANIC BAR SET SCREWS (12-24 X 5/16") MUST BE ACTIVATED AT THE TOP AND BOTTOM OF THE PUSH RAIL TO ACHIEVE IMPACT RATING.
- SET SCREWS TO BE USED IN THE EVENT OF IMMINENT SEVERE WEATHER OF HURRICANE FORCE.

PREPARE DOOR

- FOR 21/8" BORE PREP.
- POSITION TEMPLATE OVER EXISTING HOLE AND MARK FOR TWO CHASSIS MOUNTING SCREW HOLES.

ENSURE VERTICAL \odot CHASSIS
PARALLEL TO DOOR EDGE.

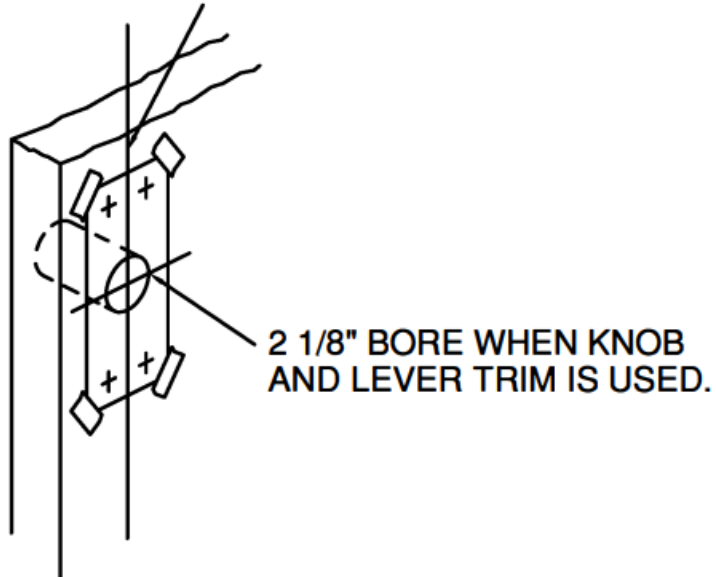

- FOR DOOR W/O BORE PREP, MARK VERTICAL. CHASSIS AND HORIZONTAL CHASSIS USING DIMENSIONS BELOW.
- MOUNTING SCREW HOLES.

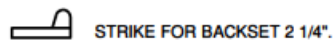
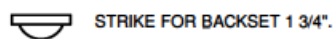
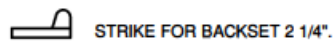
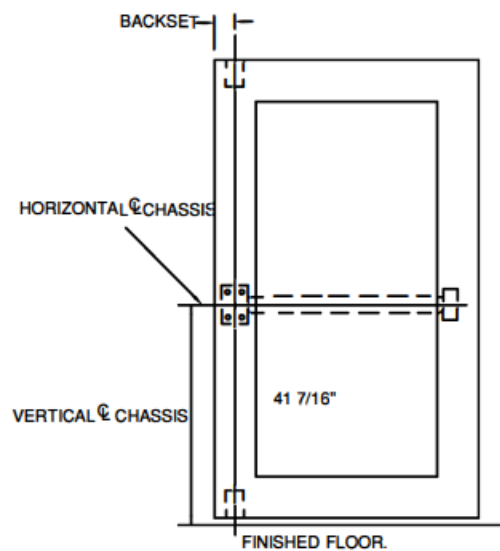

- IDENTIFY THE TYPE OF INSTALLATION TO DETERMINE THE LOCATION OF VERTICAL

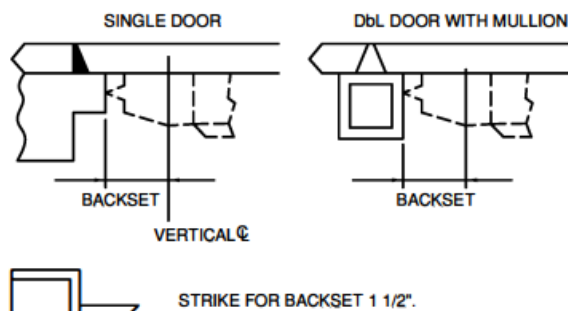

APPLY HARDWARE

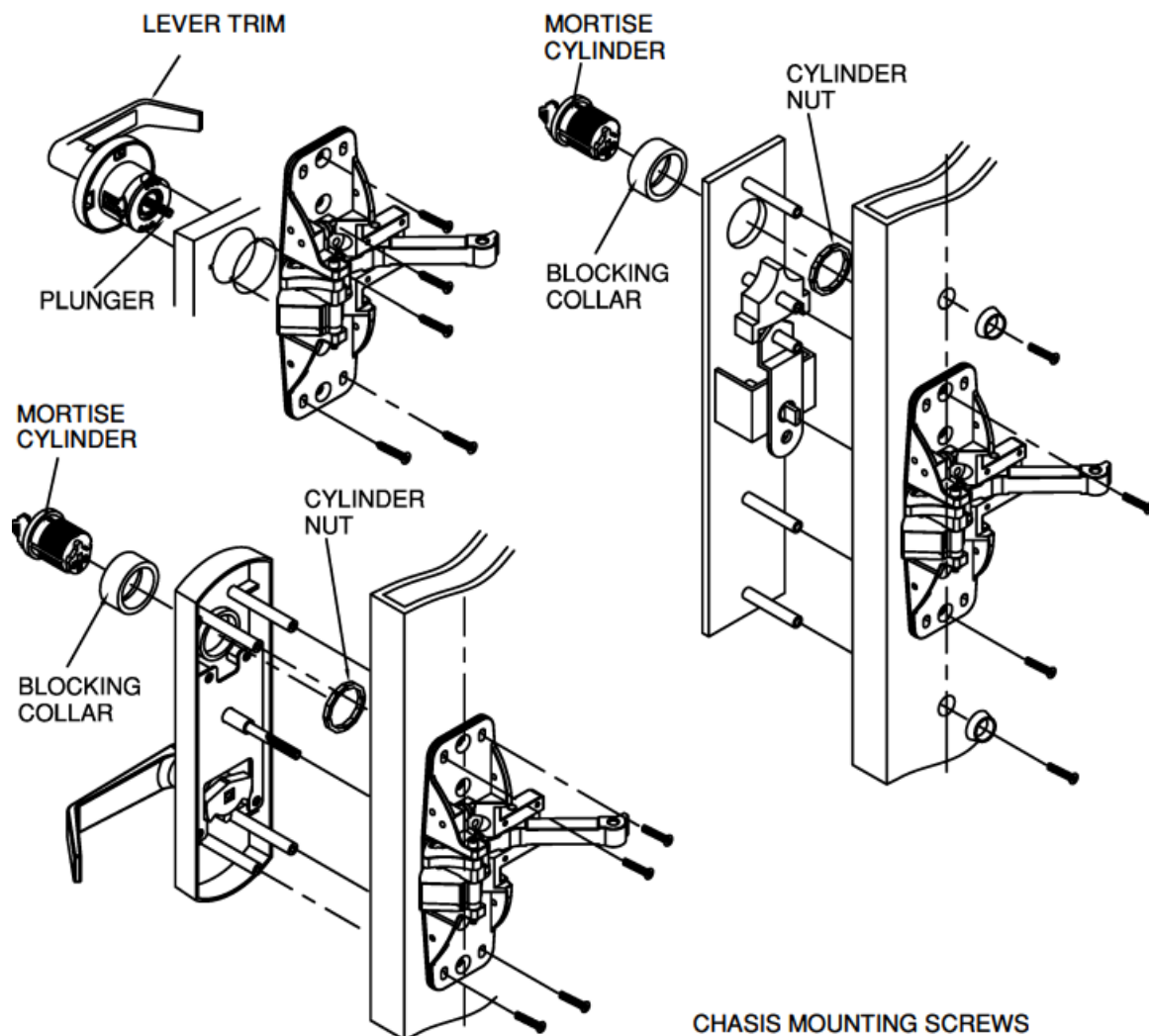

APPLY RAIL ASSEMBLY

- CHECK THE SIZE OF THE DEVICE, IF CUTTING TO LENGTH IS REQUIRED.
- 2 DETERMINE CUT-OFF LENGTH "X" BY SUBTRACTING 1-3/4" FROM "Y". MARK THE CUT-OFF POINT ON THE MOUNTING RAIL.
- DEPRESS THE ARM INTO THE RAIL OPENING AND SLIDE THE RAIL ONTO THE CHASSIS. LEVEL RAIL AND FASTEN CHASSIS AND MOUNTING PLATE.

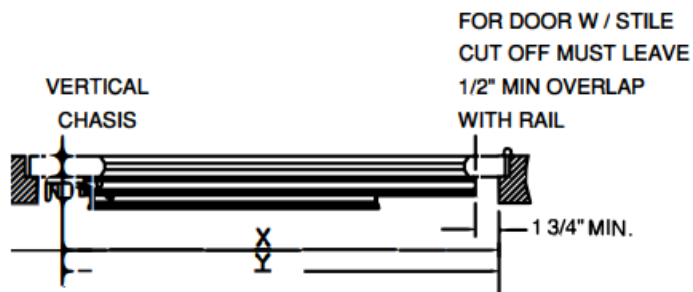

CUT OFF AND DEBURR

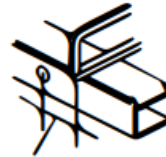

DON'T CUT CLOSER THAN 1-3/4" FROM LOWER PIUOT.

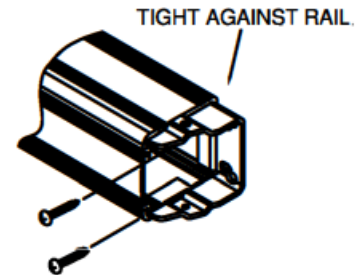
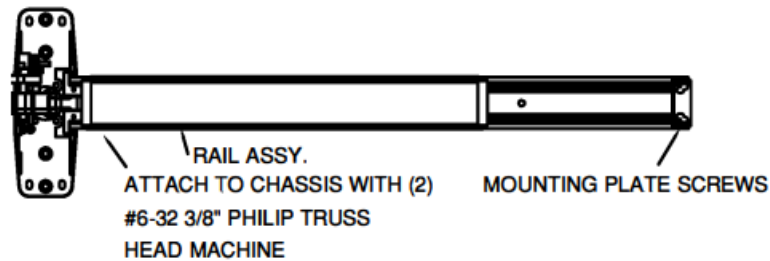

ATTACH MOUNTING PLATE TO DOOR WITH (3) ROUND HEAD SCREWS.

APPLY COVER AND STRIKES

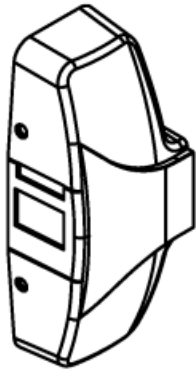

ATTACH COVER TO CHASSIS WITH (4) #8 TRUSS HEAD MACHINE SCREW.

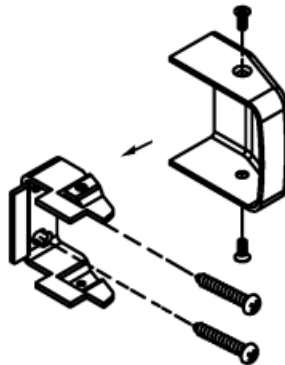

ATTACH END CAP TO MOUNTING PLATE WITH (2) COVER SCREWS.

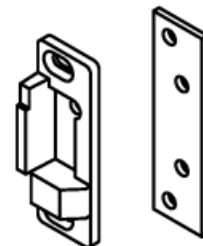

ATTACH STRIKE TO DOOR STOP WITH (2), STRIKE SCREW AND LOCK WASHER

DRWG.# EDG-4100-09/24-1of1

Documents / Resources

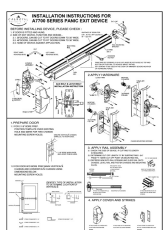

[CAL-ROYAL A7700 Series Panic Exit Device](#) [pdf] Installation Guide
A7700 Series Panic Exit Device, A7700 Series, Panic Exit Device, Exit Device, Device

References

- [User Manual](#)

Manuals+. Privacy Policy

This website is an independent publication and is neither affiliated with nor endorsed by any of the trademark owners. The "Bluetooth®" word mark and logos are registered trademarks owned by Bluetooth SIG, Inc. The "Wi-Fi®" word mark and logos are registered trademarks owned by the Wi-Fi Alliance. Any use of these marks on this website does not imply any affiliation with or endorsement.