



CAKE Osa Plus Upper Windshield Instructions

[Home](#) » [cake](#) » CAKE Osa Plus Upper Windshield Instructions 

CAKE Osa Plus Upper Windshield



Contents

[1 Installation Instructions](#)

[2 Documents / Resources](#)

[3 Related Posts](#)

Installation Instructions

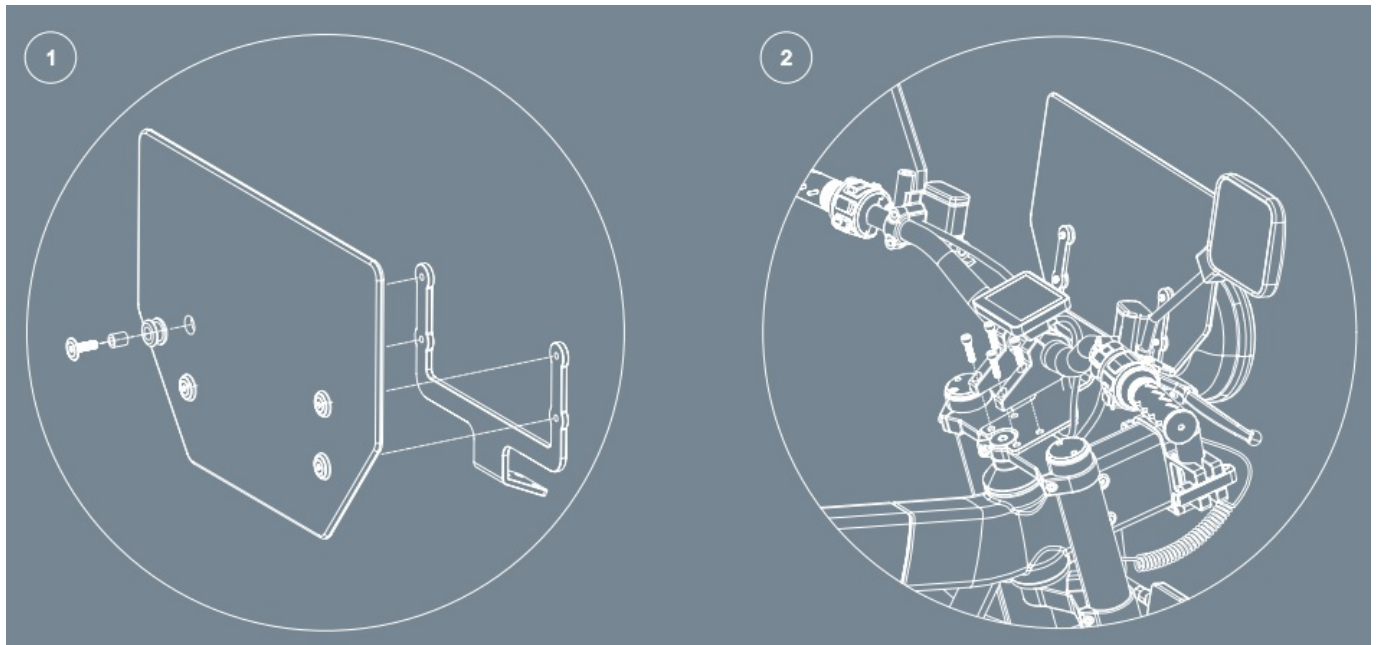

Items	Instructions	
①	Assemble the spacers onto the windshield. Mount it to the bracket with the four torx screws.	Fasteners included 4x torx screws 4x hex screws 4x metal spacers 4x rubber spacers
②	Remove the stem from the bike by removing the four screws. Install windshield using the four new hex screws.	Tools needed Torx 20 Hexkey 5 mm

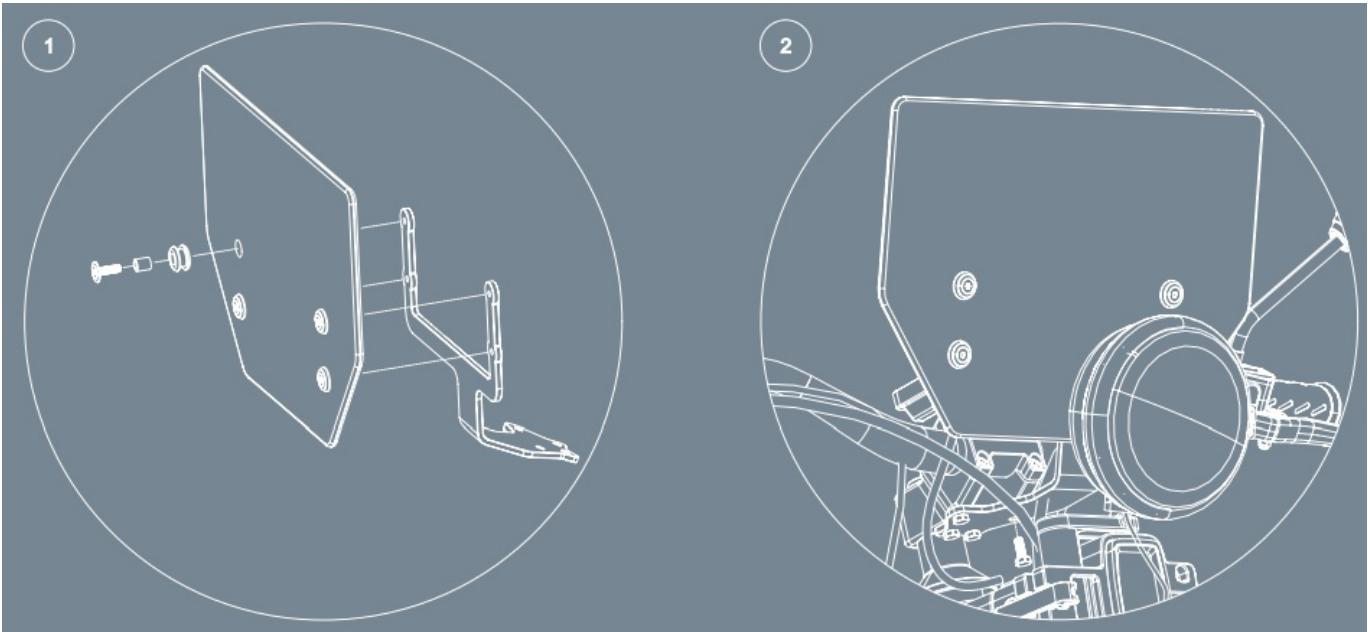

Items	Instructions	
①	Insert spacers into holes in windshield. Mount windshield to bracket using the four torx screws.	Fasteners included 4x torx screws 4x hex screws 4x metal spacers 4x rubber spacers
②	Mount the bracket under the stem using the four bolts. Tip: Make a full turn with the handlebar for better access to the screw holes.	Tools needed Torx 20 Hexkey 5 mm

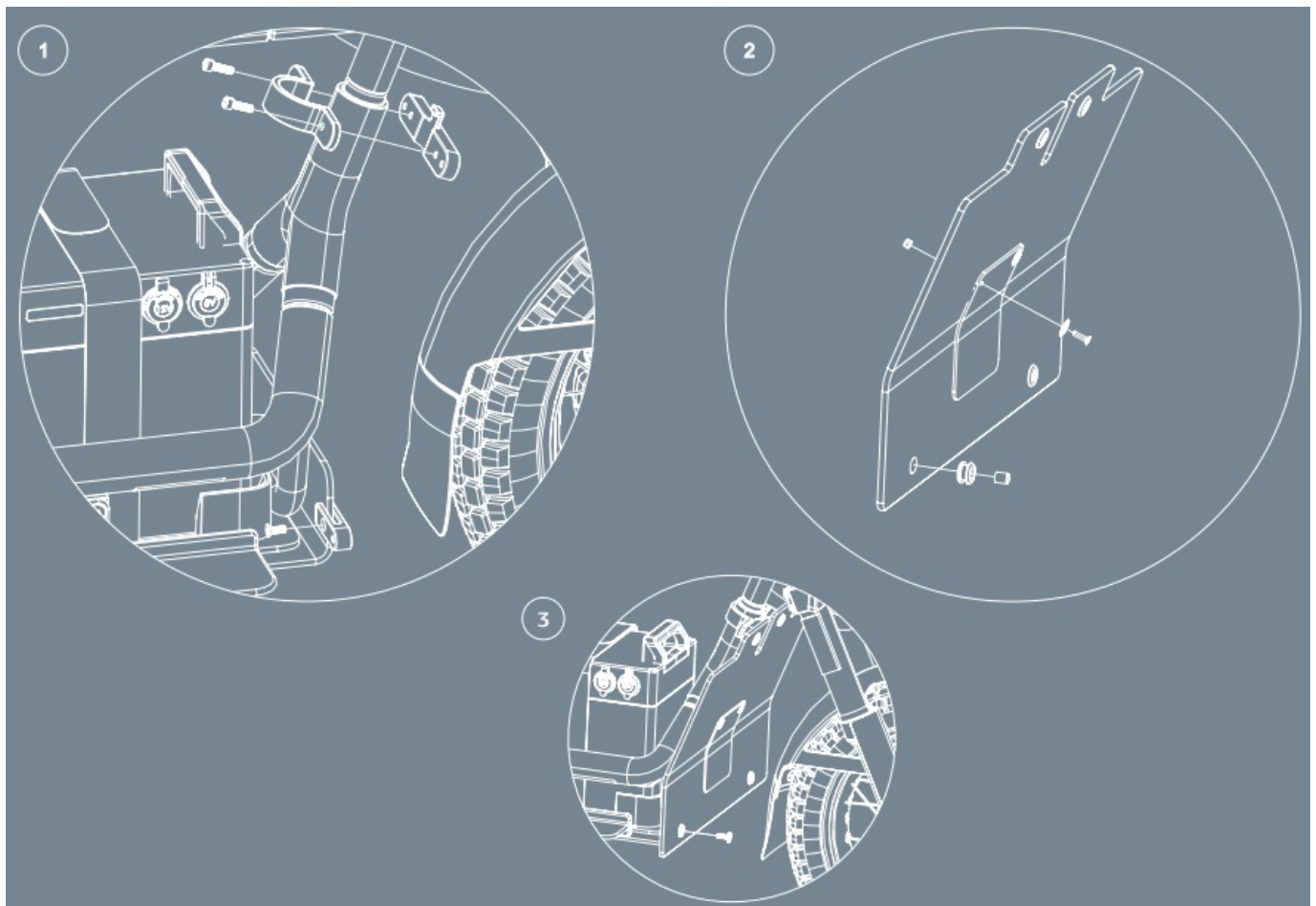

Items	Instructions	
①	Install the clamps on the bike. The two small clamps goes on the skid plate, one on each side of the bike, and the big clamp goes on the down tube. Make sure that the big clamp is on the correct height. The hook should be on top of the edge. Apply loctite to all screws and tighten to 10Nm.	Fasteners included 4x flat head screw 2x M6 torx screw 2x M4 torx screw 2x M6 hex screw 2x washer 2x M4 nut 4x rubber spacer 4x metal spacer
②	Insert the spacers into the holes in the windshields and install the mud flap using the two screws, washers and nuts.	Tools needed Torx 20 Torx 30 Hex key 5 mm Wrench 7 mm
③	3. Install the windshield on the bike by screwing it onto the clamps. Apply Loctite to all screws and tighten to 10Nm.	

NOTE: If the Ösa has a :work front carrier, you must use the :work edition of the windshield with holes for the carrier elbows. The elbows does then have to be dismantled first and then reinstalled again after the windshield is in place.

1

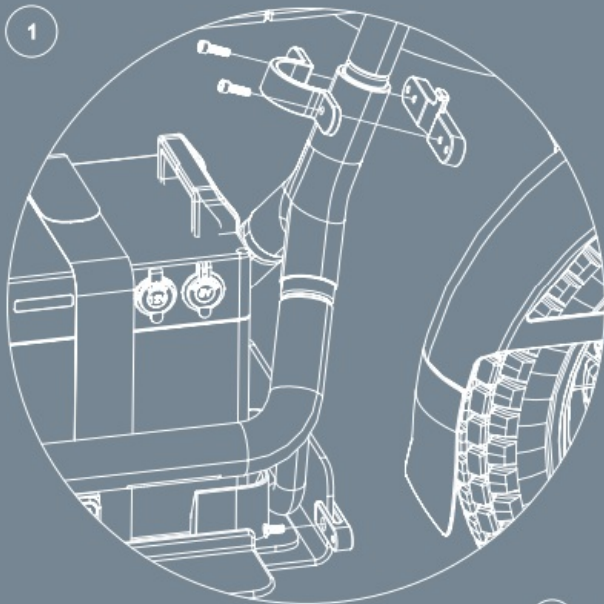

2

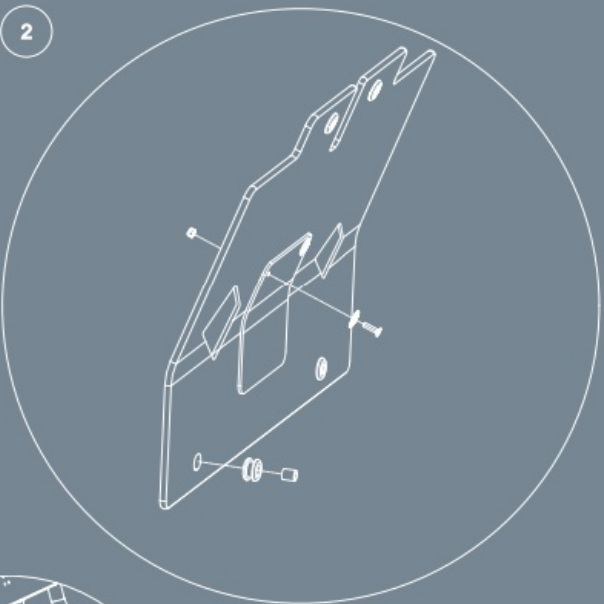

3

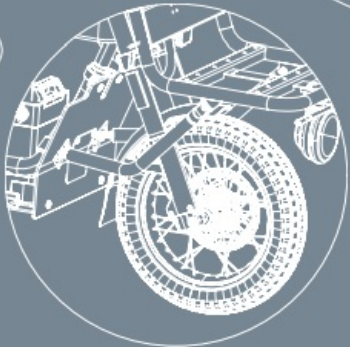

Items	Instructions	
①	Install the clamps on the bike. The two small clamps goes on the skid plate, one on each side of the bike, and the big clamp goes on the down tube. Make sure that the big clamp is on the correct height. The hook should be on top of the edge. Apply loctite to all screws and tighten to 10Nm.	Fasteners included 4x flat head screw 2x M6 torx screw 2x M4 torx screw 2x M6 hex screw 2x washer 2x M4 nut 4x rubber spacer 4x metal spacer
②	Insert the spacers into the holes in the windshields and install the mud flap using the two screws, washers and nuts.	Tools needed Torx 20 Torx 30 Hex key 5 mm Wrench 7 mm
③	Dismount the elbows of the front carrier. Then install the windshield on the bike by screwing it onto the clamps. Reinstall the carrier elbows again after the windshield is in place. Apply Loctite to all screws and tighten	

Please contact your local CAKE service center if you need support

Documents / Resources

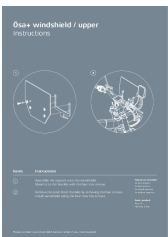
	CAKE Osa Plus Upper Windshield [pdf] Instructions Osa Plus, Upper Windshield, Osa Plus Upper Windshield, Windshield
---	--