



CADAC 2017001 Bluetooth Thermometer Instruction Manual

[Home](#) » [CADAC](#) » CADAC 2017001 Bluetooth Thermometer Instruction Manual 

Contents

- [1 CADAC 2017001 Bluetooth Thermometer](#)
- [2 General](#)
- [3 In the box](#)
- [4 Quickstart instructions](#)
- [5 Powering On & Off](#)
- [6 Connecting](#)
- [7 Disconnecting](#)
- [8 Positioning of magnetic base](#)
- [9 Probe](#)
- [10 APP functions](#)
- [11 Warranty](#)
- [12 Documents / Resources](#)
- [13 Related Posts](#)



CADAC 2017001 Bluetooth Thermometer



General

Thank you for purchasing the i-Braai thermometer. To get started, simply follow the below steps to help guide you on how to set up and how to operate the app and its functions.

In the box

- 1x i-Braai thermometer
- 1x Coin cell battery (installed)
- 1x Meat probe
- 1x Magnetic base

Quickstart instructions

Download the CADAC i-Braai app from the App Store® or Google Play™ store by typing in “i-Braai” as the keyword in the search bar .The CADAC i-Braai is compatible with the following devices:



Fig. 1

- iPhone® (4S and later)
- iPad® (3rd generation and later)
- iPad mini™ (all generations)
- iPod touch® (5th generation and later)
- Android™ devices equipped with
- Bluetooth® 4.0 and running Android™ software version 4.3 or later

Separate the i-Braai from its base by firmly holding the base with one hand and gently pulling the i-Braai top upwards with the other hand. On the underside of the i-Braai, turn and open the battery cover by twisting it counter-clockwise, remove the plastic lint and replace the cover.

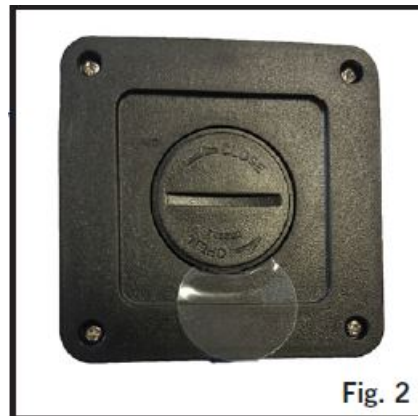

Place the i-Braai top back onto its base. Plug the probe into the probe port of the i-Braai. Enable Location and then Bluetooth® on your smart device under 'Settings'. Tap the power button located at the bottom of the faceplate. Open the CADAC i-Braai App on your smart device. Press on search in the centre of the app and it will automatically pair with your i-Braai thermometer .

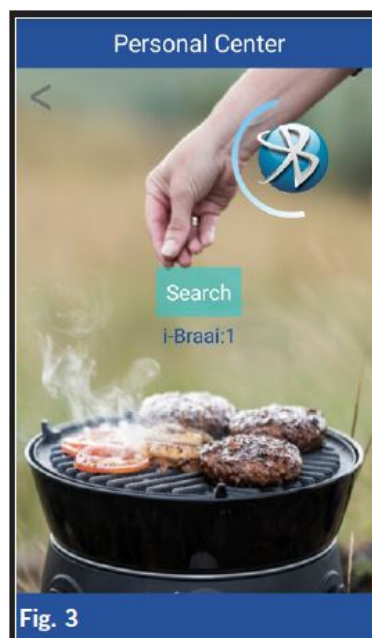

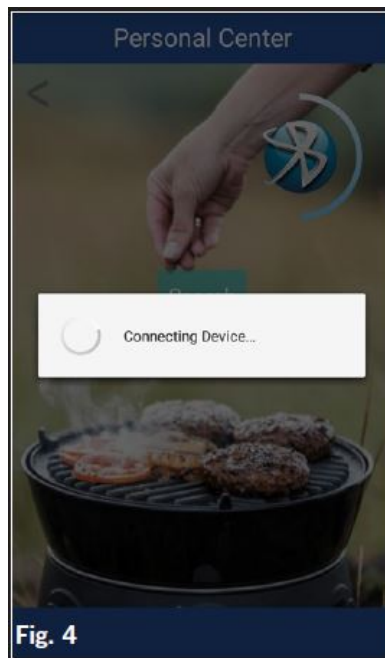

Fig. 4

You are now connected and ready to use your i-Braai.

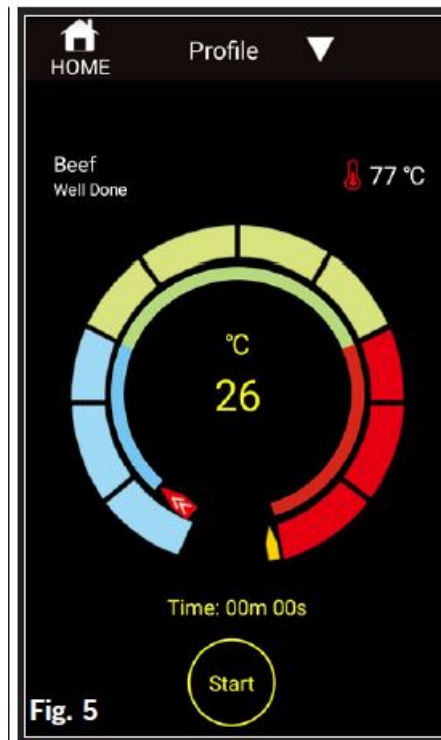

Fig. 5

Powering On & Off

To turn on the i-Braai follow these steps:

- Make sure the probe is installed
- Press the power button located at the centre of the faceplate once.
- Press the power button again quickly to change between Celsius and Fahrenheit..

To turn off the i-Braai follow these steps:

Press and hold down the power button located in the centre of the faceplate for several seconds.

Connecting

To connect your i-Braai to your iPhone®, iPad®, iPod touch® or Android™ device follow these steps:

- Open Settings.
- Set Location to On.
- Tap Bluetooth®.
- Set Bluetooth® to On.
- While turned on, place your i-Braai thermometer next to your smart device and open the i-Braai App.
- Select “Search” in the centre of the screen.

Disconnecting

To disconnect your i-Braai device from your iPhone®, iPad®, iPod Touch® or Android™ device, follow these steps:

- While turned on, place your i-Braai next to your smart device and select the home screen.
- Tap “Pair” in the top left corner of the screen.
- Tap “Disconnect” in the centre of the screen.

Positioning of magnetic base

- The base of the i-Braai is magnetic for convenient positioning on a cool portion of your grill, smoker or other magnetic surfaces.
- The magnetic base is not designed to withstand high heat and it must be placed on a cool surface.

Probe

- Meat probes should always be inserted into the centre of the item being cooked for an accurate temperature reading.
- When using the standard meat probe, be sure to route the probe wire where it will not be exposed to flames or temperatures exceeding 572°F / 300°C).
- The probe should be cleaned by hand with a damp towel or sanitary wipe. The probe is not dishwasher safe. Take precaution not to get the wiring of the probe wet.
- Be sure to avoid water exposure to the wiring of the probes as well as the area where the wiring and crimp meet the probe.
- The probe is not waterproof and damage may result from water exposure.
- The probe should never be submersed in water.

APP functions

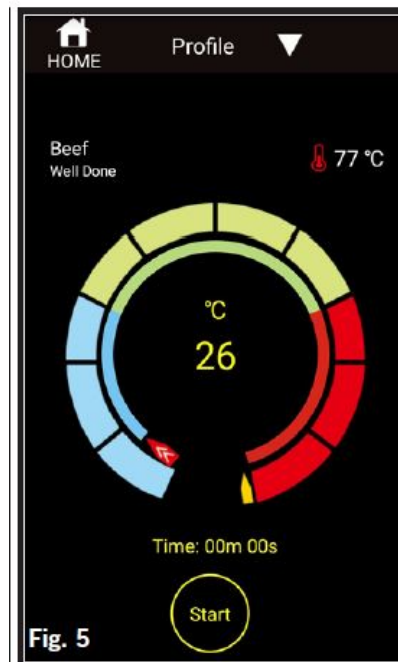

- The i-Braai App offers pre-set alarms for many types of meats and cooking temperatures. Tapping profile and then meat type will take you to the pre-set alarms.
- Change between type of meats by tapping the meat type or temperature mark.
- Once the meat is selected, you can 'Select Your Doneness.'
- Tap "Back" and then "Start" to commence.
- You can also create your own custom pre-set alarm for any desired temperature by tapping profile and then type of meats or temperature mark.
- You can choose to bypass the pre-set alarms by choosing "Temperature" or "Timer".
- For "Temperature" choose the desired doneness and then start.
- For "Timer" choose the time and then start for the countdown to commence.

CAMERA

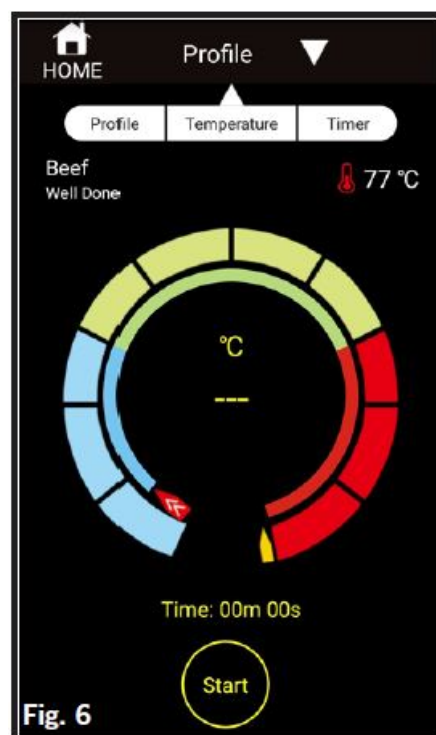

SETTINGS



- Choose your alarm tone by doing the following:
- Select profile to view the sound options.
- Tap on each tone to hear and select the desired ton sound.

SUPPORT

Instruction manual

VERSION

Version of the installed APP

Warranty

CADAC (Pty) Ltd hereby warrants to the ORIGINAL PURCHASER of this CADAC product, that it will be free of defects in material and workmanship from the date of purchase for 2 years. The warranty will only apply if the unit is assembled and operated in accordance with the printed instructions. CADAC may require reasonable proof of your date of purchase. THEREFORE, YOU SHOULD RETAIN YOUR SALES SLIP OR INVOICE. This Limited Warranty shall be limited to the repair or replacement of parts that prove defective under normal use and service and which on examination shall indicate, to CADAC's satisfaction, they are defective. Before returning any parts, contact the customer service representative in your region. If CADAC confirms the defect and approves the claim, CADAC will elect to replace such parts. This Limited Warranty does not cover any failures or operating difficulties due to accident, abuse, misuse, alteration, misapplication, vandalism, improper installation or improper maintenance or service, or failure to perform normal and routine maintenance. Deterioration or damage due to severe weather conditions such as hail, hurricanes, earthquakes or tornadoes, discoloration due to exposure to chemicals either directly or in the atmosphere, is not cover by this Limited Warranty. There are no other express warrants except as set forth herein and any applicable implied warranties of merchantability and fitness are limited in duration to the period of coverage of this express written limited warranty. Some regions do not allow limitation on how long an implied warranty lasts, so this limitation may not apply to you. CADAC is not liable for any special, indirect or consequential damages. Some regions do not allow the exclusion or limitation of incidental or consequential damages, to this limitation or exclusion may not apply to you. CADAC does not authorize any person or company to assume for it any obligation or liability in connection with the sale, installation, use, removal, return, or replacement of its equipment; and no such representations are binding on CADAC. This

Warranty applies only to products sold at retail.

Documents / Resources

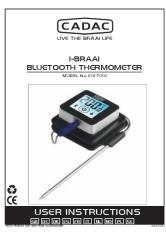
	<p>CADAC 2017001 Bluetooth Thermometer [pdf] Instruction Manual 2017001 Bluetooth Thermometer, 2017001, Bluetooth Thermometer</p>
---	---