



## C-PEN Exam Reader 2 Scanning Pens User Guide

[Home](#) » [C-PEN](#) » C-PEN Exam Reader 2 Scanning Pens User Guide 



EMPOWERING PEOPLE  
QUICK START GUIDE  
EXAM READER



REGISTER your C-PEN to get notified about future updates

[cpen.com/contact/product-registration](https://www.cpen.com/contact/product-registration)



<https://www.cpen.com/c-pen-product-registration/>

## Contents

- 1 Congratulations to your advanced C-Pen Exam
- 2.
- 2 Let's get started!
- 3 Button and connectors
- 4 USB connectivity
- 5 Safety Precautions for Battery Usage
- 6 BATTERY maintenance and precautions
- 7 Declaration of Conformity
- 8 Documents / Resources
  - 8.1 References
- 9 Related Posts

## Congratulations to your advanced C-Pen Exam 2.

C-PEN Exam 2 is designed with the purpose of being a reading assistant. Being a closed device with no means to store any data onto it, it is especially well suited for use in exams where it, similar to a human reader, simply reads the questions.

Whether you need to read questions in an exam, do your homework, or simply want to read your favourite novel, we hope reading becomes less challenging and more enjoyable.

The purpose of this guide is to get you started. It does not provide a complete description of all functions and settings as they change by each firmware upgrade we provide. Therefore, for latest and more complete information check our website [www.cpen.com/products/exam2](http://www.cpen.com/products/exam2) and our Youtube channel [cpen.com/youtube](http://cpen.com/youtube)

## Let's get started!

1. Press and hold the power button for 3 seconds, then release it. if the display doesn't light up, charge the battery for about 30 minutes and then give it a second try.
2. At first use, a guide will help you set up your C-Pen Exam 2. This includes settings for
  - Talking Menu (reads menu out loud)
  - Menu language (user interface language)
  - Scan language (language of text to scan)
  - Voice (as some languages supports more than one accent)
  - Left/Right handed (hand holding the pen)

After this, you reach the menu, the Reader function is the only available function. Use it to scan and listen to the text being read out loud to you. Press the OK button to listen to the text as many times as you want. Or press the MENU button to access options such as reading speed, volume, reading pauses, reading language and dictionaries. If you like, you can connect a pair of earphones so that only you can hear the C-Pen Exam 2.

### How to scan

Hold the C-Pen Exam 2 almost straight up. Make sure that you do not press any buttons during a scan. The pen scans one (1) text line at a time and this text line shall be centered in between the two white nibs in the front of the pen. Scanning start and stop points are aligned with the edge of the transparent window. When the Scan Trigger 2 gets in touch with the paper, the scan light lights up. Start moving the pen straight along the text line at a steady pace.

## Button and connectors

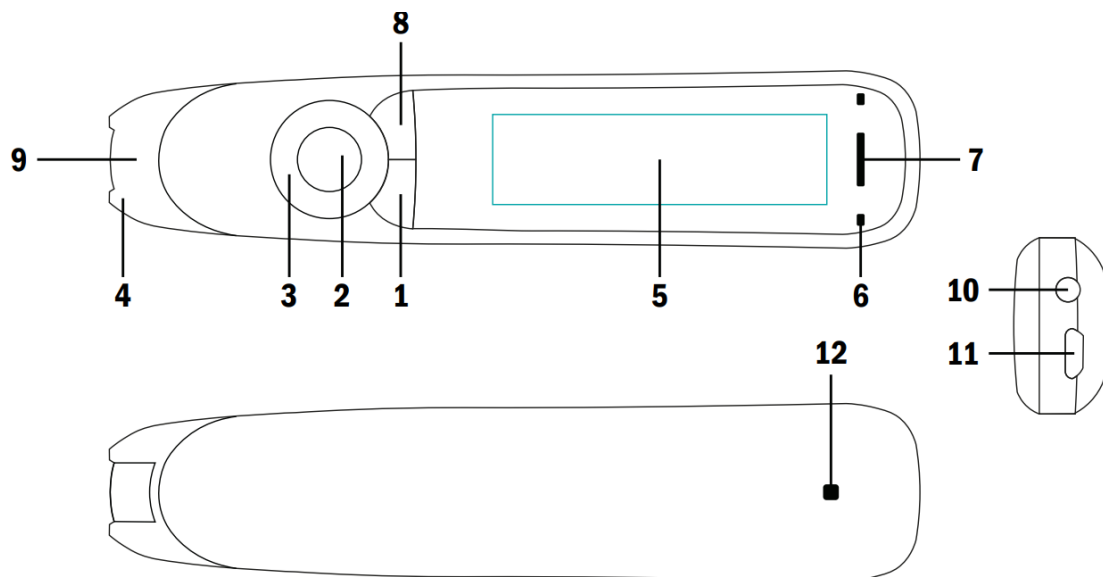

1. Power On/Off & Back button: press 3 seconds to turn on the device. Press briefly to cancel operations in the user interface.
2. OK button: press to confirm an operation or to trigger reading text out loud in Text Reader mode.
3. 4-way Nav button: move focus up, down, left, right.
4. Scan Trigger: automatically activated when the pen is in contact with the paper. It also turns on the scanlight
5. Screen
6. N/A.
7. Speaker: used when text is read out loud. Muted if earphones are connected.
8. Menu button
9. Scanning window: frames the text to be scanned
10. Earphone jack
11. Micro USB connector: used for charging or connecting to a computer when updating firmware.
12. Reset button: resets the device. It is recommended to use this button only when the device cannot be turned off properly.

## C-Pen Exam 2 functions

### Talking menu

When turned on, all menu items are read out loud to support e.g. visually impaired users. Switch on or off under Settings in the main menu.

### Reader

Scan a word, line of text or paragraph and have the text read aloud to you. C-Pen Exam 2 can be set to read text automatically when scanned, or just read text on the screen when you press the OK button. When listening to the text, you can pause it by pressing the OK button, and the scanned text can be read out as many times as you like. Use the navigation buttons to select the starting point, then press the OK button and listen. When a specific word is selected, press and hold the OK button to zoom in on it and have it read aloud.

## USB connectivity

USB is used for charging the built-in battery, and to update the embedded C-Pen Exam 2 firmware. For details about update, visit [support.cpen.com](http://support.cpen.com).

## Safety Precautions for Battery Usage

THE LITHIUM BATTERY IS HAZARDOUS. ANY ATTEMPT TO DISASSEMBLE THE BATTERY IS NOT ALLOWED. IF YOU DISASSEMBLE OR REPLACE THE BATTERY, IT MAY EXPLODE. THROWING IT INTO A FIRE MAY ALSO CAUSE AN EXPLOSION. KEEP THE BATTERY AND THE DEVICE DRY, AND AWAY FROM WATER OR OTHER LIQUID TO AVOID SHORT-CIRCUIT. MAKE SURE NOT TO USE THE BATTERY WHEN IT IS DAMAGED, DEFORMED, DISCOLORED OR OVERHEATED OR EMITS AN ODOR. THIS PRODUCT SHOULD BE USED WITH CARE IN TROPICAL REGIONS. IF YOU HAVE QUESTIONS ON HOW TO USE THE PEN, PLEASE CONTACT OUR TECHNICAL SUPPORT/SERVICE FOR HELP.

## **BATTERY maintenance and precautions**

Battery capacity deteriorates over time. To optimize battery life time:

- Charge battery prior to becoming completely empty.
- Do not expose the battery to heat longer than necessary (above 30°C is considered hot).
- Disconnect charger as soon as possible after battery becoming fully charged.
- Especially do not leave battery flat as it may harm the battery.
- EVEN IF THE DEVICE IS NOT USED FOR A LONGER PERIOD IT'S RECOMMENDED TO CHARGE THE BATTERY AT LEAST EVERY THREE MONTHS

## **Declaration of Conformity**

Virrata AB hereby declares that the products C-Pen Exam 2, C-Pen Reader 2, Exam Reader, Reader Pen, Lingo Pen, Reader Pen Secure all comply with requirements Electromagnetic Compatibility Directive 2014/30/EU and 93/68/EEC -CE Marking directive and with SI 2016/1091 requirements – UKCA.

Warning – any changes or modifications not expressly approved by the party responsible for compliance could void the user's authority to operate the equipment.

This device complies with part 15 of the FCC Rules. Operation is subject to the following two conditions: (1) This device may not cause harmful interference, and (2) this device must accept any interference received, including interference that may cause undesired operation.

**Note:** This equipment has been tested and found to comply with the limits for a Class B digital device, pursuant to part 15 of the FCC Rules. These limits are designed to provide reasonable protection against harmful interference in a residential installation. This equipment generates, uses, and can radiate radio frequency energy and, if not installed and used in accordance with the instructions, may cause harmful interference to radio communications. However, there is no guarantee that interference will not occur in a particular installation. If this equipment does cause harmful interference to radio or television reception, which can be determined by turning the equipment off and on, the user is encouraged to try to correct the interference by one or more of the following measures:

- Reorient or relocate the receiving antenna.
- Increase the separation between the equipment and receiver.
- Connect the equipment into an outlet on a circuit different from that to which the receiver is connected.
- Consult the dealer or an experienced radio/TV technician for help.

FCC Radiation Exposure Statement: This equipment complies with FCC radiation exposure limits set forth for an uncontrolled environment. This transmitter must not be co-located or operating in conjunction with any other antenna or transmitter. This equipment should be installed and operated with minimum distance 20cm between the radiator & your body.

## **RoHS Declaration**

Based on information provided by our suppliers this product meets the requirements of RoHS Directive 2015/863/EU. The maximum concentration value of the prohibited six substances of "RoHS Directive" do not exceed the following:

- Cadmium and its compounds: 0.01% (100 ppm) by weight in homogeneous materials.
- Lead and its compounds, Mercury and its compounds, Hexavalent chromium and its compounds, Poly Brominated biphenyls (PBB), Poly Brominated diphenyl ethers (PBDE): 0.1% (1000 ppm) by weight in homogeneous materials.

### WEEE Notice

The Directive on Waste Electrical and Electronic Equipment (WEEE) which entered into force as European law on 13th February 2003 resulted in a major change in the treatment of electrical equipment at end-of-life. The purpose of this Directive is a first priority the prevention of WEEE and in addition to promote the reuse, recycling and other forms of recovery of such wastes so as to reduce disposal. The WEEE logo on the product or on its box indicates that this product must not be disposed of or dumped with your other household waste. You are liable to dispose of all your electronic or electrical waste equipment by relocating over to the specified collection point for recycling of such hazardous waste. Isolated collection and proper recovery of your electronic and electrical waste equipment at the time of disposal will allow us to help conserving nature resources. Moreover, proper recycling of the electronic and electrical waste equipment will ensure the safety of human health and environment. For more information about electronic and electrical waste equipment disposal, recovery and collection points, please contact your local city center household waste disposal service shop from where you purchased the equipment or manufacturer of the equipment.



### Documents / Resources

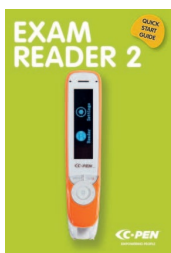

[C-PEN Exam Reader 2 Scanning Pens](#) [pdf] User Guide  
Exam Reader 2, Exam Reader 2 Scanning Pens, Scanning Pens, Pens

### References

- [☞ The original pen scanner brand for home, work and study - C-Pen](#)
- [☞ Register your product on our website and get updates - C-Pen](#)
- [☞ YouTube](#)
- [📞 Support : Helpdesk](#)
- [🌐 Support; Wij helpen je graag met al je ICT vragen en problemen!](#)
- [☞ C-Pen Exam Reader 2 - C-Pen](#)